

U.S. Army Corps  
of Engineers  
Baltimore District

# Public Notice

In Reply to Application Number  
CENAB-OP-RMS(SOMERSET COUNTY ROADS  
DEPARTMENT/WEONNA HARBOR) 2013-60527

PN 13-27

Comment Period: May 8, 2013 to May 28, 2013

---

**THE PURPOSE OF THIS PUBLIC NOTICE IS TO SOLICIT COMMENTS FROM THE PUBLIC REGARDING THE WORK DESCRIBED BELOW. NO DECISION HAS BEEN MADE AS TO WHETHER OR NOT A PERMIT WILL BE ISSUED AT THIS TIME.**

This District has received an application for a Department of the Army permit pursuant to **Section 10 of the Rivers and Harbors Act of 1899 and/or Section 404 of the Clean Water Act (33. U.S.C. 1344)** as described below:

**APPLICANT:** Somerset County Roads Department  
C/o Mr. Kelly Wright  
Andrews, Miller & Associates  
106 North Washington Street  
Easton, Maryland 21601

**LOCATION:** In the Lower Thorofare within the limits of the existing Federal Navigation channel into and including Wenona Harbor located at Deal Island Road in Wenona, Somerset County Maryland.

**PROPOSED WORK AND PURPOSE:** To maintenance dredge by hydraulic method an approximate 2.0 acre area, to a depth of -7.5 feet mean low water (MLW) and an approximate 3.5 acre area, to a depth of -6.5 feet MLW. The resulting approximately 19,000 cubic yards of sandy dredged material is to be deposited by hydraulic means in an existing approved upland (non-wetland) disposal area approximately 0.6 miles to the North. Ten year maintenance dredging is requested. The existing depths in the proposed dredge area range from -3.0 feet MLW to -7.0 MLW. All work will be completed in accordance with the enclosed plan(s). If you have any questions concerning this matter, please contact Mr. Eugene Morgenthaler at (410) 820-8629 or [eugene.j.morgenthaler@usace.army.mil](mailto:eugene.j.morgenthaler@usace.army.mil).

Site layout for this project was based upon existing contours that would most practically avoid and minimize impacts to jurisdictional waters. Efforts were made to avoid, to the maximum extent possible, the long and short term adverse impacts associated with the proposed project. The proposed impacts were reduced by proposing the minimum depths required for the skipjacks and other vessels utilizing the Wenona Harbor marina facility. Compensatory mitigation is not being proposed by the applicant for the dredging impacts. The project would be performed hydraulically and all dredge pipes would be free standing, laid on the bottom, with no pilings required.

The purpose of the proposed project is to restore required depths within the Federal Navigation channel into and including Wenona Harbor.

The Magnuson-Stevens Fishery Conservation and Management Act (MSFCMA), as amended by the Sustainable Fisheries Act of 1996 (Public Law 04-267), requires all Federal agencies to consult with the National Marine Fisheries Service (NMFS) on all actions, or proposed actions, permitted, funded, or undertaken by the agency that may adversely affect essential fish habitat (EFH). The project site lies in or adjacent to EFH as described under the MSFCMA for the *Scophthalmus aquosus* (windowpane flounder) juvenile and adult; *Pomatomus saltatrix* (blue fish) juvenile and adult; *Paralichthys dentatus* (summer flounder) juvenile and adult; and eggs, larvae, juvenile and adult stages of *Sciaenops ocellatus* (red drum),

*Scomberomorus cavalla* (king mackerel), *Scomberomorus maculatus* (spanish mackerel), and *Rachycentron canadum* (cobia), managed species under the MSFCMA.

The project has the potential to adversely affect EFH or the species of concern by loss of nursery, forage and/or shelter habitat. The project area waterway is near a Habitat Area of Particular Concern (HAPC). The SAV species that exist in the Lower Thorofoff off of Little Deal Island have been surveyed by the Virginia Institute of Marine Science (VIMS) within the segment TANMH1 and are unknown. There were no SAV ground truth observations in the general project area. Part of the project area has been periodically dredged and the additional area does not have any SAV mapped according to VIMS surveys. The project may have an adverse effect on Essential Fish Habitat as described under the Magnuson-Stevens Fishery Conservation and Management Act for the species and life stages identified above. However, the District Engineer has made a preliminary determination that site-specific impacts would not be substantial and an abbreviated consultation will be conducted with NMFS. This determination may be modified if additional information indicates otherwise and would change the preliminary determination.

The decision whether to issue a permit will be based on an evaluation of the probable impacts, including cumulative impacts of the proposed activity on the public interest. That decision will reflect the national concern for both protection and utilization of important resources. The benefit, which reasonable may be expected to accrue from the proposal, must be balanced against its reasonably foreseeable detriments. All factors, which may be relevant to the proposal will be considered, including the cumulative effects thereof; among those are conservation, economic, aesthetics, general environmental concerns, wetlands, cultural values, fish and wildlife values, flood hazards, flood plain values, land use, navigation, shoreline erosion and accretion, recreation, water supply and conservation, water quality, energy needs, safety, food and fiber production, mineral needs, and consideration of property ownership and in general, the needs and welfare of the people.

The Corps of Engineers is soliciting comments from the public; Federal, State, and local agencies and officials; Indian Tribes; and other interested parties in order to consider and evaluate the impacts of this proposed activity. Any comments received will be considered by the Corps of Engineers to determine whether to issue, modify, condition or deny a permit for this proposal. To make this decision, comments are used to assess impacts on endangered species, historic properties, water quality, general environmental effects, and the other public interest factors listed above.

Comments are used in the preparation of an Environmental Assessment and/or an Environmental Impact Statement pursuant to the National Environmental Policy Act. Comments provided will become part of the public record for this action. Comments are also used to determine the need for a public hearing and to determine the overall public interest of the proposed activity. Written comments concerning the work described above related to the factors listed above or other pertinent factors must be received by the District Engineer, U.S. Army Corps of Engineers, Baltimore District, P.O. Box 1715, Baltimore, Maryland 21203-1715 within the comment period specified above.

The applicant is required to obtain a water quality certification in accordance with Section 401 of the Clean Water Act from the Maryland Department of the Environment. Any written comments concerning the work described above which relate to water quality certification must be received by the Wetlands and Waterways Program, Maryland Department of the Environment, Montgomery Park Business Center, 1800 Washington Boulevard, Suite 430, Baltimore, Maryland 21230-1708, within the comment period as specified above to receive consideration. The Section 401 certifying agency has a statutory limit of one year from the date of this public notice to make its decision.

Where applicable, the applicant has certified in this application that the proposed activity complies with and will be conducted in a manner consistent with the approved Coastal Zone Management (CZM) Program. By this public notice, we are requesting the State concurrence or objection to the applicant's consistency statement. It should be noted that the CZM Program has a statutory limit of 6 months to make its consistency determination.

The applicant must obtain any State or local government permits which may be required.

A preliminary review of this application indicates that the proposed work will not affect Federal listed threatened or endangered species or their critical habitat, pursuant to Section 7 of the Endangered Species Act, as amended. As the evaluation of this application continues, additional information may become available which could modify this preliminary determination.

Review of the latest published version of the National Register of Historic Places indicates that no registered properties listed as eligible for inclusion, therein, are located at the site of the proposed work. Currently unknown archeological, scientific, prehistoric, or historical data may be lost or destroyed by the work to be accomplished under the request permit.

The evaluation of the impact of this project on the public interest will include application of the guidelines promulgated by the Administrator, U.S. Environmental Protection Agency, under authority of Section 404 of the Clean Water Act.

Any person who has an interest which may be adversely affected by the issuance of this permit may request a public hearing. The request, which must be in writing, must be received by the District Engineer, U.S. Army Corps of Engineers, Baltimore District, P.O. Box 1715, Baltimore, Maryland 21203-1715, within the comment period as specified above to receive consideration. Also it must clearly set forth the interest which may be adversely affected by this activity and the manner in which the interest may be adversely affected.

It is requested that you communicate this information concerning the proposed work to any persons know by you to be interested and not being known to this office, who did not receive a copy of this notice.

FOR THE DISTRICT ENGINEER:

KATHY B. ANDERSON  
Chief, Maryland Section Southern

# LOWER THOROFARE CHANNEL IMPROVEMENTS

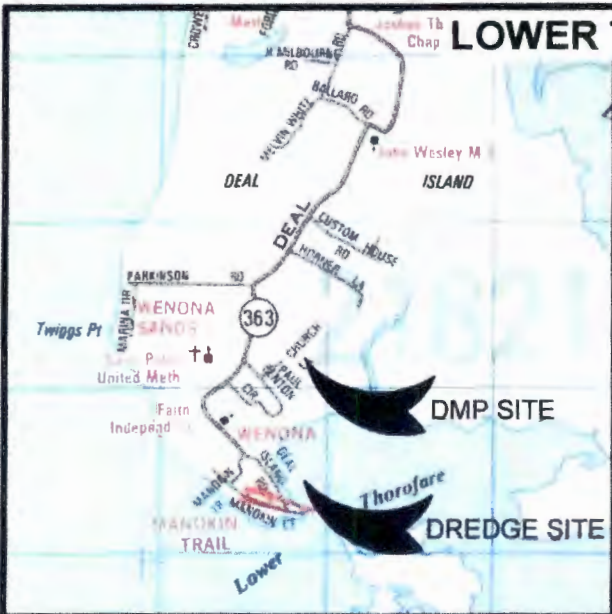

## VICINITY MAP

Copyright ADC The Map People  
Permitted Use No. 20710173

## GENERAL NOTES

1. Mean Tidal Range is 1.76'
2. Soundings shown in black are in feet and refer to Mean Low Water (MLW).
3. Soundings shown in red are in feet and refer to Mean Low Lower Water (MLLW).
4. Elevation difference between MLW and MLLW is 0.12'.
5. Datum information was obtained from NOAA Tidal Station #8571421 in Bishops Head, Maryland.
6. These drawings are for outline purposes only. Design drawings are to be provided separately.

**WATERWAY:** LOWER THOROFARE, SOMERSET COUNTY

**PROPOSED WORK:** HYDRAULIC DREDGE 2.0 ACRES TO -7.5' MLW AND 3.5 ACRES TO -6.5' MLW. TOTAL VOLUME OF DREDGE MATERIAL EQUALS APPROXIMATELY 19,000 CY. DREDGED MATERIAL TO BE DISPOSED AT NEARBY DMP SITE LOCATED 0.60 MILES AWAY.

**APPLICANT:** SOMERSET COUNTY ROADS DEPARTMENT  
8981 SIGN POST ROAD  
WESTOVER, MD. 21871

**DATE:** MARCH 2013

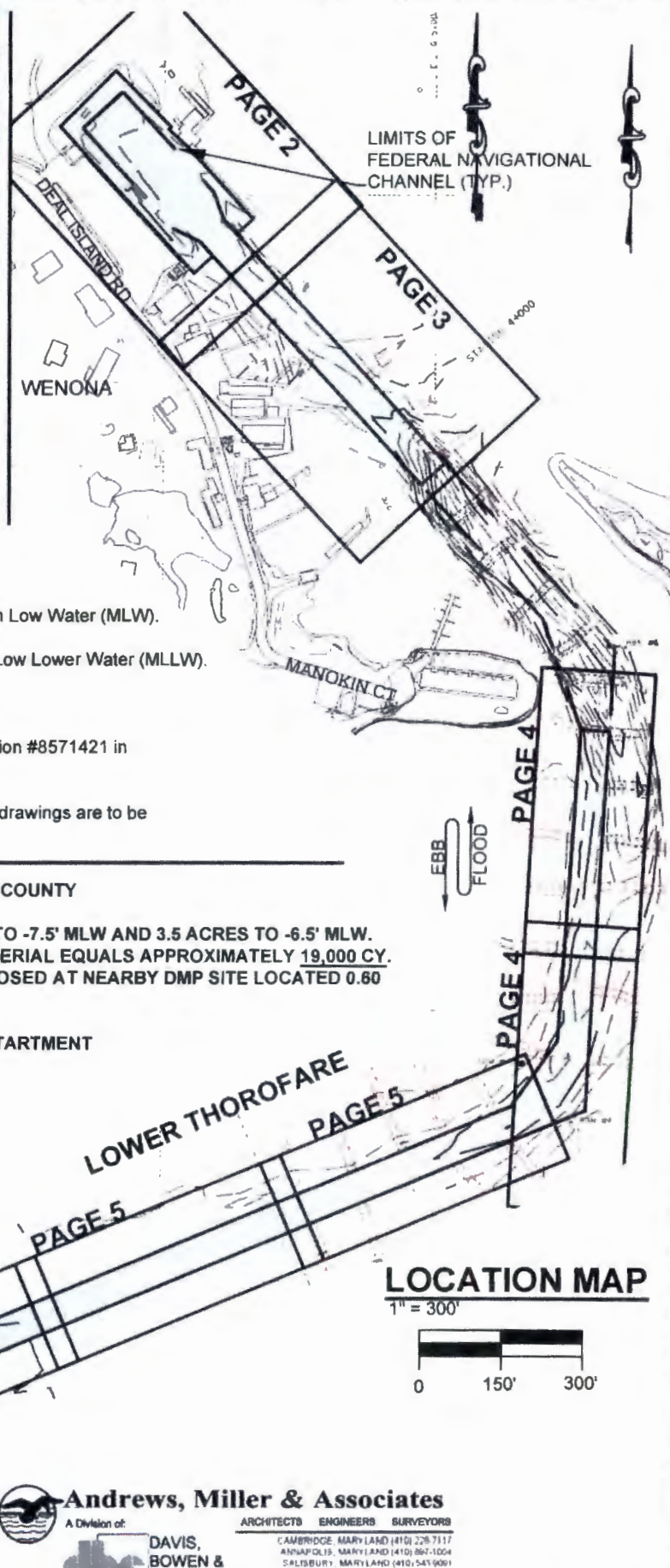

## LOCATION MAP

1" = 300'



**Andrews, Miller & Associates**

A Division of

**DAVIS,  
BOWEN &  
FRIEDEL, INC.**

ARCHITECTS ENGINEERS SURVEYORS

CAMBRIDGE, MARYLAND (410) 226-7117  
ANNEAPOLIS, MARYLAND (410) 867-1004  
SALISBURY, MARYLAND (410) 543-9001  
MILFORD, DELAWARE (302) 424-1441  
EASTON, MARYLAND (410) 770-4744

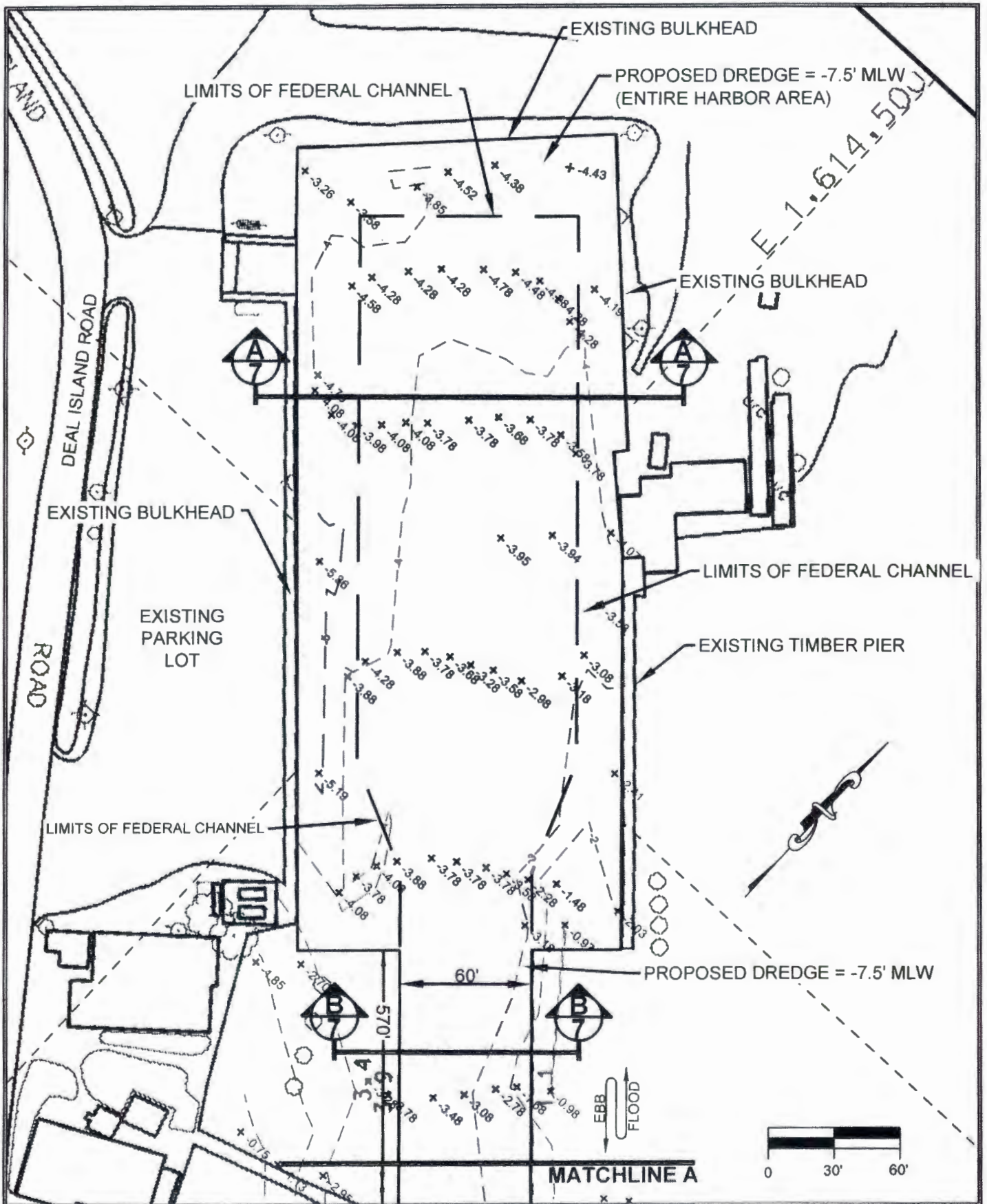

**Andrews, Miller & Associates**

A Division of:



**DAVIS,  
BOWEN &  
FRIEDEL, INC.**

**ARCHITECTS ENGINEERS SURVEYORS**

CAMBRIDGE, MARYLAND (410) 228-7117  
 ANNAPOLIS, MARYLAND (410) 897-1004  
 SALISBURY, MARYLAND (410) 543-9091  
 MILFORD, DELAWARE (302) 424-1441  
 EASTON, MARYLAND (410) 770-4744

DES: ---

DATE: 03/2013

DRN: KLW

SCALE: 1" = 60'

CHK: ETF

JOB#: 0044B014

*Page 2*

*2 of 9*

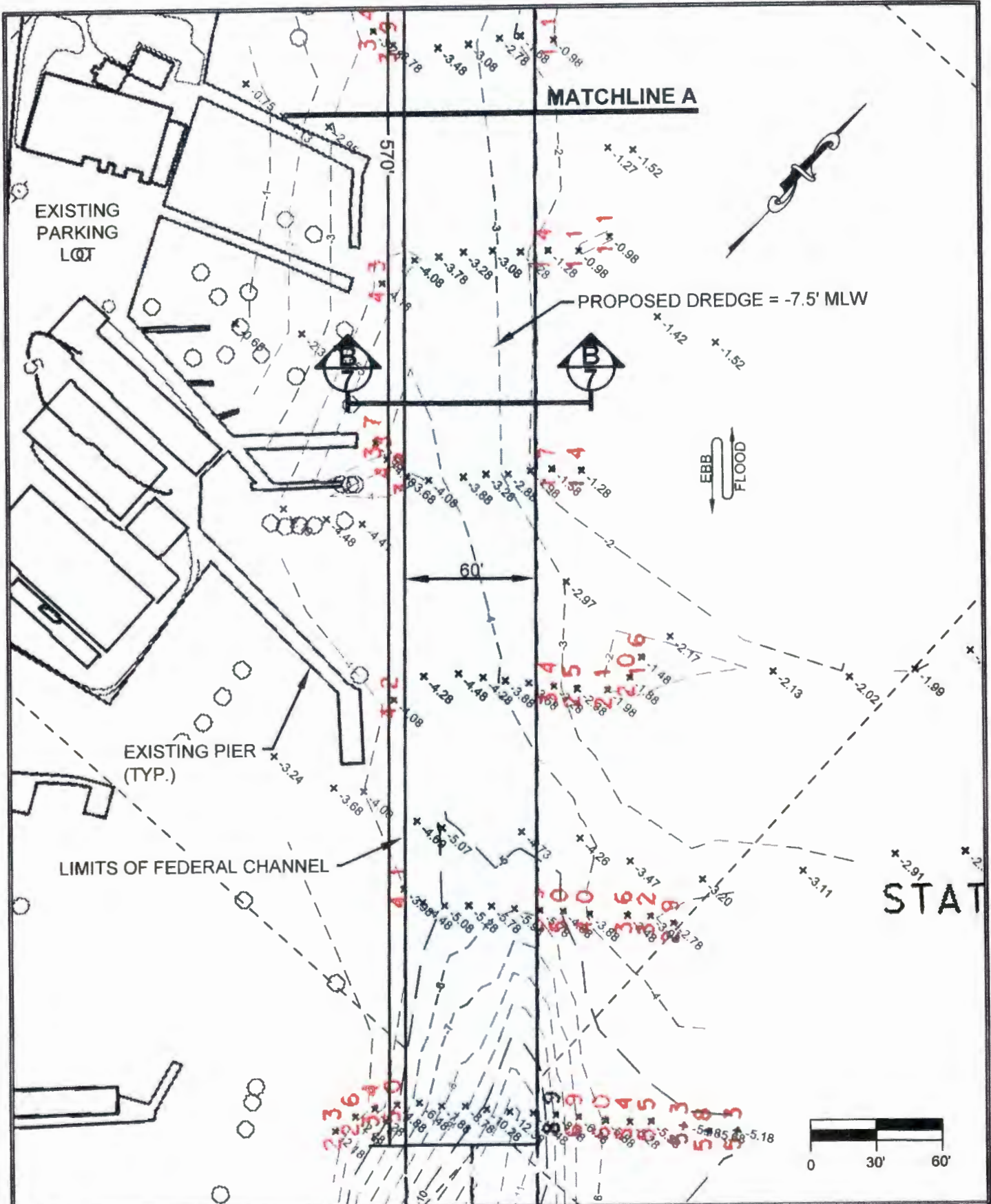

**Andrews, Miller & Associates**  
 A Division of: **dbf** **DAVIS, BOWEN & FRIEDEL, INC.**  
 ARCHITECTS ENGINEERS SURVEYORS  
 CAMBRIDGE, MARYLAND (410) 228-7117  
 ANNAPOLIS, MARYLAND (410) 897-1004  
 SALISBURY, MARYLAND (410) 543-9091  
 MILFORD, DELAWARE (302) 424-1441  
 EASTON, MARYLAND (410) 770-4744

DES: —  
 DRN: **KLW**  
 CHK: **ETF**

DATE: **03/2013**  
 SCALE: **1" = 60'**  
 JOB#: **0044B014**

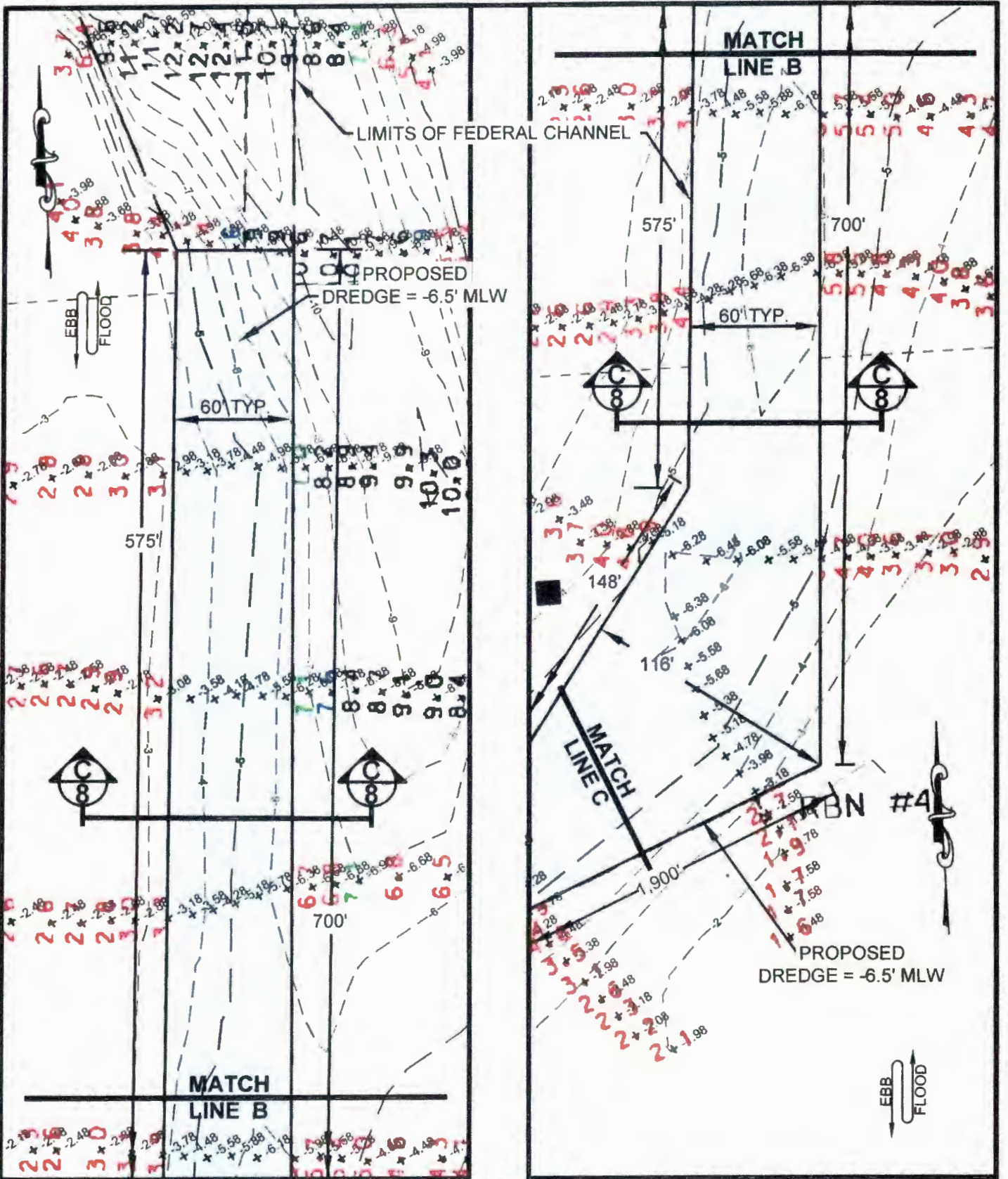

**Andrews, Miller & Associates**

A Division of:



**DAVIS,  
BOWEN &  
FRIEDEL, INC.**

ARCHITECTS ENGINEERS SURVEYORS

CAMBRIDGE, MARYLAND (410) 228-7117  
ANNAPOLIS, MARYLAND (410) 897-1004  
SALISBURY, MARYLAND (410) 543-9091  
MILFORD, DELAWARE (302) 424-1441  
EASTON, MARYLAND (410) 770-4744

DES: —

DRN: *KLW*

CHK: *ETF*

DATE: 03/2013

SCALE: 1" = 60'

JOB#: 0044B014

*Page 4*

*4 of 9*





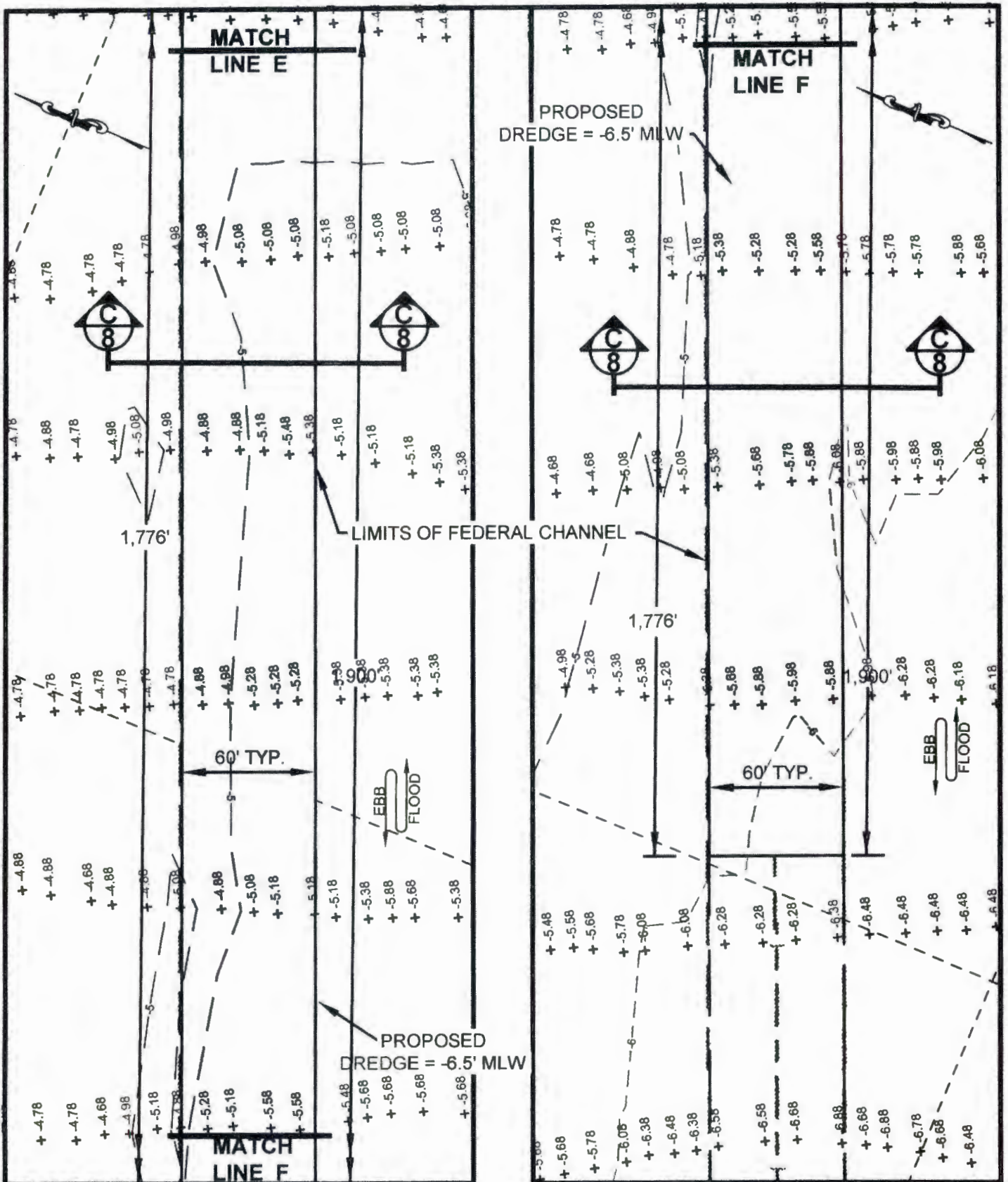

**Andrews, Miller & Associates**

A Division of:



**DAVIS,  
BOWEN &  
FRIEDEL, INC.**

**ARCHITECTS ENGINEERS SURVEYORS**

CAMBRIDGE, MARYLAND (410) 228-7117  
 ANNAPOLIS, MARYLAND (410) 897-1004  
 SALISBURY, MARYLAND (410) 543-9091  
 MILFORD, DELAWARE (302) 424-1441  
 EASTON, MARYLAND (410) 770-4744

DES: ---

DATE: 03/2013

DRN: KLW

SCALE: 1" = 60'

CHK: ETF

JOB#: 0044B014

**Page 6**

6 of 9



**Andrews, Miller & Associates**

A Division of:  
**DAVIS, BOWEN & FRIEDEL, INC.**  
 ARCHITECTS ENGINEERS SURVEYORS  
 CAMBRIDGE, MARYLAND (410) 228-7117  
 ANNAPOLIS, MARYLAND (410) 897-1004  
 SALESBURY, MARYLAND (410) 543-5081  
 MILFORD, DELAWARE (302) 424-1441  
 EASTON, MARYLAND (410) 773-4174

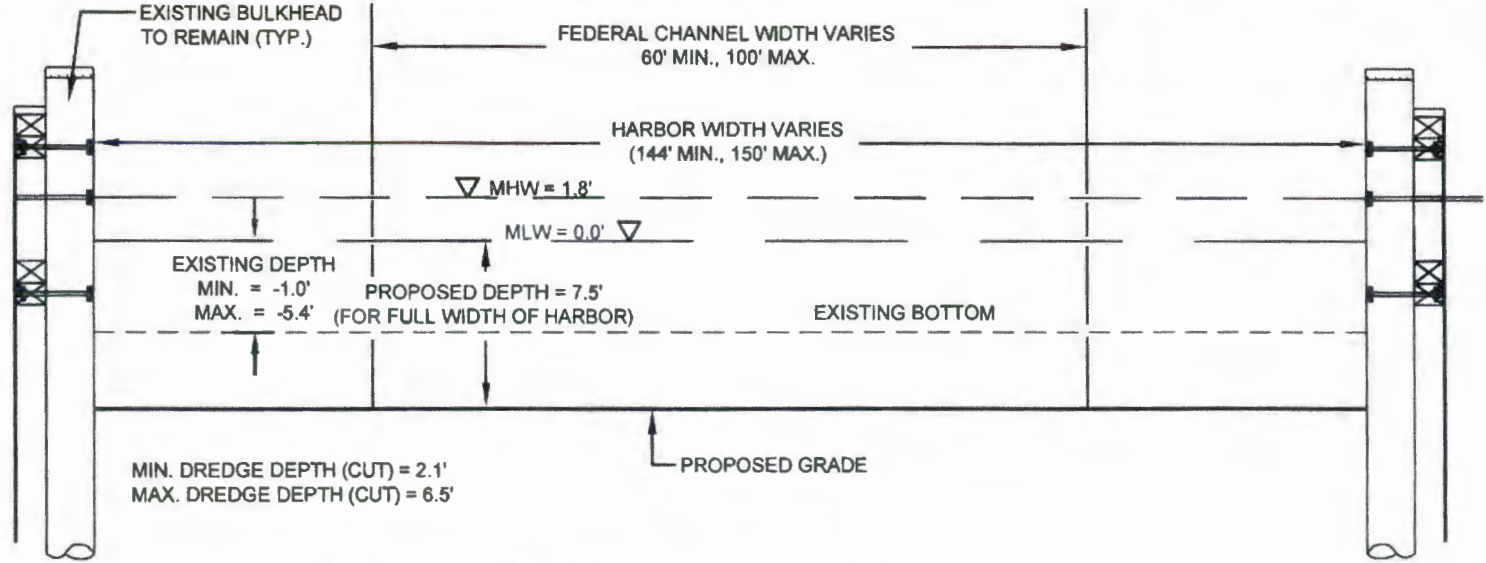

**TYPICAL DREDGE SECTION A-A**

SCALE: NONE

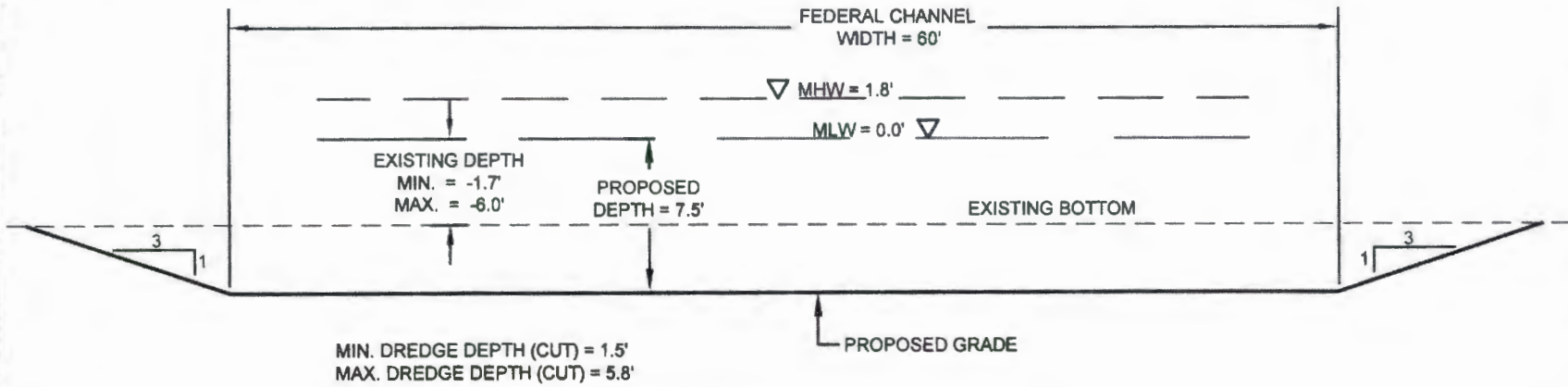

**TYPICAL DREDGE SECTION B-B**

SCALE: NONE

DES: ---	DATE: 03/2013
DRW: KLW	SCALE: None
CHK: ETF	JOB #: 00448014

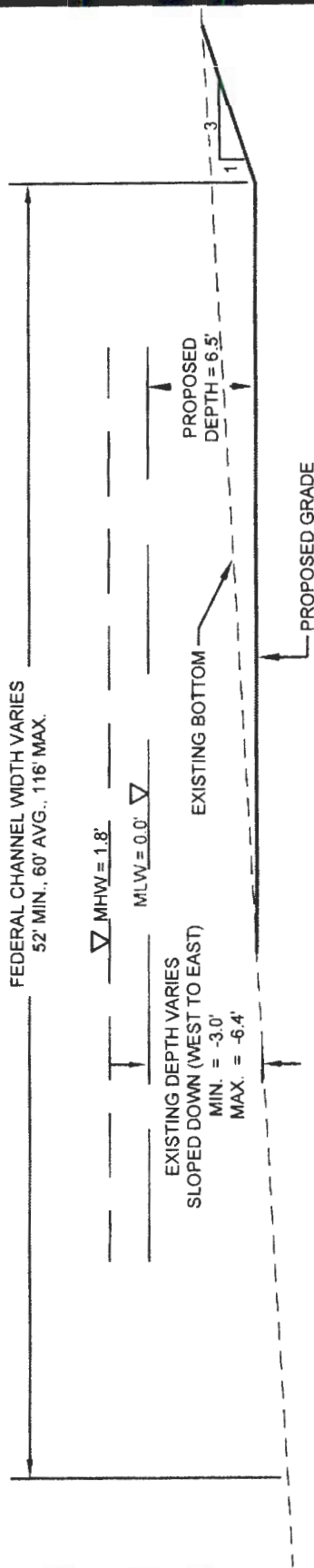

MIN. DREDGE DEPTH (CUT) = 0.1'  
 MAX. DREDGE DEPTH (CUT) = 3.5'

### TYPICAL DREDGE SECTION C-C

SCALE: NONE

Section	Proposed Depth (ft.)	Total Length (ft.)	Section Volume (cy)
A-A	-7.5	370	6,600
B-B	-7.5	570	4,100
C-C	-6.5	2,600	8,300
TOTAL		3,540	19,000

### DREDGE SUMMARY



**Andrews, Miller & Associates**

A Division of:



**DAVIS,  
BOWEN &  
FRIEDEL, INC.**

ARCHITECTS ENGINEERS SURVEYORS  
 CAMBRIDGE, MARYLAND (410) 228-7117  
 ANNAPOLIS, MARYLAND (410) 897-1004  
 SALISBURY, MARYLAND (410) 543-9091  
 MILFORD, DELAWARE (302) 424-1441  
 EASTON, MARYLAND (410) 770-4744

DES: ---

DATE: 03/2013

DRN: KLW

SCALE: None

CHK: ETF

JOB#: 0044B014

Page 8

8 of 9

OUTFALL LOCATION



ACCESS ROAD



DREDGING PROJECT AREA =  
±0.5 MILES SOUTH

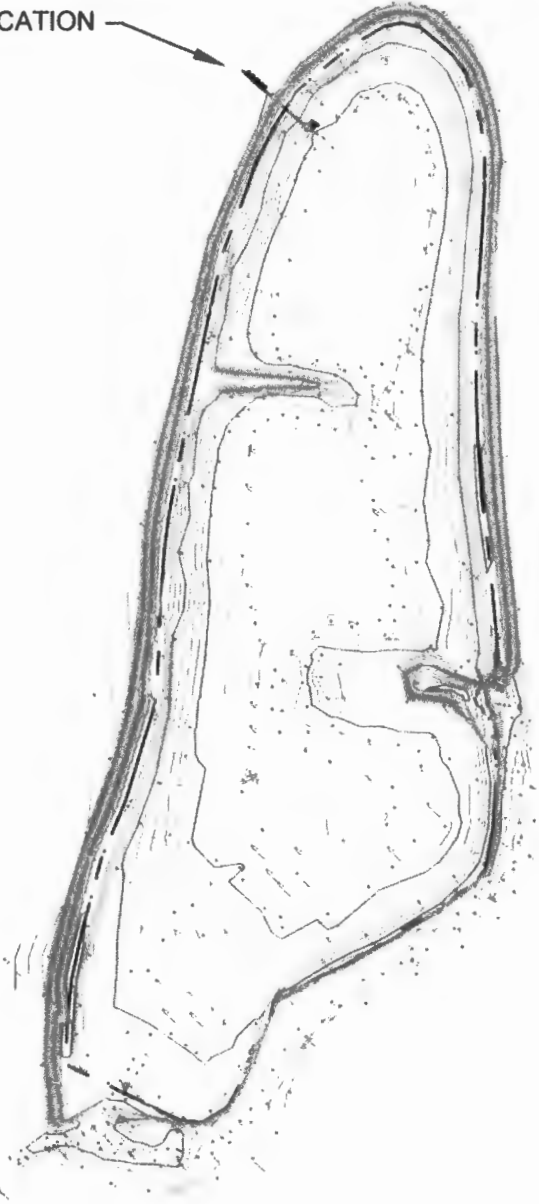

**DREDGE MATERIAL PLACEMENT SITE**

TOP ELEV.:	13.0' MLW
BOTTOM ELEV.:	VARIES (3.0' MIN.)
MAXIMUM FILL ELEV.:	11.0' MLW
SURFACE AREA AT ELEV. 10:	6.8 ACRES
AVAILABLE CAPACITY:	60,400 CY



**Andrews, Miller & Associates**

A Division of:



**DAVIS,  
BOWEN &  
FRIEDEL, INC.**

**ARCHITECTS ENGINEERS SURVEYORS**

CAMBRIDGE, MARYLAND (410) 228-7117  
ANNAPOLIS, MARYLAND (410) 897-1004  
SALISBURY, MARYLAND (410) 543-9091  
MILFORD, DELAWARE (302) 424-1441  
EASTON, MARYLAND (410) 770-4744

DES: ---

DATE: 03/2013

DRN: K<sup>L</sup>W

SCALE: 1" = 200'

CHK: E<sup>T</sup>F

JOB #: 0044B014

**Page 9**

**9 of 9**

# HYDRAULIC PIPE PLACEMENT



1 inch = 500 feet

No SAV 2008 -2012  
VIMS Surveys

Aerial Map Date: 2007



1 inch = 500 feet

Aerial Map Date: 2007