

U.S. Army Corps
of Engineers
Baltimore District

Public Notice

In Reply to Application Number:
CENAB-OP-RMN (Harford County Airport Owners
Group, Inc./Rd. Xing & Lot Fill) 2013-60337-M12

PN 13-44

Comment Period: July 19, 2013 – August 19, 2013

THE PURPOSE OF THIS PUBLIC NOTICE IS TO SOLICIT COMMENTS FROM THE PUBLIC ABOUT THE WORK DESCRIBED BELOW. AT THIS TIME, NO DECISION HAS BEEN MADE AS TO WHETHER OR NOT A PERMIT WILL BE ISSUED.

The Baltimore District has received an application for a Department of the Army Permit pursuant to **Section 404 of the Clean Water Act (33. U.S.C. 1344)**, as described below:

APPLICANT: Harford County Airport Owners Group, Inc.
Attn: Mr. Shawn Pyle
3538 Aldino Road
Churchville, Maryland 21028

LOCATION: The project is proposed at the Harford County Airport located at 3538 Aldino Road (MD 156) in Churchville, Harford County, Maryland.

WORK: The Harford County Airport Owners Group has requested Department of the Army (DA) authorization from the U.S. Army Corps of Engineers Baltimore District (Corps) to impact waters of the United States, including jurisdictional wetlands associated with the provision of updates and the expansion of the Harford County Airport. The project is being implemented to update airport facilities to current standards, consolidate three existing runways into a single larger one, and replace outdated buildings to address current/future needs. The construction of the project would result in permanent impacts to 35,703 square feet/0.82 acres of emergent nontidal wetlands and 762 linear feet/798 square feet of an unnamed tributary to Swan Creek. In addition, 15,118 square feet/0.35 acres of a forested nontidal wetland would be converted to an emergent wetland to comply with FAA requirements. All work would be completed in accordance with the attached plans dated May 10, 2013.

If you have any questions concerning this matter, please contact *Mr. Steve Elinsky at 410.962.4503 or Steve.Elinsky@usace.army.mil.*

As part of the planning process for the proposed project, steps were taken to ensure avoidance and minimization of impacts to waters of the United States to the maximum extent practicable. Compensatory mitigation required for permanent impacts to wetlands is being proposed on-site and would include the provision of wetland creation, restoration, and enhancement. Stream mitigation would be provided within areas where wetlands creation or restoration is proposed.

The decision whether to issue a permit will be based on an evaluation of the probable impact including cumulative impacts of the proposed activity on the public interest. That decision will reflect the national concern for both protection and utilization of important resources. The benefit which reasonably may be expected to accrue from the proposal must be balanced against its reasonably foreseeable detriments. All factors which may be relevant to the proposal will be considered including the cumulative effects thereof; among those are conservation, economics, aesthetics, general

environmental concerns, wetlands, cultural values, fish and wildlife values, flood hazards, flood plain values, land use, navigation, shoreline erosion and accretion, recreation, water supply and conservation, water quality, energy needs, safety, food and fiber production, and, in general, the needs and welfare of the people.

The evaluation of the impacts of the work described above on the public interest will include application of the Clean Water Act 404(b)(1) Guidelines promulgated by the Administrator, U.S. Environmental Protection Agency, under authority of Section 404 of the Clean Water Act.

The Corps of Engineers is soliciting comments from the public; Federal, State, and local agencies and officials; Indian Tribes; and other interested parties in order to consider and evaluate the impacts of this proposed activity. Any comments received will be considered by the Corps of Engineers to determine whether to issue, modify, condition or deny a permit for this proposal. To make this decision, comments are used to assess impacts on endangered species, historic properties, water quality, general environmental effects, and the other public interest factors listed above. Comments are used in the preparation of an Environmental Assessment and/or an Environmental Impact Statement pursuant to the National Environmental Policy Act. Comments are also used to determine the need for a public hearing and to determine the overall public interest of the proposed activity.

Written comments concerning the work described above related to the factors listed above or other pertinent factors must be received by the District Engineer, US Army Corps of Engineers, Baltimore District, [Attn: Mr. Steve Elinsky, CENAB-OP-RMN], P.O. Box 1715, Baltimore, Maryland 21203-1715, within the comment period as specified above to receive consideration.

SECTION 401 WATER QUALITY CERTIFICATION: The applicant is required to obtain a water quality certification in accordance with Section 401 of the Clean Water Act from the Maryland Department of the Environment. Any written comments concerning the work described above which relate to water quality certification must be received by the Maryland Department of the Environment, Tidal Wetlands Division, Wetlands and Waterways Program, Montgomery Park Business, 1800 Washington Boulevard, Suite 430, Baltimore, Maryland 21230, within the comment period as specified above to receive consideration. The Section 401 certifying agency has a statutory limit of one year from the date of this public notice to make its decision.

COASTAL ZONE MANAGEMENT PROGRAMS: Where applicable, the applicant has certified in this application that the proposed activity complies with and will be conducted in a manner consistent with the approved Coastal Zone Management (CZM) Program. By this public notice, we are requesting the State concurrence or objection to the applicant's consistency statement. Public comments relating to consistency must be received by the Coastal Zone Consistency Division, Maryland Department of the Environment, Montgomery Park Business Center, 1800 Washington Boulevard, Suite 430, Baltimore, Maryland 21230-1708 within the comment period as specified above to receive consideration. It should be noted that the CZM Program has a statutory limit of 6 months to make its consistency determination.

The applicant must obtain any State or local government permits which may be required.

A preliminary review of this application indicates that the proposed work will not affect listed species or their critical habitat pursuant to Section 7 of the Endangered Species Act as amended. As the evaluation of this application continues, additional information may become available which could modify this preliminary determination.

The Corps and the Maryland Historical Trust is reviewing the project to assess its effects if any on historic properties pursuant to Section 106 of the National Historic Preservation Act of 1966. Currently unknown archeological, scientific, prehistoric, or historical data may be lost or destroyed by the work to be accomplished under the requested permit.

Any person who has an interest which may be adversely affected by the issuance of this permit may request a public hearing. The request, which must be in writing, must be received by the District Engineer, US Army Corps of Engineers, Baltimore District, PO Box 1715, [Attn: Mr. Steve Elinsky, CENAB-OP-RMN], Baltimore, Maryland 21203-1715, within the comment period as specified as above to receive consideration. Also, it must clearly state forth the interest which may be adversely affected by this activity in the manner in which the interest may be adversely affected.

It is requested that you communicate the foregoing information concerning the proposed work to any persons known by you to be interested and not being known to this office, who did not receive a copy of this notice.

JOSEPH P. DAVIA
Chief, Maryland Section Northern

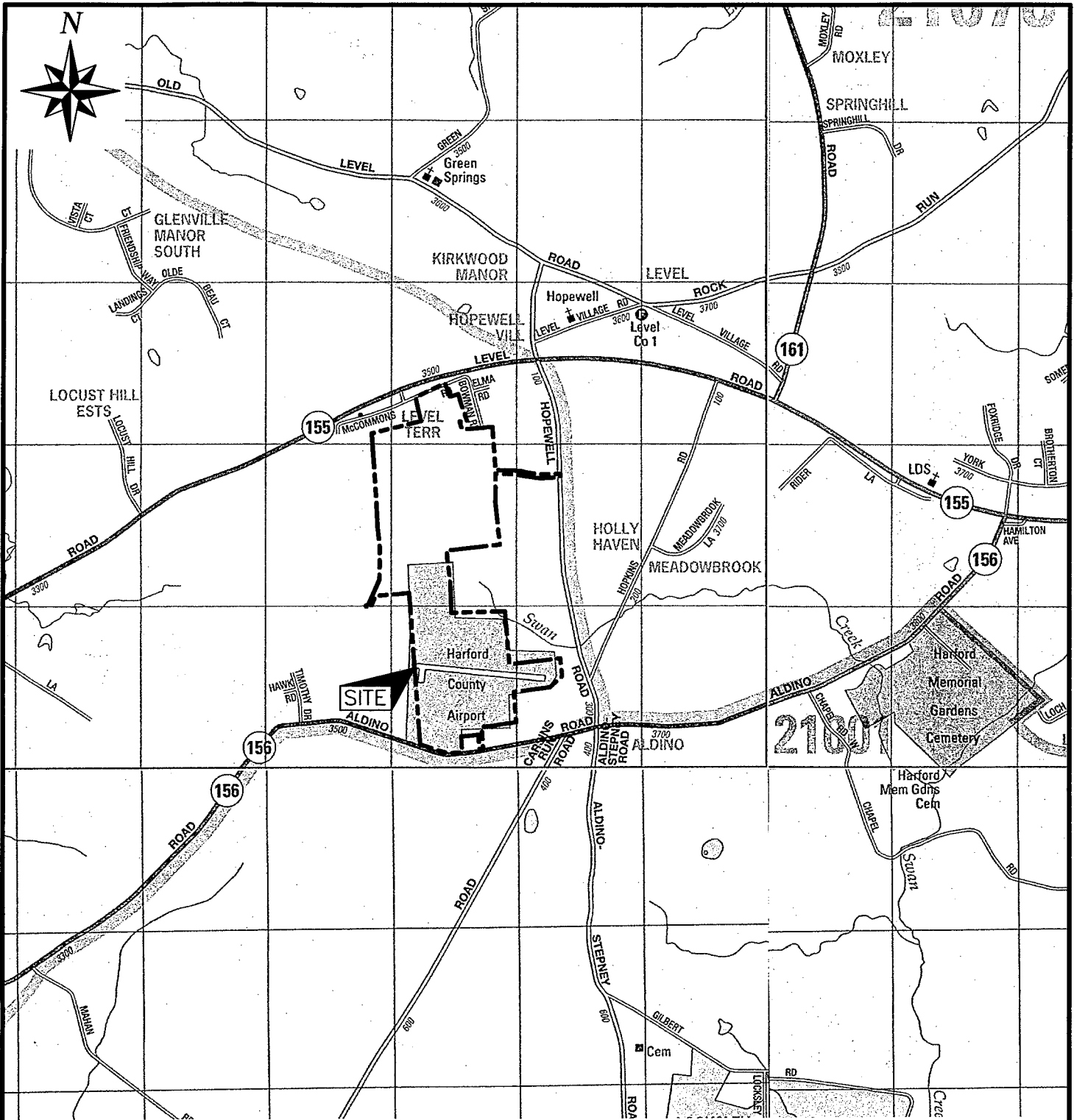

SOURCE: CHURCHVILLE AREA, HARFORD COUNTY ADC MAPS 4241,4242,4353,4354.

CNA

engineers, surveyors & landscape architects

Civil Engineers • Land Surveyors • Landscape Architects
 Planners • Geotechnical Engineers • Environmental Engineers
 215 Bynum Road
 Forest Hill, Maryland 21050
 Phone (410) 879-7200 • Fax (410) 838-1811
 E-mail: cnamail@cna-engineers.com

SITE LOCATION MAP FOR HARFORD COUNTY AIRPORT

3538 ALDINO ROAD

2ND ELECTION DISTRICT

HARFORD COUNTY, MARYLAND

Drawn: JEB



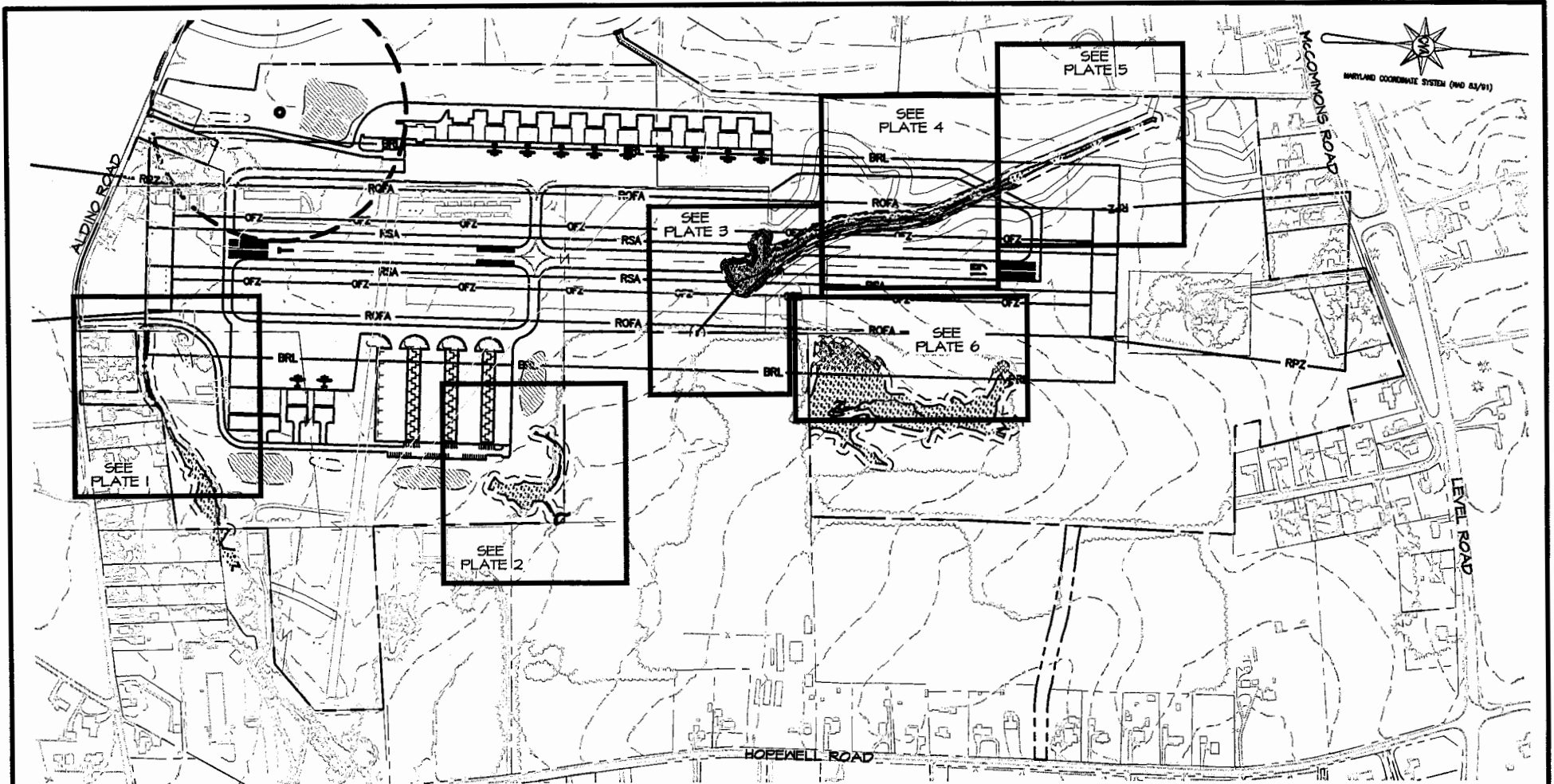

Date: 02/01/13

Scale: 1"=2000'

Job No: 11021



LEGEND

-  PERMANENT NONTIDAL WETLAND IMPACT
-  PERMANENT WETLAND BUFFER IMPACT
-  PERMANENT WATERS OF THE U.S. IMPACT
-  NONTIDAL WETLAND CONVERSION
-  TEMPORARY WETLAND BUFFER IMPACT

PROPOSED IMPACTS			
IMPACT TYPE	IMPACT AREA, SQ FT ±	IMPACT AREA, AC ±	IMPACT AREA, L.F. ±
NONTIDAL WETLAND	35,703	0.82	na
NONTIDAL WETLAND BUFFER	68,086	1.56	na
OPEN WATERS OF THE U.S.	798	0.02	762
NONTIDAL WETLAND CONVERSION	15,118	0.35	na
WETLAND BUFFER CONVERSION	13,531	0.31	na

CNA
engineers, surveyors & landscape architects

Civil Engineers • Land Surveyors • Landscape Architects
Planners • Geotechnical Engineers • Environmental Engineers
215 Byrum Road
Forest Hill, Maryland 21050
Phone (410) 879-7200 • Fax (410) 838-1811
E-mail: cnamail@cna-engineers.com

PROPOSED JURISDICTIONAL IMPACTS
FOR
HARFORD COUNTY AIRPORT

2nd ELECTION DISTRICT HARFORD COUNTY, MARYLAND

Drawn: MWD Date: 05/10/13 Scale: 1"=600' Job No: 11021

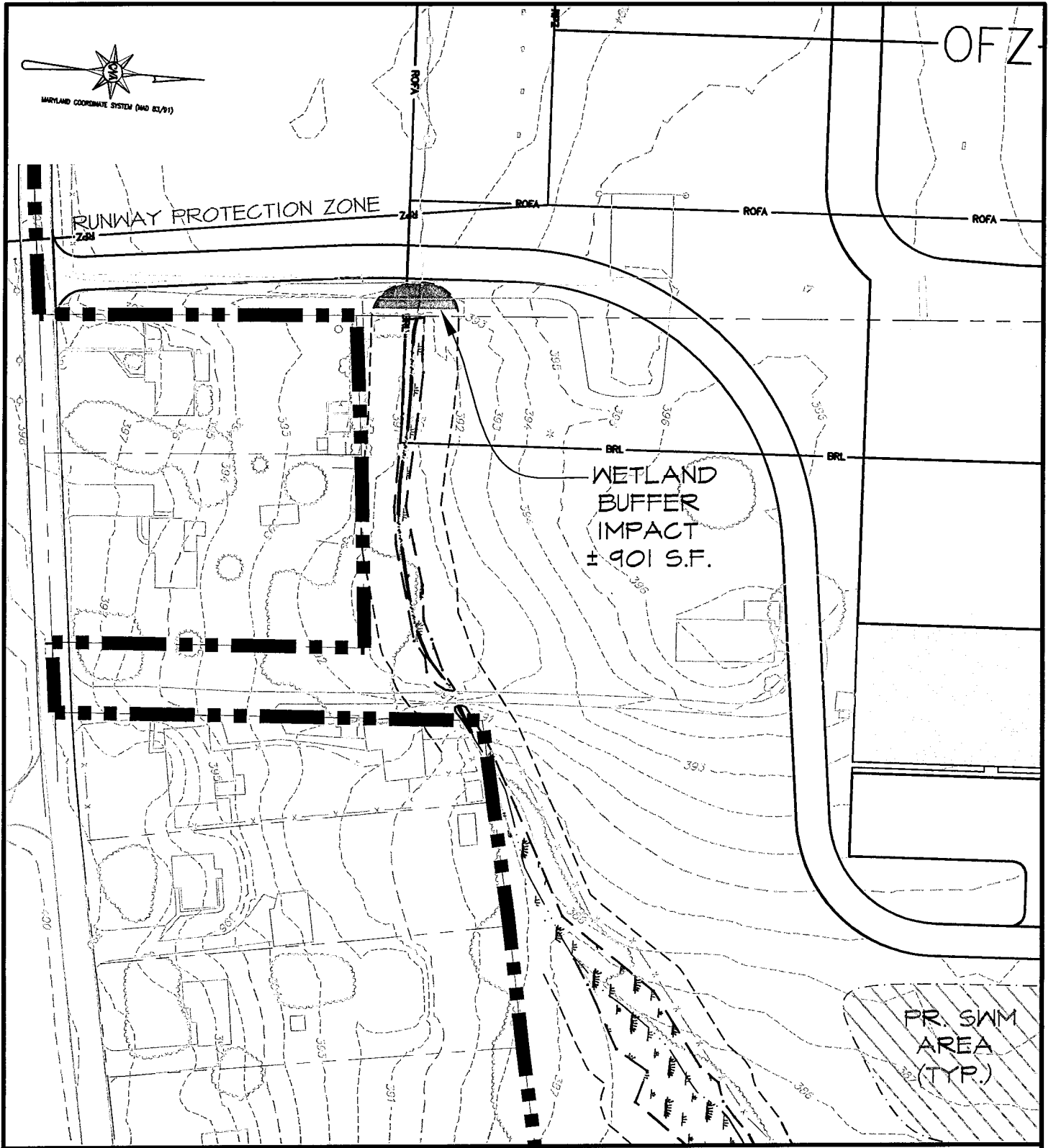

CNA
 engineers, surveyors & landscape architects

Civil Engineers • Land Surveyors • Landscape Architects
 Planners • Geotechnical Engineers • Environmental Engineers
 215 Bynum Road
 Forest Hill, Maryland 21050
 Phone (410) 879-7200 • Fax (410) 838-1811
 E-mail: cnamail@cna-engineers.com

IMPACT PLATE 1
 FOR
**HARFORD COUNTY
 AIRPORT**

2nd ELECTION DISTRICT HARFORD COUNTY
 Drawn: MWD Date: 05/10/13 Scale: 1"=100' Job No: 11021

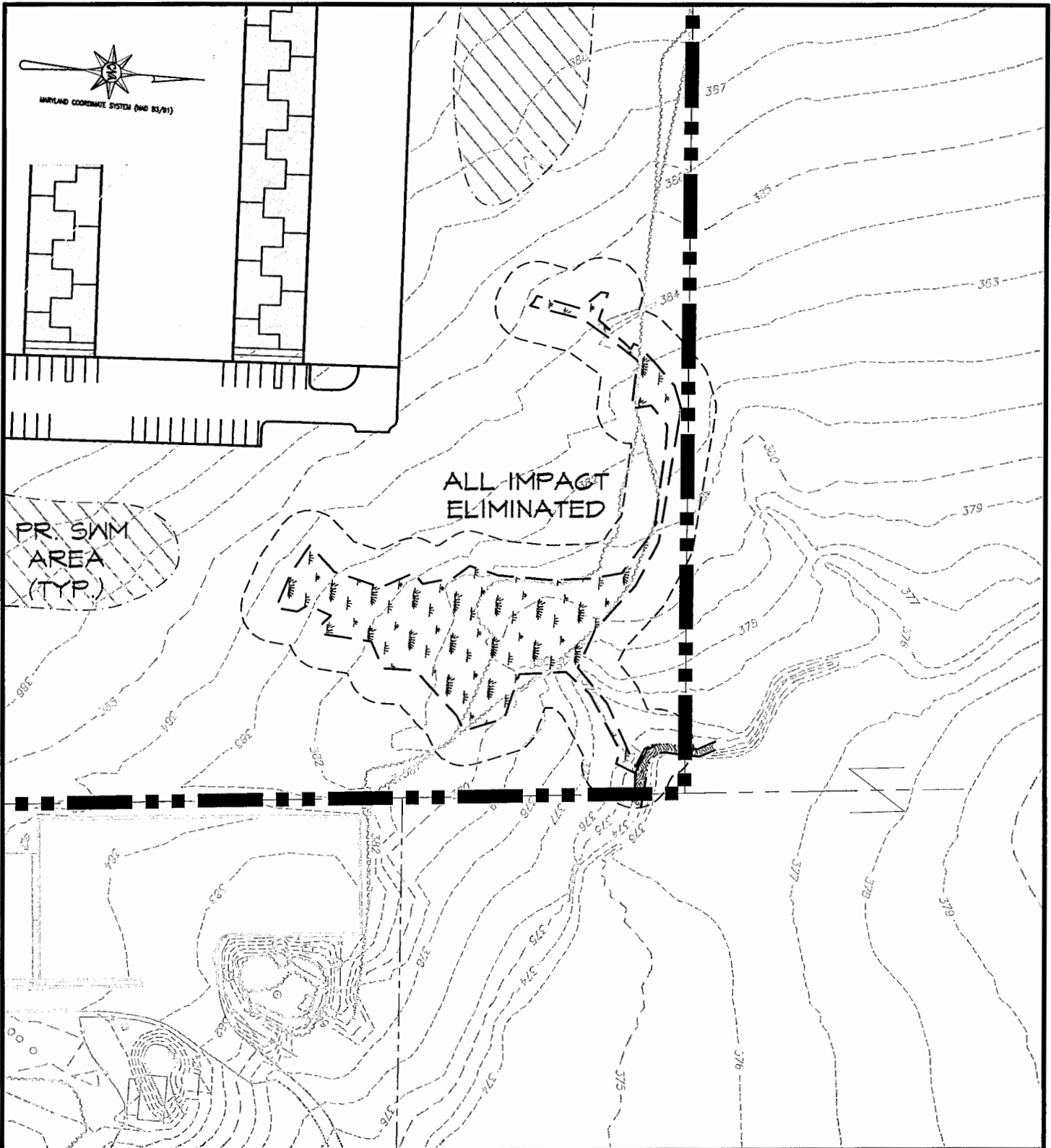

CNA
 engineers, surveyors & landscape architects

Civil Engineers • Land Surveyors • Landscape Architects
 Planners • Geotechnical Engineers • Environmental Engineers
 215 Bynum Road
 Forest Hill, Maryland 21050
 Phone (410) 879-7200 • Fax (410) 838-1811
 E-mail: cnamail@cna-engineers.com

IMPACT PLATE 2
 FOR
**HARFORD COUNTY
 AIRPORT**

2nd ELECTION DISTRICT

HARFORD COUNTY

Drawn: MWD

Date: 05/10/13

Scale: 1"=100'

Job No: 11021



PART OF NONTIDAL
WETLAND IMPACT
AREA TOTALING
±35,703 S.F.

PART OF WETLAND
BUFFER IMPACT
± 67,184 S.F.

PART OF
WATERS OF THE
U.S. IMPACT
± 798 S.F., 762 L.F.

IMPACT
ELIMINATED

RUNWAY OBJECT FREE AREA

WETLAND & STREAM
AREA

TRANSITIONAL
SURFACE
7:1 SLOPE

TRANSITIONAL
SURFACE
7:1 SLOPE

CNA
engineers, surveyors & landscape architects

Civil Engineers • Land Surveyors • Landscape Architects
Planners • Geotechnical Engineers • Environmental Engineers
215 Bynum Road
Forest Hill, Maryland 21050
Phone (410) 879-7200 • Fax (410) 838-1811
E-mail: cnamail@cna-engineers.com

IMPACT PLATE 3

FOR

**HARFORD COUNTY
AIRPORT**

2nd ELECTION DISTRICT

HARFORD COUNTY

Drawn: MWD

Date: 05/10/13

Scale: 1"=100'

Job No: 11021

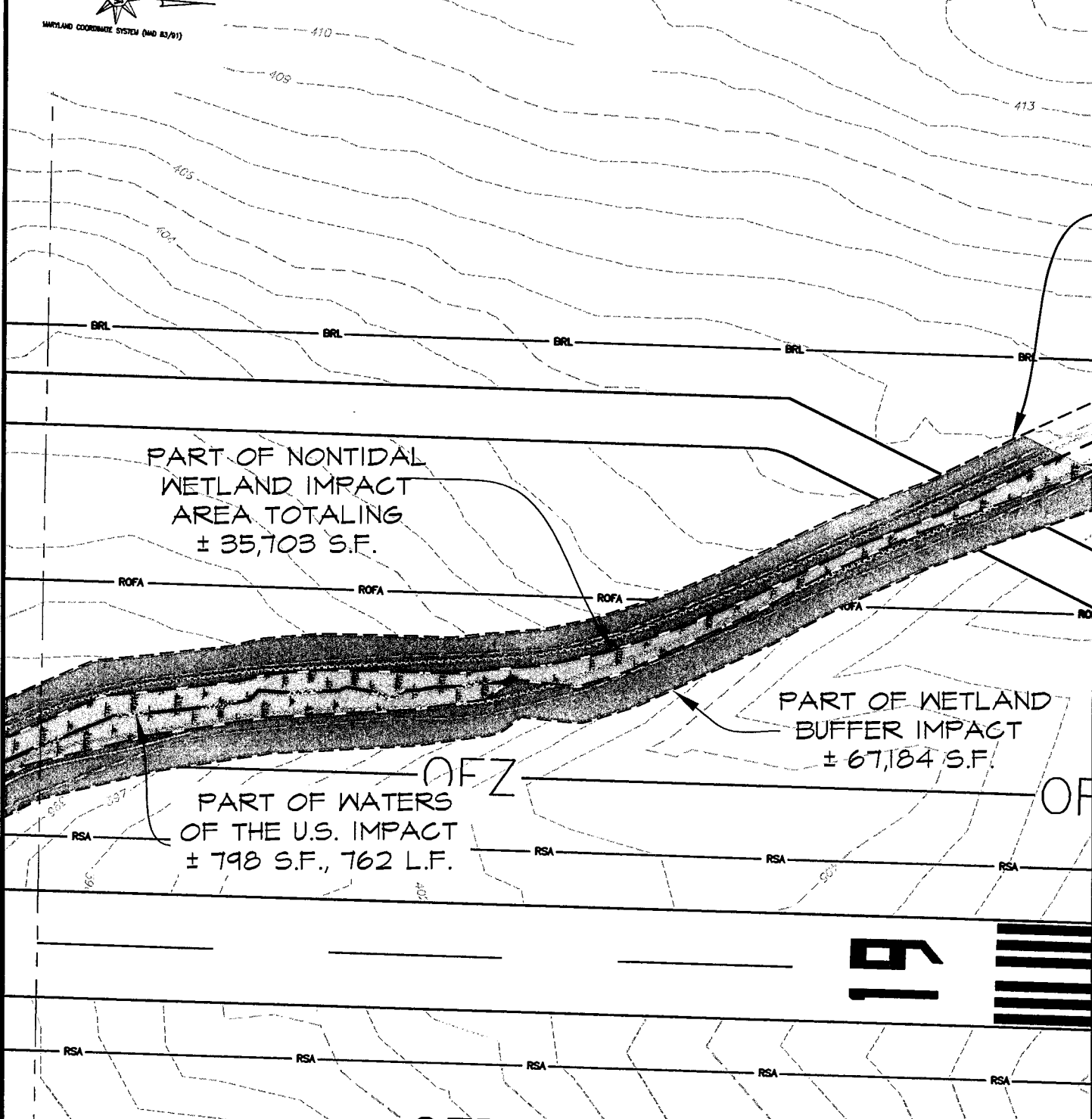
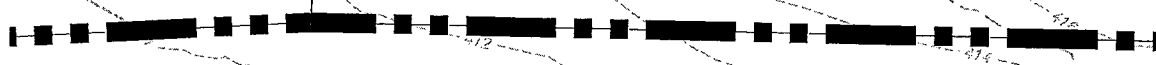

PART OF NONTIDAL WETLAND IMPACT AREA TOTALING ± 35,703 S.F.

PART OF WETLAND BUFFER IMPACT ± 67,184 S.F.

PART OF WATERS OF THE U.S. IMPACT ± 798 S.F., 762 L.F.



CNA

engineers, surveyors & landscape architects

Civil Engineers • Land Surveyors • Landscape Architects
Planners • Geotechnical Engineers • Environmental Engineers
215 Bynum Road
Forest Hill, Maryland 21050
Phone (410) 879-7200 • Fax (410) 838-1811
E-mail: cnamail@cna-engineers.com

IMPACT PLATE 4 FOR HARFORD COUNTY AIRPORT

2nd ELECTION DISTRICT		HARFORD COUNTY	
Drawn: MWD	Date: 05/10/13	Scale: 1"=100'	Job No: 11021

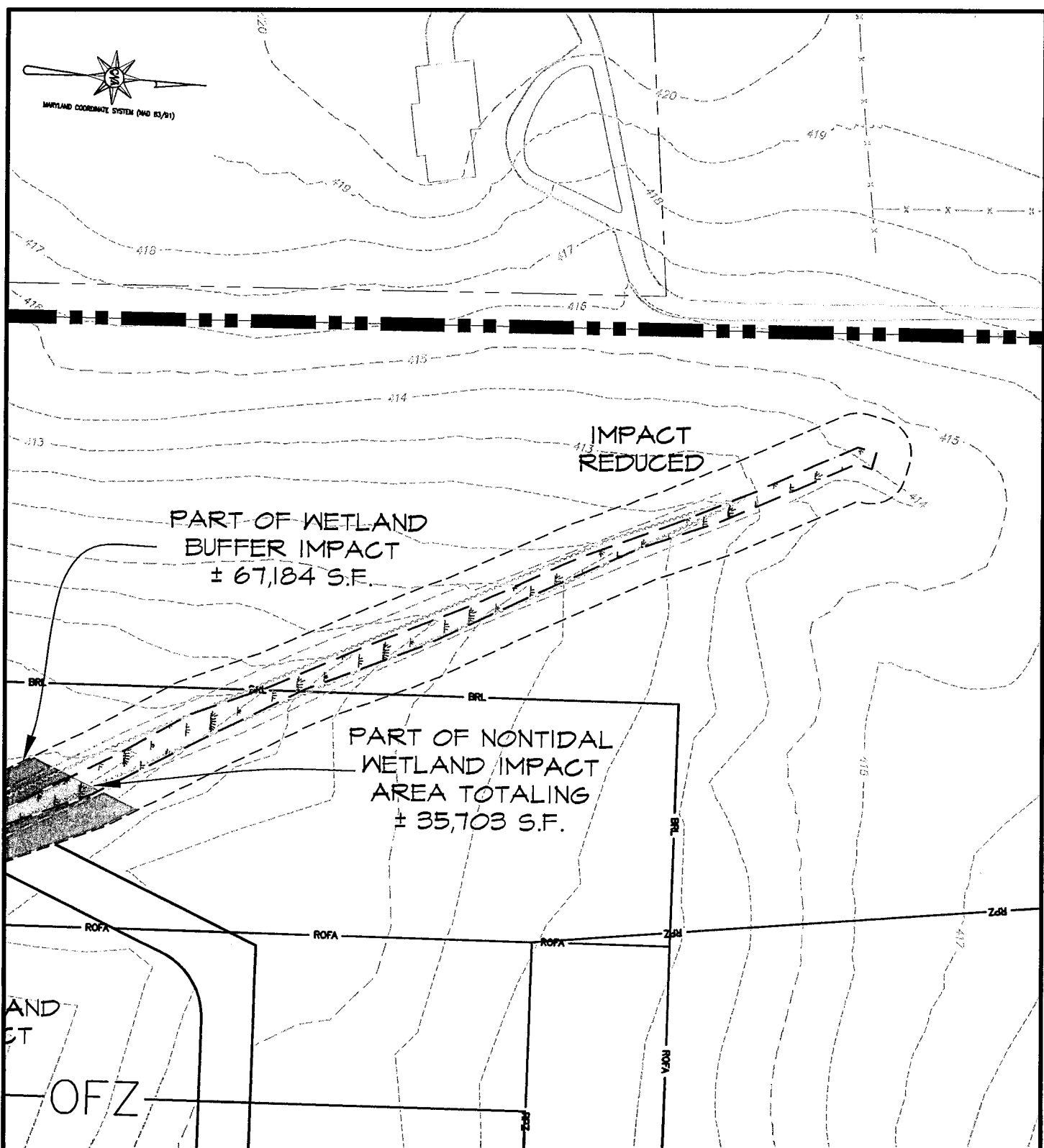

CNA
 engineers, surveyors & landscape architects

Civil Engineers • Land Surveyors • Landscape Architects
 Planners • Geotechnical Engineers • Environmental Engineers
 215 Bynum Road
 Forest Hill, Maryland 21050
 Phone (410) 879-7200 • Fax (410) 838-1811
 E-mail: cnamail@cna-engineers.com

IMPACT PLATE 5
 FOR
**HARFORD COUNTY
 AIRPORT**

2nd ELECTION DISTRICT		HARFORD COUNTY	
Drawn: MWD	Date: 05/10/13	Scale: 1"=100'	Job No: 11021

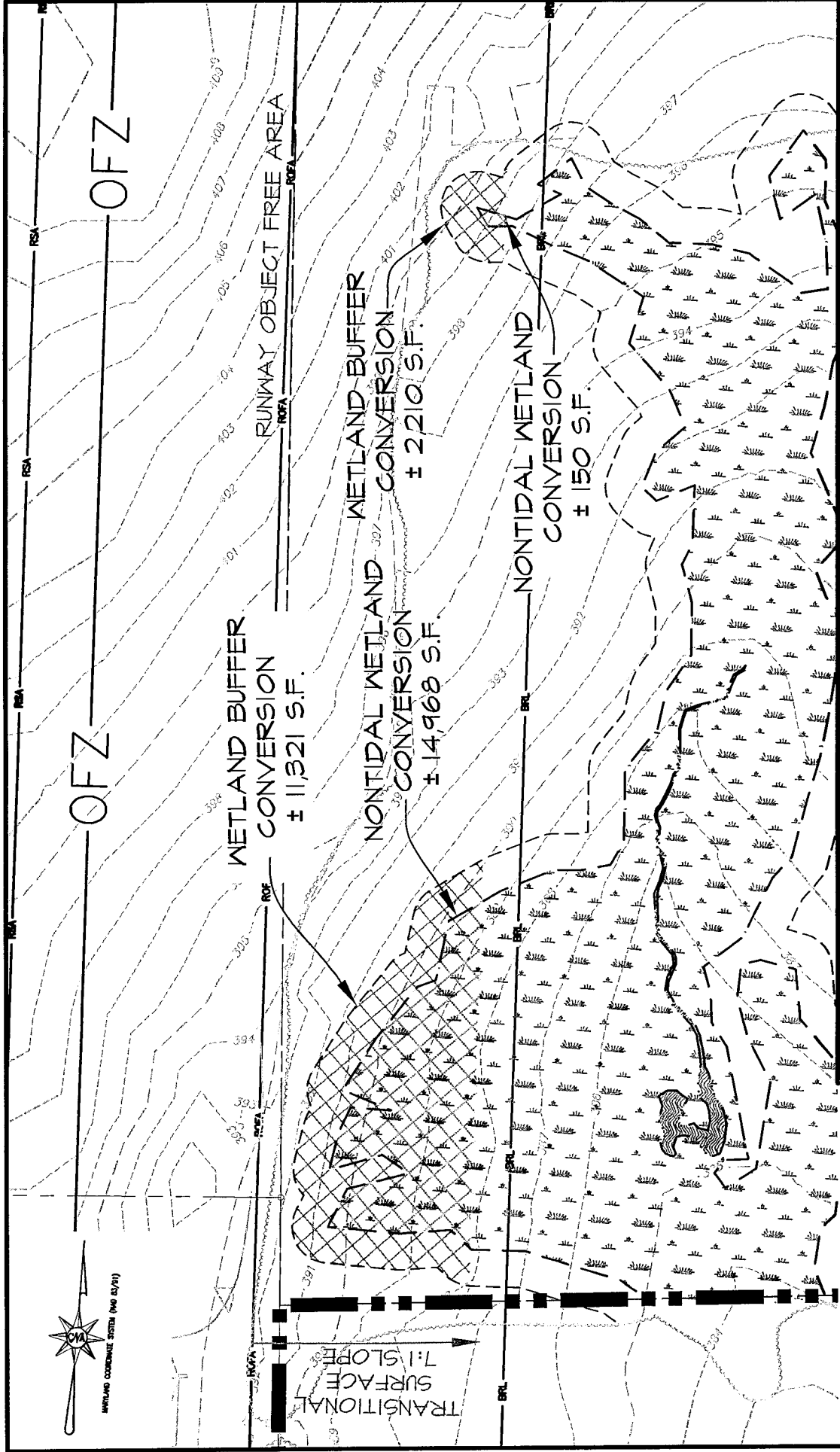

CNA
 engineers, surveyors & landscape architects

Civil Engineers • Land Surveyors • Landscape Architects
 Planners • Geotechnical Engineers • Environmental Engineers
 215 Bynum Road
 Forest Hill, Maryland 21050
 Phone (410) 879-7200 • Fax (410) 838-1811
 E-mail: cnamail@cna-engineers.com

IMPACT PLATE 6
 FOR
**HARFORD COUNTY
 AIRPORT**

2nd ELECTION DISTRICT HARFORD COUNTY

Drawn: MWD Date: 05/10/13 Scale: 1"=100' Job No: 11021

AI: 105144, Harford County Airport 13-NT-0080/201360337

Avoidance & Minimization Comparison Table

IMPACT TYPE	CONCEPT 1 Preliminary Concept	CONCEPT 2 Original Submittal	CONCEPT 3 April 2013 Submittal	CONCEPT 4 May 2013 Submittal
PERMANENT NONTIDAL WETLAND				
Impact Area (S.F.)	157,262	56,831	44,935	35,703
Impact Area (Acres)	3.61	1.30	1.03	0.82
PERMANENT WETLAND BUFFER				
Impact Area (S.F.)	122,412	121,100	107,854	68,086
Impact Area (Acres)	2.81	2.78	2.48	1.56
PERMANENT WATERS OF THE U.S.				
Impact Area (S.F.)	2,472	957	919	798
Impact Area (Acres)	0.06	0.02	0.02	0.02
Impact Length (L.F.)	500	897	883	762
NONTIDAL WETLAND CONVERSION				
Impact Area (S.F.)	7,649	15,118	15,118	15,118
Impact Area (Acres)	0.18	0.35	0.35	0.35
TEMPORARY WETLAND BUFFER				
Impact Area (S.F.)	5,429	13,531	13,531	13,531
Impact Area (Acres)	0.12	0.31	0.31	0.31
OPEN WATERS OF THE U.S. CONVERSION				
Impact Area (S.F.)	132	0	0	0
Impact Area (Acres)	0.00	0.00	0.00	0.00
Impact Length (L.F.)	127	0	0	0

AS CONTO SYSTEM AND 8/4/11

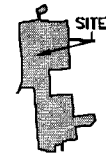
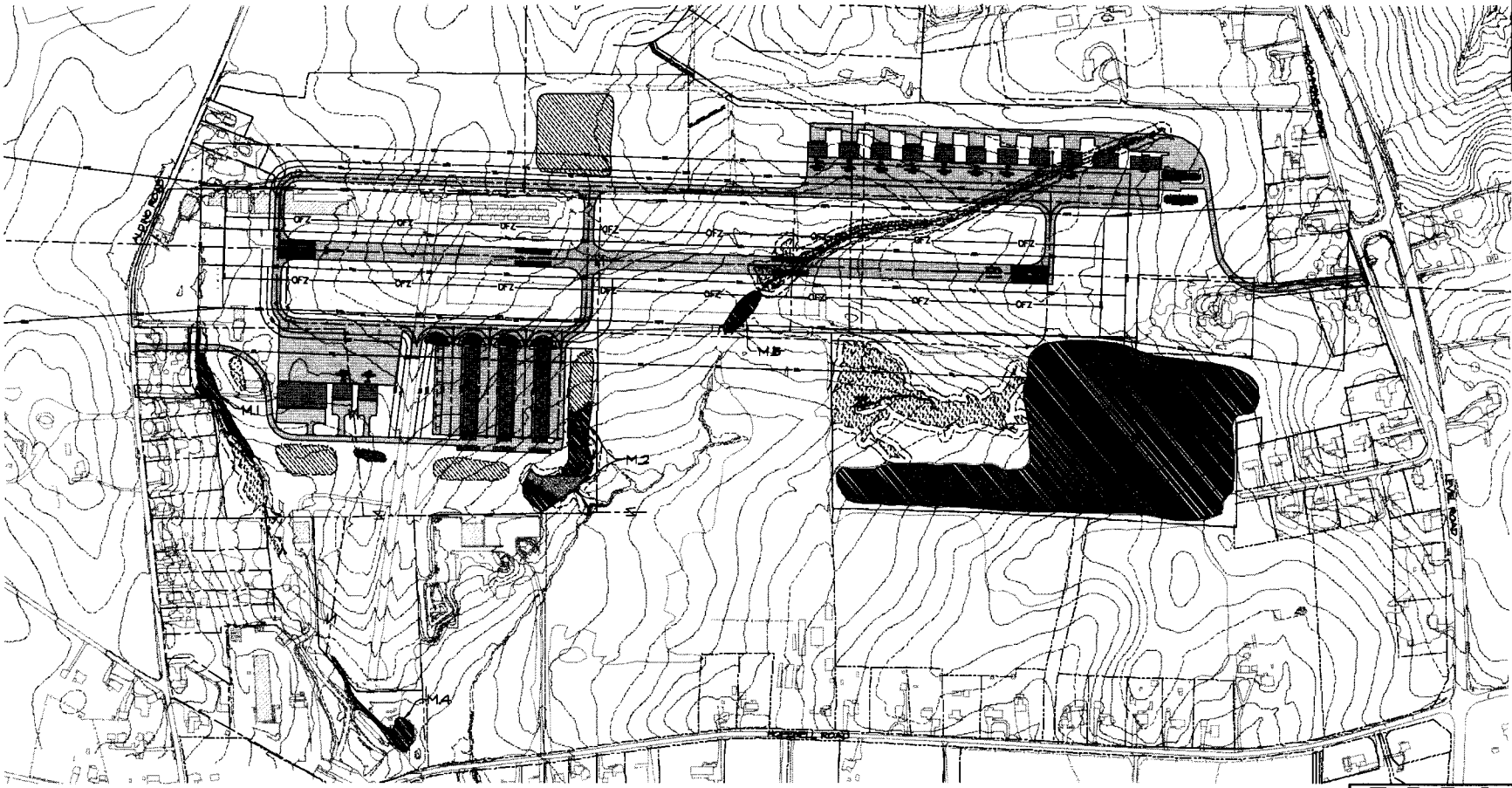

COPYRIGHT AND THE MAP PEOPLE
PERMITTED USE No. 21004231

LOCATION MAP

SCALE 1"=500'

LEGEND

-  RESTORATION/CREATION
-  ENHANCEMENT

CNA Civil Engineers & Land Surveyors & Landscape Architects
 Planners & Geotechnical Engineers & Environmental Engineers
 218 South Road
 P.O. Box 146, Meriden 03450
 Phone (603) 875-7200 or Fax (603) 882-1811
 C-NAE 00000001-00000000

CONCEPT PHASE I MITIGATION EXHIBIT
 FOR
HARFORD COUNTY AIRPORT
 3538 ALDINO ROAD

Date	Revisions	Date:	Scale:
		03/27/2013	NIS
		Drawn By:	Job No:
		Designed By:	11021
		Reviewed By:	Street:
		1 of 1	