



U.S. Army Corps
of Engineers
Baltimore District

Public Notice

In Reply to Application Number
CENAB-OP-RMN(MD SHA/MD 4 at Suitland Parkway)
2007-08551-M15

PN 14-41

Comment Period: July 15, 2014 to August 13, 2014

THE PURPOSE OF THIS PUBLIC NOTICE IS TO SOLICIT COMMENTS FROM THE PUBLIC ABOUT THE WORK DESCRIBED BELOW. AT THIS TIME, NO DECISION HAS BEEN MADE AS TO WHETHER OR NOT A PERMIT WILL BE ISSUED.

The Baltimore District has received an application for a Department of the Army Permit pursuant to Section 404 of the Clean Water Act (33 U.S.C. 1344), as described below:

APPLICANT: Mr. Todd Nichols
Maryland State Highway Administration
707 N. Calvert Street C-303
Baltimore, Maryland 21202

LOCATION AND WATERWAY: Unnamed tributaries, and adjacent wetlands, to Cabin Branch at the MD 4 and Suitland Parkway Interchange and unnamed tributaries, and adjacent wetlands, to Southwestern Branch. The proposed compensatory mitigation is located in Melwood and District Heights, respectively, in Prince George's County, Maryland.

WORK: Maryland State Highway Administration proposes to construct a new diamond interchange with directional ramp at the existing MD 4/Suitland Parkway interchange. MD 4 will be lowered beneath Suitland Parkway as part of the interchange construction. The roadway improvements also include the relocation of utilities, roadway widening, and construction of acceleration/deceleration lanes. The proposed roadway improvement will permanently impact approximately 2,542 linear feet (25,849 square feet) of stream channel and 2,886 square feet of nontidal wetland and temporarily impact approximately 383 linear feet (4,867 square feet) of stream channel and 56,359 square feet of nontidal wetlands. Compensatory mitigation for the project consists of wetland and stream restoration of approximately 1,688 linear feet of stream along Marbury Drive in District Heights, MD. The restoration activities include realigning the stream away from infrastructure, installing riffle grade controls and stormwater treatment bars, and establishing a vegetated stream/wetland buffer. The Marbury Drive wetland and stream restoration will permanently impact approximately 1,688 linear feet (48,069 square feet) of stream and 963 square feet of nontidal wetland.

All work is to be completed in accordance with the enclosed plan(s). If you have any questions concerning this matter, please contact Mr. Jack Dinne of this office at (410) 962-6005 or john.j.dinne@usace.army.mil.

The decision whether to issue a permit will be based on an evaluation of the probable impact including cumulative impacts of the proposed activity on the public interest. That decision will reflect the national concern for both protection and utilization of important resources. The benefit which reasonably may be expected to accrue from the proposal must be balanced against its reasonably foreseeable detriments. All factors which may be relevant to the proposal will be considered including the cumulative effects thereof; among those are conservation, economics, aesthetics, general environmental concerns, wetlands, cultural values, fish and wildlife values, flood hazards, flood plain values, land use, navigation, shoreline erosion and accretion, recreation, water supply and conservation, water quality, energy needs, safety, food and fiber production, and, in general, the needs and welfare of the people.

The evaluation of the impact of the work described above on the public interest will include application of the Clean Water Act, Section 404 (b)(1) Guidelines promulgated by the Administrator, U.S. Environmental Protection Agency, under authority of Section 404 of the Clean Water Act.

The Corps of Engineers is soliciting comments from the public; Federal, State, and local agencies and officials: Indian Tribes; and other interested parties in order to consider and evaluate the impacts of this proposed activity. Any comments received will be considered by the Corps of Engineers to determine whether to issue, modify, condition or deny a permit for this proposal. To make this decision, comments are used to assess impacts on endangered species, historic properties, water quality, general environmental effects, and the other public interest factors listed above. Comments are used in the preparation of an Environmental Assessment and/or an Environmental Impact Statement pursuant to the National Environmental Policy Act. Comments are also used to determine the need for a public hearing and to determine the overall public interest of the proposed activity.

Written comments concerning the work described above related to the factors listed above or other pertinent factors must be received by the District Engineer, U.S. Army Corps of Engineers, Baltimore District, [Attn: Mr. Jack Dinne, CENAB-OP-RMN], P.O. Box 1715, Baltimore, Maryland 21203-1715, within the comment period as specified above to receive consideration.

SECTION 401 WATER QUALITY CERTIFICATION: The applicant is required to obtain a water quality certification in accordance with Section 401 of the Clean Water Act from the Maryland Department of the Environment. Any written comments concerning the work described above which relate to water quality certification must be received by the Maryland Department of the Environment, Non-Tidal Wetlands and Waterways Program, Montgomery Park Business Center, 1800 Washington Boulevard, Suite 430, Baltimore, Maryland 21230-1708 within the comment period as specified above to receive consideration. The 401 certifying agency has a statutory limit of one year to make its decision.

COASTAL ZONE MANAGEMENT PROGRAMS: Where applicable, the applicant has certified in this application that the proposed activity complies with and will be conducted in a manner consistent with the Coastal Zone Management (CZM) Program. By this public notice, we are requesting the State concurrence or objection to the applicant's consistency statement. It should be noted that the CZM Program has a statutory limit of 6 months to make its consistency determination.

The applicant must obtain any State or local government permits, which may be required.

A preliminary review of this application indicates that the proposed work will not affect listed species or their critical habitat pursuant to Section 7 of the Endangered Species Act as amended. As the evaluation of this application continues, additional information may become available which could modify this preliminary determination.

Review of the latest published version of the National Register of Historic Places indicates that no registered properties listed as eligible for inclusion therein are located at the site of the proposed work. Currently unknown archeological, scientific, prehistoric, or historical data may be lost or destroyed by the work to be accomplished under the requested permit.

Any person who has an interest which may be adversely affected by the issuance of this permit may request a public hearing. The request, which must be in writing, must be received by the District Engineer, U.S. Army Corps of Engineers, Baltimore District, [Attn: Mr. Jack Dinne, CENAB-OP-RMN], P.O. Box 1715, Baltimore, Maryland 21203-1715, within the comment period as specified as above to receive consideration. Also, it must clearly state forth the interest which may be adversely affected by this activity in the manner in which the interest may be adversely affected.

It is requested that you communicate the foregoing information concerning the proposed work to any persons known by you to be interested and not being known to this office, who did not receive a copy of this notice.

FOR THE DISTRICT ENGINEER:

Joseph P. DaVia
Chief, Maryland Section Northern

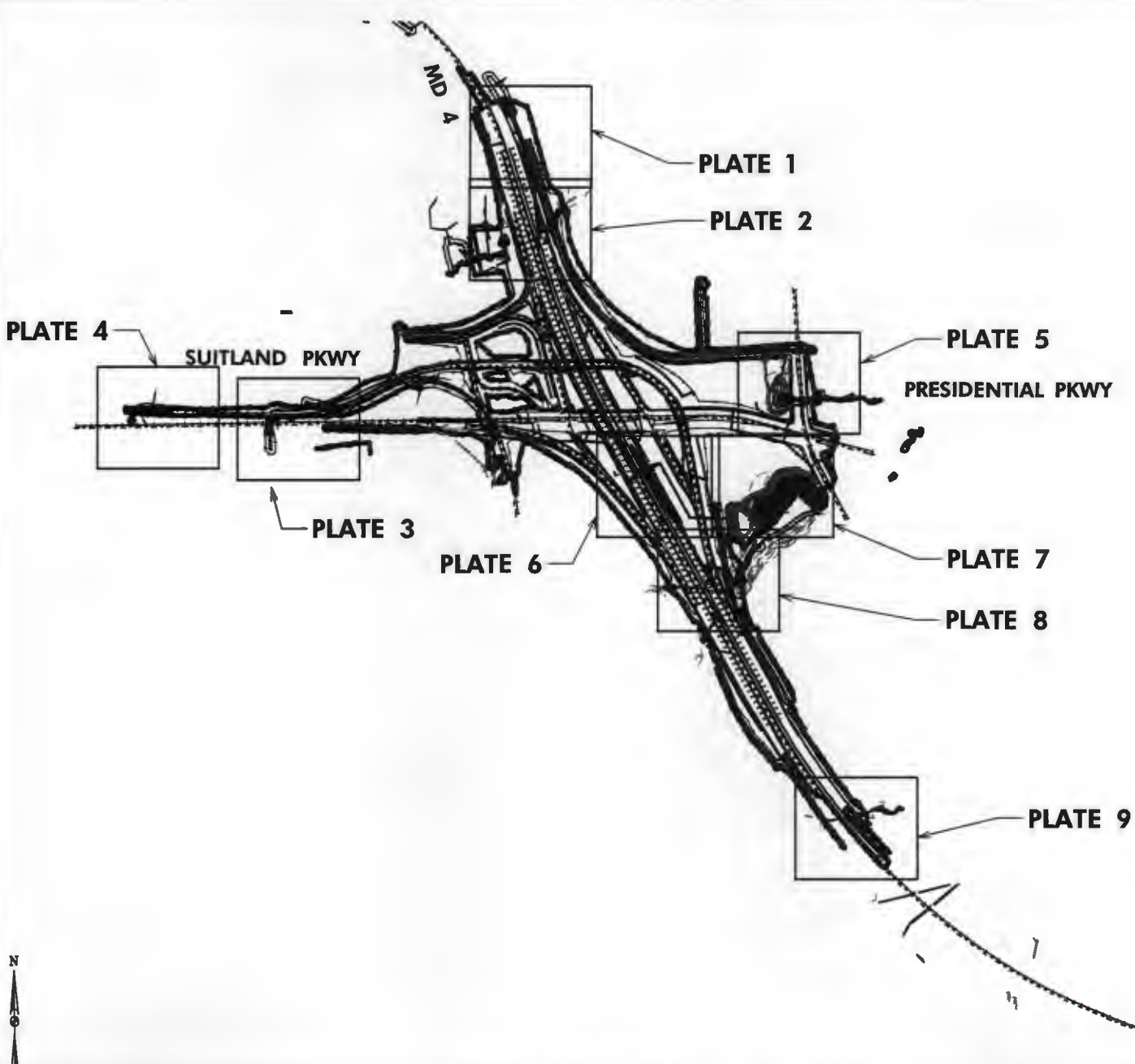

25' WETLAND BUFFER		LEGEND	WATERS OF THE U.S.	
WETLAND BOUNDARY			LIMITS OF DISTURBANCE	
			LIMIT OF GRADING	

WETLAND IMPACTS	
	TEMPORARY WETLAND IMPACTS = 56,267 SF
	PERMANENT WETLAND IMPACTS = 2,867 SF
WATERS OF THE US (WUS) IMPACTS	
	TEMPORARY WUS IMPACTS = 252 LF / 3,967 SF
	PERMANENT WUS IMPACTS = 2,502 LF / 25,634 SF

25' WETLAND BUFFER IMPACTS	
	TEMPORARY 25' WETLAND BUFFER IMPACTS = 28,476 SF
	PERMANENT 25' WETLAND BUFFER IMPACTS = 23,804 SF

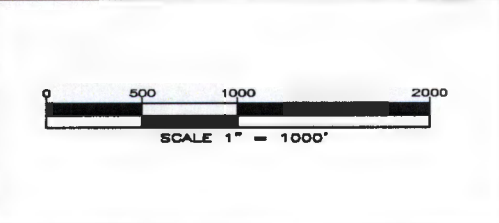

MD 4/SUITLAND PARKWAY INTERCHANGE

CONTRACT NO.: PG618C21/PG618E21
 COUNTY: PRINCE GEORGE'S
 APPLICATION BY: MARYLAND STATE HIGHWAY ADMINISTRATION

INDEX PLATE
 MAY 2014

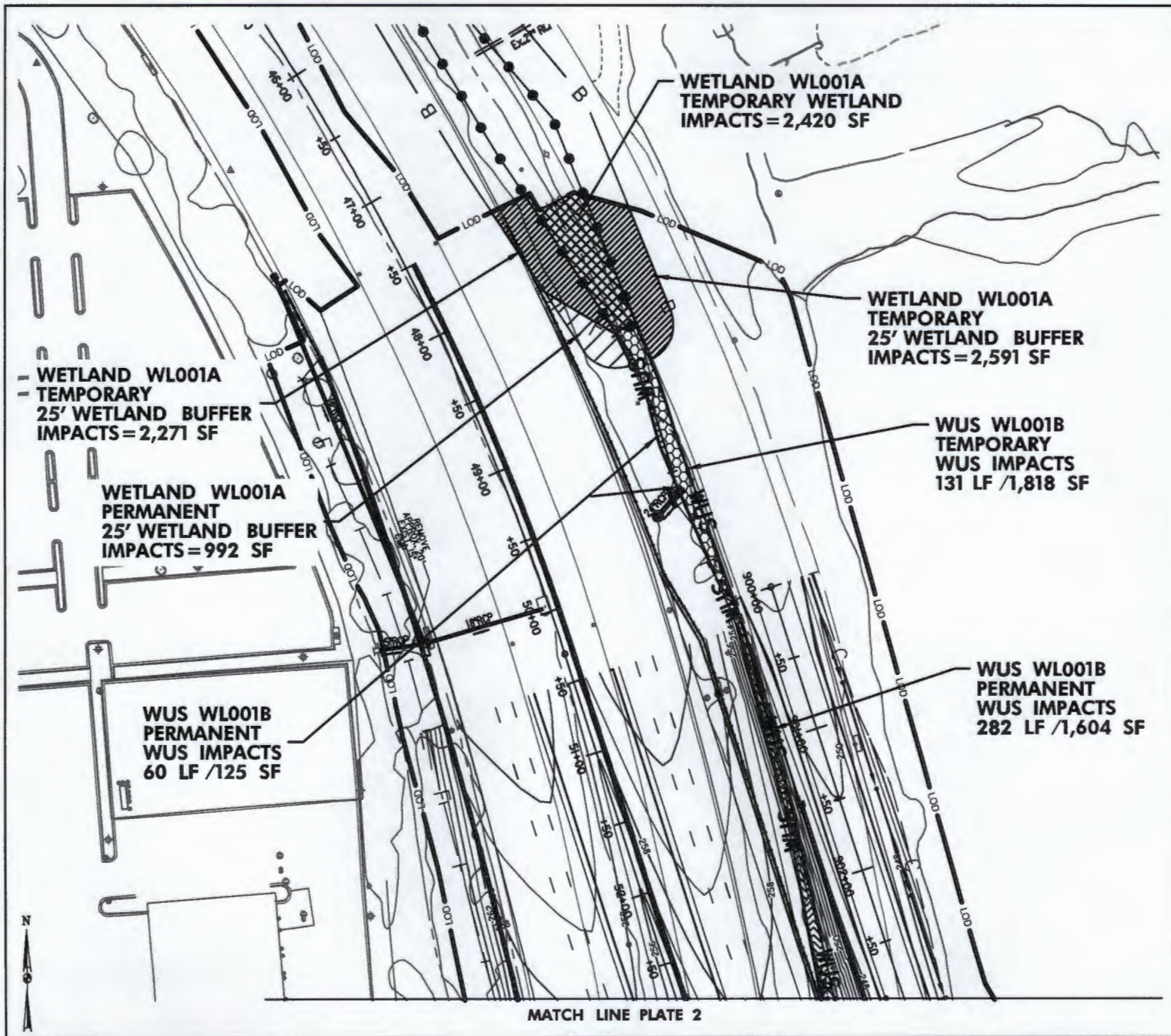

MATCH LINE PLATE 2

25' WETLAND BUFFER	— B — B —	LEGEND	WATERS OF THE U.S.	— WUS — WUS —
WETLAND BOUNDARY	— ● — ● —		LIMITS OF DISTURBANCE	— LOD — LOD —
			LIMIT OF GRADING	— F — C —

WETLAND IMPACTS	
	TEMPORARY WETLAND IMPACTS = 2,420 SF
	PERMANENT WETLAND IMPACTS = 0 SF

25' WETLAND BUFFER IMPACTS	
	TEMPORARY 25' WETLAND BUFFER IMPACTS = 4,862 SF
	PERMANENT 25' WETLAND BUFFER IMPACTS = 992 SF

WATERS OF THE US (WUS) IMPACTS	
	TEMPORARY WUS IMPACTS = 131 LF / 1,818 SF
	PERMANENT WUS IMPACTS = 342 LF / 1,729 SF

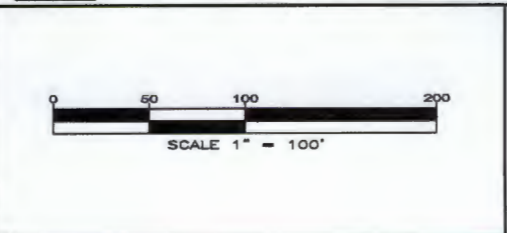

MD 4/SUITLAND PARKWAY INTERCHANGE

CONTRACT NO.: PG618C21/PG618E21
 COUNTY: PRINCE GEORGE'S
 APPLICATION BY: MARYLAND STATE HIGHWAY ADMINISTRATION

PLATE 1
 MAY 2014

MATCH LINE PLATE 1

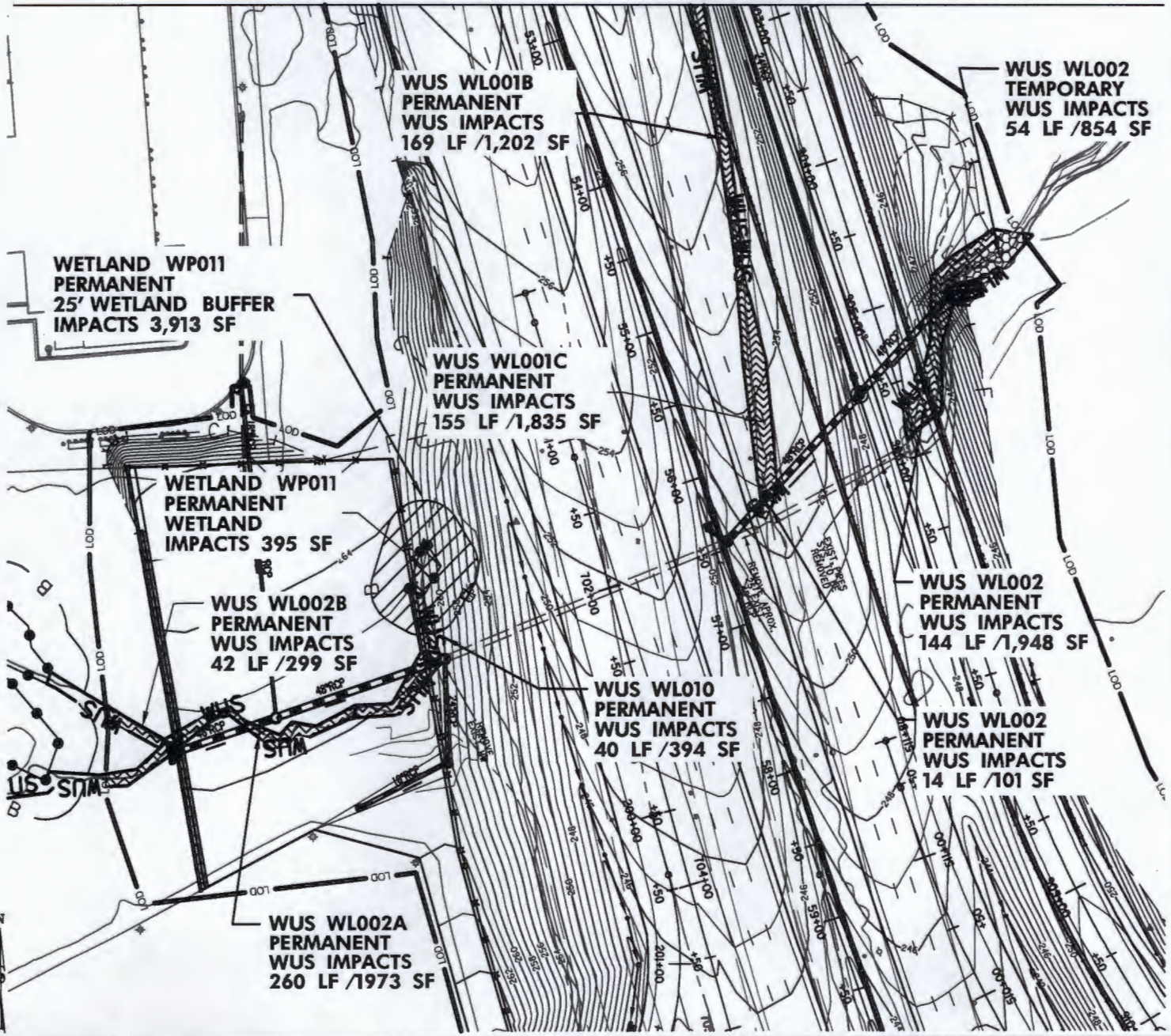

**WETLAND WP011
PERMANENT
25' WETLAND BUFFER
IMPACTS 3,913 SF**

**WUS WL001B
PERMANENT
WUS IMPACTS
169 LF /1,202 SF**

**WUS WL002
TEMPORARY
WUS IMPACTS
54 LF /854 SF**

**WUS WL001C
PERMANENT
WUS IMPACTS
155 LF /1,835 SF**

**WETLAND WP011
PERMANENT
WETLAND
IMPACTS 395 SF**

**WUS WL002B
PERMANENT
WUS IMPACTS
42 LF /299 SF**

**WUS WL002
PERMANENT
WUS IMPACTS
144 LF /1,948 SF**

**WUS WL010
PERMANENT
WUS IMPACTS
40 LF /394 SF**

**WUS WL002
PERMANENT
WUS IMPACTS
14 LF /101 SF**

**WUS WL002A
PERMANENT
WUS IMPACTS
260 LF /1,973 SF**

LEGEND

25' WETLAND BUFFER
WETLAND BOUNDARY



WATERS OF THE U.S.
LIMITS OF DISTURBANCE
LIMIT OF GRADING

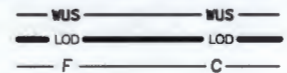

WETLAND IMPACTS

- TEMPORARY WETLAND IMPACTS = 0
- PERMANENT WETLAND IMPACTS = 395 SF

25' WETLAND BUFFER IMPACTS

- TEMPORARY 25' WETLAND BUFFER IMPACTS = 0
- PERMANENT 25' WETLAND BUFFER IMPACTS = 3,913 SF

WATERS OF THE US (WUS) IMPACTS

- TEMPORARY WUS IMPACTS = 54 LF / 854 SF
- PERMANENT WUS IMPACTS = 824 LF / 7,752 SF

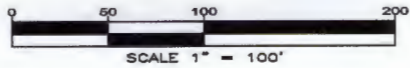

**MD 4/SUITLAND PARKWAY
INTERCHANGE**

CONTRACT NO.: PG618C21/PG618E21
COUNTY: PRINCE GEORGE'S
APPLICATION BY: MARYLAND STATE HIGHWAY
ADMINISTRATION

PLATE 2
MAY 2014

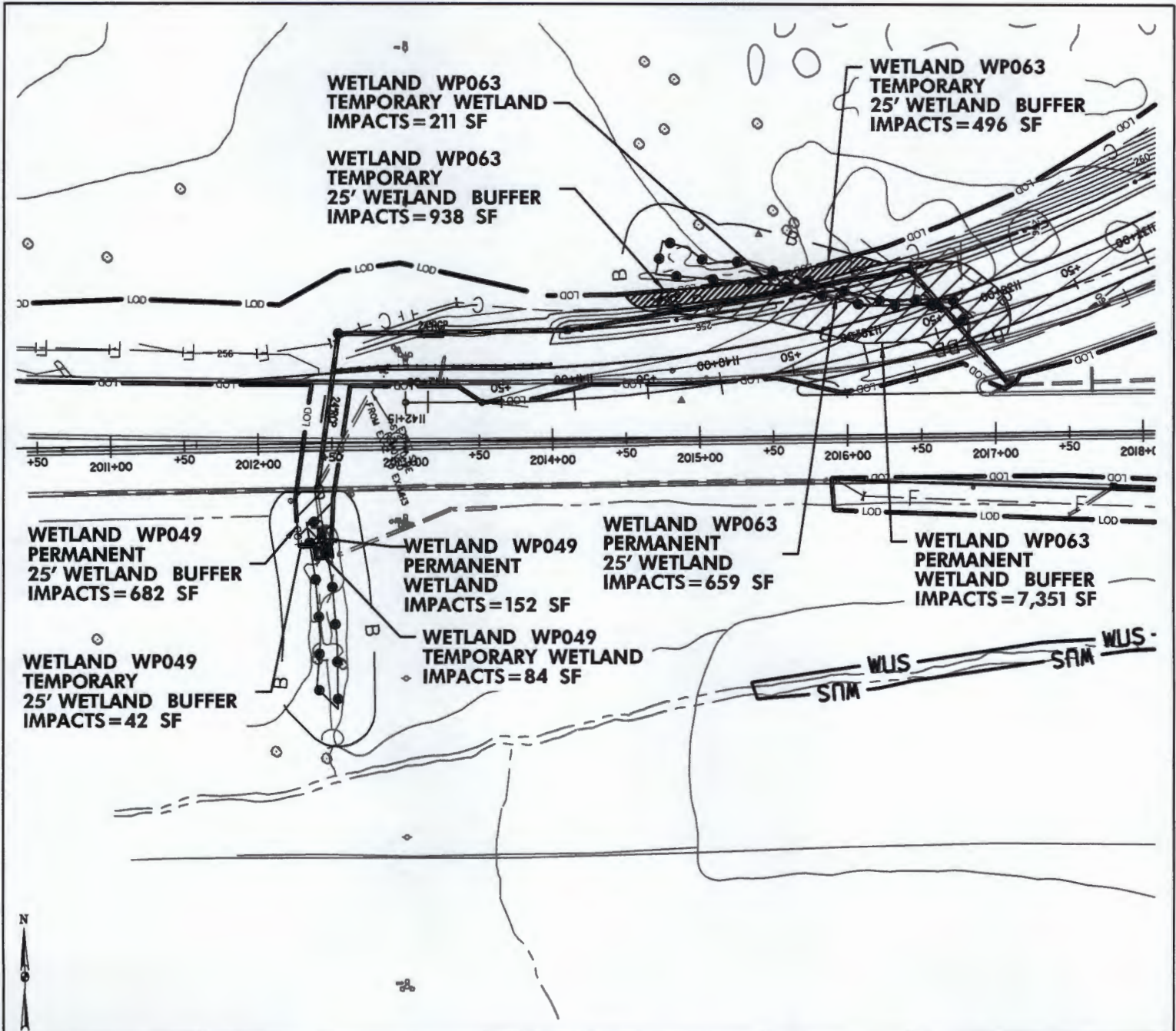

25' WETLAND BUFFER
WETLAND BOUNDARY



LEGEND

WATERS OF THE U.S.
LIMITS OF DISTURBANCE
LIMIT OF GRADING

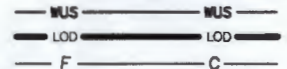

WETLAND IMPACTS

	TEMPORARY WETLAND IMPACTS = 295 SF
	PERMANENT WETLAND IMPACTS = 811 SF

25' WETLAND BUFFER IMPACTS

	TEMPORARY 25' WETLAND BUFFER IMPACTS = 1,476 SF
	PERMANENT 25' WETLAND BUFFER IMPACTS = 8,033 SF

WATERS OF THE US (WUS) IMPACTS

	TEMPORARY WUS IMPACTS = 0
	PERMANENT WUS IMPACTS = 0

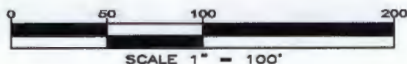

MD 4/SUITLAND PARKWAY INTERCHANGE

CONTRACT NO.: PG618C21/PG618E21
 COUNTY: PRINCE GEORGE'S
 APPLICATION BY: MARYLAND STATE HIGHWAY ADMINISTRATION

PLATE 3
 MAY 2014

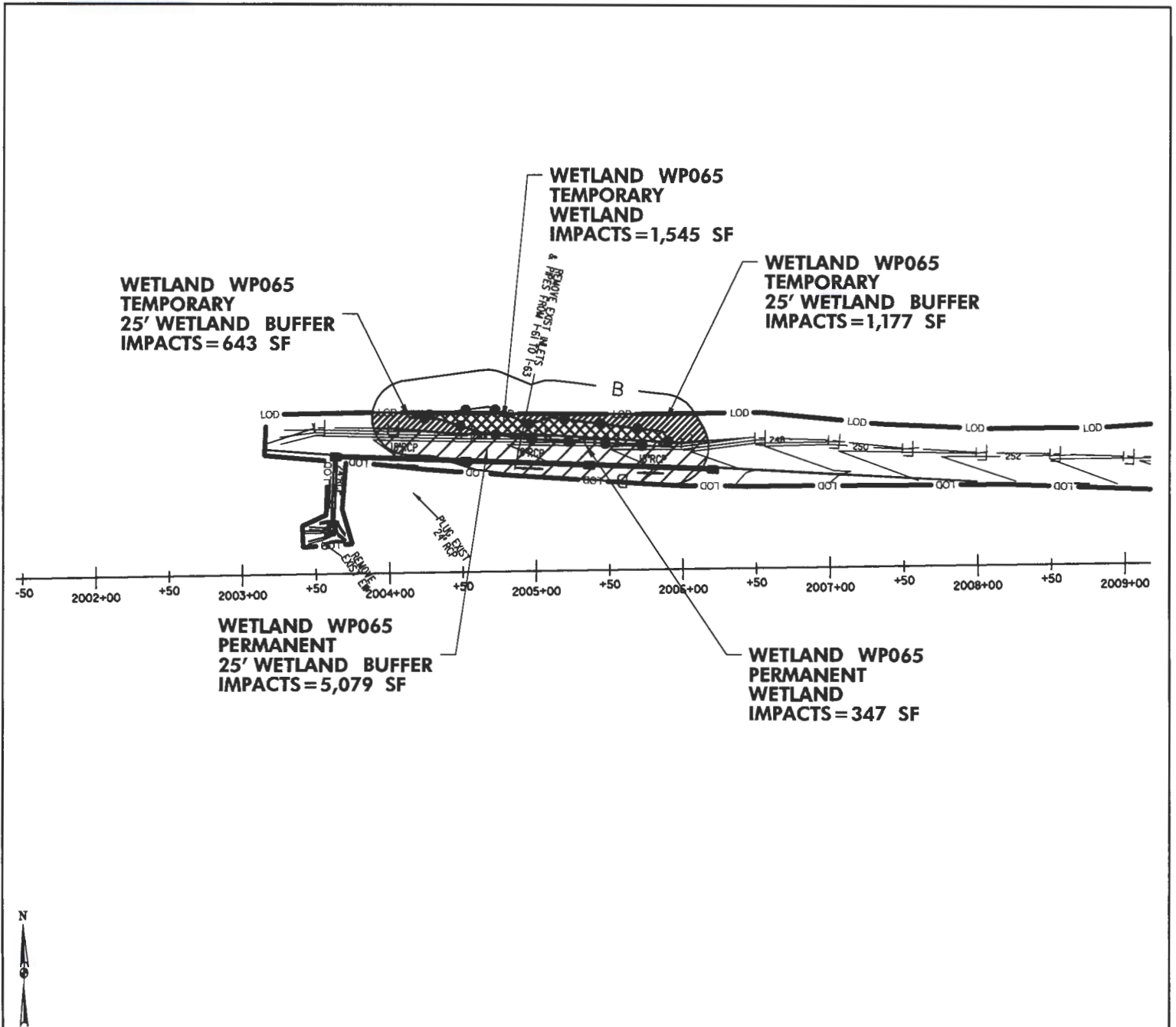

WETLAND WP065
 TEMPORARY
 WETLAND
 IMPACTS=1,545 SF

WETLAND WP065
 TEMPORARY
 25' WETLAND BUFFER
 IMPACTS=643 SF

WETLAND WP065
 TEMPORARY
 25' WETLAND BUFFER
 IMPACTS=1,177 SF

WETLAND WP065
 PERMANENT
 25' WETLAND BUFFER
 IMPACTS=5,079 SF

WETLAND WP065
 PERMANENT
 WETLAND
 IMPACTS=347 SF



LEGEND

25' WETLAND BUFFER	— B — B —	WATERS OF THE U.S.	— WUS — WUS —
WETLAND BOUNDARY	— ● — ● —	LIMITS OF DISTURBANCE	— LOD — LOD —
		LIMIT OF GRADING	— F — C —

WETLAND IMPACTS TEMPORARY WETLAND IMPACTS = 1,545 SF PERMANENT WETLAND IMPACTS = 347 SF		25' WETLAND BUFFER IMPACTS TEMPORARY 25' WETLAND BUFFER IMPACTS = 1,820 SF PERMANENT 25' WETLAND BUFFER IMPACTS = 5,079 SF	
--	--	---	--

WATERS OF THE US (WUS) IMPACTS TEMPORARY WUS IMPACTS = 0 PERMANENT WUS IMPACTS = 0	
---	--

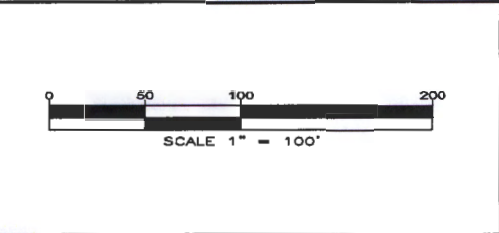

MD 4/SUITLAND PARKWAY INTERCHANGE

CONTRACT NO.: PG618C21/PG618E21
 COUNTY: PRINCE GEORGE'S
 APPLICATION BY: MARYLAND STATE HIGHWAY ADMINISTRATION

PLATE 4
 MAY 2014

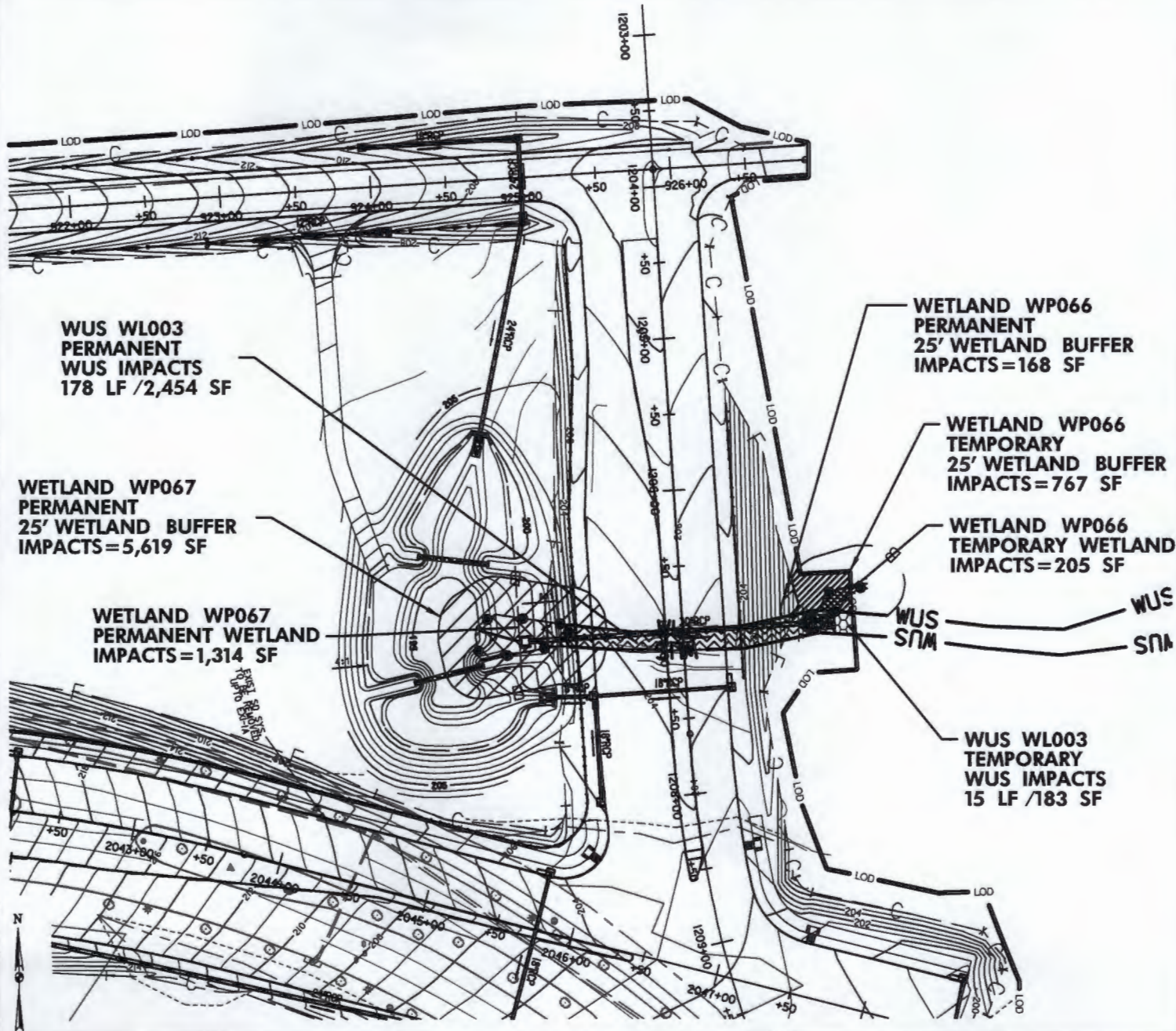

**WUS WL003
PERMANENT
WUS IMPACTS
178 LF / 2,454 SF**

**WETLAND WP067
PERMANENT
25' WETLAND BUFFER
IMPACTS=5,619 SF**

**WETLAND WP067
PERMANENT WETLAND
IMPACTS=1,314 SF**

**WETLAND WP066
PERMANENT
25' WETLAND BUFFER
IMPACTS=168 SF**

**WETLAND WP066
TEMPORARY
25' WETLAND BUFFER
IMPACTS=767 SF**

**WETLAND WP066
TEMPORARY WETLAND
IMPACTS=205 SF**

**WUS
SNM**

**WUS WL003
TEMPORARY
WUS IMPACTS
15 LF / 183 SF**

LEGEND

25' WETLAND BUFFER
WETLAND BOUNDARY

WATERS OF THE U.S.
LIMITS OF DISTURBANCE
LIMIT OF GRADING

WUS
LOD
F

WETLAND IMPACTS

- TEMPORARY WETLAND IMPACTS = 205 SF
- PERMANENT WETLAND IMPACTS = 1,314 SF

25' WETLAND BUFFER IMPACTS

- TEMPORARY 25' WETLAND BUFFER IMPACTS = 767 SF
- PERMANENT 25' WETLAND BUFFER IMPACTS = 5,787 SF

WATERS OF THE US (WUS) IMPACTS

- TEMPORARY WUS IMPACTS = 15 LF / 183 SF
- PERMANENT WUS IMPACTS = 178 LF / 2,454 SF

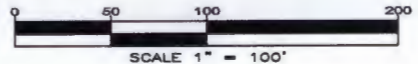

**MD 4/SUITLAND PARKWAY
INTERCHANGE**

CONTRACT NO.: PG618C21/PG618E21
COUNTY: PRINCE GEORGE'S
APPLICATION BY: MARYLAND STATE HIGHWAY
ADMINISTRATION

PLATE 5
MAY 2014

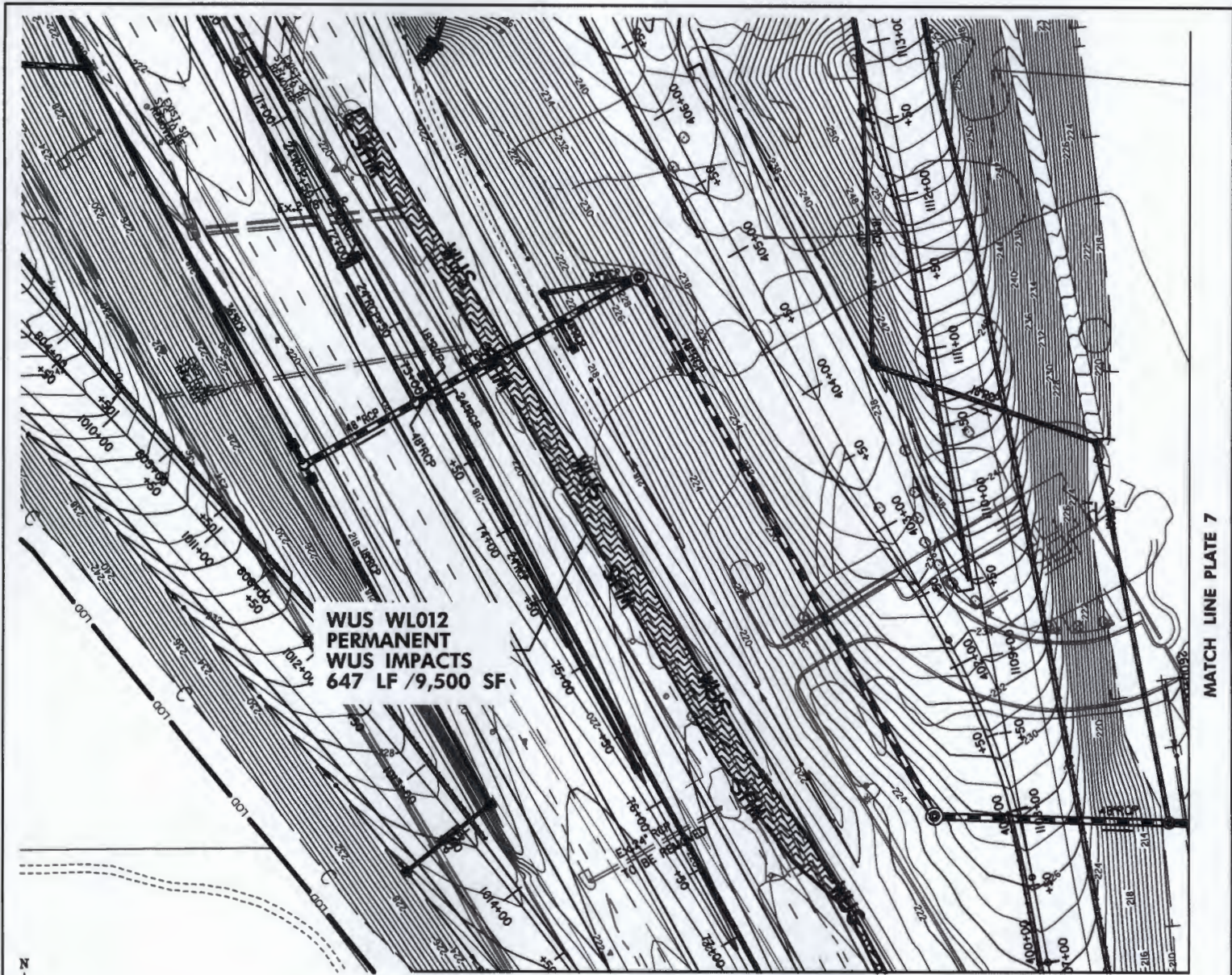

WUS WL012
 PERMANENT
 WUS IMPACTS
 647 LF / 9,500 SF

MATCH LINE PLATE 7

MATCH LINE PLATE 8



<p>25' WETLAND BUFFER WETLAND BOUNDARY</p> <p>— B — B — — ● — ● —</p>		<p>LEGEND</p>		<p>WATERS OF THE U.S. LIMITS OF DISTURBANCE LIMIT OF GRADING</p> <p>— WUS — WUS — — LOD — LOD — — F — C —</p>	
<p>WETLAND IMPACTS</p> <p>▨ TEMPORARY WETLAND IMPACTS = 0 ▩ PERMANENT WETLAND IMPACTS = 0</p>		<p>25' WETLAND BUFFER IMPACTS</p> <p>▨ TEMPORARY 25' WETLAND BUFFER IMPACTS = 0 ▩ PERMANENT 25' WETLAND BUFFER IMPACTS = 0</p>			
<p>WATERS OF THE US (WUS) IMPACTS</p> <p>▨ TEMPORARY WUS IMPACTS = 0 ▩ PERMANENT WUS IMPACTS = 647 LF / 9,500 SF</p>					

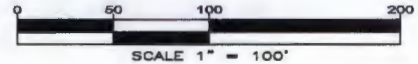

**MD 4/SUITLAND PARKWAY
 INTERCHANGE**

CONTRACT NO.: PG618C21/PG618E21
 COUNTY: PRINCE GEORGE'S
 APPLICATION BY: MARYLAND STATE HIGHWAY
 ADMINISTRATION

PLATE 6
 MAY 2014

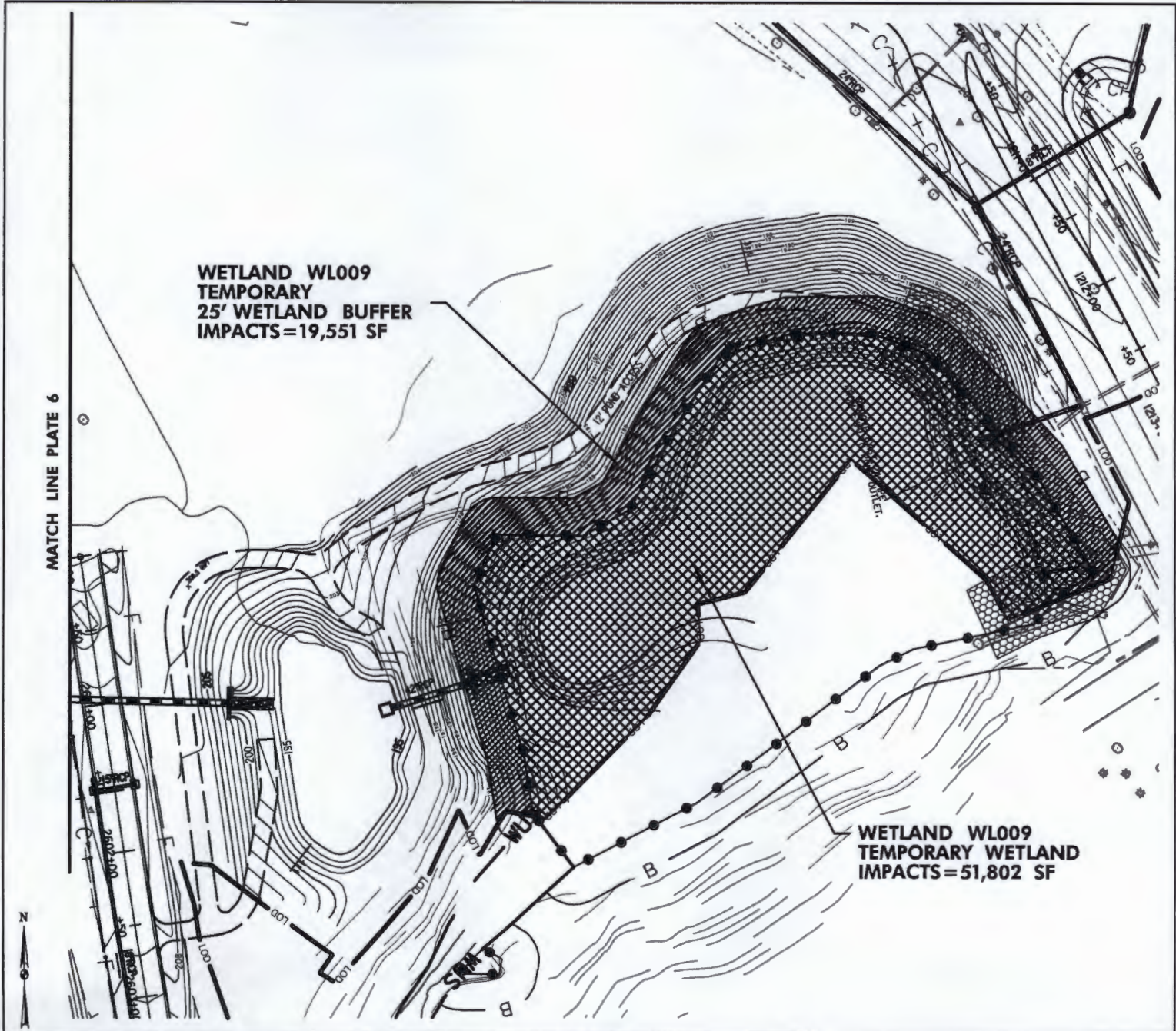

25' WETLAND BUFFER	— B — B —	LEGEND	WATERS OF THE U.S.	— WUS — WUS —
WETLAND BOUNDARY	— ● — ● —		LIMITS OF DISTURBANCE	— LOD — LOD —
			LIMIT OF GRADING	— F — C —

WETLAND IMPACTS	
	TEMPORARY WETLAND IMPACTS = 51,802 SF
	PERMANENT WETLAND IMPACTS = 0

25' WETLAND BUFFER IMPACTS	
	TEMPORARY 25' WETLAND BUFFER IMPACTS = 19,551 SF
	PERMANENT 25' WETLAND BUFFER IMPACTS = 0

WATERS OF THE US (WUS) IMPACTS	
	TEMPORARY WUS IMPACTS = 0
	PERMANENT WUS IMPACTS = 0

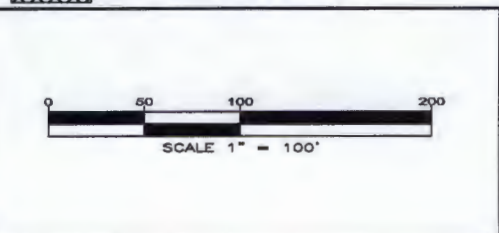

MD 4/SUITLAND PARKWAY INTERCHANGE

CONTRACT NO.: PG618C21/PG618E21
 COUNTY: PRINCE GEORGE'S
 APPLICATION BY: MARYLAND STATE HIGHWAY ADMINISTRATION

PLATE 7
 MAY 2014

MATCH LINE PLATE 6

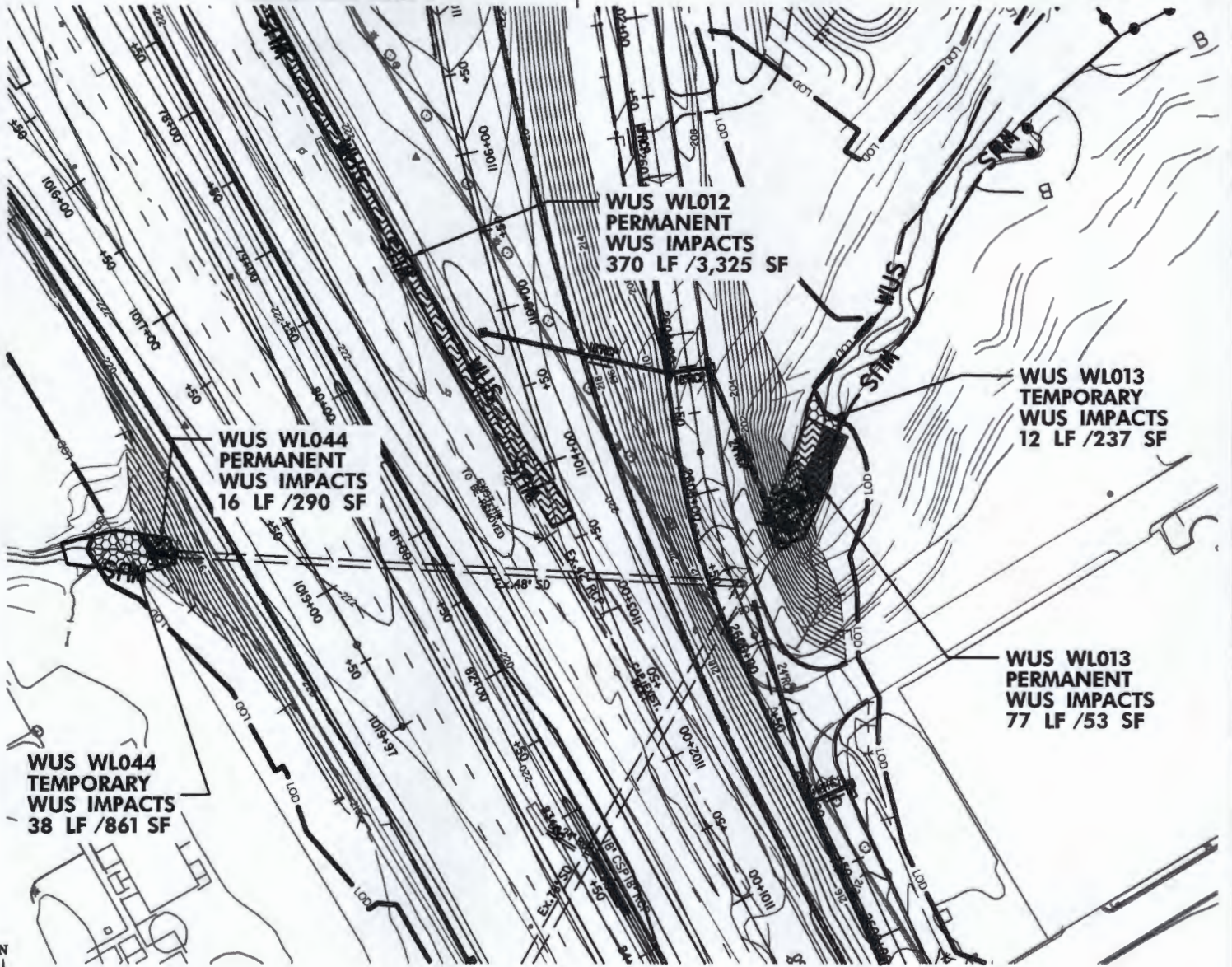

25' WETLAND BUFFER
WETLAND BOUNDARY



LEGEND

WATERS OF THE U.S.
LIMITS OF DISTURBANCE
LIMIT OF GRADING



WETLAND IMPACTS

- TEMPORARY WETLAND IMPACTS = 0
- PERMANENT WETLAND IMPACTS = 0

25' WETLAND BUFFER IMPACTS

- TEMPORARY 25' WETLAND BUFFER IMPACTS = 0
- PERMANENT 25' WETLAND BUFFER IMPACTS = 0

WATERS OF THE US (WUS) IMPACTS

- TEMPORARY WUS IMPACTS = 50 LF / 1,098 SF
- PERMANENT WUS IMPACTS = 463 LF / 3,668 SF

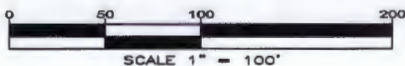

MD 4/SUITLAND PARKWAY INTERCHANGE

CONTRACT NO.: PG618C21/PG618E21
 COUNTY: PRINCE GEORGE'S
 APPLICATION BY: MARYLAND STATE HIGHWAY ADMINISTRATION

PLATE B
 MAY 2014

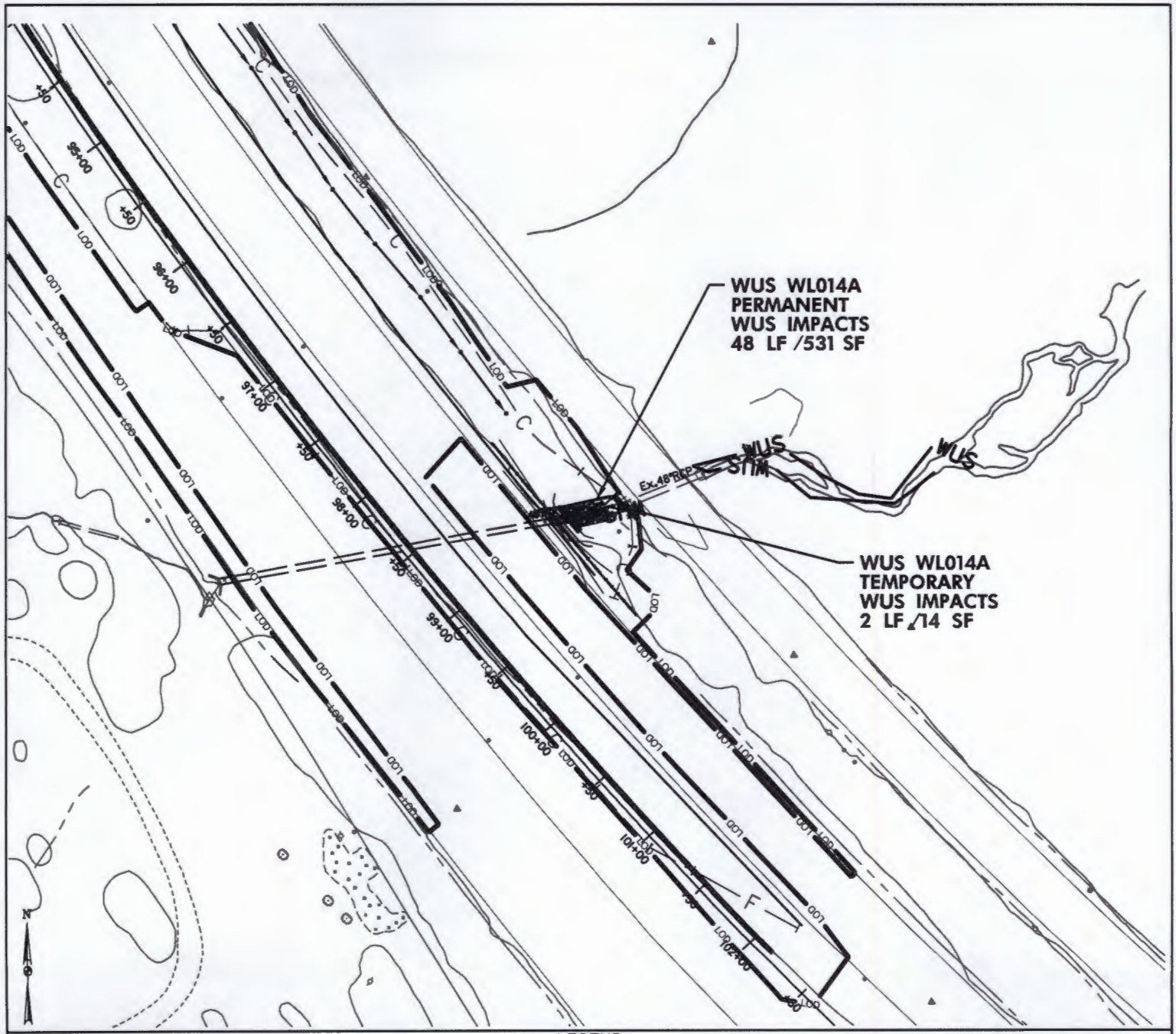

**WUS WL014A
PERMANENT
WUS IMPACTS
48 LF / 531 SF**

**WUS WL014A
TEMPORARY
WUS IMPACTS
2 LF / 14 SF**

25' WETLAND BUFFER	— B — B —	LEGEND	WATERS OF THE U.S.	— WUS —	— WUS —
WETLAND BOUNDARY	— ● — ● —		LIMITS OF DISTURBANCE	— LOD —	— LOD —
			LIMIT OF GRADING	— F —	— C —

WETLAND IMPACTS	
	TEMPORARY WETLAND IMPACTS = 0
	PERMANENT WETLAND IMPACTS = 0
WATERS OF THE US (WUS) IMPACTS	
	TEMPORARY WUS IMPACTS = 2 LF / 14 SF
	PERMANENT WUS IMPACTS = 48 LF / 531 SF

25' WETLAND BUFFER IMPACTS	
	TEMPORARY 25' WETLAND BUFFER IMPACTS = 0
	PERMANENT 25' WETLAND BUFFER IMPACTS = 0

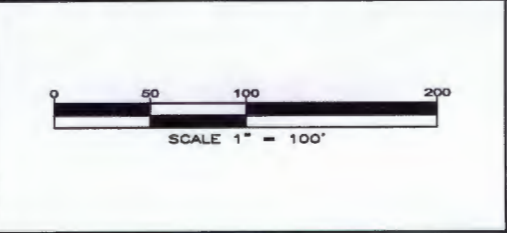

**MD 4/SUITLAND PARKWAY
INTERCHANGE**

CONTRACT NO.: PG618C21/PG618E21
 COUNTY: PRINCE GEORGE'S
 APPLICATION BY: MARYLAND STATE HIGHWAY
 ADMINISTRATION

PLATE 9
 MAY 2014



NOT TO SCALE



MARYLAND STATE HIGHWAY ADMINISTRATION
707 NORTH CALVERT ST.
BALTIMORE, MARYLAND 21202

CONTRACT NO.: PG618C21
COUNTY: PRINCE GEORGE'S
STATE: MARYLAND
APPLICATION BY: MDSA
WETLAND PLATE NO.
SHEET 1 OF 9 DATE: 5/2/14
REVISION:

PURPOSE: MARBURY DRIVE
STREAM MITIGATION

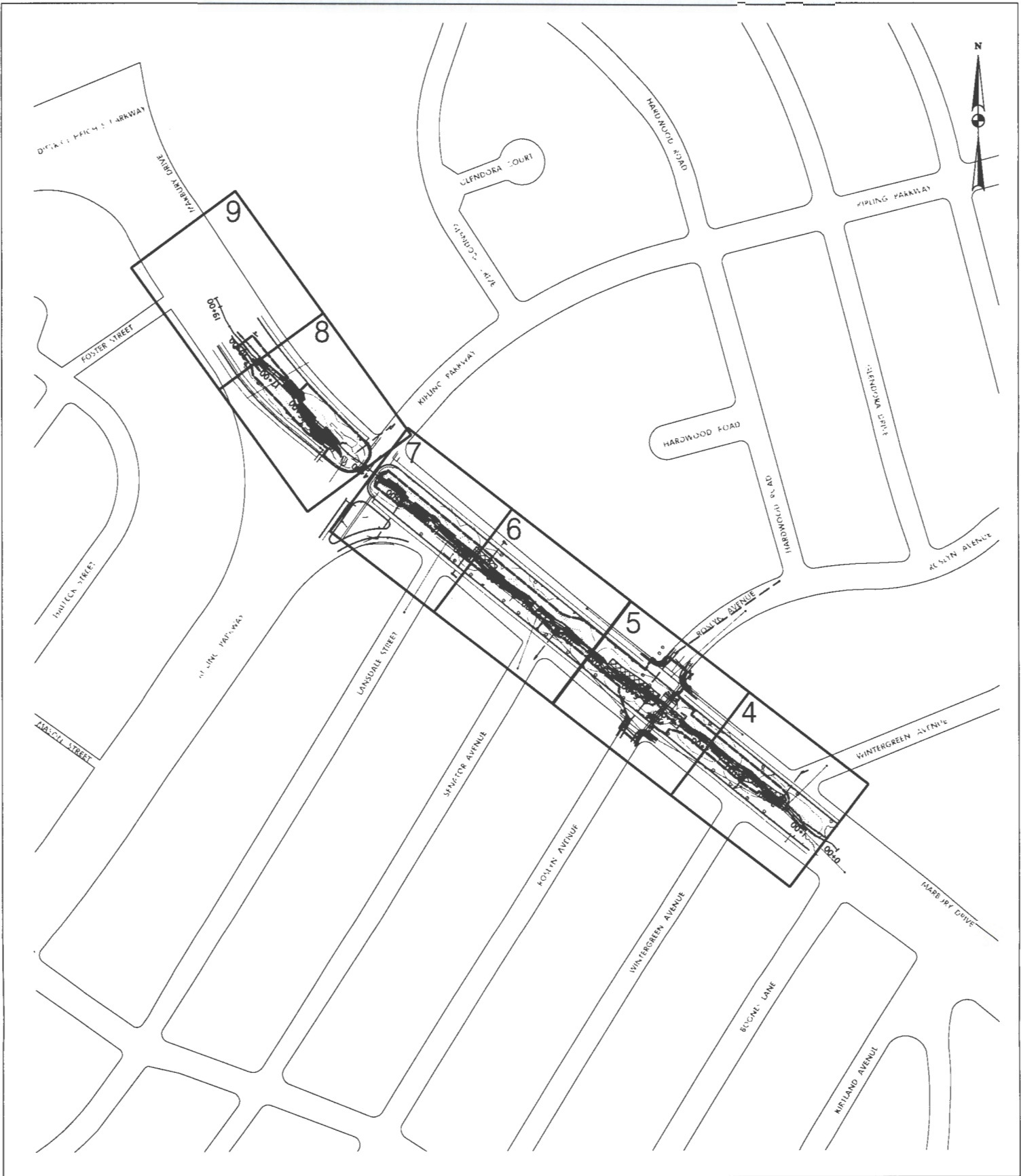

VICINITY MAP

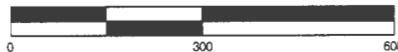

SCALE: 1" = 300'



MARYLAND STATE HIGHWAY ADMINISTRATION
707 NORTH CALVERT ST.
BALTIMORE, MARYLAND 21202

CONTRACT NO.: PG618C21
COUNTY: PRINCE GEORGE'S
STATE: MARYLAND
APPLICATION BY: MDSA
WETLAND PLATE NO.
SHEET 2 OF 9 DATE: 5/2/14
REVISION:

PURPOSE: MARBURY DRIVE
STREAM MITIGATION

Summary of Impacts

SHEET	WATERS US IMPACTS				100 YR FLOODPLAIN	WETLAND IMPACTS (PEM)		WETLAND BUFFER IMPACTS	
	PERMANENT		TEMPORARY		DISTURBANCE	PERMANENT	TEMPORARY	PERMANENT	TEMPORARY
	LF	SF	LF	SF	SF	SF	SF	SF	SF
4	251	3,041	0	0	6,550	0	0	0	0
5	362	4,892	0	0	9,755	0	0	0	0
6	375	4,509	0	0	15,517	380	0	2,505	0
7	304	3,389	0	0	14,477	377	0	6,488	0
8	341	5,548	0	0	14,214	206	0	4,727	0
9	55	841	0	0	6,861	0	0	112	0
TOTAL	1,688	22,220	0	0	67,374	963	0	13,832	0

Symbology

LIMIT OF DISTURBANCE		PERMANENT WETLAND IMPACTS	
WETLAND BOUNDARY (PEM)		PERMANENT WETLAND BUFFER IMPACTS	
25' WETLAND BUFFER		PERMANENT STREAM IMPACTS	
WATERS OF THE U.S.		RIFFLE GRADE CONTROL	
LIMIT OF PLANTING		RIFFLE GRADE CONTROL RUNGLIDE	
100-YEAR FLOODPLAIN		FABRIC ENCAPSULATED SOIL LIFT	
EXISTING MINOR CONTOURS		PLUNGE POOL	
EXISTING MAJOR CONTOURS		STORMWATER TREATMENT BAR	
SUPER SILT FENCE			
TREE			
ROOTWAD			

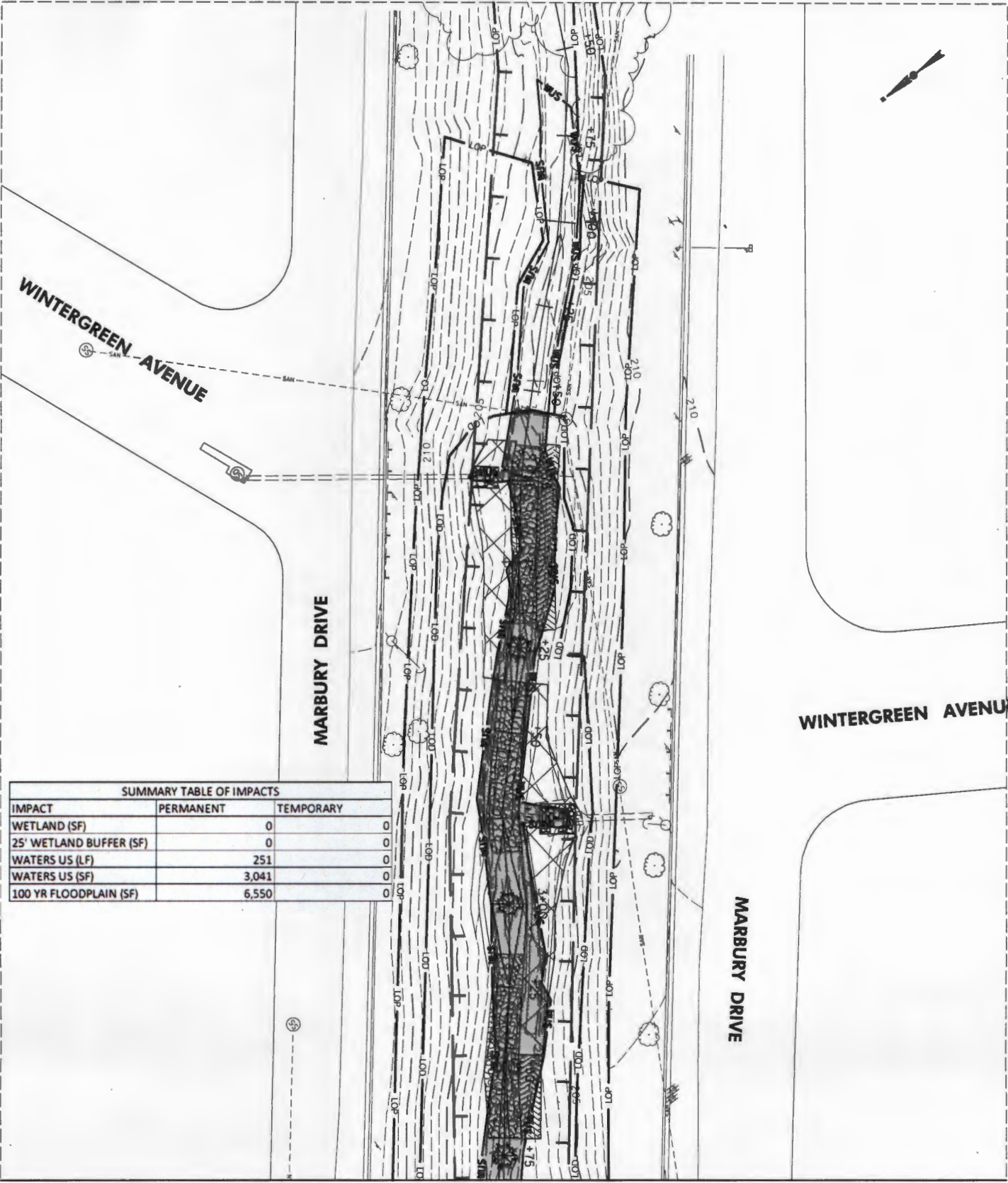

SUMMARY TABLE OF IMPACTS		
IMPACT	PERMANENT	TEMPORARY
WETLAND (SF)	0	0
25' WETLAND BUFFER (SF)	0	0
WATERS US (LF)	251	0
WATERS US (SF)	3,041	0
100 YR FLOODPLAIN (SF)	6,550	0

MATCH SHEET 5 OF 9

PLAN VIEW

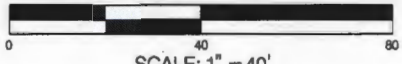

SCALE: 1" = 40'



MARYLAND STATE HIGHWAY ADMINISTRATION
707 NORTH CALVERT ST.
BALTIMORE, MARYLAND 21202

CONTRACT NO.: PG618C21
COUNTY: PRINCE GEORGE'S
STATE: MARYLAND
APPLICATION BY: MDSA
WETLAND PLATE NO. 1
SHEET 4 OF 9 DATE: 5/2/14
REVISION:

MARBURY DRIVE
PURPOSE: STREAM MITIGATION

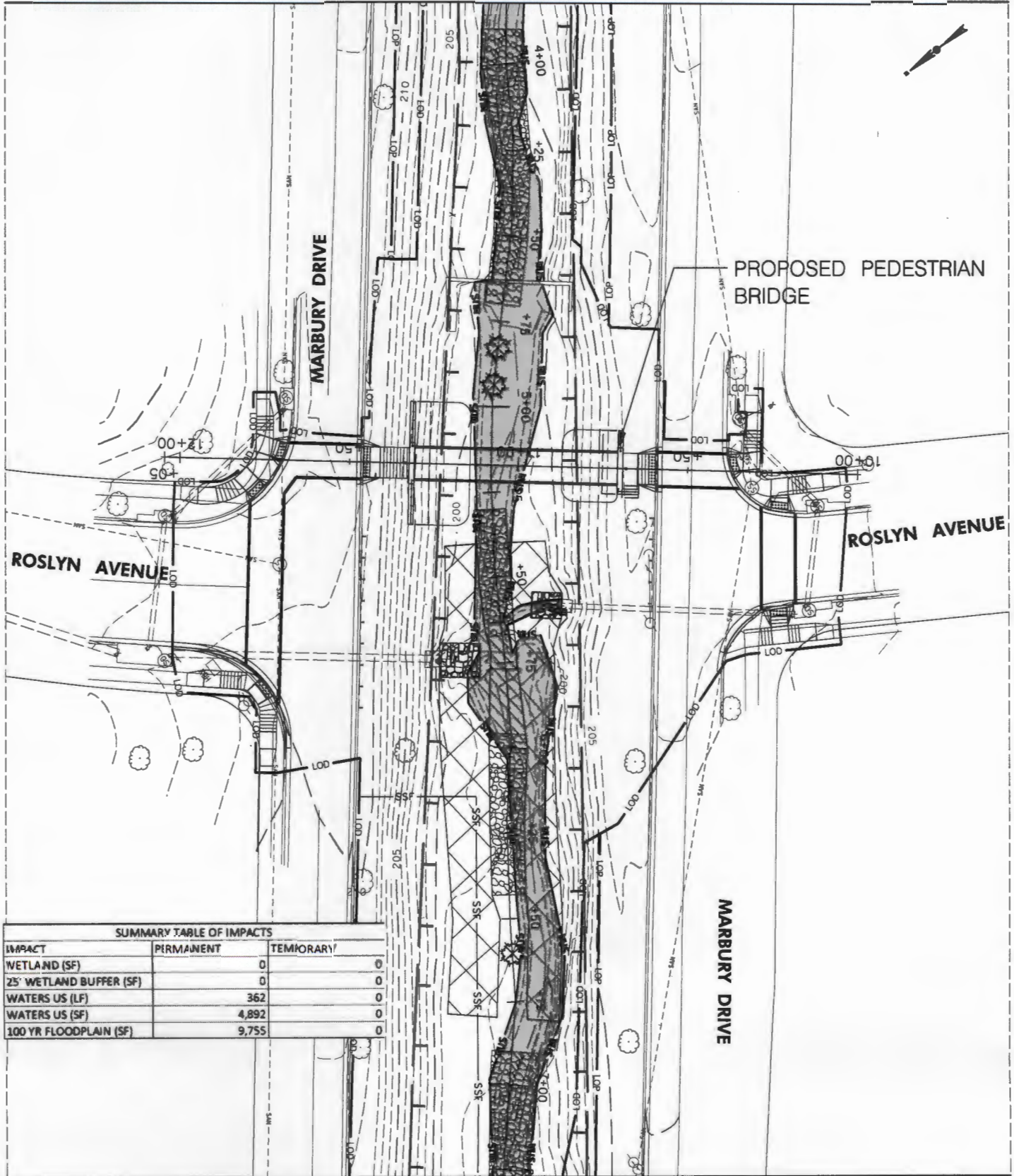

SUMMARY TABLE OF IMPACTS		
IMPACT	PERMANENT	TEMPORARY
WETLAND (SF)	0	0
25' WETLAND BUFFER (SF)	0	0
WATERS US (LF)		362
WATERS US (SF)	4,892	0
100 YR FLOODPLAIN (SF)	9,755	0

PLAN VIEW

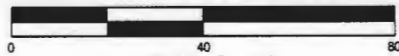

SCALE: 1" = 40'



MARYLAND STATE HIGHWAY ADMINISTRATION
707 NORTH CALVERT ST.
BALTIMORE, MARYLAND 21202

CONTRACT NO.: PG618C21
COUNTY: PRINCE GEORGE'S
STATE: MARYLAND
APPLICATION BY: MDSA
WETLAND PLATE NO. 2
SHEET 5 OF 9 DATE: 5/2/14
REVISION:

PURPOSE: MARBURY DRIVE
STREAM MITIGATION

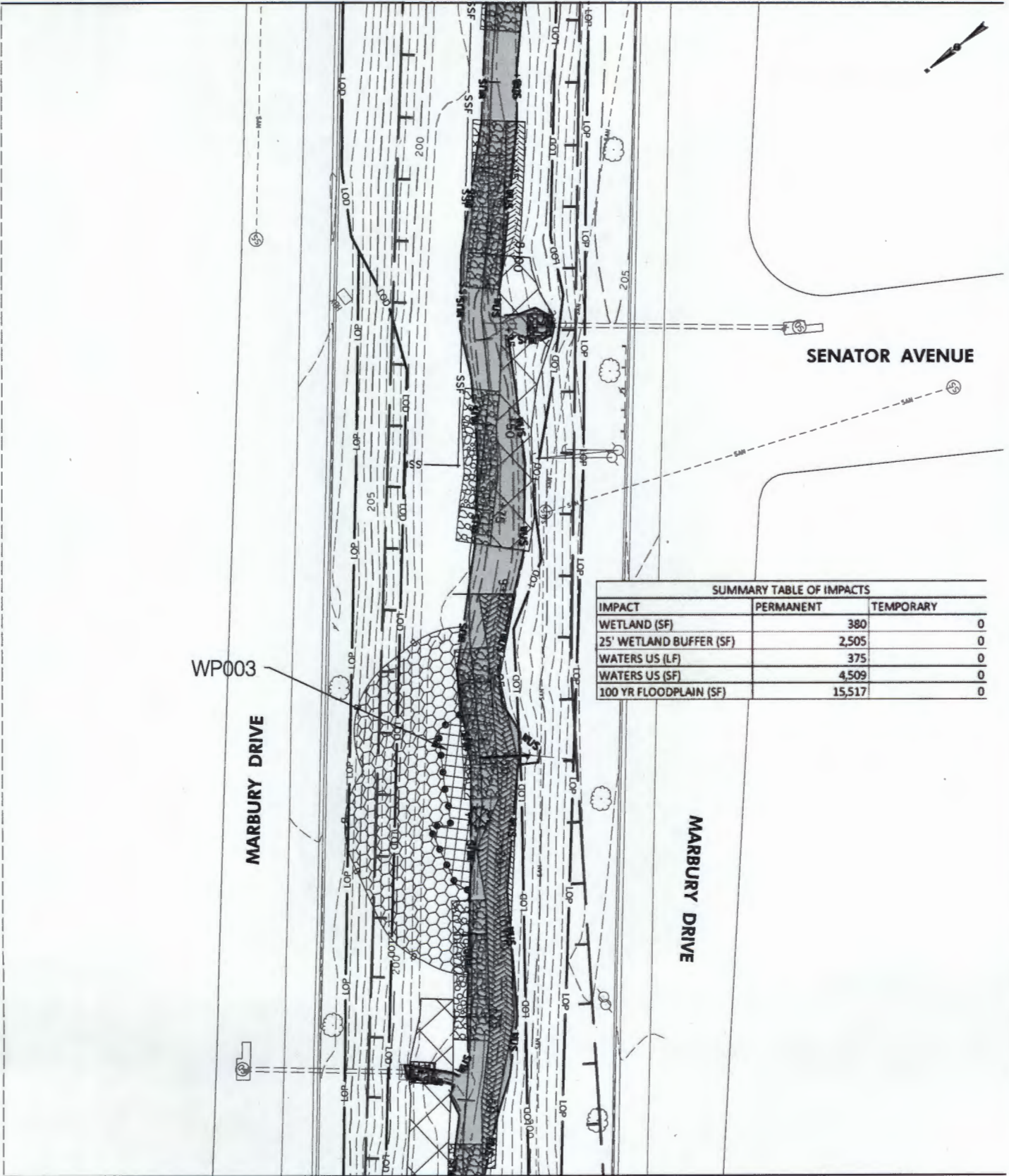

SUMMARY TABLE OF IMPACTS		
IMPACT	PERMANENT	TEMPORARY
WETLAND (SF)	380	0
25' WETLAND BUFFER (SF)	2,505	0
WATERS US (LF)	375	0
WATERS US (SF)	4,509	0
100 YR FLOODPLAIN (SF)	15,517	0

PLAN VIEW

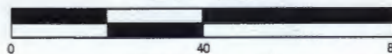

SCALE: 1" = 40'



MARYLAND STATE HIGHWAY ADMINISTRATION
707 NORTH CALVERT ST.
BALTIMORE, MARYLAND 21202

CONTRACT NO.: PG618C21
COUNTY: PRINCE GEORGE'S
STATE: MARYLAND
APPLICATION BY: MDSA
WETLAND PLATE NO. 3
SHEET 6 OF 9 DATE: 5/2/14
REVISION:

MARBURY DRIVE
PURPOSE: STREAM MITIGATION

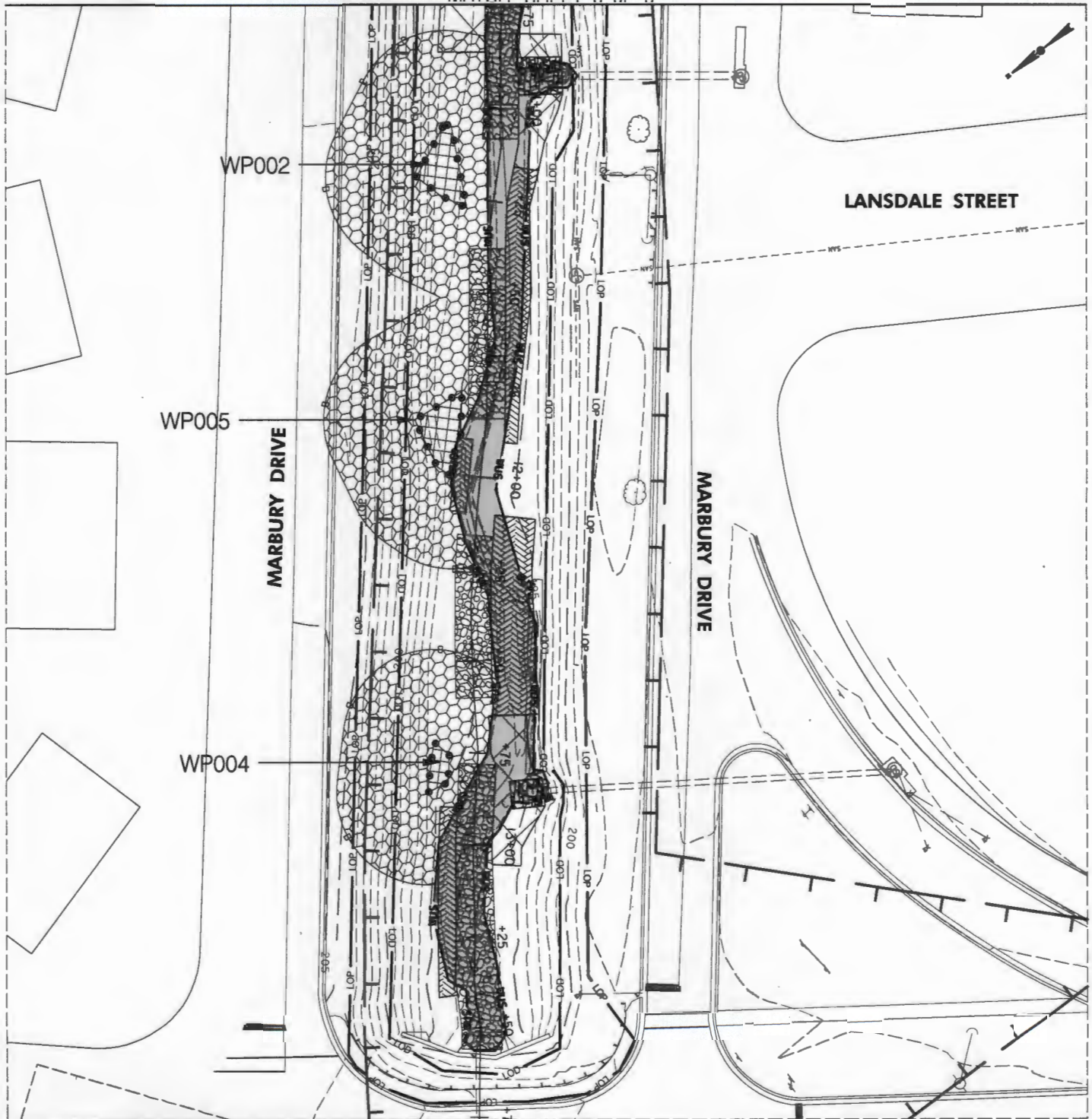

IMPACT	PERMANENT	TEMPORARY
WETLAND (SF)	377	0
25' WETLAND BUFFER (SF)	6,488	0
WATERS US (I.F.)	304	0
WATERS US (SF)	3,389	0
100 YR FLOODPLAIN (SF)	14,477	0

KIPLING PARKWAY

PLAN VIEW

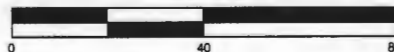

SCALE: 1" = 40'



MARYLAND STATE HIGHWAY ADMINISTRATION
707 NORTH CALVERT ST.
BALTIMORE, MARYLAND 21202

CONTRACT NO.: PG618C21
COUNTY: PRINCE GEORGE'S
STATE: MARYLAND
APPLICATION BY: MDSA
WETLAND PLATE NO. 4
SHEET 7 OF 9 DATE: 5/2/14
REVISION:

PURPOSE: MARBURY DRIVE
STREAM MITIGATION

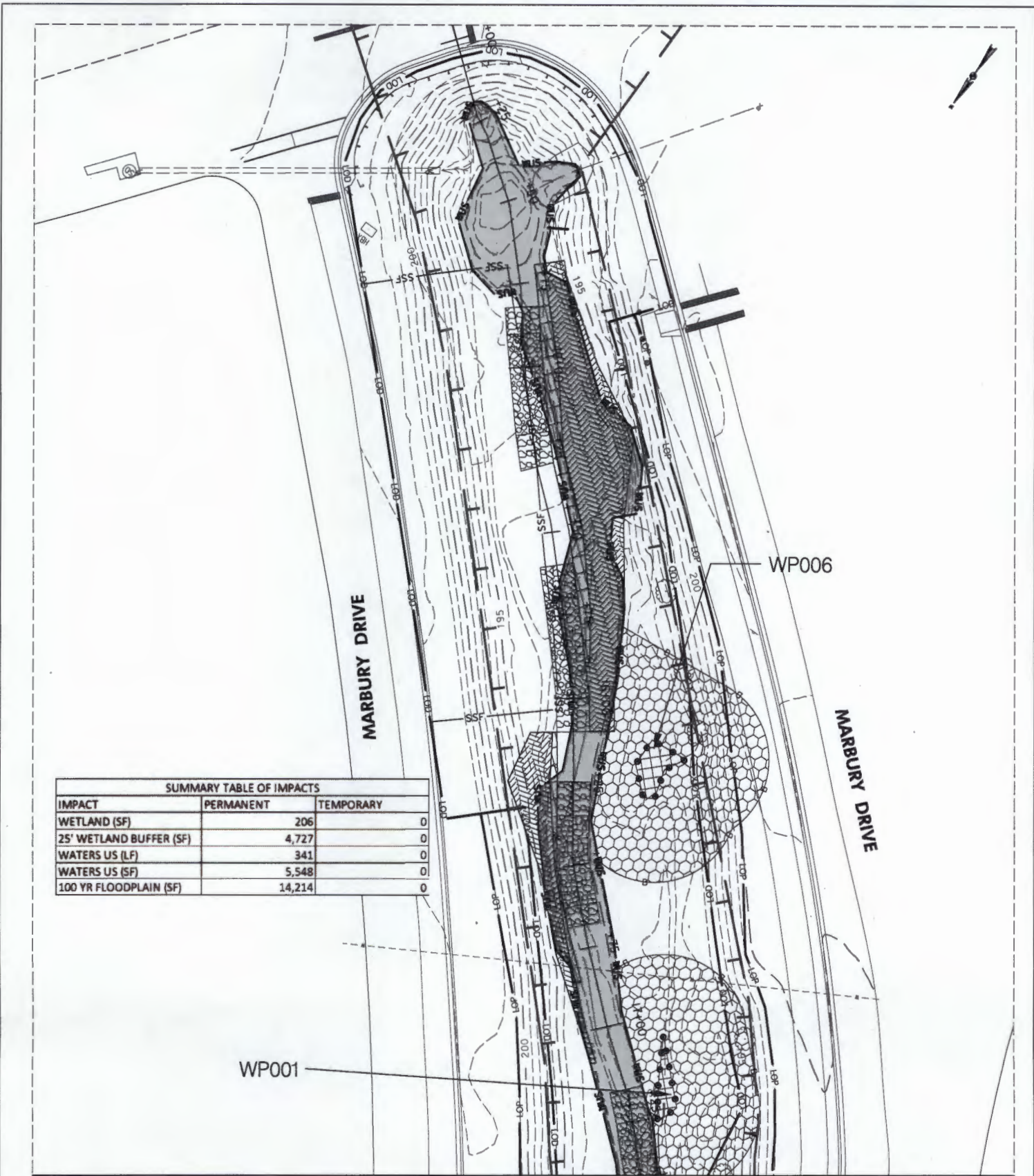

SUMMARY TABLE OF IMPACTS		
IMPACT	PERMANENT	TEMPORARY
WETLAND (SF)	206	0
25' WETLAND BUFFER (SF)	4,727	0
WATERS US (LF)	341	0
WATERS US (SF)	5,548	0
100 YR FLOODPLAIN (SF)	14,214	0

MATCH SHEET 9 OF 9

PLAN VIEW

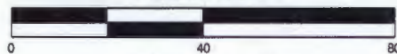

SCALE: 1" = 40'



MARYLAND STATE HIGHWAY ADMINISTRATION
707 NORTH CALVERT ST.
BALTIMORE, MARYLAND 21202

CONTRACT NO.: PG618C21
COUNTY: PRINCE GEORGE'S
STATE: MARYLAND
APPLICATION BY: MDSA
WETLAND PLATE NO. 5
SHEET 8 OF 9 DATE: 5/214
REVISION:

MARBURY DRIVE
PURPOSE: STREAM MITIGATION

MARBURY DRIVE

NO STREAM IMPACTS WILL OCCUR WITHIN THE LOP BOUNDARY BECAUSE NO EQUIPMENT WILL BE ALLOWED IN THE STREAM

SUMMARY TABLE OF IMPACTS		
IMPACT	PERMANENT	TEMPORARY
WETLAND (SF)	0	0
25' WETLAND BUFFER (SF)	112	0
WATERS US (LF)	55	0
WATERS US (SF)	841	0
100 YR FLOODPLAIN (SF)	6,861	0

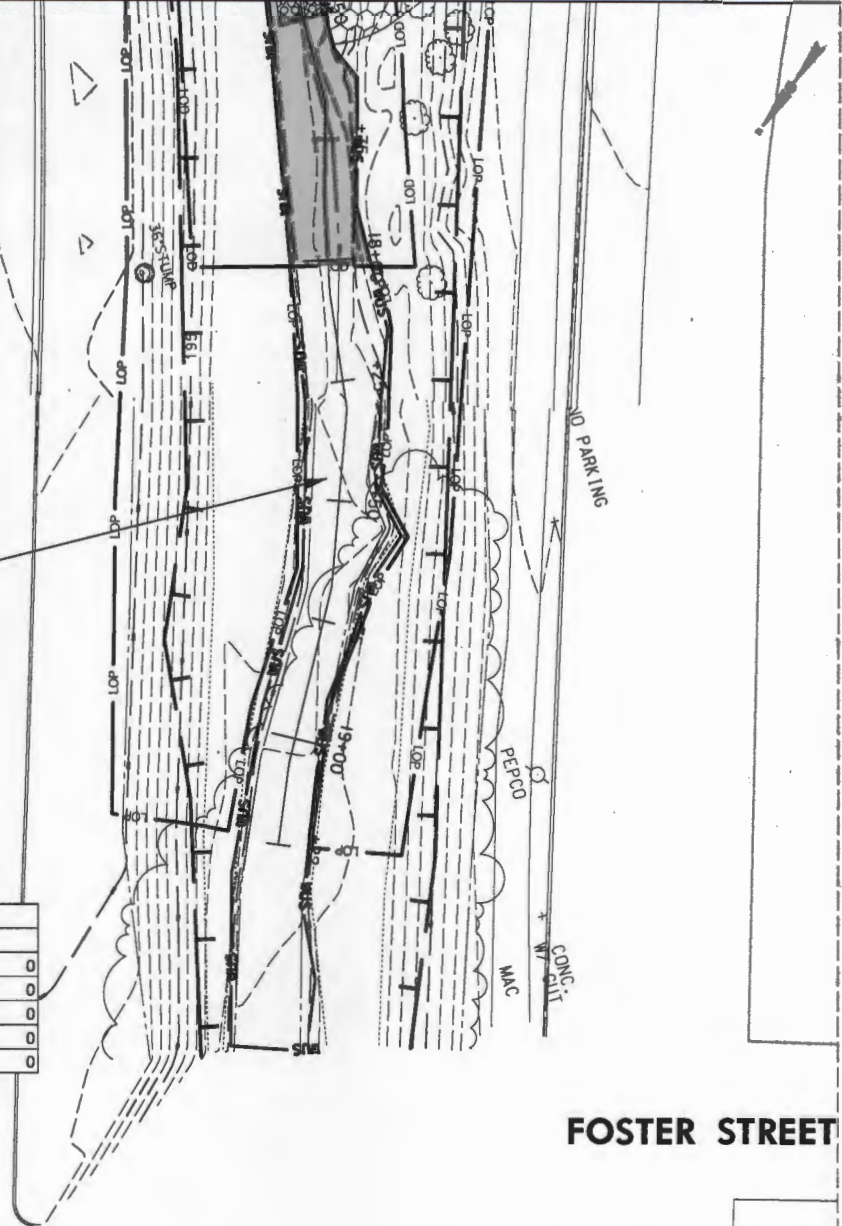

FOSTER STREET

PLAN VIEW

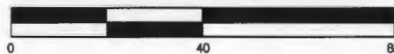

SCALE: 1" = 40'



MARYLAND STATE HIGHWAY ADMINISTRATION
707 NORTH CALVERT ST.
BALTIMORE, MARYLAND 21202

CONTRACT NO.: PG618C21
COUNTY: PRINCE GEORGE'S
STATE: MARYLAND
APPLICATION BY: MDSHA
WETLAND PLATE NO. 6
SHEET 9 OF 9 DATE: 5/2/14
REVISION:

PURPOSE: MARBURY DRIVE
STREAM MITIGATION

MD 4 and Suitland Parkway							
Roadway Construction Impacts Revised - May 2014							
WUS System	Flow Type	Watershed	Impact Plate	WUS Impacts			
				Permanent		Temporary	
				lf	sq. ft.	lf	sq. ft.
WUS WL001B	Intermittent	Western Branch	1	342	1,729	131	1,818
			2	169	1,202		
WUS WL001C	Intermittent	Western Branch	2	155	1,835		
WUS WL002	Perennial	Western Branch	2	158	2,049	54	854
WUS WL002A	Perennial	Western Branch	2	260	1,973		
WUS WL002B	Perennial	Western Branch	2	42	299		
WUS WL010	Intermittent	Western Branch	2	40	394		
WUS WL003	Intermittent	Western Branch	5	178	2,454	15	183
WUS WL012	Intermittent	Western Branch	6	647	9,500		
			8	370	3,325		
WUS WL013	Perennial	Western Branch	8	77	53	12	237
WUS WL044	Intermittent	Western Branch	8	16	290	38	861
WUS WL014A	Intermittent	Western Branch	9	48	531	2	14
Total WUS Impacts				2,502	25,634	252	3,967
Wetland ID	Cover Type	Watershed	Impact Plate	Wetland Impacts (sq. ft.)		25' Wetland Buffer Impacts (sq. ft.)	
				Permanent	Temporary	Permanent	Temporary
Wetland WL001A	Emergent	Western Branch	1		2420	992	4862
Wetland WP011	Emergent	Western Branch	2	395		3,913	
Wetland WP049*	Emergent	Potomac River Upper Tidal	3	152	84	682	42
Wetland WP063	Emergent	Potomac River Upper Tidal	3	659	211	7,351	1,434
Wetland WP065	Emergent	Potomac River Upper Tidal	4	347	1,545	5,079	1,820
Wetland WP066	Emergent	Western Branch	5		205	168	767
Wetland WP067	Emergent	Western Branch	5	1,314		5,619	
Wetland WL009	Open Water	Western Branch	7		51,802		19,551
Total Wetland/25' Buffer Impacts				2,867	56,267	23,804	28,476

*19 sf of the temporary impacts to WP049 overlap with permanent impacts from NuStar.

MD 4 and Suitland Parkway

NuStar Pipeline Relocation Impacts Revised - May 2014

WUS System	Flow Type	Watershed	Impact Plate	WUS Impacts			
				Permanent		Temporary	
				lf	sq. ft.	lf	sq. ft.
WUS WL101	Intermittent	Western Branch	4	12	100	54	243
WUS-1	Intermittent	Western Branch	5	12	115	59	427
WUS WL044	Intermittent	Western Branch	5			18	230
Total WUS Impacts				24	215	131	900
Wetland ID	Cover Type	Watershed	Impact Plate	Wetland Impacts (sq. ft.)		25' Wetland Buffer Impacts (sq. ft.)	
				Permanent	Temporary	Permanent	Temporary
Wetland WP049	Emergent	Potomac River Upper Tidal	2	19	92		2,040
Wetland WP062	Scrub-Shrub	Potomac River Upper Tidal	2				1,211
Wetland G-G	Forested	Western Branch	4				1,321
Total Wetland/25' Buffer Impacts				19	92	0	4,572

MD 4 and Suitland Parkway					
Marbury Stréam Restoration Impacts Revised - May 2014					
Flow Type	Watershed	WUS Impacts			
		Permanent		Temporary	
		lf	sq. ft.	lf	sq. ft.
Perennial	Western Branch	1,688	22,220	0	0
Cover Type	Watershed	Wetland Impacts (sq. ft.)		25' Wetland Buffer Impacts (sq. ft.)	
		Permanent	Temporary	Permanent	Temporary
		Emergent	Western Branch	963	0
Cover Type	Watershed	Floodplain Impacts (sq. ft.)			
		Disturbance			
		N/A	Western Branch	67,374	