

U.S. Army Corps
of Engineers
Baltimore District

Public Notice

In Reply to Application Number
CENAB-OP-RMN (Watergate Harbor Imp. Assoc./Dredging)
2014-61605-M36

PN 15-07

Comment Period: February 2, 2015 – March 3, 2015

THE PURPOSE OF THIS PUBLIC NOTICE IS TO SOLICIT COMMENTS FROM THE PUBLIC REGARDING THE WORK DESCRIBED BELOW. NO DECISION HAS BEEN MADE AS TO WHETHER OR NOT A PERMIT WILL BE ISSUED AT THIS TIME.

This District has received an application for a Department of the Army permit pursuant to Section 10 of the Rivers and Harbors Act of 1899 and Section 404 of the Clean Water Act (33 U.S.C. 1344) as described below:

APPLICANT: Watergate Harbor Improvement Association
c/o Mr. Eric Thompson
3702 Thomas Point Road
Annapolis, Maryland 21403

WATERWAY AND LOCATION: Within tidal waters of the U.S., in the South River and Watergate Harbor, in Annapolis, Anne Arundel County, Maryland.

WORK: To mechanically dredge an existing channel to a depth of -4.0-feet mean low water (MLW) in the South River and Watergate Harbor, dredge nine individual spurs to existing docks, and replace an existing wood jetty in-place. Additionally, three landowners are proposing to replace existing waterfront structures as noted below. Mechanical dredging of the main channel and harbor will permanently impact approximately 49,331 square feet of tidal waters of the U.S. The main channel dredging will occur within a 40-foot wide by 387-foot long area, while the interior channel dredging within Watergate Harbor will occur within a 30-foot wide by 1,054-foot long area. Dredging of the nine spurs to a depth of -4.0-feet MLW within Watergate Harbor will permanently impact a total of 9,103 square feet of tidal waters of the U.S. A total of 3,931 cubic yards (3,212 from the main channel and 719 from the nine spurs) of dredge material will be disposed of at Westport Reclamation Services, located at 4944 Sands Road, Lothian, Maryland. The wood jetty will be replaced in-place and measures 3-feet by 375-feet and will extend a maximum of 375-feet channelward of the approximate mean high water shoreline. The permit for these projects, if issued, would authorize periodic maintenance dredging for a period of six (6) years from the date of the authorization, subject to prior notification of the District Engineer and availability of an adequate disposal site for the dredged material. As there are no impacts to wetlands, submerged aquatic vegetation beds, or other special aquatic sites, no compensatory mitigation for aquatic impacts is proposed by the applicant. The purpose of the proposed work is to improve navigable access to, from, and within Watergate Harbor for the residents of the Watergate Harbor Improvement Association. Unless otherwise noted below, all work is shown on the enclosed plans dated August 26, 2014, as revised November 1, 2014.

SPURS:

Spur 1: 2014–61757 David Friedlander: To mechanically dredge a 24-foot by 60-foot spur channel in Watergate Harbor to a depth of -4.0-feet MLW and deposit approximately 63.5 cubic yards of dredged material at Westport Reclamation Services, located at 4944 Sands Road, Lothian, Maryland. Periodic maintenance dredging for a period of six years from the date of the authorization, subject to prior notification of the District and availability of an adequate disposal site for the dredged material, has been requested.

Spur 2: 2014–61756 Lyle Moldin: To mechanically dredge a 24-foot by 60-foot spur channel in Watergate Harbor to a depth of -4.0-feet MLW and deposit approximately 63.5 cubic yards of dredged material at Westport Reclamation Services, located at 4944 Sands Road, Lothian, Maryland. Periodic maintenance dredging for a period of six years from the date of the authorization, subject to prior notification of the District and availability of an adequate disposal site for the dredged material, has been requested. Also requested is the construction of an 11-foot by 19-foot by 12-foot triangular shaped fixed pier with two pilings and a boatlift. The structure will extend a maximum distance of 21-feet channelward of the approximate mean high water shoreline. All proposed work is shown on plans dated September 14, 2014.

Spur 3: 2014–61722 William Turley: To mechanically dredge a 25-foot by 50-foot spur channel in Watergate Harbor to a depth of -4.0-feet MLW and deposit approximately 92 cubic yards of dredged material behind a proposed bulkhead replacement on-site. Periodic maintenance dredging for a period of six years from the date of the authorization, subject to prior notification of the District and availability of an adequate disposal site for the dredged material, has been requested. Also requested is the reconstruction of 140 linear feet of existing wood bulkhead within 18-inches. The new bulkhead will extend a maximum distance of 1.5-feet channelward of the approximate mean high water shoreline. All proposed work is shown on plans dated September 14, 2014.

Spur 4: 2014–61913 Marie Doyon: To mechanically dredge a 15-foot by 65-foot spur channel in Watergate Harbor to a depth of -4.0-feet MLW and deposit approximately 87 cubic yards of dredged material at Westport Reclamation Services, located at 4944 Sands Road, Lothian, Maryland. Periodic maintenance dredging for a period of six years from the date of the authorization, subject to prior notification of the District and availability of an adequate disposal site for the dredged material, has been requested.

Spur 5: 2014–61755 Mark Wiggins: To mechanically dredge a 25-foot by 52-foot spur channel in Watergate Harbor to a depth of -4.0-feet MLW and deposit approximately 98 cubic yards of dredged material at Westport Reclamation Services, located at 4944 Sands Road, Lothian, Maryland. Periodic maintenance dredging for a period of six years from the date of the authorization, subject to prior notification of the District and availability of an adequate disposal site for the dredged material, has been requested.

Spur 6: 2014–61861 Robert Adams, Sr.: To mechanically dredge a 37-foot by 41-foot spur channel in Watergate Harbor to a depth of -4.0-feet MLW and deposit approximately 97 cubic yards of dredged material at Westport Reclamation Services,

located at 4944 Sands Road, Lothian, Maryland. Periodic maintenance dredging for a period of six years from the date of the authorization, subject to prior notification of the District and availability of an adequate disposal site for the dredged material, has been requested.

Spur 7: 2014–60483 Eric Thompson: To mechanically dredge a 15-foot by 59-foot spur channel in Watergate Harbor to a depth of -4.0-feet MLW and deposit approximately 74 cubic yards of dredged material behind a proposed bulkhead replacement on-site. Periodic maintenance dredging for a period of six years from the date of the authorization, subject to prior notification of the District and availability of an adequate disposal site for the dredged material, has been requested. Also requested is the removal of an existing pier, pilings, and boatlift, construct a new 6-foot by 45-foot pier with a 10-foot by 20-foot platform, a 6-foot by 5-foot walkway, 2 pilings, and a boatlift, and reconstruct 110 linear feet of existing rock revetment. The new revetment will extend a maximum distance of 8.5-feet channelward of the approximate mean high water shoreline, while the new pier will extend a maximum distance of 45-feet channelward of the approximate mean high water shoreline. All proposed work is shown on plans dated February 22, 2014, as revised October 27, 2014.

Spur 8: 2014–61758 Caroline Valente: To mechanically dredge an 18-foot by 62-foot spur channel in Watergate Harbor to a depth of -4.0-feet MLW and deposit approximately 72 cubic yards of dredged material at Westport Reclamation Services, located at 4944 Sands Road, Lothian, Maryland. Periodic maintenance dredging for a period of six years from the date of the authorization, subject to prior notification of the District and availability of an adequate disposal site for the dredged material, has been requested.

Spur 9: 2014–61862 George Benson, Jr.: To mechanically dredge a 17-foot by 62-foot spur channel in Watergate Harbor to a depth of -4.0-feet MLW and deposit approximately 72 cubic yards of dredged material at Westport Reclamation Services, located at 4944 Sands Road, Lothian, Maryland. Periodic maintenance dredging for a period of six years from the date of the authorization, subject to prior notification of the District and availability of an adequate disposal site for the dredged material, has been requested.

All work is to be completed in accordance with the enclosed plans. If you have any questions concerning this matter, please contact Mr. John Policarpo at (410) 962-4522 or at john.n.policarpo@usace.army.mil.

The decision whether to issue a permit will be based on an evaluation of the probable impacts, including cumulative impacts of the proposed activity on the public interest. That decision will reflect the national concern for both protection and utilization of important resources. The benefit, which reasonable may be expected to accrue from the proposal, must be balanced against its reasonably foreseeable detriments. All factors, which may be relevant to the proposal will be considered, including the cumulative effects thereof; among those are conservation, economic, aesthetics, general environmental concerns, wetlands, cultural values, fish and wildlife values, flood hazards, flood plain values, land use, navigation, shoreline erosion and accretion, recreation, water supply and conservation, water quality, energy needs, safety, food and fiber production, mineral needs, and consideration of property ownership and in general, the needs and welfare of the people.

The evaluation of the impact of the work described above on the public interest will include application of the Clean Water Act Section 404(b)(1) Guidelines promulgated by the Administrator, U.S. Environmental Protection Agency, under authority of Section 404 of the Clean Water Act.

The Corps of Engineers is soliciting comments from the public; Federal, State, and local agencies and officials; Indian Tribes; and other interested parties in order to consider and evaluate the impacts of this proposed activity. Any comments received will be considered by the Corps of Engineers to determine whether to issue, modify, condition or deny a permit for this proposal. To make this decision, comments are used to assess impacts on endangered species, historic properties, water quality, general environmental effects, and the other public interest factors listed above. Comments are used in the preparation of an Environmental Assessment and/or an Environmental Impact Statement pursuant to the National Environmental Policy Act. Comments provided will become part of the public record for this action. Comments are also used to determine the need for a public hearing and to determine the overall public interest of the proposed activity.

Written comments concerning the work described above related to the factors listed above or other pertinent factors must be received by the District Engineer, U.S. Army Corps of Engineers, Baltimore District, ATTN: Mr. John Policarpo, CENAB-OP-RMN, P.O. Box 1715, Baltimore, Maryland 21203-1715, within the comment period specified above.

ESSENTIAL FISH HABITAT: The Magnuson-Stevens Fishery Conservation and Management Act (MSFCMA), as amended by the Sustainable Fisheries Act of 1996 (Public Law 04-267), requires all Federal agencies to consult with the National Marine Fisheries Service (NMFS) on all actions, or proposed actions, permitted, funded, or undertaken by the agency that may adversely effect Essential Fish Habitat (EFH).

The project site lies in or adjacent to EFH as described under the MSFCMA for juvenile and adult *Scophthalmus aquosus* (windowpane flounder); larvae, juvenile, and adult *Paralichthys dentatus* (summer flounder); adult and juvenile *Centropristus striata* (black sea bass); juvenile and adult *Pomatomus saltatrix* (blue fish); and the eggs, larvae, juveniles, and adults of *Peprilus triacanthos* (Atlantic butterfly), *Rachycentron canadum* (cobia), *Scomberomorus maculatus* (Spanish mackerel), and *Scomberomorus cavalla* (king mackerel), managed species under the MSFCMA.

A preliminary assessment indicates that the proposed work would not have a substantial adverse effect on either managed species or prey species. Therefore, no EFH conservation measures have been developed. As the evaluation of this application continues, additional information may become available which could modify this preliminary determination.

SECTION 401 WATER QUALITY CERTIFICATION: The applicants are required to obtain a water quality certification in accordance with Section 401 of the Clean Water Act from the Maryland Department of the Environment. Any written comments concerning the work described above which relate to water quality certification must be received by the Maryland Department of the Environment, Tidal Wetlands Division, Montgomery Park Business Center, 1800 Washington Boulevard, Suite 430, Baltimore, Maryland 21230-1708 within the comment period as specified above to receive consideration. The Section 401 certifying agency has a statutory limit of one year from the date of this public notice to make its decision.

COASTAL ZONE MANAGEMENT PROGRAMS: Where applicable, the applicants have certified in this application that the proposed activity complies with and will be conducted in a manner consistent with the approved Coastal Zone Management (CZM) Program. By this public notice, we are requesting the State concurrence or objection to the applicant's consistency statement. Public comments relating to consistency must be received by the Maryland Department of the Environment, Wetlands and Waterways Program, Montgomery Park Business Center, 1800 Washington Boulevard, Suite 430, Baltimore, Maryland 21230-1708 within the comment period specified above to receive consideration. It should be noted that the CZM Program has a statutory limit of 6 months to make its consistency determination.

The applicants must obtain any State or local government permits which may be required.

A preliminary review of these applications indicates that the proposed work will not affect Federally listed threatened or endangered species or their critical habitat, pursuant to Section 7 of the Endangered Species Act, as amended. As the evaluation of this application continues, additional information may become available which could modify this preliminary determination.

Review of the latest published version of the National Register of Historic Places indicates that no registered properties listed as eligible for inclusion, therein, are located at the site of the proposed work. Currently unknown archeological, scientific, prehistoric, or historical data may be lost or destroyed by the work to be accomplished under the requested permit.

Any person who has an interest which may be adversely affected by the issuance of this permit may request a public hearing. The request, which must be in writing, must be received by the District Engineer, U.S. Army Corps of Engineers, Baltimore District, ATTN: Mr. John Policarpo CENAB-OP-RMN, P.O. Box 1715, Baltimore, Maryland 21203-1715, within the comment period as specified above to receive consideration. Also it must clearly set forth the interest which may be adversely affected by this activity and the manner in which the interest may be adversely affected.

It is requested that you communicate this information concerning the proposed work to any persons know by you to be interested and not being known to this office, who did not receive a copy of this notice.

FOR THE DISTRICT ENGINEER:

Joseph P. DaVia
Chief, Maryland Section Northern

1. SEE SITE PLAN NOTES ON PAGE 9 OF 12.
2. SECTION A-A TO END IS 147 LF.

SOUTH RIVER

FLOOD



EBB

DREDGE 49,331 SF OF EXISTING CHANNEL TO A DEPTH OF -4.0' AT MLW. MAIN CHANNEL IS 40' WIDE BY 387' LONG, INTERIOR CHANNEL 30' WIDE BY 1054' LONG. TOTAL SPOILS IS 3212 CYDS OF CLEAN SAND TO BE DISPOSED OF AT WESTPORT RECLAMATION SERVICES SPOILS SITE.

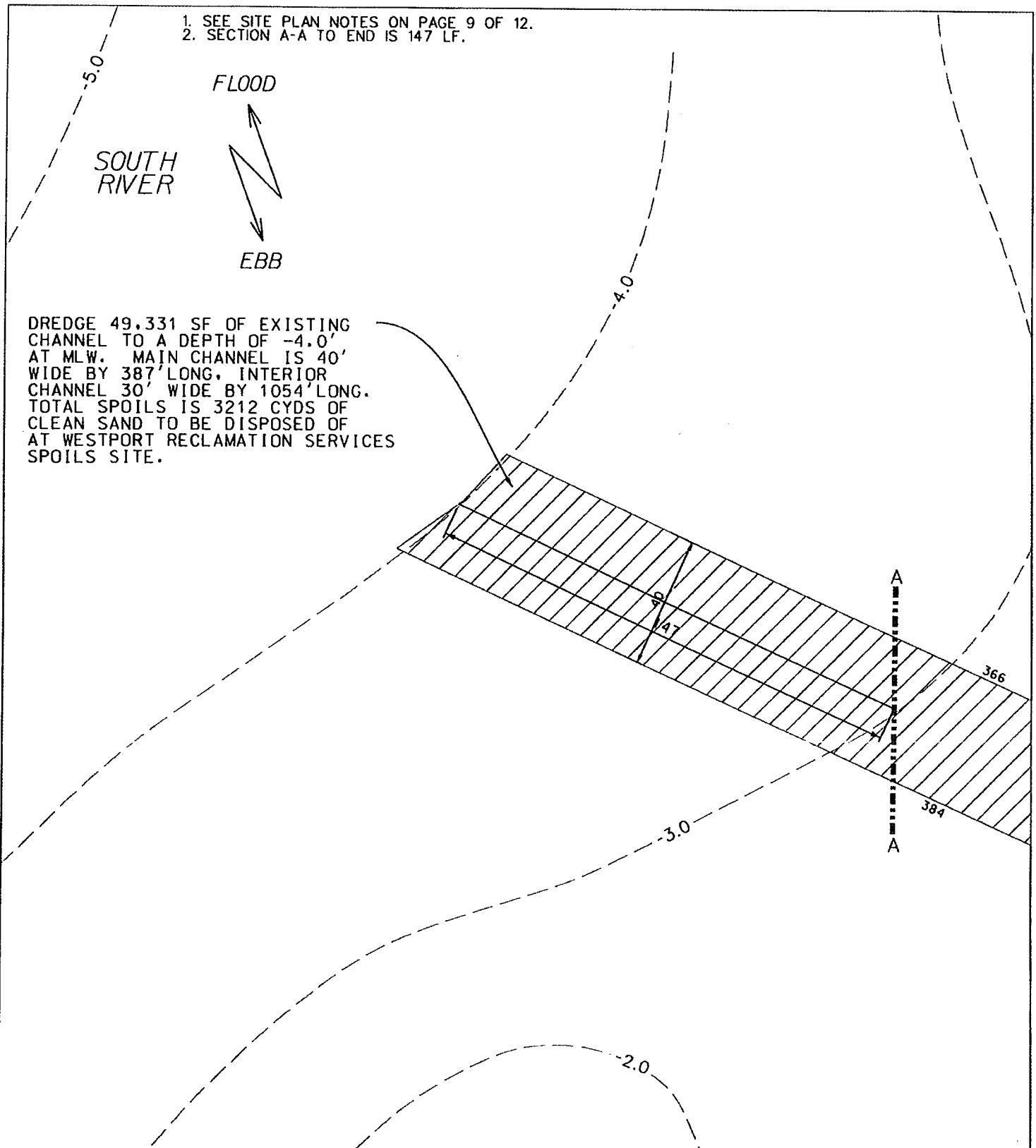

Tax Account No.:
N/A
Tax Map: 61
Parcel: 17
Deed Ref: N/A
Lot: Harbor
Zoning: N/A
Lot Size: N/A



SITE PLAN - 1
SCALE: 1" = 40'

Waterfront Engineering, Design,
and Construction, Inc.
303 Najoles Rd. St. 114
Millersville, MD 21108
(410) 703-8533
waterfrontdesign@verizon.net

PROPOSED: Maintenance dredging work. REVISED 11/1/2014

in: Watergate Harbor State: Maryland
co: Anne Arundel at: Watergate
Application by: Watergate Harbor Imp. Assoc.
Sheet 1 of 12 Date: August 26, 2014

NOTE: This drawing is not an engineered drawing. All dimensions and measurements shall be field verified by contractor.

Applicant's Signature:

1. SEE SITE PLAN NOTES ON PAGE 9 OF 12.
2. SECTION A-A TO B-B IS 240 LF.

DREDGE 49,331 SF OF EXISTING CHANNEL TO A DEPTH OF -4.0' AT MLW. MAIN CHANNEL IS 40' WIDE BY 387' LONG, INTERIOR CHANNEL 30' WIDE BY 1054' LONG. TOTAL SPOILS IS 3212 CYDS OF CLEAN SAND TO BE DISPOSED OF AT WESTPORT RECLAMATION SERVICES SPOILS SITE.

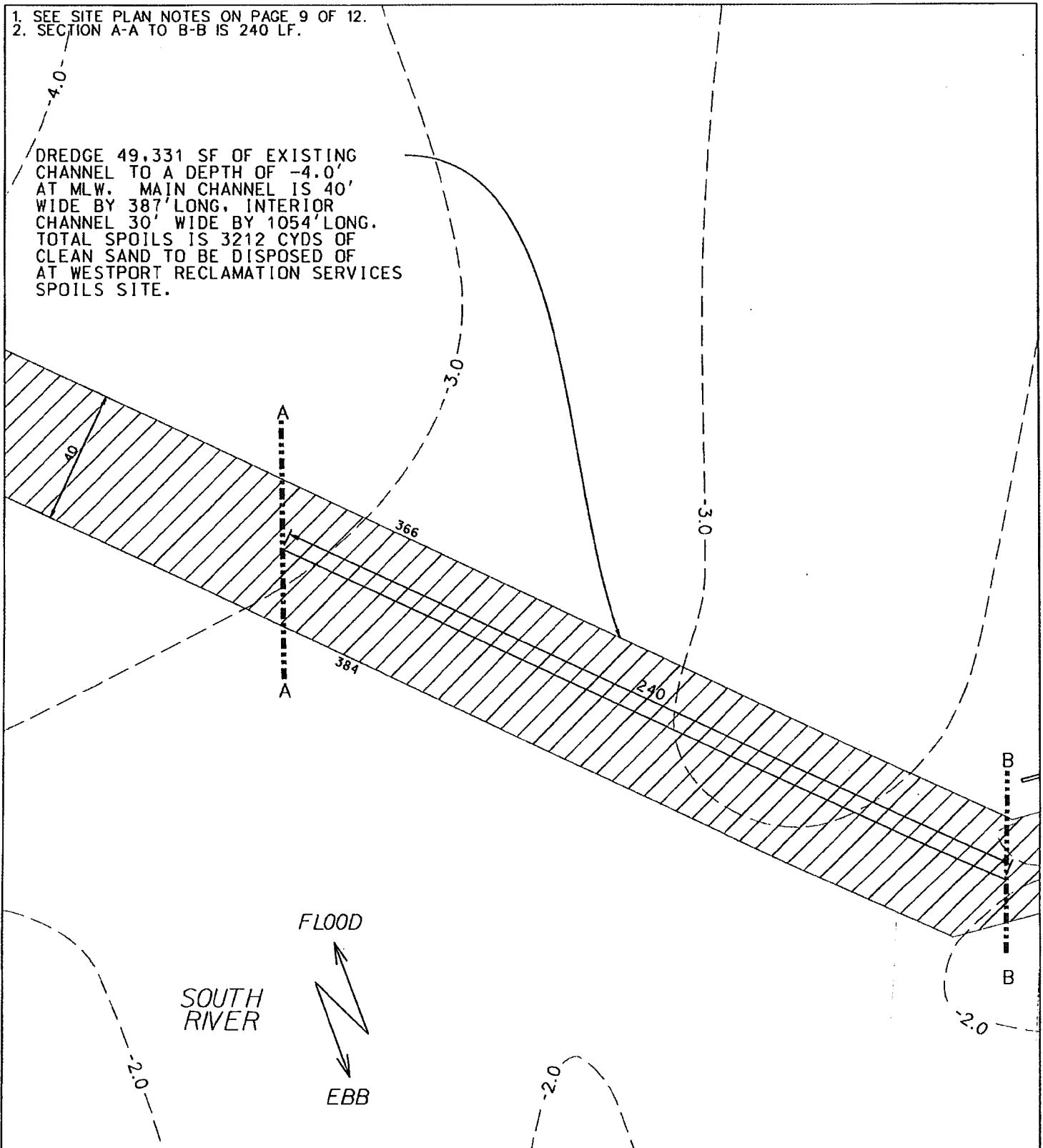

Tax Account No.:
N/A
Tax Map: 61
Parcel: 17
Deed Ref: N/A
Lot: Harbor
Zoning: N/A
Lot Size: N/A



SITE PLAN - 2
SCALE: 1" = 40'

Waterfront Engineering, Design,
and Construction, Inc.
303 Najoles Rd. St. 114
Millersville, MD 21108
(410) 703-8533
waterfrontdesign@verizon.net

PROPOSED: Maintenance dredging work. REVISED 11/1/2014

in: Watergate Harbor State: Maryland
co: Anne Arundel ot: Watergate
Application by: Watergate Harbor Imp. Assoc.
Sheet 2 of 12 Date: August 26, 2014

NOTE: This drawing is not an engineered drawing. All dimensions and measurements shall be field verified by contractor.

Applicant's Signature:

1. SEE SITE PLAN NOTES ON PAGE 9 OF 12.
2. SECTION B-B TO C-C IS 317 LF.

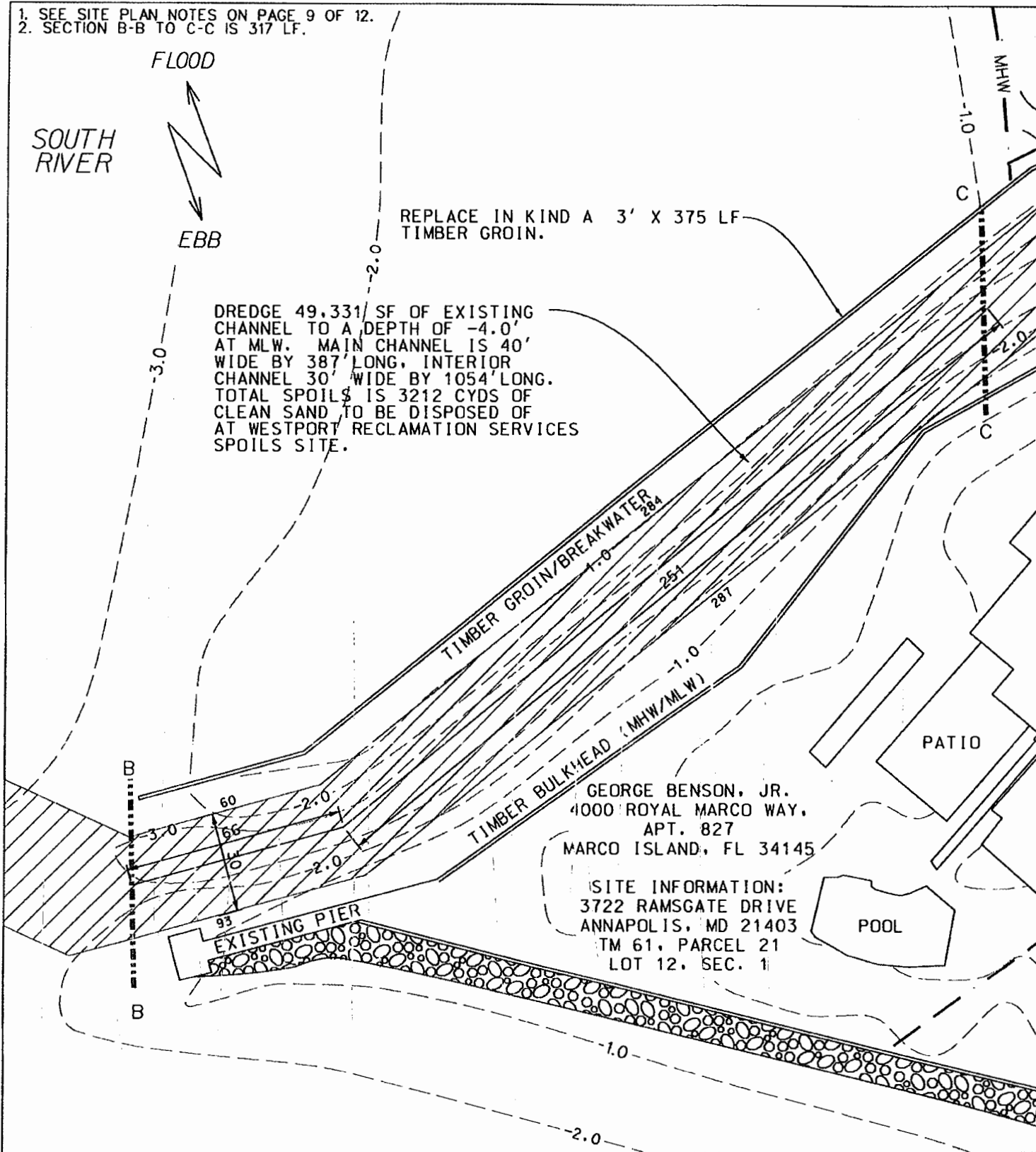

Tax Account No.:
N/A
Tax Map: 61
Parcel: 17
Deed Ref: N/A
Lot: Harbor
Zoning: N/A
Lot Size: N/A



SITE PLAN - 3
SCALE: 1" = 40'

Waterfront Engineering, Design,
and Construction, Inc.
303 Najoles Rd. St. 114
Millersville, MD 21108
(410) 703-8533
waterfrontdesign@verizon.net

REvised 11/1/2014
Maintenance dredging work.

in: Watergate Harbor State: Maryland
co: Anne Arundel at: Watergate
Application by: Watergate Harbor Imp. Assoc.
Sheet 3 of 12 Date: August 26, 2014

NOTE: This drawing is not an engineered drawing. All dimensions and measurements shall be field verified by contractor.

Applicant's Signature:

1. SEE SITE PLAN NOTES ON PAGE 9 OF 12.
2. SECTION C-C TO D-D IS 239 LF

FISHING CREEK FARM HOA, INC.
 PO BOX 3482
 ANNAPOLIS, MD 21403
 TM 57, PARCEL 121
 RECREATION AREA, B

DREDGE 49,331 SF OF EXISTING CHANNEL TO A DEPTH OF -4.0' AT MLW. MAIN CHANNEL IS 40' WIDE BY 387' LONG, INTERIOR CHANNEL 30' WIDE BY 1054' LONG. TOTAL SPOILS IS 3212 CYDS OF CLEAN SAND TO BE DISPOSED OF AT WESTPORT RECLAMATION SERVICES SPOILS SITE.

DREDGE A 17' X 124' SPUR TO A DEPTH OF -4.0' AT MLW. TOTAL SQ. FT. OF 2590 WITH 144 CYDS OF SPOILS (ON SEPARATE PERMIT)

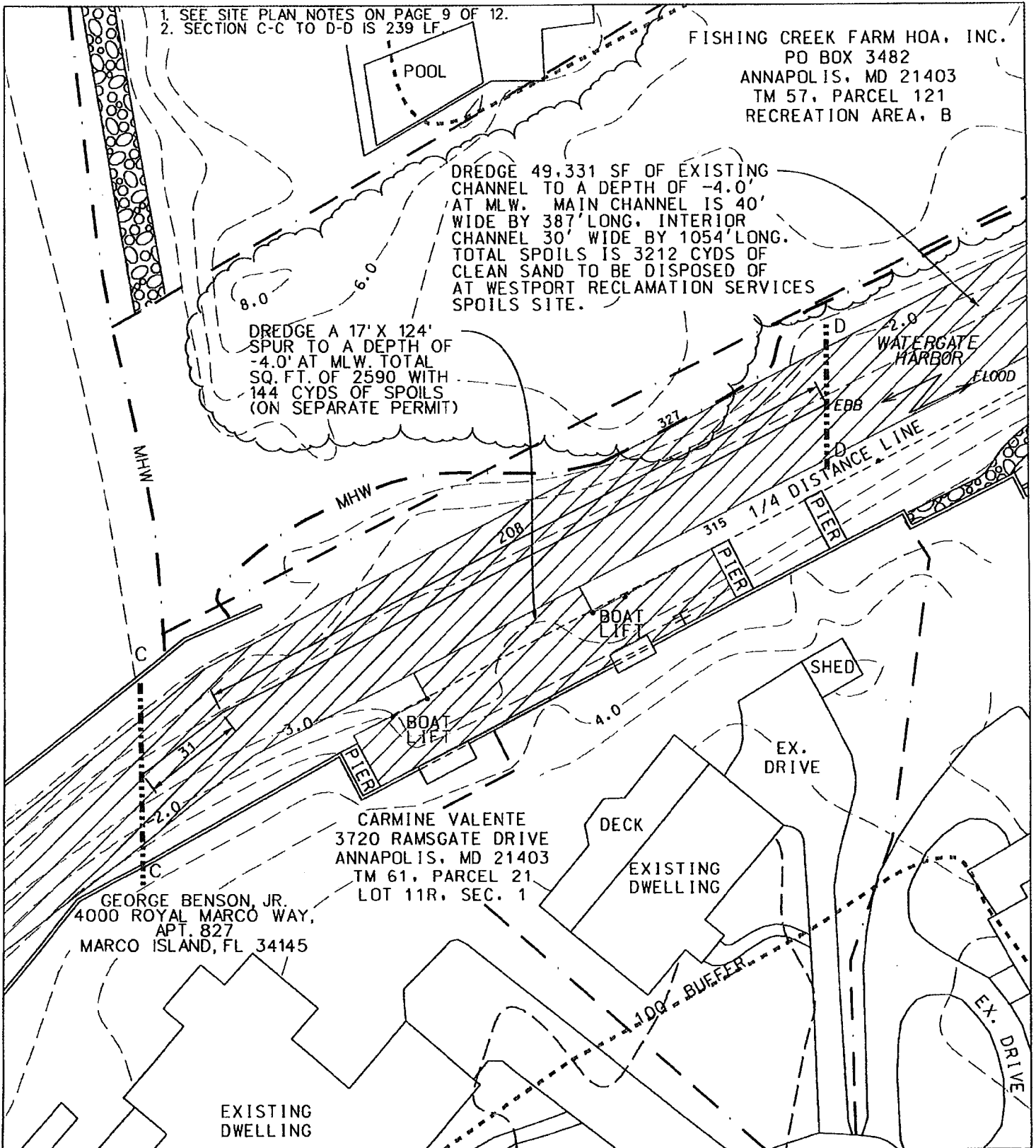

Tax Account No.: N/A
 Tax Map: 61
 Parcel: 17
 Deed Ref: N/A
 Lot: Harbor
 Zoning: N/A
 Lot Size: N/A

SITE PLAN - 4
SCALE: 1" = 40'
 Waterfront Engineering, Design, and Construction, Inc.
 303 Najoles Rd. St. 114
 Millersville, MD 21108
 (410) 703-8533
 waterfrontdesign@verizon.net

PROPOSED: Maintenance dredging work. **REVISED 11/1/2014**
 in: Watergate Harbor State: Maryland
 co: Anne Arundel at: Watergate
 Application by: Watergate Harbor Imp. Assoc.
 Sheet 4 of 12 Date: August 26, 2014

NOTE: This drawing is not an engineered drawing. All dimensions and measurements shall be field verified by contractor.
 Applicant's Signature:

1. SEE SITE PLAN NOTES ON PAGE 9 OF 12
2. SECTION D-D TO E-E IS 378 LF.

DREDGE 49,331 SF OF EXISTING CHANNEL TO A DEPTH OF -4.0' AT MLW. MAIN CHANNEL IS 40' WIDE BY 387' LONG, INTERIOR CHANNEL 30' WIDE BY 1054' LONG. TOTAL SPOILS IS 3212 CYDS OF CLEAN SAND TO BE DISPOSED OF AT WESTPORT RECLAMATION SERVICES SPOILS SITE.

DREDGE A 15' X 65' SPUR TO A DEPTH OF -4.0' AT MLW. TOTAL SQ. FT. OF 978 WITH 87 CYDS OF SPOILS (ON SEPARATE PERMIT)

DREDGE A 15' X 59' SPUR TO A DEPTH OF -4.0' AT MLW. TOTAL SQ. FT. OF 833 WITH 74 CYDS OF SPOILS (ON SEPARATE PERMIT)

DREDGE A 37' X 41' SPUR TO A DEPTH OF -4.0' AT MLW. TOTAL SQ. FT. OF 1248 WITH 97 CYDS OF SPOILS (ON SEPARATE PERMIT)

ROBERT ADAMS
3718 RAMSGATE DRIVE
ANNAPOLIS, MD 21403
TM 61, PARCEL 21
LOT 10, PT. OF 11, SEC. 1

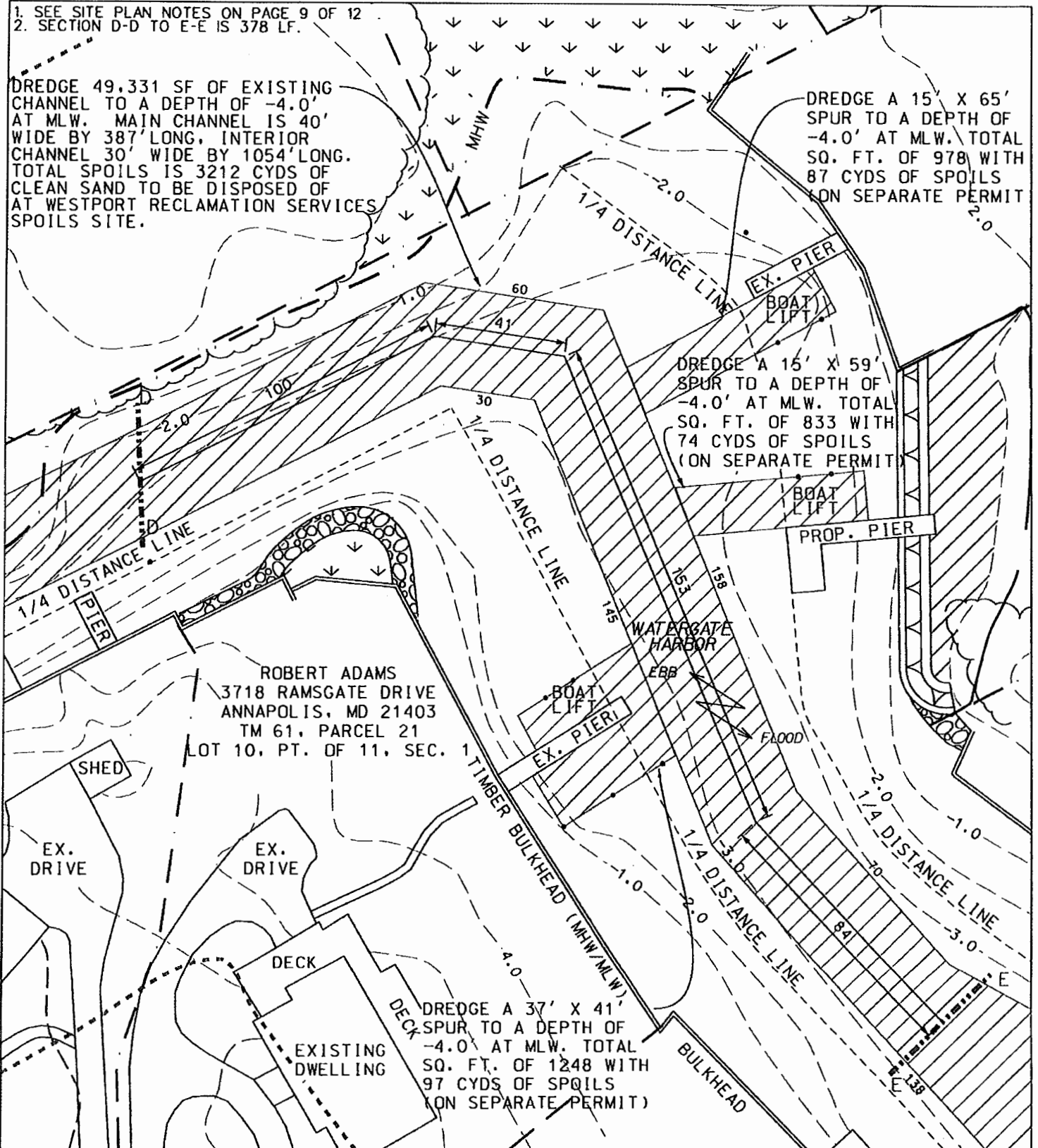

Tax Account No.:
N/A
Tax Map: 61
Parcel: 17
Deed Ref: N/A
Lot: Harbor
Zoning: N/A
Lot Size: N/A

SITE PLAN - 5
SCALE: 1" = 40'
Waterfront Engineering, Design,
and Construction, Inc.
303 Najoles Rd. St. 114
Millersville, MD 21108
(410) 703-8533
waterfrontdesign@verizon.net

PROPOSED: Maintenance dredging work. **REVISED 11/1/2014**
in: Watergate Harbor State: Maryland
co: Anne Arundel at: Watergate
Application by: Watergate Harbor Imp. Assoc.
Sheet 5 of 12 Date: August 26, 2014

NOTE: This drawing is not an engineered drawing. All dimensions and measurements shall be field verified by contractor.

Applicant's Signature:

1. SEE SITE PLAN NOTES ON PAGE 9 OF 12.
 2. SECTION E-E TO END IS 120 LF.

ROBERT MITCHELL
 3704 THOMAS POINT RD.
 ANNAPOLIS, MD 21403
 TM 61, PARCEL 17
 LOT 3, SEC. 1

DREDGE 49,331 SF OF EXISTING CHANNEL TO A DEPTH OF -4.0' AT MLW. MAIN CHANNEL IS 40' WIDE BY 387' LONG, INTERIOR CHANNEL 30' WIDE BY 1054' LONG. TOTAL SPOILS IS 3212 CYDS OF CLEAN SAND TO BE DISPOSED OF AT WESTPORT RECLAMATION SERVICES SPOILS SITE.

MARK WIGGINS
 3706 THOMAS POINT RD.
 ANNAPOLIS, MD 21403
 TM 61, PARCEL 17
 LOT 4, SEC. 1

DREDGE A 25' X 52' SPUR TO A DEPTH OF -4.0' AT MLW. TOTAL SQ. FT. OF 1102 WITH 98 CYDS OF SPOILS (ON SEPARATE PERMIT)

DREDGE A 25' X 50' SPUR TO A DEPTH OF -4.0' AT MLW. TOTAL SQ. FT. OF 1250 WITH 92 CYDS OF SPOILS (ON SEPARATE PERMIT)

DREDGE A 24' X 60' SPUR TO A DEPTH OF -4.0' AT MLW. TOTAL SQ. FT. OF 1102 WITH 127 CYDS OF SPOILS (TO BE SPLIT FOR 63.5 CYDS FOR EACH APPLICANT) (ON SEPARATE PERMIT)

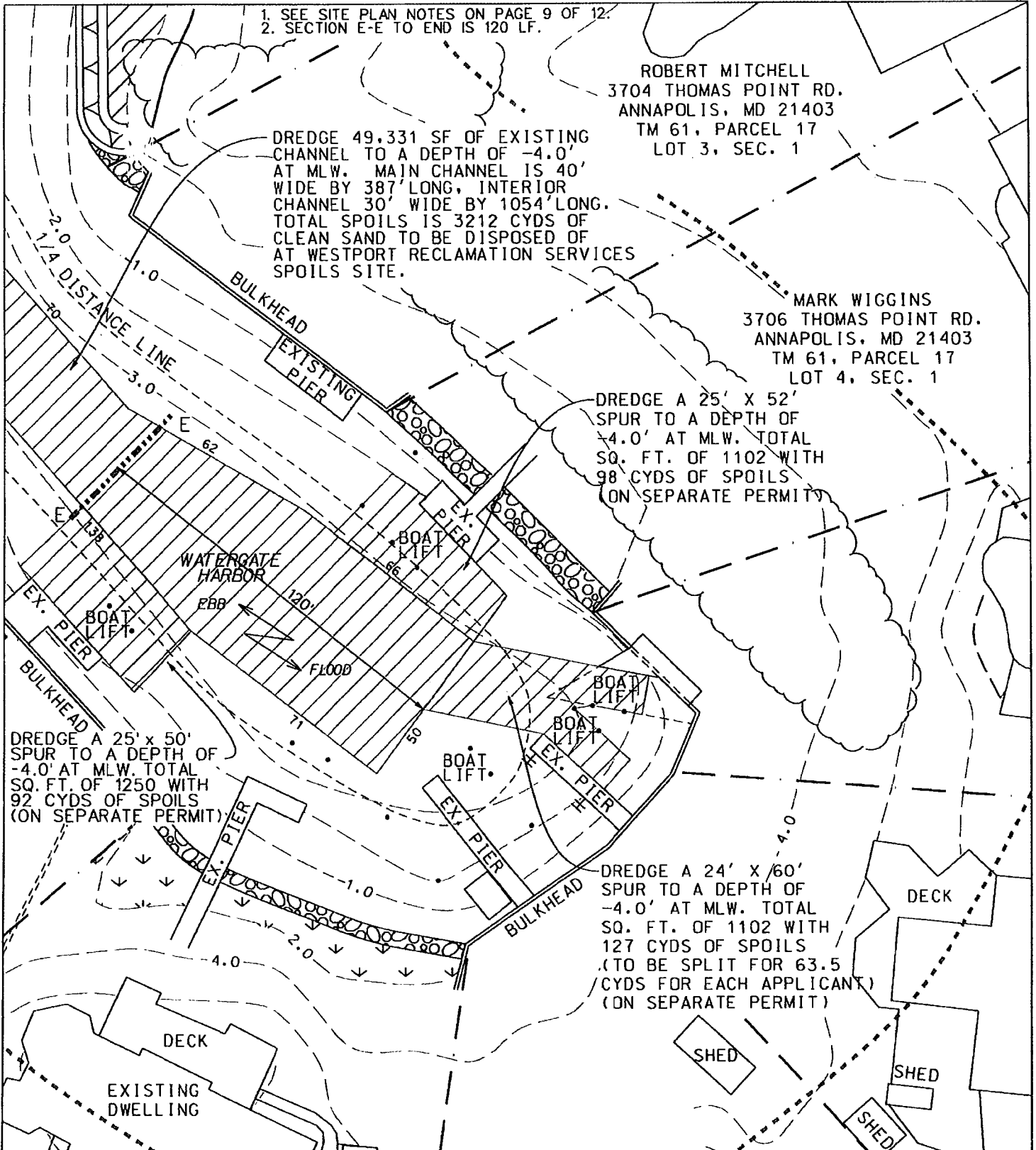

Tax Account No.:
 N/A
 Tax Map: 61
 Parcel: 17
 Deed Ref: N/A
 Lot: Harbor
 Zoning: N/A
 Lot Size: N/A





SITE PLAN - 6
SCALE: 1" = 40'
 Waterfront Engineering, Design,
 and Construction, Inc.
 303 Najoles Rd. St. 114
 Millersville, MD 21108
 (410) 703-8533
 waterfrontdesign@verizon.net

PROPOSED: Maintenance dredging work. **REVISED 11/1/2014**
 in: Watergate Harbor State: Maryland
 co: Anne Arundel at: Watergate
 Application by: Watergate Harbor Imp. Assoc.
 Sheet 6 of 12 Date: August 26, 2014

NOTE: This drawing is not an engineered drawing. All dimensions and measurements shall be field verified by contractor.
 Applicant's Signature:

GENERAL NOTES

1. ZONING: R2
2. LOT SETBACKS: FRONT: 30 FEET PRINCIPAL
REAR: 25 FEET
SIDE: 7 FEET/20 FEET COMBINED
3. PREDOMINANT SOIL TYPE: MZA - MISPELLION & TRANSQUAKING SOILS
4. TOTAL SF OF SITE: N/A SF OR N/A ACRES.
5. PROPOSED DREDGE/EXCAVATION AREA: 49,331 S.F. 1.13 ACRES
6. A. A. COUNTY TOPO SHEET: U25
7. F.E.M.A. RATE MAP: 240008-0261E ZONE AE, EL. 7.2
8. THIS LOT IS IN THE 100 YEAR FLOOD AREA AND A BUFFER MODIFIED AREA.
9. ELEVATIONS SHOWN ON THIS PLAN WERE OBTAINED FROM COUNTY RUN SURVEY. ELEVATIONS SHOWN ARE TIED INTO COUNTY MONUMENTS AND THE DATUM OF 0.0 FEET IS EQUAL TO MEAN LOW WATER. ANY CONTRACTOR SHALL FIELD VERIFY TO THEIR SATISFACTION, ALL QUANTITIES AND MEASUREMENTS BEFORE BIDDING THE WORK SHOWN AND BEFORE CONDUCTING ANY OF THE PROPOSED WORK. WATERFRONT ENGINEERING, DESIGN AND CONSTRUCTION INC. IS NOT RESPONSIBLE FOR COST/QUANTITY OVERRAGES.
10. BOUNDARY INFORMATION OBTAINED FROM ANNE ARUNDEL COUNTY DEPARTMENT OF PUBLIC WORKS ENGINEERING WEBSITE, AS-BUILT UTILITY PLANS, MARYLAND DEPARTMENT OF ASSESSMENTS AND TAXATION, (PARCELS 17, 121 & 21, TAX MAPS 57 & 61), PLAT OF WATERGATE, SECTION 1, PLAT BOOK 32, PAGE 84, AND PLAT OF FISHING CREEK FARMS, PLAT NO. 9, PLAT BOOK 109, PAGE 45
11. PUBLIC WATER, PUBLIC SEWER.
12. SITE IS IN THE SOUTH RIVER WATERSHED.
13. SITE IS DESIGNATED AS LDA BY THE CRITICAL AREA COMMISSION.

LEGEND	
EXISTING CONTOUR	— 4.0 —
PROPOSED CONTOUR	● 4.0 ●
EX. MEAN LOW WATER (MLW)	- - - - -
EX. MEAN HIGH WATER (MHW)	- - - - -
EXISTING MARSH	
EXISTING TREE LINE	
PROPERTY LINE	- - - - -
LIMIT OF DISTURBANCE	— LOD —
TURBIDITY CURTAIN	— TBC —
100' TIDAL BUFFER	- - - - -
EXISTING RP-RAP	
PROPOSED RP-RAP	
PROPOSED DREDGING	

SEQUENCE OF CONSTRUCTION

1. OBTAIN ALL NECESSARY PERMITS. CONDUCT A PRECONSTRUCTION MEETING AT LEAST 48 HOURS PRIOR TO START. CONTACT THE MARYLAND DEPARTMENT OF THE ENVIRONMENT (MDE) AT 410-537-3510, ANNE ARUNDEL COUNTY GRADING INSPECTOR AT 410-222-7780, AND THE RESPONSIBLE PERSONNEL. WORK MAY NOT COMMENCE UNTIL THE PERMITTEE OR THE RESPONSIBLE PERSONNEL HAVE MET ON-SITE WITH THE SEDIMENT AND EROSION CONTROL INSPECTOR TO REVIEW THE APPROVED PLANS. (1 DAY)
2. INSTALL ANY TEMPORARY SEDIMENT CONTROL MEASURES INCLUDING TEMPORARY SILT FENCE, TEMPORARY TURBIDITY CURTAIN (IF UTILIZED) AROUND ALL STONE WORK AREAS. NOTE THAT THE MDE INSPECTOR MAY AGREE THAT THE TEMPORARY TURBIDITY CURTAIN CAN BE ELIMINATED IF DEEMED NOT NECESSARY. ALL WORK DONE FROM BARGE. (3 DAYS)
3. REMOVE EXISTING GROIN IN SECTIONS AND INSTALL REPLACEMENT TIMBER GROIN AS SHOWN ON PLAN. (2 MONTHS)
4. MECHANICALLY DREDGE AREA AS SHOWN ON PLAN. DREDGE SPOILS TO BE PLACED ON BARGE TO DRY THEN OFF LOADED ONTO TRUCKS AND DISPOSED OF AT WESTPORT RECLAMATION SERVICES SITE. (2 MONTHS)
5. ONCE THE SITE IS FULLY STABILIZED AND THROUGH COORDINATION AND APPROVAL OF THE MARYLAND DEPARTMENT OF THE ENVIRONMENT AND THE ANNE ARUNDEL COUNTY GRADING INSPECTOR, REMOVE FINAL SEDIMENT CONTROL MEASURES.

NOTE:
THE SEQUENCE OF CONSTRUCTION AS LISTED ABOVE IS FOR THE USE BY THE CONTRACTOR AS A GENERAL GUIDELINE FOR SEQUENCING THE CONSTRUCTION OF ALL PROPOSED STRUCTURES. THE CONTRACTOR MAY ADJUST THE SEQUENCE OF CONSTRUCTION, AS NEEDED, UPON THE APPROVAL OF THE OWNER, THE COUNTY INSPECTOR AND THE MARYLAND DEPARTMENT OF THE ENVIRONMENT INSPECTOR.

Tax Account No.: N/A Tax Map: 61 Parcel: 17 Deed Ref: N/A Lot: Harbor Zoning: N/A Lot Size: N/A	NOTES SHEET Waterfront Engineering, Design, and Construction, Inc. 303 Najoles Rd. St. 114 Millersville, MD 21108 (410) 703-8533 waterfrontdesign@verizon.net	PROPOSED: REVISÉD 11/1/2014 Maintenance dredging work. in: Watergate Harbor State: Maryland co: Anne Arundel at: Watergate Application by: Watergate Harbor Imp. Assoc. Sheet 7 of 12 Date: August 26, 2014
--	--	--

NOTE: This drawing is not an engineered drawing. All dimensions and measurements shall be field verified by contractor.

Applicant's Signature:

NOTES:

1. Wood shall be grade #2 or better per AWPA Standards
 - (1) Piles - 2.5 lb/cu. ft. CCA Type C is required.
 - (2) Wales, Cap-Boards, and Sheeting - 2.5 lb/cu. ft. CCA is required.
2. All steel hardware shall be hot dip galvanized after fabrication and must be specified for marine use.
3. All wall piles must be a minimum length of 20' with 12" minimum tip and must be located 6' O/C.
4. This standard is for typical river conditions with firm granular soil. It does not take into account excessive water depth, poor soil conditions, scouring due to currents or waves, or heavy loads. Where site conditions differ the structure shall be designed and sealed by a Professional Engineer registered to practice in the State of Maryland.
 The details on this drawing are to be considered as minimum standards for specific conditions. It shall be the responsibility of the applicant/contractor to determine if conditions require design modifications. Waterfront Engineering, Design and Construction, Inc. and the Engineer assume no responsibility or liability for performance of the structure on this drawing.
5. All bolts to be thru bolted and recessed on outboard side. Minimum size of hardware is 1" diameter bolts with 3" x 1/4" NYDD washer and Nut.
6. Use 60d nails for attaching sheeting to wales and 20d nails to attach cap to wales.
7. Use copper pile caps.

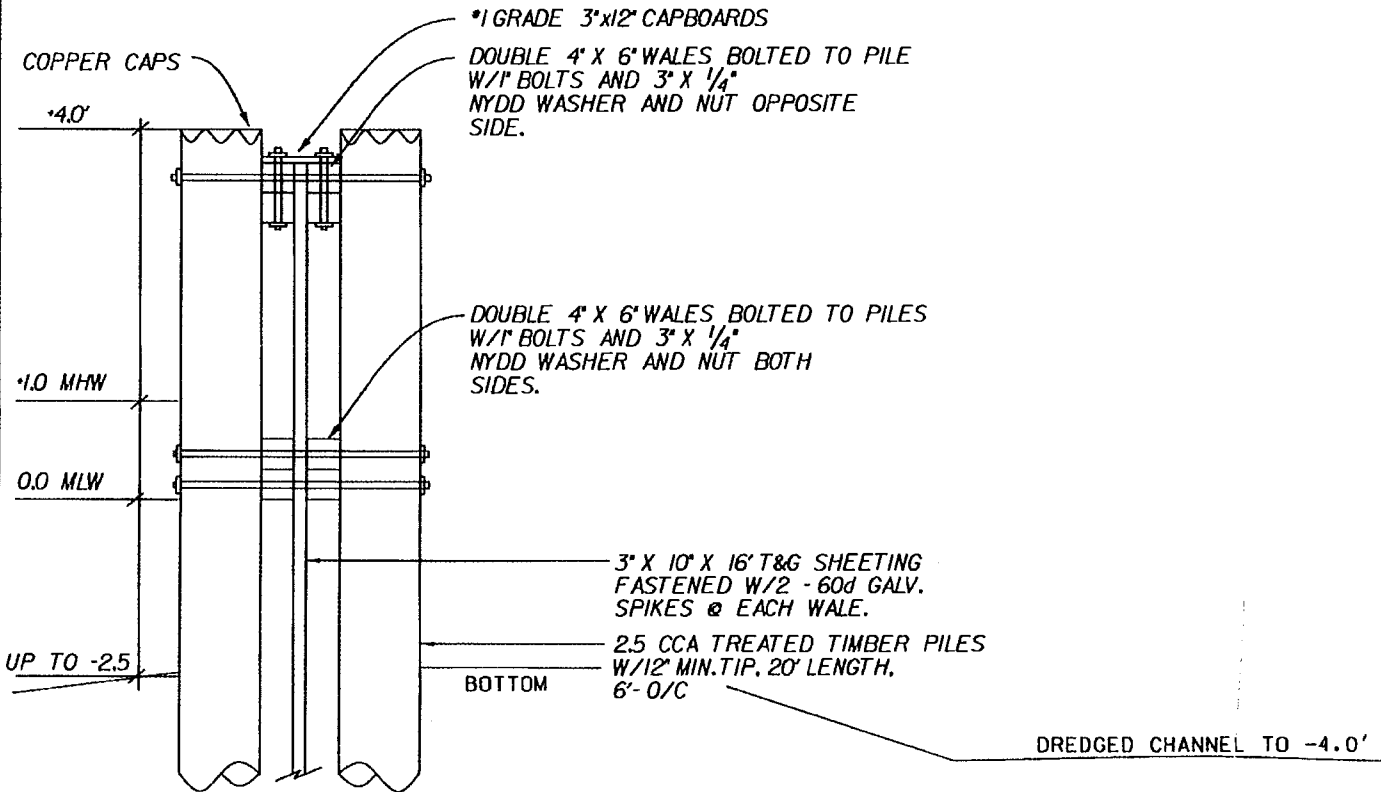

TYPICAL GROIN SECTION ALONG CHANNEL
SCALE: NTS

Tax Account No.:
N/A
Tax Map: 61
Parcel: 17
Deed Ref: N/A
Lot: Harbor
Zoning: N/A
Lot Size: N/A

**TIMBER GROIN
SPECIFICATION SHEET**
Waterfront Engineering, Design
and Construction, Inc.
303 Najoles Rd. St. 114
Millersville, MD 21108
(410) 703-8533
waterfrontdesign@verizon.net

PROPOSED: Maintenance dredging work. REVISED 11/1/2014
in: Watergate Harbor State: Maryland
co: Anne Arundel at: Watergate
Application by: Watergate Harbor Imp. Assoc.
Sheet 8 of 12 Date: August 26, 2014

NOTE: This drawing is not an engineered drawing. All dimensions and measurements shall be field verified by contractor.

Applicant's Signature:

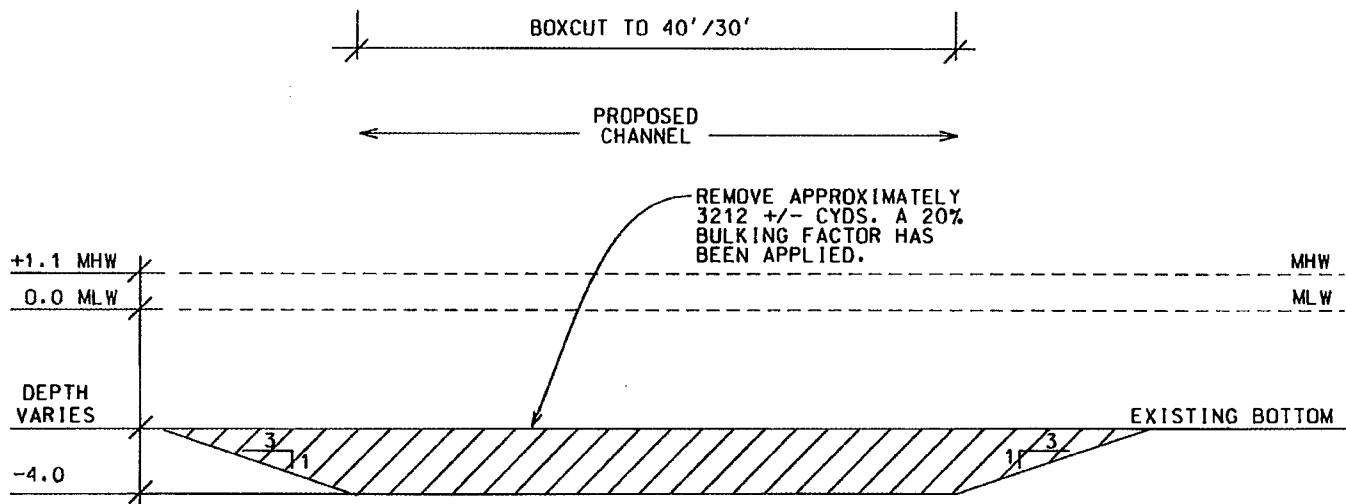

TYPICAL DREDGE CROSS SECTION IN CHANNEL
SCALE: NTS

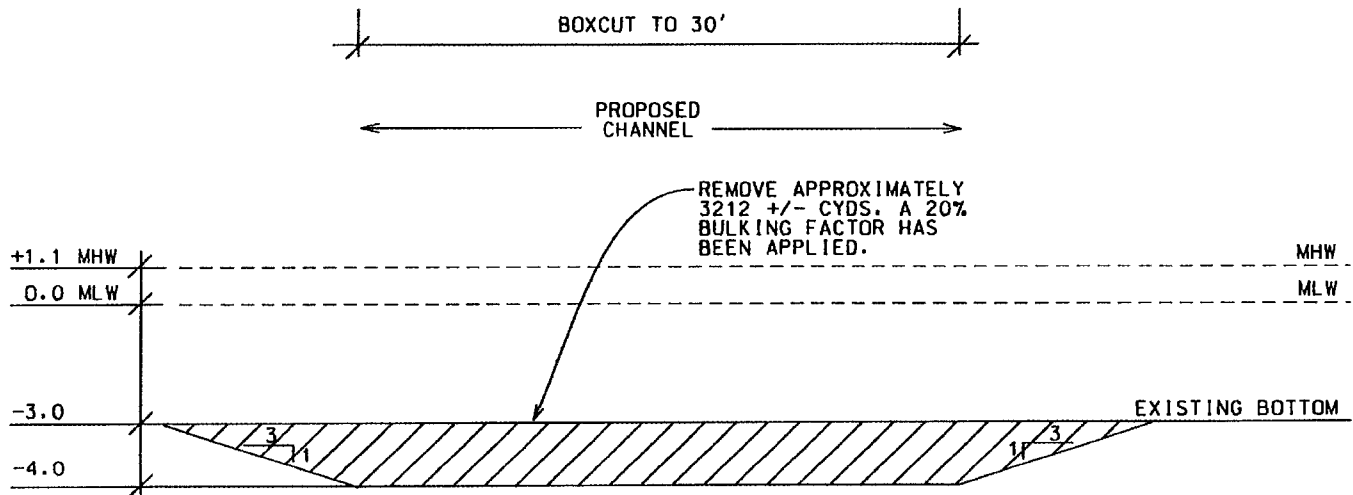

TYPICAL DREDGE CROSS SECTION AT
PREVIOUSLY DREDGED NODE OF SAND
(PERMIT 14-GL-0286)
SCALE: NTS

Tax Account No.:
N/A
Tax Map: 61
Parcel: 17
Deed Ref: N/A
Lot: Harbor
Zoning: N/A
Lot Size: N/A

DREDGE SPECS.

Waterfront Engineering, Design
and Construction, Inc.
303 Najoles Rd. St. 114
Millersville, MD 21108
(410) 703-8533
waterfrontdesign@verizon.net

PROPOSED:
Maintenance dredging work.

REVISED 11/1/2014

in: Watergate Harbor State: Maryland
co: Anne Arundel at: Watergate
Application by: Watergate Harbor Imp. Assoc.
Sheet 9a of 12 Date: August 26, 2014

NOTE: This drawing is not an engineered drawing. All dimensions and measurements shall be field verified by contractor.

Applicant's Signature:

SITE PLANS NOTES AND DISCLAIMERS

1. PROPERTY LINES SHOWN HEREON HAVE BEEN TAKEN FROM FIELD EVIDENCE, AND/OR AVAILABLE DEEDS AND PLATS AND SHOULD NOT BE CONSTRUED TO BE REPRESENTATIVE OF THE ACCURACY OF A BOUNDARY SURVEY. THIS IS NOT A BOUNDARY SURVEY! THIS SITE PLAN WAS DEVELOPED WITHOUT THE BENEFIT OF A TITLE SEARCH AND MAY NOT REFLECT ENCUMBRANCES, DEDICATIONS, AND/OR RESTRICTIONS WHICH MAY EXIST AND COULD POTENTIALLY BE REVEALED THROUGH A THOROUGH TITLE EXAMINATION.
2. ALL SHORELINE WORK WILL BE CONDUCTED FROM A BARGE WHICH IS TO BE LOADED FROM AN AUTHORIZED OFF-SITE LOCATION. THE LOD AS SHOWN AND WILL BE CONFINED TO THE SUBJECT PROPERTY.
3. CONTRACTOR IS RESPONSIBLE FOR THE LOCATION OF ANY PROPOSED STRUCTURES IN RELATION WITH THE PROPERTY CORNERS. NEIGHBORING STRUCTURES SHOWN ON THIS DRAWING AS APPROXIMATE IN LOCATION AND SHOULD NOT BE USED TO LOCATE NEW STRUCTURES. A SURVEY IS REQUIRED TO LOCATE AND NEW OR REPLACEMENT STRUCTURES. THIS SURVEY MUST BE PERFORMED BY A STATE OF MARYLAND LICENSED SURVEYOR.
4. THIS SITE PLAN HAS BEEN PREPARED TO REQUEST DREDGING OF COMMUNITY CHANNEL AND TO INSTALL A TIMBER GROIN. ANY CHANGE TO THESE PLANS WILL REQUIRE A SEPARATE PERMIT FROM ANNE ARUNDEL CO., FOR ABOVE MHW WORK AND IF WORK WILL BE IN THE WATER OR ALONG SHORELINE THE MARYLAND DEPARTMENT OF THE ENVIRONMENT AND THE CORPS OF ENGINEERS. THIS WILL REQUIRE MORE DETAILS AND INFORMATION AND THIS DRAWING SHALL NOT BE UTILIZED FOR SUCH LICENSES OR PERMITS.
5. CONTACT MS. UTILITY AT LEAST 48 HOURS PRIOR TO START OF ANY ON LAND OR IN WATER WORK. ALL UTILITIES MUST BE LOCATED PRIOR TO ANY CONSTRUCTION. THIS PLAN SHALL NOT BE UTILIZED FOR LOCATING ANY UTILITIES EITHER ABOVE OR BELOW GROUND.
6. TOPOGRAPHY WAS OBTAINED FROM 2011 ANNE ARUNDEL COUNTY DEPARTMENT OF PUBLIC WORKS SURVEY DATA. WATER DEPTHS WERE FIELD RUN BY WATERFRONT ENGINEERING, DESIGN AND CONSTRUCTION, INC. IN WINTER OF 2014. VERTICAL DATUM IS 0.0 FEET IS EQUAL TO MEAN LOW WATER.
7. IT SHOULD BE NOTED THAT WATER DEPTHS IN THIS AREA ARE CONSTANTLY CHANGING THEREFORE THE CONTRACTOR MUST FIELD VERIFY ALL QUANTITIES AND MEASUREMENTS TO THERE SATISFACTION. THESE PLANS ARE FOR PERMIT PURPOSES ONLY AND SHALL NOT BE UTILIZED FOR CONSTRUCTION PURPOSES OTHER THAN GENERAL LOCATION OF STRUCTURES.
8. A SUBMERGED AQUATIC VEGETATION (SAV) SURVEY WAS CONDUCTED BY THE PERMIT COORDINATORS, INC. ON 5-21-2014 AND NO SAVS WERE FOUND IN AND AROUND THE DREDGE AREA. SURVEY WAS CONDUCTED FROM A VESSEL. AREAS INSIDE THE CHANNEL ALONG WITH AREAS OUTSIDE THE GROIN AND ALONG THE INSIDE OF THE GROINS WERE RACKED AND NO SAVS WERE FOUND. VIMS DATA ALSO SHOWS NO HISTORICAL SAVS.

Tax Account No.: N/A Tax Map: 61 Parcel: 17 Deed Ref: N/A Lot: Harbor Zoning: N/A Lot Size: N/A	SITE PLAN NOTES Waterfront Engineering, Design and Construction, Inc. 303 Najoles Rd. St. 114 Millersville, MD 21108 (410) 703-8533 waterfrontdesign@verizon.net	PROPOSED: REVISED 11/1/2014 Maintenance dredging work. in: Watergate Harbor State: Maryland co: Anne Arundel at: Watergate Application by: Watergate Harbor Imp. Assoc. Sheet 9 of 12 Date: August 26, 2014
--	---	---

NOTE: This drawing is not an engineered drawing. All dimensions and measurements shall be field verified by contractor.

Applicant's Signature:

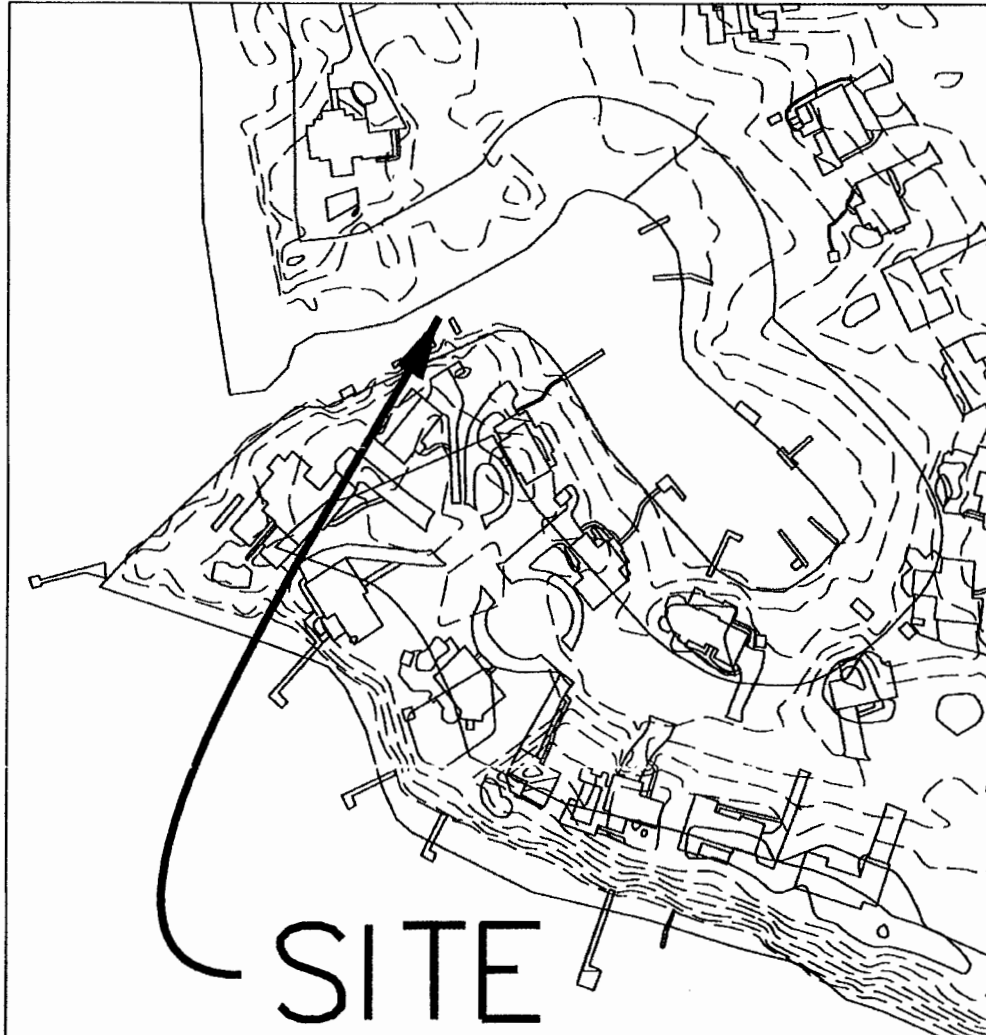

AREA DRAINAGE MAP SCALE: 1" = 200'

Tax Account No.:
N/A
Tax Map: 61
Parcel: 17
Deed Ref: N/A
Lot: Harbor
Zoning: N/A
Lot Size: N/A

DRAINAGE MAP SHT.
SCALE: AS NOTED
Waterfront Engineering, Design,
and Construction, Inc.
303 Najoles Rd. St. 114
Millersville, MD 21108
(410) 703-8533
waterfrontdesign@verizon.net

PROPOSED: REVISIED 11/1/2014
Maintenance dredging work.
in: Watergate Harbor State: Maryland
co: Anne Arundel at: Watergate
Application by: Watergate Harbor Imp. Assoc.
Sheet 10 of 12 Date: August 26, 2014

NOTE: This drawing is not an engineered drawing. All dimensions and measurements shall be field verified by contractor.

Applicant's Signature:

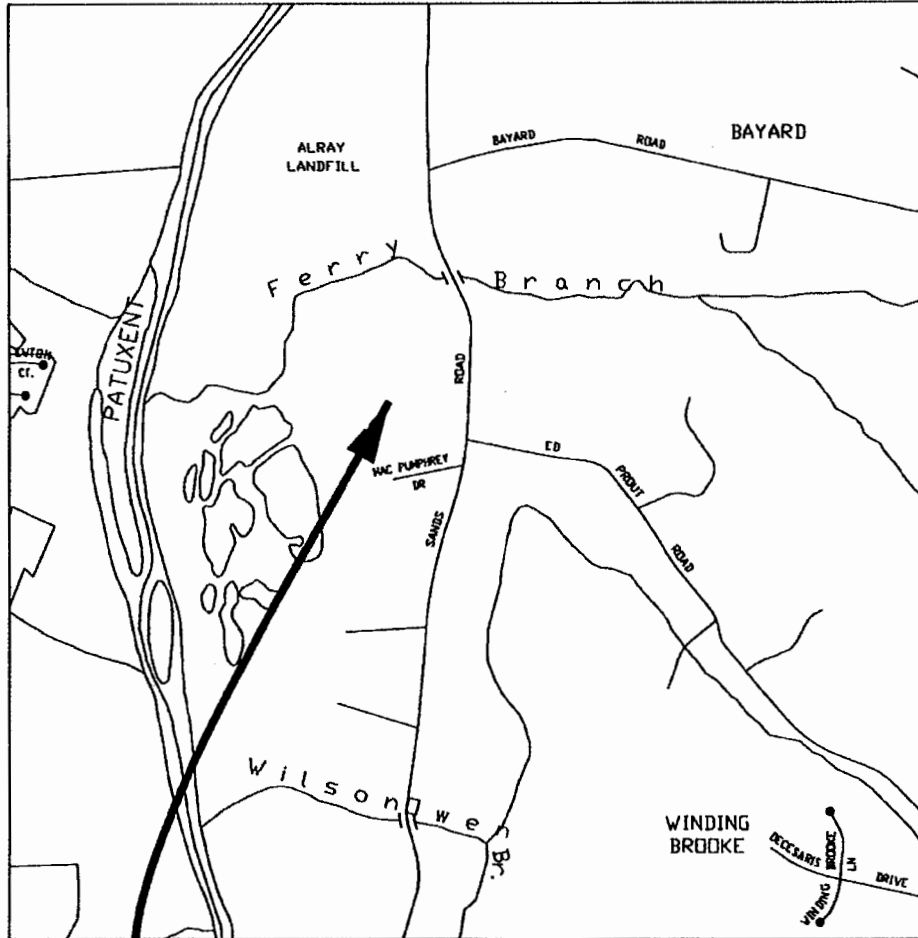

SITE

DREDGE SPOILS DISPOSAL SITE MAP
SCALE: 1" = 2000'

Tax Account No.:
N/A
Tax Map: 61
Parcel: 17
Deed Ref: N/A
Lot: Harbor
Zoning: N/A
Lot Size: N/A

**SPOILS DISPOSAL
MAP SHEET**
Waterfront Engineering, Design,
and Construction, Inc.
303 Najoles Rd. St. 114
Millersville, MD 21108
(410) 703-8533
waterfrontdesign@verizon.net

PROPOSED: Maintenance dredging work. REVISED 11/1/2014
in: Watergate Harbor State: Maryland
co: Anne Arundel at: Watergate
Application by: Watergate Harbor Imp. Assoc.
Sheet 11 of 12 Date: August 26, 2014

NOTE: This drawing is not an engineered drawing. All dimensions and measurements shall be field verified by contractor.

Applicant's Signature:

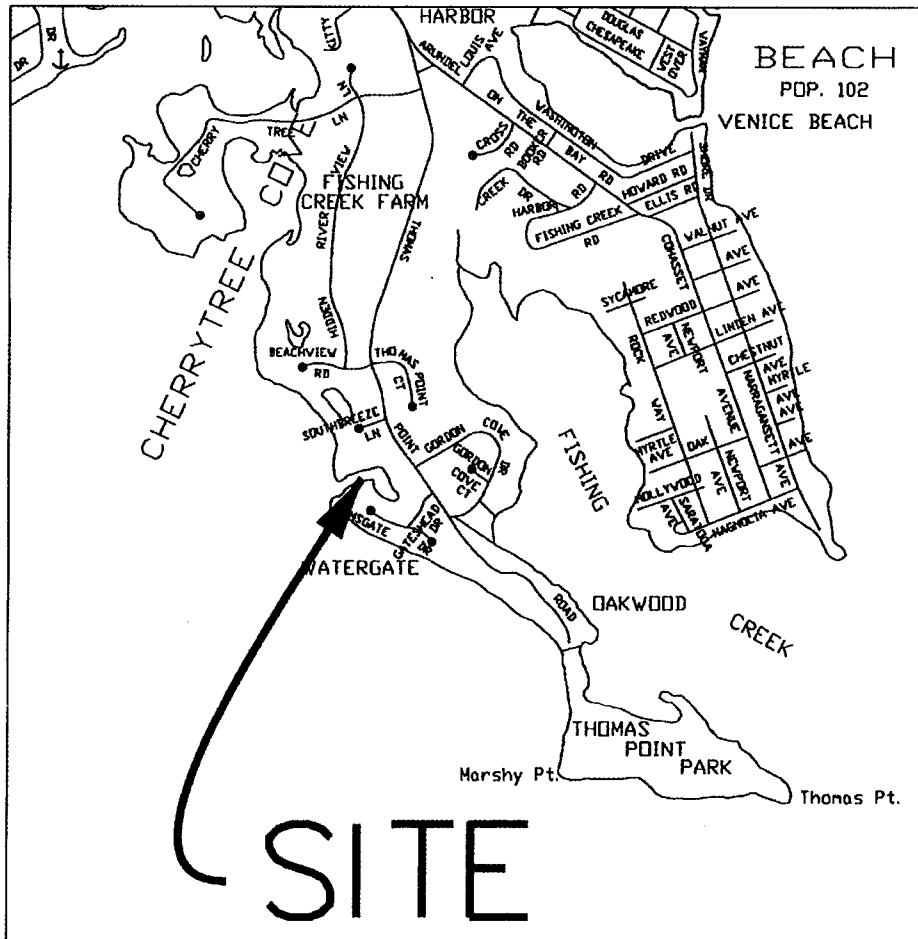

VICINITY MAP SCALE: 1" = 2000'

Tax Account No.:
N/A
Tax Map: 61
Parcel: 17
Deed Ref: N/A
Lot: Harbor
Zoning: N/A
Lot Size: N/A

VICINITY MAP SHT.
SCALE: AS NOTED
Waterfront Engineering, Design,
and Construction, Inc.
303 Najoles Rd. St. 114
Millersville, MD 21108
(410) 703-8533
waterfrontdesign@verizon.net

PROPOSED: Maintenance dredging work. REVISED 11/1/2014
in: Watergate Harbor State: Maryland
co: Anne Arundel at: Watergate
Application by: Watergate Harbor Imp. Assoc.
Sheet 12 of 12 Date: August 26, 2014

NOTE: This drawing is not on engineered drawing. All dimensions and measurements shall be field verified by contractor.

Applicant's Signature:

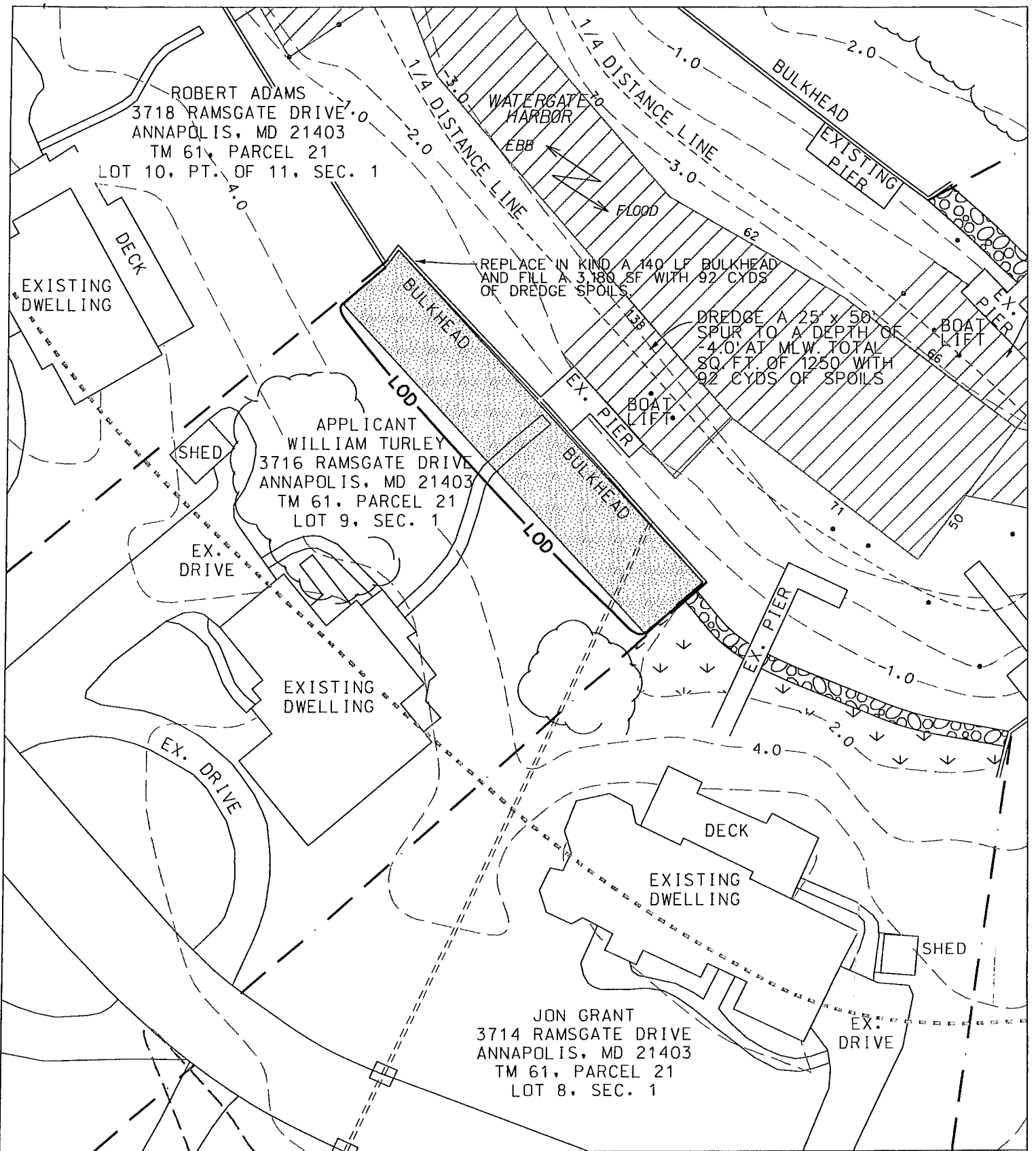

Tax Account No.:
2909-0381-6463
Tax Map: 61
Parcel: 21
Deed Ref: 20522/00511
Lot: 9
Zoning: R2
Lot Size: 23,907 SF

SITE PLAN
SCALE: 1" = 40'
Waterfront Engineering, Design,
and Construction, Inc.
303 Najoles Rd. St. 114
Millersville, MD 21108
(410) 703-8533
waterfrontdesign@verizon.net

PROPOSED:
Maintenance dredging work and a
replacement in kind bulkhead.
in: Watergate Harbor State: Maryland
co: Anne Arundel at: Watergate
Application by: William Turley
Sheet 1 of 7 Date: September 14, 2014

NOTE: This drawing is not an engineered drawing. All dimensions and measurements shall be field verified by contractor.

Applicant's Signature:

GENERAL NOTES

1. ZONING: R2
2. LOT SETBACKS: FRONT: 30 FEET PRINCIPAL
REAR: 25 FEET
SIDE: 7 FEET/20 FEET COMBINED
3. PREDOMINANT SOIL TYPE: MZA - MISPILLION & TRANSOUAKING SOILS
4. TOTAL SF OF SITE: N/A SF OR N/A ACRES.
5. PROPOSED DREDGE/EXCAVATION AREA: 1,250 S.F. 0.03 ACRES
6. A. A. COUNTY TOPO SHEET: U25
7. F.E.M.A. RATE MAP: 240008-0261E ZONE AE, EL. 7.2
8. THIS LOT IS IN THE 100 YEAR FLOOD AREA AND A BUFFER MODIFIED AREA.
9. ELEVATIONS SHOWN ON THIS PLAN WERE OBTAINED FROM COUNTY RUN SURVEY. ELEVATIONS SHOWN ARE TIED INTO COUNTY MONUMENTS AND THE DATUM OF 0.0 FEET IS EQUAL TO MEAN LOW WATER. ANY CONTRACTOR SHALL FIELD VERIFY TO THEIR SATISFACTION. ALL QUANTITIES AND MEASUREMENTS BEFORE BIDDING THE WORK SHOWN AND BEFORE CONDUCTING ANY OF THE PROPOSED WORK. WATERFRONT ENGINEERING, DESIGN AND CONSTRUCTION INC. IS NOT RESPONSIBLE FOR COST/QUANTITY OVERAGES.
10. BOUNDARY INFORMATION OBTAINED FROM ANNE ARUNDEL COUNTY DEPARTMENT OF PUBLIC WORKS ENGINEERING WEBSITE, AS-BUILT UTILITY PLANS, MARYLAND DEPARTMENT OF ASSESSMENTS AND TAXATION, (PARCEL 17, TAX MAP 61), PLAT OF WATERGATE, SECTION 1, PLAT BOOK 32, PAGE 84.
11. PUBLIC WATER, PUBLIC SEWER.
12. SITE IS IN THE SOUTH RIVER WATERSHED.
13. SITE IS DESIGNATED AS LDA BY THE CRITICAL AREA COMMISSION.

<i>LEGEND</i>	
EXISTING CONTOUR	— 4.0 —
PROPOSED CONTOUR	●— 4.0 —●
EX. MEAN LOW WATER (MLW)	— · — · — · — · —
EX. MEAN HIGH WATER (MHW)	— — — — —
EXISTING MARSH GRASSES.....	
EXISTING TREE LINE	
PROPERTY LINE	— · — · — · — · —
LIMIT OF DISTURBANCE	— LOD —
TURBIDITY CURTAIN	— TBC —
100' TIDAL BUFFER	100' 50' 100' 50' 100'
EXISTING RIP-RAP	
PROPOSED RIP-RAP	
PROPOSED DREDGING	

SEQUENCE OF CONSTRUCTION

1. OBTAIN ALL NECESSARY PERMITS. CONDUCT A PRECONSTRUCTION MEETING AT LEAST 48 HOURS PRIOR TO START. CONTACT THE MARYLAND DEPARTMENT OF THE ENVIRONMENT (MDE) AT 410-537-3510, ANNE ARUNDEL COUNTY GRADING INSPECTOR AT 410-222-7780, AND THE RESPONSIBLE PERSONNEL. WORK MAY NOT COMMENCE UNTIL THE PERMITTEE OR THE RESPONSIBLE PERSONNEL HAVE MET ON-SITE WITH THE SEDIMENT AND EROSION CONTROL INSPECTOR TO REVIEW THE APPROVED PLANS. (1 DAY)
2. INSTALL ANY TEMPORARY SEDIMENT CONTROL MEASURES INCLUDING TEMPORARY SILT FENCE, TEMPORARY TURBIDITY CURTAIN (IF UTILIZED) AROUND ALL STONE WORK AREAS. NOTE THAT THE MDE INSPECTOR MAY AGREE THAT THE TEMPORARY TURBIDITY CURTAIN CAN BE ELIMINATED IF DEEMED NOT NECESSARY. ALL WORK DONE FROM BARGE. (3 DAYS)
3. DREDGE AREA AS SHOWN ON PLAN AND STORE MATERIAL AND PLACE ON BARGE. (1 DAY)
4. INSTALL BULKHEAD AS SHOWN ON PLAN AND BACKFILL UPON COMPLETION. (3 WEEKS)
5. ONCE THE SITE IS FULLY STABILIZED AND THROUGH COORDINATION AND APPROVAL OF THE MARYLAND DEPARTMENT OF THE ENVIRONMENT AND THE ANNE ARUNDEL COUNTY GRADING INSPECTOR, REMOVE FINAL SEDIMENT CONTROL MEASURES.

NOTE:

THE SEQUENCE OF CONSTRUCTION AS LISTED ABOVE IS FOR THE USE BY THE CONTRACTOR AS A GENERAL GUIDELINE FOR SEQUENCING THE CONSTRUCTION OF ALL PROPOSED STRUCTURES. THE CONTRACTOR MAY ADJUST THE SEQUENCE OF CONSTRUCTION, AS NEEDED, UPON THE APPROVAL OF THE OWNER, THE COUNTY INSPECTOR AND THE MARYLAND DEPARTMENT OF THE ENVIRONMENT INSPECTOR.

Tax Account No.:
2909-0381-6463
Tax Map: 61
Parcel: 21
Deed Ref: 20522/00511
Lot: 9
Zoning: R2
Lot Size: 23,907 SF

NOTES SHEET

Waterfront Engineering, Design,
and Construction, Inc.
303 Najoles Rd. St. 114
Millersville, MD 21108
(410) 703-8533
waterfrontdesign@verizon.net

PROPOSED:
Maintenance dredging work and a
replacement in kind bulkhead.

in: Watergate Harbor State: Maryland
co: Anne Arundel at: Watergate
Application by: William Turley
Sheet 2 of 7 Date: September 14, 2014

NOTE: This drawing is not an engineered drawing. All dimensions and measurements shall be field verified by contractor.

Applicant's Signature:

SITE DATA

TOTAL LOT SIZE = 23,907 SF
CRITICAL AREA DESIGNATION = LDA
ZONING = R2
DISTURBED AREA = 3,680 SF

IMPERVIOUS DATA:
HOUSE = 2,982 SF
SIDEWALKS/DRIVEWAYS = 4,507 SF
ACCESSORY STRUCTURES = 191 SF
TOTAL IMPERVIOUS = 7,680 SF

WOODLANDS DATA:
EXISTING WOODLANDS = 2,896 SF
EXISTING MARSH = 00 SF
MARSH REMOVED = 00 SF
TREES REMOVED = 00 SF
REFORESTATION PROPOSED = 00 SF
BOND AMOUNT = 3,680 X \$1.50 = \$5,520.00
INSPECTION FEE = 0.07 X \$5,520.00 = \$386.40
TOTAL FEE = \$5,520.00 + \$386.40 = \$5,906.40

SITE PLANS NOTES AND DISCLAIMERS

1. PROPERTY LINES SHOWN HEREON HAVE BEEN TAKEN FROM FIELD EVIDENCE, AND/OR AVAILABLE DEEDS AND PLATS AND SHOULD NOT BE CONSTRUED TO BE REPRESENTATIVE OF THE ACCURACY OF A BOUNDARY SURVEY. THIS IS NOT A BOUNDARY SURVEY! THIS SITE PLAN WAS DEVELOPED WITHOUT THE BENEFIT OF A TITLE SEARCH AND MAY NOT REFLECT ENCUMBRANCES, DEDICATIONS, AND/OR RESTRICTIONS WHICH MAY EXIST AND COULD POTENTIALLY BE REVEALED THROUGH A THOROUGH TITLE EXAMINATION.
2. ALL SHORELINE WORK WILL BE CONDUCTED FROM A BARGE WHICH IS TO BE LOADED FROM AN AUTHORIZED OFF-SITE LOCATION. THE LOD AS SHOWN AND WILL BE CONFINED TO THE SUBJECT PROPERTY.
3. CONTRACTOR IS RESPONSIBLE FOR THE LOCATION OF ANY PROPOSED STRUCTURES IN RELATION WITH THE PROPERTY CORNERS. NEIGHBORING STRUCTURES SHOWN ON THIS DRAWING AS APPROXIMATE IN LOCATION AND SHOULD NOT BE USED TO LOCATE NEW STRUCTURES. A SURVEY IS REQUIRED TO LOCATE AND NEW OR REPLACEMENT STRUCTURES. THIS SURVEY MUST BE PERFORMED BY A STATE OF MARYLAND LICENSED SURVEYOR.
4. THIS SITE PLAN HAS BEEN PREPARED TO REQUEST DREDGING OF COMMUNITY CHANNEL. ANY CHANGE TO THESE PLANS WILL REQUIRE A SEPARATE PERMIT FROM ANNE ARUNDEL CO., FOR ABOVE MHW WORK AND IF WORK WILL BE IN THE WATER OR ALONG SHORELINE THE MARYLAND DEPARTMENT OF THE ENVIRONMENT AND THE CORPS OF ENGINEERS. THIS WILL REQUIRE MORE DETAILS AND INFORMATION AND THIS DRAWING SHALL NOT BE UTILIZED FOR SUCH LICENSES OR PERMITS.
5. CONTACT MS. UTILITY AT LEAST 48 HOURS PRIOR TO START OF ANY ON LAND OR IN WATER WORK. ALL UTILITIES MUST BE LOCATED PRIOR TO ANY CONSTRUCTION. THIS PLAN SHALL NOT BE UTILIZED FOR LOCATING ANY UTILITIES EITHER ABOVE OR BELOW GROUND.
6. TOPOGRAPHY WAS OBTAINED FROM 2011 ANNE ARUNDEL COUNTY DEPARTMENT OF PUBLIC WORKS SURVEY DATA. WATER DEPTHS WERE FIELD RUN BY WATERFRONT ENGINEERING, DESIGN AND CONSTRUCTION, INC. IN WINTER OF 2014. VERTICAL DATUM IS 0.0 FEET IS EQUAL TO MEAN LOW WATER.
7. IT SHOULD BE NOTED THAT WATER DEPTHS IN THIS AREA ARE CONSTANTLY CHANGING THEREFORE THE CONTRACTOR MUST FIELD VERIFY ALL QUANTITIES AND MEASUREMENTS TO THERE SATISFACTION. THESE PLANS ARE FOR PERMIT PURPOSES ONLY AND SHALL NOT BE UTILIZED FOR CONSTRUCTION PURPOSES OTHER THAN GENERAL LOCATION OF STRUCTURES.
8. AN SAV SURVEY WAS CONDUCTED BY WATERFRONT ENGINEERING, DESIGN AND CONSTRUCTION, INC. ON 5-21-2014 AND NO SAV'S WERE FOUND IN AND AROUND THE DREDGE AREA. VIMS DATA ALSO SHOWS NO HISTORICAL SAVS.

Tax Account No.: 2909-0381-6463 Tax Map: 61 Parcel: 21 Deed Ref: 20522/00511 Lot: 9 Zoning: R2 Lot Size: 23,907 SF	JOB DATA SHEET SCALE: N/A	PROPOSED: Maintenance dredging work and a replacement in kind bulkhead.
	Waterfront Engineering, Design, and Construction, Inc. 303 Najoles Rd. St. 114 Millersville, MD 21108 (410) 703-8533 waterfrontdesign@verizon.net	in: Watergate Harbor State: Maryland co: Anne Arundel at: Watergate Application by: William Turley Sheet 3 of 7 Date: September 14, 2014

NOTE: This drawing for permit purpose only. All dimensions are approximate and were provided by the applicant.

Applicant's Signature:

NOTES:

1. Wood shall be grade #2 or better per AWPA Standards
 - (1) Piles - 2.5 lb/cu. ft. CCA Type C is required.
 - (2) Wales, Cap-Boards, and Sheeting - 2.5 lb/cu. ft. CCA is required.
2. All steel hardware shall be hot dip galvanized after fabrication and must be specified for marine use.
3. All wall piles must be a minimum length of 24' with 12" minimum tip and must be located 5' O/C.
4. This standard is for typical river conditions with firm granular soil. It does not take into account excessive water depth, poor soil conditions, scouring due to currents or waves, or heavy loads. Where site conditions differ the structure shall be designed and sealed by a Professional Engineer registered to practice in the State of Maryland.
 The details on this drawing are to be considered as minimum standards for specific conditions. It shall be the responsibility of the applicant/contractor to determine if conditions require design modifications. The Permit Coordinators, Inc. assume no responsibility or liability for performance of the structure on this drawing.
5. All bolts to be thru bolted and recessed on outboard side. Minimum size of hardware is 3/4" diameter bolts with 3" x 1/4" NYDD washer and Nut.
6. Use 60d nails for attaching sheeting to wales and 20d nails to attach cap to wales.
7. Use copper pile caps.
8. Plumbing and electric to be extended thru new bulkhead.
9. This is not an engineered or sealed construction detail. This detail is for general permitting purposes only.

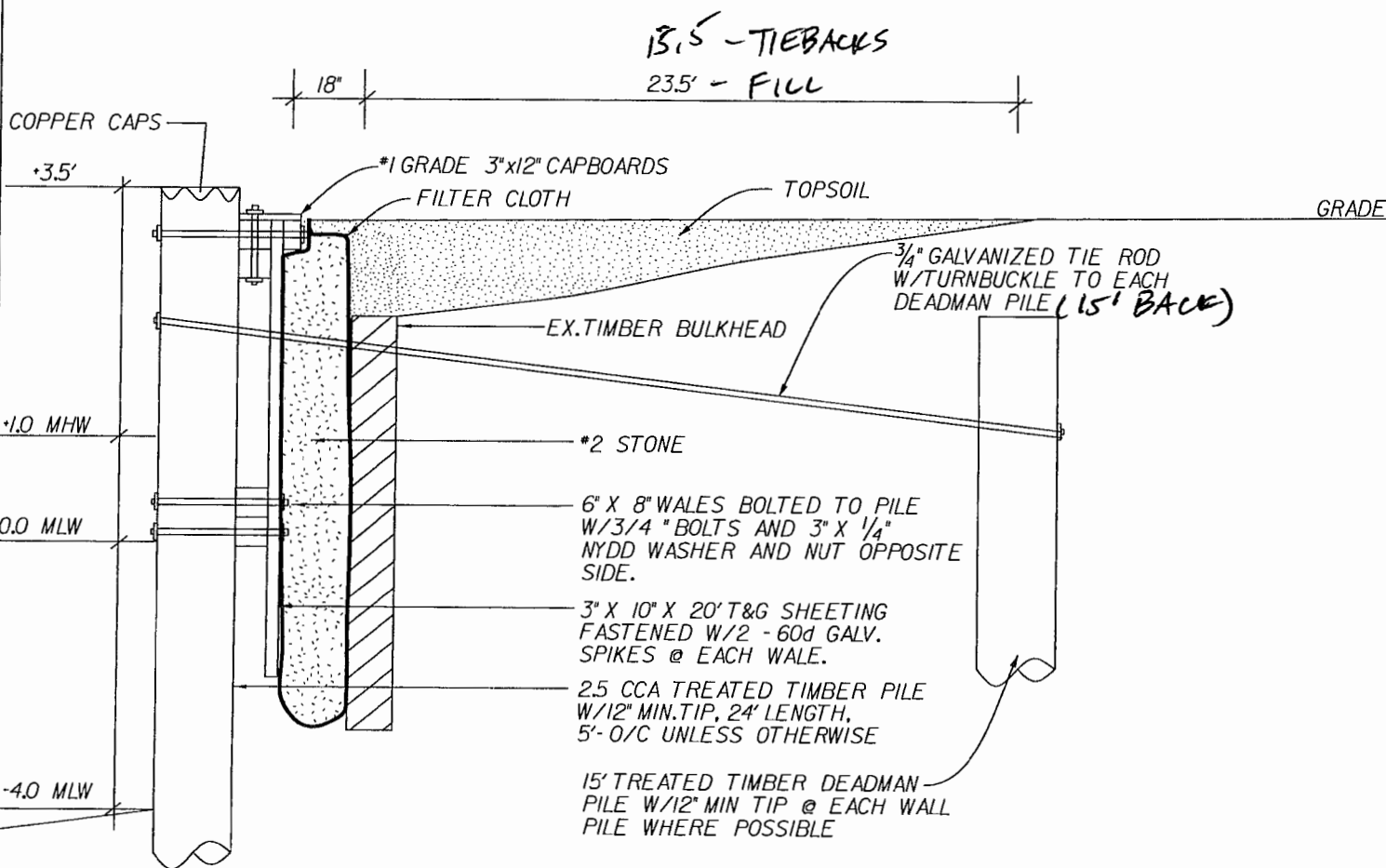

TYPICAL BULKHEAD CROSS SECTION SCALE: NTS

Tax Account No.:
2909-0381-6463
Tax Map: 61
Parcel: 21
Deed Ref: 20522/00511
Lot: 9
Zoning: R2
Lot Size: 23,907 SF

BULKHEAD SPECS.
SCALE: NTS
Waterfront Engineering, Design,
and Construction, Inc.
303 Najoles Rd. St. 114
Millersville, MD 21108
(410) 703-8533
waterfrontdesign@verizon.net





PROPOSED:
Maintenance dredging work and a
replacement in kind bulkhead.
in: Watergate Harbor State: Maryland
co: Anne Arundel at: Watergate
Application by: William Turley
Sheet 4 of 7 Date: September 14, 2014

NOTE: This drawing is for permit purposes only. All dimensions are approximate. This is not an engineered drawing.

Applicant's Signature:

GENERAL NOTES

1. ZONING: R2
2. LOT SETBACKS: FRONT: 30 FEET PRINCIPAL
REAR: 25 FEET
SIDE: 7 FEET/20 FEET COMBINED
3. PREDOMINANT SOIL TYPE: MZA - MISPELLION & TRANSQUAKING SOILS
4. TOTAL SF OF SITE: N/A SF OR N/A ACRES.
5. PROPOSED DREDGE/EXCAVATION AREA: 551 S.F. 0.02 ACRES
6. A. A. COUNTY TOPO SHEET: U25
7. F.E.M.A. RATE MAP: 240008-0261E ZONE AE, EL. 7.2
8. THIS LOT IS IN THE 100 YEAR FLOOD AREA AND A BUFFER MODIFIED AREA.
9. ELEVATIONS SHOWN ON THIS PLAN WERE OBTAINED FROM COUNTY RUN SURVEY. ELEVATIONS SHOWN ARE TIED INTO COUNTY MONUMENTS AND THE DATUM OF 0.0 FEET IS EQUAL TO MEAN LOW WATER. ANY CONTRACTOR SHALL FIELD VERIFY TO THEIR SATISFACTION, ALL QUANTITIES AND MEASUREMENTS BEFORE BIDDING THE WORK SHOWN AND BEFORE CONDUCTING ANY OF THE PROPOSED WORK. WATERFRONT ENGINEERING, DESIGN AND CONSTRUCTION INC. IS NOT RESPONSIBLE FOR COST/QUANTITY OVERAGES.
10. BOUNDARY INFORMATION OBTAINED FROM ANNE ARUNDEL COUNTY DEPARTMENT OF PUBLIC WORKS ENGINEERING WEBSITE, AS-BUILT UTILITY PLANS, MARYLAND DEPARTMENT OF ASSESSMENTS AND TAXATION, (PARCEL 17, TAX MAP 61), A PLAT OF WATERFRONT SOILS, PUBLIC WATER, PUBLIC SEWER, WITH 63.5 CYDS OF SPOILS PLAT BOOK 32, PAGE 84.551.
11. SITE IS IN THE SOUTH RIVER WATERSHED.
12. SITE IS DESIGNATED AS LDA BY THE CRITICAL AREA COMMISSION.

<i>LEGEND</i>	
EXISTING CONTOUR	— 4.0 —
PROPOSED CONTOUR	● 4.0 ●
EX. MEAN LOW WATER (MLW)	- - - - -
EX. MEAN HIGH WATER (MHW)	- - - - -
EXISTING MARSH GRASSES.....	
EXISTING TREE LINE	
PROPERTY LINE	- - - - -
LIMIT OF DISTURBANCE	— LOD —
TURBIDITY CURTAIN	— TBC —
100' TIDAL BUFFER	- - - - -
EXISTING RIP-RAP	
PROPOSED RIP-RAP	
PROPOSED DREDGING	

SEQUENCE OF CONSTRUCTION

1. OBTAIN ALL NECESSARY PERMITS. CONDUCT A PRECONSTRUCTION MEETING AT LEAST 48 HOURS PRIOR TO START. CONTACT THE MARYLAND DEPARTMENT OF THE ENVIRONMENT (MDE) AT 410-537-3510, ANNE ARUNDEL COUNTY GRADING INSPECTOR AT 410-222-7780, AND THE RESPONSIBLE PERSONNEL. WORK MAY NOT COMMENCE UNTIL THE PERMITTEE OR THE RESPONSIBLE PERSONNEL HAVE MET ON-SITE WITH THE SEDIMENT AND EROSION CONTROL INSPECTOR TO REVIEW THE APPROVED PLANS. (1 DAY)
2. INSTALL ANY TEMPORARY SEDIMENT CONTROL MEASURES INCLUDING TEMPORARY SILT FENCE, TEMPORARY TURBIDITY CURTAIN (IF UTILIZED) AROUND ALL STONE WORK AREAS. NOTE THAT THE MDE INSPECTOR MAY AGREE THAT THE TEMPORARY TURBIDITY CURTAIN CAN BE ELIMINATED IF DEEMED NOT NECESSARY. ALL WORK DONE FROM BARGE. (3 DAYS)
3. DREDGE AREA AS SHOWN ON PLAN. (2 WEEKS)
4. BUILD PIER AND WALKWAY. (1 WEEK)
5. ONCE THE SITE IS FULLY STABILIZED AND THROUGH COORDINATION AND APPROVAL OF THE MARYLAND DEPARTMENT OF THE ENVIRONMENT AND THE ANNE ARUNDEL COUNTY GRADING INSPECTOR, REMOVE FINAL SEDIMENT CONTROL MEASURES.

NOTE:

THE SEQUENCE OF CONSTRUCTION AS LISTED ABOVE IS FOR THE USE BY THE CONTRACTOR AS A GENERAL GUIDELINE FOR SEQUENCING THE CONSTRUCTION OF ALL PROPOSED STRUCTURES. THE CONTRACTOR MAY ADJUST THE SEQUENCE OF CONSTRUCTION, AS NEEDED, UPON THE APPROVAL OF THE OWNER, THE COUNTY INSPECTOR AND THE MARYLAND DEPARTMENT OF THE ENVIRONMENT INSPECTOR.

Tax Account No.:
2909-0156-6660
Tax Map: 61
Parcel: 17
Deed Ref: 12512/00772
Lot: 5
Zoning: R2
Lot Size: 28,960 SF

NOTES SHEET

Waterfront Engineering, Design,
and Construction, Inc.
303 Najoles Rd. St. 114
Millersville, MD 21108
(410) 703-8533
waterfrontdesign@verizon.net

PROPOSED:

Maintenance dredging work.

in: Watergate Harbor State: Maryland
co: Anne Arundel at: Watergate
Application by: Lyle Moldin
Sheet 4 of 8 Date: September 14, 2014

NOTE: This drawing is not an engineered drawing. All dimensions and measurements shall be field verified by contractor.

Applicant's Signature:

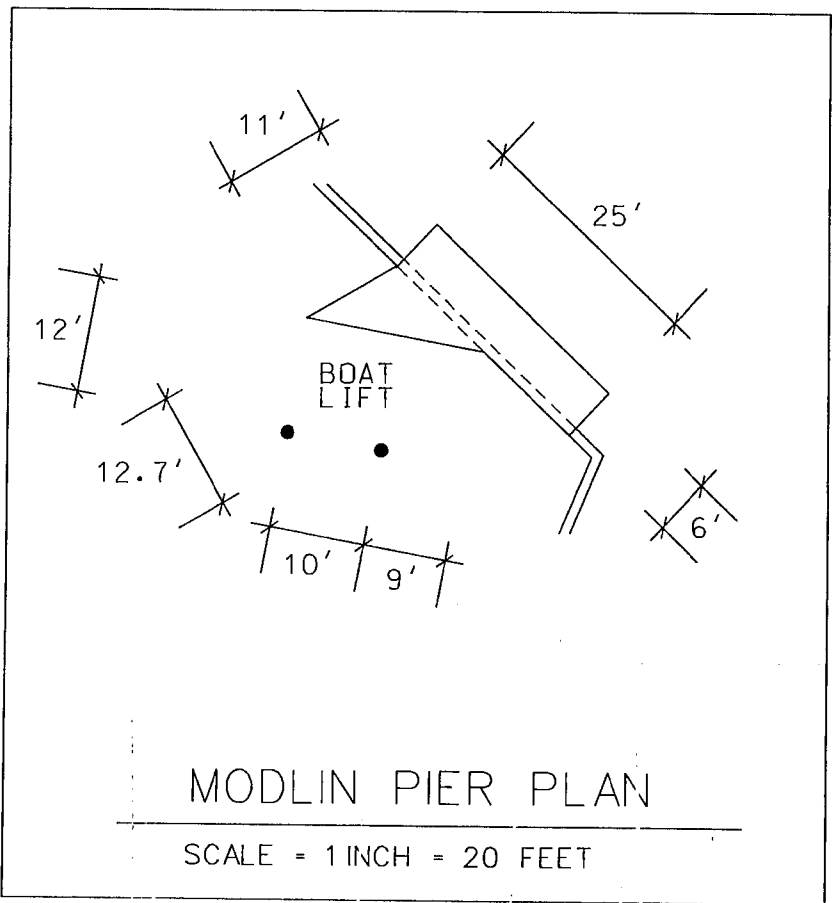

Tax Account No.:
2909-0156-6660
Tax Map: 61
Parcel: 17
Deed Ref: 12512/00772
Lot: 5
Zoning: R2
Lot Size: 28,960 SF

LAYOUT SHEET
CROSS SECTIONS

Waterfront Engineering, Design
and Construction, Inc.
303 Najoles Rd. St. 114
Millersville, MD 21108
(410) 703-8533
waterfrontdesign@verizon.net

PROPOSED:
Maintenance dredging work.

in: Watergate Harbor State: Maryland
co: Anne Arundel at: Watergate
Application by: Lyle Moldin
Sheet 3 of 8 Date: September 14, 2014

NOTE: This drawing is not an engineered drawing. All dimensions and measurements shall be field verified by contractor.

Applicant's Signature:

NOTE: ALL PILES MUST BE DRIVEN WHERE POSSIBLE.

PILE SIZE SCHEDULE

Water Depth (MLW)	Pile Diameter	Pile Length
0' - 3'	10"	30'
3' - 6'	12"	40'
6' - 9'	14"	50'

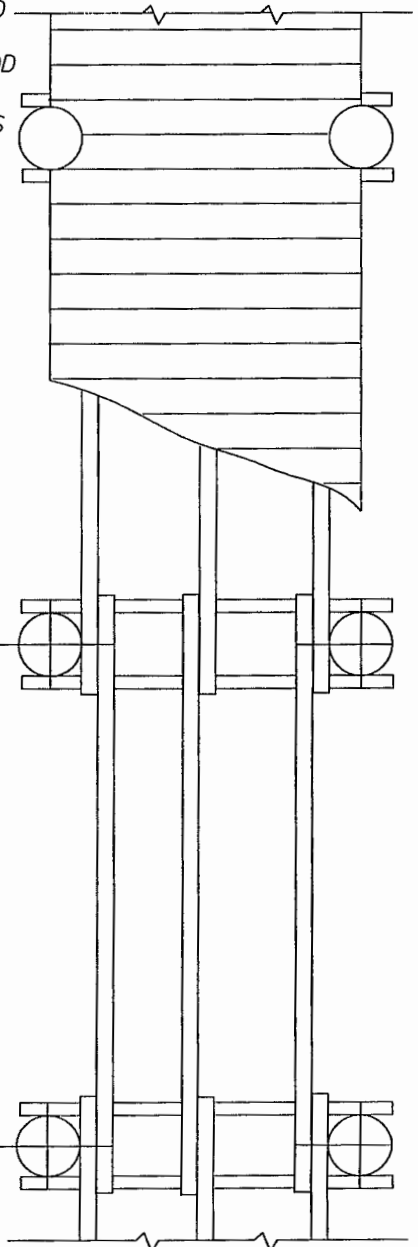
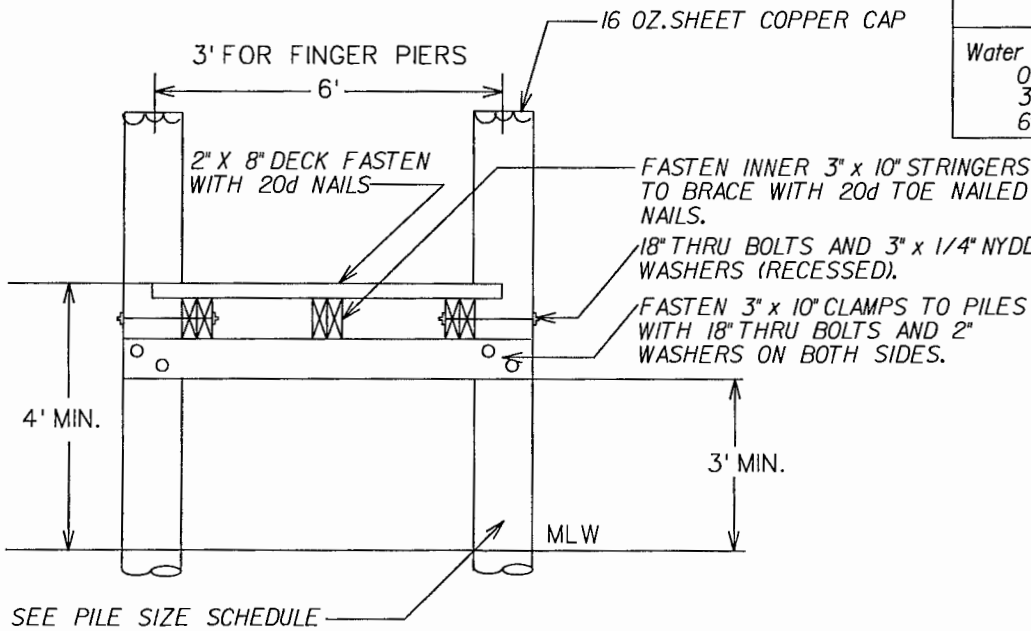

TYPICAL PIER CROSS SECTION
NOT TO SCALE

COPYRIGHT 2012

NOTES:

1. Wood shall be grade #2 or better per S.P.I.R. Standards. Treatment shall be per AWP Standards; (1) Piles - 2.5 lb/cu. ft. CCA Type C. For areas of severe marine infestation 2.5 lb/cu. ft. CCA is recommended; (2) Decking and stringers - 1.5 lb/cu. ft. Penta or 0.4 lb/cu. ft. CCA Type C.
2. All steel hardware shall be hot dip galvanized after fabrication.
3. For pier widths of 4' or less a center stringer is not required unless composite decking is applied.
4. For piles extending more than 5 ft. above mean low water, the pile length must be increased accordingly.
5. All steel hardware shall be a minimum of 1" with 3" x 1/4" NYDD washers.
6. This standard is for typical river conditions with firm granular soil. It does not take into account excessive water depth, poor soil conditions, scouring due to currents or waves, or heavy loads. Where site conditions differ the structure shall be designed and sealed by a Professional Engineer registered to practice in the State of Maryland.
7. The details on this drawing are to be considered as minimum standards for specific conditions. It shall be the responsibility of the applicant to determine if conditions require design modifications. The Permit Coordinators and the Engineer assume no responsibility or liability for performance of the structure on this drawing.
8. All bolts to be thru bolted and recessed on outboard side.
9. TPC, Inc. reserves the right to prosecute violators of federal copyright laws.

TYPICAL PIER PLAN
SCALE: NONE

Tax Account No.:
2909-0156-6660
Tax Map: 61
Parcel: 17
Deed Ref: 12512/00772
Lot: 5
Zoning: R2
Lot Size: 28,960 SF

PIER
SPECIFICATIONS
Waterfront Engineering, Design
and Construction, Inc.
303 Najoles Rd. St. 114
Millersville, MD 21108
(410) 703-8533
waterfrontdesign@verizon.net

PROPOSED:
Maintenance dredging work.
in: Watergate Harbor State: Maryland
co: Anne Arundel at: Watergate
Application by: Lyle Moldin
Sheet 2 of 8 Date: September 14, 2014

NOTE: This drawing is not an engineered drawing. All dimensions and measurements shall be field verified by contractor.

Applicant's Signature:

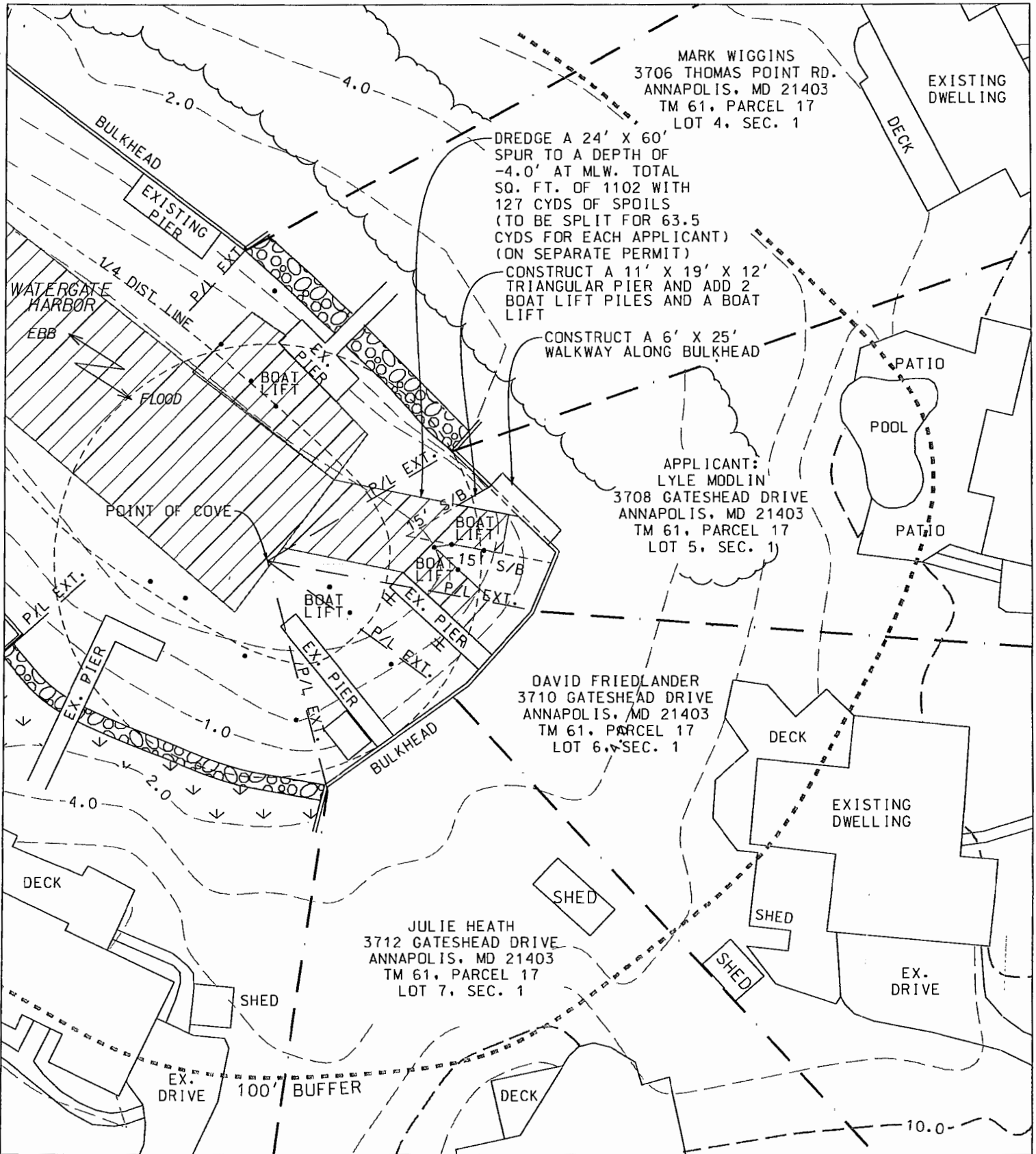

Tax Account No.:
2909-0156-6660
Tax Map: 61
Parcel: 17
Deed Ref: 12512/00772
Lot: 5
Zoning: R2
Lot Size: 28,960 SF

SITE PLAN
SCALE: 1" = 40'
Waterfront Engineering, Design,
and Construction, Inc.
303 Najoles Rd. St. 114
Millersville, MD 21108
(410) 703-8533
waterfrontdesign@verizon.net

PROPOSED:
Maintenance dredging work.
in: Watergate Harbor State: Maryland
co: Anne Arundel at: Watergate
Application by: Lyle Moldin
Sheet 1 of 8 Date: September 14, 2014

NOTE: This drawing is not an engineered drawing. All dimensions and measurements shall be field verified by contractor.
Applicant's Signature:

SITE PLAN NOTES ON SHEET 6 OF 8 APPLY.

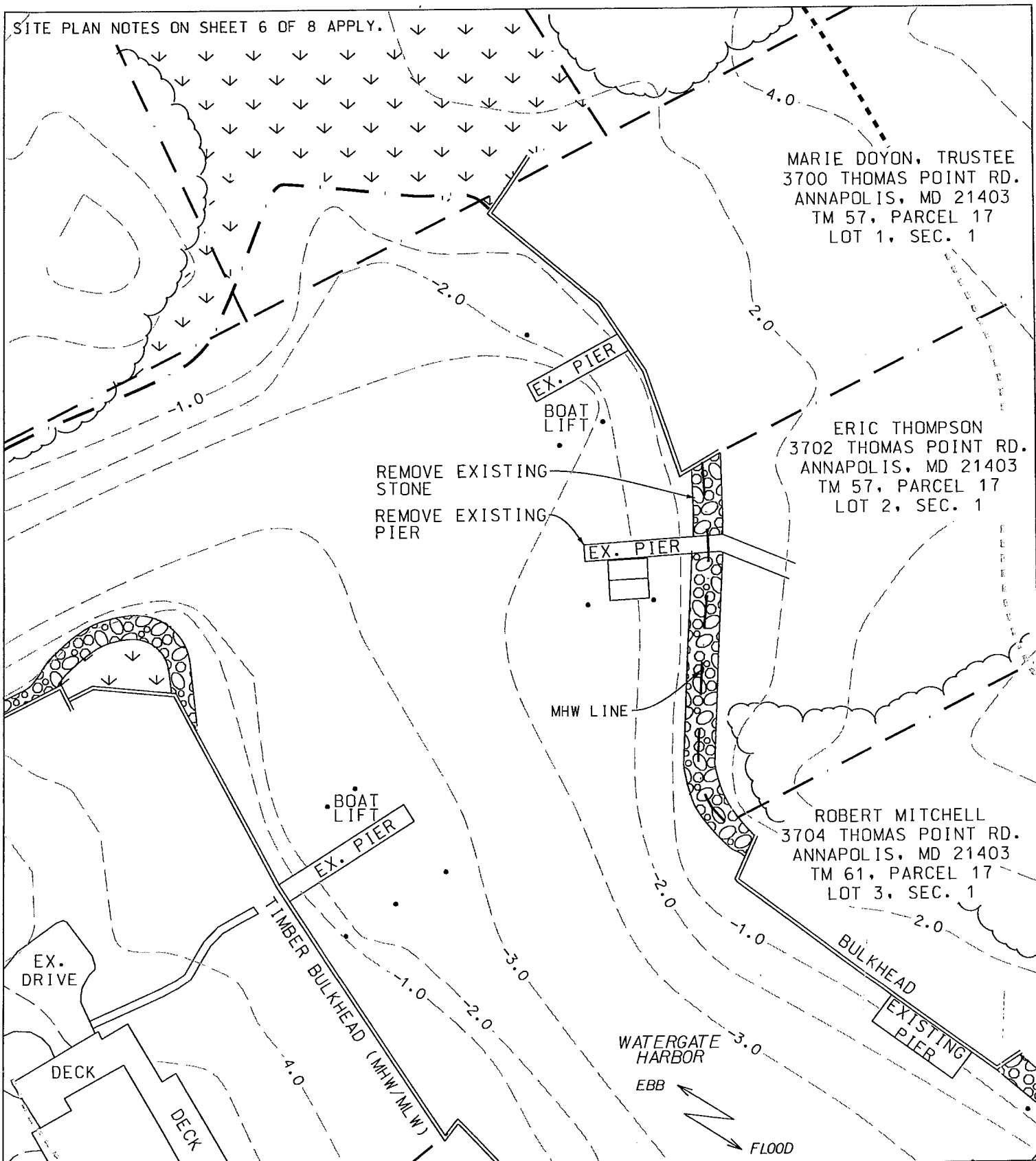

MARIE DOYON, TRUSTEE
 3700 THOMAS POINT RD.
 ANNAPOLIS, MD 21403
 TM 57, PARCEL 17
 LOT 1, SEC. 1

ERIC THOMPSON
 3702 THOMAS POINT RD.
 ANNAPOLIS, MD 21403
 TM 57, PARCEL 17
 LOT 2, SEC. 1

ROBERT MITCHELL
 3704 THOMAS POINT RD.
 ANNAPOLIS, MD 21403
 TM 61, PARCEL 17
 LOT 3, SEC. 1

Tax Account No.:
 2909-0763-4540
 Tax Map: 61
 Parcel: 17
 Deed Ref: 25843/312
 Lot: 2
 Zoning: R2
 Lot Size: 29,480 SF

EX. SITE PLAN
 SCALE: 1" = 40'
 Waterfront Engineering, Design
 and Construction, Inc.
 303 Najoles Rd. St. 114
 Millersville, MD 21108
 (410) 703-8533
 waterfrontdesign@verizon.net

PROPOSED: Pier and shoreline work. REVISÉD 10/27/2014
 in: Watergate Harbor State: Maryland
 co: Anne Arundel at: Watergate
 Application by: Eric Thompson
 Sheet 1 of 10 Date: February 22, 2014

NOTE: This drawing is not an engineered drawing. All dimensions and measurements shall be field verified by contractor.

Applicant's Signature:

SITE PLAN NOTES ON SHEET 6 OF 8 APPLY.

DREDGE A 15' X 59' SPUR TO A DEPTH OF -4.0' AT MLW. TOTAL SQ. FT. OF 833 WITH 74 CYDS OF SPOILS

MARIE DOYON, TRUSTEE
3700 THOMAS POINT RD.
ANNAPOLIS, MD 21403
TM 57, PARCEL 17
LOT 1, SEC. 1

APPLICANT:
ERIC THOMPSON
3702 THOMAS POINT RD.
ANNAPOLIS, MD 21403
TM 57, PARCEL 17
LOT 2, SEC. 1

CONSTRUCT A 6' X 45' PIER WHICH INCLUDES A 10' X 20' PLATFORM, A 6' X 5' WALKWAY, 2 BOAT LIFT PILES AND A BOAT LIFT

ROBERT MITCHELL
3704 THOMAS POINT RD.
ANNAPOLIS, MD 21403
TM 61, PARCEL 17
LOT 3, SEC. 1

RECONSTRUCT A 110 LF +/- STONE REVETMENT

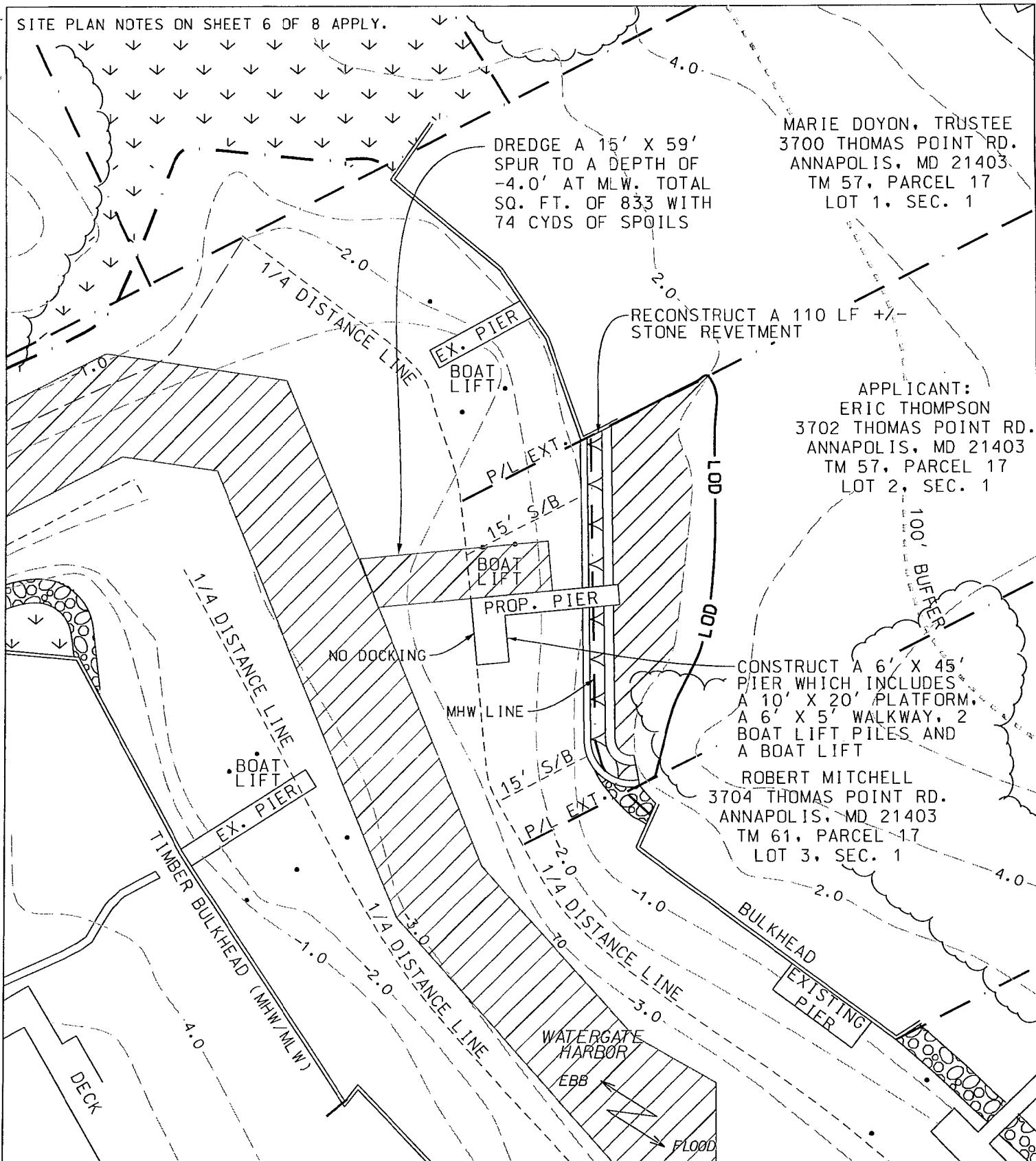

Tax Account No.:
2909-0763-4540
Tax Map: 61
Parcel: 17
Deed Ref: 25843/312
Lot: 2
Zoning: R2
Lot Size: 29,480 SF



PROP. SITE PLAN
SCALE: 1" = 40'

Waterfront Engineering, Design
and Construction, Inc.
303 Najoles Rd. St. 114
Millersville, MD 21108
(410) 703-8533
waterfrontdesign@verizon.net

PROPOSED:
Pier and shoreline work.

REVISED 10/27/2014

in: Watergate Harbor State: Maryland
co: Anne Arundel at: Watergate
Application by: Eric Thompson
Sheet 2 of 10 Date: February 22, 2014

NOTE: This drawing is not an engineered drawing. All dimensions and measurements shall be field verified by contractor.

Applicant's Signature:

NOTE: ALL PILES MUST BE DRIVEN WHERE POSSIBLE.

PILE SIZE SCHEDULE

Water Depth (MLW)	Pile Diameter	Pile Length
0' - 3'	10"	30'
3' - 6'	12"	40'
6' - 9'	14"	50'

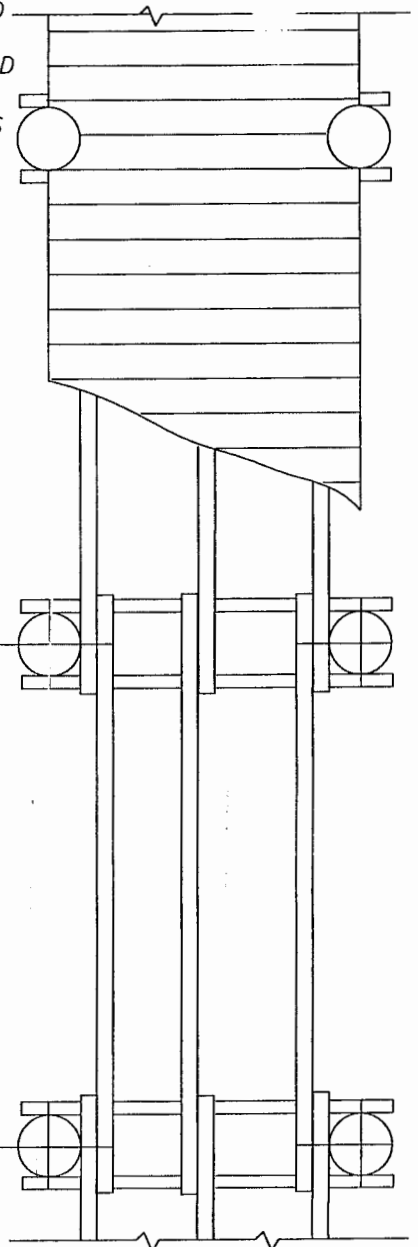
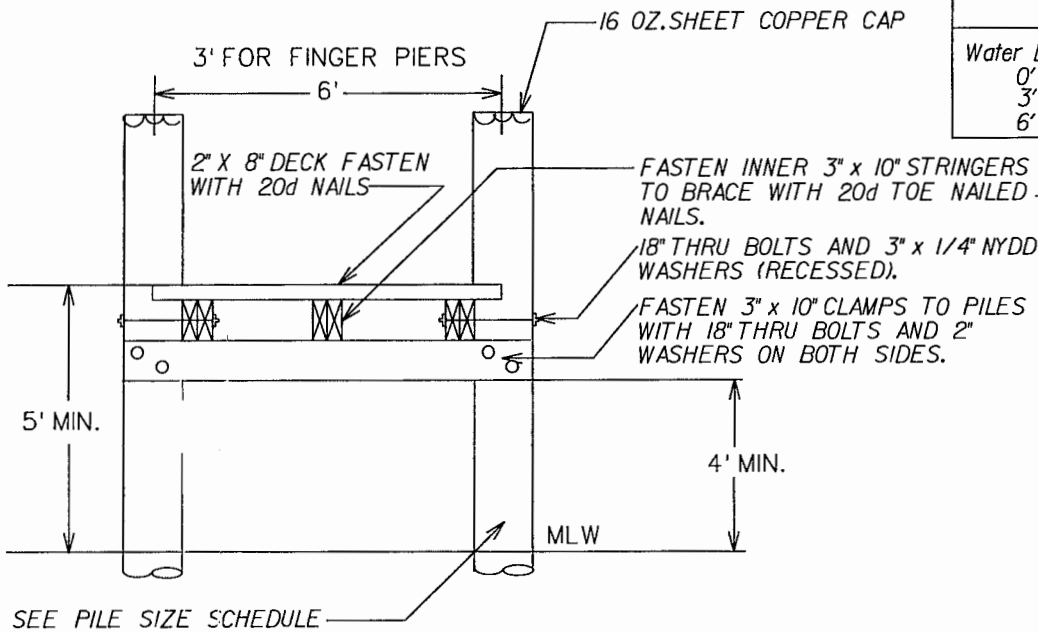

TYPICAL PIER CROSS SECTION
NOT TO SCALE

COPYRIGHT 2012

TYPICAL PIER PLAN
SCALE: NONE

NOTES:

- Wood shall be grade #2 or better per S.P.I.R. Standards. Treatment shall be per AWPA Standards; (1) Piles - 2.5 lb/cu. ft. CCA Type C. For areas of severe marine infestation 2.5 lb/cu. ft. CCA is recommended; (2) Decking and stringers - 1.5 lb/cu. ft. Penta or 0.4 lb/cu. ft. CCA Type C.
- All steel hardware shall be hot dip galvanized after fabrication.
- For pier widths of 4' or less a center stringer is not required unless composite decking is applied.
- For piles extending more than 5 ft. above mean low water, the pile length must be increased accordingly.
- All steel hardware shall be a minimum of 1" with 3" x 1/4" NYDD washers.
- This standard is for typical river conditions with firm granular soil. It does not take into account excessive water depth, poor soil conditions, scouring due to currents or waves, or heavy loads. Where site conditions differ the structure shall be designed and sealed by a Professional Engineer registered to practice in the State of Maryland.
- The details on this drawing are to be considered as minimum standards for specific conditions. It shall be the responsibility of the applicant to determine if conditions require design modifications. The Permit Coordinators and the Engineer assume no responsibility or liability for performance of the structure on this drawing.
- All bolts to be thru bolted and recessed on outboard side.
- TPC, Inc. reserves the right to prosecute violators of federal copyright laws.

Tax Account No.:
2909-0763-4540
Tax Map: 61
Parcel: 17
Deed Ref: 25843/312
Lot: 2
Zoning: R2
Lot Size: 29,480 SF

**PIER
SPECIFICATIONS**

Waterfront Engineering, Design
and Construction, Inc.
303 Najoles Rd. St. 114
Millersville, MD 21108
(410) 703-8533
waterfrontdesign@verizon.net

PROPOSED: Pier and shoreline work. REVISED 10/27/2014

in: Watergate Harbor State: Maryland
co: Anne Arundel at: Watergate
Application by: Eric Thompson
Sheet 3 of 10 Date: February 22, 2014

NOTE: This drawing is not an engineered drawing. All dimensions and measurements shall be field verified by contractor.

Applicant's Signature:

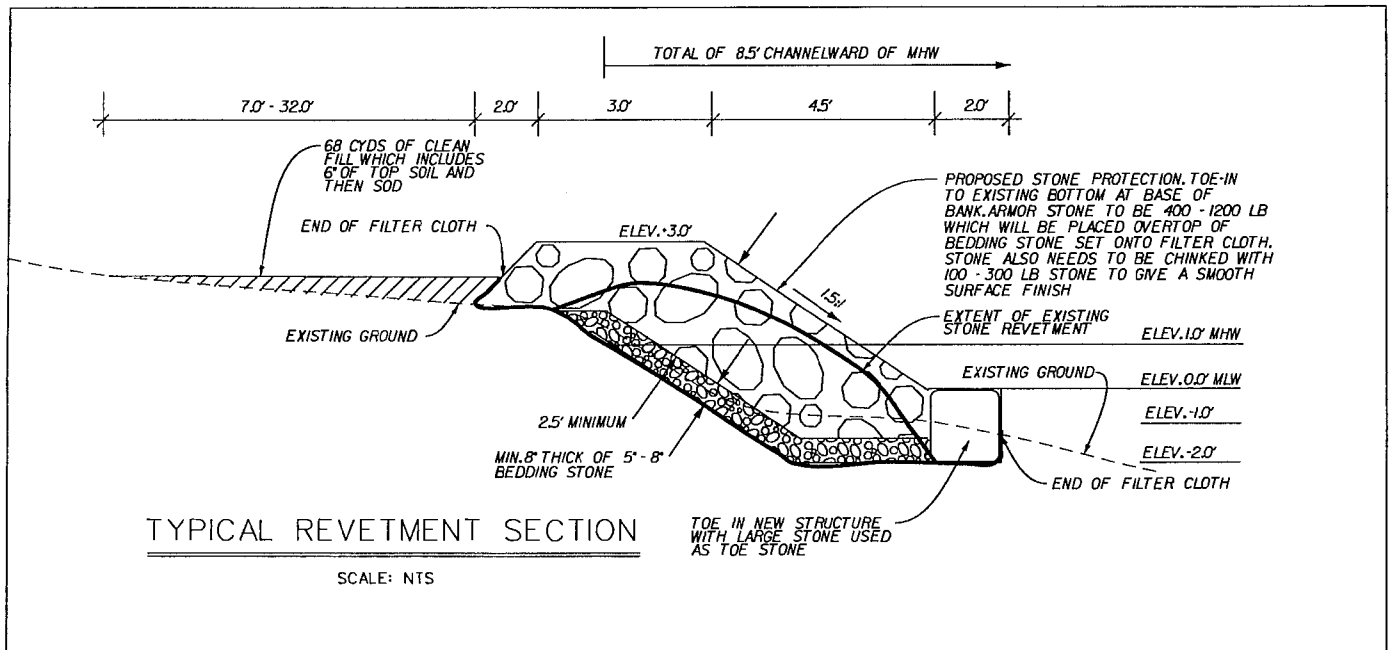
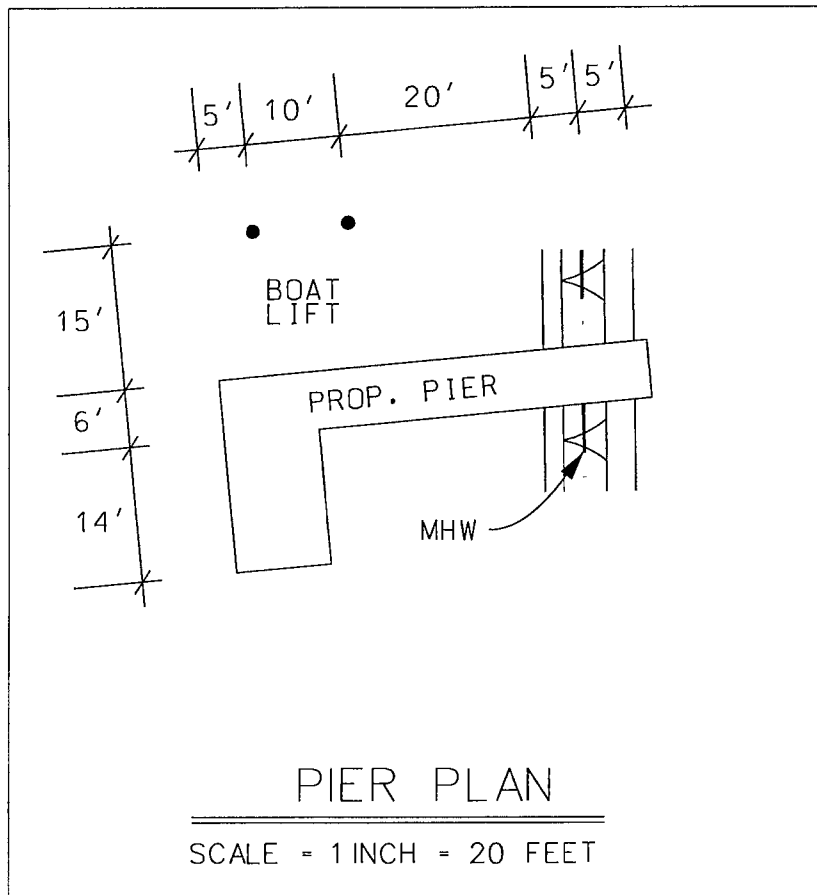

Tax Account No.:
2909-0763-4540
Tax Map: 61
Parcel: 17
Deed Ref: 25843/312
Lot: 2
Zoning: R2
Lot Size: 29,480 SF

**LAYOUT SHEET
CROSS SECTIONS**

Waterfront Engineering, Design
and Construction, Inc.
303 Najoles Rd. St. 114
Millersville, MD 21108
(410) 703-8533
waterfrontdesign@verizon.net

PROPOSED: Pier and shoreline work. REVISED 10/27/2014





in: Watergate Harbor State: Maryland
co: Anne Arundel at: Watergate
Application by: Eric Thompson
Sheet 5 of 10 Date: February 22, 2014

NOTE: This drawing is not an engineered drawing. All dimensions and measurements shall be field verified by contractor.

Applicant's Signature:

GENERAL NOTES

1. ZONING: R2
2. LOT SETBACKS: FRONT: 30 FEET PRINCIPAL
REAR: 25 FEET
SIDE: 7 FEET/20 FEET COMBINED
3. PREDOMINANT SOIL TYPE: AuB - ANNAPOLIS-URBAN LAND COMPLEX 'C' SOILS
4. TOTAL SF OF SITE: 29,480 SF OR 0.68 ACRES.
5. PROPOSED DISTURBED AREA: 2980 S.F. 0.07 ACRES
6. A. A. COUNTY TOPO SHEET: U25
7. F.E.M.A. RATE MAP: 240008-0261E ZONE AE. EL. 7.2
8. THIS LOT IS IN THE 100 YEAR FLOOD AREA AND A BUFFER MODIFIED AREA.
9. ELEVATIONS SHOWN ON THIS PLAN WERE OBTAINED FROM COUNTY RUN SURVEY. ELEVATIONS SHOWN ARE TIED INTO COUNTY MONUMENTS AND THE DATUM OF 0.0 FEET IS EQUAL TO MEAN LOW WATER. ANY CONTRACTOR SHALL FIELD VERIFY TO THEIR SATISFACTION, ALL QUANTITIES AND MEASUREMENTS BEFORE BIDDING THE WORK SHOWN AND BEFORE CONDUCTING ANY OF THE PROPOSED WORK. THE PERMIT COORDINATORS INC. IS NOT RESPONSIBLE FOR COST/QUANTITY OVERAGES.
10. BOUNDARY INFORMATION OBTAINED FROM ANNE ARUNDEL COUNTY DEPARTMENT OF PUBLIC WORKS ENGINEERING WEBSITE, AS-BUILT UTILITY PLANS, MARYLAND DEPARTMENT OF ASSESSMENTS AND TAXATION, (PARCELS 17, 121 & 21, TAX MAPS 57 & 61), PLAT OF WATERGATE, SECTION 1, PLAT BOOK 32, PAGE 84, AND PLAT OF FISHING CREEK FARMS, PLAT NO. 9, PLAT BOOK 109, PAGE 45
11. PUBLIC WATER, PUBLIC SEWER.
12. SITE IS IN THE SOUTH RIVER WATERSHED.
13. SITE IS DESIGNATED AS LDA BY THE CRITICAL AREA COMMISSION.

LEGEND	
EXISTING CONTOUR	— 4.0 —
PROPOSED CONTOUR	● 4.0 ●
EX. MEAN LOW WATER (MLW)	- - - - -
EX. MEAN HIGH WATER (MHW)	= = = = =
EXISTING MARSH GRASSES.....	
EXISTING TREE LINE	
PROPERTY LINE	- - - - -
LIMIT OF DISTURBANCE	— LOD —
REINFORCED SILT FENCE	— RSF —
100' TIDAL BUFFER	■ ■ ■ ■ ■
EXISTING RIP-RAP	
PROPOSED RIP-RAP	
PROPOSED DREDGING	

SEQUENCE OF CONSTRUCTION

1. OBTAIN ALL NECESSARY PERMITS. CONDUCT A PRECONSTRUCTION MEETING AT LEAST 48 HOURS PRIOR TO START. CONTACT THE MARYLAND DEPARTMENT OF THE ENVIRONMENT (MDE) AT 410-537-3510, ANNE ARUNDEL COUNTY GRADING INSPECTOR AT 410-222-7780, AND THE RESPONSIBLE PERSONNEL. WORK MAY NOT COMMENCE UNTIL THE PERMITTEE OR THE RESPONSIBLE PERSONNEL HAVE MET ON-SITE WITH THE SEDIMENT AND EROSION CONTROL INSPECTOR TO REVIEW THE APPROVED PLANS. (1 DAY)
2. INSTALL ANY TEMPORARY SEDIMENT CONTROL MEASURES INCLUDING TEMPORARY SILT FENCE, TEMPORARY TURBIDITY CURTAIN (IF UTILIZED) AROUND ALL STONE WORK AREAS. NOTE THAT THE MDE INSPECTOR MAY AGREE THAT THE TEMPORARY TURBIDITY CURTAIN CAN BE ELIMINATED IF DEEMED NOT NECESSARY. ALL WORK DONE FROM BARGE. (3 DAYS)
3. REMOVE PIER AND CLEAR DEBRIS FROM SHORELINE AND PREPARE GROUND FOR INSTALLATION OF STONE REVETMENT. (1 DAY)
4. INSTALL FILTER CLOTH AND INSTALL TOE STONE. INSTALL BEDDING STONE ONTO FILTER CLOTH. INSTALL ARMOR STONE ONLY UTILIZING STONE THAT MEETS THE SPECIFICATIONS FOR STONE SIZE. CONSTRUCT STONE REVETMENT IN THE AREA AS SHOWN. (2 WEEKS)
- 4A. DREDGE SPUR TO PIER. (1 DAY)
5. CONSTRUCT PIER AS SHOWN ON PLAN. (1 WEEKS)
6. ONCE THE SITE IS FULLY STABILIZED AND THROUGH COORDINATION AND APPROVAL OF THE MARYLAND DEPARTMENT OF THE ENVIRONMENT AND THE ANNE ARUNDEL COUNTY GRADING INSPECTOR, REMOVE FINAL SEDIMENT CONTROL MEASURES.

NOTE:
THE SEQUENCE OF CONSTRUCTION AS LISTED ABOVE IS FOR THE USE BY THE CONTRACTOR AS A GENERAL GUIDELINE FOR SEQUENCING THE CONSTRUCTION OF ALL PROPOSED STRUCTURES. THE CONTRACTOR MAY ADJUST THE SEQUENCE OF CONSTRUCTION, AS NEEDED, UPON THE APPROVAL OF THE OWNER, THE COUNTY INSPECTOR AND THE MARYLAND DEPARTMENT OF THE ENVIRONMENT INSPECTOR.

Tax Account No.: 2909-0763-4540 Tax Map: 61 Parcel: 17 Deed Ref: 25843/312 Lot: 2 Zoning: R2 Lot Size: 29,480 SF	<h2 style="margin: 0;">NOTES SHEET</h2>	PROPOSED: Pier and shoreline work. REVISED 10/27/2014 in: Watergate Harbor State: Maryland co: Anne Arundel at: Watergate Application by: Eric Thompson Sheet 6 of 10 Date: February 22, 2014
Waterfront Engineering, Design and Construction, Inc. 303 Najoles Rd. St. 114 Millersville, MD 21108 (410) 703-8533 waterfrontdesign@verizon.net		

NOTE: This drawing is not an engineered drawing. All dimensions and measurements shall be field verified by contractor.

Applicant's Signature:

SITE DATA

SITE DATA:

TOTAL LOT SIZE = 29,480 SF
 CRITICAL AREA DESIGNATION = LDA
 ZONING = R2
 DISTURBED AREA = 2980 SF

IMPERVIOUS DATA:

EXISTING DWELLING = 2492 SF
 DRIVES AND WALKS = 1280 SF
 ACCESSORY STRUCTURES = 684 SF
 TOTAL EXISTING IMPERVIOUS = 4456 SF
 IMPERVIOUS CREATED = 0 SF
 FINAL IMPERVIOUS = 4456 SF OR 15%

WOODLANDS DATA:

EXISTING WOODLANDS = 2000 SF
 EXISTING MARSH = APPROXIMATELY 00 SF
 WOODLANDS/MARSH REMOVED = 00 SF
 REFORESTATION REQUIRED = 2980 SF
 BOND AMOUNT = 2980 X \$1.50 = \$4,470.00
 INSPECTION FEE = \$4,470.00 X 0.07 = \$312.90
 TOTAL FEE = \$4,782.90

SITE PLANS NOTES AND DISCLAIMERS

1. PROPERTY LINES SHOWN HEREON HAVE BEEN TAKEN FROM FIELD EVIDENCE, AND/OR AVAILABLE DEEDS AND PLATS AND SHOULD NOT BE CONSTRUED TO BE REPRESENTATIVE OF THE ACCURACY OF A BOUNDARY SURVEY. THIS IS NOT A BOUNDARY SURVEY! THIS SITE PLAN WAS DEVELOPED WITHOUT THE BENEFIT OF A TITLE SEARCH AND MAY NOT REFLECT ENCUMBRANCES, DEDICATIONS, AND/OR RESTRICTIONS WHICH MAY EXIST AND COULD POTENTIALLY BE REVEALED THROUGH A THOROUGH TITLE EXAMINATION.
2. ALL SHORELINE WORK WILL BE CONDUCTED FROM A BARGE WHICH IS TO BE LOADED FROM AN AUTHORIZED OFF-SITE LOCATION. THE LOD AS SHOWN AND WILL BE CONFINED TO THE SUBJECT PROPERTY.
3. CONTRACTOR IS RESPONSIBLE FOR THE LOCATION OF ANY PROPOSED STRUCTURES IN RELATION WITH THE PROPERTY CORNERS. NEIGHBORING STRUCTURES SHOWN ON THIS DRAWING AS APPROXIMATE IN LOCATION AND SHOULD NOT BE USED TO LOCATE NEW STRUCTURES. A SURVEY IS REQUIRED TO LOCATE AND NEW OR REPLACEMENT STRUCTURES. THIS SURVEY MUST BE PERFORMED BY A STATE OF MARYLAND LICENSED SURVEYOR.
4. THIS SITE PLAN HAS BEEN PREPARED TO REQUEST A BUILDING PERMIT TO CONSTRUCT SHORE EROSION CONTROL STONE REVETMENT, REPLACE A PIER AND SPUR DREDGE TO PIER. ANY CHANGE TO THESE PLANS WILL REQUIRE A SEPARATE PERMIT FROM ANNE ARUNDEL CO., AND IF WORK IN THE WATER OR SHORELINE THE MARYLAND DEPARTMENT OF THE ENVIRONMENT AND THE CORPS OF ENGINEERS. THIS WILL REQUIRE MORE DETAILS AND INFORMATION AND THIS DRAWING SHALL NOT BE UTILIZED FOR SUCH LICENSES OR PERMITS.
5. CONTACT MS. UTILITY AT LEAST 48 HOURS PRIOR TO START OF ANY ON LAND OR IN WATER WORK. ALL UTILITIES MUST BE LOCATED PRIOR TO ANY CONSTRUCTION. THIS PLAN SHALL NOT BE UTILIZED FOR LOCATING ANY UTILITIES EITHER ABOVE OR BELOW GROUND.
6. TOPOGRAPHY WAS OBTAINED FROM 2011 ANNE ARUNDEL COUNTY DEPARTMENT OF PUBLIC WORKS SURVEY DATA. WATER DEPTHS WERE FIELD RUN BY THE PERMIT COORDINATORS, INC. IN WINTER OF 2014. VERTICAL DATUM IS 0.0 FEET IS EQUAL TO MEAN LOW WATER.
7. IT SHOULD BE NOTED THAT WATER DEPTHS IN THIS AREA ARE CONSTANTLY CHANGING THEREFORE THE CONTRACTOR MUST FIELD VERIFY ALL QUANTITIES AND MEASUREMENTS TO THERE SATISFACTION. THESE PLANS ARE FOR PERMIT PURPOSES ONLY AND SHALL NOT BE UTILIZED FOR CONSTRUCTION PURPOSES OTHER THAN GENERAL LOCATION OF STRUCTURES.

Tax Account No.: 2909-0763-4540 Tax Map: 61 Parcel: 17 Deed Ref: 25843/312 Lot: 2 Zoning: R2 Lot Size: 29,480 SF	DATA SHEET Waterfront Engineering, Design and Construction, Inc. 303 Najoles Rd. St. 114 Millersville, MD 21108 (410) 703-8533 waterfrontdesign@verizon.net	PROPOSED: Pier and shoreline work. REVISED 10/27/2014 in: Watergate Harbor State: Maryland co: Anne Arundel at: Watergate Application by: Eric Thompson Sheet 7 of 10 Date: February 22, 2014
---	--	--

NOTE: This drawing is not an engineered drawing. All dimensions and measurements shall be field verified by contractor.

Applicant's Signature: