

**U.S. Army Corps
of Engineers**
Baltimore District

Public Notice

In Reply to Application Number
CENAB-OP-RMS (TRINITY EPISCOPAL CHURCH)
2014-61436

PN 15-13

Comment Period: February 25, 2015 to March 25, 2015

THE PURPOSE OF THIS PUBLIC NOTICE IS TO SOLICIT COMMENTS FROM THE PUBLIC ABOUT THE WORK DESCRIBED BELOW. AT THIS TIME, NO DECISION HAS BEEN MADE AS TO WHETHER OR NOT A PERMIT WILL BE ISSUED.

The Maryland Department of the Environment (MDE) and the Baltimore District Corps of Engineers have received an application for a State of Maryland Tidal Wetland License and Department of the Army permit pursuant to Section 10 of the Rivers and Harbors Act of 1899 and Section 404 of the Clean Water Act, as described below:

APPLICANT: The Reverend John A. Ball
P.O. Box 207
St. Mary's City, Maryland 20650

LOCATION: In the St. Mary's River at 47477 Trinity Church Road, St. Mary's City, St. Mary's County, Maryland

WORK: To stabilize approximately 425 linear feet of an eroding shoreline by creating approximately 0.2 acre area of emergent intertidal wetlands by depositing approximately 415 cubic yards of sloped, clean select sand fill stabilized with *Spartina alterniflora* and *S. patens*; to rehabilitate and expand the existing 15-foot wide by 425-foot long vented high profile sill to extend an average of 20 feet and no more than 75 feet channelward of the approximate mean high water shoreline. All work is to be completed in accordance with the proposed plan(s). If you have any questions concerning this matter, please contact Mrs. Erica Schmidt at (410) 962-6029 or Erica.Schmidt@usace.army.mil.

Site layout for this project was based upon existing breakwater layout and marsh grasses. Efforts were made to avoid, to the extent possible, the long and short-term adverse impacts associated with the proposed project. The applicant proposes to access the site from the land on an existing access pathway.

Compensatory mitigation is not being proposed by the applicant for permanent impacts to open water.

The purpose of the project is primarily to provide shoreline stabilization to protect existing tidal wetlands and structures onsite.

The Magnuson-Stevens Fishery Conservation and Management Act (MSFCMA), as amended by the Sustainable Fisheries Act of 1996 (Public Law 04-267), requires all Federal agencies to consult with the National Marine Fisheries Service (NMFS) on all actions, or proposed actions, permitted, funded, or undertaken by the agency that may adversely effect essential fish habitat (EFH). The project site lies in or adjacent to EFH as described under MSFCMA for Gadus morhua (Atlantic Cod) adult, Pleuronectes americanus (winter flounder) juvenile, and adult, Scophthalmus aquosus (windowpane flounder) eggs, larvae, juvenile and adult; Pomatomus saltatrix (blue fish) juvenile

and adult; (Lophius americanus) (Monkfish) eggs and larvae, Stenotomus chrysops (scup) juvenile and adult; Centropristus striata (black sea bass) juvenile and adult; Paralichthys dentatus (summer flounder) larvae, juvenile and adult; Urophycis chuss (red hake) eggs, larvae, juvenile; (Peprilus triacanthus) (Atlantic butterflyfish) eggs, juvenile, adult; Clupea harengus (Atlantic sea herring) juvenile and adult; Odontaspis taurus (sand tiger shark) larvae and adult; Squatina dumerili (Atlantic angel shark) larvae, juvenile, and adult; Charcharinus obscurus (dusky shark) larvae; Charcharinus plumbeus (sandbar shark) larvae, juvenile, and adult; Odontaspis taurus sand tiger shark, larvae and juvenile, Sphyrna lewini (scalloped hammerhead shark) juvenile; Rhizopriondon terraenovae (Atlantic sharpnose shark) adult, Prionance glauca (blue shark) adult Galeocerdo cuvieri (tiger shark) larvae; and eggs, larvae, juvenile, and adult stages of Scomberomorus cavalla (king mackerel), Scomberomorus maculatus (spanish mackerel), and Rachycentron canadum (cobia), Spisula solidissima (surf clam) juvenile, all managed species under the MSFCMA.

The project has the potential to adversely affect EFH or the species of concern by alteration of spawning, nursery, forage and/or shelter habitat. The project may have an adverse effect on approximately 0.35 acres of EFH as described under the MSFCMA for the species and life stages identified above. This habitat consists of a mostly sandy and silty sub-tidal substrate that does not support submerged aquatic vegetation (SAV). The proposed project would alter the existing elevations and substrate within the project footprint and the areas filled are not expected to support the current benthos and fishery due to the project. However, the District Engineer has made a preliminary determination that site-specific impacts would not be substantial and an abbreviated consultation will be conducted with NMFS. No mitigative measures are recommended to minimize adverse effects on EFH at this time. This determination may be modified if additional information indicates otherwise and would change the preliminary determination.

The decision whether to issue a permit will be based on an evaluation of the probable impact including cumulative impacts of the proposed activity on the public interest. That decision will reflect the national concern for both protection and utilization of important resources. The benefit which reasonably may be expected to accrue from the proposal must be balanced against its reasonably foreseeable detriments. All factors which may be relevant to the proposal will be considered including the cumulative effects thereof; among those are conservation, economics, aesthetics, general environmental concerns, wetlands, cultural values, fish and wildlife values, flood hazards, flood plain values, land use, navigation, shoreline erosion and accretion, recreation, water supply and conservation, water quality, energy needs, safety, food and fiber production, and, in general, the needs and welfare of the people.

The Corps of Engineers is soliciting comments from the public; Federal, State, and local agencies and officials; Indian Tribes; and other interested parties in order to consider and evaluate the impacts of this proposed activity. Any comments received will be considered by the Corps of Engineers to determine whether to issue, modify, condition or deny a permit for this proposal. To make this decision, comments are used to assess impacts on endangered species, historic properties, water quality, general environmental effects, and the other public interest factors listed above. Comments are used in the preparation of an Environmental Assessment and/or an Environmental Impact Statement pursuant to the National Environmental Policy Act. Comments are also used to determine the need for a public hearing and to determine the overall public interest of the proposed activity.

The applicant is required to obtain a water quality certification in accordance with Section 401 of the Clean Water Act from the Maryland Department of the Environment. Any written comments concerning the work described above which relate to water quality certification must be received by the Wetlands and Waterways Program, Maryland Department of the Environment, 1800 Washington Blvd. Suite 430, Baltimore, Maryland 21230 within the comment period as specified

above to receive consideration. Written comments concerning the work described above related to the factors listed above or other pertinent factors must be received by the District Engineer, US Army Corps of Engineers, Baltimore District, PO Box 1715, Baltimore, Maryland 21203-1715, within the comment period as specified above to receive consideration. The 401 certifying agency has a statutory limit of one year to make its decision.

The applicant has certified in this application that the proposed activity complies with and will be conducted in a manner consistent with the Maryland Coastal Zone Program. This certification statement is available for inspection in the District Office; however, public comments relating to consistency must be received by the Coastal Zone Division, Maryland Department of the Environment, 1800 Washington Blvd. Suite 430, Baltimore, Maryland 21230, within the comment period as specified above. It should be noted that CZ Division has a statutory limit of 6 months in which to make its consistency determination.

The applicant must obtain any State or local government permits, which may be required.

A preliminary review of this application indicates that the proposed work will not affect listed species or their critical habitat pursuant to Section 7 of the Endangered Species Act as amended. As the evaluation of this application continues, additional information may become available which could modify this preliminary determination.

Review of the latest published version of the National Register of Historic Places indicates that no registered properties listed as eligible for inclusion therein are located at the site of the proposed work. Currently unknown archeological, scientific, prehistoric, or historical data may be lost or destroyed by the work to be accomplished under the requested permit.

The evaluation of the impact of the work described above on the public interest will include application of the guidelines promulgated by the Administrator, U.S. Environmental Protection Agency, under authority of Section 404 of the Clean Water Act. Any person who has an interest, which may be adversely affected by the issuance of this permit, may request a public hearing. The District Engineer must receive the request, which must be in writing, US Army Corps of Engineers, Baltimore District, PO Box 1715, Baltimore, Maryland 21203-1715, within the comment period as specified as above to receive consideration. Also, it must clearly state forth the interest that may be adversely affected by this activity in the manner in which the interest may be adversely affected.

It is requested that you communicate the foregoing information concerning the proposed work to any persons known by you to be interested and not being known to this office, who did not receive a copy of this notice.

FOR THE DISTRICT ENGINEER:

Kathy B. Anderson
Chief, Maryland Section Southern

THE DRAWINGS ARE PREPARED COOPERATIVELY BY THE NATURAL RESOURCE CONSERVATION SERVICE FOR THE NAMED LANDOWNER AND THE MARYLAND DEPARTMENT OF AGRICULTURE. THE DRAWINGS AND SPECIFICATIONS SHALL VIOLATE THE COOPERATIVE AGREEMENT AND ALL DRAWINGS, SPECIFICATIONS, AND QUANTITIES ESTIMATE SHALL IMMEDIATELY BE RETURNED TO THE LOCAL NRCS OFFICE.

SAFETY REGULATIONS

ALL EXCAVATION AND METHODS OF CONSTRUCTION SHALL BE IN ACCORDANCE WITH THE MARYLAND OCCUPATIONAL SAFETY AND HEALTH ADMINISTRATION (OSHA) STANDARDS AS SET FORTH IN THE LATEST VERSION OF THE CODE OF MARYLAND REGULATIONS

GENERAL NOTES:

- THE MEAN LOW WATER DATUM (MLW) IS BASED ON COMPARISONS OF ACTUAL WATER LEVELS WITH TIDE LEVELS PREDICTED FOR THE SITE LOCALITY ST. MARY'S CITY, MARYLAND - NOAA TIDE STATION #2319) AND THE LEVEL OF EXISTING MARSH VEGETATION DURING AN INSTRUMENT SURVEY OF THE SITE ON 7/15/13. THE MEAN TIDE RANGE IS 1.5', THE SPRING TIDE RANGE IS 1.7', HORIZONTAL CONTROL WAS ESTABLISHED BY A CLOSED LOOP TRAVERSE.
- VERTICAL CONTROL IS 0.0 FEET MLW.
- TOPOGRAPHIC AND HYDROGRAPHIC DATA OBTAINED DURING JULY 2013.
- ALL DIMENSIONS AND COORDINATES GIVEN IN FEET.
- EXISTING ELEVATIONS ARE GIVEN IN FEET ABOVE SEA LEVEL.
- ALL EARTHROCK INTERFACES TO RECEIVE FILTER CLOTH.
- CONTRACTOR TO REFUSE ANY EXISTING MATERIALS THAT MEET PROPOSED ROCK STRUCTURE REQUIREMENTS.
- CONTRACTOR SHALL DRESS EXISTING SLOPE TO FORM PROPER INTERFACE AT EXISTING BANK.

MARYLAND DEPARTMENT OF ENVIRONMENT
GENERAL PERMIT
ALL LAND DISTURBANCES IN EXCESS OF ONE (1.0) ACRE WILL REQUIRE A GENERAL PERMIT TO DISCHARGE STORMWATER ASSOCIATED WITH CONSTRUCTION ACTIVITIES FROM THE MARYLAND DEPARTMENT OF ENVIRONMENT. THE APPROVED GENERAL PERMIT MUST BE PRESENTED TO THE ST. MARY'S SOIL CONSERVATION DISTRICT TO BEGINNING ANY WORK ON THE SITE. PLEASE CONTACT THE SMCDC WITH ANY QUESTIONS.

CHURCH POINT

PROPOSED LIVING SHORELINE PROJECT

(ST. MARY'S SOIL CONSERVATION DISTRICT)



VICINITY MAP
NTS.

| SHEET | TITLE |
|--------|------------------------|
| 2..... | PLAN VIEW |
| 3..... | PROFILES |
| 4..... | PROFILES |
| 5..... | DETAILS |
| 6..... | GENERAL CONDITIONS |
| 7..... | EXISTING CONDITIONS |
| 8..... | BUFFER MANAGEMENT PLAN |

| | |
|--|--------------|
| SITE DATA: | LUGM# |
| LANDOWNER INFORMATION: THE REVEREND JOHN A. BULL, RECTOR TRINITY EPISCOPAL CHURCH AND ST. MARY'S PARISH 474 MARYLAND CHURCH ROAD ST. MARY'S CITY, MD 20686 | |
| CONTACT PERSON: FATHER JOHN BULL 301-882-451-OFFICE 240-825-0732-CELL 301-114-084-RECTORY | |
| SITE DETAILS: TOTAL DISTURBED ACRES = 40.5 AC. AREA TO VEGETATIVELY STABILIZED = 40.2 AC. SAND FILL TOTALS = 1419 CU.YDS. RIP RAP TOTALS = 1385 TON CORBELLE STONE = 130 CU. YDS. CUT TOTALS = 130 CU. YDS. SITE LOCATION (TBM1) = +38.187914N +76.437203W | |

MATERIALS NOTE

All Materials are estimated quantities using St. Mary's Soil Conservation District's survey and design data. All materials and cost are estimated quantities and not to be used as quantities for a bid proposal. All bidding contractors must use their own cost and general quantities for their bid proposal.

MATERIALS LIST

| |
|---|
| -520 Tons Sand |
| -525 Tons Rip Rap |
| (400-1200lb) |
| -30 Tons Cobble Stone |
| -8000 Sq. Ft. Filter Cloth |
| -3245 Plants |
| -0.5 Ac. Seeding |
| -105 Tons Blue Stone for Reclamation of Access Road |
| -Mobilization & Demobilization |

CRITICAL AREA NOTES

1. ACCESS TO SITE WILL BE THROUGH THE GATEWAY. THE ENTIRE ACCESS IS TO BE MAINTAINED AND NOT TO BE CUT OFF THROUGH TRINITY EPISCOPAL CHURCH AND ST. MARY'S SOIL CONSERVATION DISTRICT.
2. OVERHANGING LIMBS WITHIN LOD SHALL BE TRIMMED AS DIRECTED BY CONTRACTING OFFICER.
3. ACCESS OR VEGETATION WILL BE REMOVED TO PROVIDE ACCESS.
4. ALL DISTURBED AREAS WITHIN LOD AND ACCESS ROUTE THAT ARE NOT OTHERWISE STABILIZED WILL BE SEEDED AND MULCHED WITH IN 3 DAYS.

CONSTRUCTION SEQUENCE:

1. CONTACT THE ST. MARY'S SOIL CONSERVATION DISTRICT AT MEETING ROOM, 861 ST. ANDREW AVE. FOR CONSTRUCTION MEETING
2. CONTACT MISS ULTRY AT 811 & CONTACT NDE INSPECTOR
3. PRUNE LIMBS AND BRANCHES WITHIN LOD TO ALLOW EQUIPMENT ACCESS
4. INSTALL NEW FILTER FABRIC AND BEGIN CONSTRUCTION OF NEW SILL TO APPROVED ELEVATIONS. STONE FROM THE OLD STRUCTURE MAY BE USED IN THE NEW STRUCTURE (REMOVAL OF EXISTING SILL SHOULD BE DONE IN REMOVED AT ANY ONE TIME)
5. SAND FILL BEING CONSTRUCTED, PLACE AND GRADE CLEAN SAND FILL THROUGH SEVERAL TIERES PRIOR TO PLANTING.
7. PLANT SPARTINA ALTERNIFLORA AND SPARTINA PATENS. ADD 1 OUNCE OF OSMOCOTE FERTILIZER TO EACH PLANT.
8. REMOVE EXISTING AND NEW WITHIN LIMITS OF DISTURBANCE.
9. REMOVAL OF EROSION AND SEDIMENT CONTROL STRUCTURES WITH INSPECTOR APPROVAL

CONSTRUCTION NOTIFICATION

The Contractor must notify the ST. MARY'S SOIL CONSERVATION DISTRICT prior to the start of construction to ensure proper construction techniques to enable appropriate notification of the project.

It is the Landowner's responsibility to obtain all County, State, and Federal permits that may be needed, and to maintain the structure and related regulations.

GENERAL/GENERAL CERTIFICATION

I, THE LANDOWNER, HEREBY CERTIFY THAT THE PLANS WILL BE CONSTRUCTED IN ACCORDANCE WITH THE APPROVED PERMIT AND ALL REGULATIONS, SPECIFICATIONS, STANDARDS AND CERTIFICATE OF TRAINED AT THE MARYLAND DEPT OF ENVIRONMENT APPROVED THROUGH PROPOSED SILL ONE BEHIND THE PROJECT.

OWNER'S SIGNATURE: _____ DATE: _____

SOIL/VEGETATION CERTIFICATION

I HEREBY CERTIFY THAT THE PLANS HAVE BEEN DESIGNED IN ACCORDANCE WITH APPROVED REGULATIONS, SPECIFICATIONS, STANDARDS AND CERTIFICATE OF TRAINED AT THE MARYLAND DEPT OF ENVIRONMENT APPROVED THROUGH PROPOSED SILL ONE BEHIND THE PROJECT.

CONSULTANT'S SIGNATURE: _____ DATE: _____

GENERAL/CONTRACTOR STATEMENT

I CERTIFY THAT THE DESIGN HAS BEEN DEVELOPED TO BE IN ACCORDANCE WITH THE CONSTRUCTION DISTRICT AND I UNDERSTAND AND AGREE TO BE RESPONSIBLE FOR THE DESIGN AND SPECIFICATIONS. I FURTHER UNDERSTAND AND AGREE TO BE RESPONSIBLE FOR THE SUPERVISION OF THIS OFFICE.

OWNER'S SIGNATURE: _____ DATE: _____

RED-LINE CERTIFICATION

PROJECT MEETS NRCS STANDARDS AND SPECIFICATIONS

TECHNICAL CHARGE: _____ DATE: _____

CONSTRUCTION SUPERVISION BY NRCS/MDASDCD PERSONNEL
LANDOWNERS PERMISSION FOR MDE AND COE INSPECTION

| REVISIONS | Date | Approved |
|-------------|------|----------|
| Description | | |

Sheet 1 of 8



TRINITY EPISCOPAL CHURCH
CHURCH POINT PROPOSED LIVING SHORELINE PROJECT
P.O. BOX 145 St. Mary's City, Maryland 20686

Maryland Department of Agriculture
ST. MARY'S Soil Conservation District

Designed _____ Date _____
Drawn _____
Checked _____

Approved _____ Date _____
Title _____ Job Class _____

NOTE
 The proposed project extends approximately 75' channelward of the current MHW Line. All proposed work will not extend any further channelward than the existing structures and the current channelward encroachment is due to the erosion of the constructed marsh creation installed in 1998. At that time the maximum channelward encroachment was 35 feet.



LEGEND

- POND LEVEL
- PROPOSED SILL
- EXISTING SILL
- TOPO EXISTING PROFILES
- SPARTINA PATEN
- SPARTINA ALTERNIFLORA
- EXISTING SPARTINA PATEN
- EXISTING SPARTINA ALTERNIFLORA
- TREES
- HUB
- TBM132 = +4' MLW
- MLW=Mean Low Water

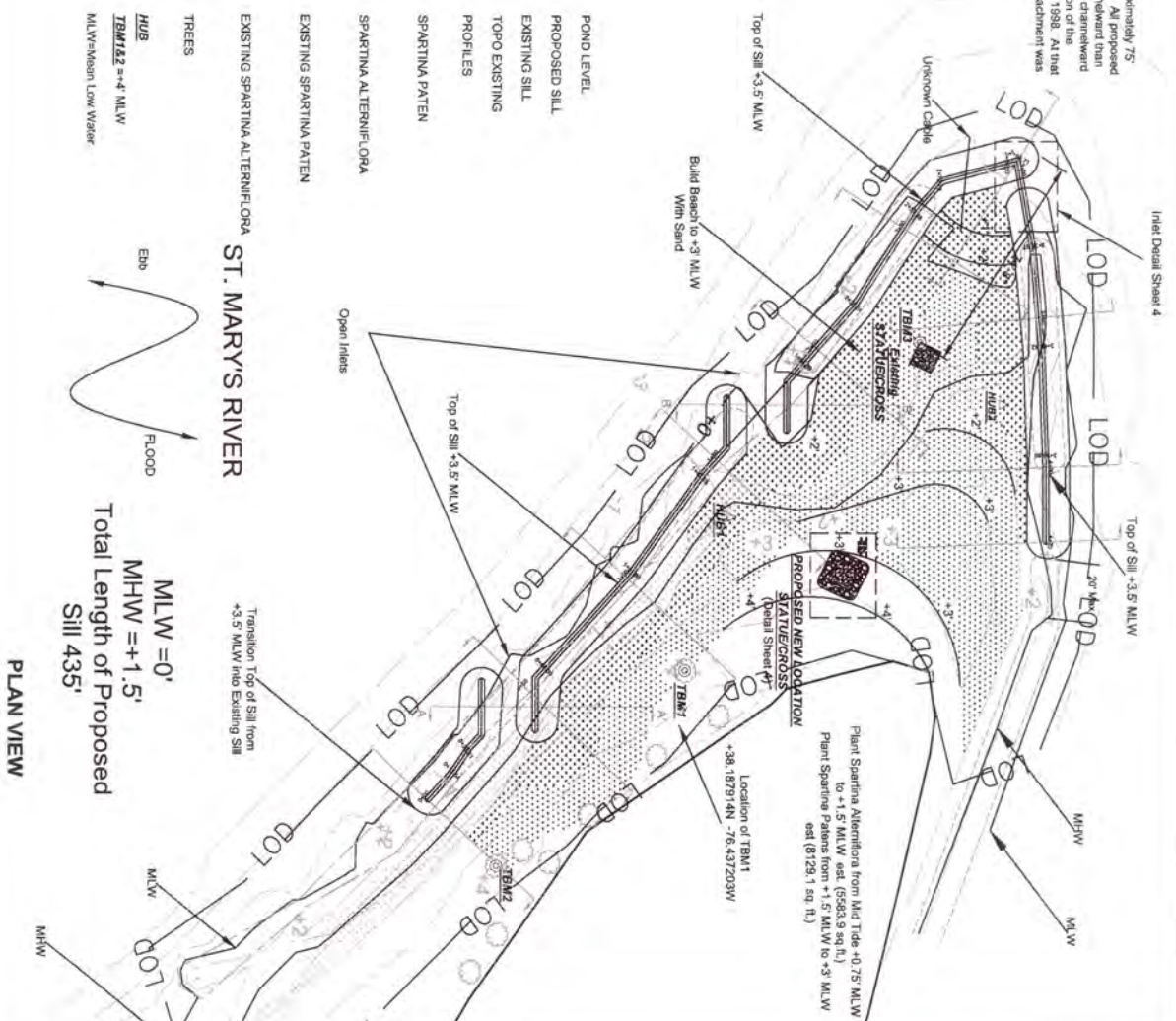

PLAN VIEW

TRAVERSE DATA

| TRAVERSE POINT | NORTHING | EASTING | ELEVATION |
|----------------|----------|---------|-----------|
| 1 (HUB) | 5000.00 | 5000.00 | +2.74 MLW |
| 2 (TBM1) | 5001.55 | 4962.52 | +1.51 MLW |
| 3 (TBM2) | 4999.80 | 5100.00 | +1.51 MLW |

MEASUREMENT DATA

| STATION | INSTRUMENT | DATE | TIME | INSTRUMENT | DATE | TIME |
|---------|------------|---------|-------|------------|---------|-------|
| 0+00.00 | 6717.2677 | 1/19/05 | 11:28 | 6814.7534 | 2/18/05 | 11:28 |
| 0+12.25 | 6815.5157 | 1/19/05 | 11:28 | 6815.5157 | 2/18/05 | 11:28 |
| 0+24.50 | 6815.5157 | 1/19/05 | 11:28 | 6815.5157 | 2/18/05 | 11:28 |
| 0+36.75 | 6815.5157 | 1/19/05 | 11:28 | 6815.5157 | 2/18/05 | 11:28 |
| 0+49.00 | 6815.5157 | 1/19/05 | 11:28 | 6815.5157 | 2/18/05 | 11:28 |
| 0+61.25 | 6815.5157 | 1/19/05 | 11:28 | 6815.5157 | 2/18/05 | 11:28 |
| 0+73.50 | 6815.5157 | 1/19/05 | 11:28 | 6815.5157 | 2/18/05 | 11:28 |
| 0+85.75 | 6815.5157 | 1/19/05 | 11:28 | 6815.5157 | 2/18/05 | 11:28 |
| 0+98.00 | 6815.5157 | 1/19/05 | 11:28 | 6815.5157 | 2/18/05 | 11:28 |
| 1+10.25 | 6815.5157 | 1/19/05 | 11:28 | 6815.5157 | 2/18/05 | 11:28 |
| 1+22.50 | 6815.5157 | 1/19/05 | 11:28 | 6815.5157 | 2/18/05 | 11:28 |
| 1+34.75 | 6815.5157 | 1/19/05 | 11:28 | 6815.5157 | 2/18/05 | 11:28 |
| 1+47.00 | 6815.5157 | 1/19/05 | 11:28 | 6815.5157 | 2/18/05 | 11:28 |
| 1+59.25 | 6815.5157 | 1/19/05 | 11:28 | 6815.5157 | 2/18/05 | 11:28 |
| 2+11.50 | 6815.5157 | 1/19/05 | 11:28 | 6815.5157 | 2/18/05 | 11:28 |
| 2+23.75 | 6815.5157 | 1/19/05 | 11:28 | 6815.5157 | 2/18/05 | 11:28 |
| 2+36.00 | 6815.5157 | 1/19/05 | 11:28 | 6815.5157 | 2/18/05 | 11:28 |
| 2+48.25 | 6815.5157 | 1/19/05 | 11:28 | 6815.5157 | 2/18/05 | 11:28 |
| 2+60.50 | 6815.5157 | 1/19/05 | 11:28 | 6815.5157 | 2/18/05 | 11:28 |
| 2+72.75 | 6815.5157 | 1/19/05 | 11:28 | 6815.5157 | 2/18/05 | 11:28 |
| 2+85.00 | 6815.5157 | 1/19/05 | 11:28 | 6815.5157 | 2/18/05 | 11:28 |
| 2+97.25 | 6815.5157 | 1/19/05 | 11:28 | 6815.5157 | 2/18/05 | 11:28 |
| 3+09.50 | 6815.5157 | 1/19/05 | 11:28 | 6815.5157 | 2/18/05 | 11:28 |
| 3+21.75 | 6815.5157 | 1/19/05 | 11:28 | 6815.5157 | 2/18/05 | 11:28 |
| 3+34.00 | 6815.5157 | 1/19/05 | 11:28 | 6815.5157 | 2/18/05 | 11:28 |
| 3+46.25 | 6815.5157 | 1/19/05 | 11:28 | 6815.5157 | 2/18/05 | 11:28 |
| 3+58.50 | 6815.5157 | 1/19/05 | 11:28 | 6815.5157 | 2/18/05 | 11:28 |
| 4+10.75 | 6815.5157 | 1/19/05 | 11:28 | 6815.5157 | 2/18/05 | 11:28 |
| 4+23.00 | 6815.5157 | 1/19/05 | 11:28 | 6815.5157 | 2/18/05 | 11:28 |

REVISIONS

| Date | Description | Approved |
|------|-------------|----------|
| | | |



TRINITY EPISCOPAL CHURCH
 CHURCH POINT PROPOSED LIVING SHORELINE PROJECT
 P.O. BOX 145 St. Mary's City, Maryland 20686

Maryland Department of Agriculture
 ST. MARY'S Soil Conservation District

Designed _____ Date _____
 Drawn _____
 Checked _____

Approved _____ Date _____
 Title _____ Job Class _____

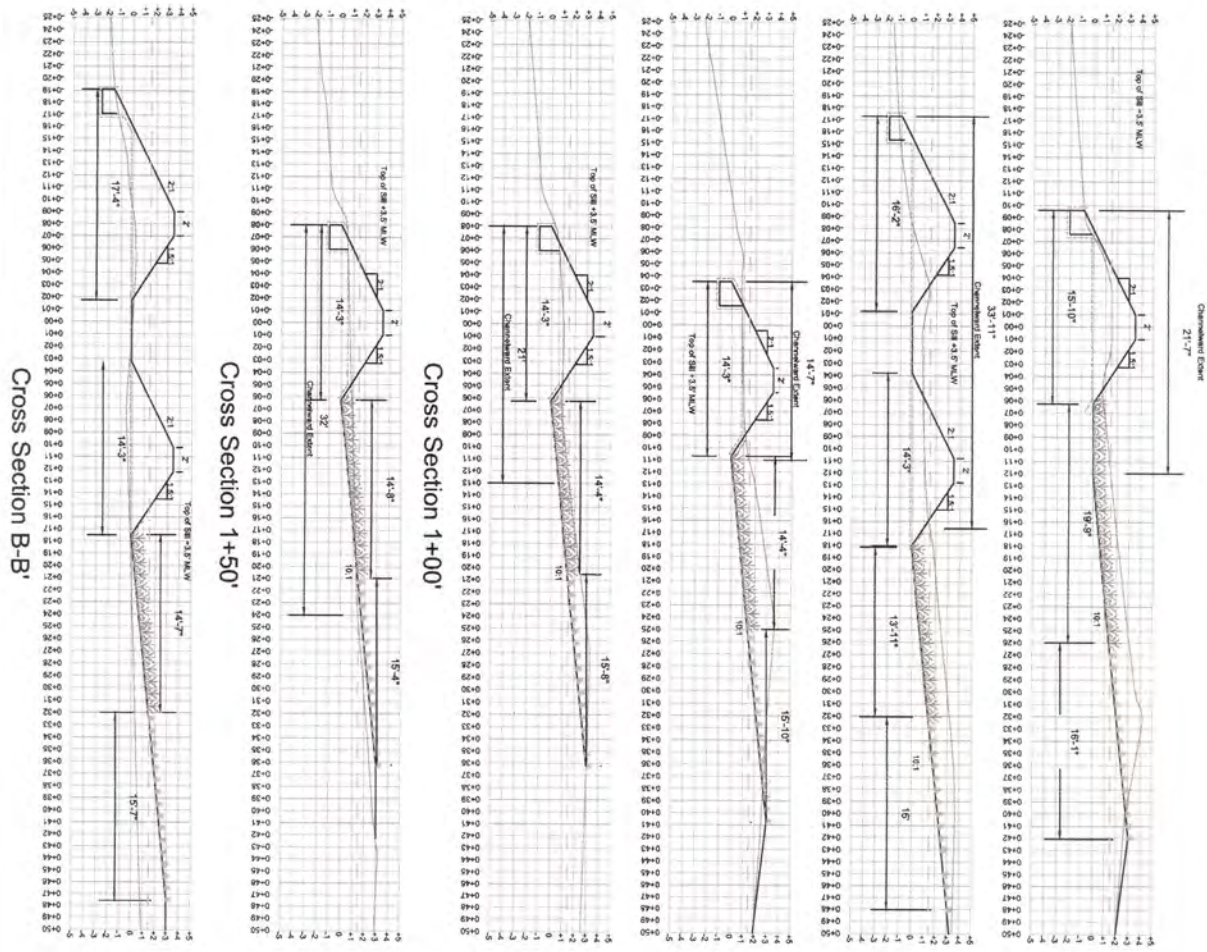

Cross Section 0+00'

Cross Section A-A'

Cross Section 0+50'

Cross Section 1+00'

LEGEND

- MHW
- EXISTING GRADE
- PROPOSED GRADE
- FILTER FABRIC
- SPARTINA ALTERNIFLORA
- SPARTINA PATEN

0 5 10 15

| REVISIONS | | |
|-----------|-------------|----------|
| Date | Description | Approved |
| | | |



TRINITY EPISCOPAL CHURCH
 CHURCH POINT PROPOSED LIVING SHORELINE PROJECT
 P.O. BOX 145 St. Mary's City, Maryland 20686

Maryland Department of Agriculture
 ST. MARY'S Soil Conservation District

| | |
|----------|-----------|
| Designed | |
| Drawn | |
| Checked | |
| Approved | Date |
| | |
| | Job Class |
| | |

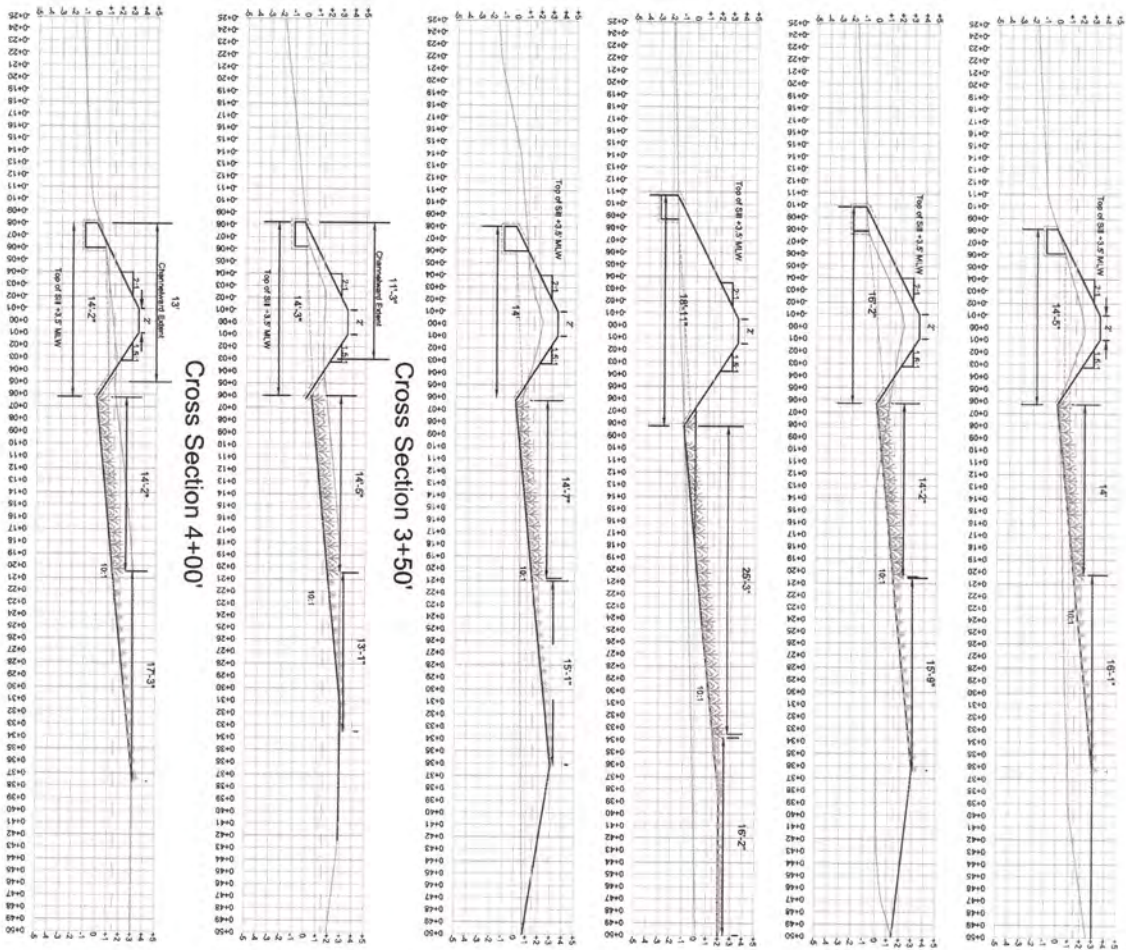

Cross Section 2+00'

Cross Section 2+50'

Cross Section 2+96.71'

Cross Section 3+50'

Cross Section 4+00'

Cross Section 4+25'

LEGEND

- MHW
- EXISTING GRADE
- PROPOSED GRADE
- FILTER FABRIC
- SPARTINA ALTERNIFLORA
- SPARTINA PATEN



| REVISIONS | | |
|-----------|-------------|----------|
| Date | Description | Approved |
| | | |
| | | |



TRINITY EPISCOPAL CHURCH
 CHURCH POINT PROPOSED LIVING SHORELINE PROJECT
 P.O. BOX 145 St. Mary's City, Maryland 20686

Maryland Department of Agriculture
 ST. MARY'S Soil Conservation District

Designed _____
 Drawn _____
 Checked _____

Approved _____ Date _____
 Title _____ Job Class _____

Statue Detail
NTS.

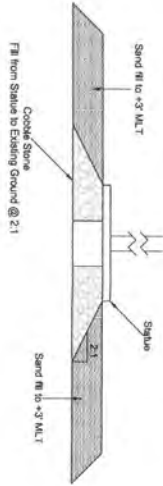

* SE WOVEN FILTER FABRIC RECOMMENDED FOR USE

SAND FILL SPECIFICATIONS

- MEDIUM TO COARSE GRAIN SANDY SOILS CLASSIFIED AS SW AND SP IN MASSACHUSETTS CLASSIFICATION OF SOILS FOR FOUNDATION DESIGNATION. CONSOLIDATED STONE OR SLAG WILL NOT BE ACCEPTABLE.
- THE BEACH NOURISHMENT MARSH SUBSTRATE MATERIAL MUST CONTAIN NO MORE THAN FIVE PERCENT (5%) PASSING THE NUMBER 20 SIEVE, NO MORE THAN TEN PERCENT (10%) PASSING THE NUMBER 40 SIEVE, AND NO MORE THAN FORTY PERCENT (40%) PASSING THE NUMBER 100 SIEVE. THE MATERIAL SHALL CONSIST OF ROUNDED OR SEMI-ROUNDED GRAINS HAVING A MEDIAN DIAMETER NO FROZEN MATERIAL, TRASH, ROOTS OR OTHER ORGANIC MATERIAL WILL BE PERMITTED IN THE FILL.

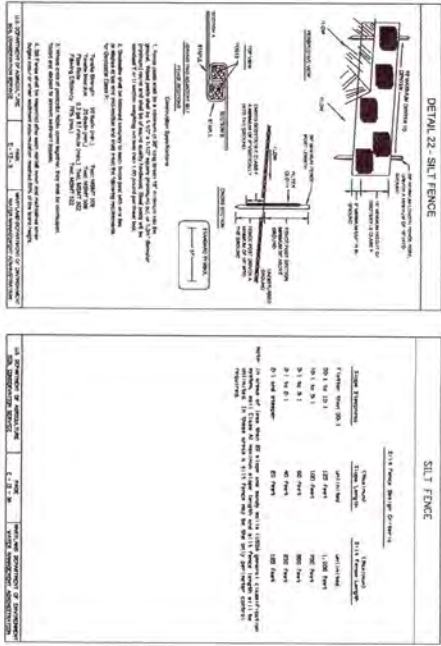

INSPECTION AGENCY APPROVAL STATEMENTS AS FOLLOWS:

- APPROVAL OF THE INSPECTION AGENCY SHALL BE REQUESTED UPON COMPLETION FOR INSTALLATION OF PERIMETER EROSION AND SEDIMENT CONTROL, BUT BEFORE PROCEEDING WITH ANY OTHER EARTH DISTURBANCE OR GRADING.
- REMOVAL OF SEDIMENT CONTROLS SHALL BE APPROVED BY THE INSPECTION AGENCY PRIOR TO COMMENCING CLEARING OR GRADING AT (410)537-2810 OR MOE. 21209-1198

TEMPORARY AND PERMANENT STABILIZATION STATEMENT

- FOLLOWING INITIAL SOIL DISTURBANCE OR REDISTURBANCE, PERMANENT OR TEMPORARY STABILIZATION SHALL BE COMPLETED WITHIN:
 - THREE CALENDAR DAYS FOR ALL PERIMETER CONTROLS, DICES, AND STABILIZATION.
 - SEVEN DAYS AS TO ALL OTHER UNNUMBERED OR GRADED AREAS IN THE PROJECT SITE.

DETAILS

Inlet Detail
NTS.

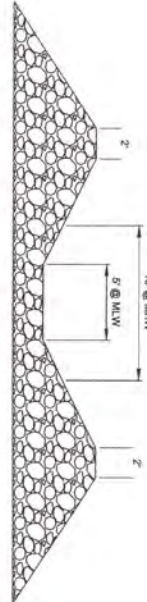

TEMPORARY SEEDING SUMMARY

| SEED MIXTURE (HARDNESS ZONE 7a) | | | | FERTILIZER RATE | | LIME RATE | |
|---------------------------------|---------|------------------|--------------|-----------------|----------------|----------------|--|
| NO. | SPECIES | APPLICATION RATE | SEEDING DATE | SEEDING DEPTH | (10-10-10) | (100LB/100 SF) | |
| 1 | RYE | 140 LBS/AC | 2/1-4/20 | 1"-2" | 600 LBS/AC | 2 TONS/AC | |
| 2 | BARLEY | 122 LBS/AC | 8/15-11/20 | 1"-2" | 150 LBS/100 SF | (100LB/100 SF) | |

| SEED MIXTURE (HARDNESS ZONE 7a) | | | | FERTILIZER RATE | | LIME RATE | |
|---------------------------------|--------------------------------|------------------|--------------|-----------------|------------|----------------|--|
| NO. | SPECIES | APPLICATION RATE | SEEDING DATE | SEEDING DEPTH | (10-20-20) | (100LB/100 SF) | |
| 1 | TALL FESCUE | 130 LBS/AC | 8/15-8/15 | 1"-2" | N | 2 TONS/AC | |
| 2 | TALL FESCUE/PERENNIAL RYEGRASS | 122 LBS/AC | 8/15-11/15 | 1"-2" | P | (100LB/100 SF) | |

| REVISIONS | | |
|-----------|-------------|----------|
| Date | Description | Approved |
| | | |



TRINITY EPISCOPAL CHURCH
CHURCH POINT PROPOSED LIVING SHORELINE PROJECT
P.O. BOX 145 St. Mary's City, Maryland 20686

Maryland Department of Agriculture
ST. MARY'S Soil Conservation District

| | |
|----------|-----------|
| Designed | |
| Drawn | |
| Checked | |
| Approved | Date |
| Title | Job Class |

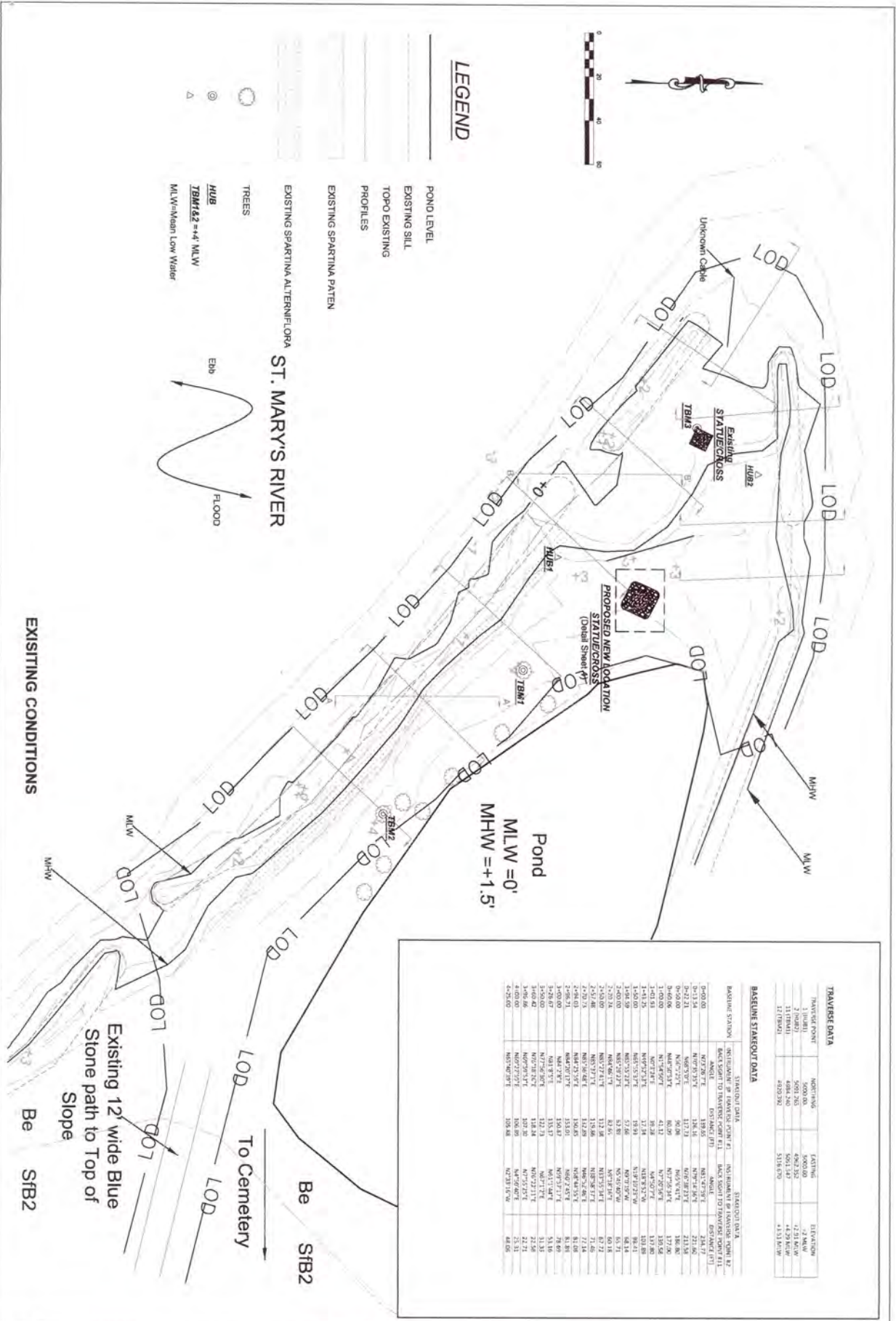

LEGEND

- POND LEVEL
- EXISTING SILL
- TOPO EXISTING
- PROFILES
- EXISTING SPARTINA PATEN
- EXISTING SPARTINA ALTERNIFLORA
- TREES
- ⊙ HUB
- △ TBM1&2 = +4' MLW
- △ MLW=Mean Low Water



ST. MARY'S RIVER

EXISTING CONDITIONS

Existing 12' wide Blue Stone path to Top of Slope

Pond
MLW = 0'
MHW = +1.5'

| TRAVERSE DATA | | EASTING | | ELEVATION | |
|---------------|----------|----------|---|---------------------|-----------|
| TRAVEL POINT | NORTHING | 5000.000 | 4962.352 | 4.212 MHW | 4.292 MLW |
| 11 (TBM1) | 4084.240 | 5051.147 | 4.128 MHW <td>4.128 MLW <td></td> </td> | 4.128 MLW <td></td> | |
| 12 (TBM2) | 4020.292 | 5116.970 | 4.133 MHW <td>4.133 MLW <td></td> </td> | 4.133 MLW <td></td> | |

| BASELINE STAKEOUT DATA | | STATION DATA | | ELEVATION DATA | |
|------------------------|---------------------------------|--------------|---------------------------------|----------------|-----------|
| BASELINE STATION | INSTRUMENTATION # | STATION NO. | INSTRUMENTATION # | STATION NO. | ELEVATION |
| 0+00.00 | ROCKSIGHT TO TRAVERSE POINT #11 | 001 | ROCKSIGHT TO TRAVERSE POINT #12 | 001 | 221.66 |
| 0+13.84 | 0+13.84 | 138.46 | 0+13.84 | 138.46 | 221.66 |
| 0+22.24 | 0+22.24 | 222.24 | 0+22.24 | 222.24 | 221.66 |
| 0+40.06 | 0+40.06 | 400.06 | 0+40.06 | 400.06 | 221.66 |
| 1+00.00 | 1+00.00 | 1000.00 | 1+00.00 | 1000.00 | 221.66 |
| 1+21.15 | 1+21.15 | 1211.15 | 1+21.15 | 1211.15 | 221.66 |
| 1+40.00 | 1+40.00 | 1400.00 | 1+40.00 | 1400.00 | 221.66 |
| 1+58.00 | 1+58.00 | 1580.00 | 1+58.00 | 1580.00 | 221.66 |
| 2+00.00 | 2+00.00 | 2000.00 | 2+00.00 | 2000.00 | 221.66 |
| 2+23.86 | 2+23.86 | 2238.86 | 2+23.86 | 2238.86 | 221.66 |
| 2+48.00 | 2+48.00 | 2480.00 | 2+48.00 | 2480.00 | 221.66 |
| 2+66.71 | 2+66.71 | 2666.71 | 2+66.71 | 2666.71 | 221.66 |
| 3+00.00 | 3+00.00 | 3000.00 | 3+00.00 | 3000.00 | 221.66 |
| 3+60.00 | 3+60.00 | 3600.00 | 3+60.00 | 3600.00 | 221.66 |
| 4+00.00 | 4+00.00 | 4000.00 | 4+00.00 | 4000.00 | 221.66 |
| 4+25.00 | 4+25.00 | 4250.00 | 4+25.00 | 4250.00 | 221.66 |

| REVISIONS | | |
|-----------|-------------|----------|
| Date | Description | Approved |
| | | |



TRINITY EPISCOPAL CHURCH
CHURCH POINT PROPOSED LIVING SHORELINE PROJECT
P.O. BOX 145 St. Mary's City, Maryland 20686

Designed _____
Drawn _____
Checked _____

Maryland Department of Agriculture
ST. MARY'S Soil Conservation District

Approved _____ Date _____
Title _____ Job Class _____

CHURCH POINT

BUFFER MANAGEMENT PLAN (ST. MARY'S SOIL CONSERVATION DISTRICT)



NTS.

NOTE
The proposed access road is shown. It will consist of a 12' wide gravel road. The road will be constructed on the existing lawn/amenity area and will be laid out in accordance with Trinity Episcopal Church. No existing vegetation or material will be removed or destroyed. Once construction is complete the road will be removed and any disturbance will be returned to existing conditions.

NOTE
The selected contractor, may at their discretion, do all of the proposed work from the water via the use of a barge. If that alternative is used, this limited access road may not be required or altered.

NOTE
In the wooded section of the access road there is an existing blue stone road that will be used and maintained during construction. It will be restored to existing or better conditions when construction is complete. Access road is shown below.

TOTAL LIMITS OF DISTURBANCE
The total LOD including the existing blue stone access road is approximately 11,500 square feet. The total LOD including the existing blue stone access road is 11,500 square feet (900'x127').

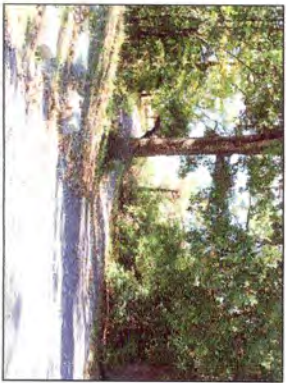

Blue stone access road looking down from the cemetery.



Blue stone access road looking down from the cemetery.



Blue stone access road looking uphill from the beach.



Proposed point of access looking from the parking lot.



Proposed access road looking from blue stone road.



Proposed access road looking towards project site.

| REVISIONS | | |
|-----------|-------------|----------|
| Date | Description | Approved |
| | | |

File No. _____
DMC _____
Sheet 8 of 8



TRINITY EPISCOPAL CHURCH
CHURCH POINT PROPOSED LIVING SHORELINE PROJECT
P.O. BOX 145 St. Mary's City, Maryland 20686

Maryland Department of Agriculture
ST. MARY'S Soil Conservation District

Designed _____
Drawn _____
Checked _____

Approved _____ Date _____
Title _____ Job Class _____