

**U.S. Army Corps
of Engineers
Baltimore District**

Public Notice

In Reply to Application Number
CENAB-OP-RM
(Elliott, David /Aquaculture Lease #248)2015-01048
(Harrington, Phillip /Aquaculture Lease #238)2015-01051
(Norzagaray, Noe /Aquaculture Lease #249)2015-01063

PN 15-70

Comment Period: October 28, 2015 to November 28, 2015

THE PURPOSE OF THIS PUBLIC NOTICE IS TO SOLICIT COMMENTS FROM THE PUBLIC ABOUT THE WORK DESCRIBED BELOW. AT THIS TIME, NO DECISION HAS BEEN MADE AS TO WHETHER OR NOT A PERMIT WILL BE ISSUED.

The Baltimore District has received 3 applications for Department of the Army Permit pursuant to Section 10 of the Rivers and Harbors Act of 1899 and Section 404 of the Clean Water Act as described below:

APPLICANT: Mr. David Thomas Elliott
4115 Wrights Wharf Road
Hurlock, Maryland 21643

Mr. Noe V. Norzagaray
6101 Suicide Bridge Road
East New Market, Maryland 21631

Mr. Philip J. Harrington
3725 Sunnyside Road
Secretary, Maryland 21664

LOCATION: The projects are proposed in Hooper Strait and the Honga River between Crab Point and Jenny Island, Dorchester County, Maryland.

DESCRIPTION OF WORK:

To establish, operate, and maintain an aquaculture operation within 3 oyster aquaculture cultivation sites totaling approximately of 532.2 acres by depositing oyster shell with spat on the bottom a maximum of 3 inches, without predator controls (e.g. nets, etcetera), on the bottom substrate. The site substrate is composed of sand and mud with scattered shell throughout the project areas and would be used for purposes of culturing native Eastern Oyster (*Crassostrea virginica*) on the proposed bottom lease sites.

The applicants have advised that the proposed submerged land lease areas would be subject to periodic harrowing, dragging and additional deposition of oyster shells, as needed, as described above, to maintain the sites. Harvesting would be accomplished by dredging or other harvesting means as approved by the MD DNR. Staging and off-loading would be at Captain Phips Seafood on Water Street in Choptank north of Secretary, Dorchester County, Maryland. The primary source for the oyster seed would be supplied by the University of Maryland Center for Environmental Science (UMCES) Horn Point Laboratory in Dorchester County, Maryland. The lease sites would be marked by anchored buoys at the corners with the name and lease number identified on each buoy.

CENAB-OP-RMS (Elliott, David /Aquaculture Lease #248)2015-01048

The bottom lease site is an approximate 119.4 acre area located a minimum of 780 feet channelward of the approximate shoreline and a maximum of 2,960 feet channelward of the approximate shoreline. Water depths within the project site varies from 5.0 feet to 23.0 feet at mean lower low water (MLLW), depending on the location within the project area, and the applicant's plans identify a minimum vertical clearance of 4 feet 9 inches at MLLW above the finished grade/elevation of the oyster shell after deposition. The coordinates for this lease in Dorchester County are as follows:

Corner	Latitude	Longitude
1	38° 13' 21.3" N	-76° 3' 45.1" W
2	38° 13' 41.3" N	-76° 4' 14.7" W
3	38° 13' 58.8" N	-76° 3' 58.3" W
4	38° 13' 43.3" N	-76° 3' 44.1" W
5	38° 13' 29.0" N	-76° 3' 39.5" W

(Harrington, Phillip /Aquaculture Lease #238) 2015-01051

The bottom lease site is an approximate 259.7 acre area located a minimum of 497 feet channelward of the approximate shoreline and a maximum of 5,239 feet channelward of the approximate shoreline. Water depths within the project site varies from 5.2 feet to 13.7 feet at mean lower low water (MLLW), depending on the location within the project area, and the applicant's plans identify a minimum vertical clearance of 4 feet 11 inches at MLLW above the finished grade/elevation of the oyster shell after deposition. The coordinates for this lease in Dorchester County are as follows:

Corner	Latitude	Longitude
1	38° 13' 42.7" N	-76° 4' 33.1" W
2	38° 14' 27.1" N	-76° 5' 13.6" W
3	38° 14' 39.4" N	-76° 4' 58.6" W
4	38° 14' 15.4" N	-76° 4' 37.4" W
5	38° 14' 8.5" N	-76° 4' 4.6" W

CENAB-OP-RMS (Norzagaray, Noe /Aquaculture Lease #249) 2015-01063

The bottom lease site is an approximate 153.2 acre area located a minimum of 1,014 feet channelward of the approximate shoreline and a maximum of 4,876 feet channelward of the approximate shoreline. Water depth within the project site varies from 4.5 feet to 14.5 feet at mean lower low water (MLLW), depending on the location within the project area, and the applicant's plans identify a minimum vertical clearance of 4 feet 3 inches at MLLW above the finished grade/elevation of the oyster shell after deposition. The coordinates for this lease in Dorchester County are as follows:

Corner	Latitude	Longitude
1	38° 14' 28.9" N	-76° 5' 46.0" W
2	38° 14' 31.7" N	-76° 6' 9.7" W
3	38° 15' 0.1" N	-76° 6' 23.6" W

4	38° 14' 59.7" N	-76° 6' 1.3" W
5	38° 14' 48.9" N	-76° 6' 1.6" W
6	38° 15' 00.0" N	-76° 5' 44.6" W

The purposes of the proposed projects are to establish areas of suitable substrate for the commercial production of oyster shellfish to marketable size.

As part of the planning process for the proposed project, steps were taken to ensure avoidance and minimization of impacts to aquatic resources to the maximum extent practicable. This area was chosen to minimize potential impacts to submerged aquatic vegetation (SAV) and navigation. According to the Virginia Institute of Marine Science (VIMS) survey maps, there is no SAV mapped within the project footprint of the proposed aquaculture operation for years 2009 through 2013. No mitigation measures are proposed by the applicants.

All work will be completed in accordance with the enclosed plan(s). If you have any questions concerning this matter, please contact Mr. Christopher Spaur of this office at 410-962-6134 or by email at christopher.c.spaur@usace.army.mil or Mr. Eugene Morgenthaler of this office at 410-820-8629 or by email at eugene.j.morgenthaler@usace.army.mil

The Magnuson-Stevens Fishery Conservation and Management Act (MSFCMA), as amended by the Sustainable Fisheries Act of 1996 (Public Law 04-267), requires all Federal agencies to consult with the National Marine Fisheries Service (NMFS) on all actions, or proposed actions, permitted, funded, or undertaken by the agency that may adversely affect Essential Fish Habitat (EFH).

The project site lies in or adjacent to EFH as described under MSFCMA for *Scophthalmus aquosus* (windowpane flounder) juvenile and adult; *Pomatomus saltatrix* (bluefish) juvenile and adult; *Paralichthys dentatus* (summer flounder) larvae, juvenile, and adult; egg, larvae, juvenile, and adult of *Scomberomorus cavalla* (king mackerel), *Scomberomorus maculatus* (Spanish mackerel), *Rachycentron canadum* (cobia), and *Sciaenops ocellatus* (red drum), all managed species under the MSFCMA.

The projects have the potential to adversely affect EFH or the species of concern by the alteration of spawning, nursery, forage and/or shelter habitat as described under the MSFCMA for the species and life stages identified above. The habitat of the bottom substrate at the project site consists of limited shell on a mix of sand and mud which does not support SAV. The Baltimore District has made a preliminary determination that site-specific impacts would not be substantial and an abbreviated consultation will be conducted with NMFS. No mitigative measures are recommended at this time to minimize adverse effects on EFH. This preliminary determination may be modified if additional information indicates otherwise and could change the Corps' preliminary determination.

The applicants are required to obtain a water quality certification in accordance with Section 401 of the Clean Water Act from the Maryland Department of the Environment. Any written comments concerning the work described above which relate to water quality certification must be received by the Wetlands and Waterways Program, Maryland Department of the Environment, Montgomery Park Business Center, 1800 Washington Boulevard, Suite 430, Baltimore, Maryland 21230-1708 within the comment period as specified above to receive consideration. The Section 401 certifying agency has a statutory limit of one year from the date of this public notice to make its decision.

The decision whether to issue a permit will be based on an evaluation of the probable impacts, including cumulative impacts of the proposed activity on the public interest. That decision will reflect the national concern for both protection and utilization of important resources. The benefit, which reasonable may be expected to accrue from the proposal, must be balanced against its reasonably foreseeable detriments. All factors, which may be relevant to the proposal will be

considered, including the cumulative effects thereof; among those are conservation, economic, aesthetics, general environmental concerns, wetlands, cultural values, fish and wildlife values, flood hazards, flood plain values, land use, navigation, shoreline erosion and accretion, recreation, water supply and conservation, water quality, energy needs, safety, food and fiber production, mineral needs, and consideration of property ownership and in general, the needs and welfare of the people.

The Corps of Engineers is soliciting comments from the public; Federal, State, and local agencies and officials; Indian Tribes; and other interested parties in order to consider and evaluate the impacts of this proposed activity. Any comments received will be considered by the Corps of Engineers to determine whether to issue, modify, condition or deny a permit for this proposal. To make this decision, comments are used to assess impacts on endangered species, historic properties, water quality, general environmental effects, and the other public interest factors listed above.

Comments are used in the preparation of an Environmental Assessment and/or an Environmental Impact Statement pursuant to the National Environmental Policy Act. Comments provided will become part of the public record for this action. Comments are also used to determine the need for a public hearing and to determine the overall public interest of the proposed activity. Written comments concerning the work described above related to the factors listed above or other pertinent factors must be received by the District Engineer, U.S. Army Corps of Engineers, Baltimore District, P.O. Box 1715, Baltimore, Maryland, 21203 within the comment period specified above.

Where applicable, the applicant has certified in this application that the proposed activity complies with and will be conducted in a manner consistent with the approved Coastal Zone Management (CZM) Program. By this public notice, we are requesting the State concurrence or objection to the applicant's consistency statement. It should be noted that the CZM Program has a statutory limit of 6 months to make its consistency determination.

The applicant must obtain any State or local government permits which may be required.

A preliminary review of this application indicates that the proposed work may affect Federal listed threatened or endangered species or their critical habitat, pursuant to Section 7 of the Endangered Species Act, as amended. The project location and vicinity is not mapped as critical habitat for any known Federally-listed threatened or endangered species; however, the waterway is known to be utilized by transient individuals of the following species: Loggerhead sea turtles (*Caretta caretta*); Kemp's Ridley sea turtles (*Lepidochelys kempii*); Leatherback sea turtles (*Dermochelys coriacea*); Green sea turtles (*Chelonia mydas*); Shortnose sturgeon (*Acipenser brevirostrum*); and Atlantic sturgeon (*Acipenser oxyrinchus*). The Baltimore District will initiate informal consultation under Section 7(a)(2) of the ESA. As the evaluation of this application continues, additional information may become available which could modify this preliminary determination.

Review of the latest published version of the National Register of Historic Places indicates that no registered properties listed as eligible for inclusion, therein, are located at the site of the proposed work. Currently unknown archeological, scientific, prehistoric, or historical data may be lost or destroyed by the work to be accomplished under the request permit.

The evaluation of the impact of the work described above on the public interest will include application of the guidelines promulgated by the Administrator, U.S. Environmental Protection Agency, under authority of Section 404 of the Clean Water Act.

Any person who has an interest which may be adversely affected by the issuance of this permit may request a public hearing. The District Engineer must receive the request, which must be in writing, US Army Corps of Engineers, Baltimore District, PO Box 1715, Baltimore, Maryland 21203-1715, within the comment period as specified as above to receive consideration. Also, it must clearly state forth the interest that may be adversely affected by this activity in the manner in which the interest may be adversely affected.

It is requested that you communicate this information concerning the proposed work to any persons known by you to be interested and not being known to this office, who did not receive a copy of this notice.

FOR THE DISTRICT ENGINEER:

KATHY B. ANDERSON
Chief, Maryland Section Southern

Proposed Shellfish Submerged Land Lease Overview Map

David T. Elliott #248 - Hooper Strait, Dorchester County Maryland

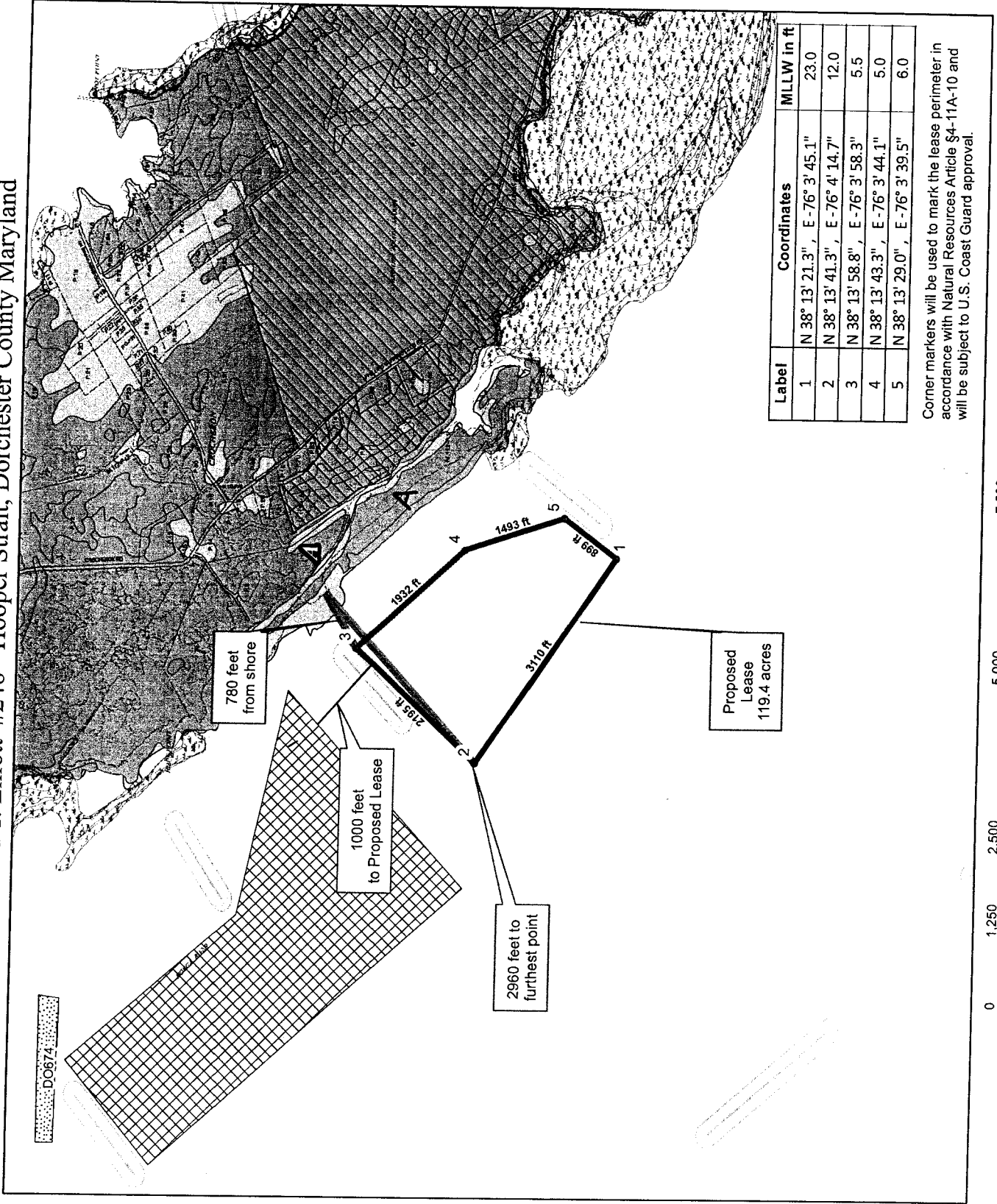

- Proposed Lease
- Land-Based Sanctuaries and Refuges (state, federal, private, etc)
- Submerged Aquatic Vegetation (VIMS)
- Structures (Piers, Marinas, etc)
- Wetlands of Special State Concern (MD-DNR)
- Active Shellfish Lease
- Proposed Shellfish Lease
- Tidal Wetlands (NWI Wetlands) (excludes E1 type)
- Federal Navigational Channels (US Army Corps)
- 150 foot Channel Boundary (MD-DNR)
- Registered Pound Net Site and 150 ft. buffer (MD-DNR)

Also shown on this map is Maryland State Tax data from the MD Property View CD Series (Maryland Department of Planning).



Larry Hogan
Governor
Boyd K. Rutherford
Lt. Governor
Mark J. Belton
Secretary



Maryland Department of Natural Resources
Geospatial Information and Analysis
380 Taylor Ave. E-2, Annapolis, MD 21401
410-260-8988 or 1-877-620-8DNR x8985
dnr.maryland.gov
DNR June 2015

IIa.

Label	Coordinates	MLLW in ft
1	N 38° 13' 21.3", E -76° 3' 45.1"	23.0
2	N 38° 13' 41.3", E -76° 4' 14.7"	12.0
3	N 38° 13' 58.8", E -76° 3' 58.3"	5.5
4	N 38° 13' 43.3", E -76° 3' 44.1"	5.0
5	N 38° 13' 29.0", E -76° 3' 39.5"	6.0

Corner markers will be used to mark the lease perimeter in accordance with Natural Resources Article §4-11A-10 and will be subject to U.S. Coast Guard approval.

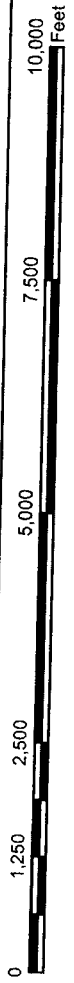

780 feet from shore

1000 feet to Proposed Lease

2960 feet to furthest point

Proposed Lease
119.4 acres

DO674

Proposed Shellfish Submerged Land Lease NAV Chart Map

David T. Elliott #248 - Hooper Strait, Dorchester County Maryland

#6.

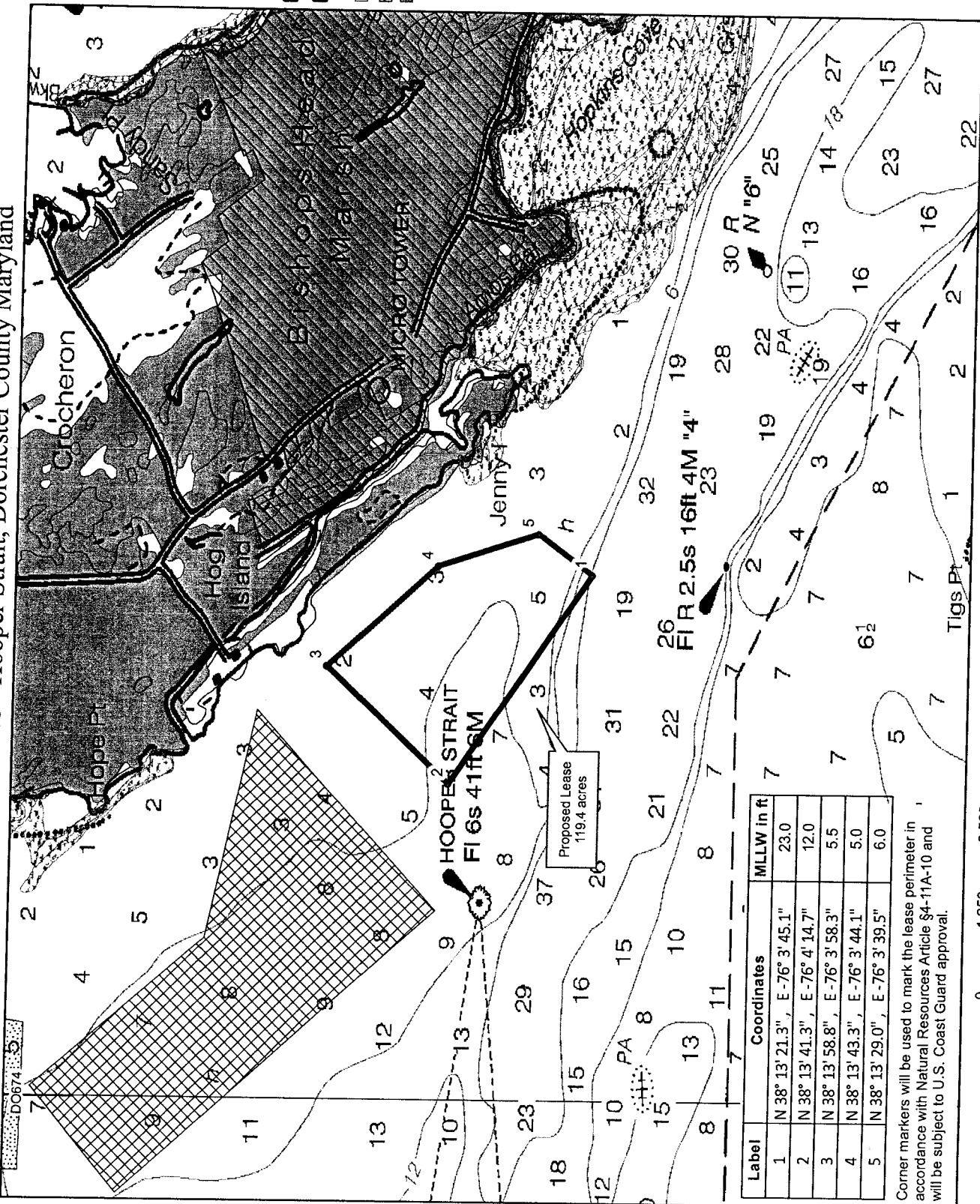

Lease Area shown over
NOAA Raster
Navigational Charts.

- Proposed Lease
- Land-Based Sanctuaries and Refuges (state, federal, private, etc)
- Submerged Aquatic Vegetation (VIMS)
- Structures (Piers, Marinas, etc)
- Wetlands of Special State Concern (MD-DNR)
- Active Shellfish Lease
- Proposed Shellfish Lease
- Tidal Wetlands (NWI Wetlands) (excludes E1 type)

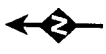

Larry Hogan
Governor
Boyd K. Rutherford
Lt. Governor
Mark J. Belton
Secretary



Maryland Department of Natural Resources
Geospatial Information and Analysis
580 Taylor Ave. E. 2nd Floor
410-260-8985 or 1-877-420-8DNR x8985
dnr.maryland.gov
DNR June 2015

Label	Coordinates	MLLW in ft
1	N 38° 13' 21.3", E-76° 3' 45.1"	23.0
2	N 38° 13' 41.3", E-76° 4' 14.7"	12.0
3	N 38° 13' 58.8", E-76° 3' 58.3"	5.5
4	N 38° 13' 43.3", E-76° 3' 44.1"	5.0
5	N 38° 13' 29.0", E-76° 3' 39.5"	6.0

Corner markers will be used to mark the lease perimeter in accordance with Natural Resources Article §4-11A-10 and will be subject to U.S. Coast Guard approval.



Cross-Section Diagram for Proposed Submerged Land Lease #248

Name: David T. Elliott
Town, State: Bishops Head, MD
Waterbody: Hooper Strait
Date: July 2015

 Corner marker with applicant contact info (see insert for details)

MHW = mean high water

MLLW = mean lower low water

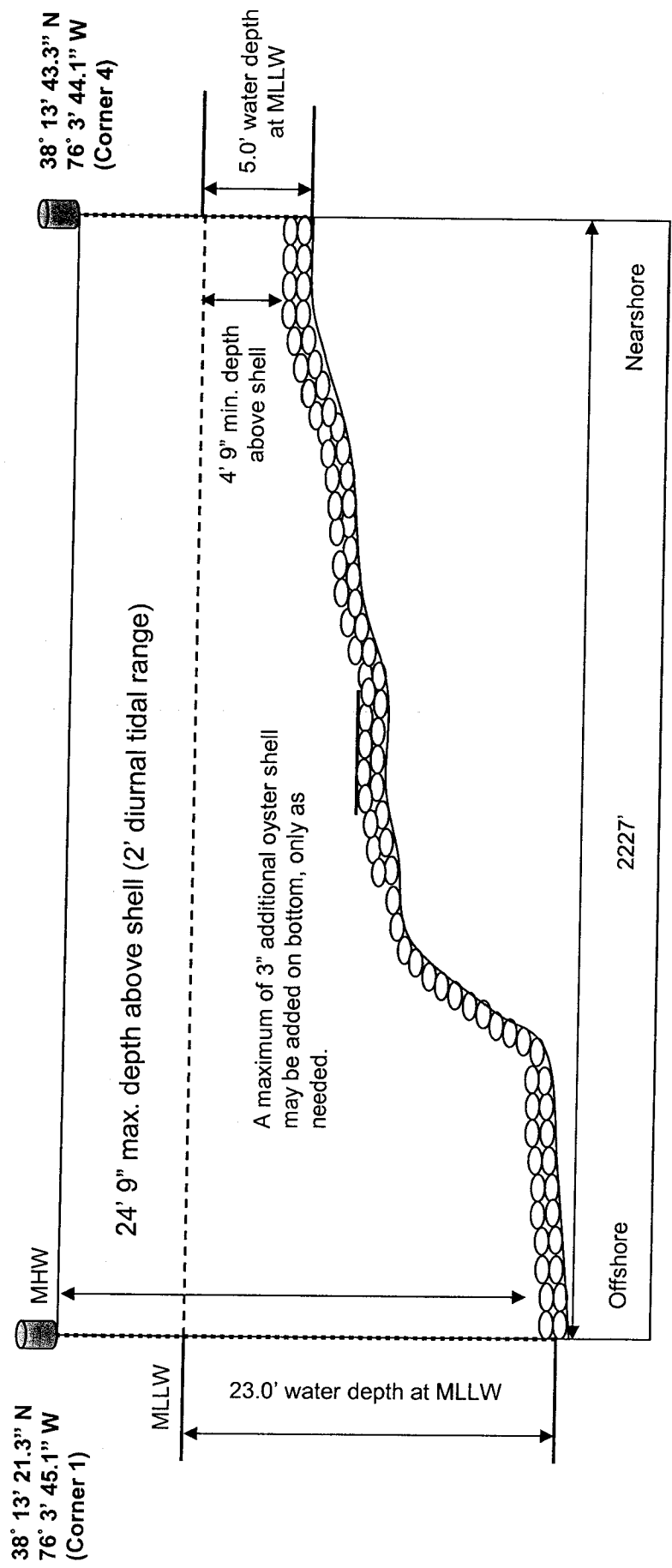

Proposed Shellfish Submerged Land Lease Overview Map

Philip J. Harrington, III #238 - Honga River, Dorchester County Maryland

- Proposed Lease
- Land-Based Sanctuaries and Refuges (state, federal, private, etc)
- Submerged Aquatic Vegetation (VIMS)
- Structures (Piers, Marinas, etc)
- Wetlands of Special State Concern (MD-DNR)
- Active Shellfish Lease
- Proposed Shellfish Lease
- Tidal Wetlands (NWI Wetlands) (excludes E1 type)
- Federal Navigational Channels (US Army Corps)
- 150 foot Channel Boundary (MD-DNR)
- Registered Pound Net Site and 150 ft. buffer (MD-DNR)

Also shown on this map is Maryland State Tax data from the MD Property View CD Series (Maryland Department of Planning).



Larry Hogan
Governor
Boyd K. Rutherford
Lt. Governor
Mark J. Belton
Secretary



Maryland Department of Natural Resources
Geospatial Information and Analysis
580 Taylor Ave. E-2 Annapolis, MD 21401
410-260-8985 or 1-877-420-RDNR 48985
dnr.maryland.gov
DNR June 2015

IIa.

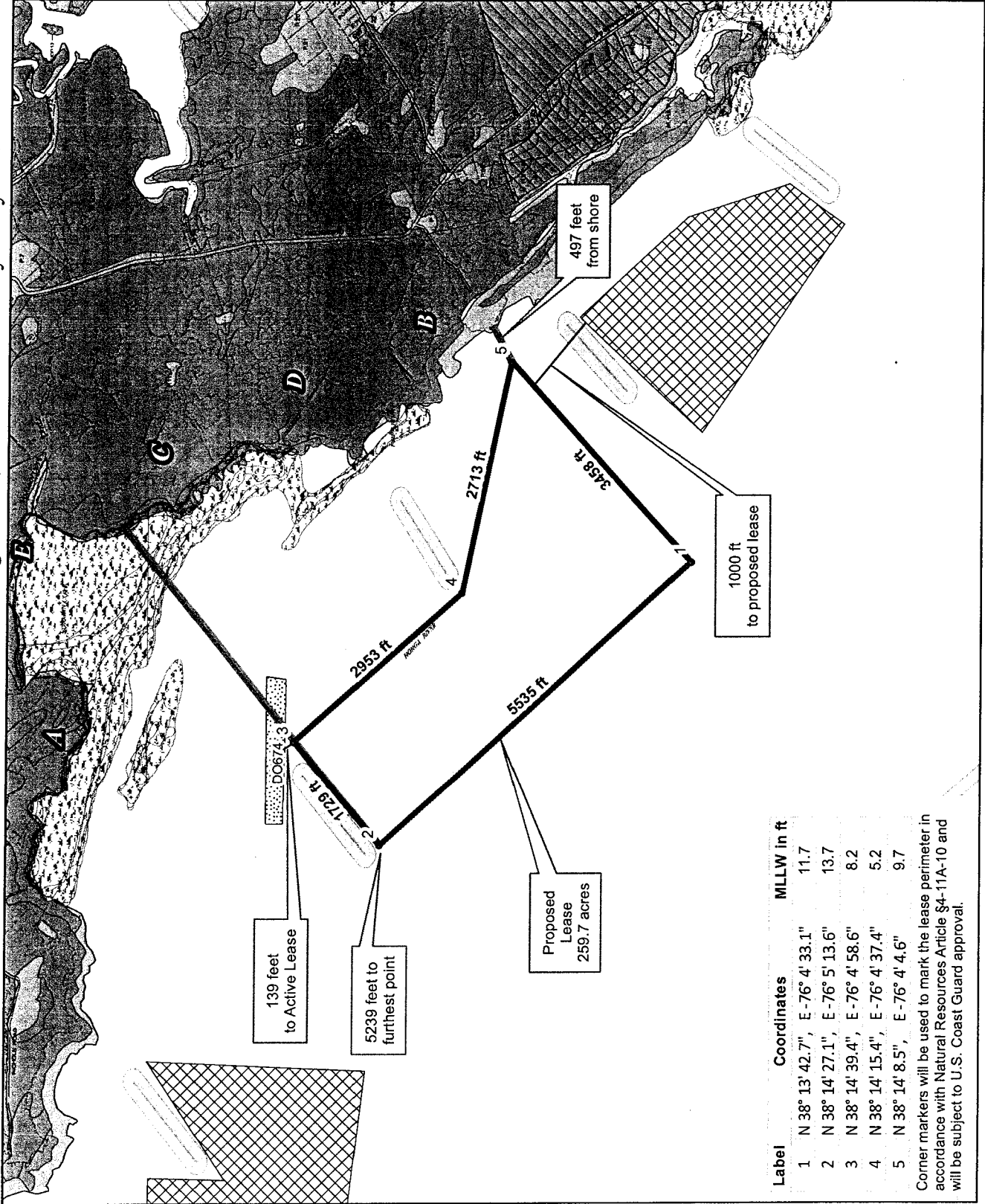

Proposed Shellfish Submerged Land Lease NAV Chart Map

Philip J. Harrington, III #238 - Hoga River, Dorchester County Maryland

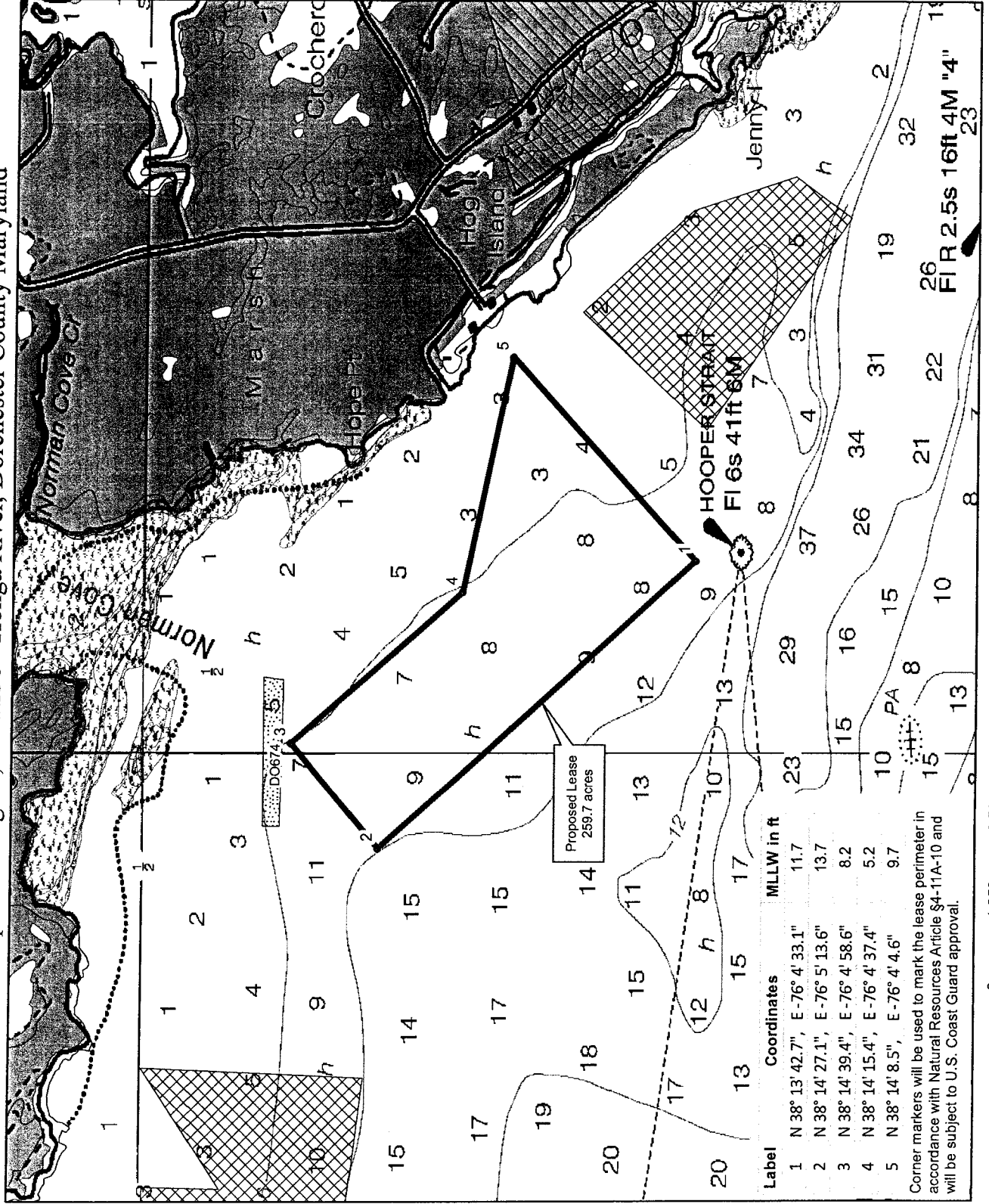

Lease Area shown over NOAA Raster Navigational Charts.

- Proposed Lease
- Land-Based Sanctuaries and Refuges (state, federal, private, etc)
- Submerged Aquatic Vegetation (VMS)
- Structures (Piers, Marinas, etc)
- Wetlands of Special State Concern (MD-DNR)
- Active Shellfish Lease
- Proposed Shellfish Lease
- Tidal Wetlands (NWI Wetlands) (excludes E1 type)



Larry Hogan
Governor
Boyd K. Rutherford
Lt. Governor
Mark J. Belton
Secretary



Maryland Department of Natural Resources
Geospatial Information and Analysis
580 Taylor Ave. E2 Annapolis, MD 21401
410-260-8985 or 1-877-620-8DNR x8985
dnr@dnr.state.md.us
DNR June 2015

410

Name: Philip J. Harrington, III
 Town, State: Bivalve, MD
 Waterbody: Nanticoke River
 Date: June 2015

Cross-Section Diagram for Proposed Submerged Land Lease #238

 Corner marker with applicant contact info (see insert for details)
MHW = mean high water
MLLW = mean lower low water

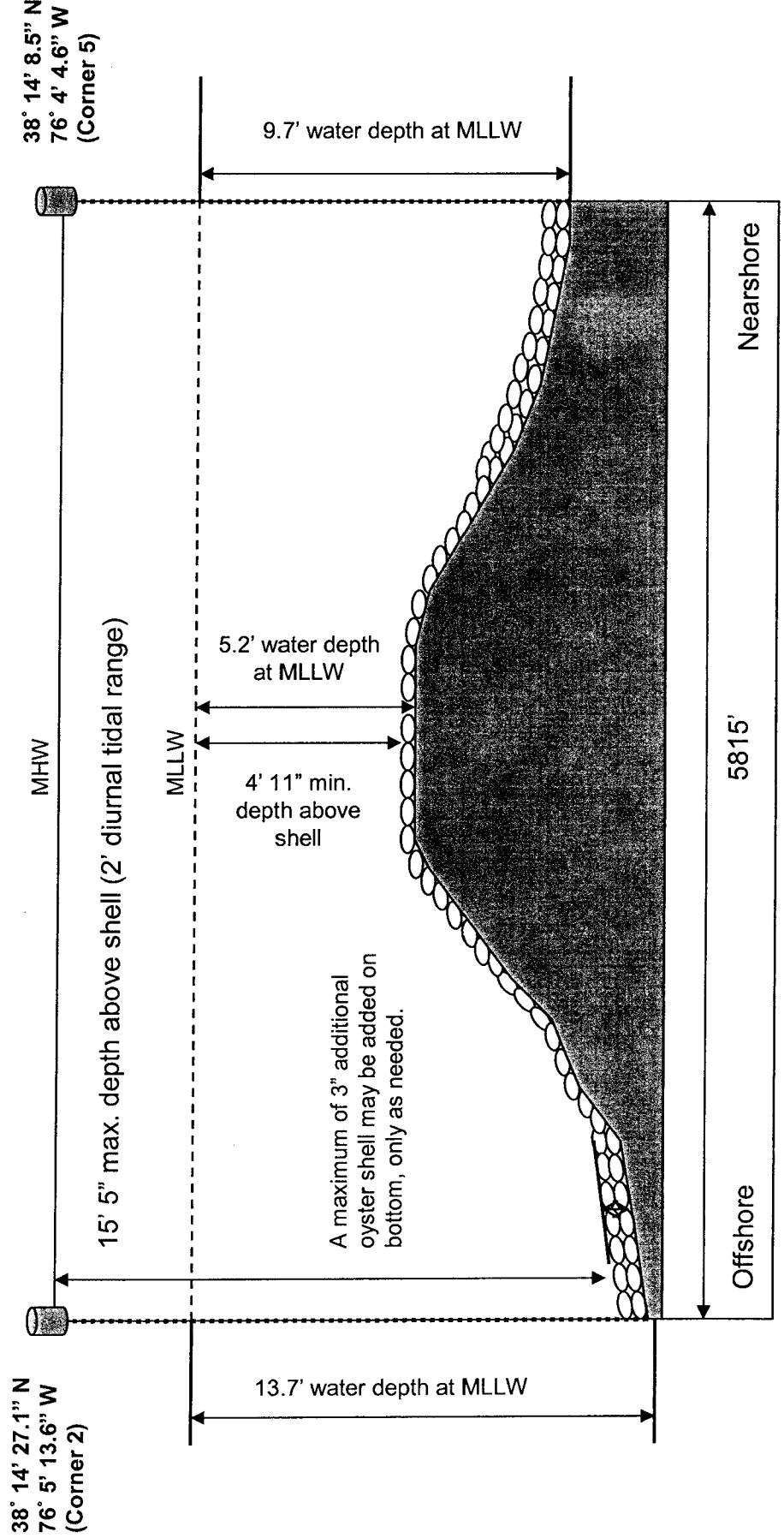

Proposed Shellfish Submerged Land Lease Overview Map

Noe V. Norzagaray #249 - Honga River, Dorchester County Maryland

11a.

- Proposed Lease
- Land-Based Sanctuaries and Refuges (state, federal, private, etc)
- Submerged Aquatic Vegetation (VIMS)
- Structures (Piers, Marinas, etc)
- Wetlands of Special State Concern (MD-DNR)
- Active Shellfish Lease
- Proposed Shellfish Lease (excludes E1 type)
- Tidal Wetlands (NWI Wetlands)
- Federal Navigational Channels (US Army Corps)
- 150 foot Channel Boundary (MD-DNR)
- Registered Pound Net Site and 150 ft. buffer (MD-DNR)

Also shown on this map is Maryland State Tax data from the MD Property View CD Series (Maryland Department of Planning).



Larry Hogan
Governor
Boyd K. Rutherford
Lt. Governor
Mark J. Belton
Secretary



Maryland Department of Natural Resources
Geospatial Information and Analysis
11000 Ave. E-2, Annapolis, MD 21401
410.326.6888 or 1-877-423-8DNR x8985
dncrmap@aol.com
DNR July 2015

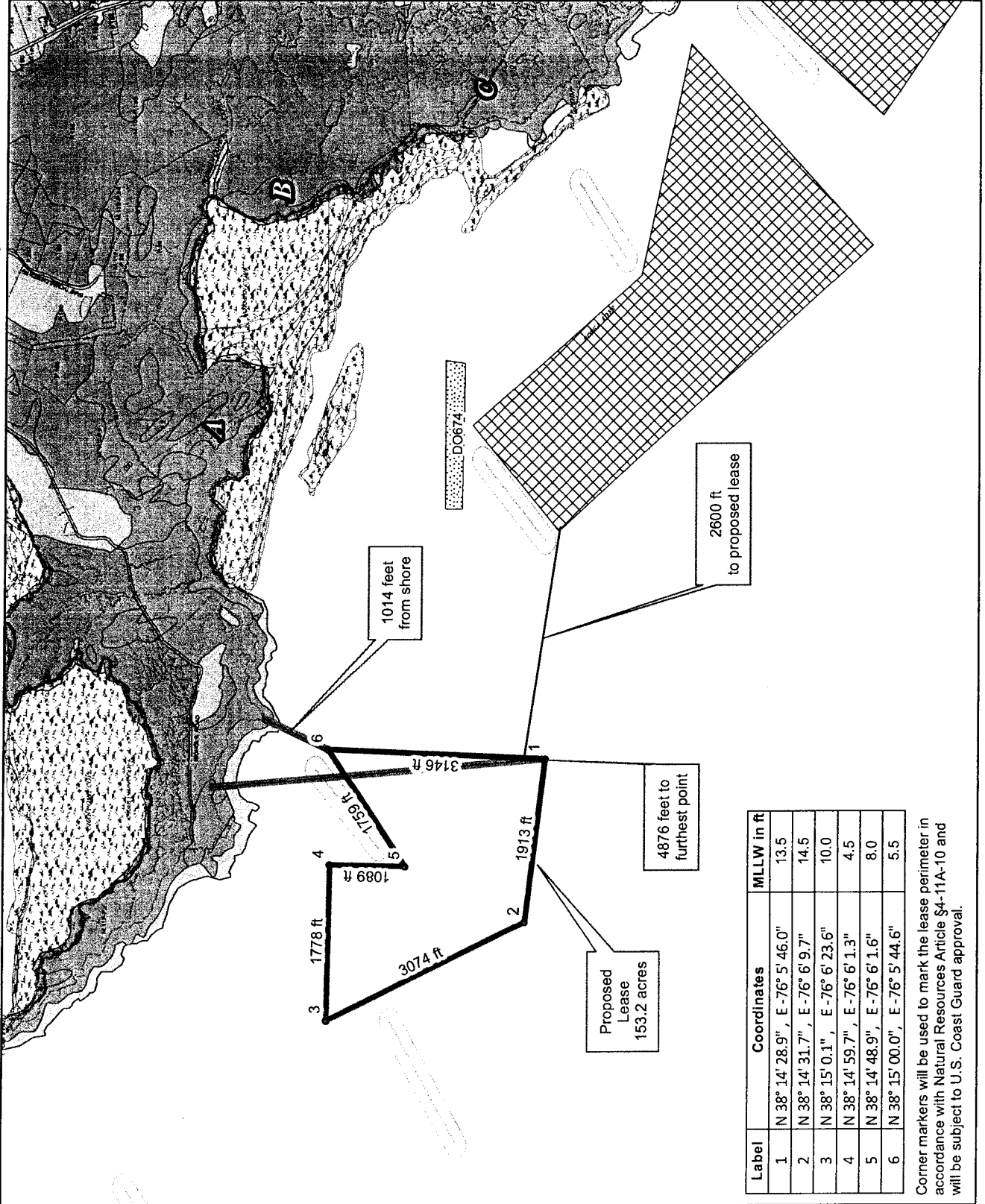

Corner markers will be used to mark the lease perimeter in accordance with Natural Resources Article §4-11A-10 and will be subject to U.S. Coast Guard approval.

Proposed Shellfish Submerged Land Lease NAV Chart Map

Noe V. Norzagaray #249 - Honga River, Dorchester County Maryland

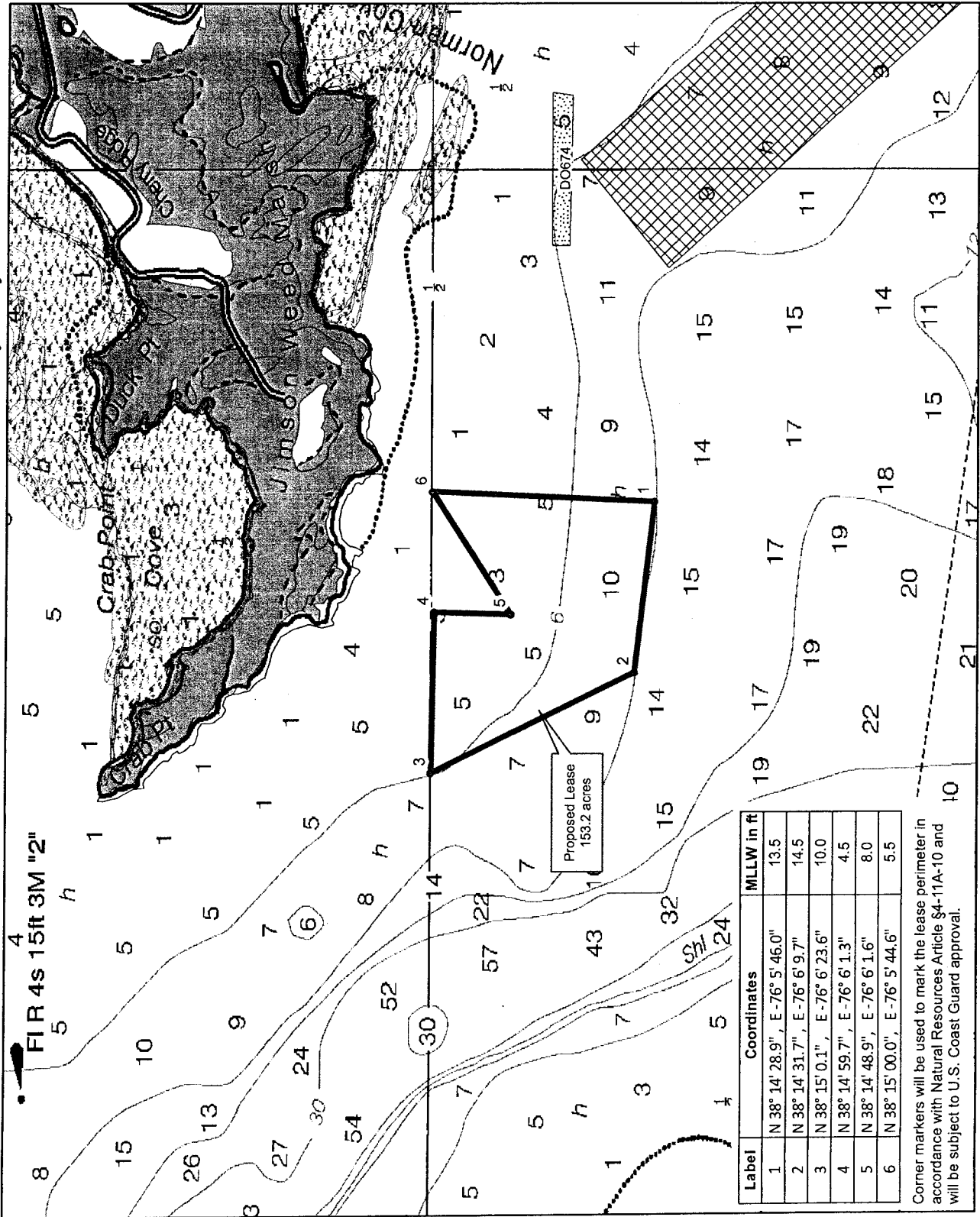

Lease Area shown over
NOAA Raster
Navigational Charts.

- Proposed Lease
- Land-Based Sanctuaries and Refuges (state, federal, private, etc)
- Submerged Aquatic Vegetation (VIMS)
- Structures (Piers, Marinas, etc)
- Wetlands of Special State Concern (MD-DNR)
- Active Shellfish Lease
- Proposed Shellfish Lease
- Tidal Wetlands (NWI Wetlands) (excludes E1 type)



Larry Hogan
Governor
Boyd K. Rutherford
Lt. Governor
Mark J. Belton
Secretary



Maryland Department of Natural Resources
Geospatial Information and Analysis
580 Taylor Ave. E-2, Annapolis, MD 21401
410-260-8985 or 1-877-620-82NR x8985
dnr.maryland.gov
DNR July 2015

IB.

Name: Noe V. Norzagaray
 Town, State: Bishops Head, MD
 Waterbody: Honga River
 Date: July 2015

Cross-Section Diagram for Proposed Submerged Land Lease #249

 Corner marker with applicant contact info (see insert for details)

MHW = mean high water

MLLW = mean lower low water

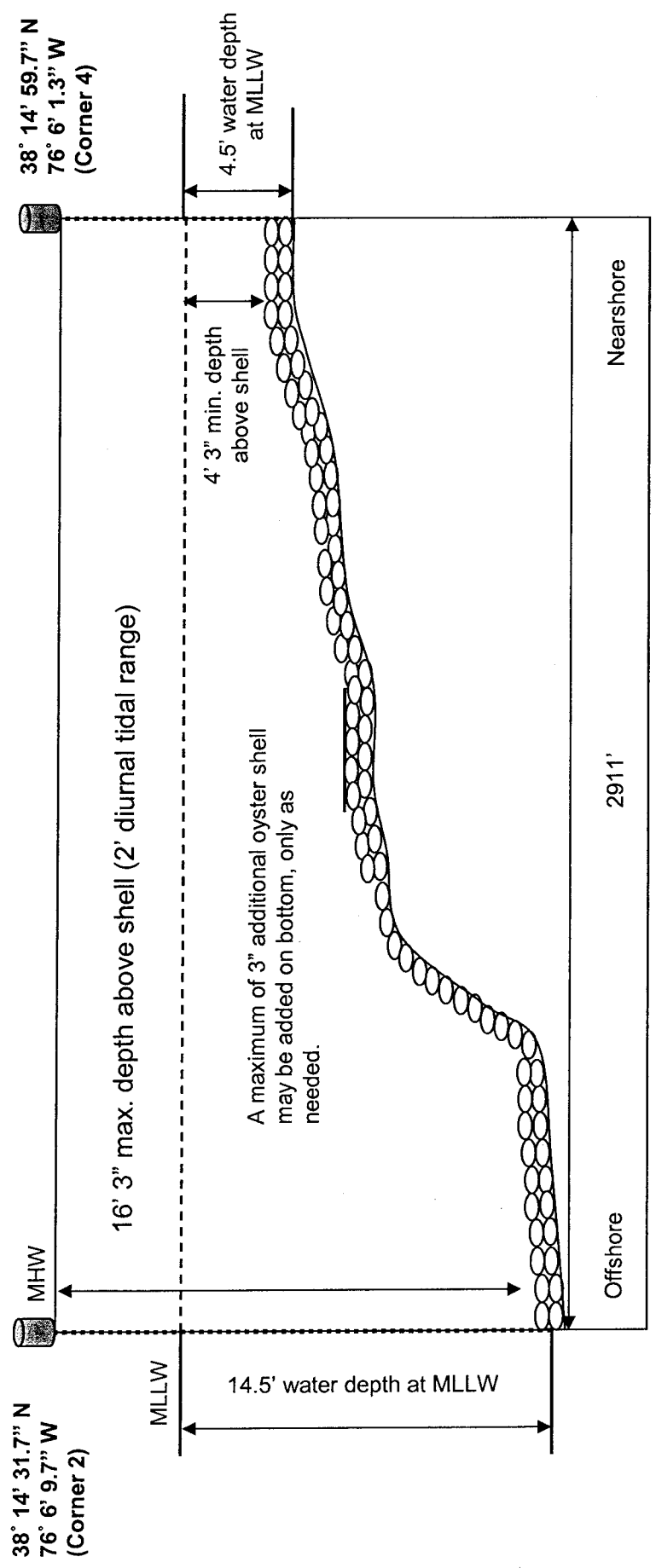

Honga River Aquaculture Site Locations

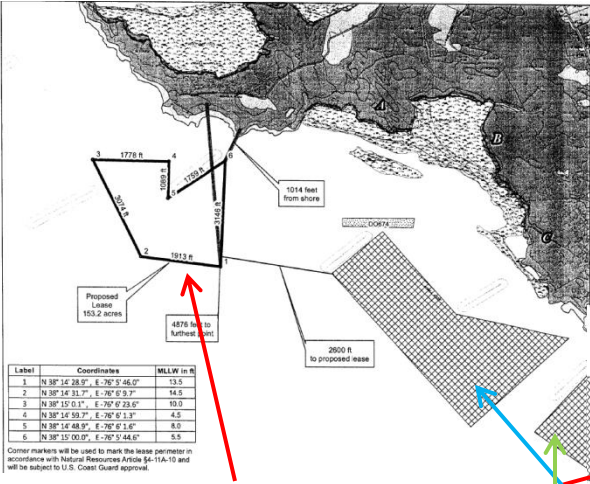

Norzagaray #249

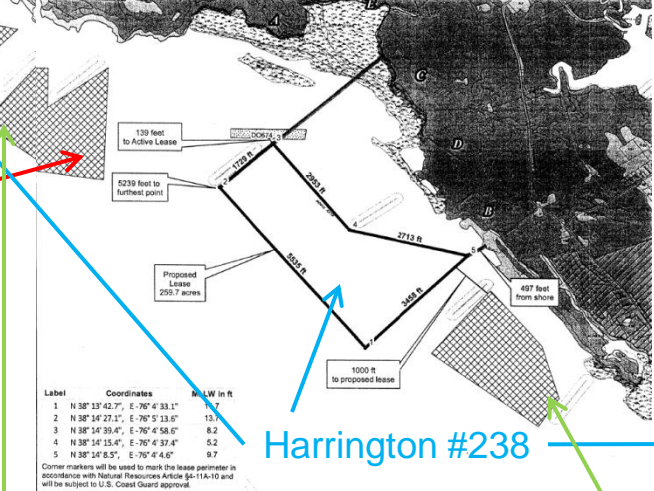

Harrington #238

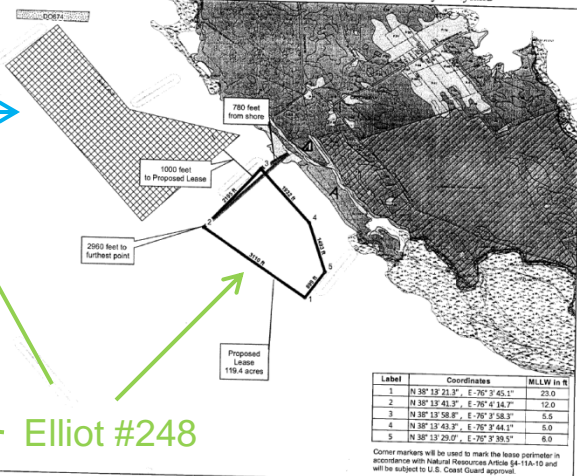

Elliot #248

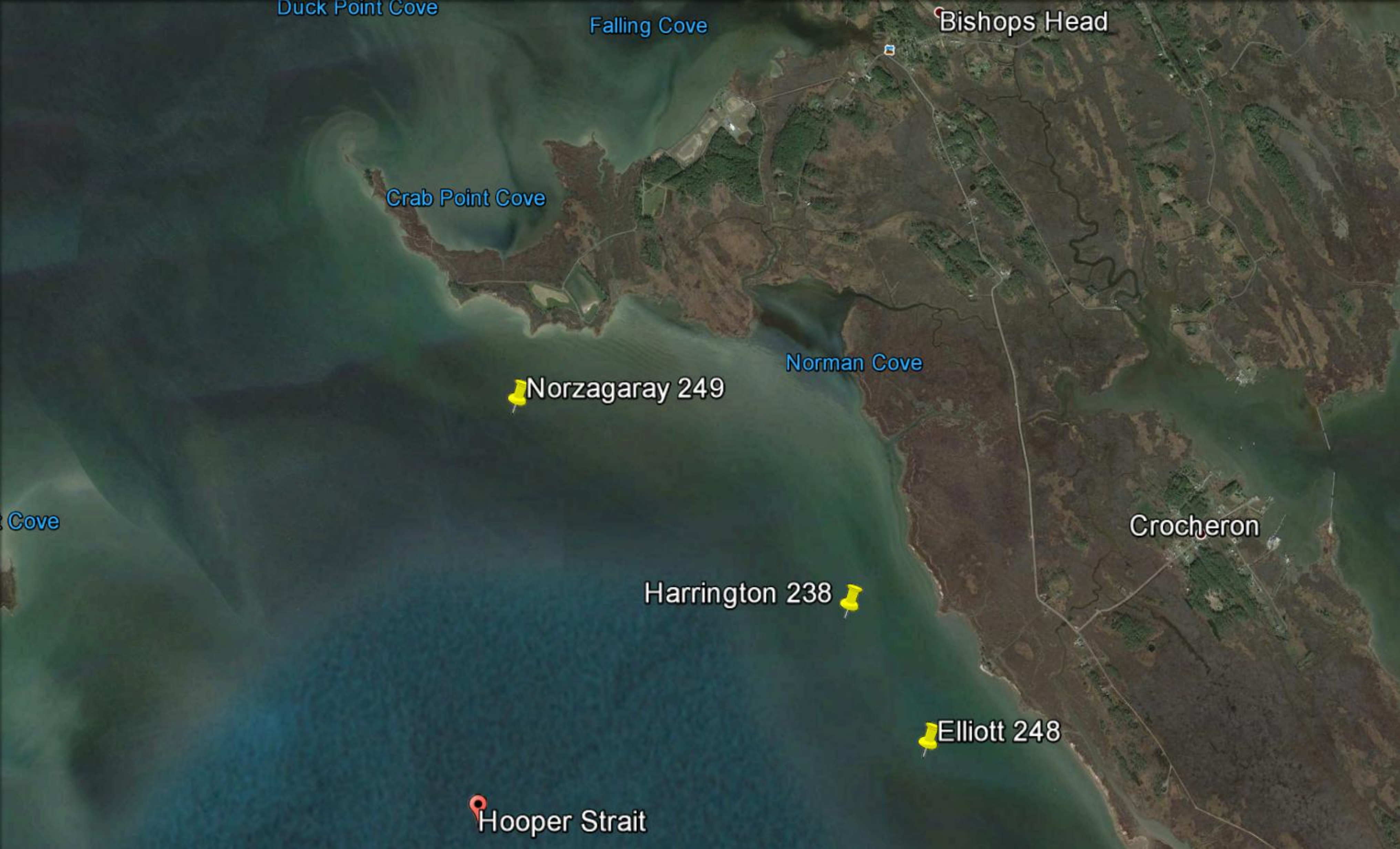

Duck Point Cove

Falling Cove

Bishops Head

Crab Point Cove

Norman Cove

Norzagaray 249

Cove

Crocheron

Harrington 238

Elliott 248

Hooper Strait