



Public Notice

U.S. Army Corps
of Engineers
Baltimore District
PN 16-38

In Reply to Application Number
CENAB-OPR-P-2015-00071-P04 (Peach Bottom Marina Maintenance Dredging)

Comment Period: June 17, 2016 to July 2, 2016

THE PURPOSE OF THIS PUBLIC NOTICE IS TO SOLICIT COMMENTS FROM THE PUBLIC REGARDING THE WORK DESCRIBED BELOW. NO DECISION HAS BEEN MADE AS TO WHETHER OR NOT A PERMIT WILL BE ISSUED AT THIS TIME.

This District has received an application for a Department of the Army permit pursuant to Section 10 of the Rivers and Harbors Act of 1899 and Section 404 of the Clean Water Act (33 U.S.C. 1344) as described below:

APPLICANT: Exelon Generation Company, LLC
Kimberly Long
FERC License Compliance Manager
300 Exelon Way
Kennett Square, PA 19348

WATERWAY AND LOCATION OF THE PROPOSED WORK: Peters Creek and the Susquehanna River, at the Peach Bottom Marina Recreation Facility located at 1798 Slate Hill Road, Drumore and Fulton Townships, Lancaster County, Pennsylvania.

PROPOSED WORK AND PURPOSE: to maintenance dredge by hydraulic method an approximate 2.29-acre area of Peters Creek, including a portion of the adjacent Susquehanna River, to provide a minimum depth of four feet of water for boat access to the marina. The resulting approximately 9,000 cubic yards of dredged silt material is to be deposited by hydraulic means in an upland (non-wetland) disposal area. The material will be piped along Slate Hill Road to property owned by Exelon located north of the Marina, as shown on the attached plans. The proposed impacts are minimized by proposing the minimum depths required for recreational boats utilizing the Peach Bottom Marina. Compensatory mitigation is not being proposed by the applicant. The purpose of the proposed project is to restore the required depths within Peters Creek and within the Susquehanna River for boat access to the existing Peach Bottom Marina.

All work would be completed in accordance with the enclosed plan(s). If you have any questions concerning this matter, please contact Ms. Patricia Strong U.S Army Corps of Engineers, 10 South Howard Street, Regulatory Branch, Pennsylvania Section, Baltimore, MD 21201; (410) 962-1847; or by e-mail @ pat.strong@usace.army.mil

The decision whether to issue a permit will be based on an evaluation of the probable impacts, including cumulative impacts of the proposed activity on the public interest. That decision will reflect the national concern for both protection and utilization of important resources. The benefit, which reasonable may be expected to accrue from the proposal, must be balanced against its reasonably foreseeable detriments. All factors, which may be relevant to the proposal will be considered, including the cumulative effects thereof; among those are conservation, economic, aesthetics, general environmental concerns, wetlands, cultural values, fish and wildlife values, flood

hazards, flood plain values, land use, navigation, shoreline erosion and accretion, recreation, water supply and conservation, water quality, energy needs, safety, food and fiber production, mineral needs, and consideration of property ownership and in general, the needs and welfare of the people.

The Corps of Engineers is soliciting comments from the public; Federal, State, and local agencies and officials; Indian Tribes; and other interested parties in order to consider and evaluate the impacts of this proposed activity. Any comments received will be considered by the Corps of Engineers to determine whether to issue, modify, condition or deny a permit for this proposal. To make this decision, comments are used to assess impacts on endangered species, historic properties, water quality, general environmental effects, and the other public interest factors listed above. Comments are used in the preparation of an Environmental Assessment and/or an Environmental Impact Statement pursuant to the National Environmental Policy Act. Comments provided will become part of the public record for this action. Comments are also used to determine the need for a public hearing and to determine the overall public interest of the proposed activity. Written comments concerning the work described above related to the factors listed above or other pertinent factors must be received by the District Engineer, U.S. Army Corps of Engineers, Baltimore District, 10 South Howard Street, Regulatory Branch, Pennsylvania Section, Baltimore, MD 21201 within the comment period specified above.

ESSENTIAL FISH HABITAT: The Magnuson-Stevens Fishery Conservation and Management Act (MSFCMA), as amended by the Sustainable Fisheries Act of 1996 (Public Law 04-267), requires all Federal agencies to consult with the National Marine Fisheries Service (NMFS) on all actions, or proposed actions, permitted, funded, or undertaken by the agency that may adversely effect Essential Fish Habitat (EFH). The Corps has determined this project will not affect any EFH.

WATER QUALITY CERTIFICATION: The applicant is required to obtain a water quality certification in accordance with Section 401 of the Clean Water Act from the Pennsylvania Department of Environmental Protection. The Section 401 certifying agency has a statutory limit of one year from the date of this public notice to make its decision.

COASTAL ZONE MANAGEMENT PROGRAMS: Where applicable, the applicant has certified in this application that the proposed activity complies with and will be conducted in a manner consistent with the approved Coastal Zone Management (CZM) Program. By this public notice, we are requesting the State concurrence or objection to the applicant's consistency statement. It should be noted that the CZM Program has a statutory limit of 6 months to make its consistency determination.

The applicant must obtain any State or local government permits which may be required.

A preliminary review of this application indicates that the proposed work will not affect Federal listed threatened or endangered species or their critical habitat, pursuant to Section 7 of the Endangered Species Act, as amended. As the evaluation of this application continues, additional information may become available which could modify this preliminary determination.

Review of the latest published version of the National Register of Historic Places indicates that no registered properties listed as eligible for inclusion, therein, are located at the site of the proposed work. Currently unknown archeological, scientific, prehistoric, or historical data may be lost or destroyed by the work to be accomplished under the request permit.

The evaluation of the impact of this project on the public interest will include application of the guidelines promulgated by the Administrator, U.S. Environmental Protection Agency, under authority of Section 404 of the Clean Water Act.

Any person who has an interest which may be adversely affected by the issuance of this permit may request a public hearing. The request, which must be in writing, must be received by the District Engineer, U.S. Army Corps of Engineers, Baltimore District, 10 South Howard Street, Regulatory Branch, Pennsylvania Section, Baltimore, MD 21201, within the comment period as specified above to receive consideration. Also it must clearly set forth the interest which may be adversely affected by this activity and the manner in which the interest may be adversely affected.

It is requested that you communicate this information concerning the proposed work to any persons know by you to be interested and not being known to this office, who did not receive a copy of this notice.

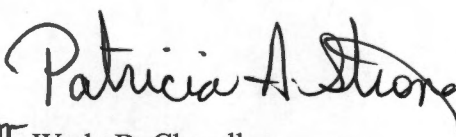
for Wade B. Chandler
Chief, Pennsylvania Section
Regulatory Branch

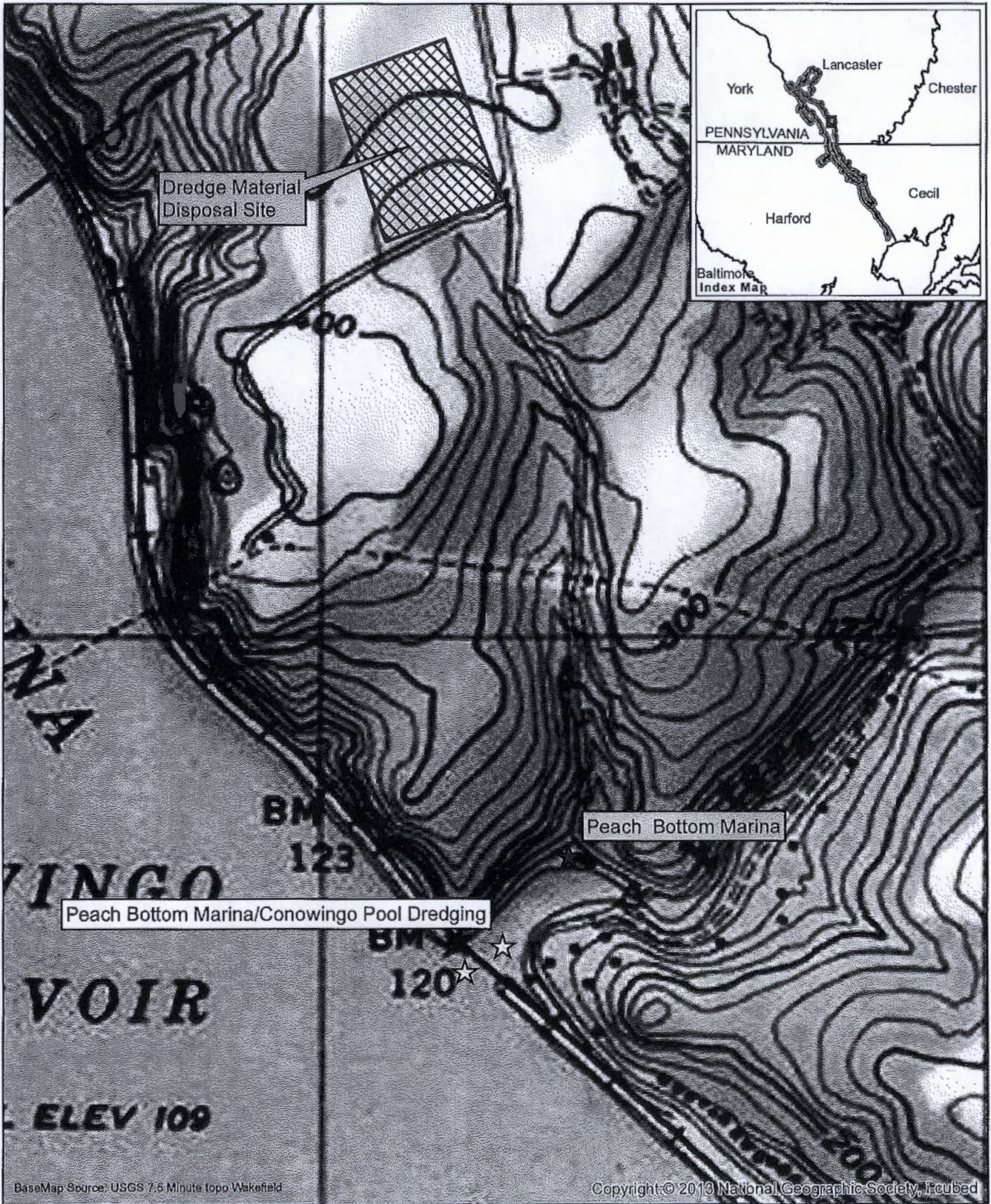

BaseMap Source: USGS 7.5 Minute topo Wakefield

Copyright © 2013 National Geographic Society, Incubed

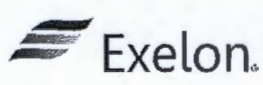





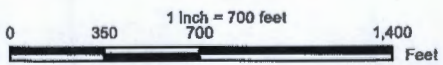
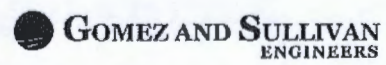

EXELON GENERATION COMPANY, LLC
CONOWINGO HYDROELECTRIC PROJECT
 (FERC No. 405)

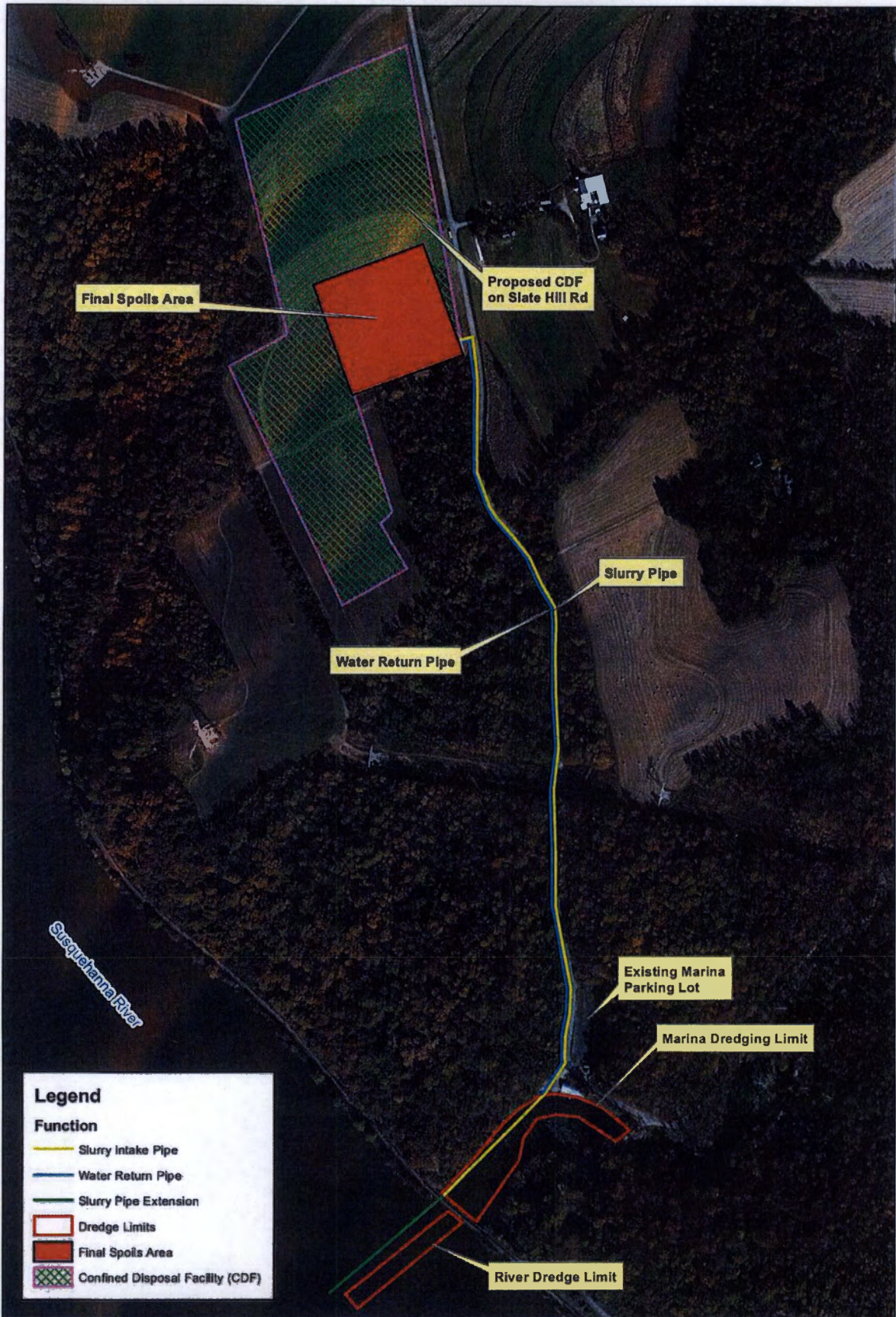
Figure 3.1
 Project Location Map



Copyright © 2015 Exelon Generation Company, LLC. All rights reserved.



Legend	
Function	
	Slurry Intake Pipe
	Water Return Pipe
	Slurry Pipe Extension
	Dredge Limits
	Final Spoils Area
	Confined Disposal Facility (CDF)



EXELON GENERATION COMPANY, LLC
 CONOWINGO HYDROELECTRIC PROJECT
 PROJECT NO. 405

Figure 2 - Peach Bottom Marina Dredging Infrastructure



1 inch = 400 feet

Copyright © 2014 Exelon Generation Company. All rights reserved.

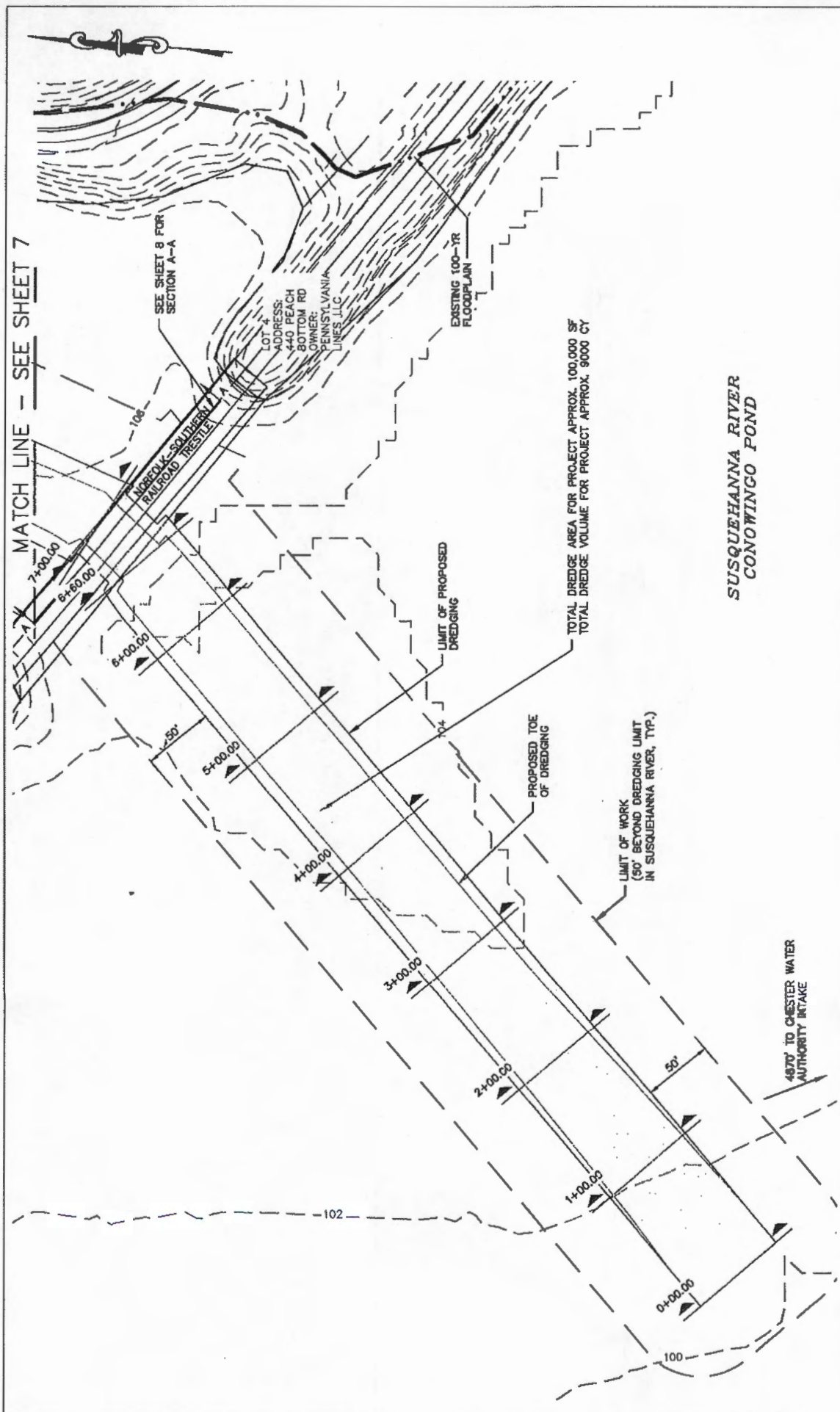

TOTAL DREDGE AREA FOR PROJECT APPROX. 100,000 SF
 TOTAL DREDGE VOLUME FOR PROJECT APPROX. 8000 CY

SUSQUEHANNA RIVER
 CONOWINGO POND

PROJECT TITLE:
 PEACH BOTTOM MARINA DREDGING

PROJECT LOCATION:
 FULTON, PA

SHEET 6 OF 33 DATE: 1/29/2016

PROPOSED CHANNEL DREDGING PLAN AND
 EROSION & SEDIMENTATION CONTROL PLAN
 STATION 0+00 TO STATION 7+00

SCALE: 1" = 100'

0' 100' 200' 300'

PREPARED BY:
GOMEZ AND SULLIVAN ENGINEERS
 Williamsville, NY • Utica, NY • Albany, NY • Hamster, NH
 www.gomezandsullivan.com

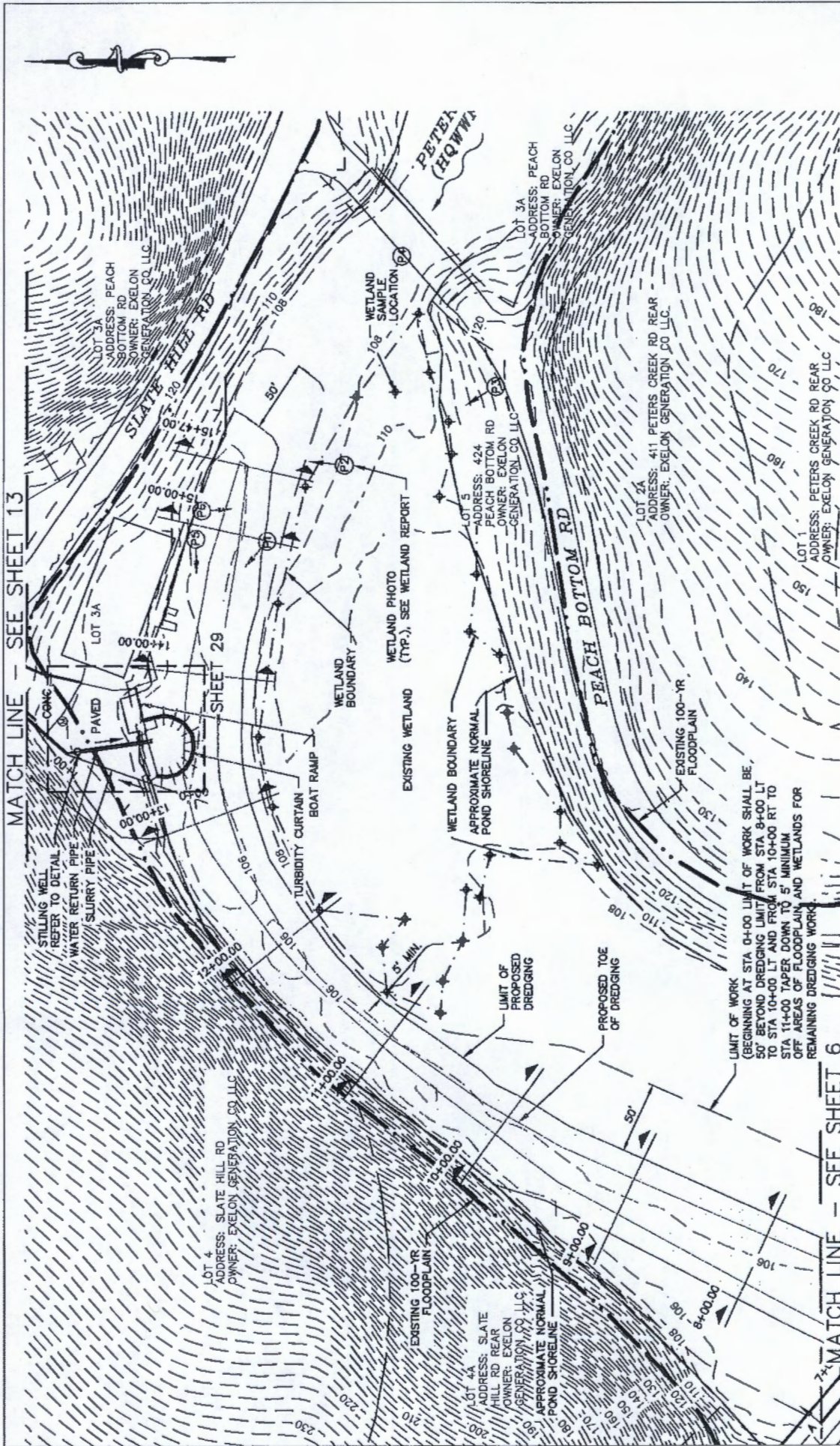

PROJECT TITLE:
 PEACH BOTTOM MARINA DREDGING
 PROJECT LOCATION:
 FULTON, PA
 SHEET 7 OF 33 DATE: 1/29/2016

PROPOSED CHANNEL DREDGING PLAN AND
 EROSION & SEDIMENTATION CONTROL PLAN
 STATION 8+00 TO STATION 15+47
 0' 100' 200' 300'
 SCALE: 1" = 100'

PREPARED BY:
GOMEZ AND SULLIVAN
 ENGINEERS
 Williamsville, NY • Utica, NY • Albany, NY • Horniker, NH
 www.gomezandsullivan.com

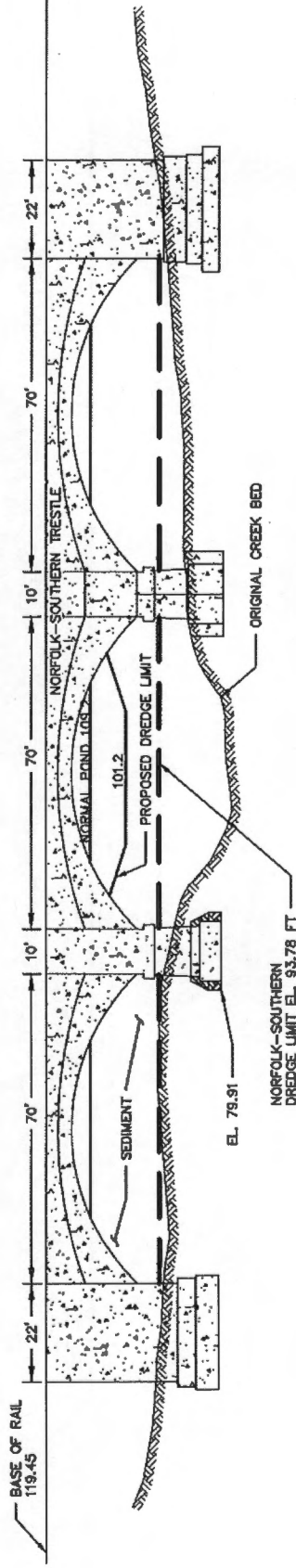

SECTION A-A
(STA 6+75 LOOKING UPSTREAM)
NOT TO SCALE

PREPARED BY:
GOMEZ AND SULLIVAN
ENGINEERS
 Williamsville, NY • Utica, NY • Albany, NY • Henniker, NH
www.gomezandsullivan.com

PROPOSED CHANNEL DREDGING PLAN
 BRIDGE TRESTLE SECTION



PROJECT TITLE:
 PEACH BOTTOM MARINA DREDGING
 PROJECT LOCATION:
 FULTON, PA
 SHEET 8 OF 33 DATE: 1/29/2016

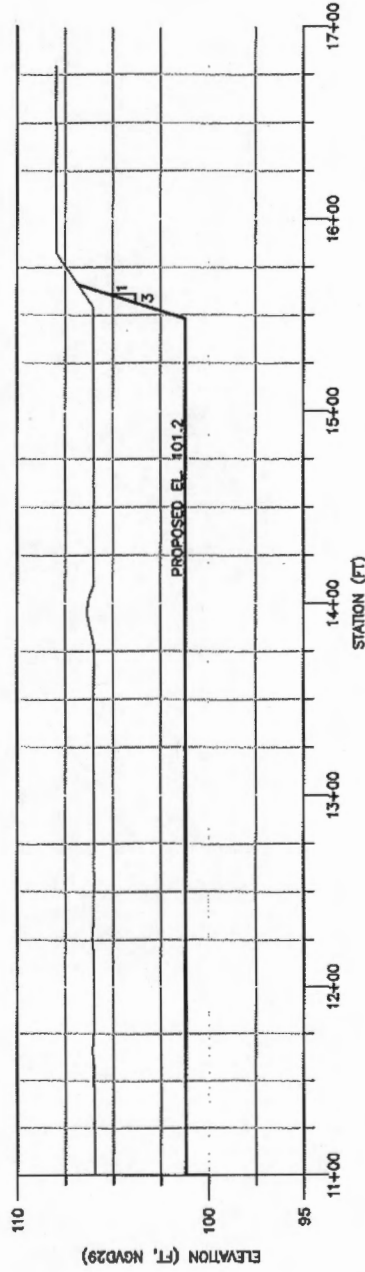
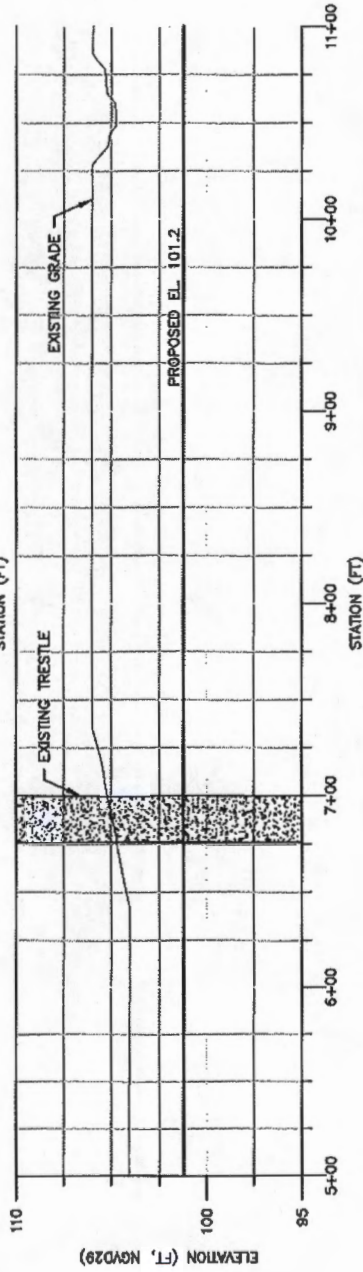
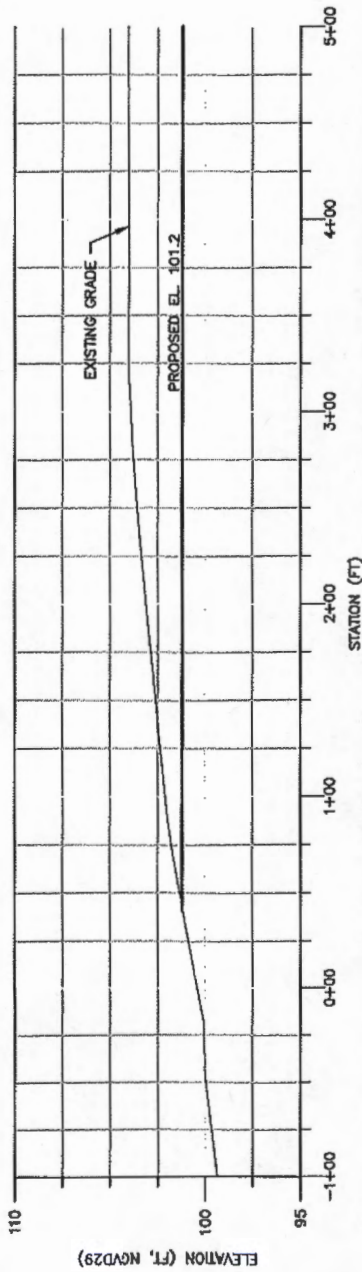

PREPARED BY:



GOMEZ AND SULLIVAN
ENGINEERS
Williamsville, NY • Utica, NY • Albany, NY • Henniker, NH
www.gomezandsullivan.com

PROPOSED CHANNEL DREDGING
PROFILE



SCALE: 1" = 100'

PROJECT TITLE:
PEACH BOTTOM MARINA DREDGING

PROJECT LOCATION:
FULTON, PA

SHEET 9 OF 33

DATE: 1/28/2016



GOMEZ AND SULLIVAN
ENGINEERS

PREPARED BY:
Williamsville, NY • Utica, NY • Albany, NY • Hamlet, NH
www.gomezandsullivan.com

PROPOSED CHANNEL DREDGING
CROSS SECTIONS
STATION 0+00 TO STATION 5+00

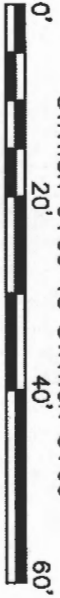

SCALE: 1" = 20'

PROJECT TITLE:
PEACH BOTTOM MARINA DREDGING
PROJECT LOCATION:
FULTON, PA

SHEET 10 OF 33

DATE: 1/29/2016

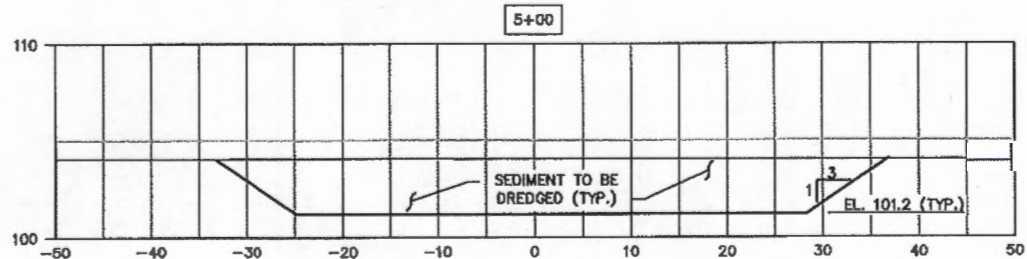
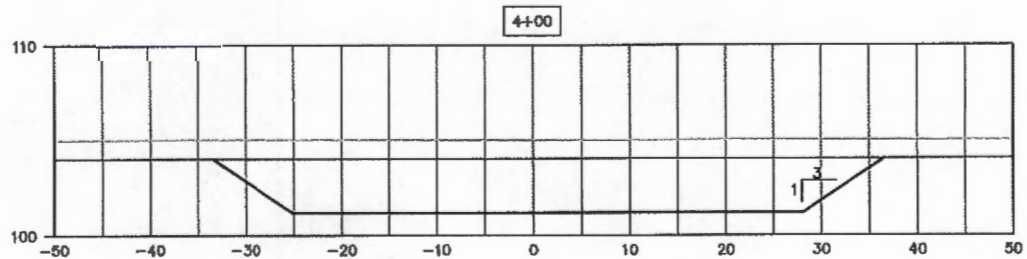
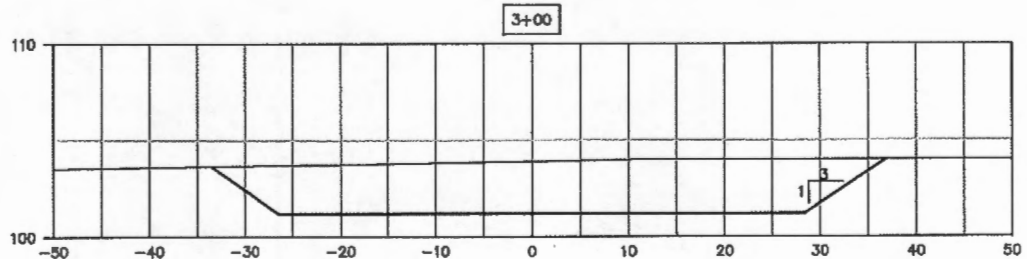
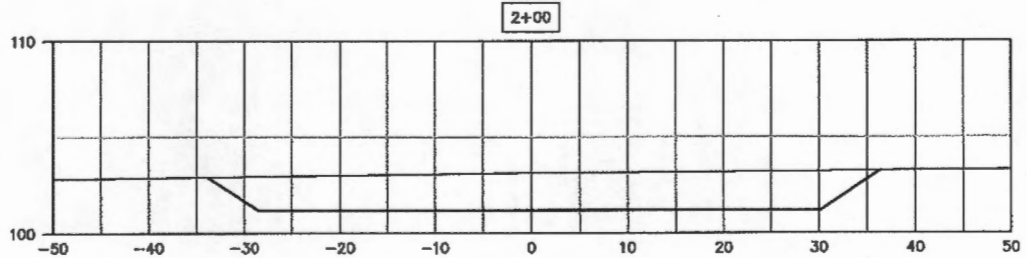
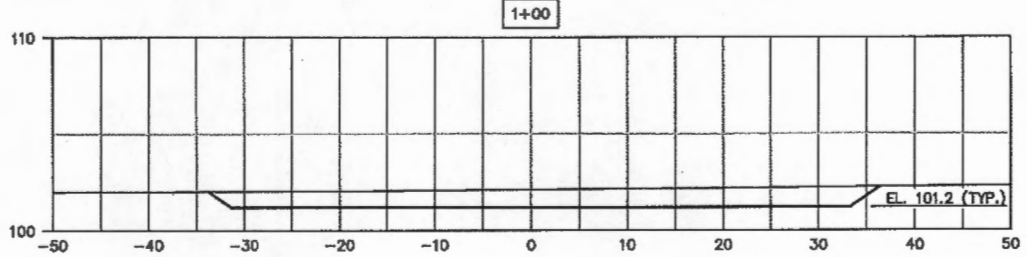
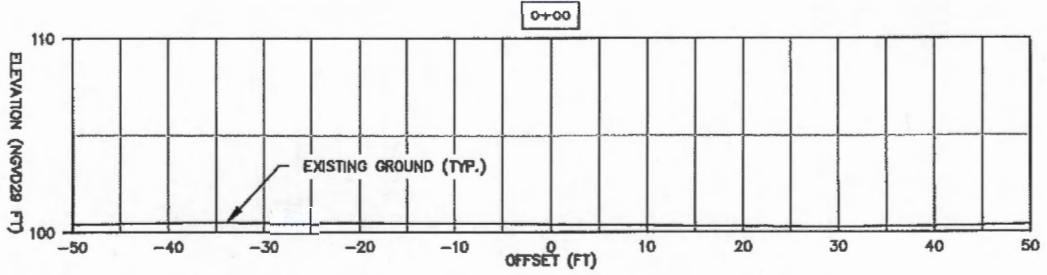

PREPARED BY:
GOMEZ AND SULLIVAN
 ENGINEERS
 Williamsville, NY • Utica, NY • Albany, NY • Hamlet, NH
 www.gomezandsullivan.com

NOTE: NORFOLK-SOUTHERN DREDGE LIMIT EL. 93.78 FT AT BRIDGE TRESTLE.

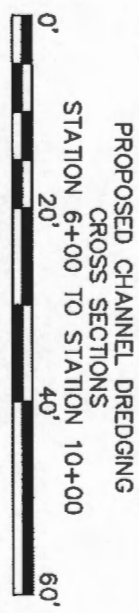
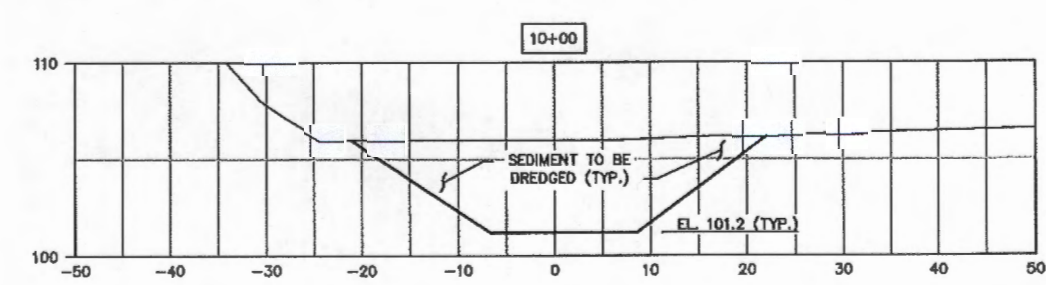
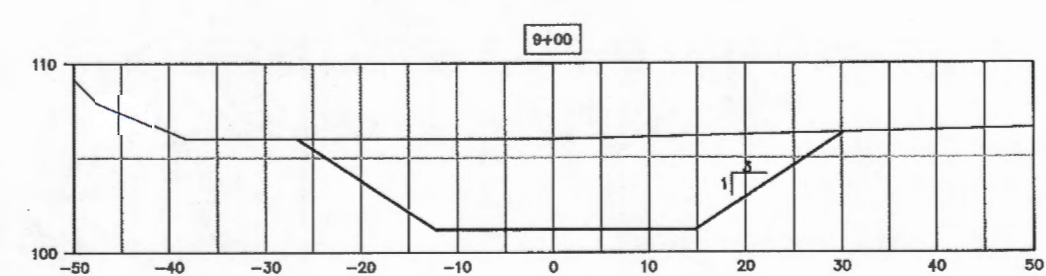
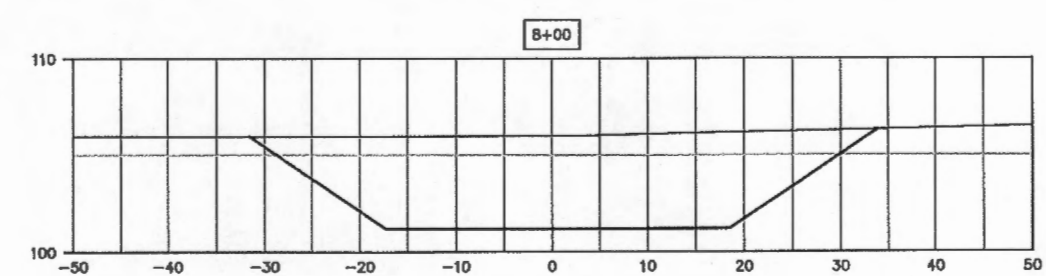
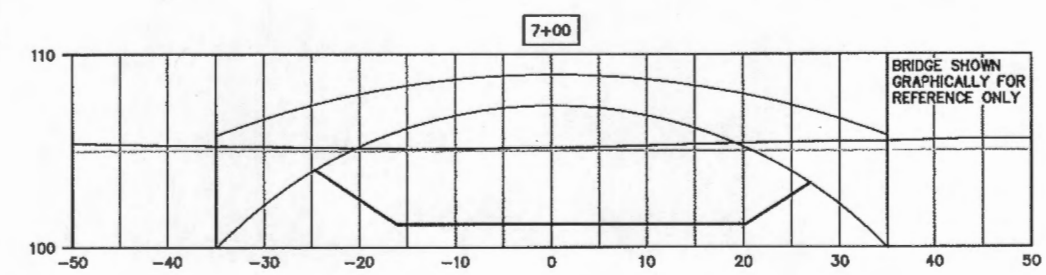
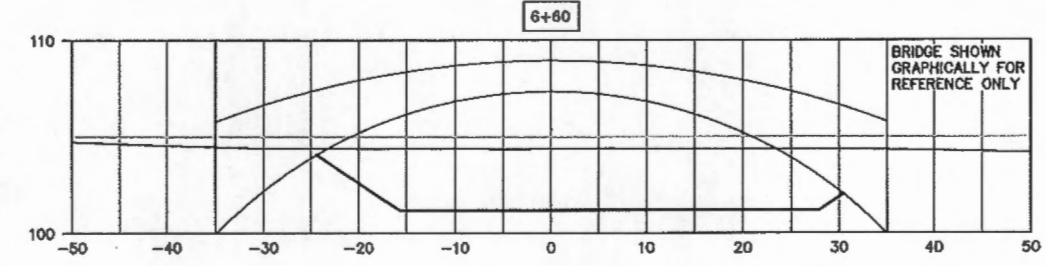
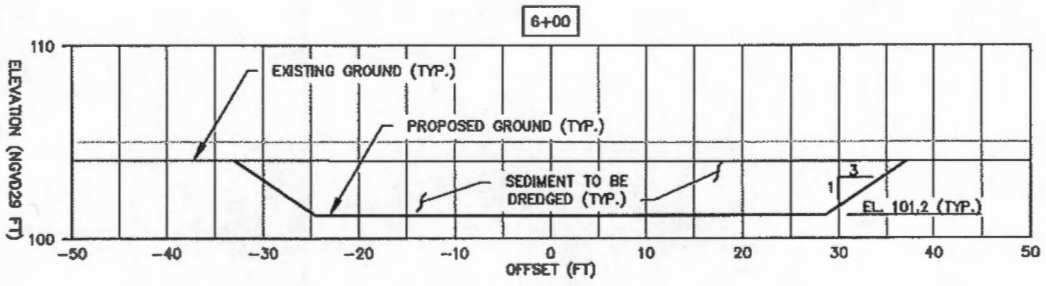

PROJECT TITLE:
 PEACH BOTTOM MARINA DREDGING
 PROJECT LOCATION:
 FULTON, PA
 SHEET 11 OF 33
 DATE: 1/29/2016

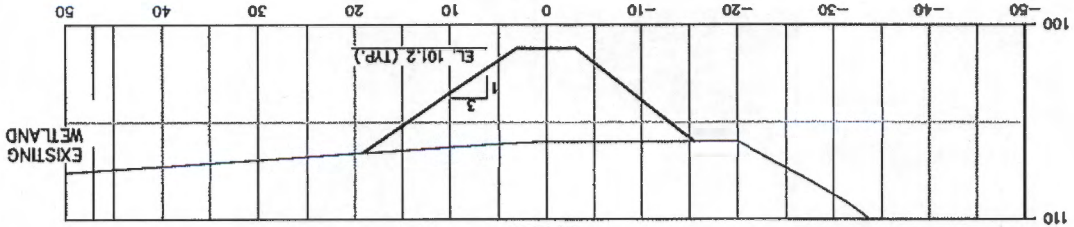

15+47

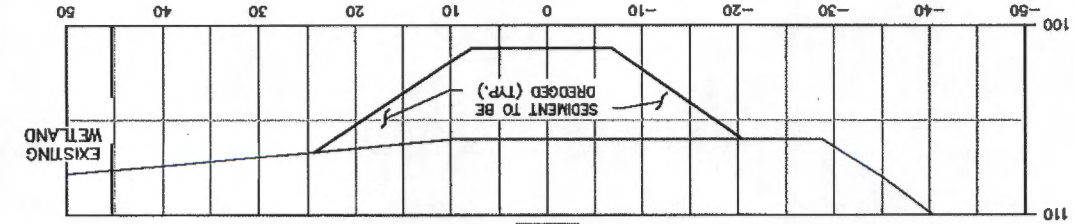

15+00

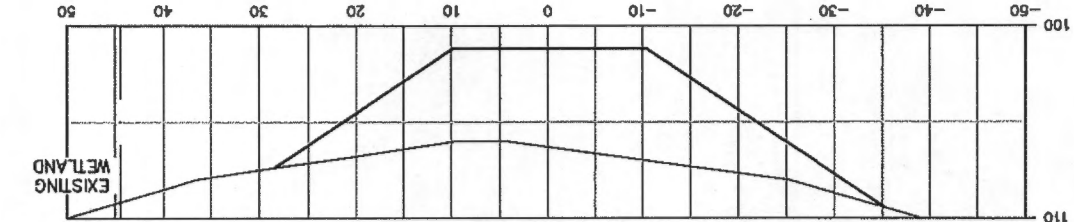

14+00

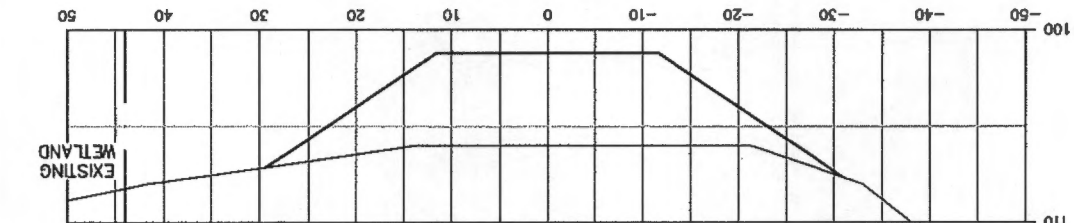

13+00

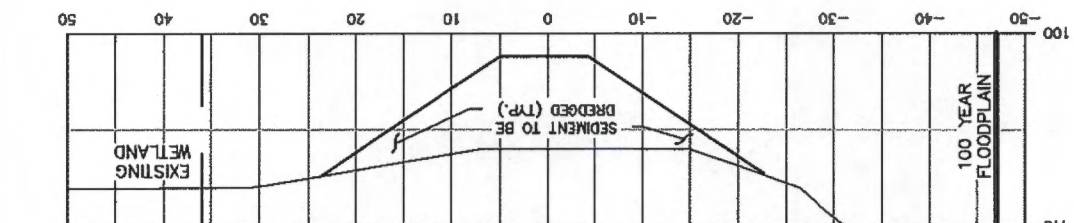

12+00

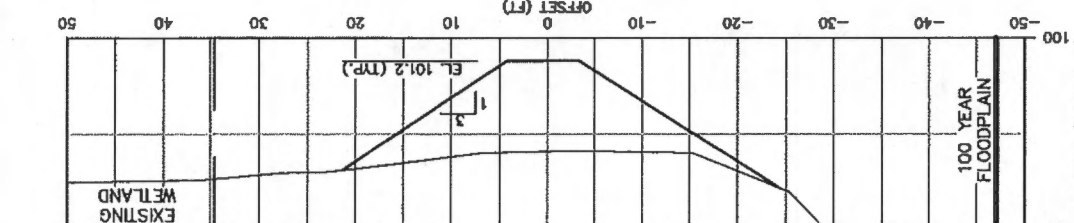

11+00

PROJECT TITLE:
PEACH BOTTOM MARINA DREDGING

PROJECT LOCATION:
FULTON, PA

SHEET 12 OF 33

DATE: 1/29/2016

PROPOSED CHANNEL DREDGING
CROSS SECTIONS
STATION 11+00 TO STATION 15+47

0' 20' 40' 60'

SCALE: 1" = 20'

PREPARED BY:

GOMEZ AND SULLIVAN ENGINEERS

Williamsville, NY • Utica, NY • Albany, NY • Henriker, NH
www.gomezandsullivan.com

MATCH LINE -- SEE SHEET 20

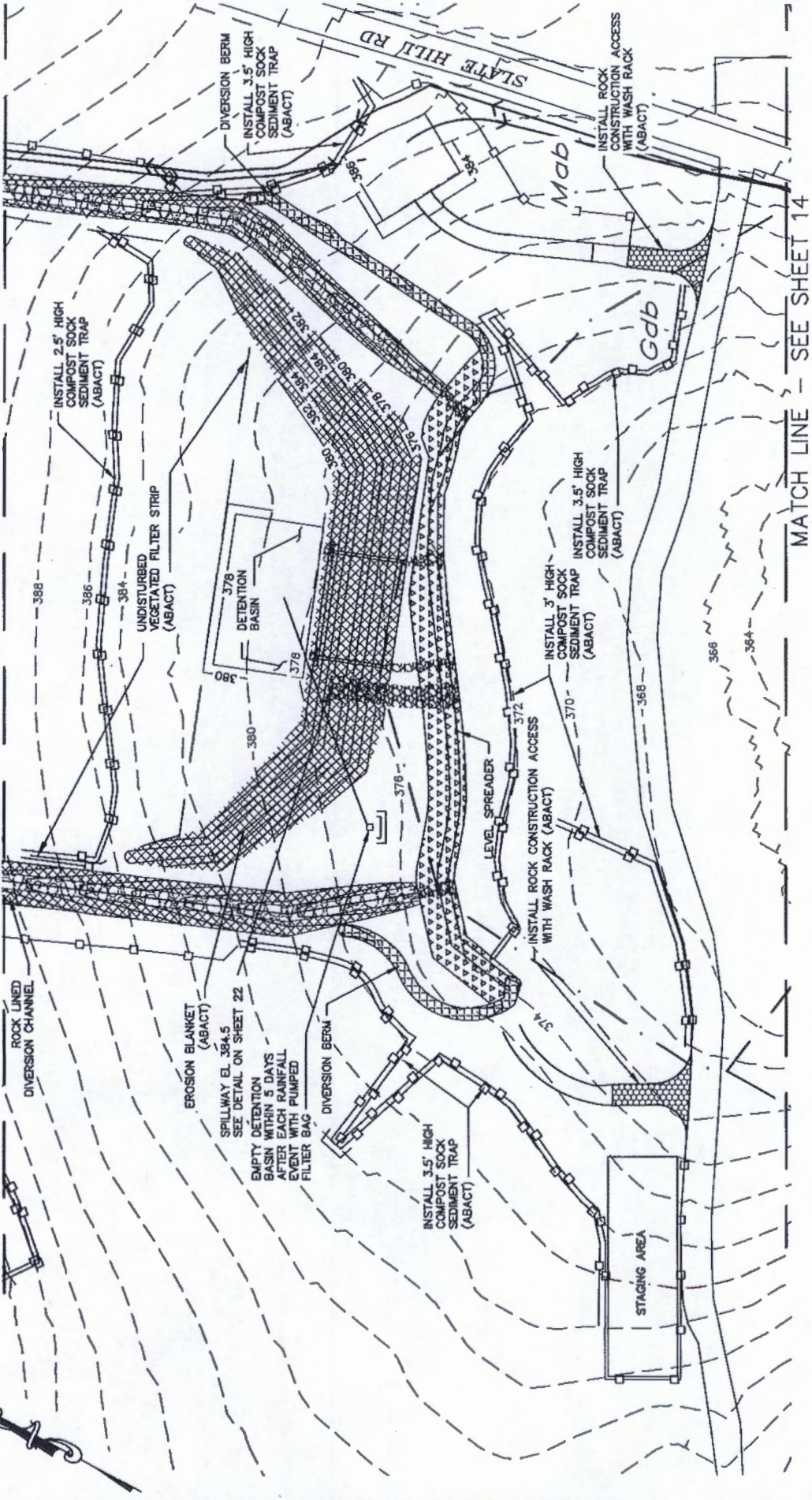

MATCH LINE -- SEE SHEET 14

PROJECT TITLE:
PEACH BOTTOM MARINA DREDGING

PROJECT LOCATION:
FULTON, PA

SHEET 19 OF 33 DATE: 1/29/2016

PROPOSED CONFINED DISPOSAL FACILITY PLAN
AND EROSION & SEDIMENTATION CONTROL PLAN



SCALE: 1" = 100'

PREPARED BY:



GOMEZ AND SULLIVAN
ENGINEERS

Williamsville, NY • Utica, NY • Albany, NY • Hemiker, NE
www.gomezandsullivan.com

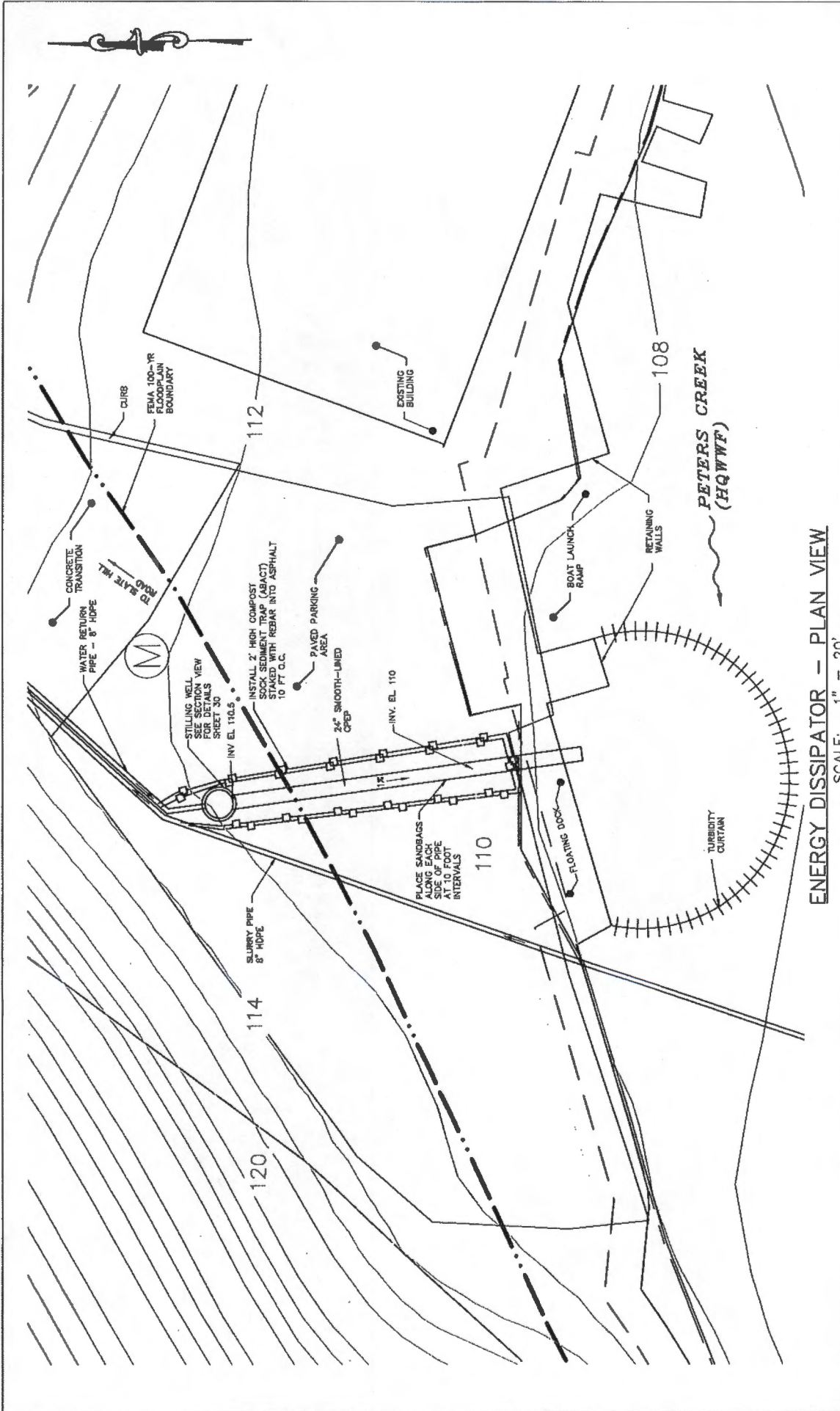

ENERGY DISSIPATOR - PLAN VIEW

SCALE: 1" = 20'

DETAILS



SCALE: 1" = 20'

PROJECT TITLE: PEACH BOTTOM MARINA DREDGING
 PROJECT LOCATION: FULTON, PA
 SHEET 29 OF 33
 DATE: 1/29/2016

PREPARED BY:

GOMEZ AND SULLIVAN ENGINEERS
 Williamsville, NY • Utica, NY • Albany, NY • Henniker, NH
www.gomezandsullivan.com