



U.S. Army Corps
of Engineers
Baltimore District

Public Notice

In Reply to Application Number
CENAB-OPR-M (US ARMY/JOINT BASE ANDREWS/
HANGER 21) 2017-62006

PN 18-19

Comment Period: April 04, 2018 to April 25, 2018

THE PURPOSE OF THIS PUBLIC NOTICE IS TO SOLICIT COMMENTS FROM THE PUBLIC REGARDING THE WORK DESCRIBED BELOW. NO DECISION HAS BEEN MADE AS TO WHETHER OR NOT A PERMIT WILL BE ISSUED AT THIS TIME.

This District has received an application for a Department of the Army permit pursuant to **Section 404 of the Clean Water Act (33. U.S.C. 1344)** as described below:

APPLICANT: Mr. Steve Richards
Joint Base Andrews
3466 North Carolina Street, 11CES/CEIE
Joint Base Andrews, Maryland 20762

WATERWAY AND LOCATION OF THE PROPOSED WORK: The project is located in nontidal wetlands and unnamed tributaries at the Presidential Aircraft Recapitalization (PAR) Hanger site on Joint Base Andrews, Prince George's County, Maryland.

PROPOSED WORK AND PURPOSE: The applicant proposes to grade and fill for the construction of a Presidential Aircraft Hangar permanently impacting approximately 148,787 square feet (3.42 acres) of nontidal wetlands and 7,188 square feet along 742 linear feet of tributaries at the end of San Antonio Boulevard.

Impacts have been avoided and minimized to the extent practicable through layout reconfiguration and minimization of the limit of disturbance. The hanger aircraft would use the existing taxiway routing so that no new taxiways need to be constructed. The location of the proposed impacts are to the existing golf course, existing buildings, taxiways, and airfield. Additional minimization is not practicable due to siting requirements and design constraints. The size and weight of the new aircraft precludes retrofits of the existing hanger facility. The purpose of the work is to provide a hanger facility to safely and effectively accommodate the new VC-25B aircraft with the associated support facilities at Joint Base Andrews.

The applicant proposes to obtain wetland and stream mitigation credit from the Mattawoman Creek Mitigation Site (MCMS) within the Joint Base Andrews-Department of Defense Umbrella Mitigation Bank Instrument (UMBI) located in Charles County Maryland. If the banking instrument is not available at the time of permit decision Joint Base Andrews has proposed to use a portion of the MCMS wetland restoration area as Permittee Responsible Mitigation.

All work will be completed in accordance with the enclosed plan(s). If you have any questions concerning this matter, please contact Mrs. Erica Schmidt, Project Manager, at 410-962-6029 or Erica.Schmidt@usace.army.mil. As the lead federal agency, the US Air Force has completed an Environmental Impact Statement and a Record of Decision has been made and published for public review at <https://parprogrameis.com/>.

The decision whether to issue a permit will be based on an evaluation of the probable impacts, including cumulative impacts of the proposed activity on the public interest. That decision will reflect the national concern for both protection and utilization of important resources. The benefit, which reasonable may be expected to accrue from the proposal, must be balanced against its reasonably foreseeable detriments. All factors, which may be relevant to the proposal will be considered, including the cumulative effects thereof; among those are conservation, economic, aesthetics, general environmental concerns, wetlands, cultural values, fish and wildlife values, flood hazards, flood plain values, land use, navigation, shoreline erosion and accretion, recreation, water supply and conservation, water quality, energy needs, safety, food and fiber production, mineral needs, and consideration of property ownership and in general, the needs and welfare of the people.

The Corps of Engineers is soliciting comments from the public; Federal, State, and local agencies and officials; Indian Tribes; and other interested parties in order to consider and evaluate the impacts of this proposed activity. Any comments received will be considered by the Corps of Engineers to determine whether to issue, modify, condition or deny a permit for this proposal. To make this decision, comments are used to assess impacts on endangered species, historic properties, water quality, general environmental effects, and the other public interest factors listed above. Comments are used in the preparation of an Environmental Assessment and/or an Environmental Impact Statement pursuant to the National Environmental Policy Act. Comments provided will become part of the public record for this action. Comments are also used to determine the need for a public hearing and to determine the overall public interest of the proposed activity. Written comments concerning the work described above related to the factors listed above or other pertinent factors must be received by the District Engineer, U.S. Army Corps of Engineers, Baltimore District, Attn.: Mrs. Erica Schmidt, CENAB-OPR-M, 2 Hopkins Plaza, Baltimore, Maryland 21201 within the comment period specified above.

ESSENTIAL FISH HABITAT: The Magnuson-Stevens Fishery Conservation and Management Act (MSFCMA), as amended by the Sustainable Fisheries Act of 1996 (Public Law 04-267), requires all Federal agencies to consult with the National Marine Fisheries Service (NMFS) on all actions, or proposed actions, permitted, funded, or undertaken by the agency that may adversely effect Essential Fish Habitat (EFH). The project site does lie in or adjacent to EFH as described under MSFCMA.

WATER QUALITY CERTIFICATION: The applicant is required to obtain a water quality certification in accordance with Section 401 of the Clean Water Act from the Maryland Department of the Environment. Any written comments concerning the work described above which relate to water quality certification must be received by the Wetlands and Waterways Program, Maryland Department of the Environment, Montgomery Park Business Center, 1800 Washington Boulevard, Suite 430, Baltimore, Maryland 21230-1708 within the comment period as specified above to receive consideration. The Section 401 certifying agency has a statutory limit of one year from the date of this public notice to make its decision.

COASTAL ZONE MANAGEMENT PROGRAMS: Where applicable, the applicant has certified

in this application that the proposed activity complies with and will be conducted in a manner consistent with the approved Coastal Zone Management (CZM) Program. By this public notice, we are requesting the State concurrence or objection to the applicant's consistency statement. It should be noted that the CZM Program has a statutory limit of 6 months to make its consistency determination.

The applicant must obtain any State or local government permits which may be required.

A preliminary review of this application indicates that the proposed work will not affect Federal listed threatened or endangered species or their critical habitat, pursuant to Section 7 of the Endangered Species Act, as amended. As the evaluation of this application continues, additional information may become available which could modify this preliminary determination.

Review of the latest published version of the National Register of Historic Places indicates that no registered properties listed as eligible for inclusion, therein, are located at the site of the proposed work. Currently unknown archeological, scientific, prehistoric, or historical data may be lost or destroyed by the work to be accomplished under the request permit.

The evaluation of the impact of this project on the public interest will include application of the guidelines promulgated by the Administrator, U.S. Environmental Protection Agency, under authority of Section 404 of the Clean Water Act.

Any person who has an interest which may be adversely affected by the issuance of this permit may request a public hearing. The request, which must be in writing, must be received by the District Engineer, U.S. Army Corps of Engineers, Baltimore District, Mrs. Erica Schmidt, Project Manager, Maryland Section Southern, 2 Hopkins Plaza, Baltimore, Maryland 21201, within the comment period as specified above to receive consideration. Also it must clearly set forth the interest which may be adversely affected by this activity and the manner in which the interest may be adversely affected.

It is requested that you communicate this information concerning the proposed work to any persons know by you to be interested and not being known to this office, who did not receive a copy of this notice.

FOR THE DISTRICT ENGINEER:

Kathy B. Anderson
Chief, Maryland Section Southern

500 0 500 1000



SCALE: 1" = 500'

NORTH

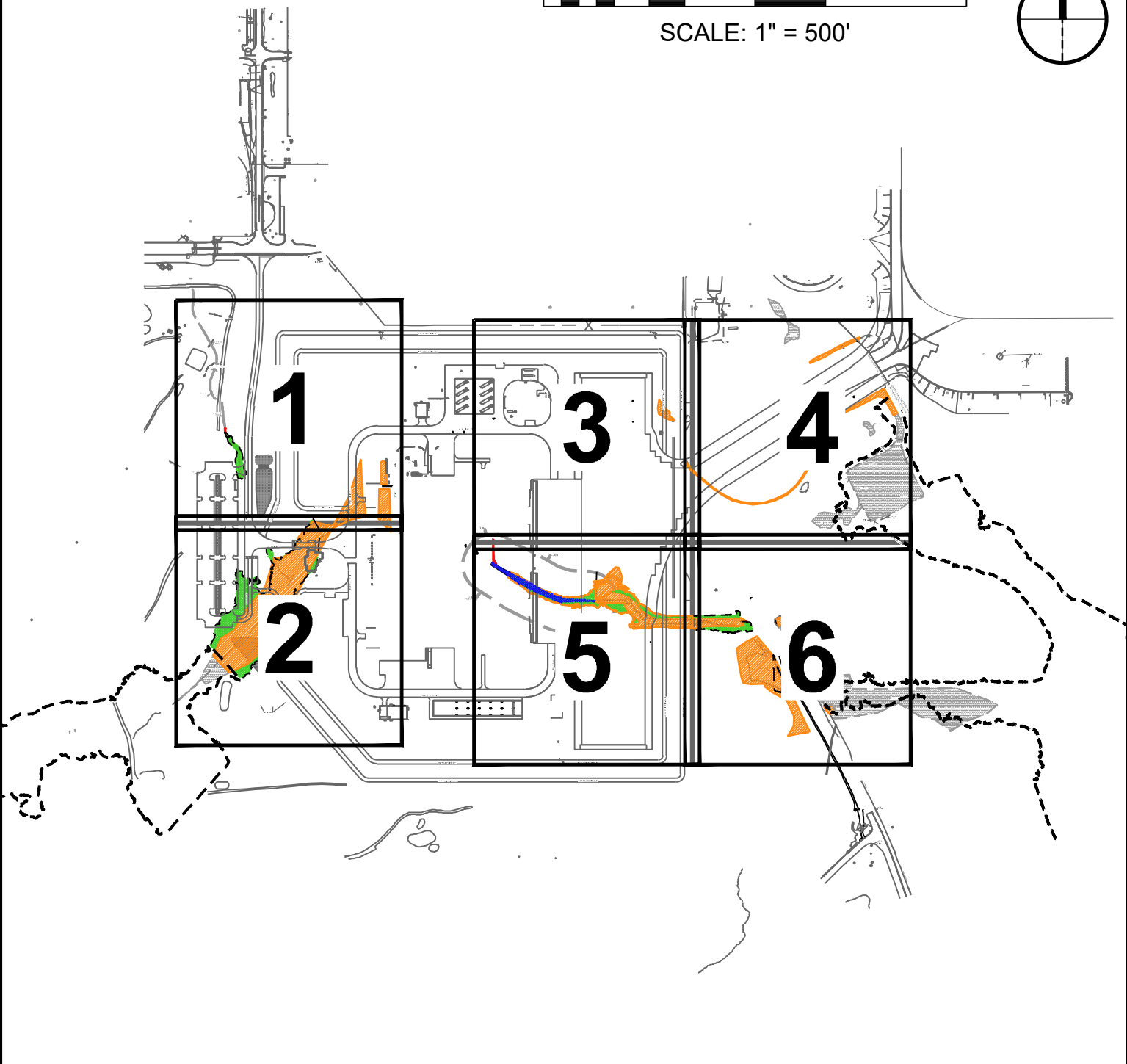
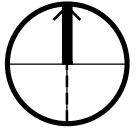

LEGEND



IMPACTED NON-TIDAL WETLANDS



IMPACTED FLOODPLAINS

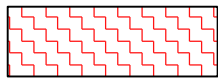

IMPACTED EPHEMERAL STREAM

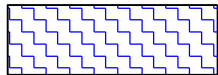

IMPACTED PERENNIAL STREAM

KEY PLAN

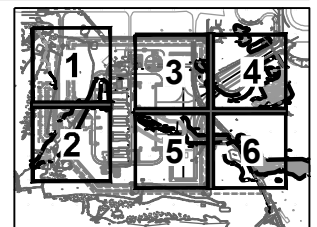

3500 Parkway Lane, Suite 600
Norcross, GA 30092
Phone (678) 336-7740
Fax (678) 336-7744
JOB NO.: 1107151

JOINT BASE ANDREWS
CAMP SPRINGS, MD

DESCRIPTION:

IMPACT



DATE: 1/11/18

DRAWING NO:

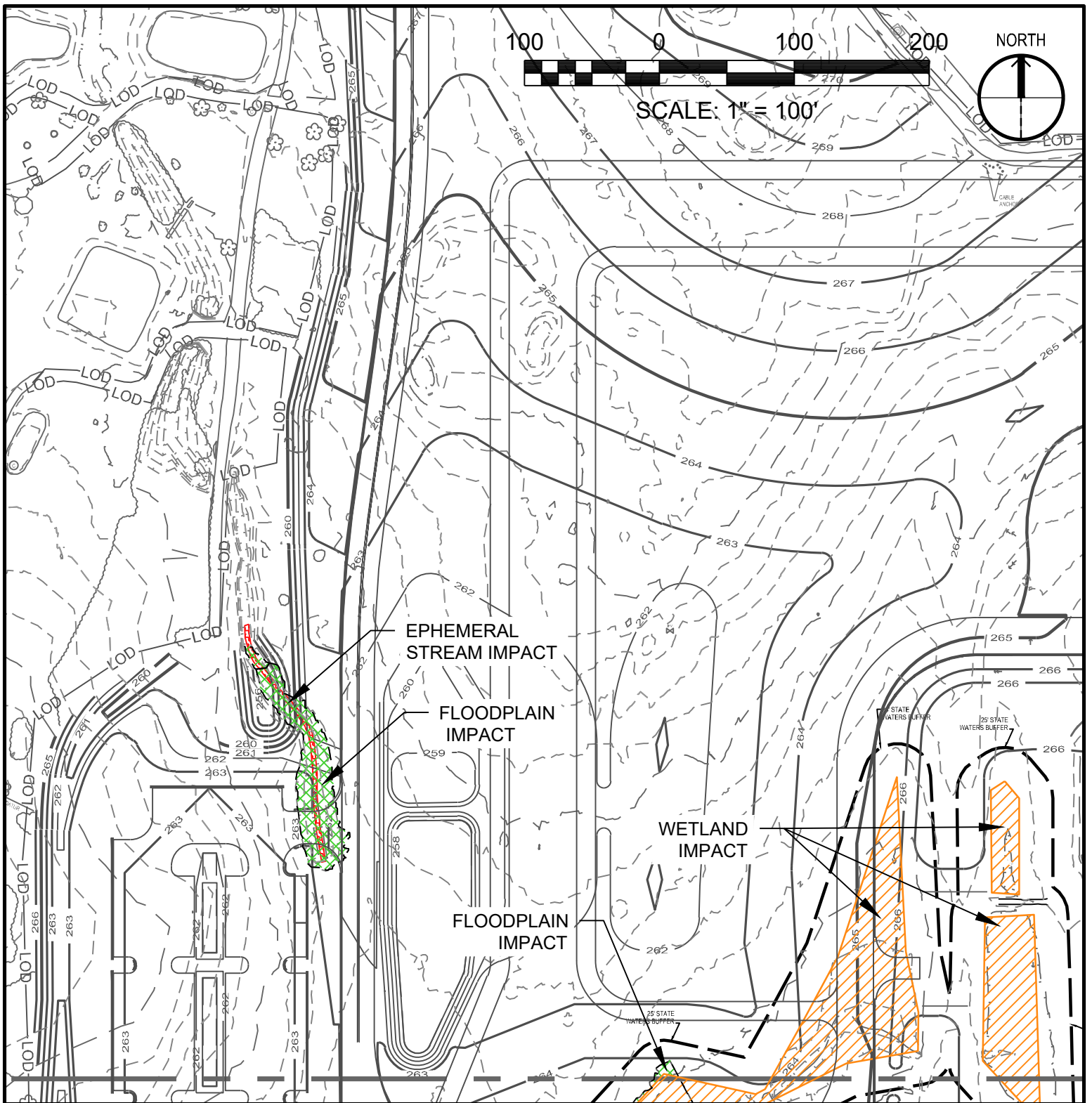
C-0

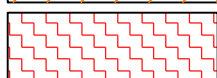

LEGEND

-  IMPACTED WETLANDS (16,140 SF)
-  IMPACTED EPHEMERAL STREAM (194 LF)
-  IMPACTED FLOODPLAIN (3,817 SF)

KEY PLAN

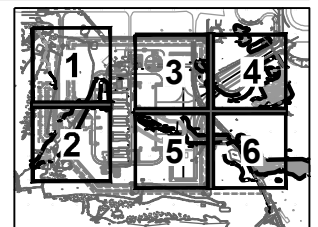

3500 Parkway Lane, Suite 600
 Norcross, GA 30092
 Phone (678) 336-7740
 Fax (678) 336-7744
 JOB NO.: 1107151

**JOINT BASE ANDREWS
 CAMP SPRINGS, MD**

DESCRIPTION:

IMPACT



DATE: 1/11/18

DRAWING NO:

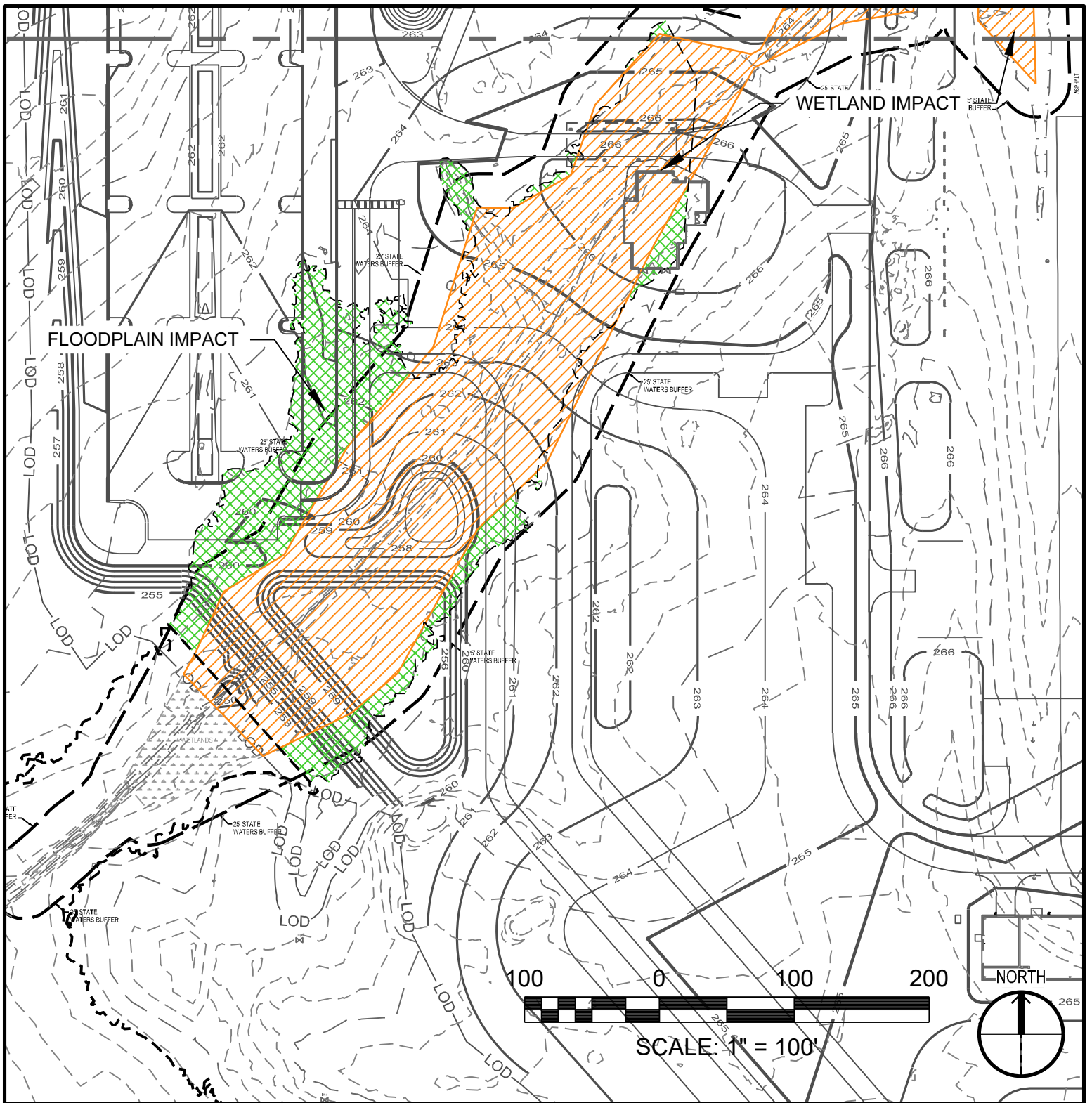
C-1



LEGEND

-  IMPACTED WETLANDS (67,336 SF)
-  IMPACTED FLOODPLAIN (82,718 SF)

KEY PLAN

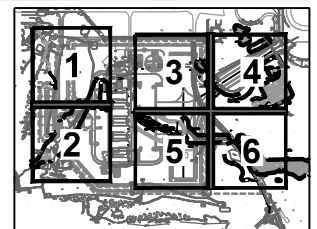

POND

3500 Parkway Lane, Suite 600
 Norcross, GA 30092
 Phone (678) 336-7740
 Fax (678) 336-7744
 JOB NO.: 1107151

JOINT BASE ANDREWS
 CAMP SPRINGS, MD

DESCRIPTION:

IMPACT

DATE: 1/11/18

DRAWING NO:

C-2

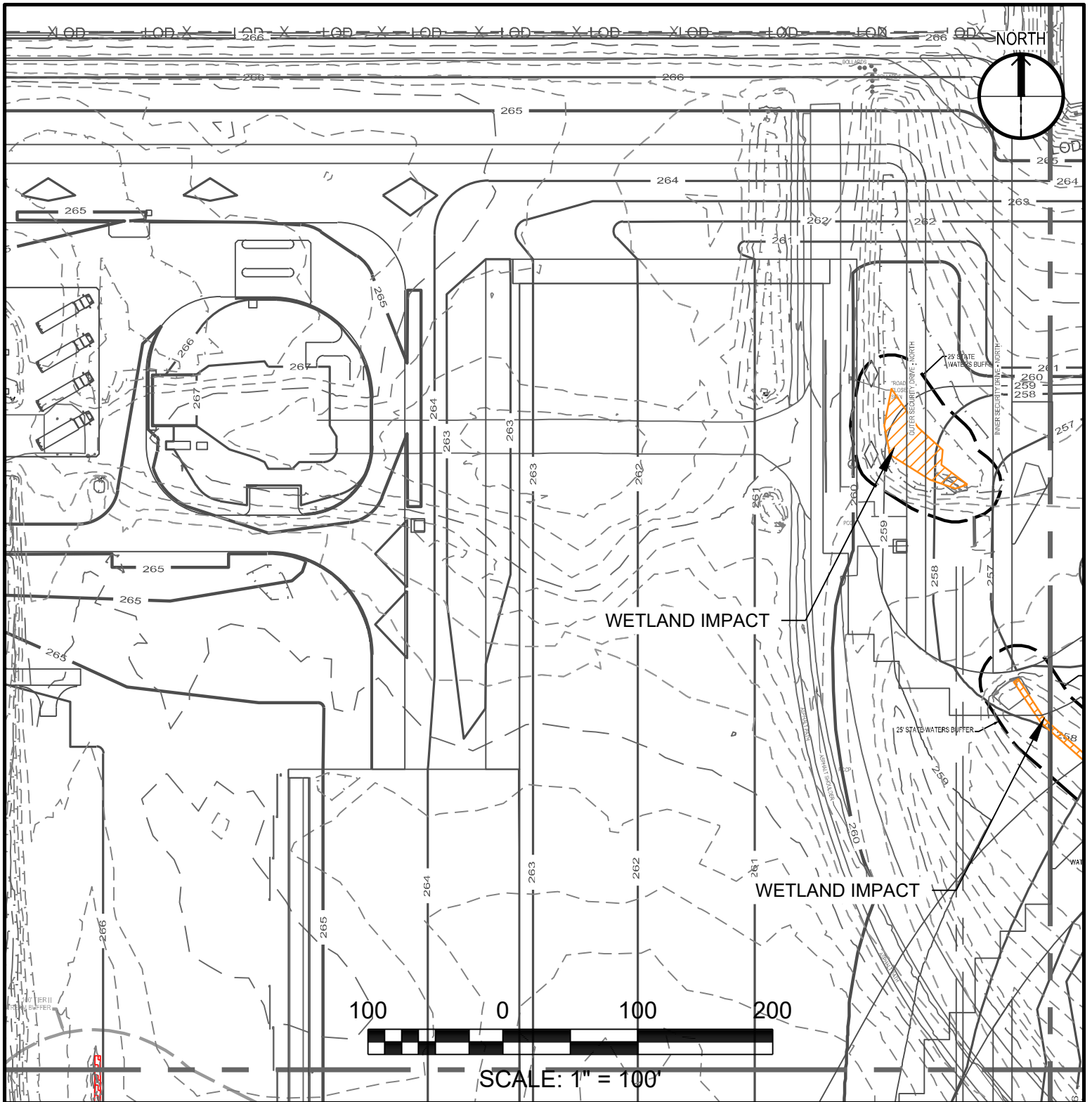

LEGEND

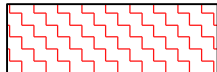
-  IMPACTED WETLANDS (1,822 SF)
-  IMPACTED EPHEMERAL STREAM (15 LF)

KEY PLAN

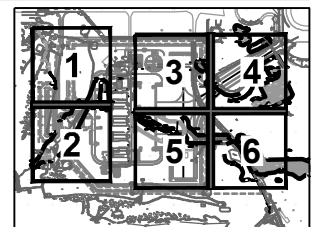

3500 Parkway Lane, Suite 600
 Norcross, GA 30092
 Phone (678) 336-7740
 Fax (678) 336-7744
 JOB NO.: 1107151

JOINT BASE ANDREWS
 CAMP SPRINGS, MD

DESCRIPTION:

IMPACT

DATE: 1/11/18

DRAWING NO:

C-3

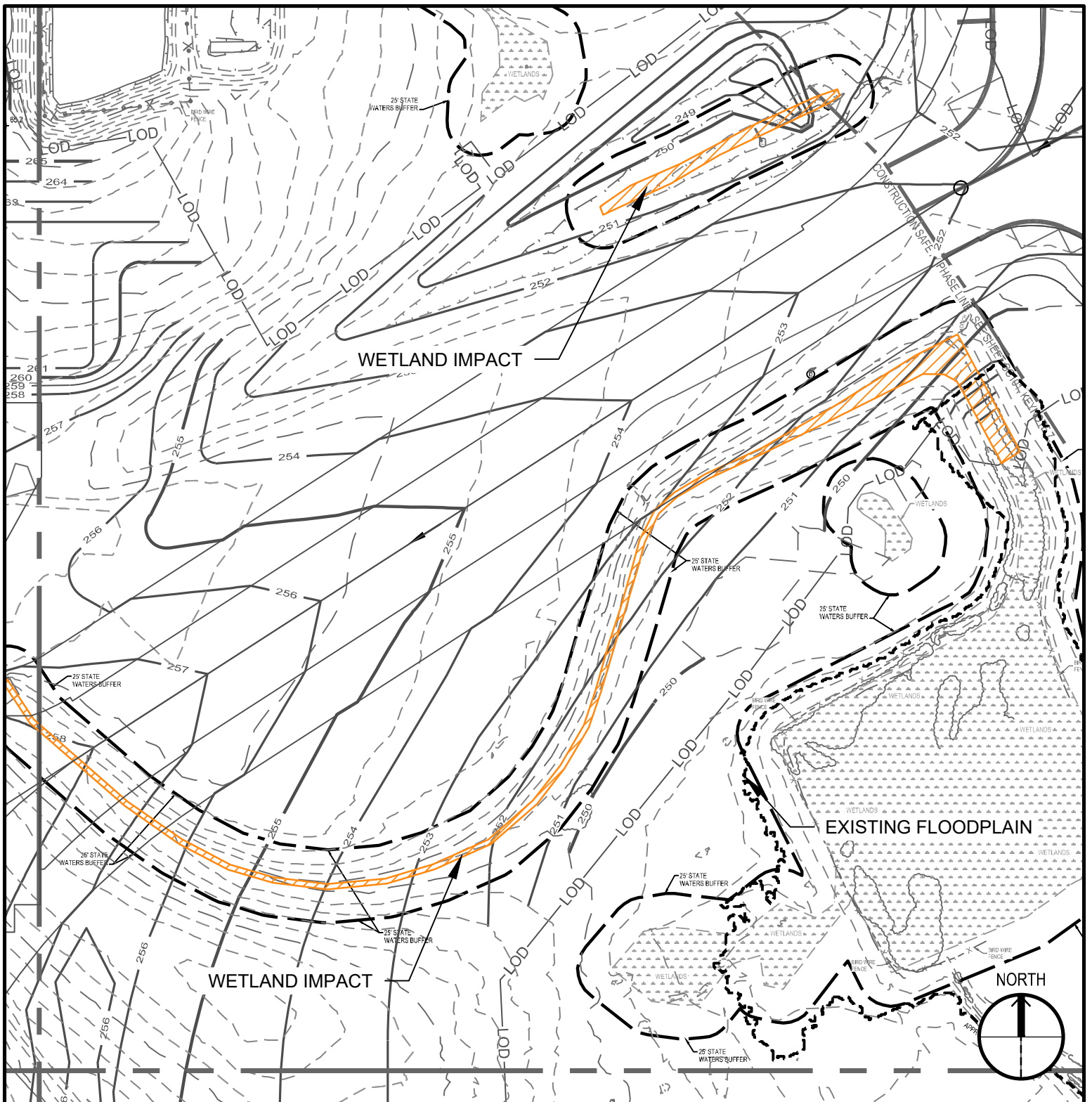

LEGEND



IMPACTED WETLANDS (7,933 SF)



SCALE: 1" = 100'

KEY PLAN

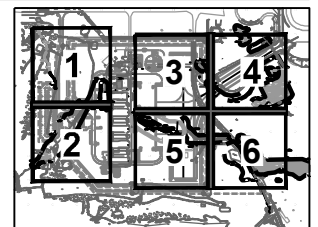

POND

3500 Parkway Lane, Suite 600
 Norcross, GA 30092
 Phone (678) 336-7740
 Fax (678) 336-7744
 JOB NO.: 1107151

JOINT BASE ANDREWS
 CAMP SPRINGS, MD

DESCRIPTION:

IMPACT



DATE: 1/11/18

DRAWING NO:

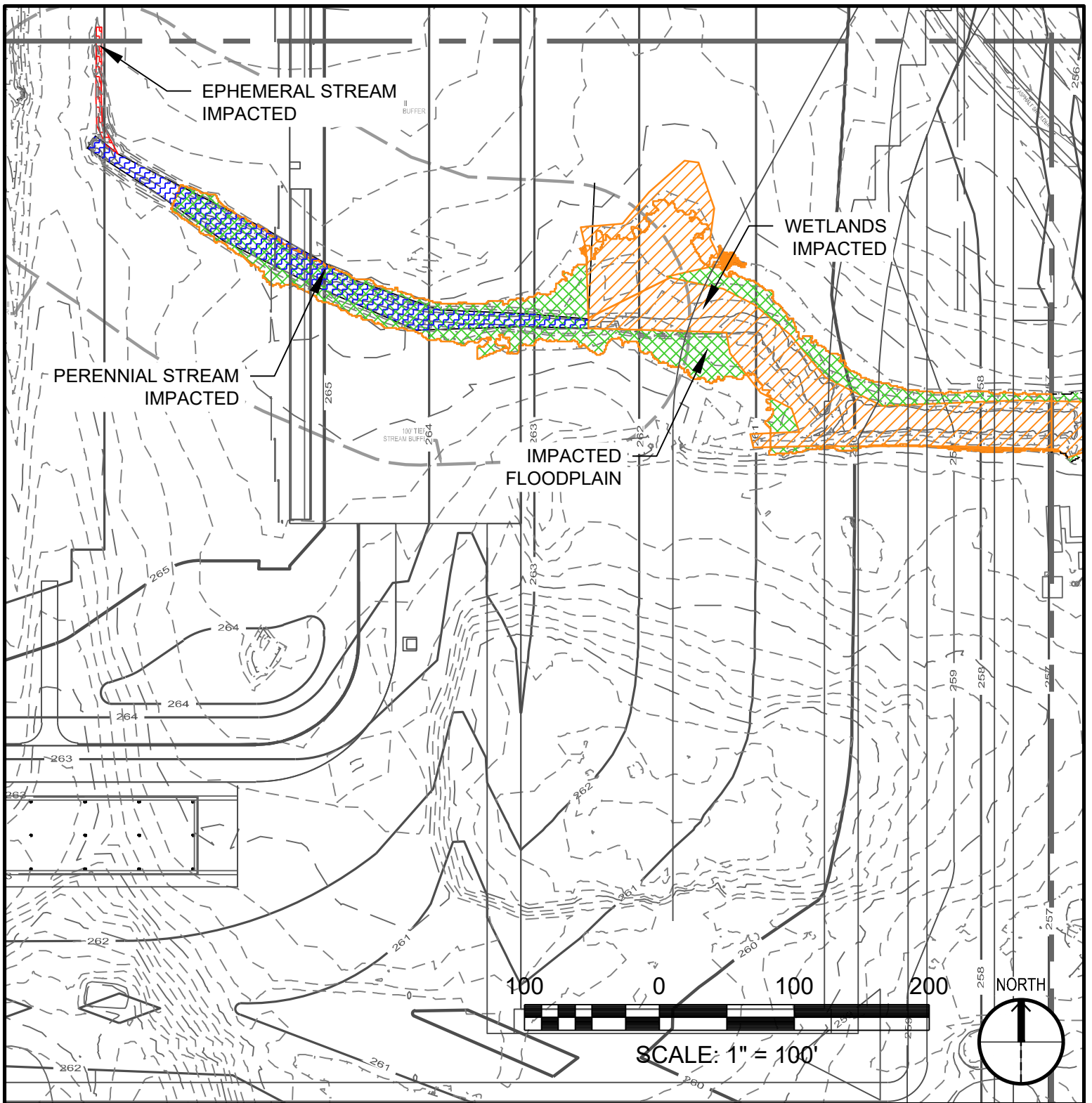
C-4

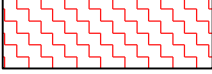
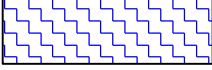

LEGEND

	IMPACTED WETLANDS (19,827 SF)		IMPACTED FLOODPLAIN (33,616 SF)
	IMPACTED EPHEMERAL STREAM (83 LF)		
	IMPACTED PERENNIAL STREAM (402 LF)		

KEY PLAN

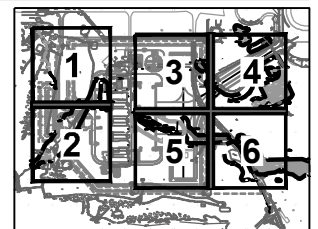

POND

3500 Parkway Lane, Suite 600
Norcross, GA 30092
Phone (678) 336-7740
Fax (678) 336-7744
JOB NO.: 1107151

JOINT BASE ANDREWS
CAMP SPRINGS, MD

DESCRIPTION:

IMPACT



DATE: 1/11/18

DRAWING NO:

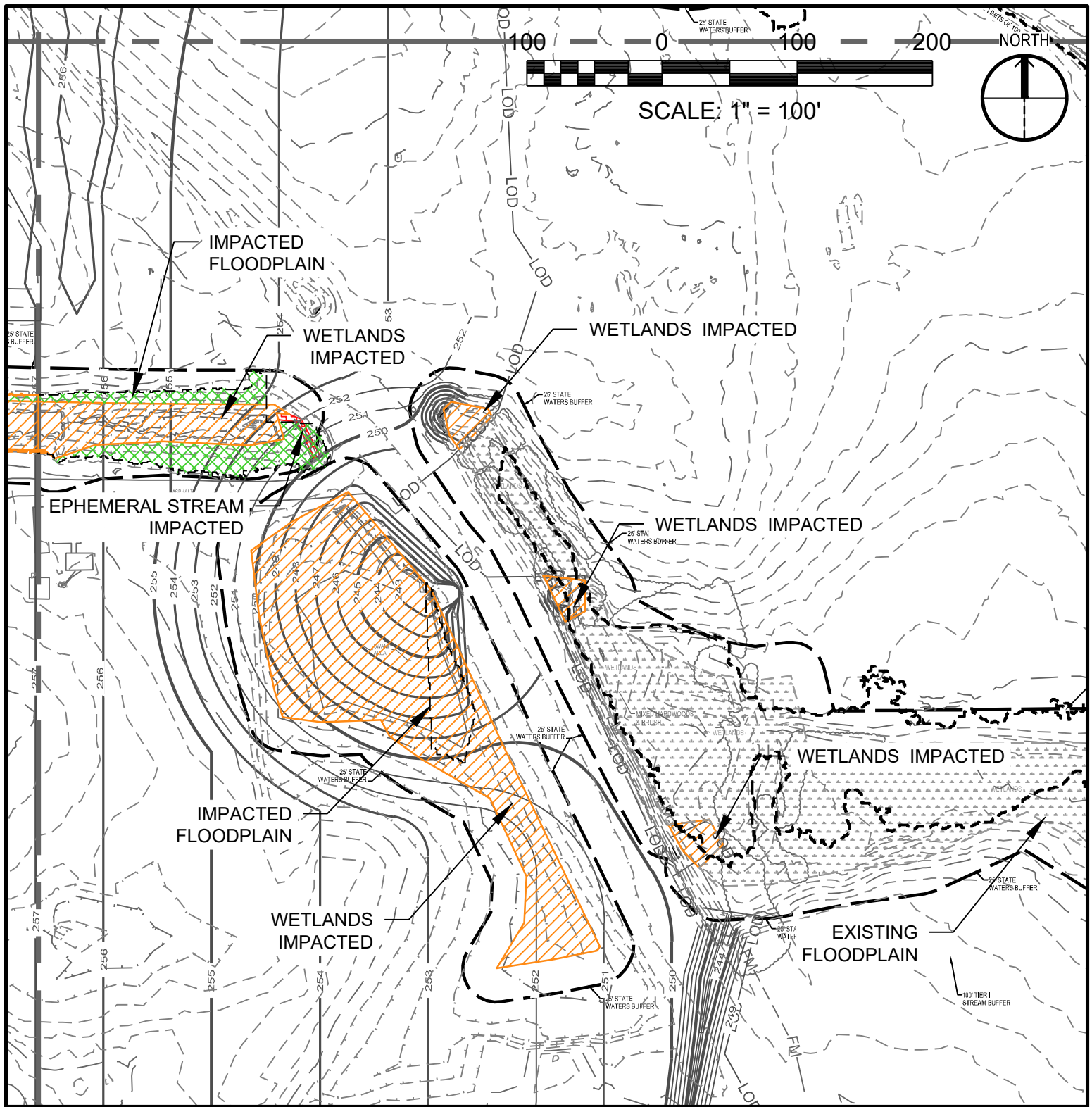
C-5

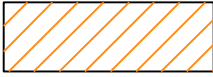
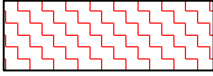

LEGEND

-  IMPACTED WETLANDS (35,729 SF)
-  IMPACTED EPHEMERAL STREAM (48LF)
-  IMPACTED FLOODPLAIN (13,348 SF)

KEY PLAN

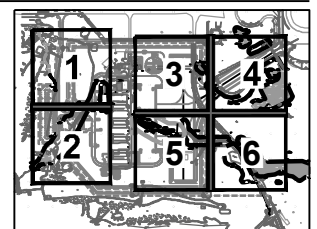

POND
 3500 Parkway Lane, Suite 600
 Norcross, GA 30092
 Phone (678) 336-7740
 Fax (678) 336-7744
 JOB NO.: 1107151

JOINT BASE ANDREWS
 CAMP SPRINGS, MD

DATE: 1/11/18

DESCRIPTION:

IMPACT

DRAWING NO:

C-6

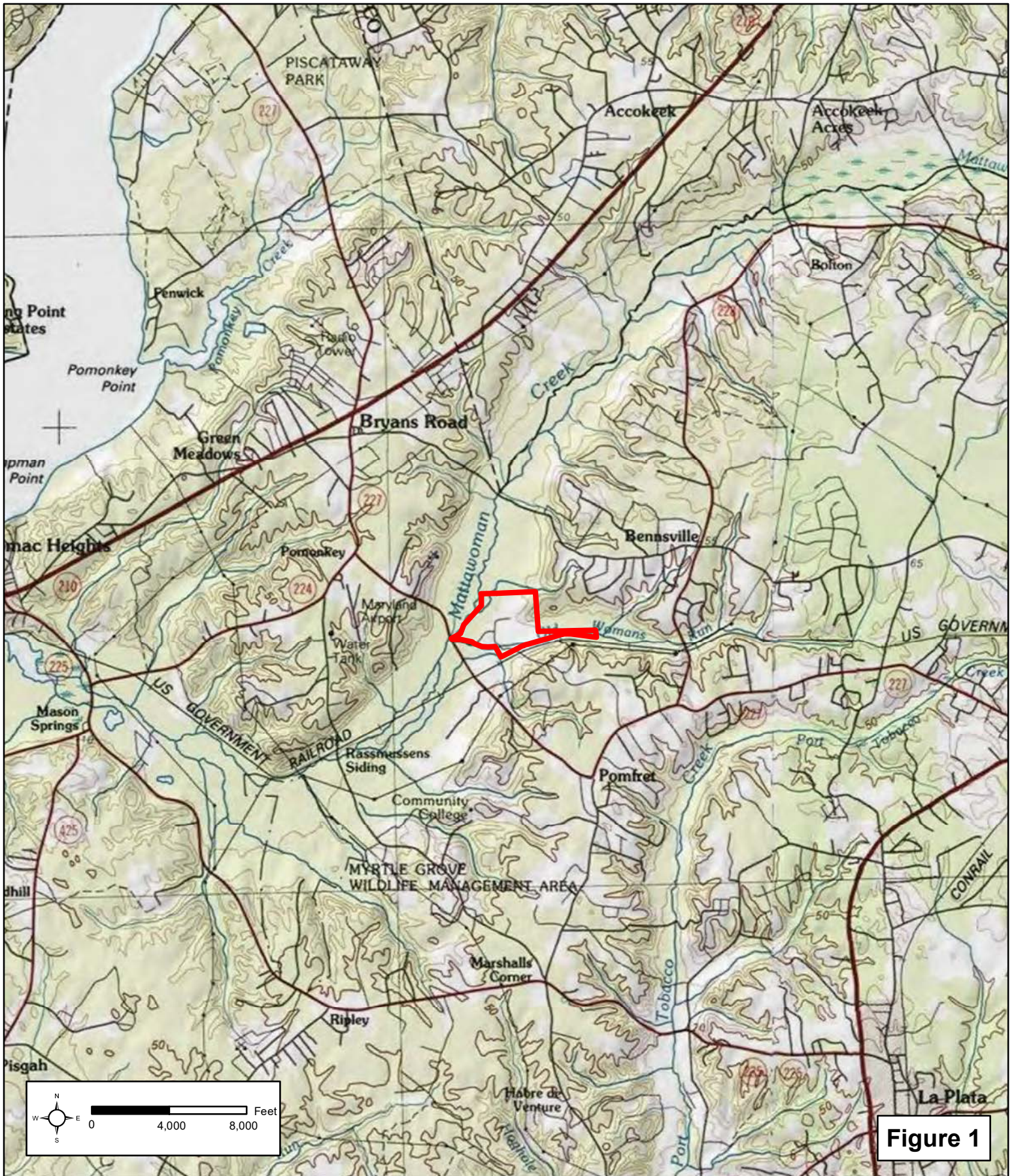

Figure 1

 Morgan Property Boundary

SITE LOCATION MAP

Mattawoman Creek Mitigation Site
 4250 Foxburrow Place
 Pomfret, Charles County, Maryland

GreenVest
 VISION - PERFORMANCE - RESULTS

MARYLAND 210 Najoles Road, Suite 202 Millersville, MD 21108 410.987.5500 (p)	NEW JERSEY 91 Fieldcrest Ave. Raritan Plaza II, A-1 Edison, NJ 08837 732.902.6644 (p)	NORTH CAROLINA 4405 Dewees Court Raleigh, NC 27612 919.349.2224 (p)
--	--	---

1 in = 8,000 ft @ 8.5 x 11 Date: 12/8/2016

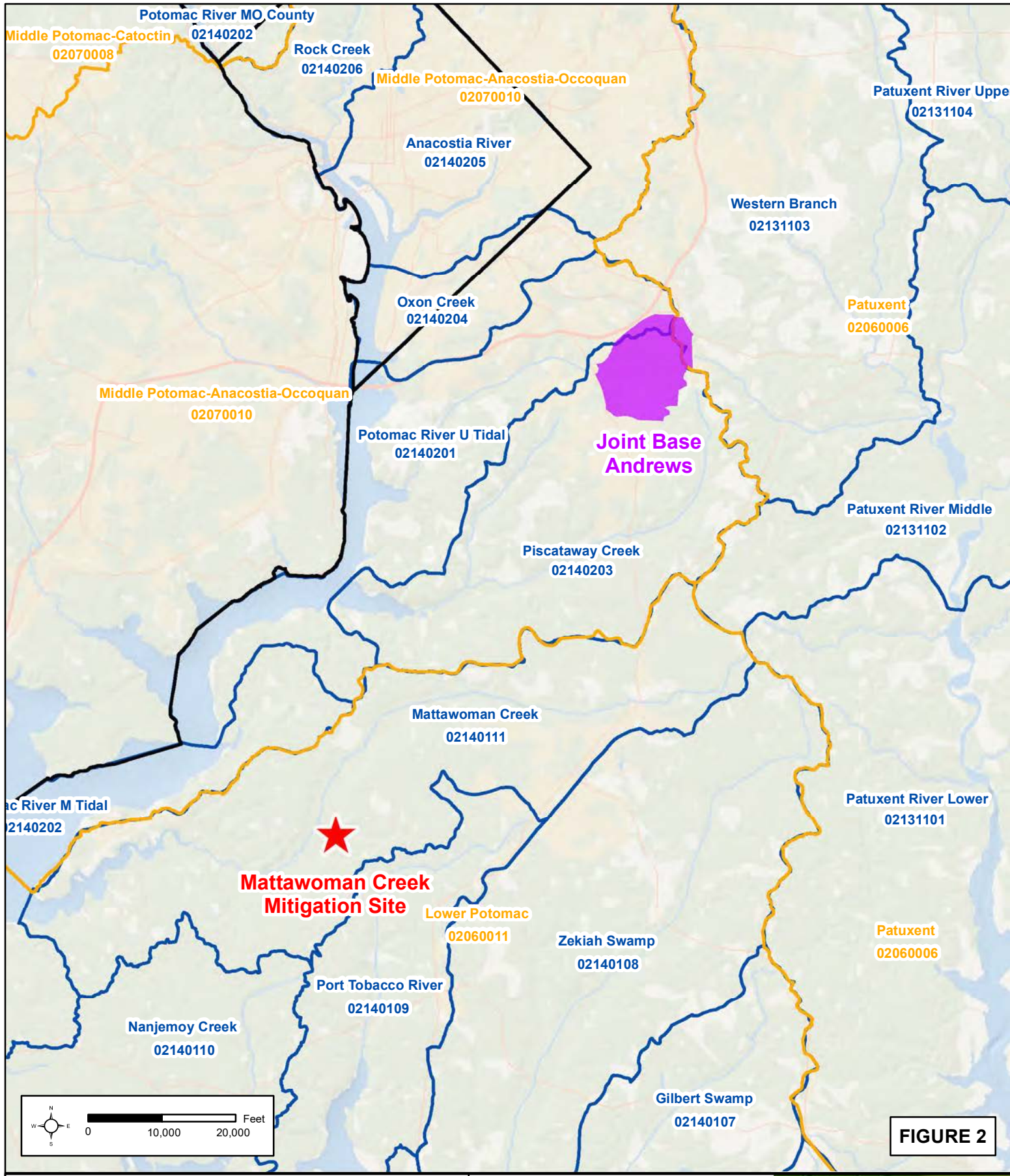

FIGURE 2

- Federal HUC-8 Boundaries
- MD 8-Digit Watershed Boundaries

**WATERSHED BOUNDARIES
MAP**

Mattawoman Creek Mitigation Site
4250 Foxburrow Place
Pomfret, Charles County, Maryland

GreenVest
VISION · PERFORMANCE · RESULTS

MARYLAND	NEW JERSEY	NORTH CAROLINA
210 Najoles Road, Suite 202 Millsville, MD 21108 410.987.5500 (p)	91 Fieldcrest Ave. Rantlan Plaza II, A-1 Edison, NJ 08837 732.902.6644 (p)	4405 Dewees Court Raleigh, NC 27612 919.349.2224 (p)

1 inch = 20,000 ft @ 8.5x11 Date: 12/8/2016

Data Sources: GreenVest, MD Map, ESRI, USDA, Prince George's County

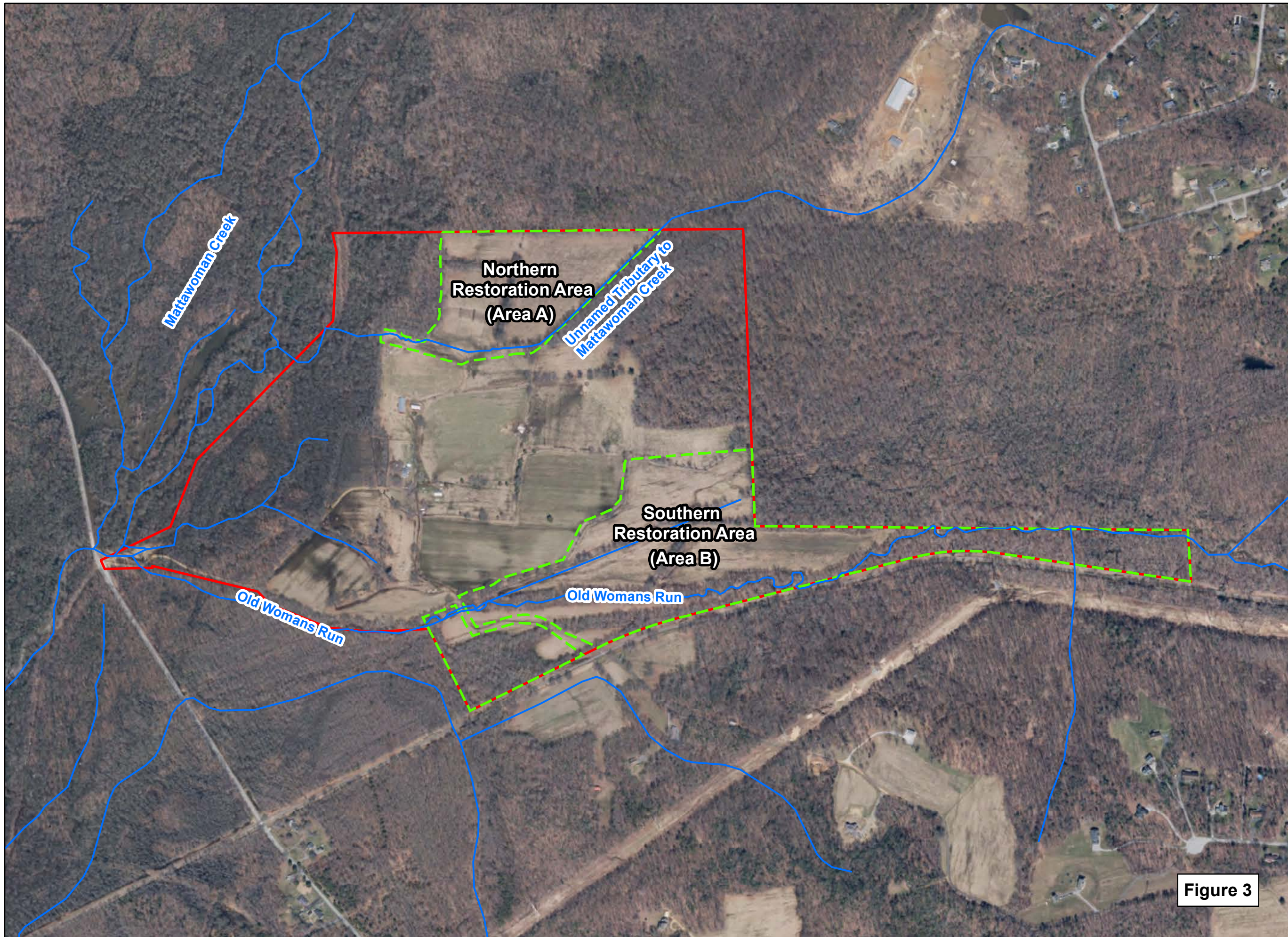

Regional Context

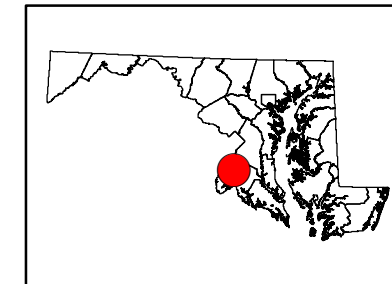

GreenVest LLC*

210 Najoles Road
Suite 202
Millersville, MD 21108
410.987.5500 (p)

* with offices in New Jersey and North Carolina

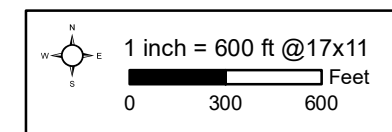

SITE MAP

Mattawoman Creek Mitigation Site
4250 Foxburrow Place
Pomfret, Charles County, Maryland

- Mitigation Area Boundaries
- Morgan Property Boundary

Figure 3