

U.S. Army Corps
of Engineers
Baltimore District

Public Notice

In Reply to Application Number
CENAB-OPR-M (CA DPW/ POTOMAC HEIGHTS
MHA/GREENWOOD AVE) 2018-60773

PN 18-45

Comment Period: July 19, 2018 – August 19, 2018

THE PURPOSE OF THIS PUBLIC NOTICE IS TO SOLICIT COMMENTS FROM THE PUBLIC ABOUT THE WORK DESCRIBED BELOW. AT THIS TIME, NO DECISION HAS BEEN MADE AS TO WHETHER OR NOT A PERMIT WILL BE ISSUED.

The Baltimore District has received an application for a Department of the Army permit pursuant to Section 10 of the Rivers and Harbors Act of 1899 and Section 404 of the Clean Water Act (33 U.S.C. 1344), as described below:

APPLICANT: Potomac Heights Mutual Homeowners Association
c/o Mr. John Stevens, CH DPW
200 Cedar Lane
Indian Head, Maryland 20640

WATERWAY AND LOCATION: All work is proposed in the Potomac River at Greenwood Avenue at Indian Head, Charles County, Maryland.

PROPOSED WORK AND PURPOSE: The applicant proposes to create a marsh along 1,775 feet of shoreline by depositing approximately 300 cubic yards of clean sloped sand to be planted with *Spartina alterniflora* and *S. patens* creating approximately 46,076 square feet of marsh toe extend no more than 32 feet channelward of the approximate mean high water (MHW) shoreline; to construct an 18-foot wide by 1,775 foot long and 4-foot high stone sill with 15 10-foot wide vents to extend no more than 50 feet channelward of the approximate mean high water (MHW) shoreline to extend no more than 50 feet channelward of the approximate MHW shoreline. All work is to be completed in accordance with the attached plans dated May 2018. If you have any questions concerning this matter, please contact Mrs. Erica Schmidt at (410) 962-6029 or Erica.Schmidt@usace.army.mil.

The proposed project is to mitigate shoreline erosion at the project site by creating a living shoreline enhancing existing aquatic habitat.

As part of the planning process for the proposed project, steps were taken to ensure avoidance and minimization of impacts to aquatic resources to the maximum extent practicable based on the existing site conditions. No compensatory mitigation is proposed since no wetland fill impacts are proposed.

The decision whether to issue a permit will be based on an evaluation of the probable impact including cumulative impacts of the proposed activity on the public interest. That decision will reflect the national concern for both protection and utilization of important resources. The benefit which reasonably may be expected to accrue from the proposal must be balanced against its reasonably foreseeable detriments. All factors which may be relevant to the

proposal will be considered including the cumulative effects thereof; among those are conservation, economics, aesthetics, general environmental concerns, wetlands, cultural values, fish and wildlife values, flood hazards, flood plain values, land use, navigation, shoreline erosion and accretion, recreation, water supply and conservation, water quality, energy needs, safety, food and fiber production, and, in general, the needs and welfare of the people.

The evaluation of the impacts of the work described above on the public interest will include application of the Clean Water Act 404(b)(1) Guidelines promulgated by the Administrator, U.S. Environmental Protection Agency, under authority of Section 404 of the Clean Water Act.

The Corps of Engineers is soliciting comments from the public; Federal, State, and local agencies and officials; Indian Tribes; and other interested parties in order to consider and evaluate the impacts of this proposed activity. Any comments received will be considered by the Corps of Engineers to determine whether to issue, modify, condition or deny a permit for this proposal. To make this decision, comments are used to assess impacts on endangered species, historic properties, water quality, general environmental effects, and the other public interest factors listed above. Comments are used in the preparation of an Environmental Assessment and/or an Environmental Impact Statement pursuant to the National Environmental Policy Act. Comments are also used to determine the need for a public hearing and to determine the overall public interest of the proposed activity.

Written comments concerning the work described above related to the factors listed above or other pertinent factors must be received by the District Engineer, U.S. Army Corps of Engineers, Baltimore District, [Attn: Mrs. Erica Schmidt, CENAB-OPR-M], 2 Hopkins Plaza, Baltimore, Maryland 21201 or Erica.Schmidt@usace.army.mil, within the comment period specified above.

ESSENTIAL FISH HABITAT: The Magnuson-Stevens Fishery Conservation and Management Act (MSFCMA), as amended by the Sustainable Fisheries Act of 1996 (Public Law 04-267), requires all Federal agencies to consult with the National Marine Fisheries Service (NMFS) on all actions, or proposed actions, permitted, funded, or undertaken by the agency that may adversely affect Essential Fish Habitat (EFH). The project site lies in or adjacent to the Potomac River complex for EFH as described under the MSFCMA for *Scophthalmus aquosus* (windowpane flounder) juvenile and adult; *Pomatomus saltatrix* (blue fish) juvenile and adult; *Paralichthys dentatus* (summer flounder) juvenile and adult; and the eggs, larvae, juvenile, and adult stages of *Sciaenops ocellatus* (red drum), *Scomberomorus cavalla* (king mackerel), *Scomberomorus maculatus* (Spanish mackerel), and *Rachycentron canadum* (cobia), managed species under the MSFCMA.

The project has the potential to adversely affect EFH or the species of concern by loss of spawning, nursery, forage and/or shelter habitat as described under the MSFCMA for the species and life stages identified above. In addition, the site is located adjacent to SAV which was not present in the previous year but has been located within the project area historically. The Baltimore District has made a preliminary determination that site-specific impacts would not be substantial and an abbreviated consultation will be conducted with NMFS. No mitigative measures are recommended to minimize adverse effects on EFH at this time. This determination may be modified if additional information indicates otherwise and would change the preliminary determination. The project area is not a Habitat Area of Particular Concern (HAPC).

WATER QUALITY CERTIFICATION: The applicant is required to obtain a water quality certification in accordance with Section 401 of the Clean Water Act from the Maryland Department of the Environment. Any written comments concerning the work described above which relate to water quality certification must be received by the Maryland Department of the Environment, Tidal Wetlands Division, Montgomery Park Business Center, 1800 Washington Blvd., Suite 430, Baltimore, Maryland 21230 within the comment period as specified above to receive consideration. The 401 certifying agency has a statutory limit of one year to make its decision.

COASTAL ZONE MANAGEMENT PROGRAM: The applicant has certified in this application that the proposed activity complies with and will be conducted in a manner consistent with the Maryland Coastal Zone Program. This certification statement is available for inspection in the District Office; however, public comments relating to consistency must be received by the Tidal Wetlands Division, Maryland Department of the Environment, Montgomery Park Business Center, 1800 Washington Blvd. Suite 430, Baltimore, Maryland 21230, within the comment period as specified above. It should be noted that the MDE has a statutory limit of 6 months in which to make its consistency determination.

The applicant must obtain any State or local government permits which may be required.

ENDANGERED SPECIES ACT: A preliminary review of this application indicates that the proposed work will not affect Federal listed threatened or endangered species or their critical habitat, pursuant to Section 7 of the Endangered Species Act, as amended because the proposed work does not extend into water depths sufficient for listed species. As the evaluation of this application continues, additional information may become available which could modify this preliminary determination.

NATIONAL HISTORIC PRESERVATION ACT: Review of the latest published version of the National Register of Historic Places indicates that no registered properties listed as eligible for inclusion therein are located at the site of the proposed work. Currently unknown archeological, scientific, prehistoric, or historical data may be lost or destroyed by the work to be accomplished under the requested permit.

The evaluation of the impact of the work described above on the public interest will include application of the guidelines promulgated by the Administrator, U.S. Environmental Protection Agency, under authority of Section 404 of the Clean Water Act. Any person who has an interest, which may be adversely affected by the issuance of this permit, may request a public hearing. The District Engineer must receive the request, which must be in writing, to the U.S. Army Corps of Engineers, Baltimore District, 2 Hopkins Plaza, Baltimore, Maryland 21201, within the comment period as specified as above to receive consideration. Also, it must clearly state the interest that may be adversely affected by this activity and the manner in which the interest may be adversely affected.

It is requested that you communicate the foregoing information concerning the proposed work to any persons known by you to be interested and not being known to this office, who did not receive a copy of this notice. If you have any questions concerning this matter, please contact Mrs. Erica Schmidt at (410) 962-6029 or Erica.Schmidt@usace.army.mil.

FOR THE DISTRICT ENGINEER:

KATHY B. ANDERSON
Chief, Maryland Section Southern

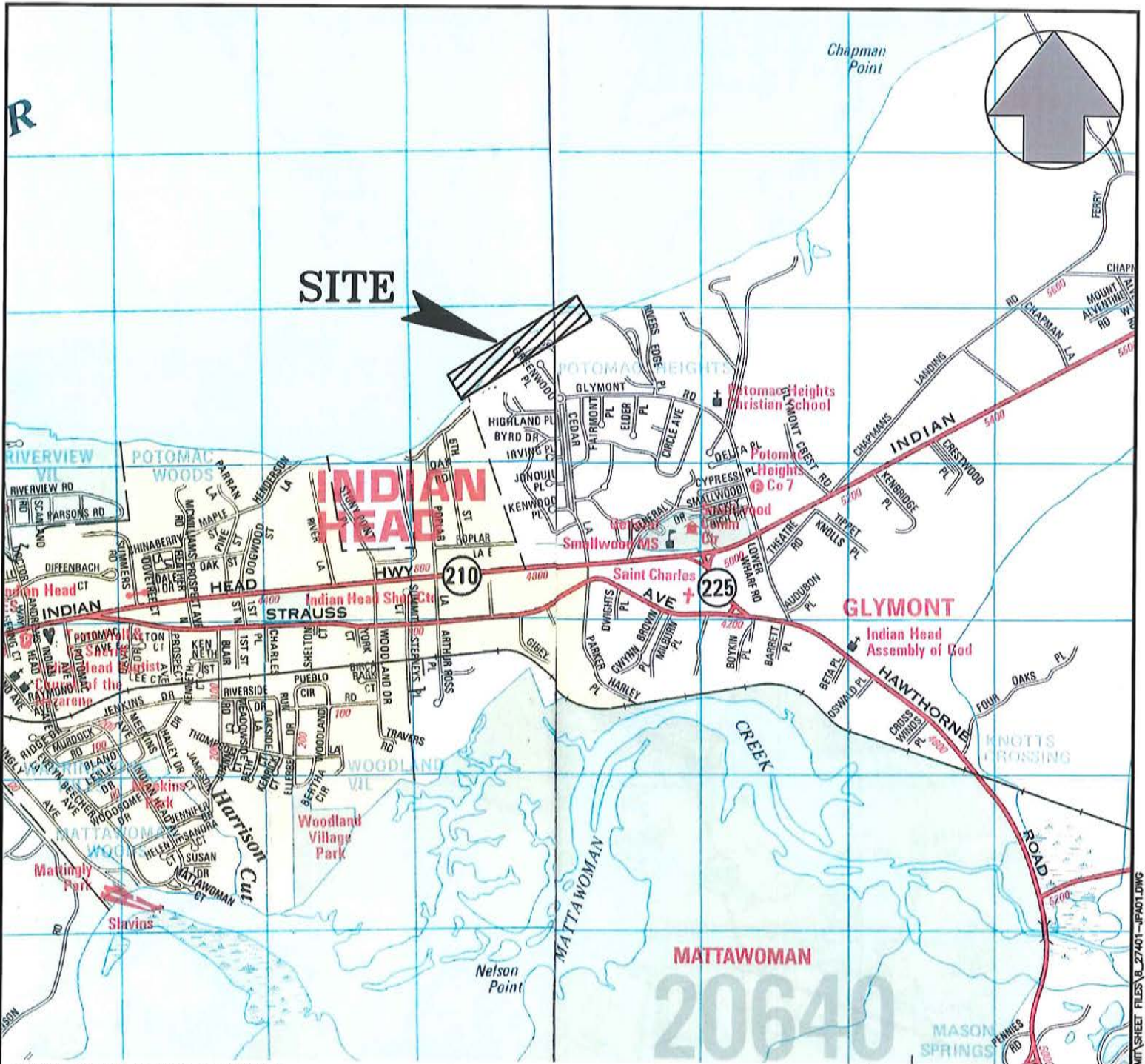

CHARLES COUNTY ADC MAP COORDINATES:
 MAP 6 GRID K-5, MAP 7 GRID A-5

MAP COPYRIGHT ADC THE MAP PEOPLE, (800-829-6277),
 PERMITTED USE NUMBER 10222014

**SHORELINE STABILIZATION
 AT
 POTOMAC HEIGHTS
 CHARLES COUNTY, MD**

APPL. BY: CHARLES COUNTY DEPARTMENT OF PUBLIC WORKS
 1001 RADIO STATION RD
 LA PLATA, MD 20646

VICINITY MAP

DATE: May 2018 SHEET 1 OF 9

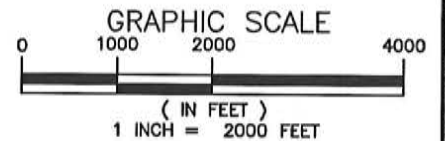

NOTE: THESE ARE PERMIT DRAWINGS
 ONLY. DESIGN DRAWINGS ARE TO BE
 PREPARED SEPARATELY.

Bayland
 Consultants & Designers, Inc.
"Integrating Engineering and Environment"
 7455 New Ridge Road, Suite T Phone: (410) 694-9401
 Hanover, Maryland 21076 Fax: (410) 694-9405
 www.baylandinc.com

Z:\B_27401_POTOMAC_HEIGHTS_SHORELINE_PEMD\CAD FILES\ARCHIVE\2018-4-5 PERMIT SHEET FILES\B_27401-1\PA01.DWG

POTOMAC RIVER

OPPOSITE SHORELINE
 1.8 MILES
 FETCH TO THE WEST
 5.8 MILES
 FETCH TO THE NORTHEAST
 3.5 MILES

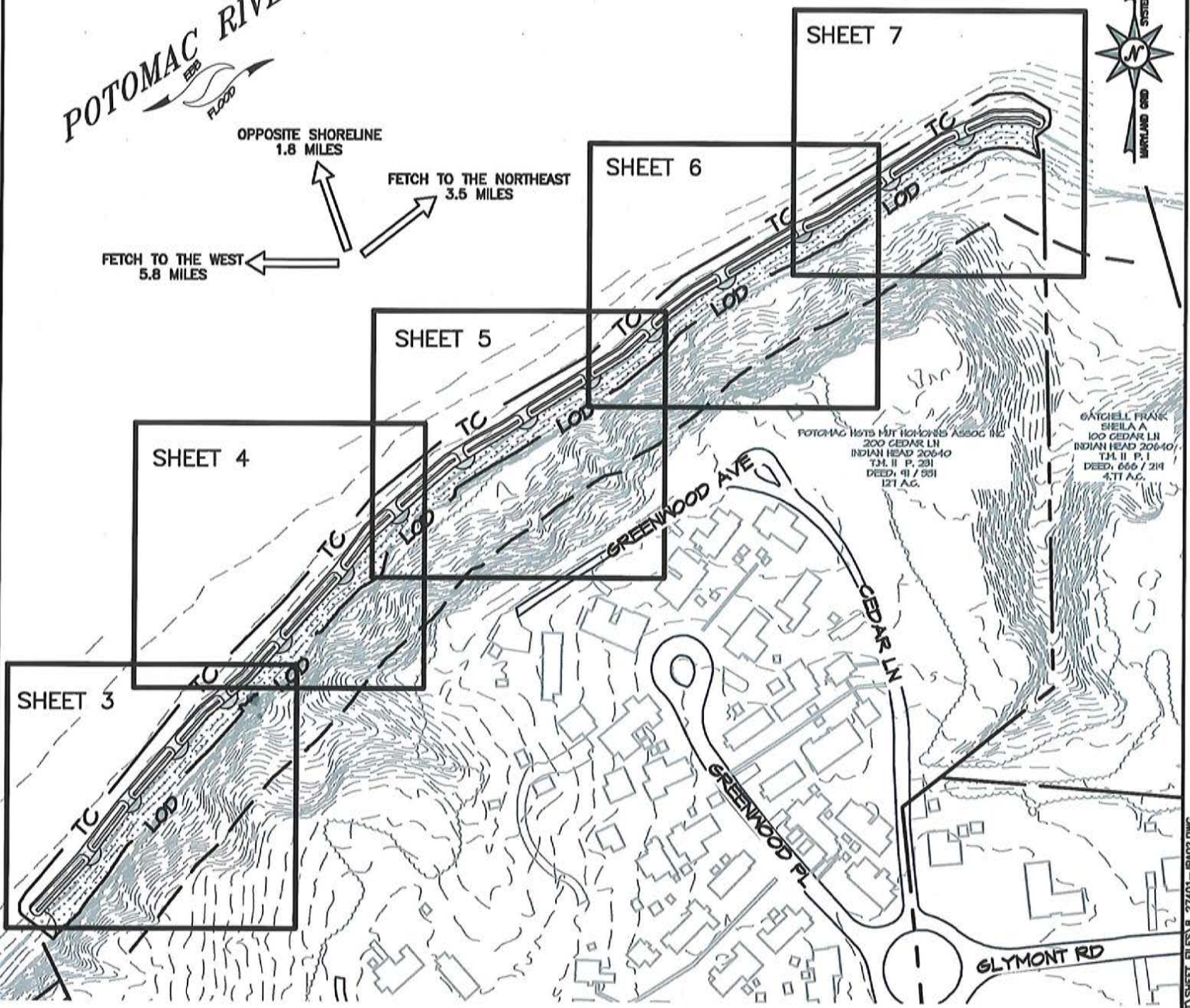

POTOMAC HEIGHTS HISTORICAL ASSOC. INC.
 2000 CEDAR LN
 INDIAN HEAD 20640
 TM, II P. 231
 DEED, 91 / 991
 121 A.G.
 GATCHELL FRANK
 SHEILA A
 100 CEDAR LN
 INDIAN HEAD 20640
 TM, II P. 1
 DEED, 660 / 219
 411 A.G.

SHORELINE STABILIZATION
 AT
 POTOMAC HEIGHTS
 CHARLES COUNTY, MD

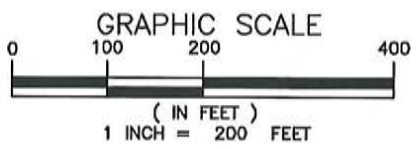

APPL. BY: CHARLES COUNTY DEPARTMENT OF PUBLIC WORKS
 1001 RADIO STATION RD
 LA PLATA, MD 20646

NOTE: THESE ARE PERMIT DRAWINGS ONLY. DESIGN DRAWINGS ARE TO BE PREPARED SEPARATELY.

KEY SHEET

DATE: May 2018 SHEET 2 OF 9

Bay and
 Consultants & Designers, Inc.
"Integrating Engineering and Environment"
 7455 New Ridge Road, Suite T Phone: (410) 694-9401
 Hanover, Maryland 21076 Fax: (410) 694-9405
 www.baylandinc.com

Z:\B_27401_POTOMAC_HEIGHTS_SHORELINE_PEBAY\CAD_FILES\ARCHIVE\2018-4-5 PERMIT SHEET FILES\B_27401-4PA02.DWG

MATCHLINE REFER TO SHEET 4

POTOMAC RIVER
EBB
FLOOD

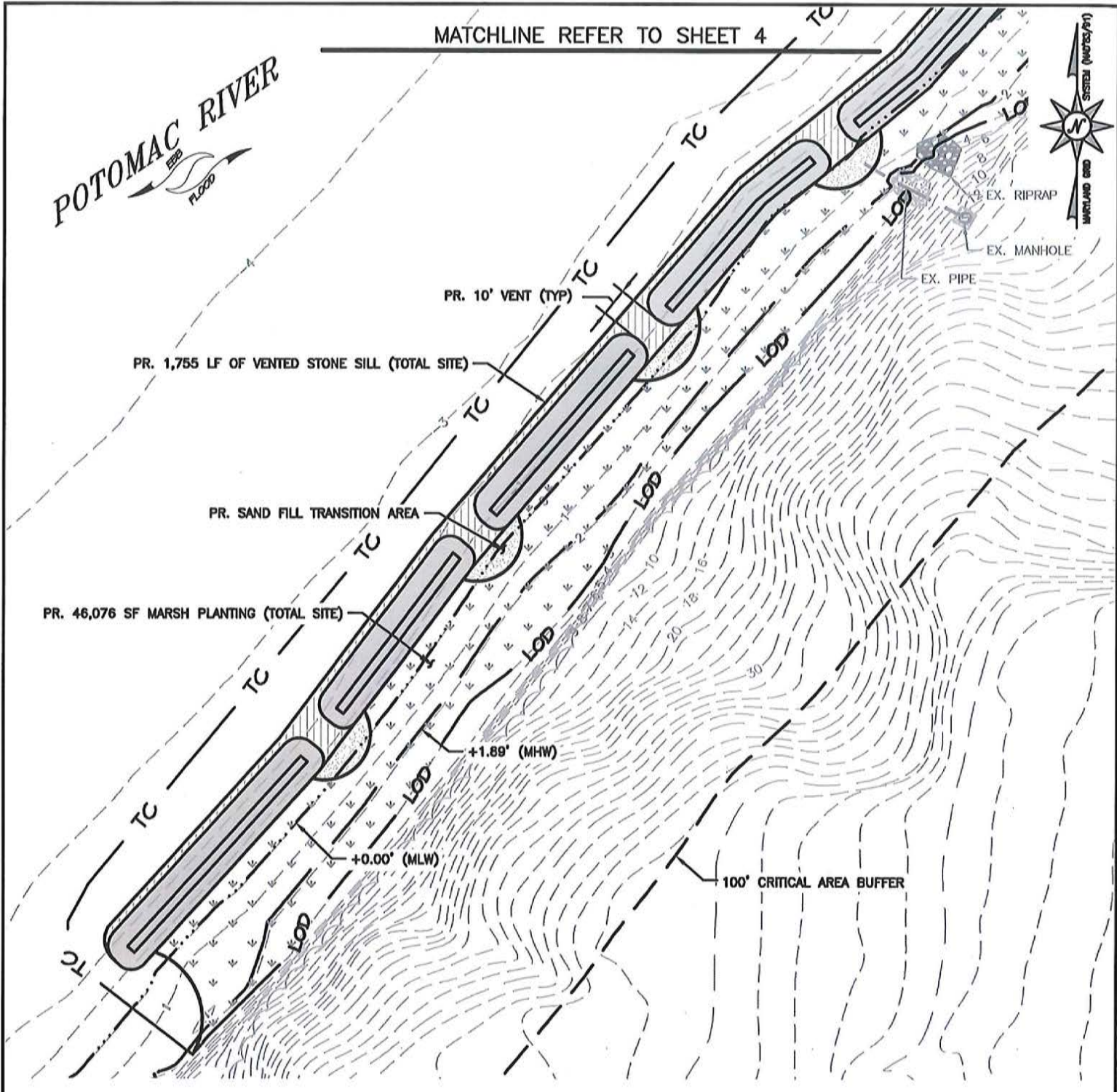

SHORELINE STABILIZATION
AT
POTOMAC HEIGHTS
CHARLES COUNTY, MD

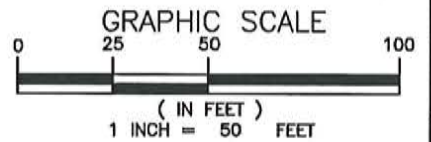

APPL. BY: CHARLES COUNTY DEPARTMENT OF PUBLIC WORKS
1001 RADIO STATION RD
LA PLATA, MD 20646

NOTE: THESE ARE PERMIT DRAWINGS ONLY. DESIGN DRAWINGS ARE TO BE PREPARED SEPARATELY.

SITE PLAN

DATE: May 2018 SHEET 3 OF 9

Bayland
Consultants & Designers, Inc.
"Integrating Engineering and Environment"
7455 New Ridge Road, Suite T Phone: (410) 694-9401
Hanover, Maryland 21076 Fax: (410) 694-9405
www.baylandinc.com

Z:\8_27401_POTOMAC_HEIGHTS_SHORELINE_PERMITS\2018-4-5 PERMIT\SHEET FILES\8_27401-PP03.DWG

POTOMAC RIVER



PR. 1,755 LF OF VENTED STONE SILL (TOTAL SITE)

50' MAX ENCROACHMENT (FROM MHW)

PR. 10' VENT (TYP)

PR. 46,076 SF MARSH PLANTING (TOTAL SITE)

PR. SAND FILL TRANSITION AREA

+1.89' (MHW)

+0.00' (MLW)

100' CRITICAL AREA BUFFER

MATCHLINE REFER TO SHEET 3

MATCHLINE REFER TO SHEET 5

SHORELINE STABILIZATION
 AT
 POTOMAC HEIGHTS
 CHARLES COUNTY, MD

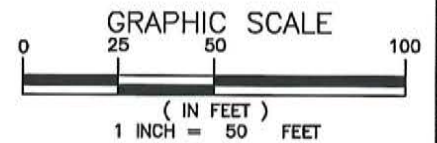

APPL. BY: CHARLES COUNTY DEPARTMENT OF PUBLIC WORKS
 1001 RADIO STATION RD
 LA PLATA, MD 20646

NOTE: THESE ARE PERMIT DRAWINGS ONLY. DESIGN DRAWINGS ARE TO BE PREPARED SEPARATELY.

SITE PLAN

DATE: May 2018 SHEET 4 OF 9



7455 New Ridge Road, Suite T Phone: (410) 694-9401
 Hanover, Maryland 21076 Fax: (410) 694-9405
 www.bsylandinc.com

Z:\8_27401_POTOMAC HEIGHTS_SHORELINE_PEARCE\CAD FILES\ARCHIVE\2018-4-5 PERMIT SHEET FILES\8_27401-IPAD04.DWG

POTOMAC RIVER
FLOOD



PR. SAND FILL TRANSITION AREA
PR. 1,755 LF OF VENTED STONE SILL (TOTAL SITE)

PR. 10' VENT (TYP)
PR. 46,076 SF MARSH PLANTING (TOTAL SITE)

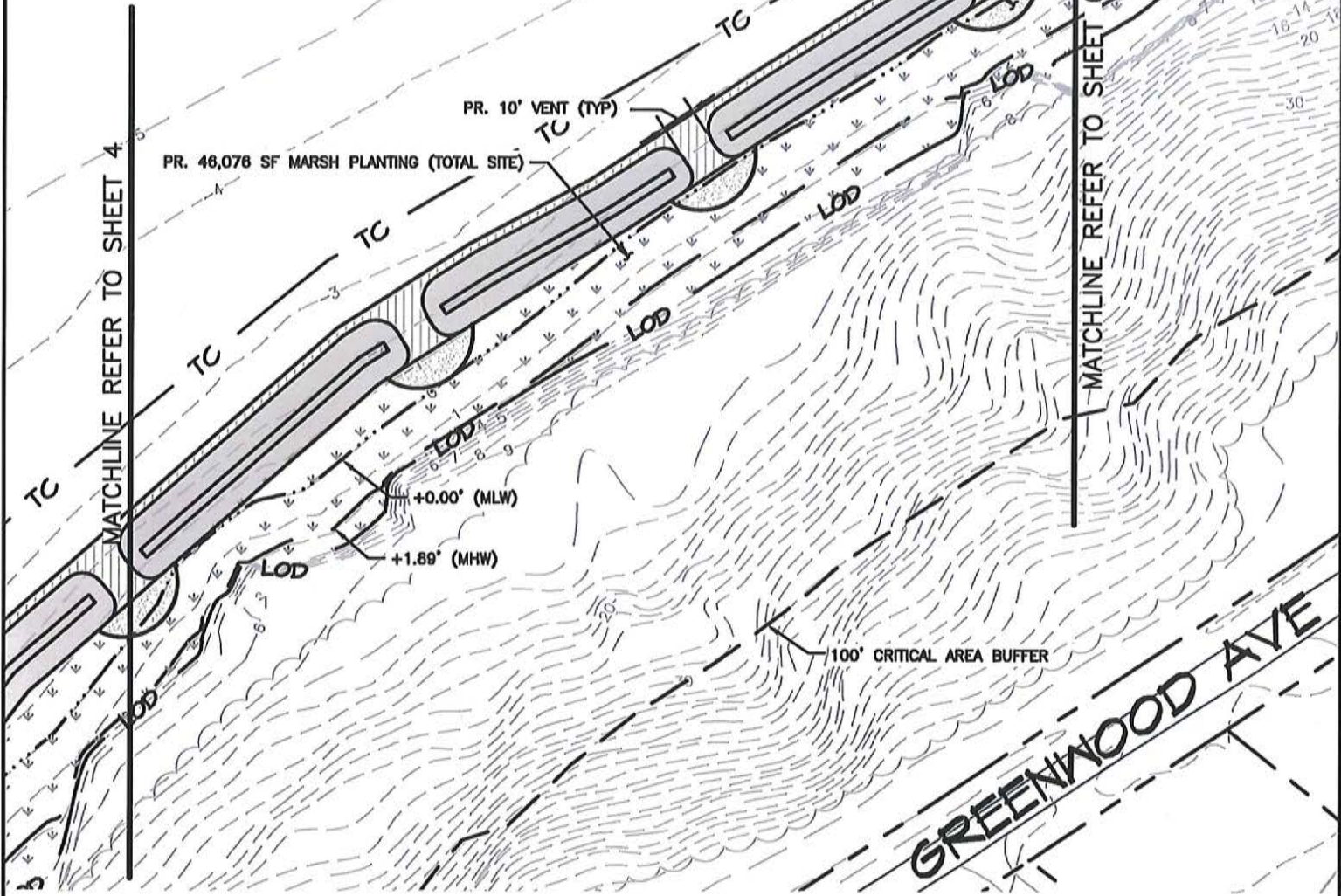

SHORELINE STABILIZATION
AT
POTOMAC HEIGHTS
CHARLES COUNTY, MD

APPL. BY: CHARLES COUNTY DEPARTMENT OF PUBLIC WORKS
1001 RADIO STATION RD
LA PLATA, MD 20646

SITE PLAN

DATE: May 2018 SHEET 5 OF 9

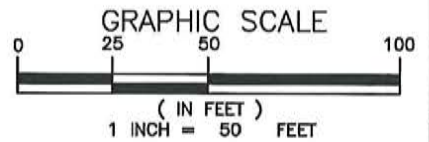

NOTE: THESE ARE PERMIT DRAWINGS ONLY. DESIGN DRAWINGS ARE TO BE PREPARED SEPARATELY.

Bay and
Consultants & Designers, Inc.
"Integrating Engineering and Environment"

7455 New Ridge Road, Suite T Phone: (410) 694-9401
Hanover, Maryland 21076 Fax: (410) 694-9405
www.baylandinc.com

Z:\8_27401_POTOMAC_HEIGHTS_SHORELINE_PEGS\CAD FILES\ARCHIVE\2018-4-5 PERMIT SHEET FILES\8_27401-PP05.DWG

POTOMAC RIVER

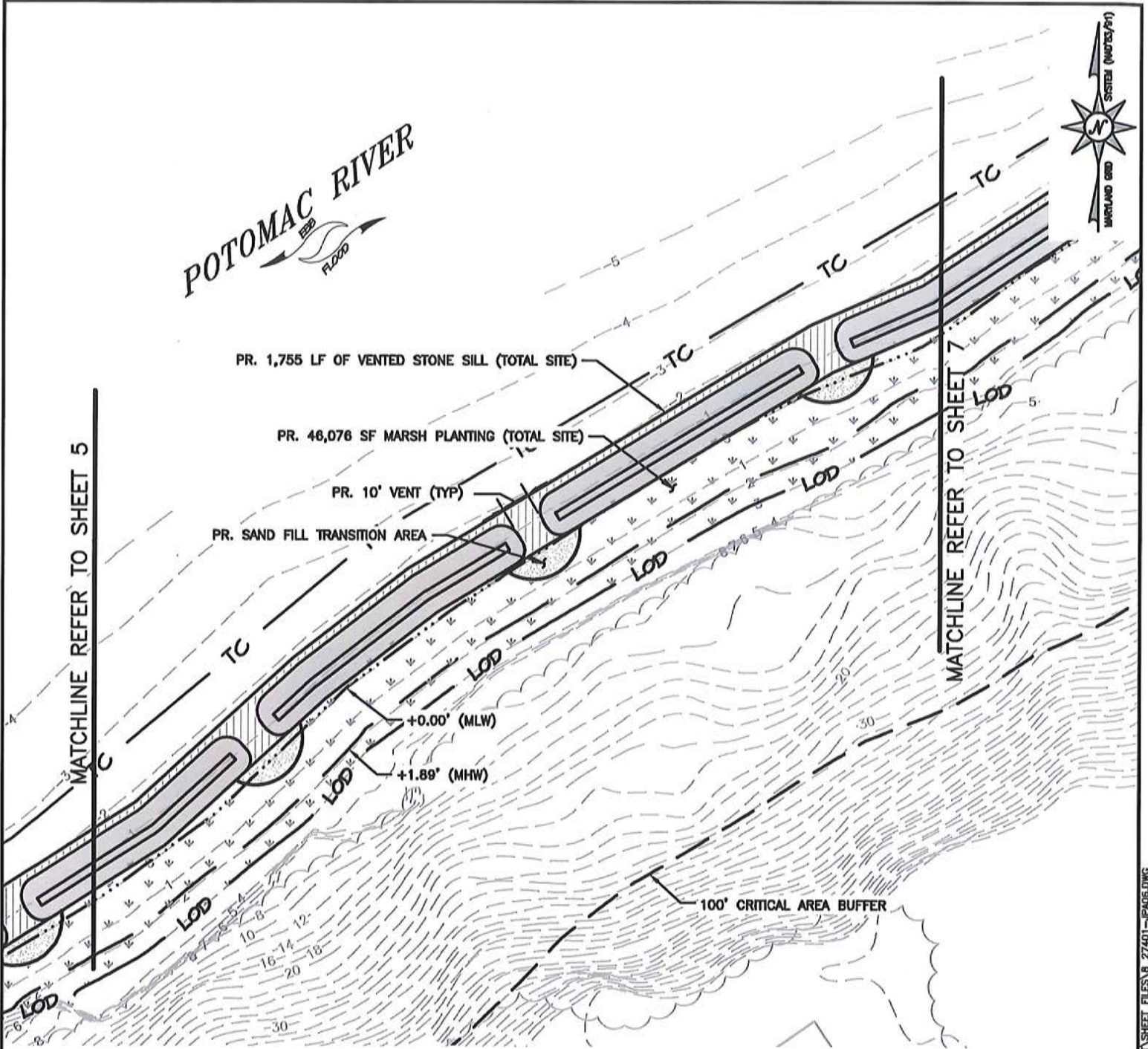

SHORELINE STABILIZATION AT POTOMAC HEIGHTS CHARLES COUNTY, MD

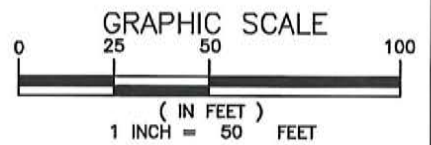

APPL. BY: CHARLES COUNTY DEPARTMENT OF PUBLIC WORKS
1001 RADIO STATION RD
LA PLATA, MD 20646

NOTE: THESE ARE PERMIT DRAWINGS
ONLY. DESIGN DRAWINGS ARE TO BE
PREPARED SEPARATELY.

SITE PLAN

DATE: May 2018 SHEET 6 OF 9

Bay and
Consultants & Designers, Inc.
"Integrating Engineering and Environment"

7455 New Ridge Road, Suite T Phone: (410) 694-9401
Hanover, Maryland 21076 Fax: (410) 694-9405
www.baylandinc.com

Z:\18_27401_POTOMAC HEIGHTS_SHORELINE_PEARDE\CAD FILES\ARCHIVE\2018-4-5 PERMIT SHEET FILES\18_27401-18A06.DWG



POTOMAC RIVER
FLOOD

PR. 1,755 LF OF VENTED STONE SILL (TOTAL SITE)

PR. SAND FILL TRANSITION AREA

PR. 46,076 SF MARSH PLANTING (TOTAL SITE)

PR. 10' VENT (TYP)

MATCHLINE REFER TO SHEET 6

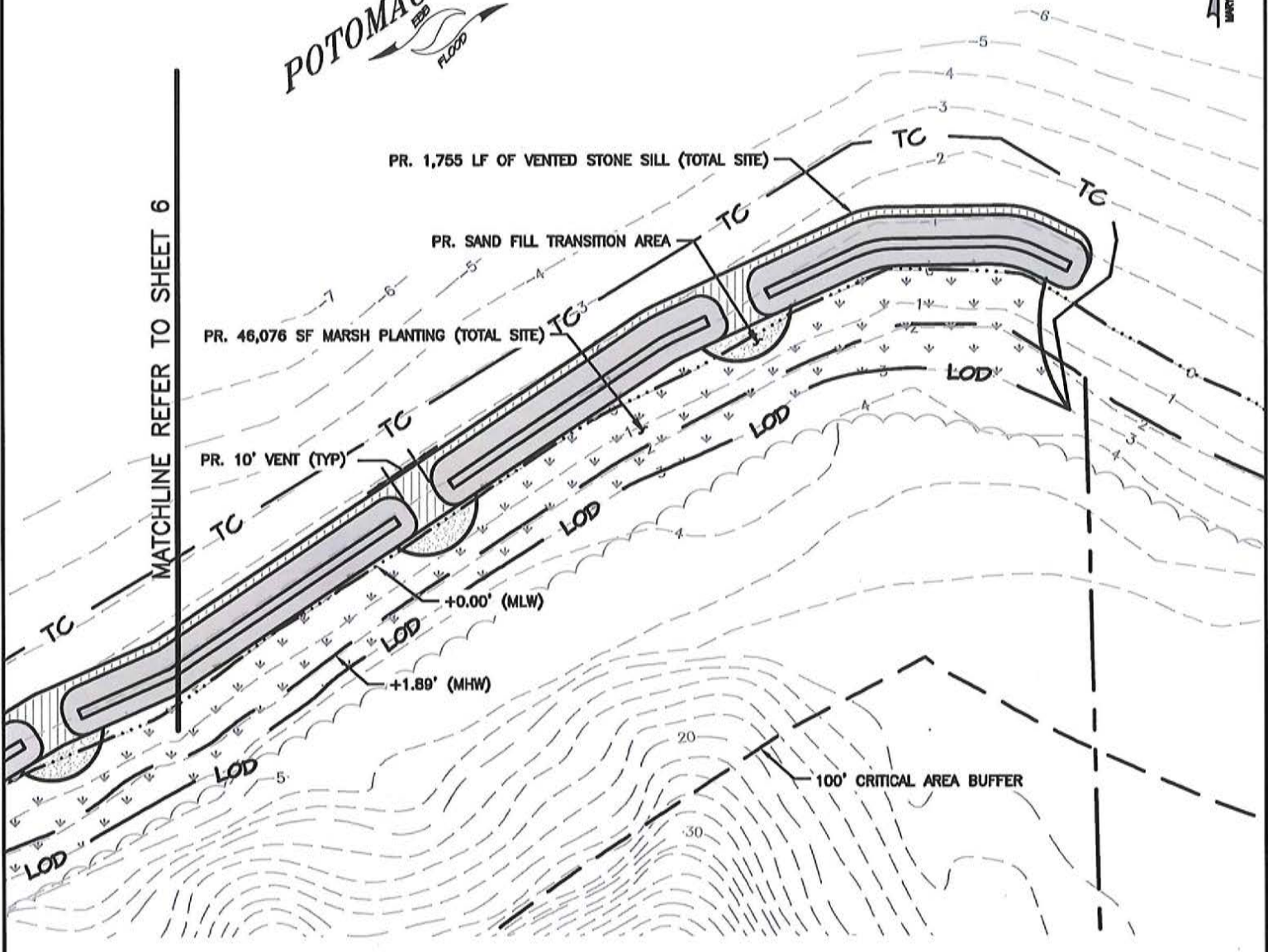

SHORELINE STABILIZATION
AT
POTOMAC HEIGHTS
CHARLES COUNTY, MD

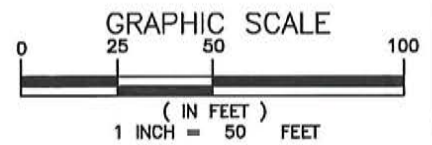

APPL. BY: CHARLES COUNTY DEPARTMENT OF PUBLIC WORKS
1001 RADIO STATION RD
LA PLATA, MD 20646

NOTE: THESE ARE PERMIT DRAWINGS ONLY. DESIGN DRAWINGS ARE TO BE PREPARED SEPARATELY.

SITE PLAN

DATE: May 2018 SHEET 7 OF 9

Bayland
Consultants & Designers, Inc.
"Integrating Engineering and Environment"
7455 New Ridge Road, Suite T Phone: (410) 694-9401
Hanover, Maryland 21076 Fax: (410) 694-9405
www.baylandinc.com

Z:\8_27401_POTOMAC HEIGHTS_SHORELINE_PEA\06\CAD FILES\SHEET FILES\8_27401-4P407.DWG

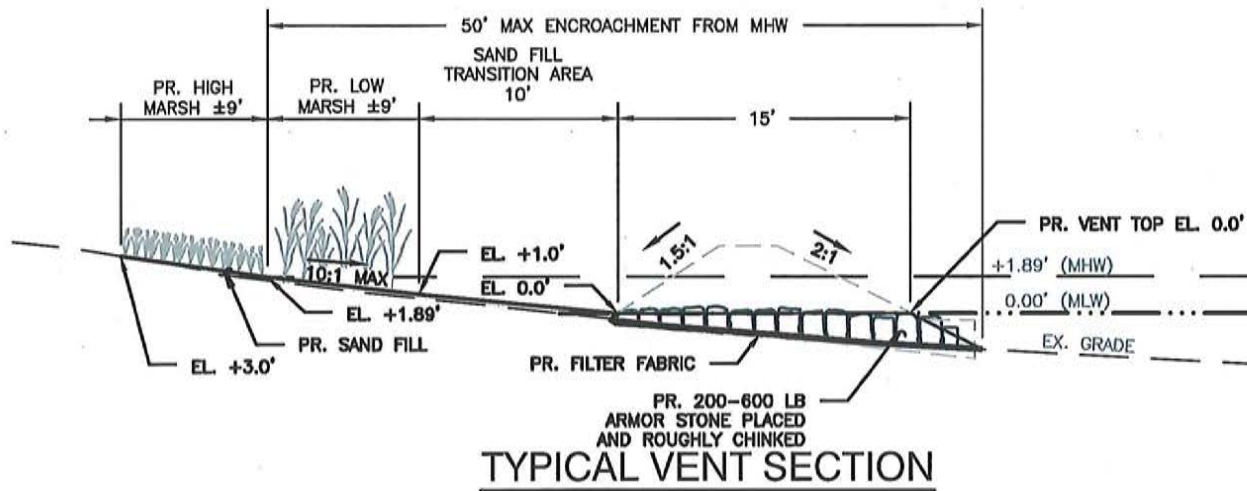

TYPICAL VENT SECTION

SCALE: 1"=10'

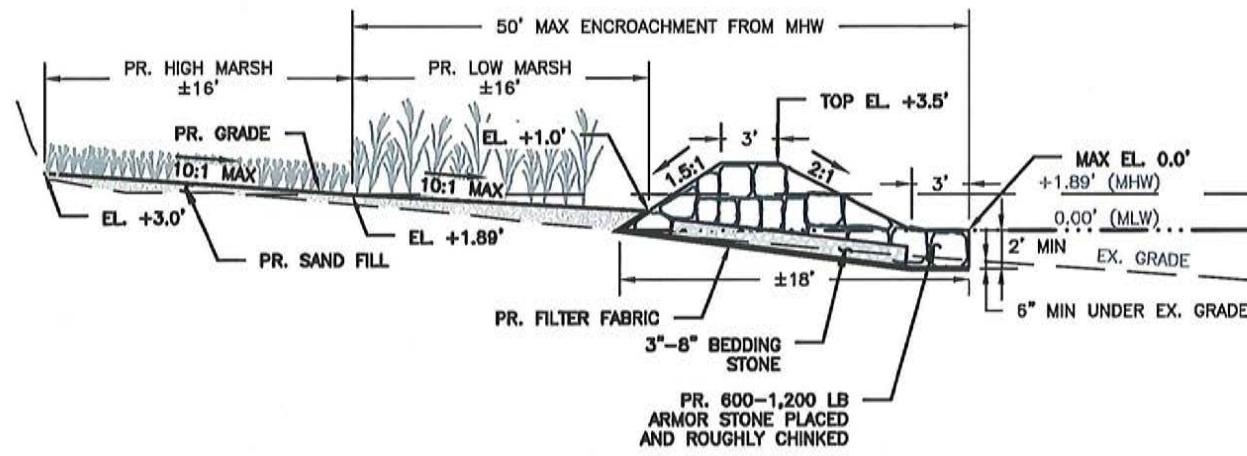

TYPICAL SILL SECTION

SCALE: 1"=10'

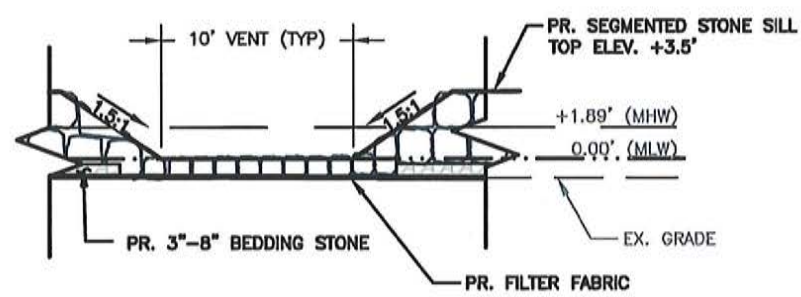

TYPICAL VENT DETAIL

SCALE: 1"=10'

**SHORELINE STABILIZATION
AT
POTOMAC HEIGHTS
CHARLES COUNTY, MD**

APPL. BY: CHARLES COUNTY DEPARTMENT OF PUBLIC WORKS
1001 RADIO STATION RD
LA PLATA, MD 20646

SECTIONS AND DETAILS

DATE: May 2018 SHEET 8 OF 9

NOTE: THESE ARE PERMIT DRAWINGS ONLY. DESIGN DRAWINGS ARE TO BE PREPARED SEPARATELY.

BayLand
Consultants & Designers, Inc.
"Integrating Engineering and Environment"

7455 New Ridge Road, Suite T Phone: (410) 694-9401
Hanover, Maryland 21076 Fax: (410) 694-9405
www.baylandinc.com

Z:\B_27401_POTOMAC HEIGHTS_SHORELINE_FEASD\CAD FILES\ARCHIVE\2018-4-5 PERMIT SHEET FILES\B_27401-JP\BOLDING