



Public Notice

U.S. Army Corps
of Engineers

Baltimore District

PN-15-29

In Reply to Application Number

CENAB-OPR-P-2009-00437 (Brushville Lake Dam Project)

Comment Period:

May 6, 2015 to June 5, 2015

THE PURPOSE OF THIS PUBLIC NOTICE IS TO SOLICIT COMMENTS FROM THE PUBLIC REGARDING THE WORK DESCRIBED BELOW. NO DECISION HAS BEEN MADE AS TO WHETHER OR NOT A PERMIT WILL BE ISSUED AT THIS TIME.

This District has received an application for a Department of the Army permit pursuant to Section 10 of the Rivers and Harbors Act of 1899 and/or Section 404 of the Clean Water Act (33 U.S.C. 1344) as described below:

APPLICANT: Mr. Jerrold A. Griffs
108 Mountain Pink Road
Bloomsburg Pennsylvania 17815

WATERWAY AND LOCATION OF THE PROPOSED WORK: Brushville Lake Dam is located in Brushville, Oakland Township, Susquehanna County, Pennsylvania, near the intersection of East Lake Road and Brushville Road. Brushville Lake is part of the Lewis Creek watershed.

PROPOSED WORK AND PURPOSE: In 2004, Brushville Lake Dam was washed out during a major storm event. The property owner, Mr. Jerrold Griffs, is proposing to reconstruct Brushville Lake Dam by installing/constructing: (1) an earthen dam with a clay core; (2) a reinforced concrete spillway; (3) a 24 inches x 36 inches concrete culvert box with gate valve; (4) rip rap protection; (5) multiple deep pool areas within the original impoundment area for the creation of aquatic habitat and a deep pool for diving; and (6) the creation of two islands within the lake area. The entire project site consists of approximately 23 acres.

The proposed project would have the following impacts:

Permanent Impacts:

1. Above the ordinary high water mark of Brushville Lake and within the construction Limit of Disturbance, as depicted on project plans, 2,800 square feet of uplands will be impacted for the reconstruction of the dam, which includes the concrete wing walls and concrete spillway. The concrete spillway is 40 feet long along the dam breast, 10 feet wide and extends 50 feet downstream. The emergency discharge is a 2 feet x 2 feet valve box.

2. Below the ordinary high water mark of Brushville Lake, 212,207 square feet of the lake bottom will be impacted by grading areas to create two islands and to make areas deeper for fish habitat.

3. 18,100 square feet of the impoundment area will be filled to create islands within the lake. The islands will be constructed to be uplands, and extend 2 feet above the water elevation of 1328 feet. An additional area approximately 137,000 square feet in size will be excavated to create areas deeper than the existing lake bottom elevation of 1325 feet. The purpose of the islands and deeper areas is to create additional areas for fish habitat.

Temporary Impacts:

1. Above the normal high water mark of Brushville Lake (uplands) and within the construction Limit of Disturbance, 37,660 square feet will be impacted during construction of the staging area and grading for the dam spillway. 34,860 square feet of this area will be restored to original condition, while 2,800 square feet will be the permanently impacted by the concrete wing walls and spillway.

Mitigation Statement: The following Mitigation Statement has been provided by the applicant: A general Erosion and Sediment Pollution Control Plan was developed for the Brushville Lake Dam Reconstruction Project to address and avoid impacts to the surrounding environment.

Approximately 18,100 square feet will be newly created islands in the lake, uplands, 2 feet above the water elevation of 1328 feet, while approximately 137,000 square feet will be dug out deeper than the existing lake bottom elevation of 1325 feet. The purpose of the islands and deeper areas is to create additional areas for fish habitat. By creating islands, the fish will have additional areas to hide and lay their eggs along the shore in between the gravel, as well as along the banks of the lake, so that the other fish will not eat the eggs. When they hatch, the fish are safer in the heavy warm water where the other fish are less likely to go and eat them. The deeper areas are not only cooler but more oxygen rich for the fish and the fish will be less likely to be eaten by other fish when in the deeper areas. By creating additional areas for the fish to lay eggs and be protected from the other fish in the lake, the fish population will grow and the lake will be balanced. The open water was always open water, no wetland studies were completed. All Erosion and Sediment Control Best Management Practices will be followed to avoid impacts to the surrounding environment when re-establishing the lake and dam. All work will occur within the Limit of Disturbance shown on the Plan and within the historic high water mark of Brushville Lake. No mitigation is proposed because the Owner is re-establishing the lake and dam with the goal of returning natural functions and characteristics inside the existing high water level. No negative environmental impacts are proposed during re-establishing the lake and dam because the work within the lake will be done prior to the construction of the dam, therefore, no water will be disturbed to cause unavoidable adverse effects to the existing surrounding habitat.

All work is proposed to be completed in accordance with the enclosed plan(s). If you have any questions concerning this matter, please contact Ms. Brittany Seguin at 814-235-1765, brittany.seguin@usace.army.mil, or State College Field Office, 1601 South Atherton Street, State College Pennsylvania 16801.

The decision whether to issue a permit will be based on an evaluation of the probable impacts, including cumulative impacts of the proposed activity on the public interest. That decision will reflect the national concern for both protection and utilization of important resources. The benefit, which reasonable may be expected to accrue from the proposal, must be balanced against its reasonably foreseeable detriments. All factors, which may be relevant to the proposal will be considered, including the cumulative effects thereof; among those are conservation, economic, aesthetics, general environmental concerns, wetlands, cultural values, fish and wildlife values, flood hazards, flood plain values, land use, navigation, shoreline erosion and accretion, recreation, water supply and conservation, water quality, energy needs, safety, food and fiber production, mineral needs, and consideration of property ownership and in general, the needs and welfare of the people.

The Corps of Engineers is soliciting comments from the public; Federal, State, and local agencies and officials; Indian Tribes; and other interested parties in order to consider and evaluate the impacts of this proposed activity. Any comments received will be considered by the Corps of Engineers to determine whether to issue, modify, condition or deny a permit for this proposal. To make this decision, comments are used to assess impacts on endangered species, historic properties, water quality, general environmental effects, and the other public interest factors listed above. Comments are used in the preparation of an Environmental Assessment and/or an Environmental Impact Statement pursuant to the National Environmental Policy Act. Comments provided will become part of the public record for this action. Comments are also used to determine the need for a public hearing and to determine the overall public interest of the proposed activity. Written comments concerning the work described above related to the factors listed above or other pertinent factors must be received by the District Engineer, U.S. Army Corps of Engineers, Baltimore District, ATTN: Ms Brittany Seguin, U.S. Army Corps of Engineers, Regulatory, 1601 S. Atherton Street, State College Pennsylvania 16801 within the comment period specified above.

ESSENTIAL FISH HABITAT: The Magnuson-Stevens Fishery Conservation and Management Act (MSFCMA), as amended by the Sustainable Fisheries Act of 1996 (Public Law 04-267), requires all Federal agencies to consult with the National Marine Fisheries Service (NMFS) on all actions, or proposed actions, permitted, funded, or undertaken by the agency that may adversely effect Essential Fish Habitat (EFH). The Corps has determined this project will not affect any EFH.

WATER QUALITY CERTIFICATION: The applicant is required to obtain a water quality certification in accordance with Section 401 of the Clean Water Act from the Pennsylvania Department of Environmental Protection. The Section 401 certifying agency has a statutory limit of one year from the date of this public notice to make its decision.

COASTAL ZONE MANAGEMENT PROGRAMS: Where applicable, the applicant has certified in this application that the proposed activity complies with and will be conducted in a manner consistent with the approved Coastal Zone Management (CZM) Program. By this public notice, we are requesting the State concurrence or objection to the applicant's consistency statement. It should be noted that the CZM Program has a statutory limit of 6 months to make its consistency determination.

The applicant must obtain any State or local government permits which may be required.

A preliminary review of this application indicates that the proposed work will not affect Federal listed threatened or endangered species or their critical habitat, pursuant to Section 7 of the Endangered Species Act, as amended. Additionally, a Pennsylvania Natural Diversity Review was performed on July 24, 2013 with the search resulting in no anticipated impacts to Federally listed threatened or endangered species. As the evaluation of this application continues, additional information may become available which could modify this preliminary determination.

Review of the latest published version of the National Register of Historic Places indicates that no registered properties listed as eligible for inclusion, therein, are located at the site of the proposed work. Additionally, the applicant coordinated with the Pennsylvania Historical and Museum Commission (PHMC), and in correspondence dated September 19, 2013, ER No. 13-2168-015-A, the PHMC determined that the project will have no effect on historic properties. Currently unknown archeological, scientific, prehistoric, or historical data may be lost or destroyed by the work to be accomplished under the request permit.

The evaluation of the impact of this project on the public interest will include application of the guidelines promulgated by the Administrator, U.S. Environmental Protection Agency, under authority of Section 404 of the Clean Water Act.

Any person who has an interest which may be adversely affected by the issuance of this permit may request a public hearing. The request, which must be in writing, must be received by the District Engineer, U.S. Army Corps of Engineers, Baltimore District, ATTN: Ms. Brittany Seguin, State College Field Office, 1601 South Atherton Street, State College, Pennsylvania 16801, within the comment period as specified above to receive consideration. Also, it must clearly set forth the interest which may be adversely affected by this activity and the manner in which the interest may be adversely affected.

It is requested that you communicate this information concerning the proposed work to any persons know by you to be interested and not being known to this office, who did not receive a copy of this notice.

Written comments concerning the work described above related to the factors listed above or other pertinent factors must be received within the comment period specified above to receive consideration. Please submit written comments to:

U.S. Army Corps of Engineers
Baltimore District
ATTN: Ms. Brittany Seguin
State College Field Office
1601 South Atherton Street,
State College, Pennsylvania 16801



Wade B. Chandler
Chief, Pennsylvania Section
Regulatory Branch

Enclosures

BRUSHVILLE LAKE
DAM RECONSTRUCTION PROJECT
OAKLAND TOWNSHIP - SUSQUEHANNA COUNTY - PENNSYLVANIA
LEWIS CREEK WATERSHED, PA DAM NO. D58-045, CLASS C LOW HAZARD PA DEP DESIGNATION

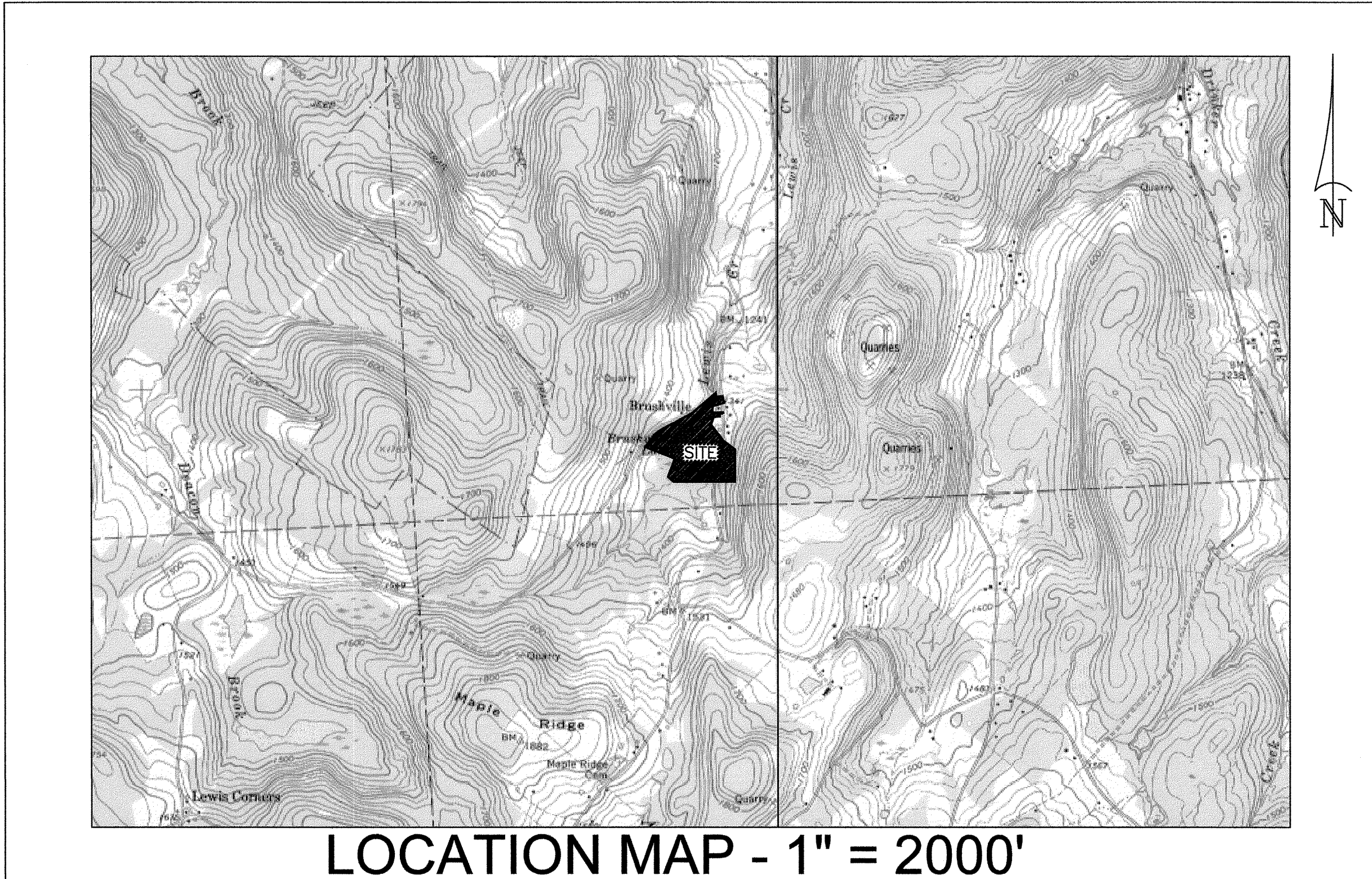

SHEET INDEX

COVER	
SHEET 1	NOTES
SHEET 2	SITE PLAN
SHEET 3	SITE PLAN
SHEET 4	CROSS SECTIONS
SHEET 5	CROSS SECTIONS
SHEET 6	DETAILS
SHEET 7	DETAILS
SHEET 8	SECTION THROUGH EARTHEN DAM

PREPARED FOR:
MR. JERROLD GRIFFIS
108 MOUNTAIN PINK ROAD
BLOOMSBURG, PA 17815
(570) 784-1525

PREPARED BY:
 **PETERS CONSULTANTS, INC.**

CONSULTING ENGINEERS AND LAND SURVEYORS

100 ROBBINS AVENUE
BERWICK, PA. 18603
(570) 752-4433

1023 MULBERRY STREET
BERWICK, PA 18603
(570) 752-7230

40 WEST MAIN STREET
BLOOMSBURG, PA. 17815
(570) 387-0334

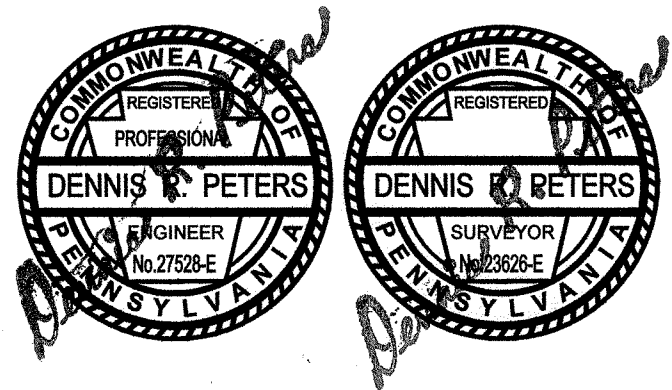

DATE: JULY 24, 2008
REVISED: OCTOBER 2, 2009

FILE NO. 2060

REGISTERED ENGINEER AND SURVEYOR

PETERS CONSULTANTS, INC.
DENNIS R. PETERS, P.E., P.L.S.
100 ROBBINS AVENUE
BERWICK, PA 18603
TELEPHONE: 570-752-4433
FAX: 570-752-4434
EMAIL: info1@petersconsultants.com

SURVEYOR'S CERTIFICATION

I HEREBY CERTIFY THAT THIS MAP AND SURVEY WERE PERFORMED IN ACCORDANCE WITH THE MINIMUM STANDARDS OF PRACTICE FOR PROFESSIONAL LAND SURVEYORS IN THE COMMONWEALTH OF PENNSYLVANIA AS ADOPTED BY THE PENNSYLVANIA SOCIETY OF LAND SURVEYORS.

Dennis R. Peters
DENNIS R. PETERS

P.L.S. NO. 23626-E

ENGINEER'S CERTIFICATION

I DENNIS R. PETERS DO HEREBY CERTIFY PURSUANT TO THE PENALTIES OF 18 PA. C.S.A., SECTION 4904 TO THE BEST OF MY KNOWLEDGE, INFORMATION AND BELIEF, THAT THE INFORMATION CONTAINED IN THE ACCOMPANYING PLANS, SPECIFICATIONS AND REPORTS HAS BEEN PREPARED IN ACCORDANCE WITH ACCEPTED ENGINEERING PRACTICE, IS TRUE AND CORRECT, AND IS IN CONFORMANCE WITH CHAPTER 105 OF THE RULES AND REGULATIONS OF THE DEPARTMENT OF ENVIRONMENTAL PROTECTION.

Dennis R. Peters
DENNIS R. PETERS

P.E. NO. 27528-E

ADA DISCLAIMER NOTE

THIS PERMIT AND/OR PLAN HAS NOT BEEN REVIEWED TO DETERMINE ITS COMPLIANCE WITH TITLE III OF THE AMERICANS WITH DISABILITIES ACT OF 1990 (ADA) WHICH PROHIBITS DISCRIMINATION ON THE BASIS OF DISABILITY IN PUBLIC ACCOMMODATIONS AND COMMERCIAL FACILITIES.

COMPLIANCE WITH TITLE III OF THIS ACT WITH REGARD TO THE PUBLIC ACCOMMODATIONS AND COMMERCIAL FACILITIES IS THE RESPONSIBILITY OF THE APPLICANT/DEVELOPER.

CONTOURS

CONTOUR LINES ARE PLOTTED FROM AN AERIAL SURVEY, COMPLETED BY AEROCON PHOTOGRAMMETRIC SERVICES, INC. 4515 GLENBROOK RD, WILLOUGHBY, OHIO 44094 (440) 946-6277 ON 4/24/07.

FLOODPLAIN

AS PER COMMUNITY-PANEL 422581 0005A EFFECTIVE DATE 10/15/1980 FOR OAKLAND TOWNSHIP, SUSQUEHANNA COUNTY, PENNSYLVANIA, THE EXISTING PROPERTY IS LOCATED IN ZONE "C"- AREAS OF MINIMAL FLOODING.

WETLAND NOTICE

NO SITE EVALUATION FOR WETLAND INTRUSION HAS BEEN PERFORMED BY PETERS CONSULTANTS, INC. OR ANY EMPLOYEE OF PETERS CONSULTANTS, INC. NO CERTIFICATION FOR THE PRESENCE OF WETLANDS IS GIVEN BY PETERS CONSULTANTS, INC., OR ANY EMPLOYEE OF PETERS CONSULTANTS, INC., AND THE SAME SHALL NOT BE IMPLIED.

OWNER

JERROLD GRIFFIS
108 MOUNTAIN PINK ROAD
BLOOMSBURG, PA 17815
(570) 784-1525

SOIL CLASSIFICATION

SOIL BOUNDARIES ARE PLOTTED FROM THE PENN STATE COLLEGE OF AGRICULTURAL SCIENCES COOPERATIVE EXTENSION WEBSITE www.soilmap.psu.edu

MqF	MARDIN VERY STONY SILT LOAM, 25-50 PERCENT SLOPES
MH	MIXED ALLUVIAL LAND, 0-8 PERCENT SLOPES
VcB2	VOLUSIA CHANNERY SILT LOAM, 3-8 PERCENT SLOPES
VcC2	VOLUSIA CHANNERY SILT LOAM, 8-15 PERCENT SLOPES
VfB	VOLUSIA FLAGGY SILT LOAM, 3-8 PERCENT SLOPES
VfD	VOLUSIA FLAGGY SILT LOAM, 15-25 PERCENT SLOPES
VsB	VOLUSIA VERY STONY SILT LOAM, 0-8 PERCENT SLOPES
VsD	VOLUSIA VERY STONY SILT LOAM, 8-25 PERCENT SLOPES
WsD	WELLSBORO VERY STONY SILT LOAM, 8-25 PERCENT SLOPES

SOIL BORING

SOIL BORING TESTS COMPLETED BY
POCONO TEST BORINGS & DRILLING COMPANY, INC.
251 ANDIA LAKE TRAIL
WHITE HAVEN, PA 18661
(570) 472-3268

CONSTRUCTION SEQUENCE

AT LEAST 7 DAYS BEFORE STARTING ANY EARTH DISTURBANCE ACTIVITIES, THE OPERATOR SHALL INVITE ALL CONTRACTORS INVOLVED IN THOSE ACTIVITIES, ALL APPROPRIATE MUNICIPAL OFFICIALS, THE EROSION AND SEDIMENT CONTROL PLAN PREPARER, AND THE SUSQUEHANNA CONSERVATION DISTRICT TO AN ON-SITE MEETING. ALSO, AT LEAST 3 DAYS BEFORE STARTING ANY EARTH DISTURBANCE ACTIVITIES, ALL CONTRACTORS INVOLVED IN THOSE ACTIVITIES SHALL NOTIFY THE PENNSYLVANIA ONE CALL SYSTEM INCORPORATED AT 1-800-242-1776 FOR BURIED UTILITY LOCATIONS. THE SEQUENCE OF BMP INSTALLATION AND REMOVAL OF TEMPORARY BMP'S SHOULD BE FOLLOWED AS LISTED. THE SEQUENCE OF BMP INSTALLATION REQUIRES THE INSTALLATION OF EACH BMP BEFORE THE BMP IS NEEDED, EXCEPT IN CERTAIN CASES (I.E. FILTER FABRIC FENCE THAT HAS BEEN UNDERMINED OR TOPPED MUST BE IMMEDIATELY REPLACED WITH A ROCK FILTER OUTLET).

1. INSTALL ORANGE SAFTEY/BARRIER FENCE AT THE LIMIT OF DISTURBANCE LINE TO ASSURE THAT AREAS OUTSIDE THE LIMITS REMAIN UNDISTURBED DURING CONSTRUCTION.
2. CONSTRUCT AND STABILIZE ROCK CONSTRUCTION ENTRANCE.
3. INSTALL FILTER FABRIC SILT FENCE AS SHOWN ON THE PLANS AT EACH SECTION PROPOSED TO BE DISTURBED BEFORE GRADING AND EARTH DISTURBANCE.
4. CLEAR AND GRUB EXISTING MATERIAL FROM THE PROPOSED DISTURBED AREAS.
5. ANY AREA WITHIN THE LIMIT OF DISTURBANCE MAY BE USED AS A TEMPORARY STOCKPILE AREA, PLACE FILTER FABRIC FENCE ALONG THE CONTOUR DOWNHILL FROM THE STOCKPILE.
6. BEGIN GRADING OF THE SITE.
7. BYPASS PUMP THE STREAM FLOW PAST THE AREAS PROPOSED FOR THE INSTALLATION OF THE 24" X 36" CONCRETE BOX CULVERT. STABILIZE THE BYPASS PUMPING OUTFALL WITH RS RIPRAP PROTECTION.
8. INSTALL THE 24" X 36" CONCRETE BOX CULVERT, GATE VALVE WHEEL ASSEMBLY, CLAY CORE, EARTHEN DAM, UPSTREAM AND DOWNSTREAM EARTHEN EMBANKMENT, GEOTEXTILE LINER AND RIPRAP PROTECTION, INSTALL THE REINFORCED CONCRETE SPILLWAY, CONCRETE CUTOFF WALL AND CONCRETE WING WALLS. AFTER STABILIZATION, OPERATE THE PROPOSED INSTALLATION SO THAT WATER DOES NOT POOL IN THE LAKE UNTIL REMAINING WORK IS COMPLETED.
9. INSTALL FILTER FABRIC FENCE AT THE DOWNSTREAM LIMITS OF ALL DISTURBED AREAS.
10. GRADE EACH AREA PROPOSED TO BE EMBANKMENT AT THE EDGE OF THE PROPOSED LAKE, AT EACH DEEP POOL AREA PROPOSED FOR AQUATIC LIFE HABITAT, AT THE POOL AREA PROPOSED FOR THE DIVING BOARD AND ALL OTHER PROPOSED GRADING AREAS.
11. PERMANENTLY STABILIZE ALL DISTURBED AREAS WITH SEED AND MULCH.
12. IMMEDIATELY AFTER FINAL GRADE IS REACHED, STABILIZE EXPOSED GROUND WITH TOPSOIL, FERTILIZER, SEED AND MULCH.
13. WHEN PERMANENT STABILIZATION OF ALL DISTURBED AREAS IS COMPLETE, REMOVE ALL TEMPORARY CONTROL MEASURES. PERMANENT STABILIZATION SHALL BE DEFINED AS THE POINT IN TIME WHERE ALL PERMANENT CONTROL MEASURES ARE COMPLETED AND OPERATIONAL, AND A UNIFORM VEGETATIVE COVER OR DENSITY OF 70% IS ACHIEVED ACROSS THE DISTURBED AREAS. THE ONSITE CONTRACTOR IS RESPONSIBLE FOR THE REMOVAL OF ALL TEMPORARY BMP'S AND THE INSTALLATION OR PLACEMENT OF ALL PERMANENT BMP'S.
14. REGULATE THE GATE VALVE WHEEL ASSEMBLY TO ALLOW THE LAKE TO SLOWLY FILL TO PROPOSED ELEVATION WHILE AT THE SAME TIME ALLOWING FLOW IN THE EXISTING STREAM TO BE AT LEAST 80% OF THE NORMAL FLOW.
15. INSTALL DAM ADVISORY SIGNS AND PLACARDS PER PADEP REGULATIONS AND REMOVE ALL ORANGE SAFETY FENCING.
16. MONITOR ALL DISTURBED AREAS FOR FINAL STABILIZATION AND CORRECT AS NECESSARY.

SOIL STABILIZATION REQUIREMENTS

MULCH MATERIALS SHALL BE UNROTTED SALT HAY OR SMALL GRAIN STRAW, SPREAD UNIFORMLY. MULCH SHALL BE APPLIED IN LONG STRANDS, NOT CHOPPED, OR FINELY BROKEN.

ALL DISTURBED SLOPES AT GRADES FLATTER THAN 3:1 SHALL BE PERMANENTLY STABILIZED AS PER THE SEEDING SPECIFICATIONS ON SHEET 6 OF 6.

ALL DISTURBED SLOPES AT A GRADES OF 3:1 AND STEEPER SHALL BE STABILIZED AS PER THE SEEDING SPECIFICATIONS ON SHEET 6 OF 6. MULCH SHALL BE REPLACED WITH AN EROSION CONTROL BLANKET, TYPE SC150 AS MADE BY NORTH AMERICAN GREEN, OR EQUIVALENT.

EROSION AND SEDIMENTATION CONTROL NOTES

1. THE CONTRACTOR SHALL ASSURE THAT THE APPROVED EROSION AND SEDIMENT POLLUTION CONTROL PLAN IS PROPERLY AND COMPLETELY IMPLEMENTED. A COPY OF THE APPROVED EROSION AND SEDIMENT POLLUTION CONTROL PLAN SHALL BE AVAILABLE AT THE PROJECT SITE AT ALL TIMES.

2. IMMEDIATELY UPON DISCOVERING UNFORESEEN CIRCUMSTANCES POSING THE POTENTIAL FOR ACCELERATED EROSION AND/OR SEDIMENT POLLUTION, THE CONTRACTOR SHALL IMPLEMENT THE APPROPRIATE BEST MANAGEMENT PRACTICES TO ELIMINATE THE POTENTIAL FOR ACCELERATED EROSION AND/OR SEDIMENT POLLUTION.

3. BEFORE INITIATING ANY REVISIONS TO THE APPROVED EROSION AND SEDIMENT POLLUTION CONTROL PLAN OR REVISIONS TO OTHER PLANS THAT MAY AFFECT THE EFFECTIVENESS OF THE APPROVED EROSION AND SEDIMENT POLLUTION CONTROL PLAN, THE CONTRACTOR MUST RECEIVE APPROVAL OF THE PLAN REVISIONS FROM THE SUSQUEHANNA COUNTY CONSERVATION DISTRICT.

4. PRIOR TO THE START OF OPERATIONS AT ANY SPOIL, BORROW OR OTHER WORK AREA NOT DETAILED ON THE APPROVED EROSION AND SEDIMENT POLLUTION CONTROL PLAN, WHETHER LOCATED WITHIN OR OUTSIDE OF THE INDICATED CONSTRUCTION LIMITS, THE PERMITTEE OR CO-PERMITTEE SHALL DEVELOP AND HAVE APPROVED BY THE OWNER AND THE SUSQUEHANNA COUNTY CONSERVATION DISTRICT, AS REQUIRED BY TITLE 25, CHAPTER 102, A SEPARATE EROSION AND SEDIMENT POLLUTION CONTROL PLAN FOR EACH SITE.

5. THE CONTRACTOR IS ADVISED TO BECOME THOROUGHLY FAMILIAR WITH THE PROVISIONS OF APPENDIX 64, EROSION CONTROL RULES AND REGULATIONS, TITLE 25, PART 1, DEPARTMENT OF ENVIRONMENTAL PROTECTION, SUBPART C, PROTECTION OF NATURAL RESOURCES, ARTICLE III, WATER RESOURCES, CHAPTER 102, EROSION CONTROL.

6. AN AREA SHALL BE CONSIDERED TO HAVE ACHIEVED FINAL STABILIZATION WHEN IT HAS A MINIMUM UNIFORM 70% PERENNIAL VEGETATIVE COVER OR OTHER PERMANENT NON-VEGETATIVE COVER WITH A DENSITY SUFFICIENT TO RESIST ACCELERATED SURFACE EROSION AND SUBSURFACE CHARACTERISTICS SUFFICIENT TO RESIST SLIDING AND OTHER MOVEMENTS.

7. IMMEDIATELY AFTER EARTH DISTURBANCE ACTIVITIES CEASE, THE CONTRACTOR SHALL STABILIZE ANY AREAS DISTURBED BY THE ACTIVITIES. DURING NON-GERMINATING PERIODS, MULCH MUST BE APPLIED AT THE SPECIFIED RATES. AT SLOPES OF 3:1 OR GREATER, AND EROSION CONTROL BLANKET, TYPE SC150 AS MADE BY NORTH AMERICAN GREEN, OR EQUIVALENT MUST BE APPLIED. DISTURBED AREAS WHICH ARE NOT AT FINISHED GRADE AND WHICH WILL BE REDISTURBED WITHIN 1 YEAR MUST BE STABILIZED IN ACCORDANCE WITH THE TEMPORARY VEGETATIVE STABILIZATION SPECIFICATIONS. DISTURBED AREAS WHICH ARE AT FINISHED GRADE OR WHICH WILL NOT BE REDISTURBED WITHIN 1 YEAR MUST BE STABILIZED IN ACCORDANCE WITH THE PERMANENT VEGETATIVE STABILIZATION SPECIFICATIONS.

8. ALL PUMPING OF SEDIMENT LADEN WATER SHALL BE THROUGH A WATER FILTER BAG, DISCHARGING OVER NON-DISTURBED AREAS. DEWATERING FACILITIES SHALL BE AT THE CONTRACTORS DISCRETION, SUBJECT TO THE SUSQUEHANNA COUNTY CONSERVATION DISTRICT REQUIREMENTS.

9. EROSION AND SEDIMENT POLLUTION CONTROL BMPS SHALL BE CONSTRUCTED, STABILIZED, AND FUNCTIONAL BEFORE SITE DISTURBANCE BEGINS WITHIN THE TRIBUTARY AREAS OF THOSE BMPS.

10. ALL AREAS WITH SLOPES IN EXCESS OF 3:1 SHALL BE PROTECTED FROM ACCELERATED SOIL EROSION BY EROSION CONTROL MATTING IMMEDIATELY AFTER THE COMPLETION OF GRADING ACTIVITIES EACH DAY.

11. ANY HAZARDOUS MATERIALS AS DEFINED BY, FEDERAL, STATE, OR LOCAL GUIDELINES, LAWS AND/OR REGULATIONS SHALL BE DISPOSED OF IN ACCORDANCE WITH ALL APPLICABLE REGULATIONS.

12. ALL MATERIALS, WHETHER NATURAL OR SYNTHETIC, SHALL BE DISPOSED OF IN ACCORDANCE WITH THE PA DEP SOLID WASTE REGULATIONS AT 25 PA CODE 260.1 ET SEQ., 271.1 ET SEQ., AND 287.1 ET SEQ. AND ANY OTHER APPROPRIATE LOCAL, STATE, OR FEDERAL CODE, REGULATION OR LAW. ALL SOIL REMOVED FROM THIS SITE MUST BE DISPOSED OF AT A SITE WITH AN APPROVED EROSION AND SEDIMENT POLLUTION CONTROL PLAN. THE CONTRACTOR SHALL NOT ILLEGALLY BURY, DUMP, OR DISCHARGE ANY BUILDING MATERIALS OR WASTES.

NOTE

SHEETS 1-8 OF 8 MUST BE READ TOGETHER AND ARE TO BE CONSIDERED ONE INTEGRAL PLAN

DATE	REVISIONS	BY
10/2/09	REVISED CONSTRUCTION SEQUENCE	JAB

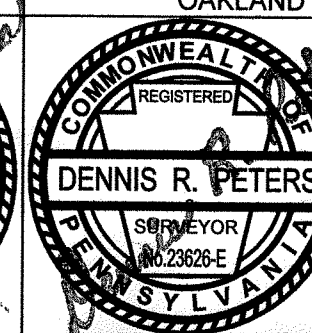
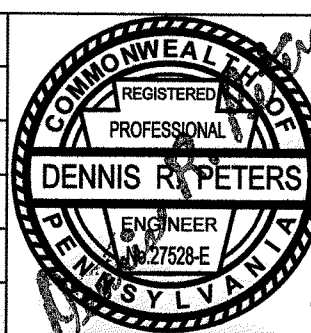

BRUSHVILLE LAKE

DAM RECONSTRUCTION PROJECT

PREPARED FOR

JERROLD GRIFFIS

NOTES

OAKLAND TOWNSHIP - SUSQUEHANNA COUNTY - PENNSYLVANIA

PETERS CONSULTANTS, INC.

CONSULTING ENGINEERS & SURVEYORS

info1@petersconsultants.com - www.petersconsultants.com

100 Robbins Avenue Berwick, Pa. 18603 1023 Mulberry Street Berwick, Pa. 18603 29 East Main Street Bloomsburg, Pa. 17815

Scale: NONE Dwn By: JAB File No.: 2060

Date: 7/24/08 Ck. By: DRP Sheet 1 of 8



PENNSYLVANIA ACT 172 AS AMENDED REQUIRES NOTIFICATION OF EXCAVATORS, DESIGNERS, OR ANY PERSON PREPARING TO DISTURB THE EARTH'S SURFACE ANYWHERE IN THE COMMONWEALTH.

COPYRIGHT PETERS CONSULTANTS, INC. 2009. THESE PLANS ARE INSTRUMENTS OF SERVICE AND REMAIN THE EXCLUSIVE PROPERTY OF PETERS CONSULTANTS, INC. THE CLIENT IS GRANTED A NON-EXCLUSIVE LICENSE TO USE THE PLANS SOLELY TO CONSTRUCT THE PROJECT DEPICTED ON THE PLANS. THE PLANS MAY NOT BE MODIFIED IN ANY WAY AND MAY NOT BE USED FOR SUBSEQUENT ADDITIONS, RENOVATIONS, MODIFICATIONS, OR ALTERATIONS TO THE PROJECT WITHOUT THE EXPRESS WRITTEN CONSENT OF PETERS CONSULTANTS, INC. PETERS CONSULTANTS, INC. ASSUMES NO LIABILITY FOR USE OF THE PLANS BEYOND THE NON-EXCLUSIVE LICENSE GRANTED HEREIN.

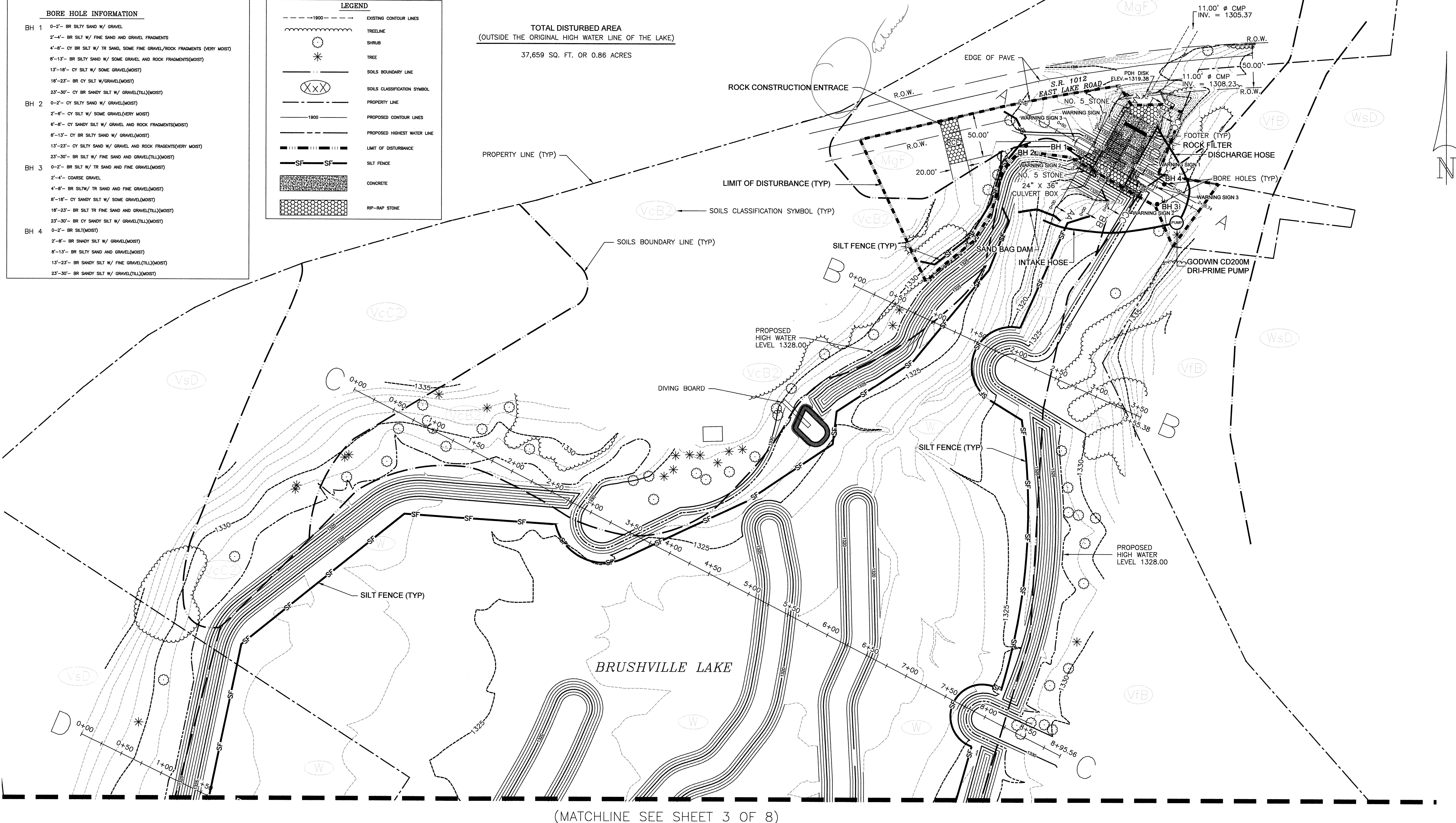

BORE HOLE INFORMATION	
BH 1	0'-2'- BR SILTY SAND W/ GRAVEL 2'-4'- BR SILTY W/ FINE SAND AND GRAVEL FRAGMENTS 4'-8'- CY BR SILT W/ TR SAND, SOME FINE GRAVEL/ROCK FRAGMENTS (VERY MOIST) 8'-13'- BR SILTY SAND W/ SOME GRAVEL AND ROCK FRAGMENTS(MOIST) 13'-18'- CY SILT W/ SOME GRAVEL(MOIST) 18'-23'- BR CY SILT W/GRAVEL(MOIST) 23'-30'- CY BR SANDY SILT W/ GRAVEL(TLL)(MOIST)
BH 2	0'-2'- CY SILTY SAND W/ GRAVEL(MOIST) 2'-6'- CY SILT W/ SOME GRAVEL(VERY MOIST) 6'-8'- CY SANDY SILT W/ GRAVEL AND ROCK FRAGMENTS(MOIST) 8'-13'- CY BR SILTY SAND W/ GRAVEL(MOIST) 13'-23'- BR SILT TR FINE SAND AND GRAVEL(TLL)(MOIST) 23'-30'- BR SILT W/ FINE SAND AND GRAVEL(TLL)(MOIST)
BH 3	0'-2'- BR SILT W/ TR SAND AND FINE GRAVEL(MOIST) 2'-4'- COARSE GRAVEL 4'-8'- BR SILTY/ TR SAND AND FINE GRAVEL(MOIST) 8'-18'- CY SANDY SILT W/ SOME GRAVEL(MOIST) 18'-23'- BR SILT TR FINE SAND AND GRAVEL(TLL)(MOIST) 23'-30'- BR CY SANDY SILT W/ GRAVEL(TLL)(MOIST)
BH 4	0'-2'- BR SILT(MOIST) 2'-8'- BR SANDY SILT W/ GRAVEL(MOIST) 8'-13'- BR SILTY SAND AND GRAVEL(MOIST) 13'-23'- BR SANDY SILT W/ FINE GRAVEL(TLL)(MOIST) 23'-30'- BR SANDY SILT W/ GRAVEL(TLL)(MOIST)

LEGEND	
	EXISTING CONTOUR LINES
	TREELINE
	SHRUB
	TREE
	SOILS BOUNDARY LINE
	SOILS CLASSIFICATION SYMBOL
	PROPERTY LINE
	PROPOSED CONTOUR LINES
	PROPOSED HIGHEST WATER LINE
	LIMIT OF DISTURBANCE
	SILT FENCE
	CONCRETE
	RIP-RAP STONE

TOTAL DISTURBED AREA
(OUTSIDE THE ORIGINAL HIGH WATER LINE OF THE LAKE)
37,659 SQ. FT. OR 0.86 ACRES

PROJECT 2008 - DRAWING 2008-GRAND-5.dwg - LAYOUT: SHEET 1

COPYRIGHT PETERS CONSULTANTS, INC. 2008. THESE PLANS ARE INSTRUMENTS OF SERVICE AND REMAIN THE EXCLUSIVE PROPERTY OF PETERS CONSULTANTS, INC. THE CLIENT IS GRANTED A NON-EXCLUSIVE LICENSE TO USE THE PLANS SOLELY TO CONSTRUCT THE PROJECT DEPICTED ON THE PLANS. THE PLANS MAY NOT BE MODIFIED IN ANY WAY AND MAY NOT BE USED FOR SUBSEQUENT ADDITIONS, RENOVATIONS, MODIFICATIONS, OR ALTERATIONS TO THE PROJECT WITHOUT THE EXPRESS WRITTEN CONSENT OF PETERS CONSULTANTS, INC. PETERS CONSULTANTS, INC. ASSUMES NO LIABILITY FOR USE OF THE PLANS BEYOND THE NON-EXCLUSIVE LICENSE GRANTED HEREIN.

PENNSYLVANIA ACT 172 AS AMENDED REQUIRES NOTIFICATION OF EXCAVATORS, DESIGNERS, OR ANY PERSON PREPARING TO DISTURB THE EARTH'S SURFACE ANYWHERE IN THE COMMONWEALTH.

50 25 0 50 100 150
HORIZONTAL SCALE
1 INCH = 50 FEET

NOTE
SHEETS 1-8 OF 8 MUST BE READ TOGETHER
AND ARE TO BE CONSIDERED ONE INTEGRAL PLAN

DATE	REVISIONS	BY
10/2/09	REVISED E & S PLAN	JAB

**BRUSHVILLE LAKE
DAM RECONSTRUCTION PROJECT**
PREPARED FOR
**JERROLD GRIFFIS
SITE PLAN**
OAKLAND TOWNSHIP - SUSQUEHANNA COUNTY - PENNSYLVANIA

PETERS CONSULTANTS, INC.
CONSULTING ENGINEERS & SURVEYORS
E-MAIL: info1@petersconsultants.com
www.petersconsultants.com

100 Robbins Avenue Berwick, Pa. 18603
1023 Mulberry Street Berwick, Pa. 18603
29 East Main Street Bloomsburg, Pa. 17815

Scale: 1" = 50' Dwn By: JAB File No.: 2060
Date: 7/24/08 Ck. By: DRP Sheet 2 of 8

(MATCHLINE SEE SHEET 2 OF 8)

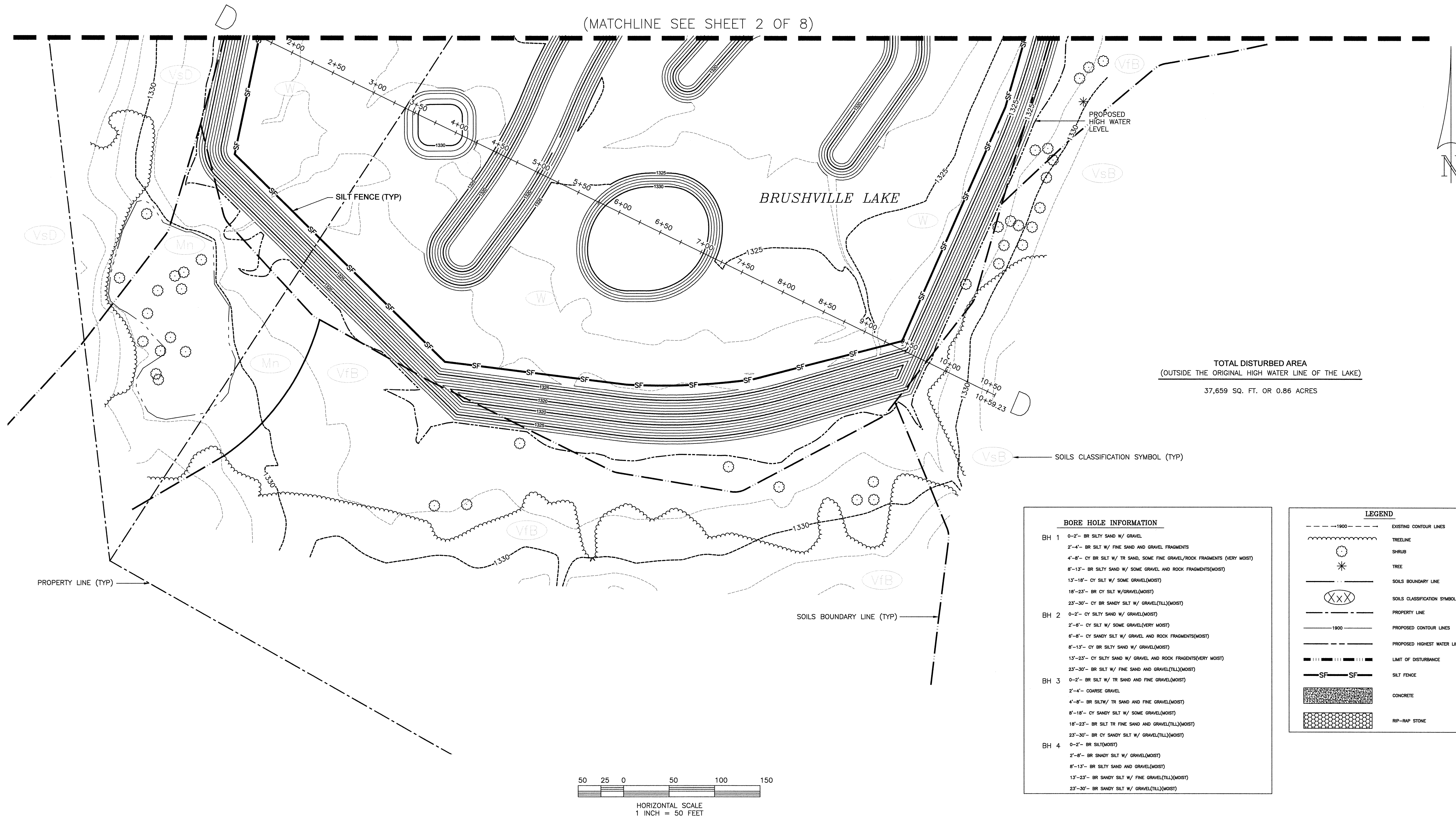

TOTAL DISTURBED AREA
(OUTSIDE THE ORIGINAL HIGH WATER LINE OF THE LAKE)
37,659 SQ. FT. OR 0.86 ACRES

BORE HOLE INFORMATION

- BH 1
0'-2'- BR SILTY SAND W/ GRAVEL
2'-4'- BR SILT W/ FINE SAND AND GRAVEL FRAGMENTS
4'-8'- CY BR SILT W/ TR SAND, SOME FINE GRAVEL/ROCK FRAGMENTS (VERY MOIST)
8'-13'- BR SILTY SAND W/ SOME GRAVEL AND ROCK FRAGMENTS(MOIST)
13'-18'- CY SILT W/ SOME GRAVEL(MOIST)
18'-23'- BR CY SILT W/GRAVEL(MOIST)
23'-30'- CY BR SANDY SILT W/ GRAVEL(TLL)(MOIST)
- BH 2
0'-2'- CY SILTY SAND W/ GRAVEL(MOIST)
2'-8'- CY SILT W/ SOME GRAVEL(VERY MOIST)
8'-8'- CY SANDY SILT W/ GRAVEL AND ROCK FRAGMENTS(MOIST)
8'-13'- CY BR SILTY SAND W/ GRAVEL(MOIST)
13'-23'- CY SILTY SAND W/ GRAVEL AND ROCK FRAGMENTS(VERY MOIST)
23'-30'- BR SILT W/ FINE SAND AND GRAVEL(TLL)(MOIST)
- BH 3
0'-2'- BR SILT W/ TR SAND AND FINE GRAVEL(MOIST)
2'-4'- COARSE GRAVEL
4'-8'- BR SILT/ TR SAND AND FINE GRAVEL(MOIST)
8'-18'- CY SANDY SILT W/ SOME GRAVEL(MOIST)
18'-23'- BR SILT TR FINE SAND AND GRAVEL(TLL)(MOIST)
23'-30'- BR CY SANDY SILT W/ GRAVEL(TLL)(MOIST)
- BH 4
0'-2'- BR SILT(MOIST)
2'-8'- BR SANDY SILT W/ GRAVEL(MOIST)
8'-13'- BR SILTY SAND AND GRAVEL(MOIST)
13'-23'- BR SANDY SILT W/ FINE GRAVEL(TLL)(MOIST)
23'-30'- BR SANDY SILT W/ GRAVEL(TLL)(MOIST)

LEGEND

- 1900 --- EXISTING CONTOUR LINES
TREELINE
SHRUB
TREE
SOILS BOUNDARY LINE
SOILS CLASSIFICATION SYMBOL
PROPERTY LINE
PROPOSED CONTOUR LINES
PROPOSED HIGHEST WATER LINE
LIMIT OF DISTURBANCE
SILT FENCE
CONCRETE
RIP-RAP STONE

NOTE

SHEETS 1-8 OF 8 MUST BE READ TOGETHER
AND ARE TO BE CONSIDERED ONE INTEGRAL PLAN

DATE	REVISIONS	BY
10/2/09	REVISED E & S PLAN	JAB

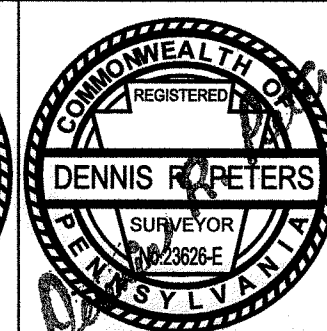
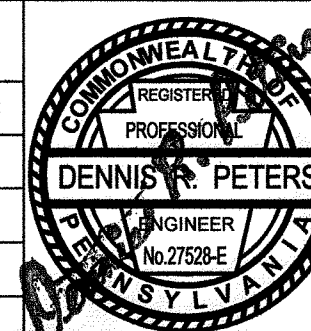

BRUSHVILLE LAKE
DAM RECONSTRUCTION PROJECT
PREPARED FOR
JERROLD GRIFFIS
SITE PLAN
OAKLAND TOWNSHIP - SUSQUEHANNA COUNTY - PENNSYLVANIA

PETERS CONSULTANTS, INC.
CONSULTING ENGINEERS & SURVEYORS
E-MAIL: info@petersconsultants.com
www.petersconsultants.com

100 Robbins Avenue Berwick, Pa. 18603 1023 Mulberry Street 29 East Main Street Bloomsburg, Pa. 17815

Scale: 1" = 50' Dwn By: JAB File No.: 2060
Date: 7/24/08 Ck. By: DRP Sheet 3 of 8



PENNSYLVANIA ACT 172 AS AMENDED REQUIRES NOTIFICATION OF EXCAVATORS,
DESIGNERS, OR ANY PERSON PREPARING TO DISTURB THE EARTH'S
SURFACE ANYWHERE IN THE COMMONWEALTH.

COPYRIGHT PETERS CONSULTANTS, INC. 2009. THESE PLANS ARE INSTRUMENTS OF SERVICE AND REMAIN THE
EXCLUSIVE PROPERTY OF PETERS CONSULTANTS, INC. THE CLIENT IS GRANTED A NON-EXCLUSIVE LICENSE TO
USE THE PLANS SOLELY TO CONSTRUCT THE PROJECT DEPICTED ON THE PLANS. THE PLANS MAY NOT BE
MODIFIED IN ANY WAY AND MAY NOT BE USED FOR SUBSEQUENT ADDITIONS, RENOVATIONS, MODIFICATIONS, OR
ALTERATIONS TO THE PROJECT WITHOUT THE EXPRESS WRITTEN CONSENT OF PETERS CONSULTANTS, INC.
PETERS CONSULTANTS, INC. ASSUMES NO LIABILITY FOR USE OF THE PLANS BEYOND THE NON-EXCLUSIVE
LICENSE GRANTED HEREIN.

PROJECT: 2060 - DRAWING: 2060-GRAND-3.dwg - LAYOUT: SHEET 3

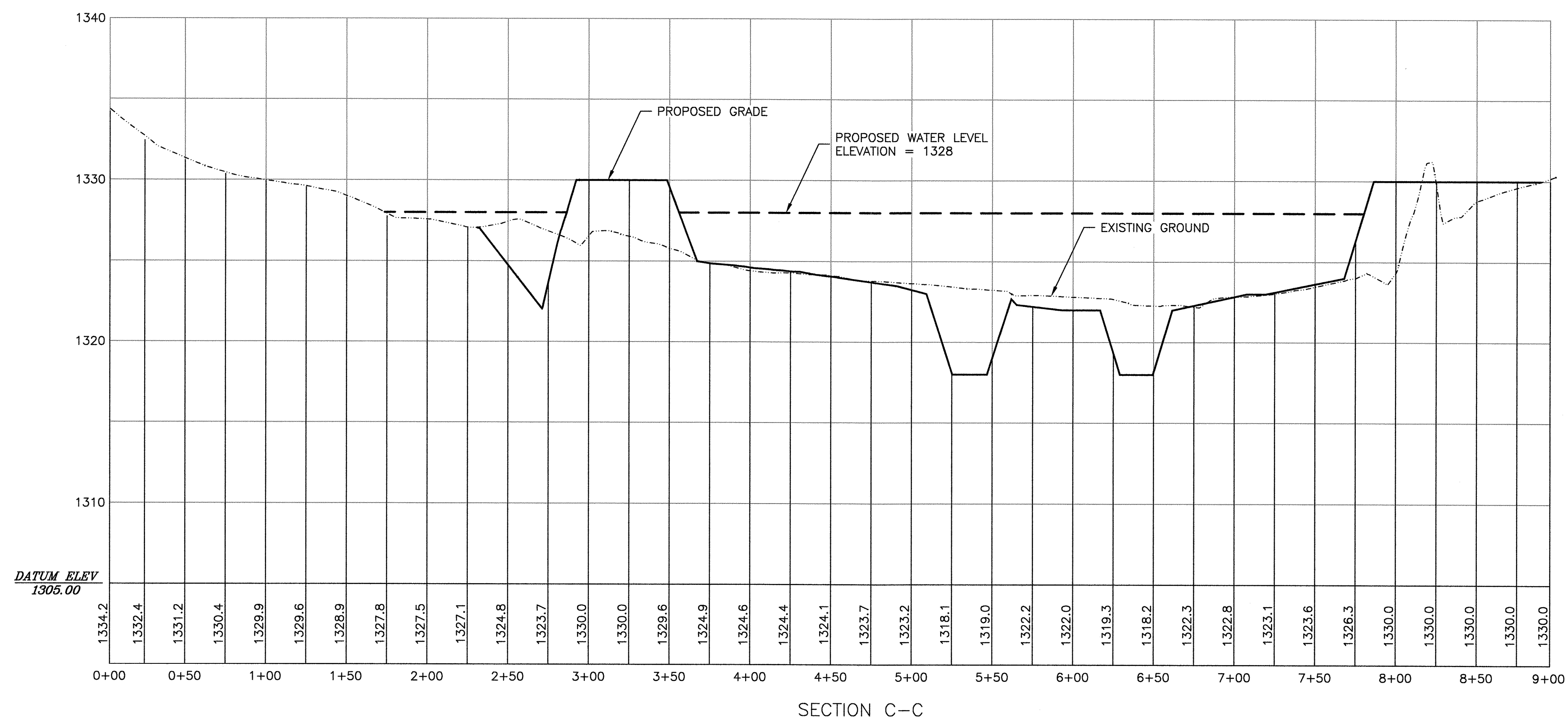
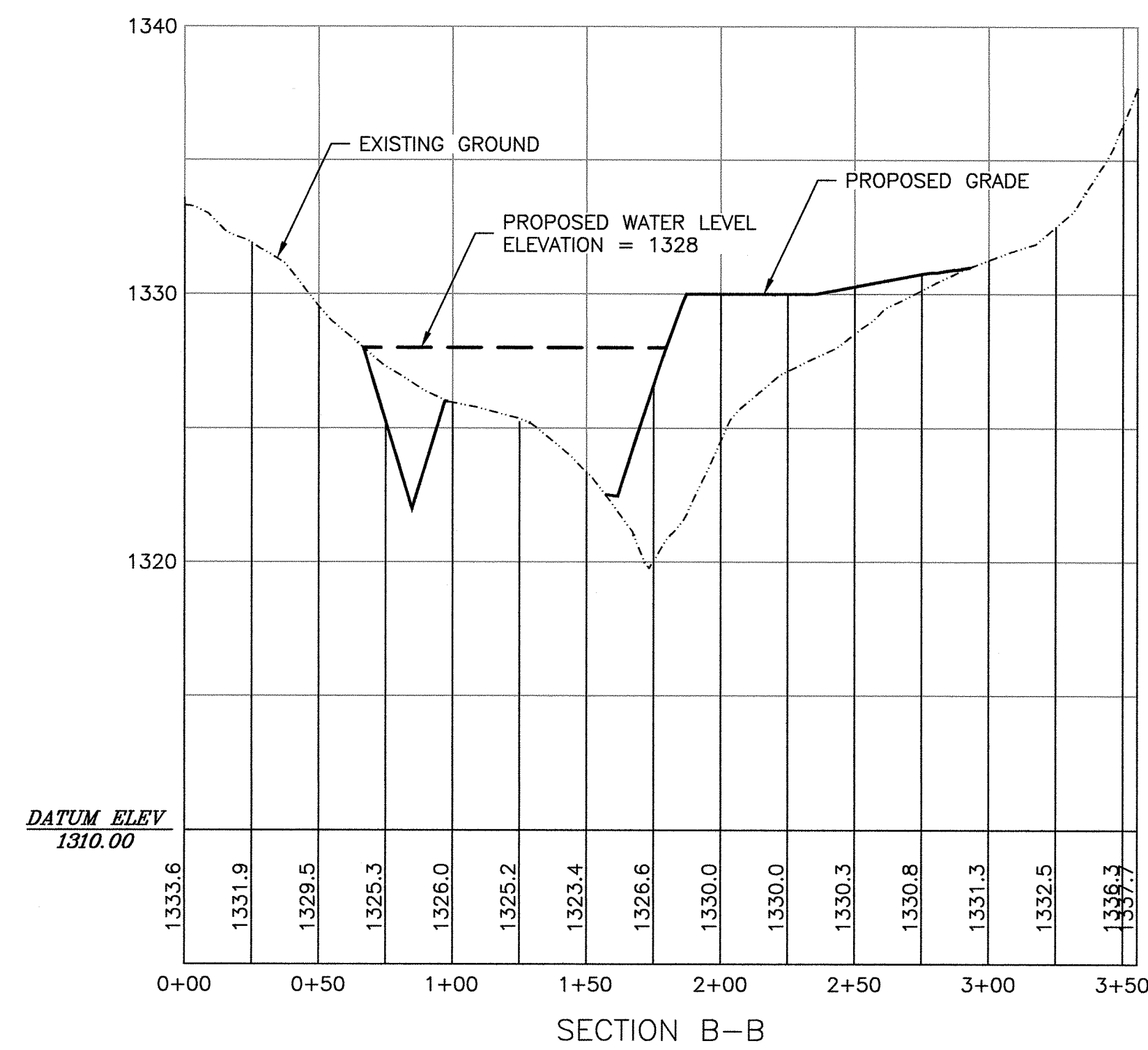
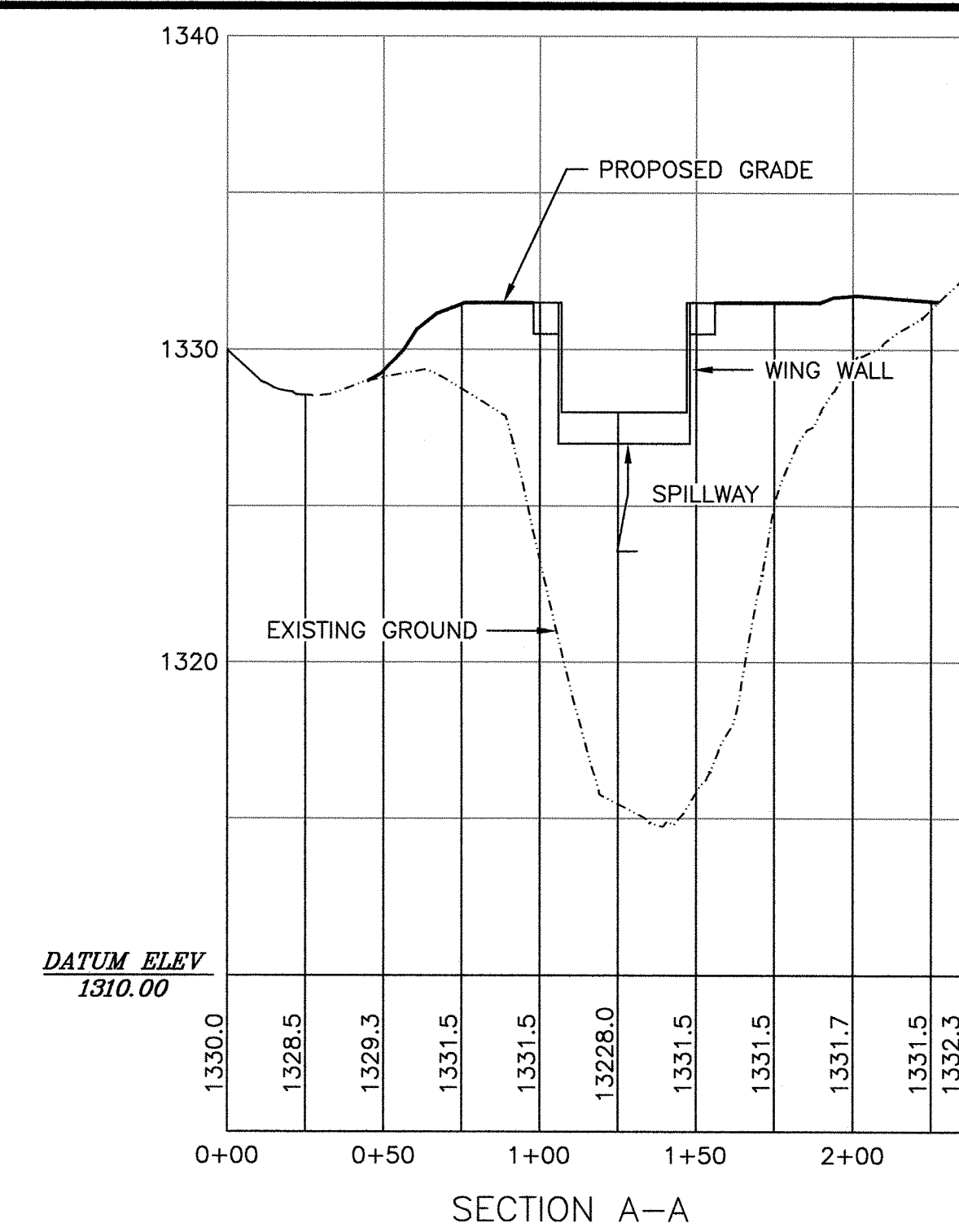
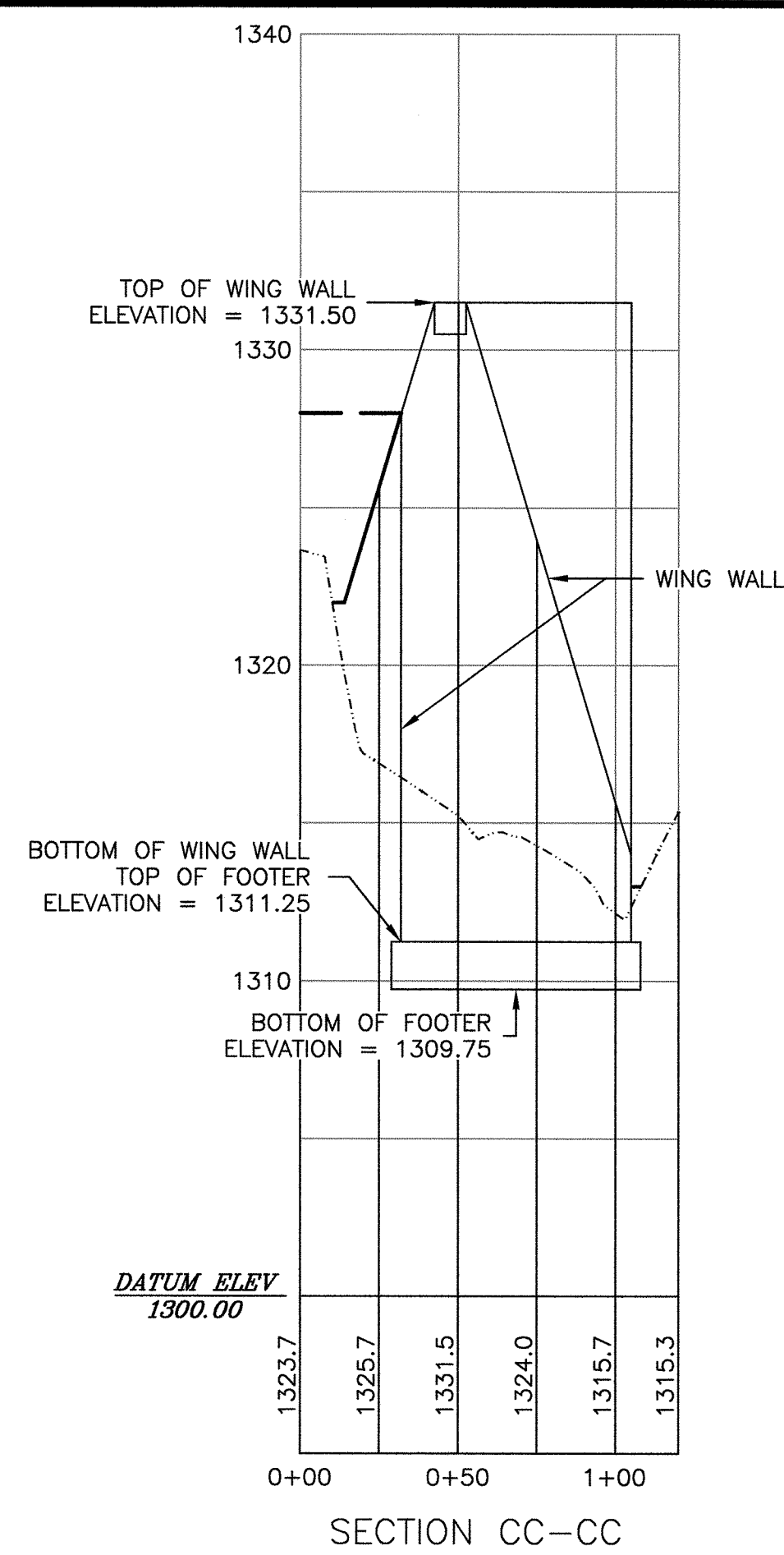
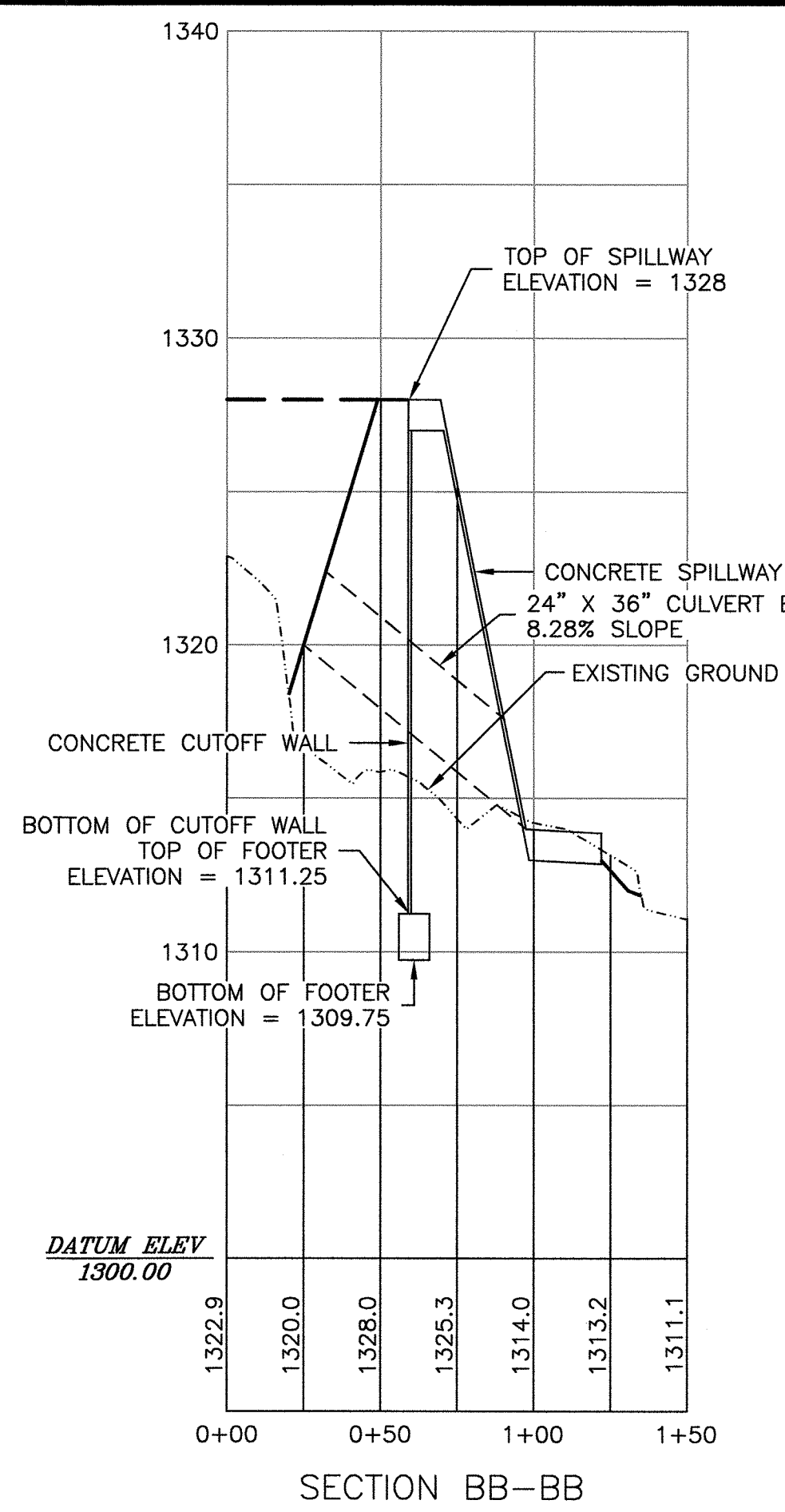
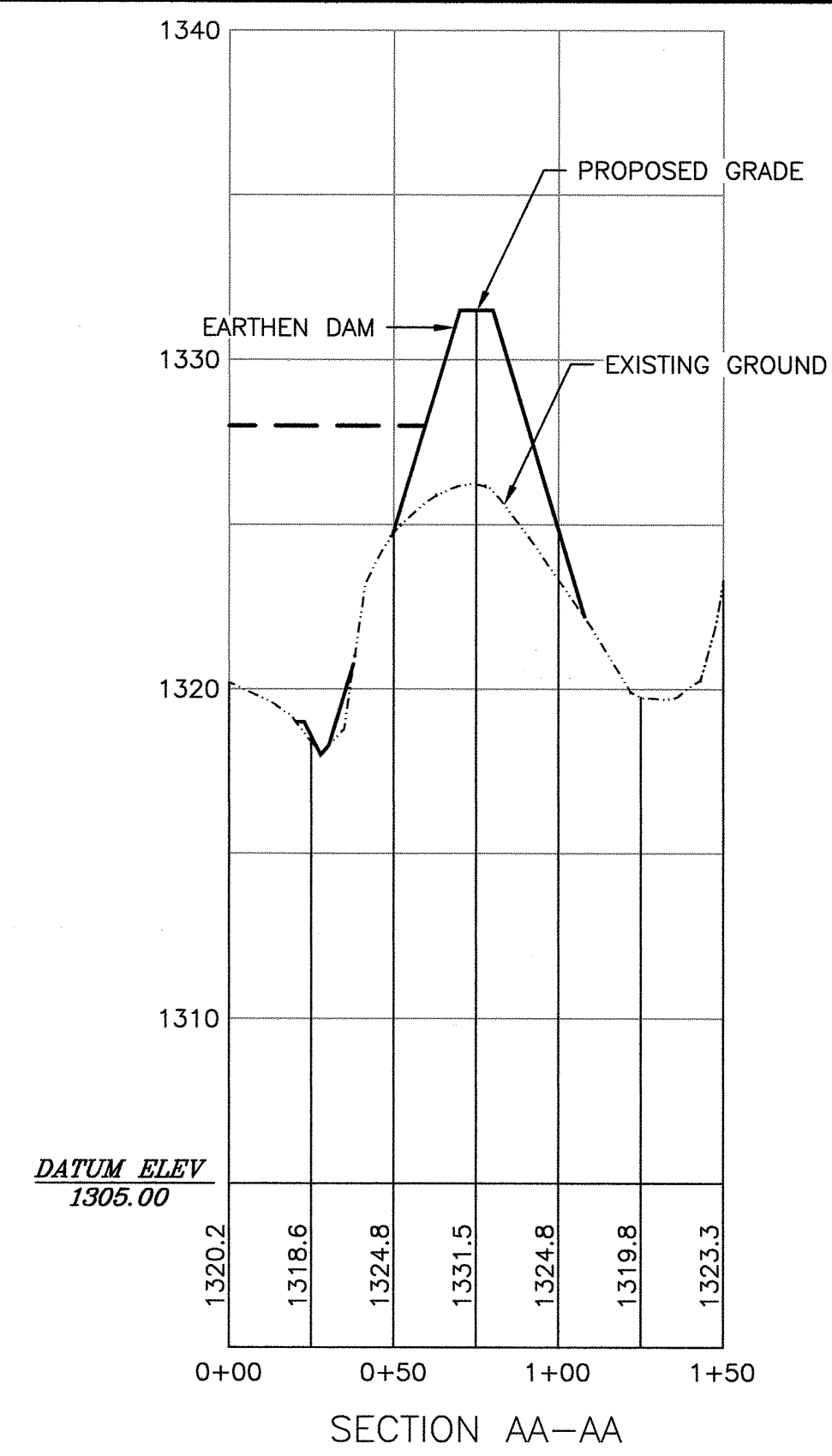

PENNSYLVANIA ACT 172 AS AMENDED REQUIRES NOTIFICATION OF EXCAVATORS, DESIGNERS, OR ANY PERSON PREPARING TO DISTURB THE EARTH'S SURFACE ANYWHERE IN THE COMMONWEALTH.

COPYRIGHT PETERS CONSULTANTS, INC. 2009. THESE PLANS ARE INSTRUMENTS OF SERVICE AND REMAIN THE EXCLUSIVE PROPERTY OF PETERS CONSULTANTS, INC. THE CLIENT IS GRANTED A NON-EXCLUSIVE LICENSE TO USE THE PLANS SOLELY TO CONSTRUCT THE PROJECT DEPICTED ON THE PLANS. THE PLANS MAY NOT BE MODIFIED IN ANY WAY AND MAY NOT BE USED FOR SUBSEQUENT ADDITIONS, RENOVATIONS, MODIFICATIONS, OR ALTERATIONS TO THE PROJECT WITHOUT THE EXPRESS WRITTEN CONSENT OF PETERS CONSULTANTS, INC. PETERS CONSULTANTS, INC. ASSUMES NO LIABILITY FOR USE OF THE PLANS BEYOND THE NON-EXCLUSIVE LICENSE GRANTED HEREIN.

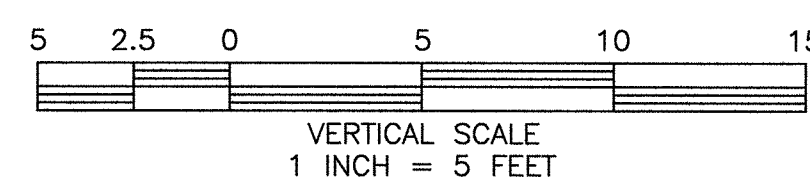
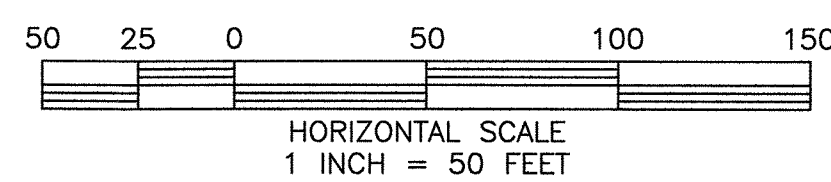

NOTE
SHEETS 1-8 OF 8 MUST BE READ TOGETHER
AND ARE TO BE CONSIDERED ONE INTEGRAL PLAN

DATE	REVISIONS	BY
10/2/09	NO CHANGES	JAB

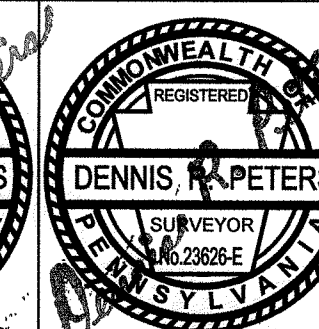
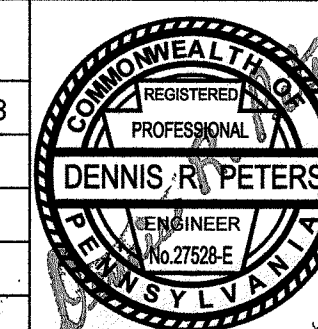

BRUSHVILLE LAKE
DAM RECONSTRUCTION PROJECT
PREPARED FOR
JERROLD GRIFFIS
SECTIONS - 1
OAKLAND TOWNSHIP - SUSQUEHANNA COUNTY - PENNSYLVANIA

PETERS CONSULTANTS, INC.
CONSULTING ENGINEERS & SURVEYORS
E-MAIL: info1@petersconsultants.com
www.petersconsultants.com
100 Robbins Avenue Berwick, Pa. 18603
1023 Mulberry Street Berwick, Pa. 18603
29 East Main Street Bloomsburg, Pa. 17815
Scale: NOTED
Date: 7/24/08
Dwn By: JAB
Ck. By: DRP
File No.: 2060
Sheet 4 of 8

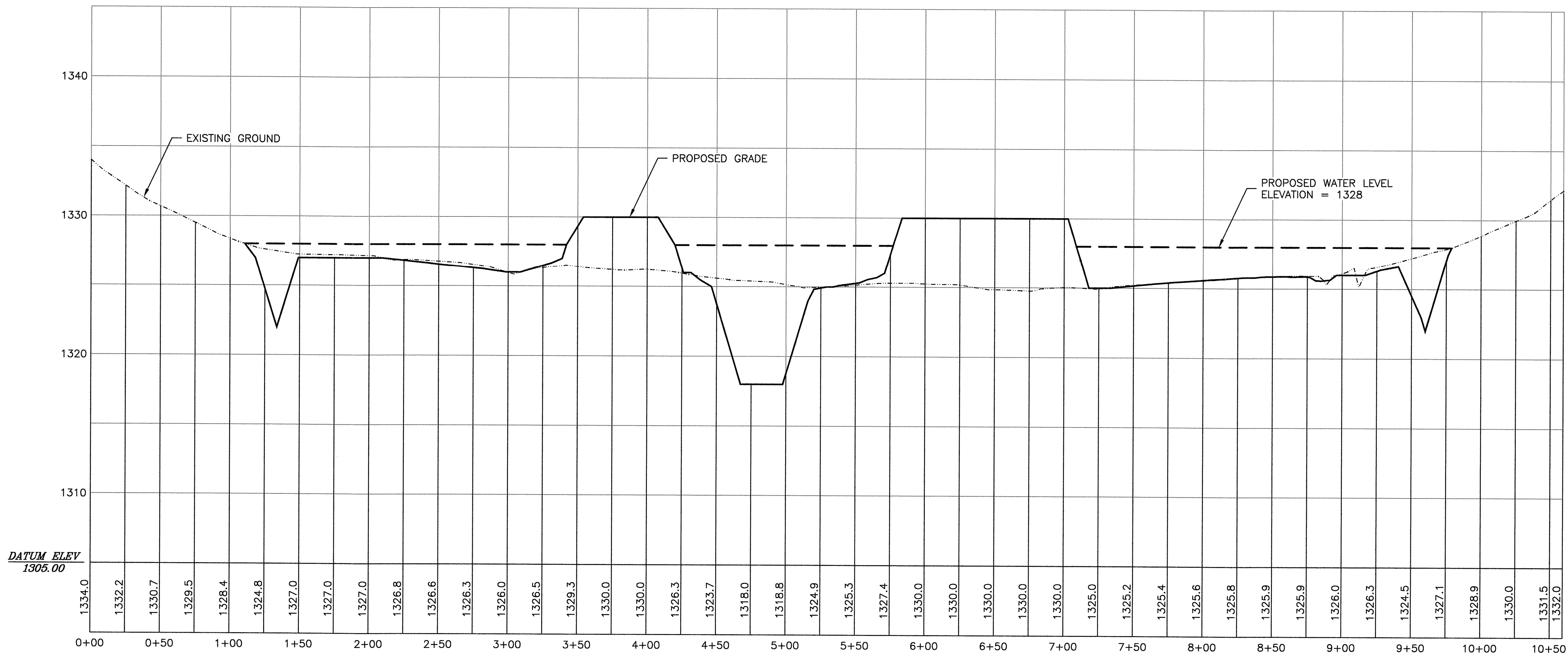

SECTION D-D

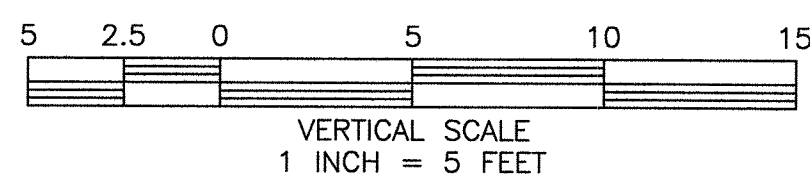
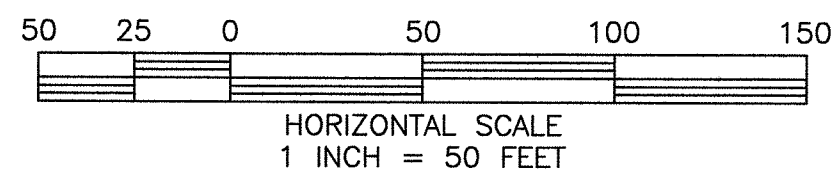

NOTE
SHEETS 1-8 OF 8 MUST BE READ TOGETHER
AND ARE TO BE CONSIDERED ONE INTEGRAL PLAN

DATE	REVISIONS	BY
10/2/09	NO CHANGES	JAB

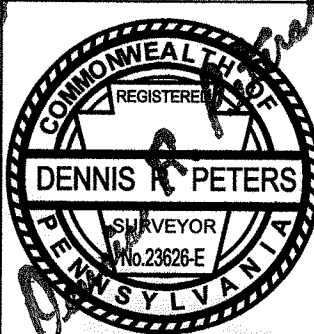
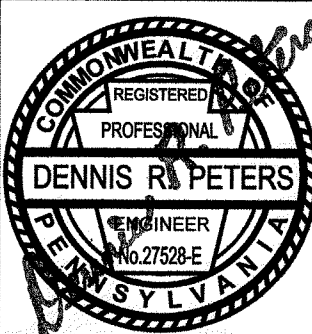

BRUSHVILLE LAKE
DAM RECONSTRUCTION PROJECT
PREPARED FOR
JERROLD GRIFFIS
SECTIONS - 2

OAKLAND TOWNSHIP - SUSQUEHANNA COUNTY - PENNSYLVANIA

PETERS CONSULTANTS, INC.
CONSULTING ENGINEERS & SURVEYORS
E-MAIL: info1@petersconsultants.com
www.petersconsultants.com

100 Robbins Avenue Berwick, Pa. 18603
1023 Mulberry Street Berwick, Pa. 18603
29 East Main Street Bloomsburg, Pa. 17815

Scale: NOTED	Dwn By: JAB	File No.: 2060
Date: 7/24/08	Ck. By: DRP	Sheet 5 of 8



PENNSYLVANIA ACT 172 AS AMENDED REQUIRES NOTIFICATION OF EXCAVATORS,
DESIGNERS, OR ANY PERSON PREPARING TO DISTURB THE EARTH'S
SURFACE ANYWHERE IN THE COMMONWEALTH.

COPYRIGHT PETERS CONSULTANTS, INC. 2009. THESE PLANS ARE INSTRUMENTS OF SERVICE AND REMAIN THE
EXCLUSIVE PROPERTY OF PETERS CONSULTANTS, INC. THE CLIENT IS GRANTED A NON-EXCLUSIVE LICENSE TO
USE THE PLANS SOLELY TO CONSTRUCT THE PROJECT DEPICTED ON THE PLANS. THE PLANS MAY NOT BE
MODIFIED IN ANY WAY AND MAY NOT BE USED FOR SUBSEQUENT ADDITIONS, RENOVATIONS, MODIFICATIONS, OR
ALTERATIONS TO THE PROJECT WITHOUT THE EXPRESS WRITTEN CONSENT OF PETERS CONSULTANTS, INC.
PETERS CONSULTANTS, INC. ASSUMES NO LIABILITY FOR USE OF THE PLANS BEYOND THE NON-EXCLUSIVE
LICENSE GRANTED HEREIN.

SEEDING SPECIFICATIONS					
FORMULA AND SPECIES	% BY WEIGHT	MINIMUM %		MAX. % WEED SEED	SEEDING RATE LBS. PER ACRE
PERMANENT SEEDING * NURSE CROP - ANNUAL RYEGRASS * TALL FESCUE - USE VARIETY THAT ORIGINATED IN PENNSYLVANIA * REDTOP	16	95	85	0.15	93 TOTAL
	81	95	80	0.15	15
	3	92	80	0.20	75
TEMPORARY SEEDING * ANNUAL RYEGRASS	100	95	85	0.15	40 TOTAL
TEMPORARY SEEDING		PERMANENT SEEDING		ALL SEEDING	
% PURE LIVE SEED: 95%		% PURE LIVE SEED: 95%		6 TON/ACRE	
APPLICATION RATE: 40 LB/ACRE		APPLICATION RATE: 93 LB/AC		CEREAL STRAW	
FERTILIZER TYPE: 10-20-20		FERTILIZER TYPE: 10-20-20		3 TON/ACRE	
FERTILIZER APPL. RATE: 680 LB/ACRE		FERTILIZER APPL. RATE: 680 LB/ACRE		EMULSIFIED ASPHALT	
		SEEDING SEASON: MARCH 15 - OCTOBER 15		ANCHORING METHOD: SPRAY	
				RATE OF APPLICATION: 150 GALLONS/ACRE	

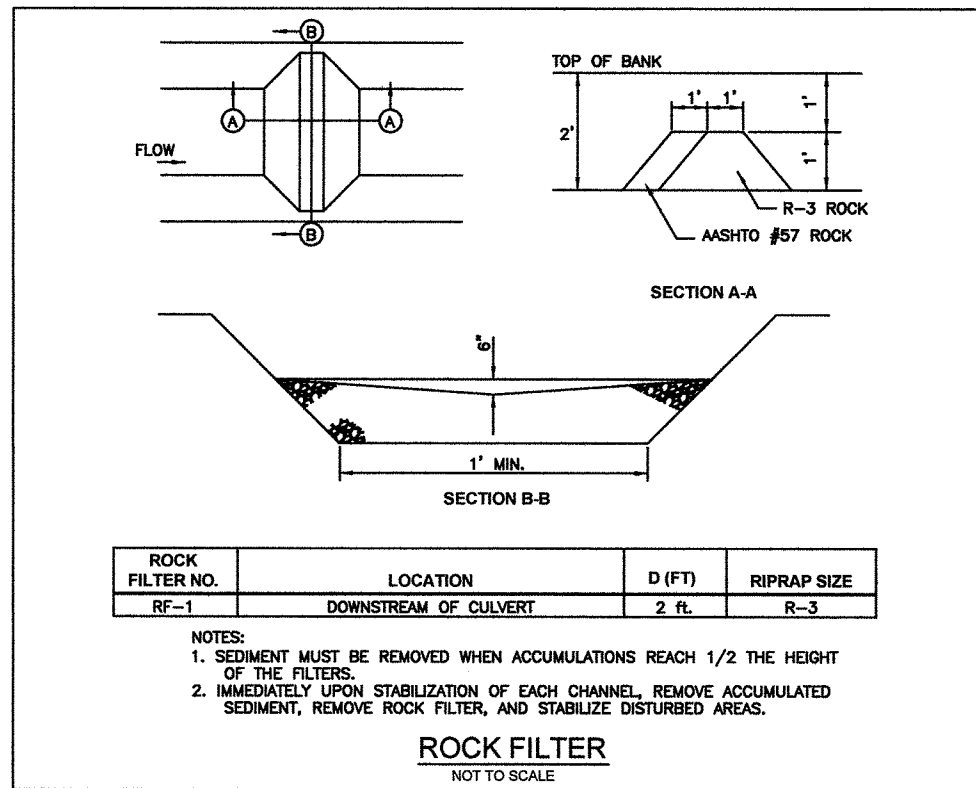
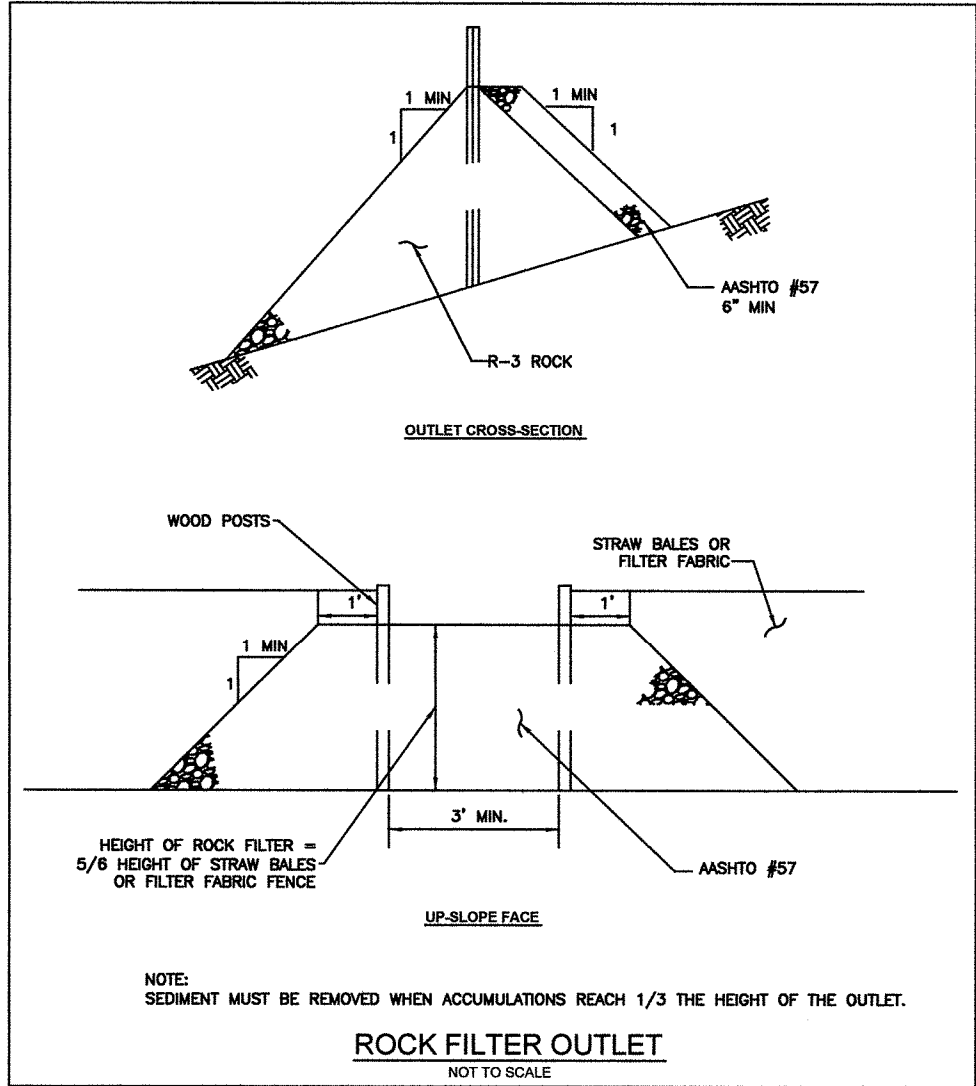

WARNING SIGN 1

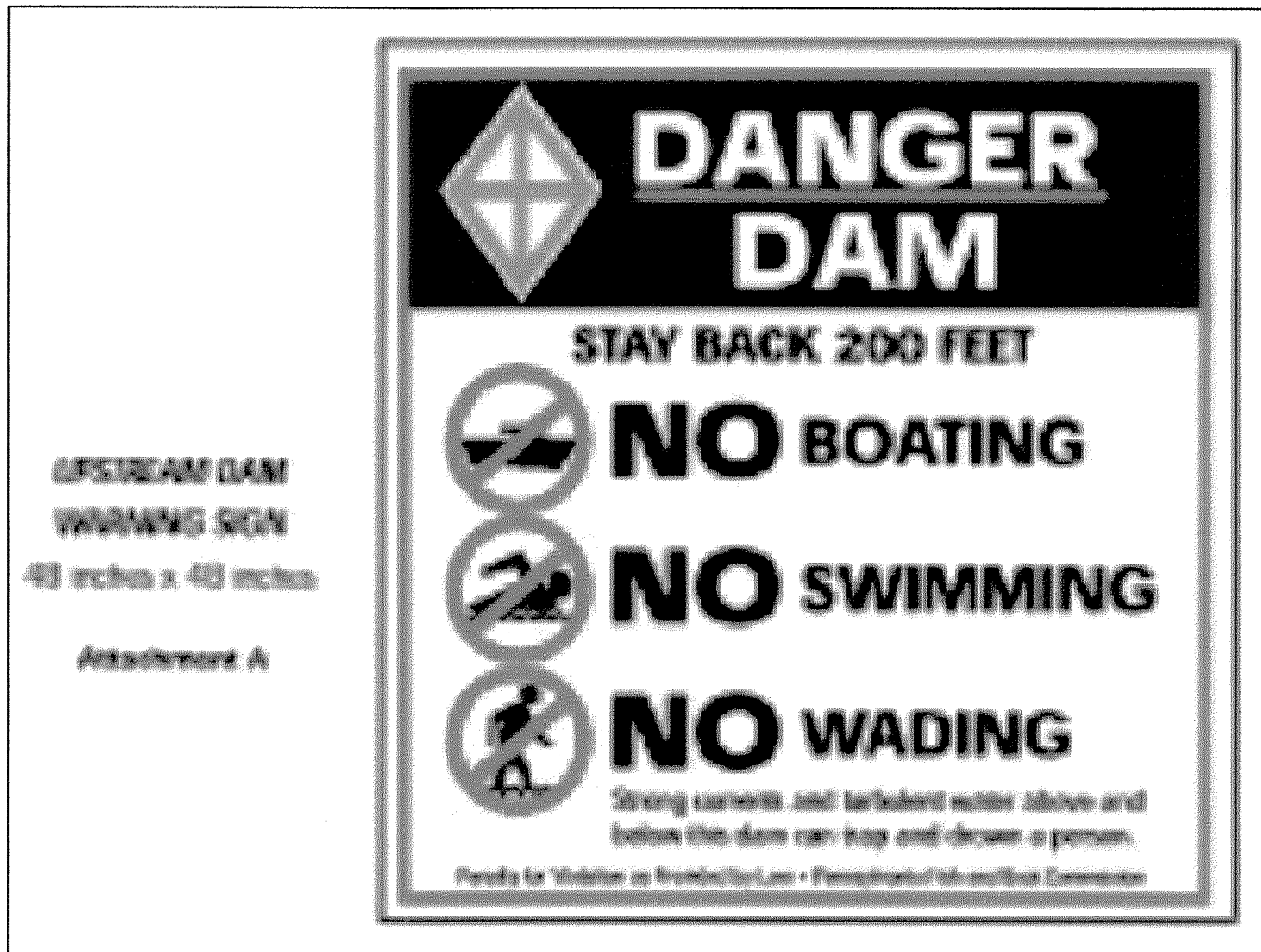

WARNING SIGN 2

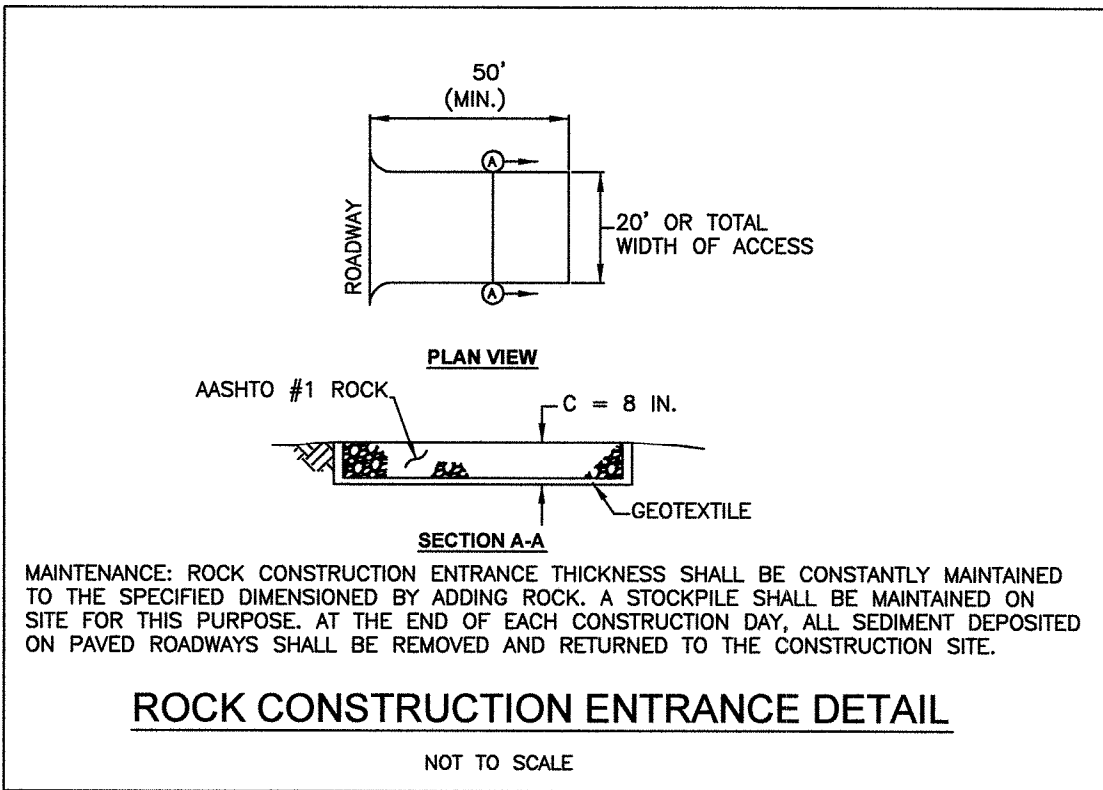
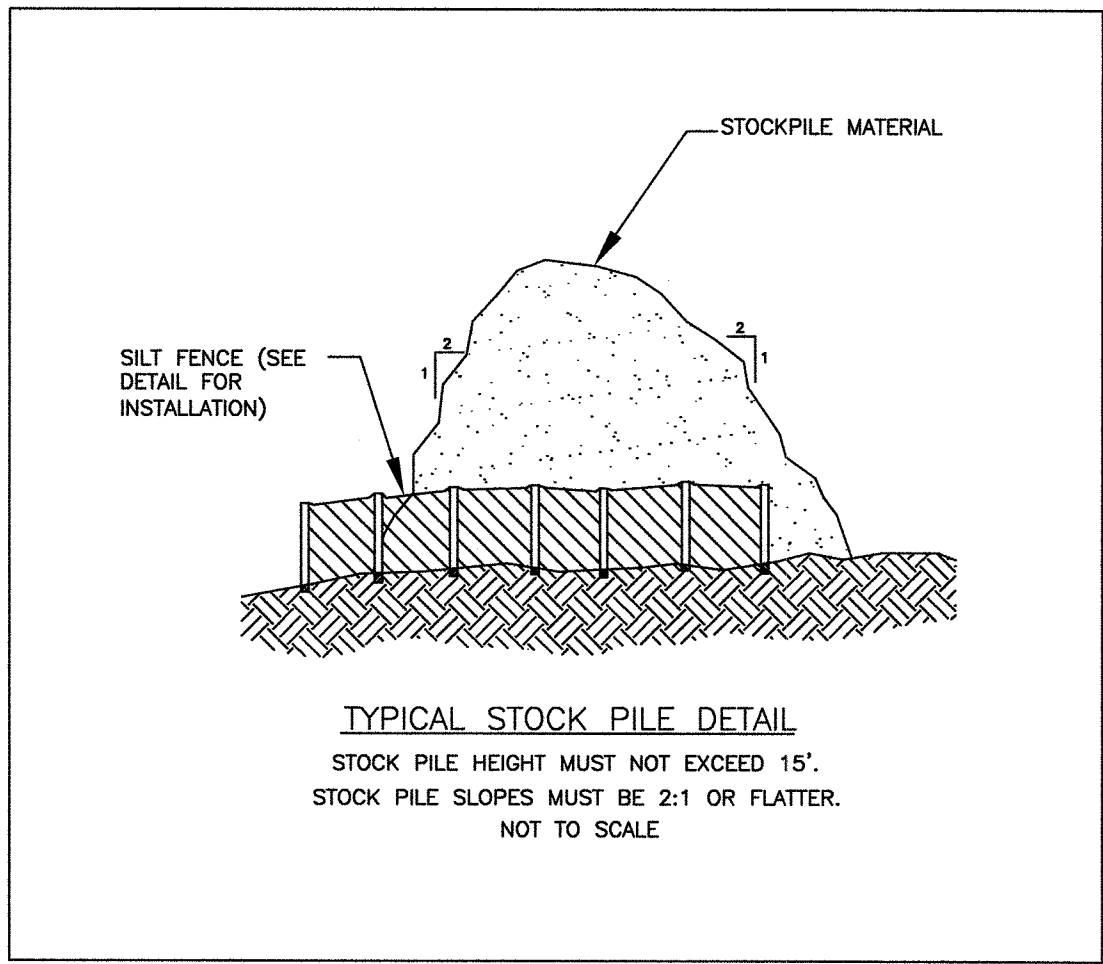

WARNING SIGN 3
48" X 48"

NOTE:
SHEETS 1-8 OF 8 MUST BE READ TOGETHER
AND ARE TO BE CONSIDERED ONE INTEGRAL PLAN

DATE	REVISIONS	BY
10/2/09	VARIOUS	JAB

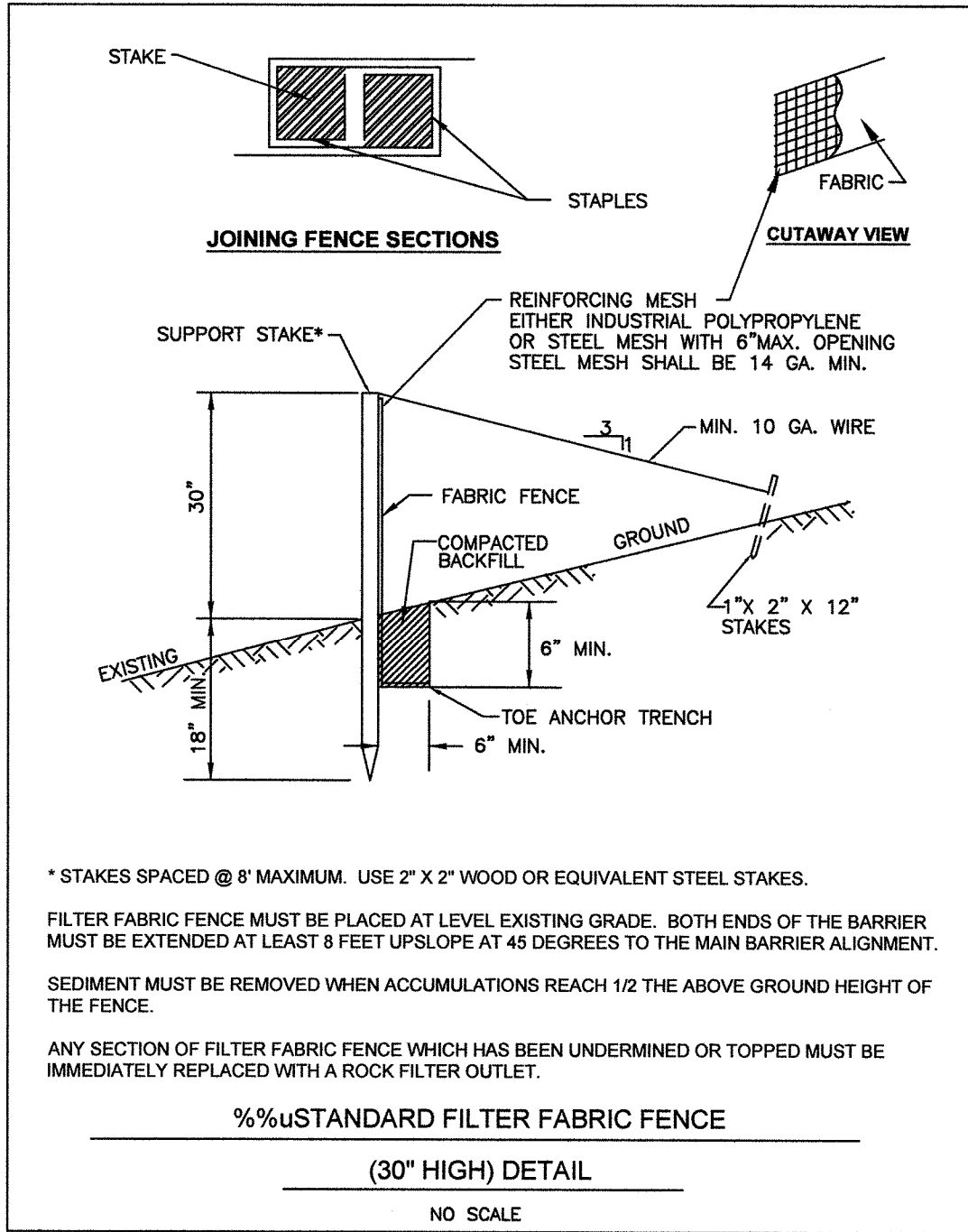
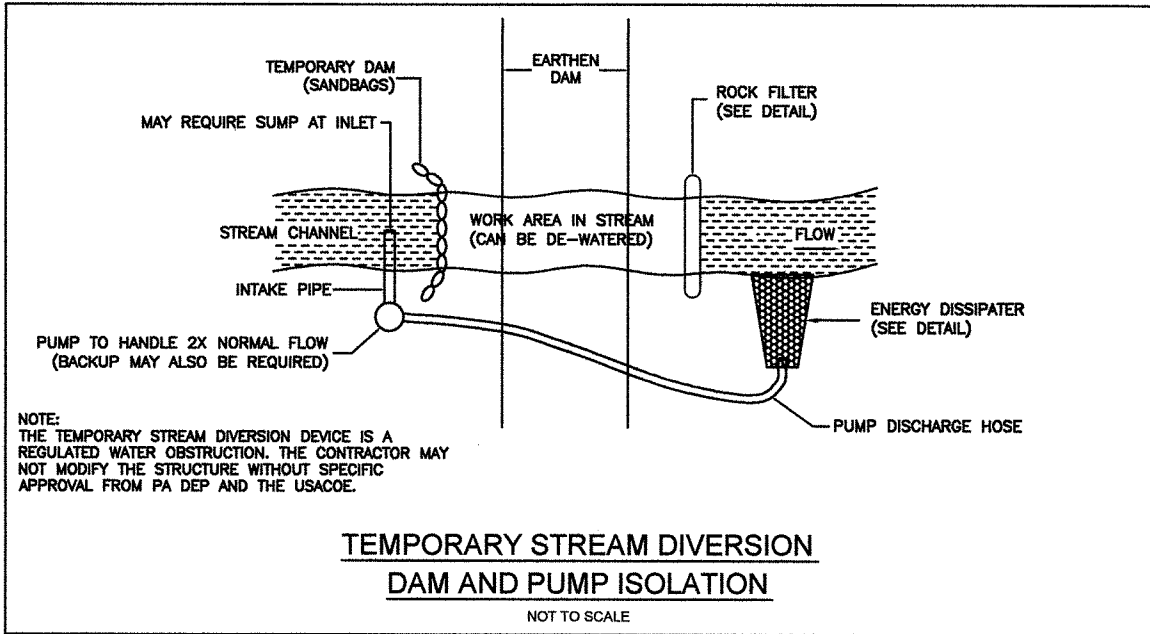

BRUSHVILLE LAKE DAM RECONSTRUCTION PROJECT			
PREPARED FOR JERROLD GRIFFIS DETAILS			
OAKLAND TOWNSHIP - SUSQUEHANNA COUNTY - PENNSYLVANIA			
PETERS CONSULTANTS, INC. CONSULTING ENGINEERS & SURVEYORS E-MAIL: info@petersconsultants.com www.petersconsultants.com			
100 Robbins Avenue Berwick, Pa. 18603	1023 Mulberry Street Berwick, Pa. 18603	29 East Main Street Bloomsburg, Pa. 17815	
Scale: NONE	Dwn By: JAB	File No.: 2060	
Date: 7/24/08	Ck. By: DRP	Sheet 6 of 8	



COPYRIGHT PETERS CONSULTANTS, INC. 2008. THESE PLANS ARE INSTRUMENTS OF SERVICE AND REMAIN THE EXCLUSIVE PROPERTY OF PETERS CONSULTANTS, INC. THE CLIENT IS GRANTED A NON-EXCLUSIVE LICENSE TO USE THE PLANS SOLELY TO CONSTRUCT THE PROJECT DEPICTED ON THE PLANS. THE PLANS MAY NOT BE MODIFIED IN ANY WAY AND MAY NOT BE USED FOR SUBSEQUENT ADDITIONS, REVISIONS, MODIFICATIONS, OR ALTERATIONS TO THE PROJECT WITHOUT THE EXPRESS WRITTEN CONSENT OF PETERS CONSULTANTS, INC. PETERS CONSULTANTS, INC. ASSUMES NO LIABILITY FOR USE OF THE PLANS BEYOND THE NON-EXCLUSIVE LICENSE GRANTED HEREIN.

PENNSYLVANIA ACT 172 AS AMENDED REQUIRES NOTIFICATION OF EXCAVATORS, DESIGNERS, OR ANY PERSON PREPARING TO DISTURB THE EARTH'S SURFACE ANYWHERE IN THE COMMONWEALTH.

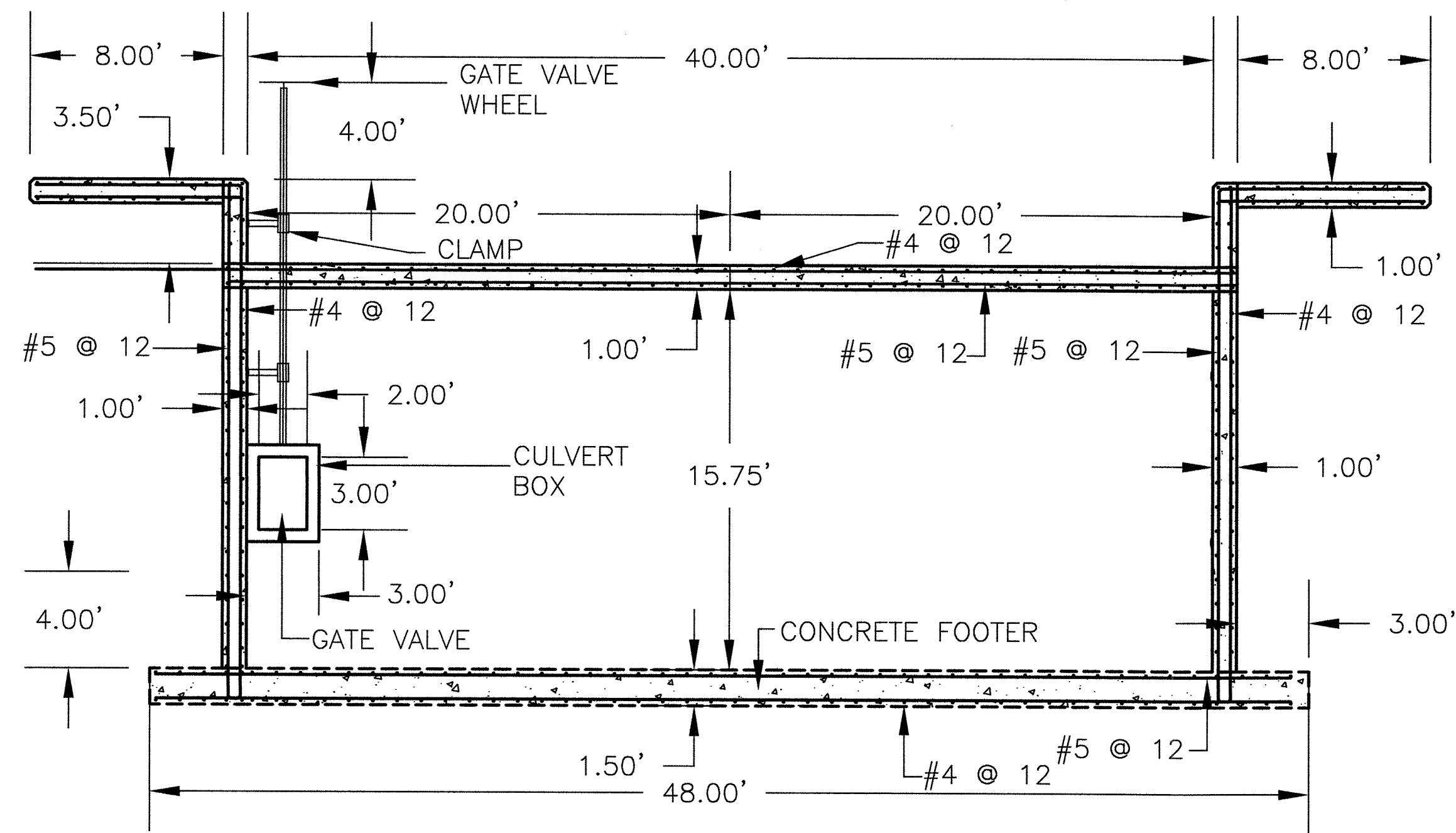

SECTION THROUGH FACE OF CUTOFF WALL

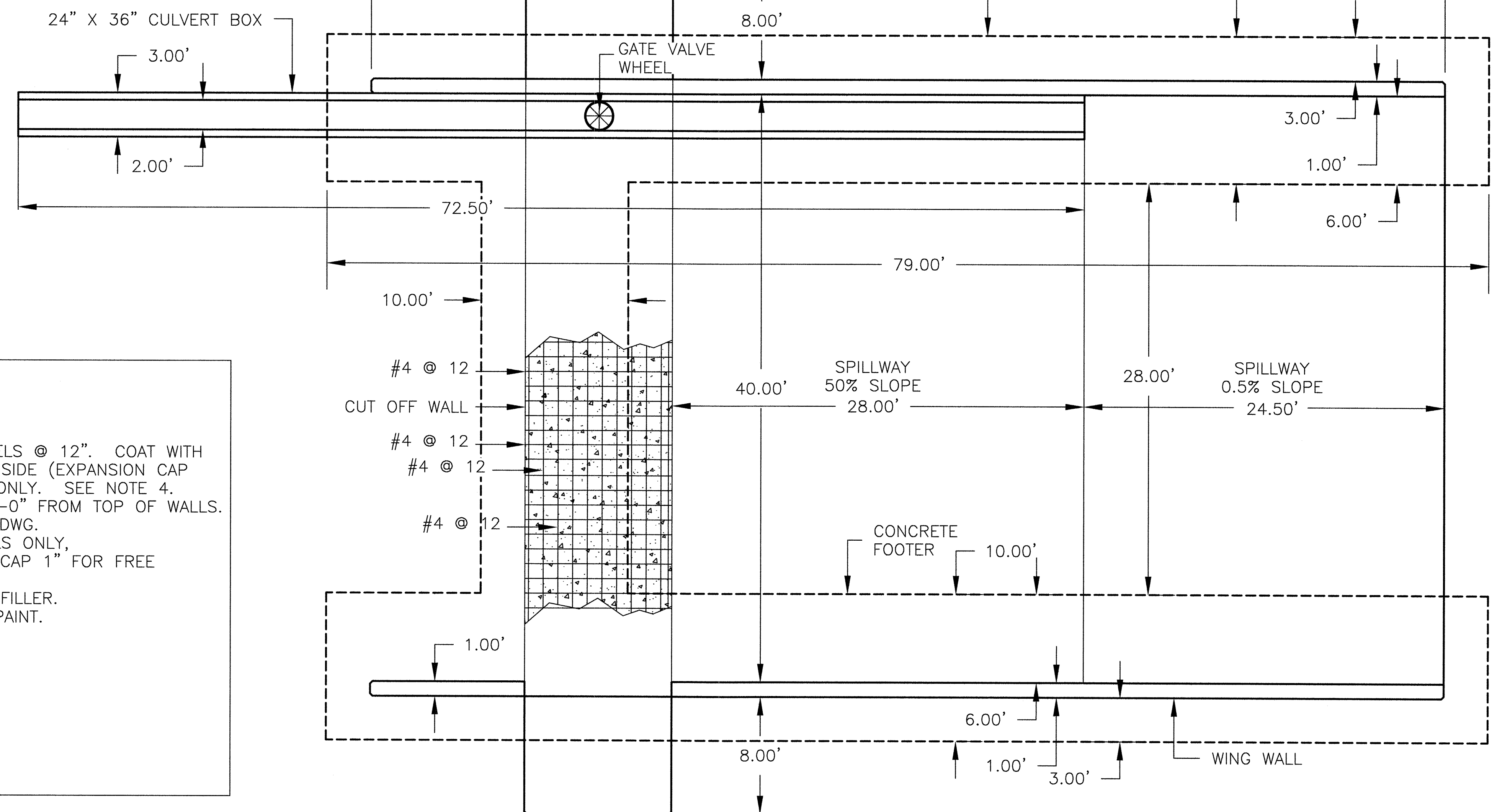

PLAN VIEW

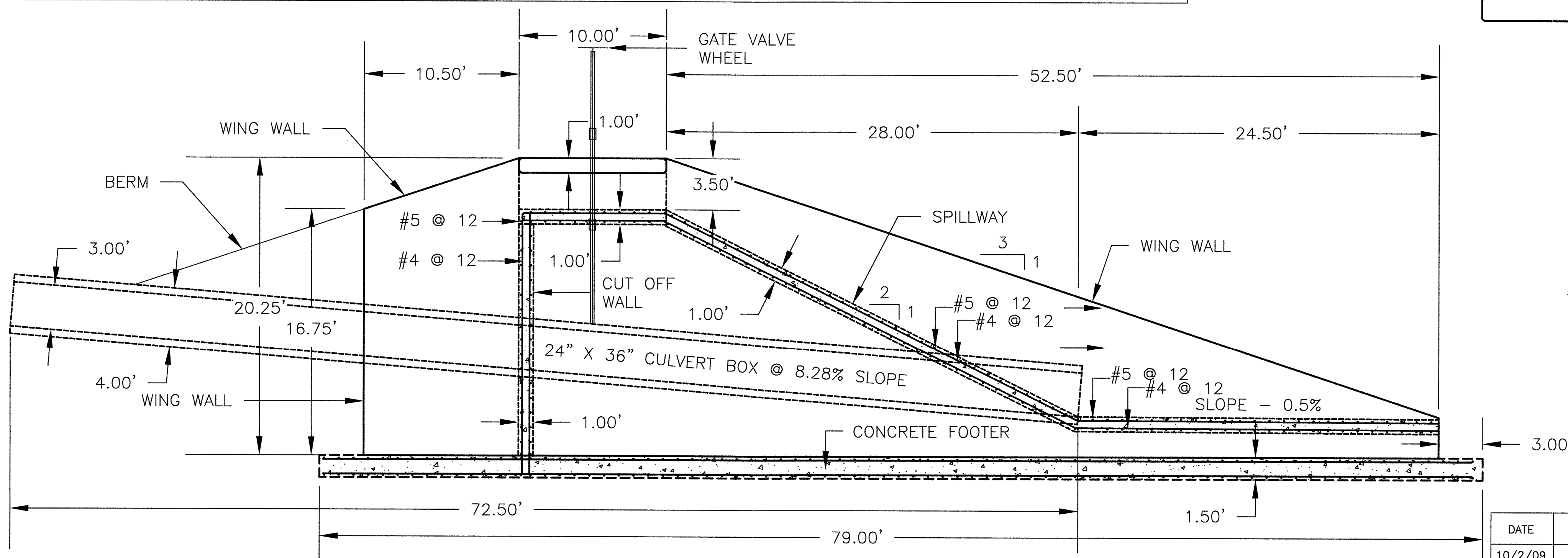
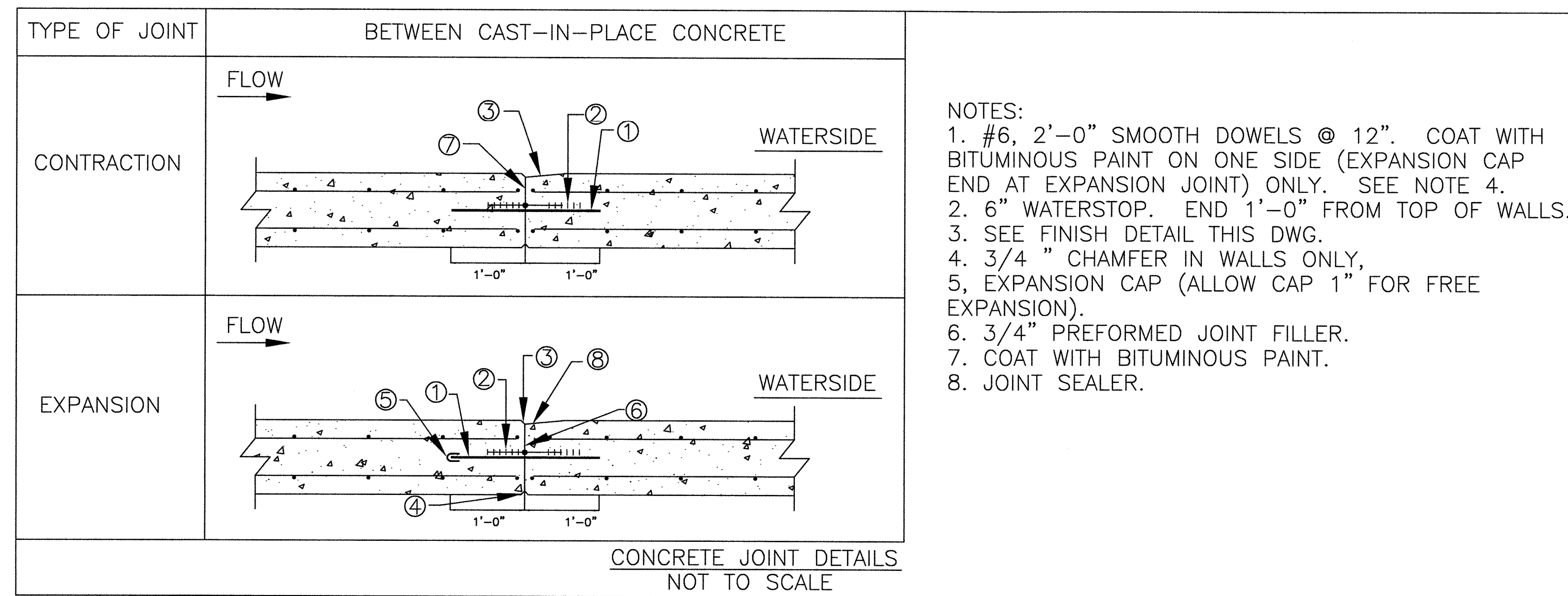

SECTION CC-CC

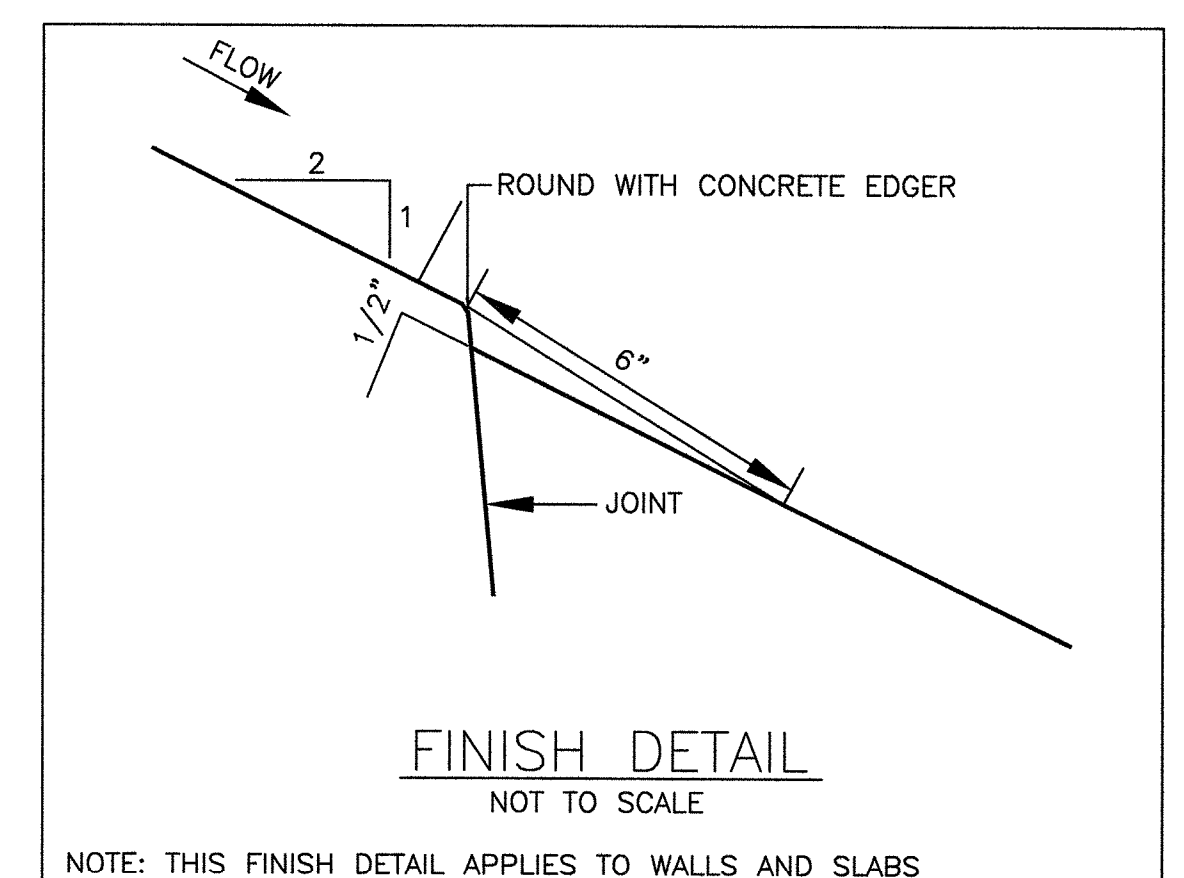
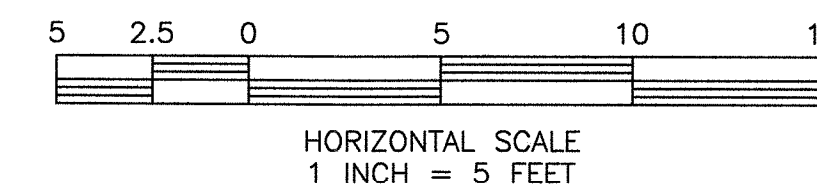

NOTE
SHEETS 1-8 OF 8 MUST BE READ TOGETHER
AND ARE TO BE CONSIDERED ONE INTEGRAL PLAN

DATE	REVISIONS	BY
10/2/09	NO CHANGES	JAB

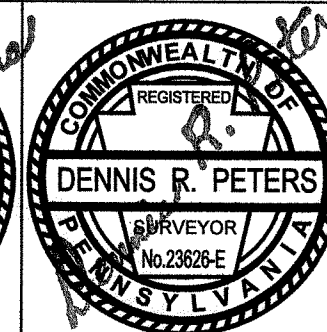
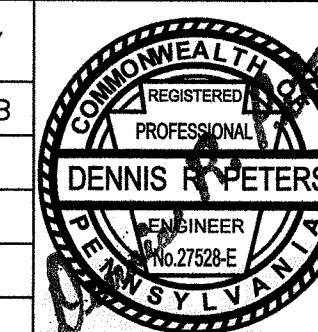

BRUSHVILLE LAKE
DAM RECONSTRUCTION PROJECT
PREPARED FOR
JERROLD GRIFFIS
DETAILS

OAKLAND TOWNSHIP - SUSQUEHANNA COUNTY - PENNSYLVANIA

PETERS CONSULTANTS, INC.
CONSULTING ENGINEERS & SURVEYORS
E-MAIL: info@petersconsultants.com
www.petersconsultants.com

100 Robbins Avenue 1023 Mulberry Street 29 East Main Street
Berwick, Pa. 18603 Berwick, Pa. 18603 Bloomsburg, Pa. 17815

Scale: 1" = 5' Dwn By: JAB File No.: 2060

Date: 7/24/08 Ck. By: DRP Sheet 7 of 8

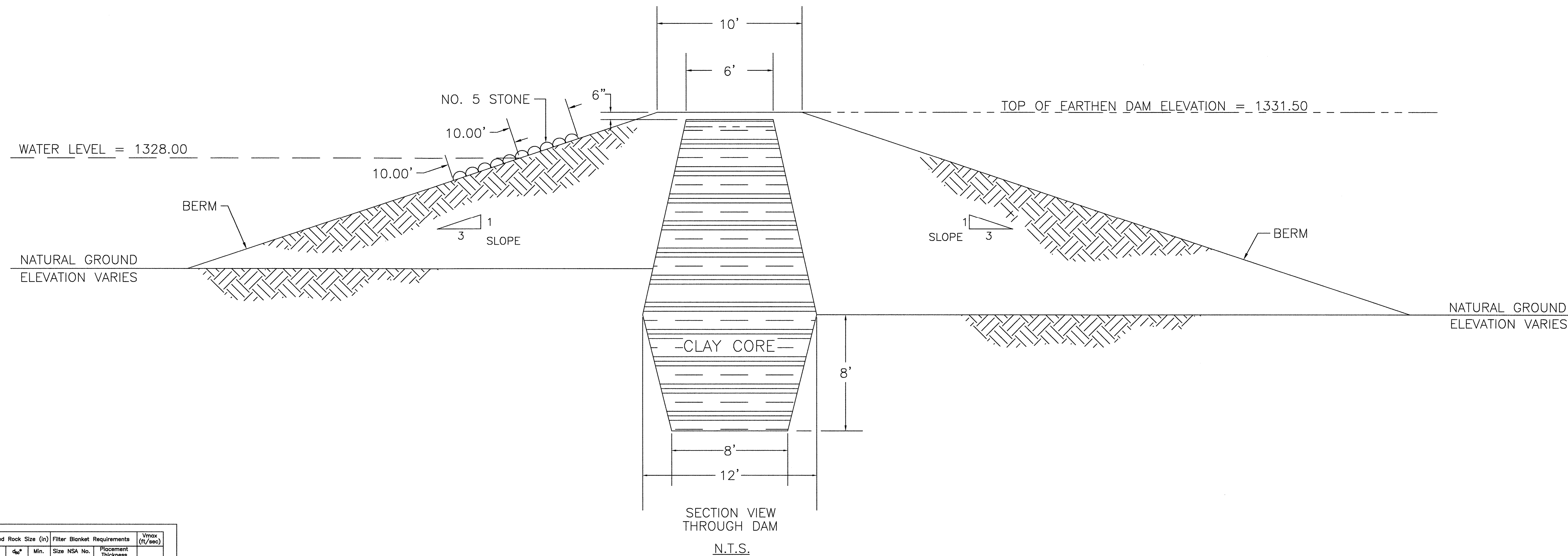

NSA No.	Graded Rock Size (in)			Filter Blanket Requirements		Vmax (ft/sec)
	Max	d_{50}	Min.	Size NSA No.	Placement Thickness	
R-1	1.5	.75	No. 8	FS-1	N/A	2.5
R-2	3	1.5	1	FS-1	N/A	4.5
R-3	6	3	2	FS-1	3	6.5
R-4	12	6	3	FS-2	4	9.0
R-5	18	9	5	FS-2	6	11.5
R-6	24	12	7	FS-3	8	13.0
R-7	30	15	12	FS-3	10	14.5
R-8	42	24	15	FS-3	12	16.0

*The d_{50} size is the size exceeded by 50% of the total weight of the tonnage shipped (i.e. 50% by weight shall consist of pieces larger than the d_{50} stone size).

RIPRAP GRADATION, FILTER BLANKET REQUIREMENTS, MAXIMUM VELOCITIES



PENNSYLVANIA ACT 172 AS AMENDED REQUIRES NOTIFICATION OF EXCAVATORS, DESIGNERS, OR ANY PERSON PREPARING TO DISTURB THE EARTH'S SURFACE ANYWHERE IN THE COMMONWEALTH.

NOTE
SHEETS 1-8 OF 8 MUST BE READ TOGETHER
AND ARE TO BE CONSIDERED ONE INTEGRAL PLAN

DATE	REVISIONS	BY
10/2/09	NO CHANGES	JAB

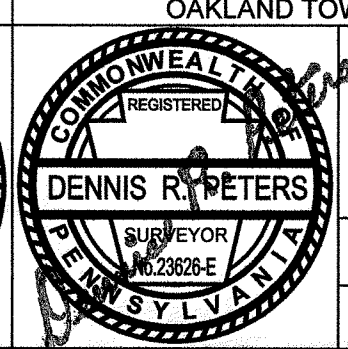
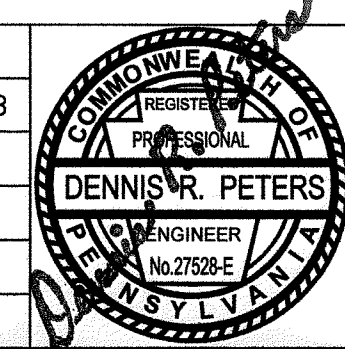

BRUSHVILLE LAKE
DAM RECONSTRUCTION PROJECT
PREPARED FOR
JERROLD GRIFFIS
SECTION THROUGH EARTHEN DAM
OAKLAND TOWNSHIP - SUSQUEHANNA COUNTY - PENNSYLVANIA

PETERS CONSULTANTS, INC.
CONSULTING ENGINEERS & SURVEYORS
info@petersconsultants.com - www.petersconsultants.com

100 Robbins Avenue Berwick, Pa. 18603 1023 Mulberry Street Berwick, Pa. 18603 29 East Main Street Bloomsburg, Pa. 17815

Scale: NONE	Dwn By: JAB	File No.: 2060
Date: 7/24/08	Ck. By: DRP	Sheet 8 of 8

PROJECT:2060 - DRAWING: CROSS SECTIONS.dwg

COPYRIGHT PETERS CONSULTANTS, INC. 2008. THESE PLANS ARE INSTRUMENTS OF SERVICE AND REMAIN THE EXCLUSIVE PROPERTY OF PETERS CONSULTANTS, INC. THE CLIENT IS GRANTED A NON-EXCLUSIVE LICENSE TO USE THE PLANS SOLELY TO CONSTRUCT THE PROJECT DEPICTED ON THE PLANS. THE PLANS MAY NOT BE MODIFIED IN ANY WAY AND MAY NOT BE USED FOR SUBSEQUENT ADDITIONS, RENOVATIONS, MODIFICATIONS, OR ALTERATIONS TO THE PROJECT WITHOUT THE EXPRESS WRITTEN CONSENT OF PETERS CONSULTANTS, INC. PETERS CONSULTANTS, INC. ASSUMES NO LIABILITY FOR USE OF THE PLANS BEYOND THE NON-EXCLUSIVE LICENSE GRANTED HEREIN.