



U.S. Army Corps  
of Engineers  
Baltimore District

# Public Notice

In Reply to Application Number  
CENAB-OPR-MN (HARFORD COUNTY PARKS & REC/  
TAYLOR CREEK WEST & RUMSEY ISLAND  
OUTFALL/DREDGING) 2018-60187-M12

PN 18-16

Comment Period: March 20, 2018 – April 20, 2018

---

**THE PURPOSE OF THIS PUBLIC NOTICE IS TO SOLICIT COMMENTS FROM THE PUBLIC REGARDING THE WORK DESCRIBED BELOW. NO DECISION HAS BEEN MADE AS TO WHETHER OR NOT A PERMIT WILL BE ISSUED AT THIS TIME.**

This District has received an application for a Department of the Army permit pursuant to **Section 10 of the Rivers and Harbors Act of 1899 and/or Section 404 of the Clean Water Act (33. U.S.C. 1344)** as described below:

**APPLICANT:** Harford County Department of Parks & Recreation  
Attn: Mr. David Goodwin  
702 North Tollgate Road  
Bel Air, Maryland 21014

**WATERWAY AND LOCATION:** The proposed dredging would occur in Taylor Creek West Channel and Rumsey Island Outfall that are both adjacent to Mariner Point Park located in Joppatowne, Harford County, Maryland.

**PROPOSED WORK:** To hydraulically or mechanically maintenance dredge Taylor Creek (West Channel) to a maximum depth of -5.0 feet at mean low water and, the Rumsey Island Outfall to a maximum depth of -5.5 feet at mean low water. Approximately 3,600 linear feet of the West Channel would be dredged where 4,200 cubic yards of dredged material would be removed from an approximate 165,356 square foot area. At the Rumsey Island Outfall, approximately 1,000 cubic yards of dredged material would be removed from an approximate 28,960 square foot area. Dredging would occur within Taylor Creek located in Joppatowne, Harford County, Maryland. Dredged materials would be deposited at the approved Mariner Point Park dredged material placement site located at Mariner Point Park in Joppatowne, Harford County, Maryland. The applicant is also requesting authorization for maintenance dredging for a period of 10 years.

**Project Purpose:** To improve navigable access within the area to be dredged.

**Avoidance/Minimization of Impacts:** Turbidity curtains would be utilized within narrower reaches of Taylor Creek during dredging operations to restrict marine life from entering the areas being dredged and, to reduce/minimize the release of sediment from the project site into adjacent waters.

All work would be completed in accordance with the enclosed plans dated January 2017. If you have any questions concerning this matter, please contact Mr. Steve Elinsky, CENAB-OPR-M, 2 Hopkins Plaza, Baltimore, Maryland, 21201 or [steve.elinsky@usace.army.mil](mailto:steve.elinsky@usace.army.mil).

The decision whether to issue a permit will be based on an evaluation of the probable impacts, including cumulative impacts of the proposed activity on the public interest. That decision will reflect the national concern for both protection and utilization of important resources. The benefit, which reasonable may be expected to accrue from the proposal, must be balanced against its reasonably foreseeable detriments. All factors, which may be relevant to the proposal will be considered, including the cumulative effects thereof; among those are conservation, economic, aesthetics, general environmental concerns, wetlands, cultural values, fish and wildlife values, flood hazards, flood plain values, land use, navigation, shoreline erosion and accretion, recreation, water supply and conservation, water quality, energy needs, safety, food and fiber production, mineral needs, and consideration of property ownership and in general, the needs and welfare of the people.

The evaluation of the impacts of the work described above on the public interest will include application of the Clean Water Act 404(b)(1) Guidelines promulgated by the Administrator, U.S. Environmental Protection Agency, under authority of Section 404 of the Clean Water Act.

The Corps of Engineers is soliciting comments from the public; Federal, State, and local agencies and officials; Indian Tribes; and other interested parties in order to consider and evaluate the impacts of this proposed activity. Any comments received will be considered by the Corps of Engineers to determine whether to issue, modify, condition or deny a permit for this proposal. To make this decision, comments are used to assess impacts on endangered species, historic properties, water quality, general environmental effects, and the other public interest factors listed above. Comments are used in the preparation of an Environmental Assessment and/or an Environmental Impact Statement pursuant to the National Environmental Policy Act. Comments provided will become part of the public record for this action. Comments are also used to determine the need for a public hearing and to determine the overall public interest of the proposed activity.

Written comments concerning the work described above related to the factors listed above or other pertinent factors must be received by the District Engineer, U.S. Army Corps of Engineers, Baltimore District, [Attn: Mr. Steve Elinsky, CENAB-OPR-M], 2 Hopkins Plaza, Baltimore, Maryland, 21201 or [steve.elinsky@usace.army.mil](mailto:steve.elinsky@usace.army.mil) within the comment period specified above.

**ESSENTIAL FISH HABITAT:** The Magnuson-Stevens Fishery Conservation and Management Act (MSFCMA), as amended by the Sustainable Fisheries Act of 1996 (Public Law 04-267), requires all Federal agencies to consult with the National Marine Fisheries Service (NMFS) on all actions, or proposed actions, permitted, funded, or undertaken by the agency that may adversely effect Essential Fish Habitat (EFH).

The project site lies in or adjacent to EFH as described under MSFCMA for windowpane flounder (*Scopthalmus aquosus*) juvenile and adult; blue fish (*Pomatomus saltatrix*) juvenile and adult; summer flounder (*Paralichthys dentatus*) juvenile and adult; and egg, larvae, juvenile and adult stages of red drum (*Sciaenops ocellatus*), king mackerel (*Scomberomorus cavalla*), spanish mackerel (*Scomberomorus maculatus*), and cobia (*Rachycentron canadum*), all managed species under the MSFCMA.

The project has the potential to adversely affect EFH or the species of concern by loss of spawning, nursery, forage and/or shelter habitat as described under the MSFCMA for the species and life stages identified above. The Baltimore District has made a preliminary determination that site-specific impacts would not be substantial and an abbreviated consultation will be conducted with NMFS. This determination may be modified if additional information indicates otherwise and would change the preliminary determination.

**WATER QUALITY CERTIFICATION:** The applicant is required to obtain a water quality certification in accordance with Section 401 of the Clean Water Act from the Maryland Department of the Environment (MDE). Any written comments concerning the work described above which relate to water quality certification must be received by the Wetlands and Waterways Program, Maryland Department of the Environment, Montgomery Park Business Center, 1800 Washington Boulevard, Suite 430, Baltimore, Maryland 21230-1708 within the comment period as specified above to receive consideration. MDE has a statutory limit of one year from the date of this public notice to make its decision.

**COASTAL ZONE MANAGEMENT PROGRAMS:** The applicant has certified in this application that the proposed activity complies with and will be conducted in a manner consistent with the approved Coastal Zone Management (CZM) Program. By this public notice, we are requesting the State concurrence or objection to the applicant's consistency statement. Public comments relating to consistency must be received by MDE, Tidal Wetlands Division, 1800 Washington Boulevard, Suite 430, Baltimore, Maryland 21230-1708 within the comment period as specified above to receive consideration. MDE has a statutory limit of 6 months from the date of this public notice to make its decision.

The applicant must obtain any State or local government permits which may be required.

A preliminary review of this application indicates that the proposed work will not affect Federal listed threatened or endangered species or their critical habitat, pursuant to Section 7 of the Endangered Species Act, as amended. As the evaluation of this application continues, additional information may become available which could modify this preliminary determination.

Review of the latest published version of the National Register of Historic Places indicates that no registered properties listed as eligible for inclusion, therein, are located at the site of the proposed work. Currently unknown archeological, scientific, prehistoric, or historical data may be lost or destroyed by the work to be accomplished under the request permit.

Any person who has an interest which may be adversely affected by the issuance of this permit may request a public hearing. The request, which must be in writing, must be received by the District Engineer, U.S. Army Corps of Engineers, Baltimore District, [Attn: Mr. Steve Elinsky, CENAB-OPR-M], 2 Hopkins Plaza, Baltimore, Maryland 21201, within the comment period as specified above to receive consideration. Also it must clearly set forth the interest which may be adversely affected by this activity and the manner in which the interest may be adversely affected.

It is requested that you communicate this information concerning the proposed work to any persons known by you to be interested and not being known to this office, who did not receive a copy of this notice.

FOR THE DISTRICT ENGINEER:

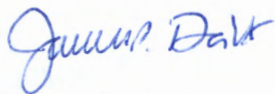

Joseph P. DaVia  
Chief, Maryland Section Northern



ADC MAP COORDINATES: MAP 28 GRIDS D-5,6,7, & E-6,7,

MAP COPYRIGHT © ADC THE MAP PEOPLE, (800) 829-6277  
 PERMITTED USE NUMBER 1022014

**MAINTENANCE DREDGING  
 AT  
 TAYLOR CREEK & RUMSEY ISLAND  
 HARFORD COUNTY, MARYLAND**

APPL. BY: HARFORD COUNTY DEPT. OF PARKS & REC.

**VICINITY MAP**

DATE: Revised February 2018 SHEET 1 OF 10

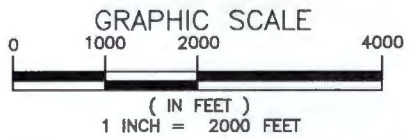

**Bayland**  
 Consultants & Designers, Inc.  
 "Integrating Engineering and Environment"

7455 New Ridge Road, Suite T Phone: (410) 694-9401  
 Hanover, Maryland 21076 Fax: (410) 694-9405  
 www.baylandinc.com

Z:\4\_3302\_TAYLOR\_CREEK\_WEST\_CHANNEL\_DREDGING\CAD FILES\SHEET FILES\9\_80001\_IP01.DWG

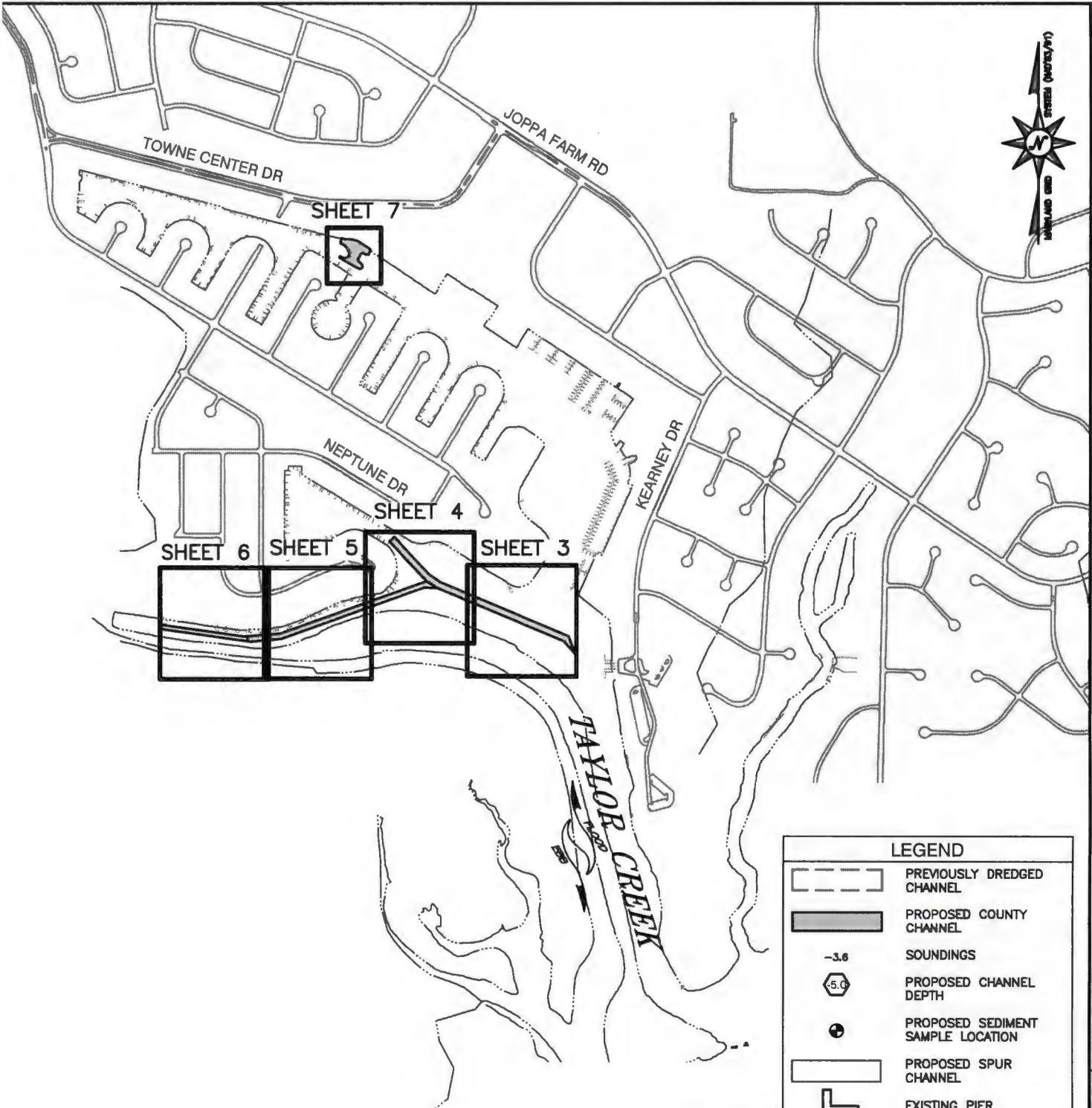

MAINTENANCE DREDGING  
AT  
TAYLOR CREEK & RUMSEY ISLAND  
HARFORD COUNTY, MARYLAND

APPL. BY: HARFORD COUNTY DEPT. OF PARKS & REC.

KEY SHEET

DATE: Revised February 2018 SHEET 2 OF 10

LEGEND	
	PREVIOUSLY DREDGED CHANNEL
	PROPOSED COUNTY CHANNEL
	SOUNDINGS
	PROPOSED CHANNEL DEPTH
	PROPOSED SEDIMENT SAMPLE LOCATION
	PROPOSED SPUR CHANNEL
	EXISTING PIER
	SPUR NUMBER
	EXISTING SHORELINE
	APPROX. PROPERTY LINES
	COMMUNITY BOAT RAMP
	EXISTING BOAT LIFT
	EXISTING PILING

NOTE:  
BASEMAP TAKEN FROM HARFORD COUNTY  
PLANIMETRICS AND IMAGERY.

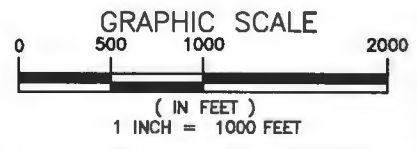

**Hayland**  
Consultants & Designers, Inc.  
"Integrating Engineering and Environment"

7455 New Ridge Road, Suite T Phone: (410) 694-9401  
Hanover, Maryland 21076 Fax: (410) 694-9405  
www.haylandinc.com

Z:\4\_3302\_TAYLOR\_CREEK\_CHANNEL\_DREDGING\CAD FILES\SHEET FILES\0\_50001 JP002.DWG

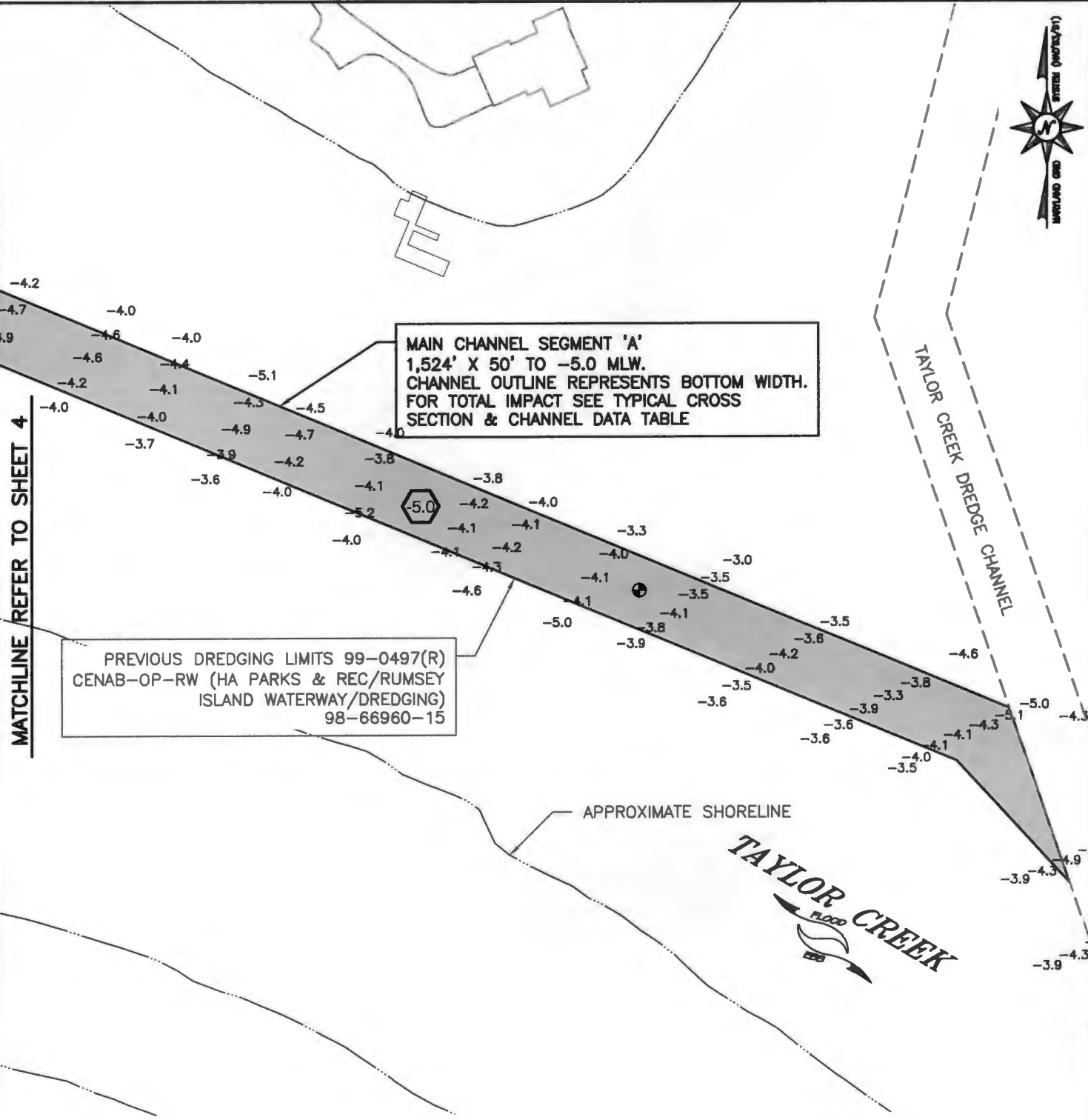

**MAIN CHANNEL SEGMENT 'A'**  
 1,524' X 50' TO -5.0 MLW.  
 CHANNEL OUTLINE REPRESENTS BOTTOM WIDTH.  
 FOR TOTAL IMPACT SEE TYPICAL CROSS  
 SECTION & CHANNEL DATA TABLE

PREVIOUS DREDGING LIMITS 99-0497(R)  
 CENAB-OP-RW (HA PARKS & REC/RUMSEY  
 ISLAND WATERWAY/DREDGING)  
 98-66960-15

MATCHLINE REFER TO SHEET 4

TAYLOR CREEK DREDGE CHANNEL

APPROXIMATE SHORELINE

**TAYLOR CREEK**  
 FLOOD

**MAINTENANCE DREDGING  
 AT  
 TAYLOR CREEK & RUMSEY ISLAND  
 HARFORD COUNTY, MARYLAND**

APPL. BY: HARFORD COUNTY DEPT. OF PARKS & REC.

**MAIN CHANNEL PLAN**

DATE: Revised February 2018 SHEET 3 OF 10

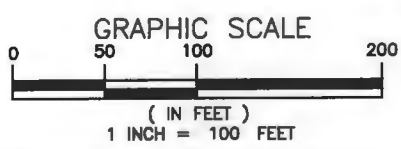

**NOTE:**  
 BASEMAP TAKEN FROM HARFORD COUNTY  
 PLANIMETRICS AND IMAGERY.

**Bayland**  
 Consultants & Designers, Inc.  
*"Integrating Engineering and Environment"*

7455 New Ridge Road, Suite T Phone: (410) 694-9401  
 Hanover, Maryland 21076 Fax: (410) 694-9405  
 www.baylandinc.com

Z:\V\_3302\_TAYLOR\_CREEK\_WEST\_CHANNEL\_DREDGING\CAD FILES\SHEET FILES\9\_160001\_JPAC4.DWG



**MAIN CHANNEL SEGMENT 'A'**  
 1,524' X 50' TO -5.0 MLW.  
 CHANNEL OUTLINE REPRESENTS BOTTOM WIDTH.  
 FOR TOTAL IMPACT SEE TYPICAL CROSS  
 SECTION & CHANNEL DATA TABLE

PREVIOUS DREDGING LIMITS 99-0497(R)  
 CENAB-OP-RW (HA PARKS & REC/RUMSEY  
 ISLAND WATERWAY/DREDGING)  
 98-66960-15

**MAIN CHANNEL SEGMENT 'B'**  
 1,422' X 40' TO -5.0 MLW.  
 CHANNEL OUTLINE REPRESENTS BOTTOM WIDTH.  
 FOR TOTAL IMPACT SEE TYPICAL CROSS  
 SECTION & CHANNEL DATA TABLE

MATCHLINE REFER TO SHEET 5

MATCHLINE REFER TO SHEET 3

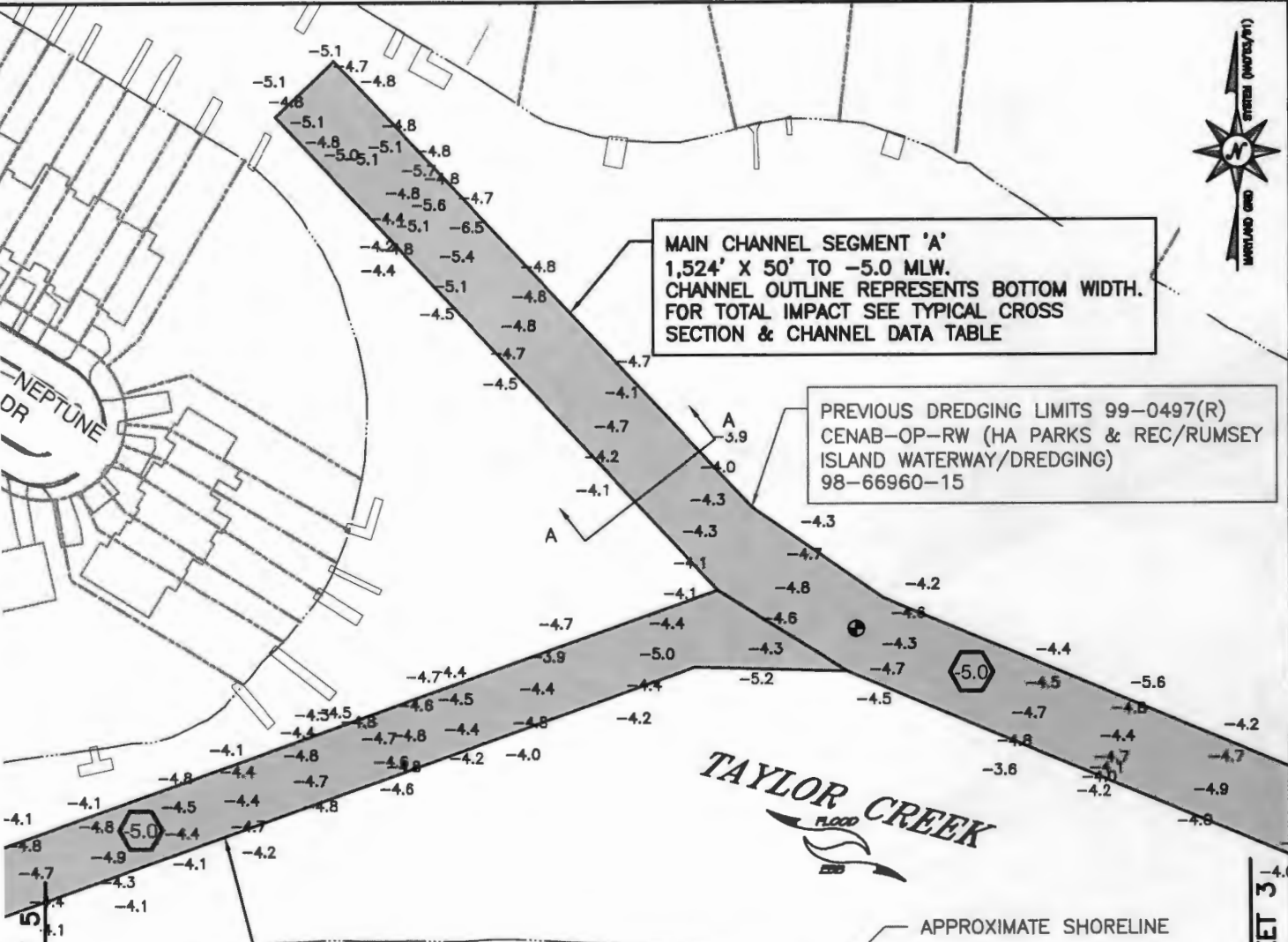

**TAYLOR CREEK**

APPROXIMATE SHORELINE

**MAINTENANCE DREDGING  
 AT  
 TAYLOR CREEK & RUMSEY ISLAND  
 HARFORD COUNTY, MARYLAND**

APPL. BY: HARFORD COUNTY DEPT. OF PARKS & REC.

**MAIN CHANNEL PLAN**

DATE: Revised February 2018 SHEET 4 OF 10

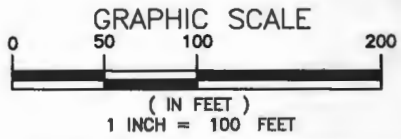

NOTE:  
 BASEMAP TAKEN FROM HARFORD COUNTY  
 PLANIMETRICS AND IMAGERY.

**Bayland**  
 Consultants & Designers, Inc.  
*"Integrating Engineering and Environment"*  
 7455 New Ridge Road, Suite T Phone: (410) 694-9401  
 Hanover, Maryland 21076 Fax: (410) 694-9405  
 www.baylandinc.com

Z:\4\_3302-TAYLOR\_CREEK\_WEST\_CHANNEL\_DREDGING\CAD FILES\SHEET FILES\0\_60001-UPAD05.DWG





NEPTUNE DR

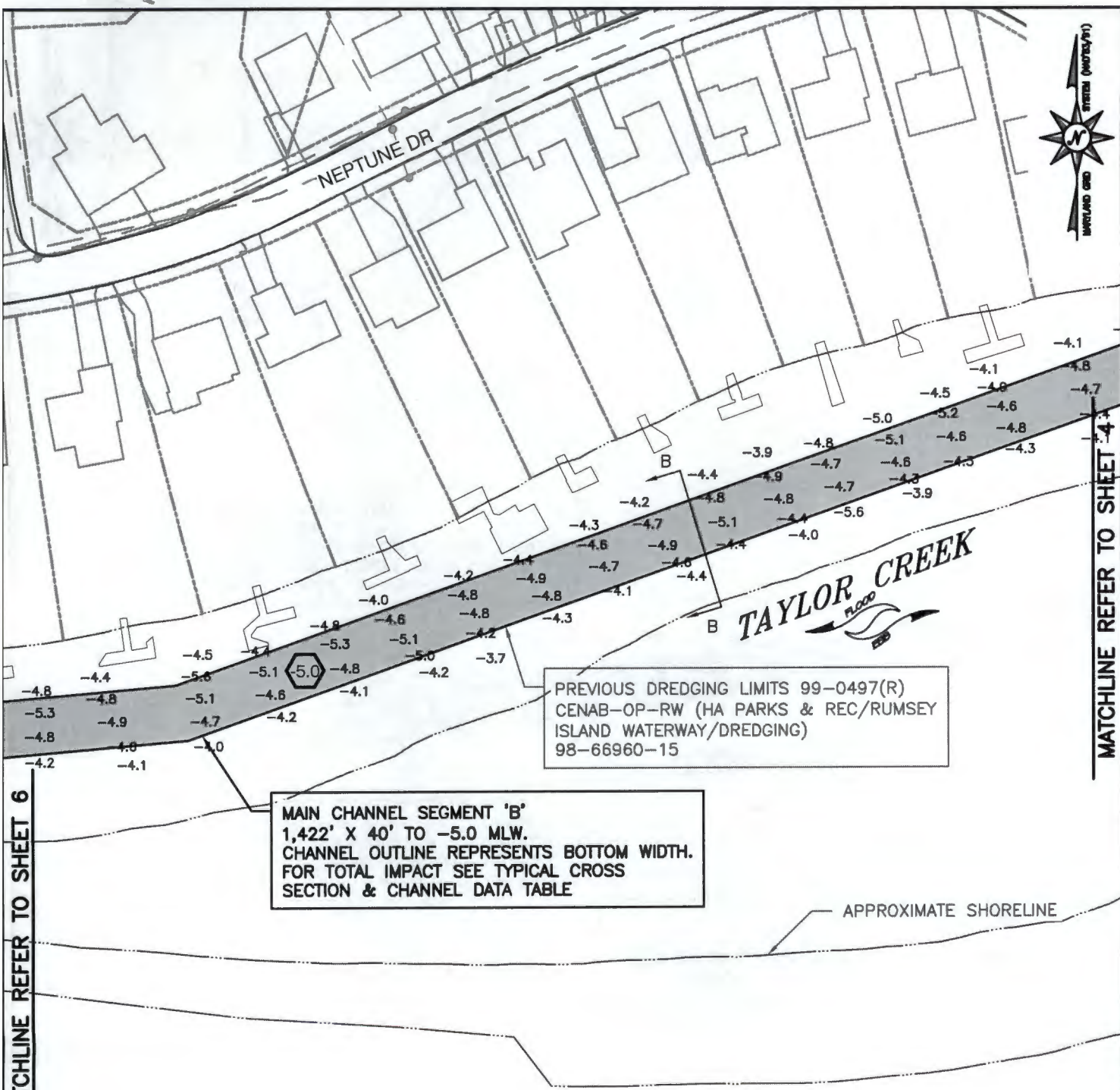

MATCHLINE REFER TO SHEET 4

MATCHLINE REFER TO SHEET 6

PREVIOUS DREDGING LIMITS 99-0497(R)  
CENAB-OP-RW (HA PARKS & REC/RUMSEY  
ISLAND WATERWAY/DREDGING)  
98-66960-15

MAIN CHANNEL SEGMENT 'B'  
1,422' X 40' TO -5.0 MLW.  
CHANNEL OUTLINE REPRESENTS BOTTOM WIDTH.  
FOR TOTAL IMPACT SEE TYPICAL CROSS  
SECTION & CHANNEL DATA TABLE

APPROXIMATE SHORELINE

# MAINTENANCE DREDGING AT TAYLOR CREEK & RUMSEY ISLAND HARFORD COUNTY, MARYLAND

APPL. BY: HARFORD COUNTY DEPT. OF PARKS & REC.

## MAIN CHANNEL PLAN

DATE: Revised February 2018 SHEET 5 OF 10

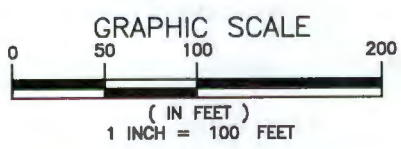

NOTE:  
BASEMAP TAKEN FROM HARFORD COUNTY  
PLANIMETRICS AND IMAGERY.

**Bayland**  
Consultants & Designers, Inc.  
"Integrating Engineering and Environment"

7455 New Ridge Road, Suite T Phone: (410) 694-9401  
Hanover, Maryland 21076 Fax: (410) 694-9485  
www.baylandinc.com

Z:\4\_3302\_TAYLOR\_CREEK\_WEST\_CHANNEL\_DREDGING\CAD FILES\SHEET FILES\9\_60001 JP406.DWG



NEPTUNE DR

APPROXIMATE SHORELINE

MAIN CHANNEL SEGMENT 'B'  
1,422' X 40' TO -5.0 MLW.  
CHANNEL OUTLINE REPRESENTS BOTTOM WIDTH.  
FOR TOTAL IMPACT SEE TYPICAL CROSS  
SECTION & CHANNEL DATA TABLE

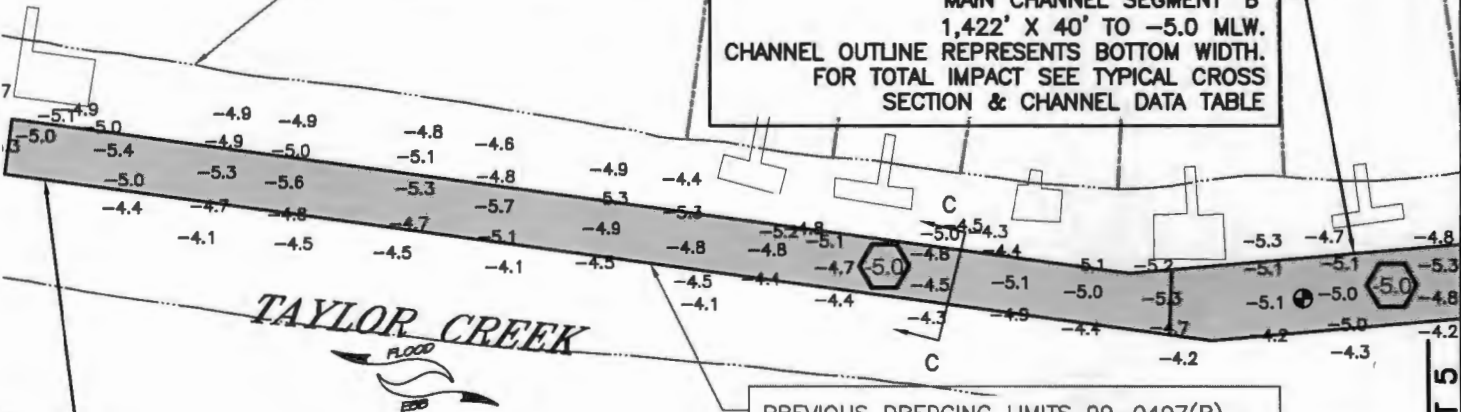

PREVIOUS DREDGING LIMITS 99-0497(R)  
CENAB-OP-RW (HA PARKS & REC/RUMSEY  
ISLAND WATERWAY/DREDGING)  
98-66960-15

MAIN CHANNEL SEGMENT 'C'  
637' X 30' TO -5.0 MLW.  
CHANNEL OUTLINE REPRESENTS BOTTOM WIDTH.  
FOR TOTAL IMPACT SEE TYPICAL CROSS  
SECTION & CHANNEL DATA TABLE

MATCHLINE REFER TO SHEET 5

# MAINTENANCE DREDGING AT TAYLOR CREEK & RUMSEY ISLAND HARFORD COUNTY, MARYLAND

APPL. BY: HARFORD COUNTY DEPT. OF PARKS & REC.

## MAIN CHANNEL PLAN

DATE: Revised February 2018 SHEET 6 OF 10

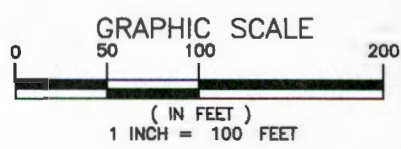

NOTE:  
BASEMAP TAKEN FROM HARFORD COUNTY  
PLANIMETRICS AND IMAGERY.

**Boyd and**  
Consultants & Designers, Inc.  
"Integrating Engineering and Environment"

7455 New Ridge Road, Suite T      Phone: (410) 694-9401  
Hanover, Maryland 21076      Fax: (410) 694-9405  
www.boydinc.com

Z:\1-3302-TAYLOR\_CREEK\_WEST\_CHANNEL\_DREDGING\CAD\_FILES\SHEET\_FILES\SHEET 6.DWG



APPROXIMATE SHORELINE

EX. STORM-WATER PIPE (TYP)

RUMSEY OUTFALL DREDGE AREA  
28,960 SF TO -5.5 MLW.  
OUTLINE REPRESENTS BOTTOM WIDTH.

PREVIOUS DREDGING LIMITS 10-WL-0409  
CENAB-OP-RMN (HA PARKS & REC/RUMSEY  
ISLAND/DREDGING) 2009-63227-M06

APPROXIMATE LOCATION OF  
PR. TURBIDITY CURTAIN

TAYLOR CREEK  
FLOOD

# MAINTENANCE DREDGING AT TAYLOR CREEK & RUMSEY ISLAND HARFORD COUNTY, MARYLAND

APPL. BY: HARFORD COUNTY DEPT. OF PARKS & REC.

## RUMSEY OUTFALL PLAN

DATE: Revised February 2018 SHEET 7 OF 10

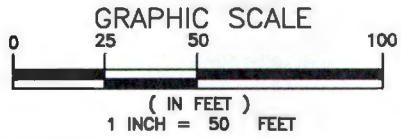

NOTE:  
BASEMAP TAKEN FROM HARFORD COUNTY  
PLANIMETRICS AND IMAGERY.

**Bayland**  
Consultants & Designers, Inc.  
"Integrating Engineering and Environment"

7455 New Ridge Road, Suite T Phone: (410) 694-9401  
Hanover, Maryland 21076 Fax: (410) 694-9405  
www.baylandinc.com

Z:\\_3002\_TAYLOR\_CREEK\_WEST\_CHANNEL\_DREDGING\CAD FILES\SHEET FILES\9\_50001\_IP108.DWG

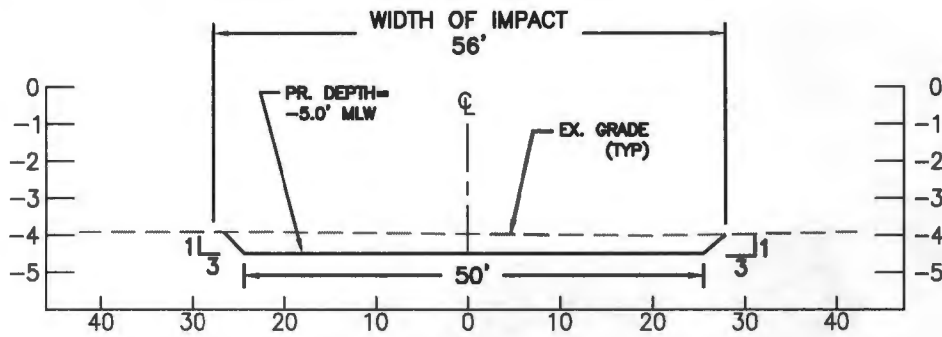

## SECTION A-A

SCALE: NTS

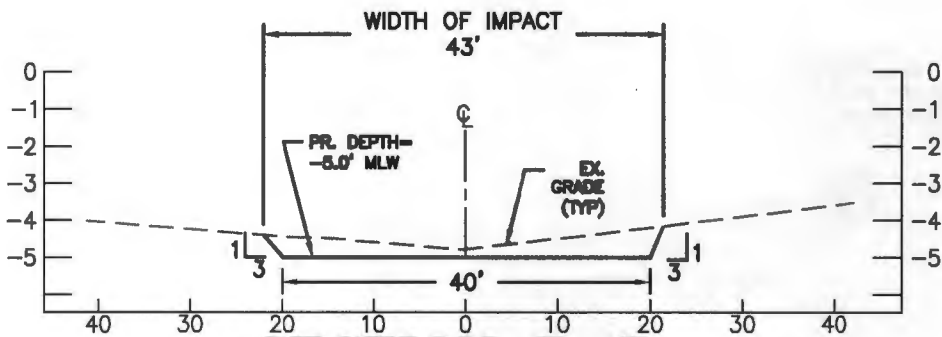

## SECTION B-B

SCALE: NTS

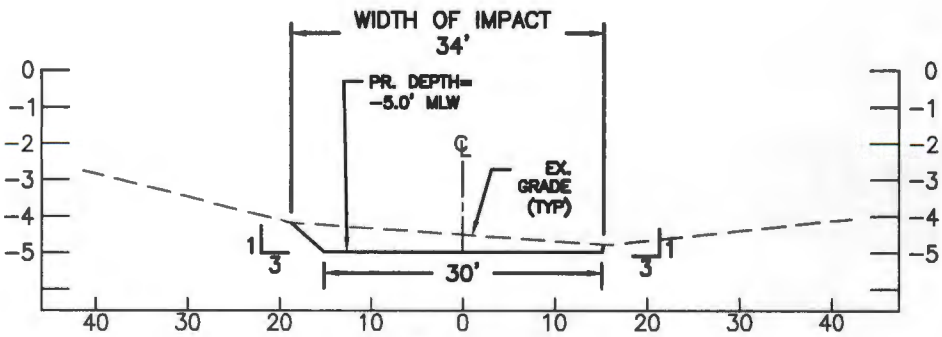

## SECTION C-C

SCALE: NTS

MAINTENANCE DREDGING  
AT  
TAYLOR CREEK & RUMSEY ISLAND  
HARFORD COUNTY, MARYLAND

APPL. BY: HARFORD COUNTY DEPT. OF PARKS & REC.

CROSS SECTIONS

DATE: Revised February 2018 SHEET 8 OF 10

**BayLand**  
Consultants & Designers, Inc.  
"Integrating Engineering and Environment"

7455 New Ridge Road, Suite T Phone: (410) 694-9401  
Hanover, Maryland 21076 Fax: (410) 694-9405  
www.baylandinc.com

Z:\\_3502-TAYLOR\_CREEK\_WEST\_CHANNEL\_DREDGING\CAD\_FILES\SHEET\_FILES\0\_50001\_IPA10.DWG

### TAYLOR CREEK CHANNEL DETAILS

CHANNEL	LENGTH (FT)	WIDTH (FT)	DEPTH (FT)	VOLUME (CY)
SEGMENT A	1524	50	-5.0'	3000
SEGMENT B	1422	40	-5.0'	1000
SEGMENT C	637	30	-5.0'	200
TOTAL MAIN CHANNEL LENGTH				3,583 LF
TOTAL MAIN CHANNEL VOLUME				4,200 CY
TOTAL AREA OF IMPACT				165,356 SF = 3.8 AC

### RUMSEY ISLAND OUTFALL DETAILS

CHANNEL	DEPTH (FT)	VOLUME (CY)
SEGMENT C	-5.5'	1000 ±
TOTAL MAIN CHANNEL VOLUME		1000 ±
TOTAL AREA OF IMPACT		28,960 SF = 0.66 AC

#### NOTES

1. BASEMAP COMPILED FROM HARFORD COUNTY GIS AND IMAGERY.
2. SOUNDINGS ARE IN FEET AND REFER TO MLW.
3. TIDAL RANGE 1.25 FEET.
4. TOPOGRAPHIC AND BATHYMETRIC SURVEYS PERFORMED BY DNR ON 12/08/2014.
5. MATERIAL WILL BE PLACED AT MARINER POINT PARK DMP SITE.
6. THESE ARE PERMIT DRAWINGS ONLY AND SUBJECT TO CHANGE DURING THE PERMIT PROCESS. DESIGN DRAWINGS ARE TO BE PREPARED SEPARATELY.

**MAINTENANCE DREDGING  
 AT  
 TAYLOR CREEK & RUMSEY ISLAND  
 HARFORD COUNTY, MARYLAND**

APPL. BY: HARFORD COUNTY DEPT. OF PARKS & REC.

#### CHANNEL DETAILS

DATE: Revised February 2018 SHEET 9 OF 10



**A-Z Land**  
 Consultants & Designers, Inc.  
*"Integrating Engineering and Environment"*

7455 New Ridge Road, Suite T      Phone: (410) 694-9401  
 Hanover, Maryland 21076      Fax: (410) 694-9405  
 www.haylandinc.com

Z:\4\_3302\_TAYLOR\_CREEK\_WEST\_CHANNEL\_DREDGING\CAD FILES\SHEET FILES\9\_30001 JP003.DWG

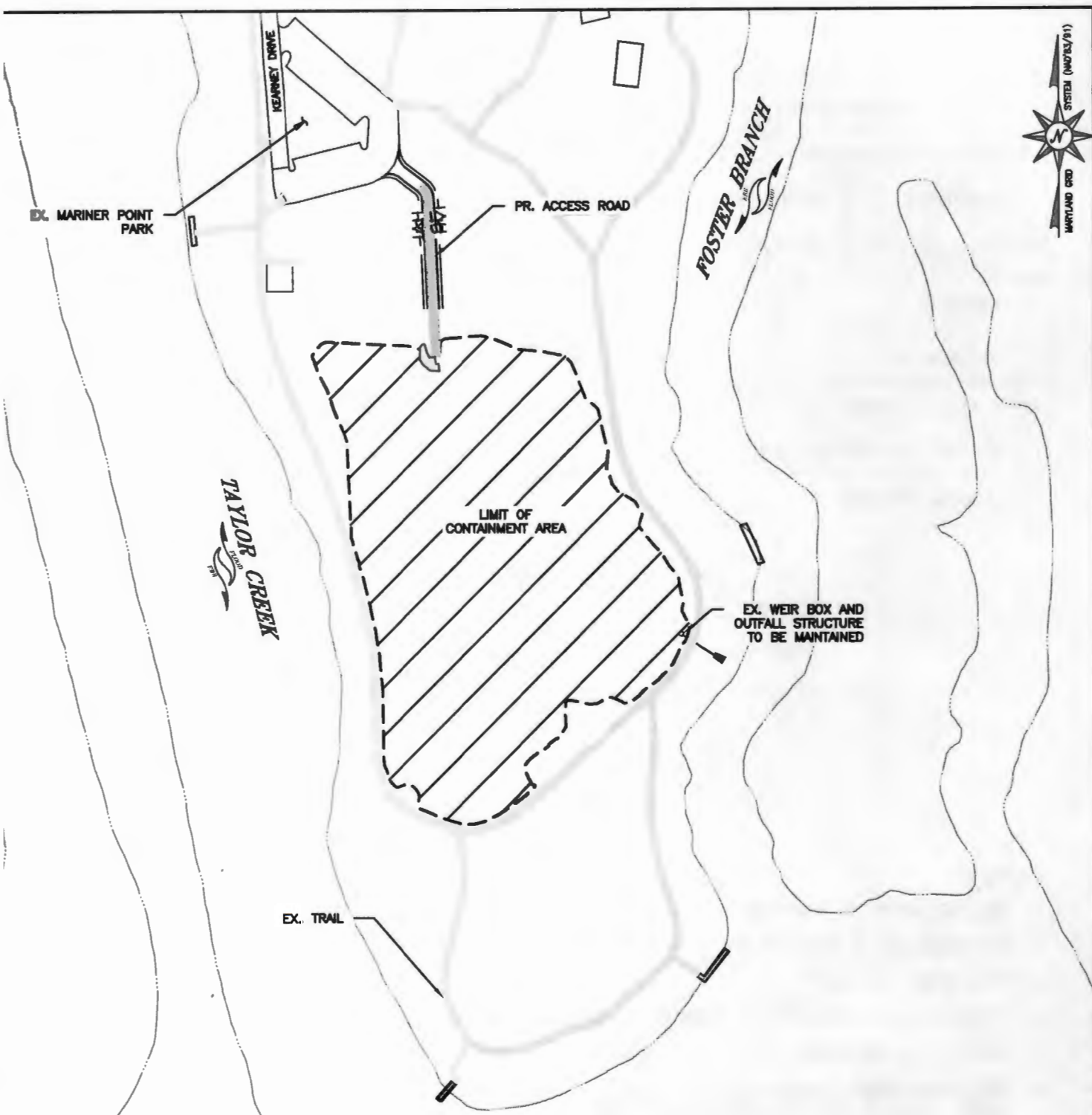

**MAINTENANCE DREDGING  
AT  
TAYLOR CREEK & RUMSEY ISLAND  
HARFORD COUNTY, MARYLAND**

APPL. BY: HARFORD COUNTY DEPT. OF PARKS & REC.  
MARINER POINT PARK  
DREDGED MATERIAL PLACEMENT SITE  
DATE: Revised February 2018 SHEET 10 OF 10

- NOTES:**
1. THE ESTIMATED AVAILABLE VOLUME AT THE MARINER POINT PARK DMP SITE IS APPROXIMATELY 28,260 CY. BASED ON DECEMBER 2015 SURVEY AND SUBSEQUENT DREDGING PROJECTS OF GUNPOWDER RIVER AND TAYLOR CREEK.

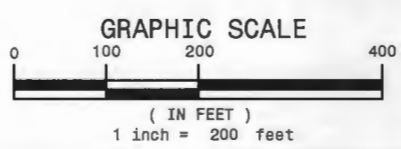

**NOTE:**  
BASEMAP TAKEN FROM HARFORD COUNTY  
PLANIMETRICS AND IMAGERY.

7455 New Ridge Road, Suite T  
Hanover, Maryland 21076  
www.baylandinc.com

Phone: (410) 694-9401  
Fax: (410) 694-9405

E:\4\_3502\_TAYLOR\_CREEK\_WEST\_CHANNEL\_DREDGING\CAD FILES\SHEET FILES\9\_50001\_IPA00.DWG