



Spring Valley

Formerly Used Defense Site

Groundwater Study Isoconcentration Maps

Purpose: The purpose of the Spring Valley Formerly Used Defense Site (FUDS) groundwater study is to identify the nature and extent of groundwater contamination, possibly related to past Department of Defense activities in the FUDS.

Perchlorate: To date, perchlorate is the primary contaminant of concern in groundwater located in the Spring Valley FUDS. While perchlorate has many present day uses that could contribute to the groundwater contamination, it may have also been used at the American University Experiment Station during World War I. Perchlorate has been found at levels above the interim drinking water health advisory limit of 15 ug/L in two areas of the Spring Valley FUDS.

Isoconcentration map: An isoconcentration map is one of many various interpretation tools that can be used in studying groundwater and groundwater contaminants. The maps included in the following pages are maps of the two areas where perchlorate has been found above 15 ug/L in the Spring Valley FUDS. The contour lines mark the approximate locations of equal concentrations of perchlorate. The included mapped perchlorate contour lines marked at the 5, 15, 50, and 100 ug/L intervals are a professional's interpretation based on the available data. Therefore, the earlier maps (2005 & 2006) have less complete contour information, as fewer sampling points were available for testing. As more wells were installed in subsequent years, particularly in the American University area, more data were available to use in interpreting the approximate locations of perchlorate contours. The following maps of isoconcentration curves should be considered working interpretations that could easily change as new data becomes available; they have not been formally reviewed by the U.S. Environmental Protection Agency or the District Department of the Environment.

For more information on the groundwater study and other project efforts, please contact the Community Outreach team at (410) 962-0157.

Spring Valley FUDS Groundwater Study

American University area perchlorate contours: 2005 & 2006

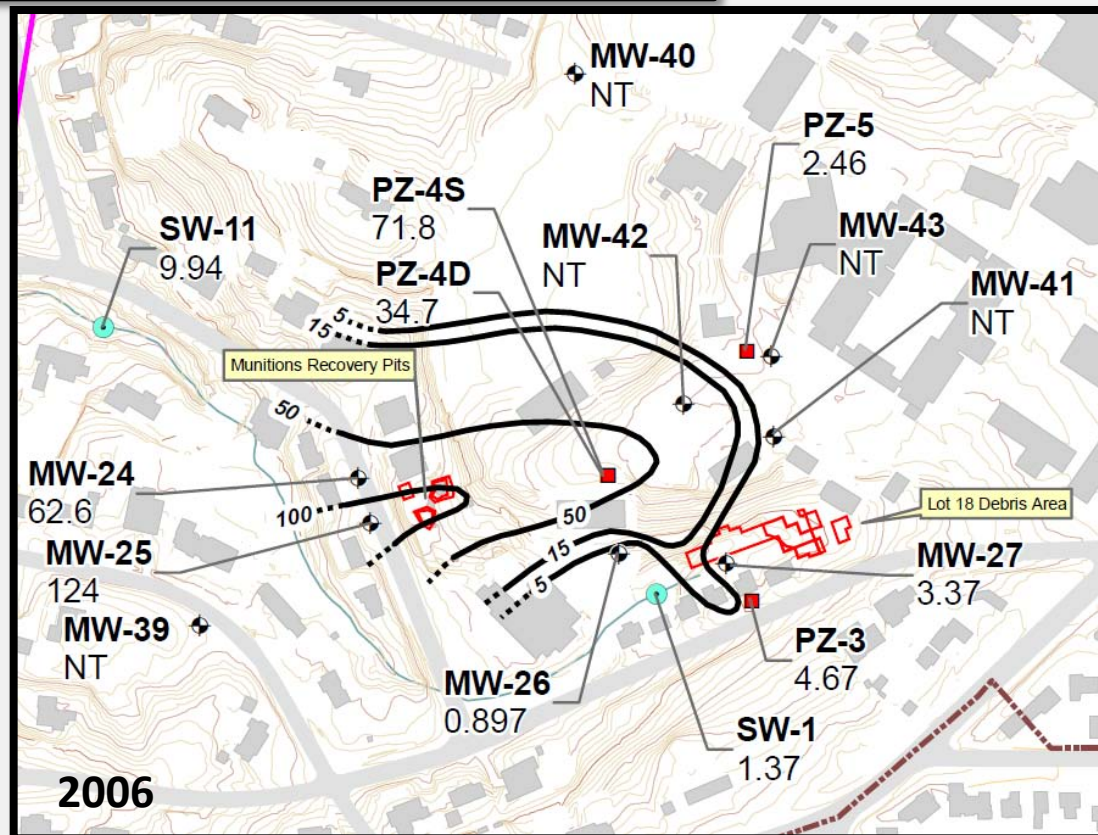
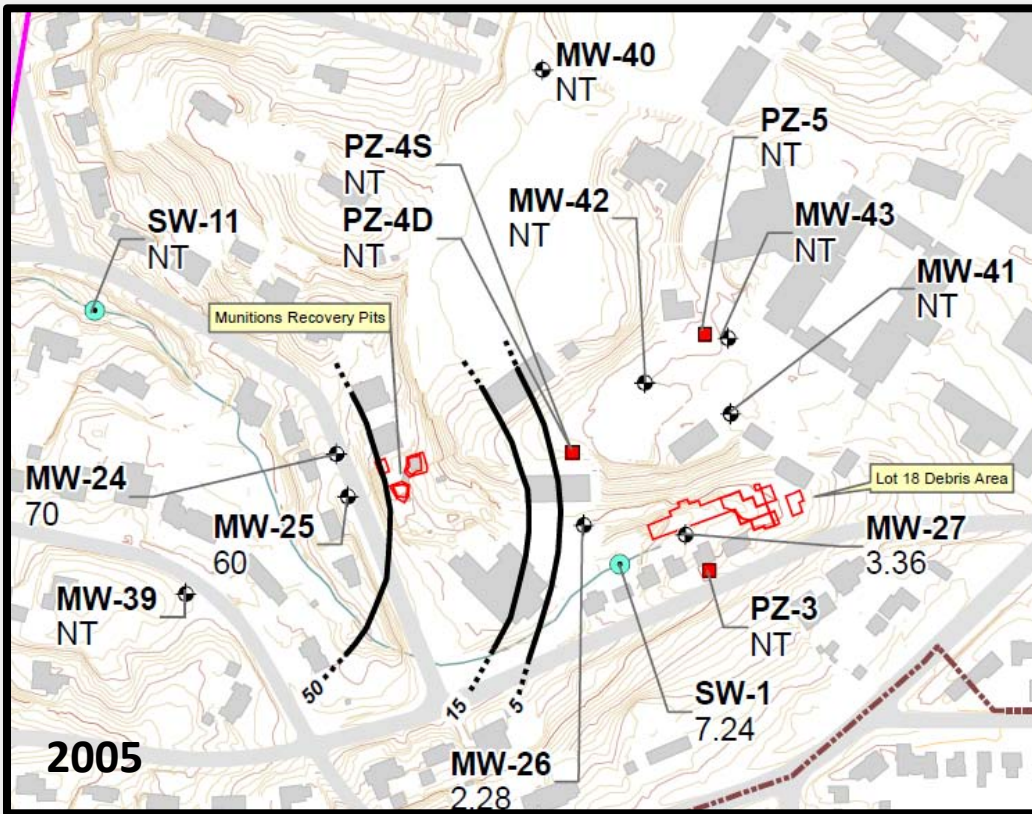

Spring Valley FUDS Groundwater Study

American University area perchlorate contours: 2007 & 2009

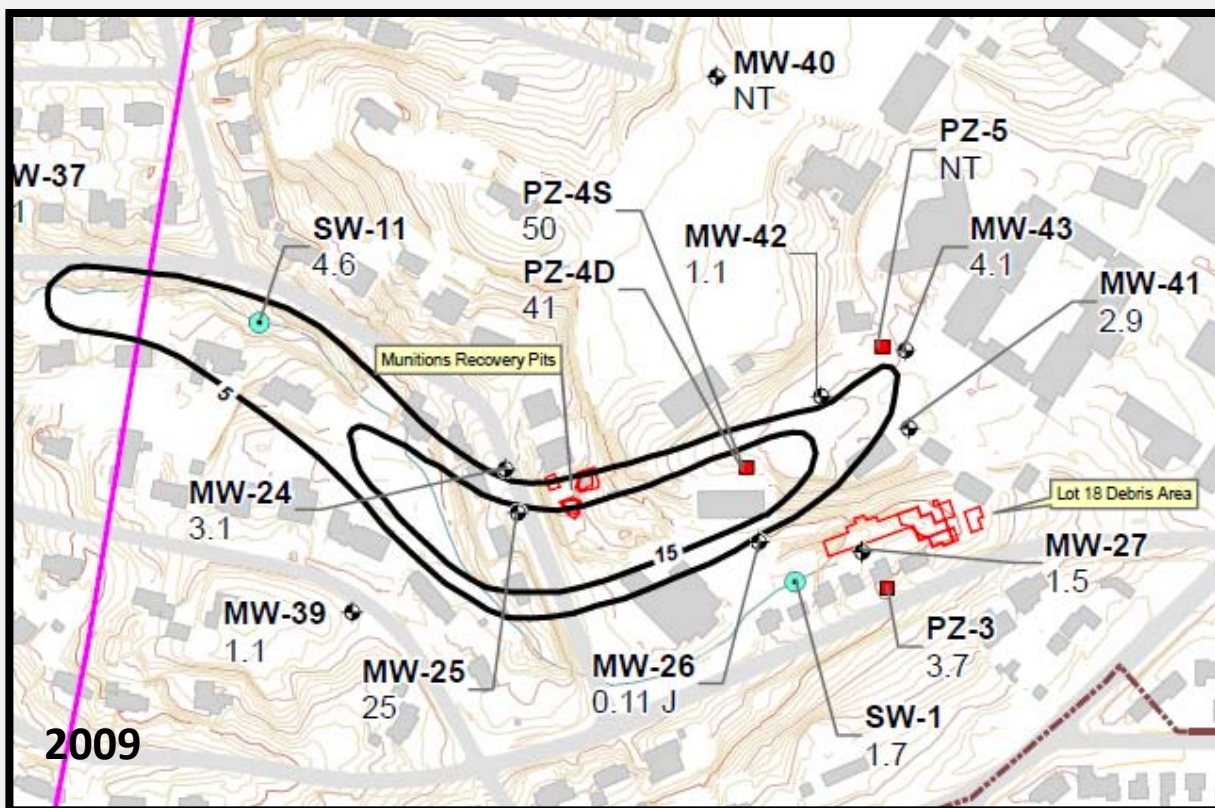
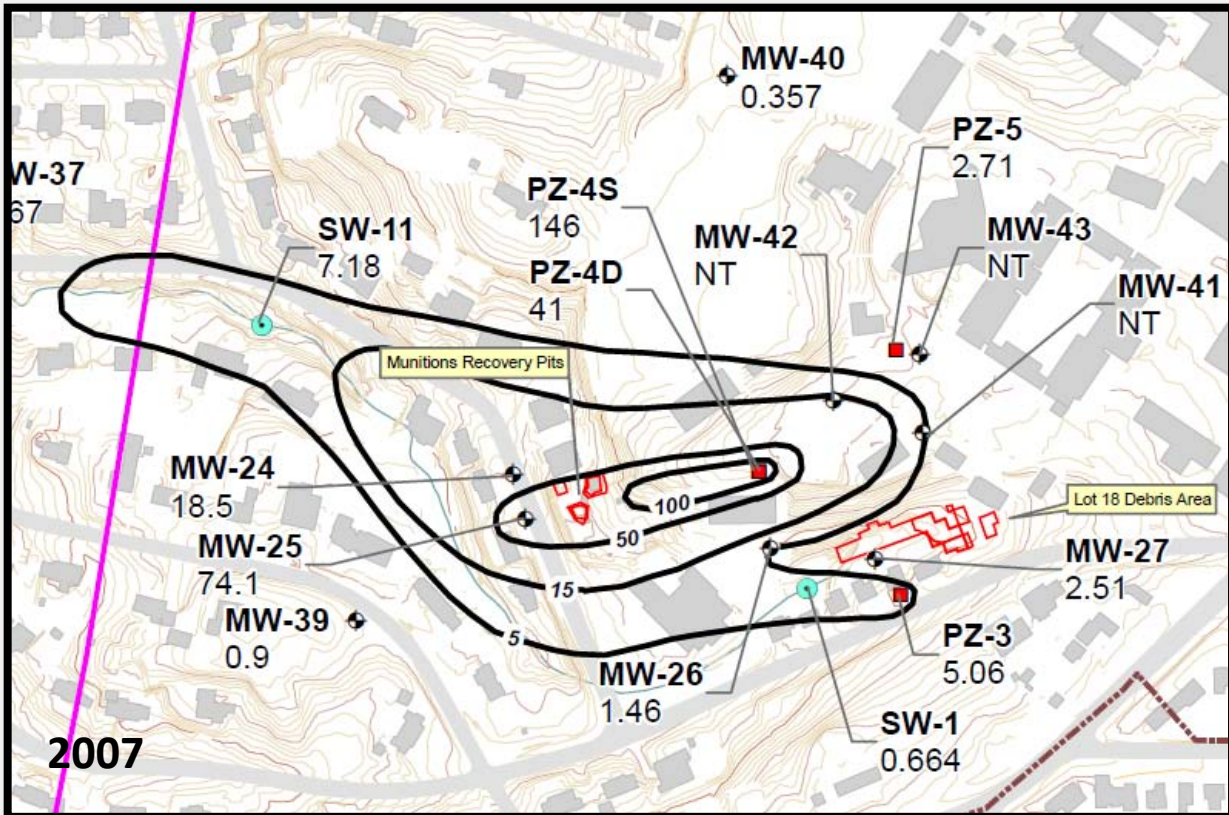

Spring Valley FUDS Groundwater Study

Sibley Sump area perchlorate contours: 2005 & 2006

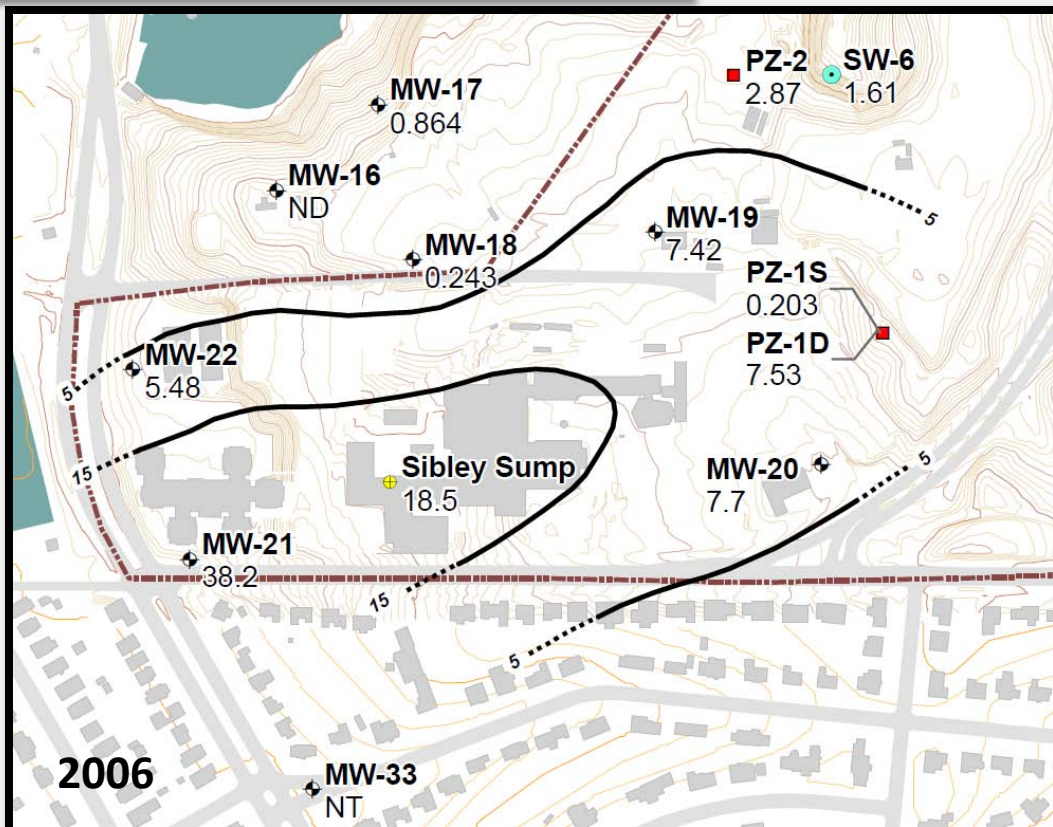
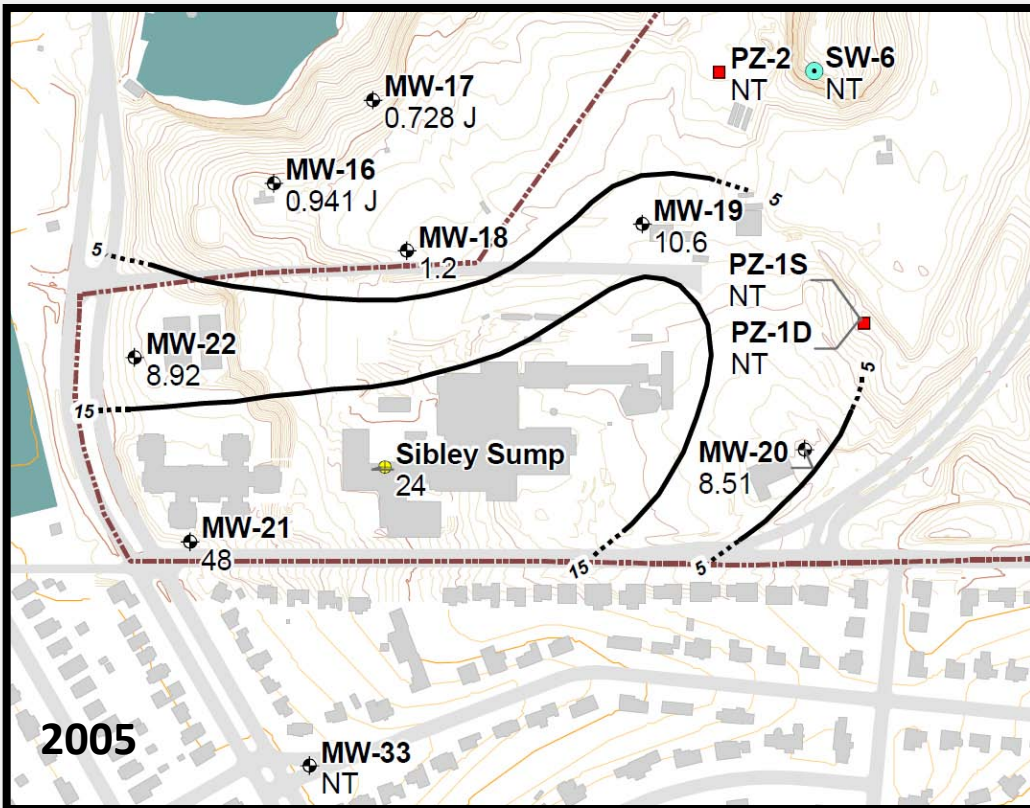

Spring Valley FUDS Groundwater Study

Sibley Sump area perchlorate contours: 2007 & 2009

