

**DEEP COVE**

**APPLICATION BY:**  
**JAMES GOULD**  
**1051 DEEP CREEK AVENUE**  
**ARNOLD, MD 21012**

CHESTER DAILEY & MELISSA REESE  
 1043 DEEP CREEK AVENUE  
 ARNOLD, MD 21012

CHRIS & MEGAN HOPKINSON  
 1061B DEEP CREEK AVENUE  
 ARNOLD, MD 21012

**SPUR DATA**

AREA = 849 SF  
 VOLUME = 14 CY  
 2020 SAV IMPACT = 849 SF

**SAV LEGEND**

COMPOSITE SAV BED FROM SPRING AND SUMMER SAV SURVEY 2020  
 SPRING SURVEY DATE: MAY 13, 2020  
 SUMMER SURVEY DATES: JULY 15, 2020

**NOTE:**

1. ADDITIONAL DETAILS INCLUDING SIDE SLOPES AND CROSS SECTION HAVE BEEN ADDED TO GRAPHICALLY REPRESENT IMPACTS.

**NAB-2021-60568 (GOULD, JAMES)**  
**Sheet 1 of 1**  
**February 2021**

**LEGEND**

- 1.0 EXISTING DEPTH
- EXISTING PILING
- PROPOSED PILING
- BOTTOM CUT AREA
- SIDE SLOPE AREA

**NOTES:**

1. TIDAL RANGE IS 1.0 FEET.
2. SOUNDINGS ARE IN FEET AND REFER TO MLW.
3. MATERIAL WILL BE PLACED AT ROCK CREEK DMP SITE.
4. THESE ARE PERMIT DRAWINGS ONLY. DESIGN DRAWINGS WILL BE PREPARED SEPARATELY.
5. BASEMAP TAKEN FROM ANNE ARUNDEL COUNTY 2016 PLANIMETRICS AND 2017 IMAGERY.

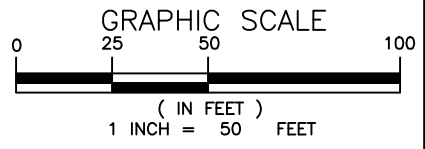

**Bayland**  
 Consultants & Designers, Inc.  
 "Integrating Engineering and Environment"  
 7455 New Ridge Road, Suite T Phone: (410) 694-9401  
 Hanover, Maryland 21076 Fax: (410) 694-9405  
 www.baylandinc.com

DEEP CREEK HEADWATERS & COVE SPURS  
 SPUR 3  
 JAMES GOULD  
 1051 DEEP CREEK AVENUE  
 ARNOLD, MD 21012  
 FEBRUARY 2021

Z:\5\_18501\_DEEP\_CREEK\_HW\_&\_COVE\_DREDGING\CAD FILES\SHEET FILES\5\_18501\_SPUR06.DWG

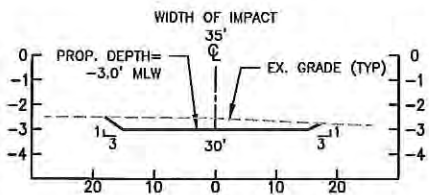

**SECTION A-A**  
SCALE: NTS

MARK JOHNSON &  
KRISTI BLEYER  
979 PHILLIPS DRIVE  
ARNOLD, MD 21012



**APPLICATION BY:**  
**GREG DUNHAM & ANDY PAYNE**  
**975 & 977 PHILLIPS DRIVE**  
**ARNOLD, MD 21012**

CHRIS & TAMARA DIMARIO  
973 PHILLIPS DRIVE  
ARNOLD, MD 21012

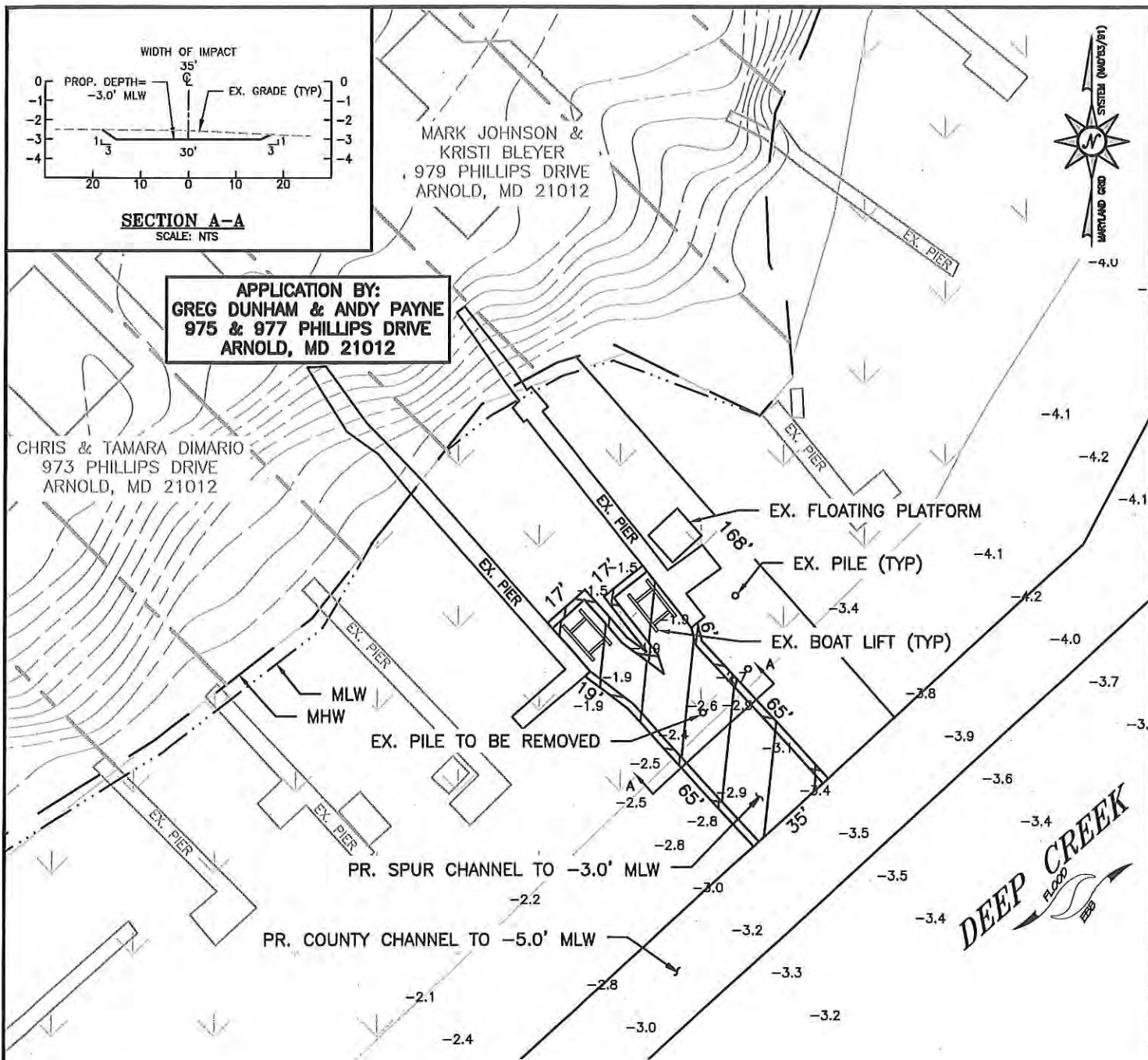

**SPUR DATA**

AREA = 3,612 SF  
VOLUME = 98 CY  
2020 SAV IMPACT = 2,155 SF

**LEGEND**

- 1.0 EXISTING DEPTH
- EXISTING PILING
- PROPOSED PILING

- BOTTOM CUT AREA
- SIDE SLOPE AREA

**SAV LEGEND**

COMPOSITE SAV BED FROM SPRING AND SUMMER SAV SURVEY 2020

SPRING SURVEY DATE: MAY 13, 2020

SUMMER SURVEY DATES: JULY 15, 2020

**NOTE:**

1. ADDITIONAL DETAILS INCLUDING SIDE SLOPES AND CROSS SECTION HAVE BEEN ADDED TO GRAPHICALLY REPRESENT IMPACTS.

**NAB-2021-60563 (DUNHAM & PAYNE)**  
**Sheet 1 of 1**  
**February 2021**

**NOTES:**

1. TIDAL RANGE IS 1.0 FEET.
2. SOUNDINGS ARE IN FEET AND REFER TO MLW.
3. MATERIAL WILL BE PLACED AT ROCK CREEK DMP SITE.
4. THESE ARE PERMIT DRAWINGS ONLY. DESIGN DRAWINGS WILL BE PREPARED SEPARATELY.
5. BASEMAP TAKEN FROM ANNE ARUNDEL COUNTY 2016 PLANIMETRICS AND 2017 IMAGERY.

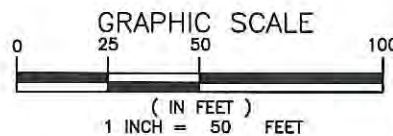

**Bayland**  
Consultants & Designers, Inc.  
"Integrating Engineering and Environment"  
7455 New Ridge Road, Suite T Phone: (410) 694-9401  
Hanover, Maryland 21076 Fax: (410) 694-9405  
www.baylandinc.com

DEEP CREEK HEADWATERS & COVE SPURS  
SPUR 6  
GREG DUNHAM & ANDY PAYNE  
975 & 977 PHILLIPS DRIVE  
ARNOLD, MD 21012  
FEBRUARY 2021