

DORCHESTER COUNTY, MD

INDEX TO MAPS

SITE

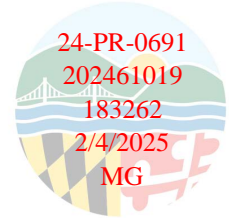

Pages 2, 3 and 4 provide you a complete Step-by-Step guide to using your Street Map Book, Map Legend, Contents and Key to Abbreviations. Take a few minutes to familiarize yourself with this time saving information.

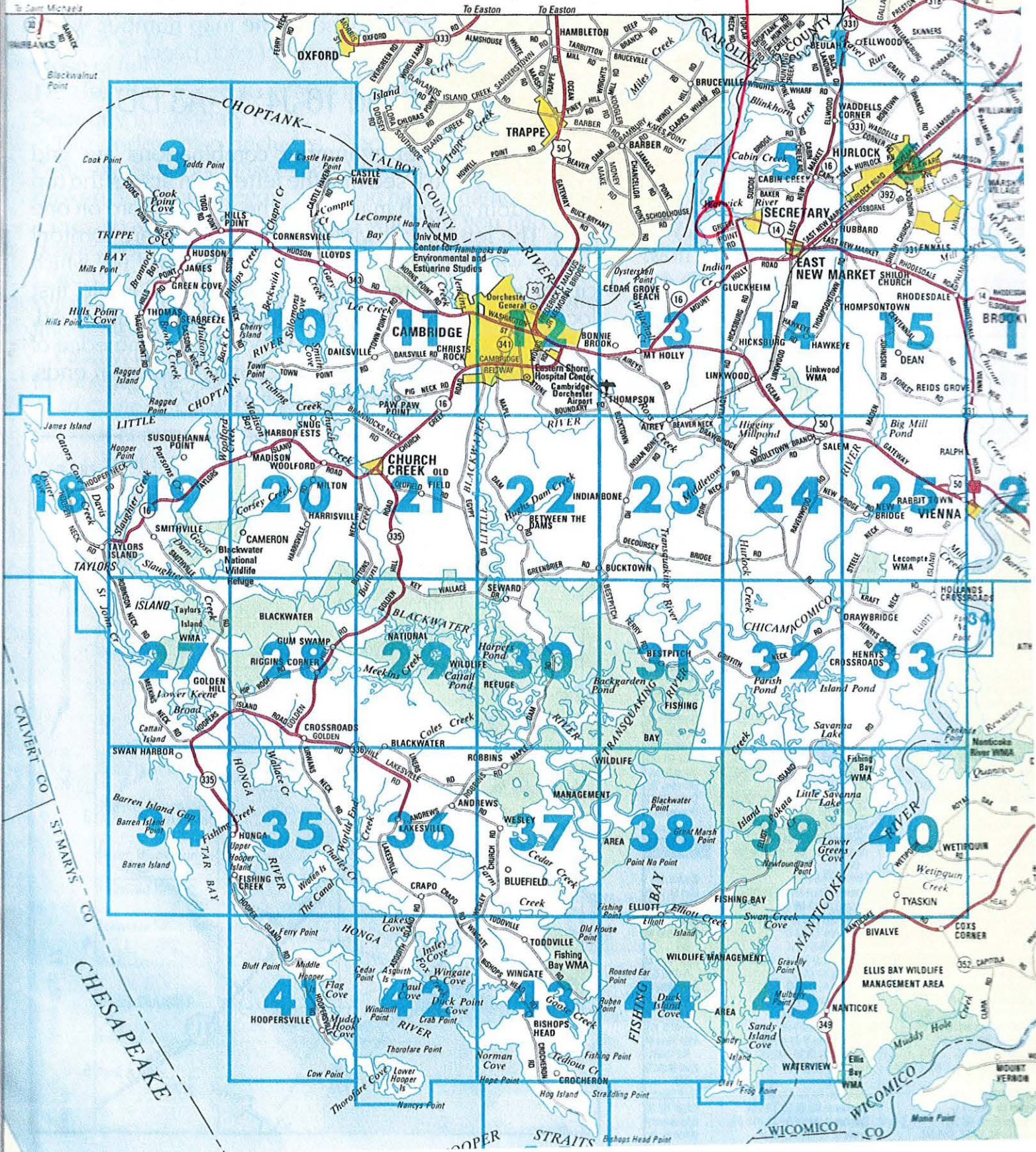



SITE
SECRETARY

21631

EAST NEW MARKET

WARWICK RIVER

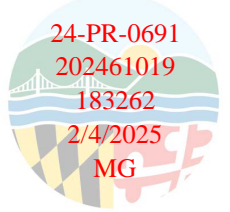

EBS
FLOOD

P. 240
LOT 2

P. 171

CHOPTANK RIVER

-4.0'
-2.0'

MHWL = 2.5'
MLWL = 0.0'

Jarrell T. Nobel
3702 Sunnyside Road
East New Market, Maryland 21231
2.0 ac. Lot 1
Map Grid Parcel Liber Folio
0021 0009 0240 00684 00308

-3.0'

-1.0'

ACCESS
TO PIER EASEMENT

PARKING AREA

Scott J. Hughes
6018 Blue Heron Drive
East New Market, Maryland 21631
2.04 ac. Lot 15
Map Grid Parcel Liber Folio
0021 0009 0002 00064 00007

Renato Canzon
3915 Legation St, NW
Washington, DC 20015
2.70 ac. Lot 14
Map Grid Parcel Liber Folio
0021 0009 0002 01674 00109

BLUE HERON DRIVE

EXISTING
CONDITIONS

POND

Sunset Cove HOA, Inc.
Blue Heron Drive
East New Market, Maryland 21631

Map Grid Parcel Liber Folio
0021 0009 0002 00064 00007

Goertemiller & Associates
P.O. Box 2752
Easton, Maryland 21601

Livingsystems1@gmail.com
Cell: 410-310-1842
Fax: 410-476-5742
Office: 410-476-4580

WARWICK RIVER

24-PR-0691
202461019
183262
2/4/2025
MG

PAGE 4 OF 9

P. 240
LOT 2

P. 171



CHOPTANK RIVER

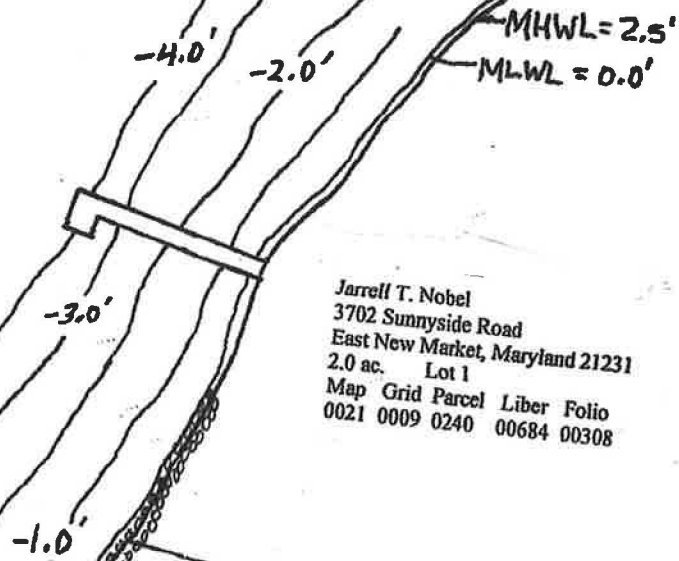

Jarrell T. Nobel
3702 Sunnyside Road
East New Market, Maryland 21231
2.0 ac. Lot 1
Map Grid Parcel Liber Folio
0021 0009 0240 00684 00308

ACCESS EASEMENT
TO PIER
PARKING AREA

Scott J. Hughes
6018 Blue Heron Drive
East New Market, Maryland 21631
2.04 ac. Lot 15
Map Grid Parcel Liber Folio
0021 0009 0002 00064 00007

Renato Canzon
3915 Legation St., NW
Washington, DC 20015
2.70 ac. Lot 14
Map Grid Parcel Liber Folio
0021 0009 0002 01674 00109

BLUE HERON DRIVE

PROPOSED
CONDITIONS

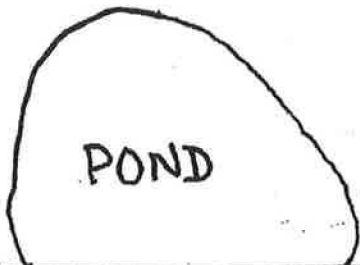

Sunset Cove HOA, Inc.
Blue Heron Drive
East New Market, Maryland 21631

Map Grid Parcel Liber Folio
0021 0009 0002 00064 00007

Goertemiller & Associates
P.O. Box 2752
Easton, Maryland 21601

Livingecosystems1@gmail.com
Cell: 410-310-1842
Fax: 410-476-5742
Office: 410-476-4580

FLOOD
FBB

CHOPTANK RIVER

PROPOSED CONDITIONS
FOR BOAT LIFTS

PLAN VIEW

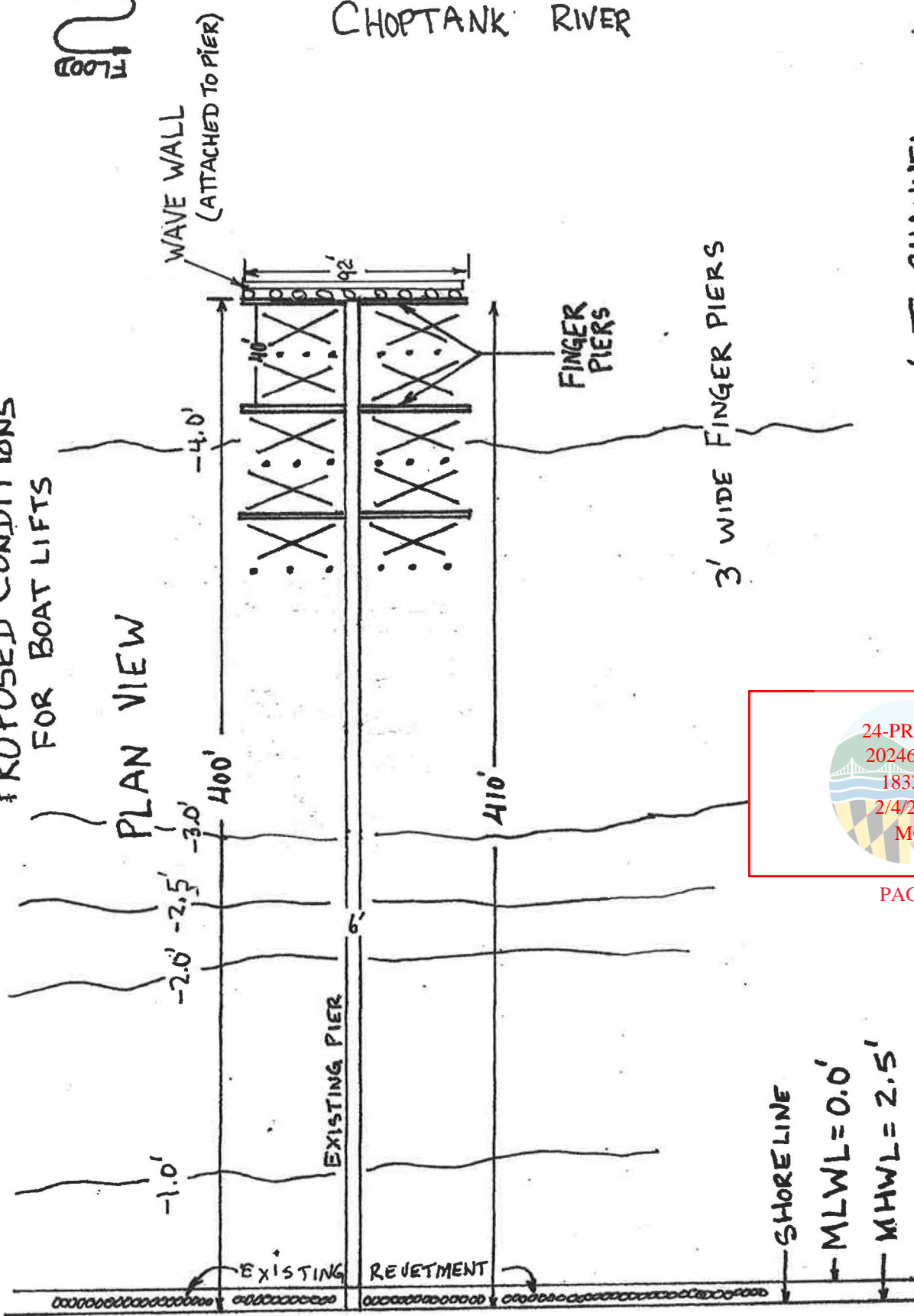

3,600' TO CHANNEL
4,800' TO SHORELINE

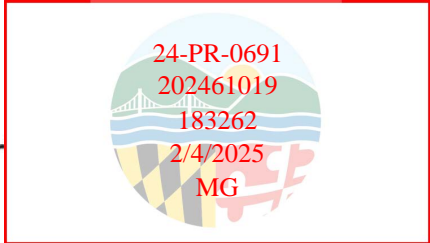

PAGE 5 OF 9

SHORE LINE
MHL = 2.5'
MLWL = 0.0'
1" = 60'

Sunset Cove HOA, Inc.
Blue Heron Drive
East New Market, Maryland 21631

Map Grid Parcel Liber Folio
0021 0009 0002 00064 00007

Goertemiller & Associates
P.O. Box 2752
Easton, Maryland 21601

Livingecosystems1@gmail.com
Cell: 410-310-1842
Fax: 410-476-5742
Office: 410-476-4580

NOTES:

Dock Height min 4.0' Above MLWL = 0.0'

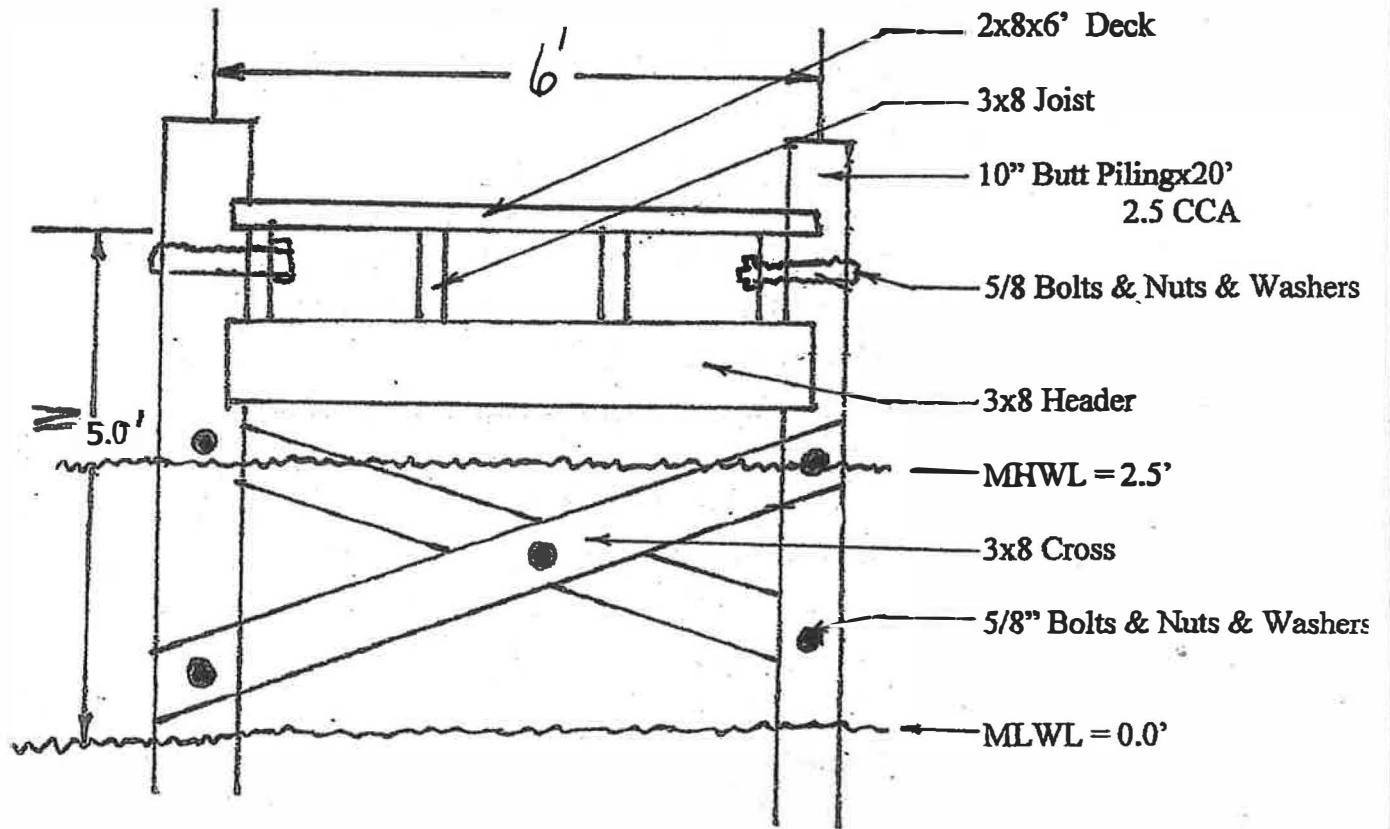

DOCK ELEVATION
PROPOSED CONDITIONS

PAGE 6 OF 9

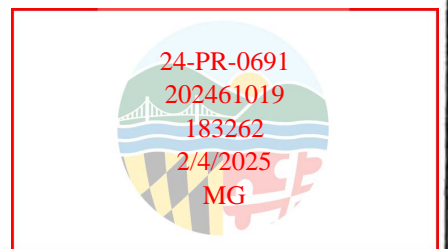

Sunset Cove HOA, Inc.
Blue Heron Drive
East New Market, Maryland 21631

Map Grid Parcel Liber Folio
0021 0009 0002 00064 00007

Goertemiller & Associates
P.O. Box 2752
Easton, Maryland 21601

Livingecosystems1@gmail.com
Cell: 410-310-1842
Fax: 410-476-5742
Office: 410-476-4580

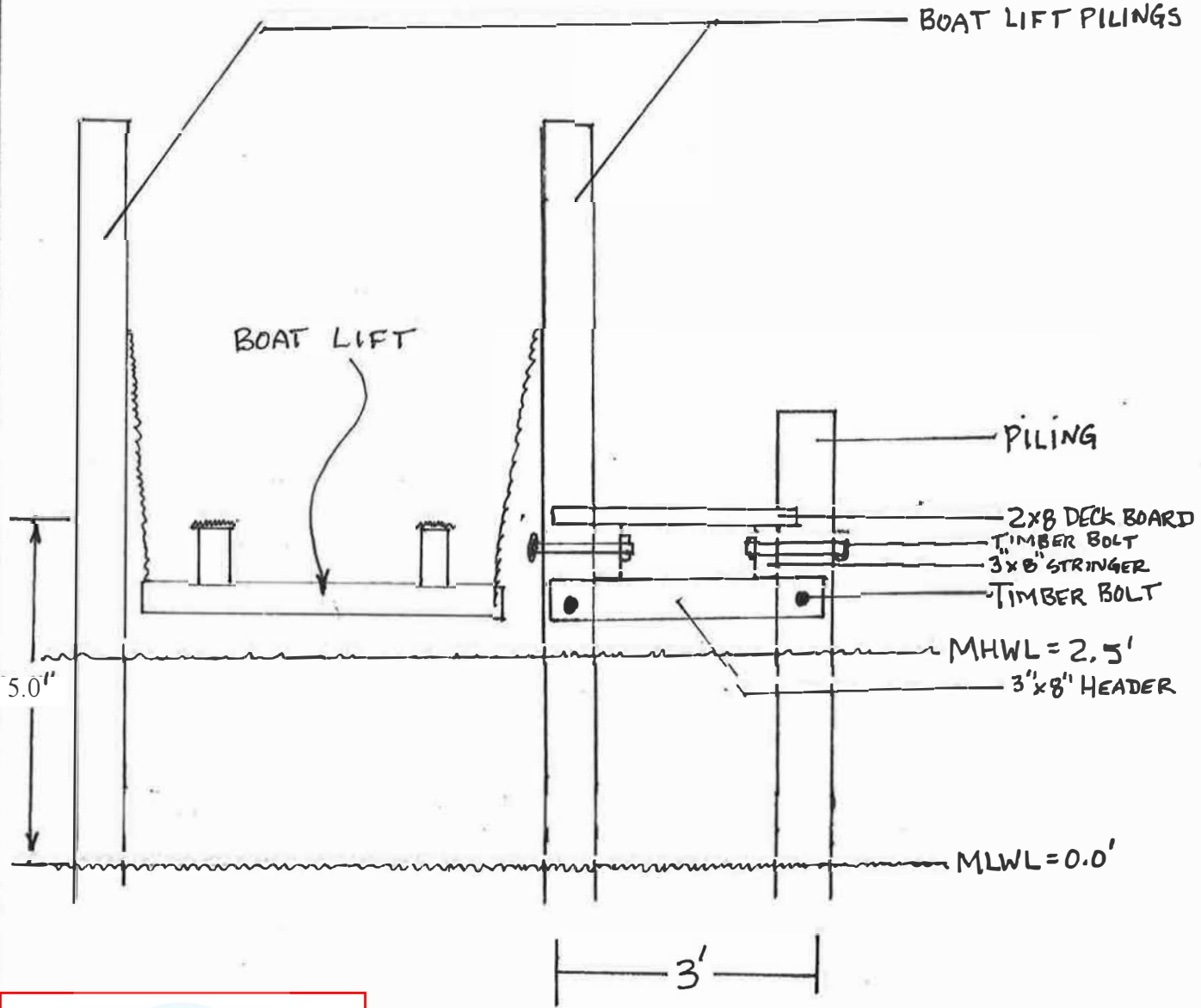

24-PR-0691
 202461019
 183262
 2/4/2025
 MG

Dock Hight Min 4.0' above MLWL = 0.0'

PAGE 7 OF 9

BOAT LIFT & 3' WIDE FINGER PIER

Sunset Cove HOA, Inc. Blue Heron Drive East New Market, Maryland 21631	Map Grid Parcel Liber Folio 0021 0009 0002 00064 00007	Goertemiller & Associates P.O. Box 2752 Easton, Maryland 21601	Livingecosystems1@gmail.com Cell: 410-310-1842 Fax: 410-476-5742 Office: 410-476-4580
--	---	--	--

PLAN

8"x8"x4' TUBER BUTT BLOCK BOLTED TO TOP WALE

PROFILE
WAVE FENCE

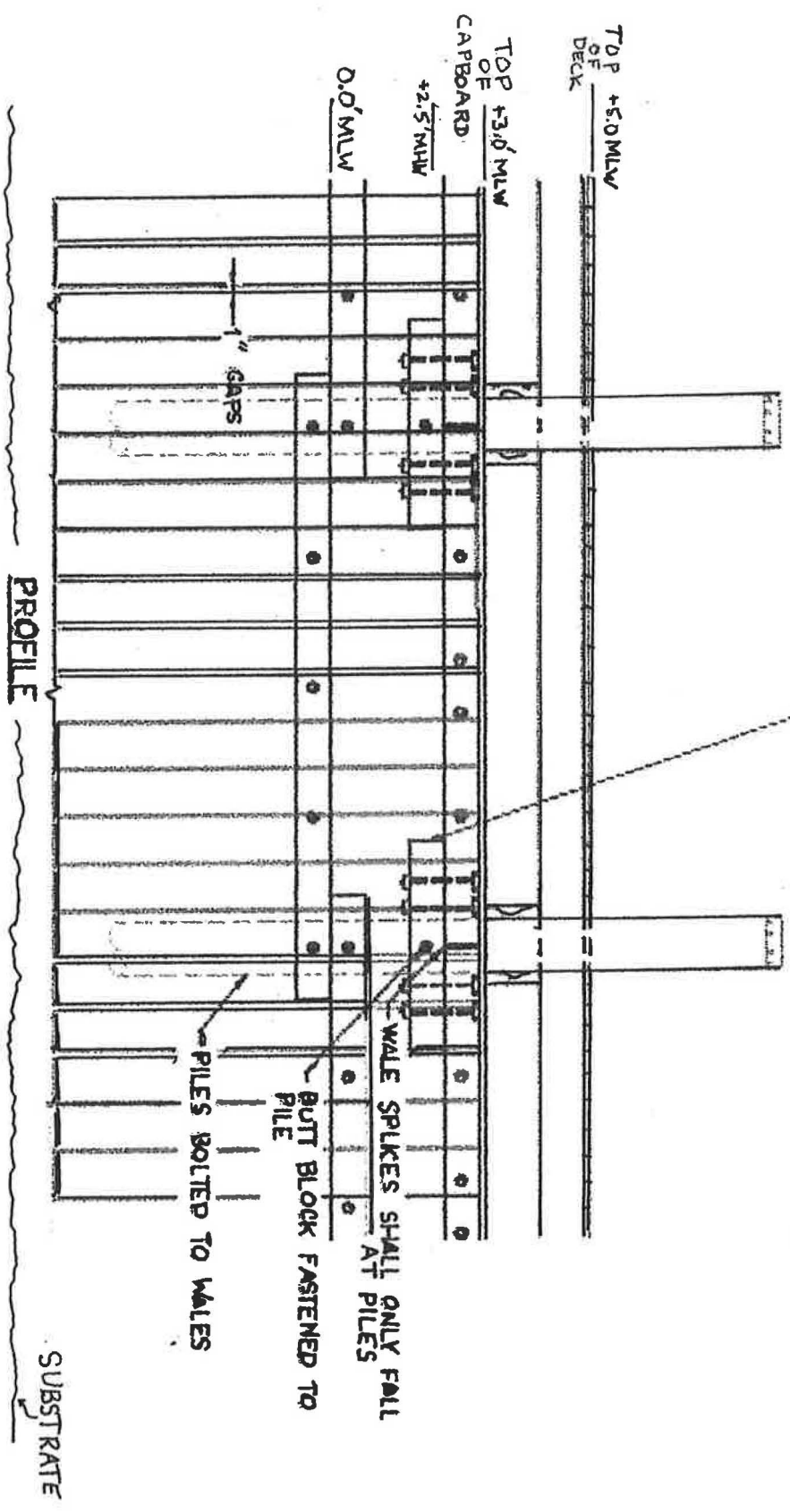

PAGE 8 OF 9

24-PR-0691
202461019
183262
2/4/2025
MG

<p>Sunset Cove HOA, Inc. Blue Heron Drive East New Market, Maryland 21631</p>	<p>Map Grid Parcel Liber Folio 0021 0009 0002 00064 00007</p>	<p>Goertemiller & Associates P.O. Box 2752 Easton, Maryland 21601</p>	<p>Livingecosystems1@gmail.com Cell: 410-310-1842 Fax: 410-476-5742 Office: 410-476-4580</p>
---	---	---	--

Wave Fence

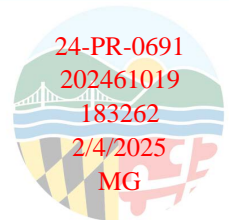
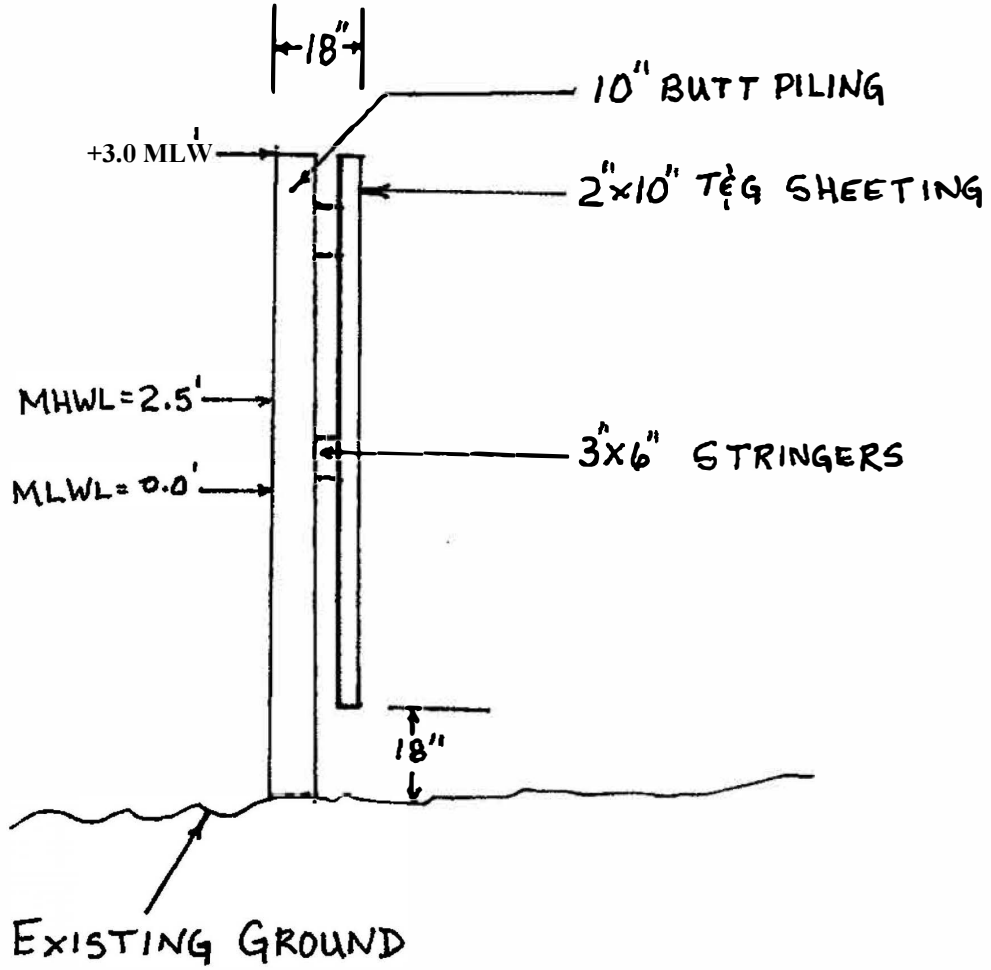

Sunset Cove HOA, Inc.
Blue Heron Drive
East New Market, Maryland 21631

Map Grid Parcel Liber Folio
0021 0009 0002 00064 00007

Goertemiller & Associates
P.O. Box 2752
Easton, Maryland 21601

Livingecosystems1@gmail.com
Cell: 410-310-1842
Fax: 410-476-5742
Office: 410-476-4580

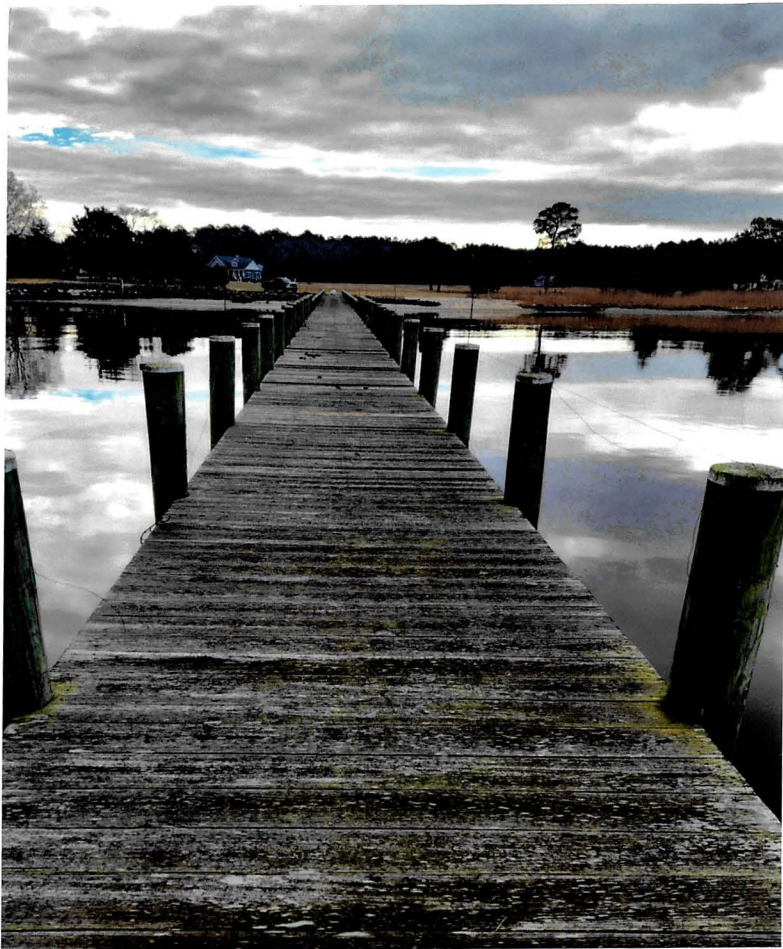

Sunset Cove HOA, Inc.
Blue Heron Drive
East New Market, Maryland 21631

Map Grid Parcel Liber Folio
0021 0009 0002 00064 00007

Goertemiller & Associates
P.O. Box 2752
Easton, Maryland 21601

Livingecosystems1@email.com
Cell: 410-516-1612
Fax: 410-476-5742
Office: 410-476-4580

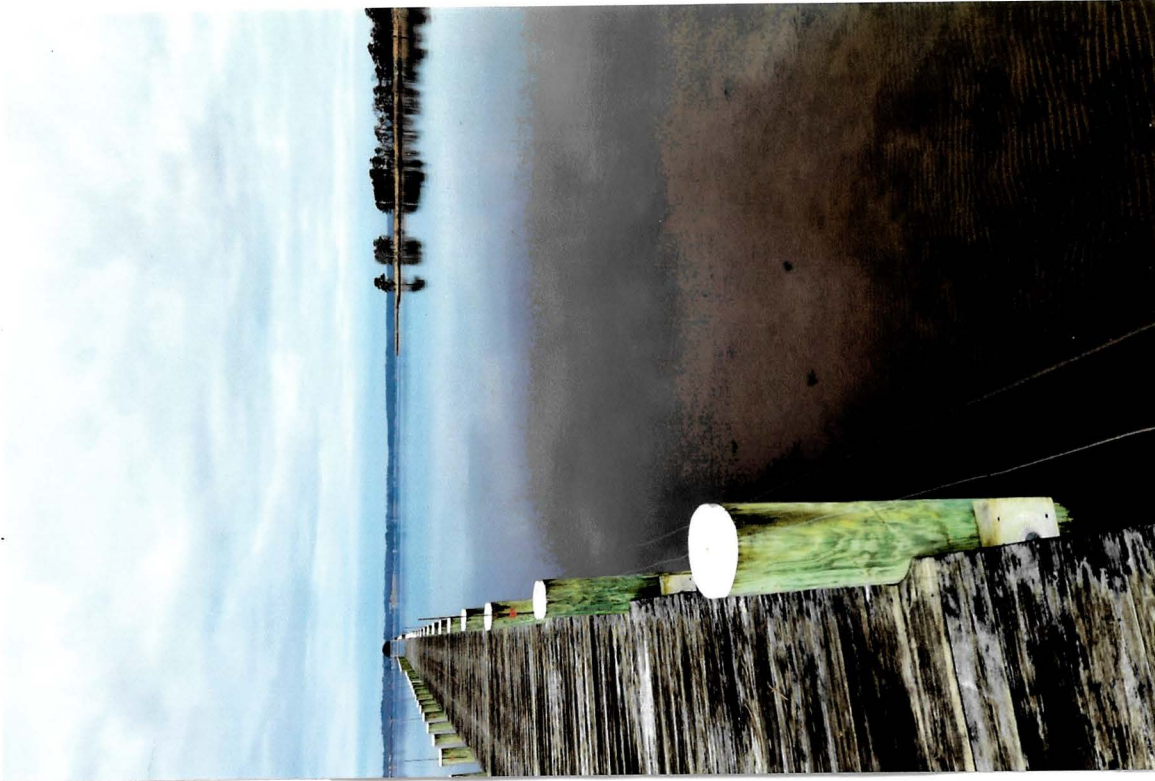

Sunset Cove HOA, Inc.
Blue Heron Drive
East New Market, Maryland 21631

Map Grid Parcel Liber Folio
0021 0009 0002 00064 00007

Goertemiller & Associates
P.O. Box 2752
Easton, Maryland 21601

Livingecosystems1@gmail.com
Cell: 410-516-1812
Fax: 410-476-5782
Office: 410-476-4580