

GENERAL NOTES:

- 1) ALL STRUCTURAL COMPONENTS SHALL BE 6061-T6 ALUMINUM.
- 2) ALL OTHER COMPONENTS MAY BE 6063-T6 OR SIMILAR 6XXX SERIES ALUMINUM.
- 3) ALL FASTENERS SHALL BE ASTM F593 TYPE 304 STAINLESS STEEL.
- 4) ALL WELDS SHALL BE 1/4" FILLET WITH 4043 ALLOY FILLER, UNLESS NOTES OTHERWISE.
- 5) ALL EXPOSED WELDS THAT MAY COME IN CONTACT WITH PEDESTRIANS SHALL BE DEBURRED.
- 6) DECKING TO BE WAHOO 8" FORTIS RIBBED DECKING IN MILL FINISH

DESIGN NOTES:

- 1) CODES AND DESIGN STANDARDS: AASHTO GUIDE SPECIFICATIONS FOR DESIGN OF PEDESTRIAN BRIDGES, 2009 WITH INTERIM REVISIONS; ALUMINUM DESIGN MANUAL, 2015; AWS 1.2/D1.2M STRUCTURAL WELDING CODE - ALUMINUM.
- 2) DESIGN LIVE LOAD = 100 PSF OR 400 LB POINT LOAD
- 3) WIND LOAD = 27 PSF APPLIED NORMAL TO FULL VERTICAL PROJECTED AREA OF GANGWAY
- 4) HANDRAIL LOAD = 50 PLF OR 200 LB POINT LOAD IN ANY DIRECTION
- 5) MAXIMUM DEFLECTION = L/240
- 6) APPROXIMATE DEAD WEIGHT OF GANGWAY = 6,500 LBS

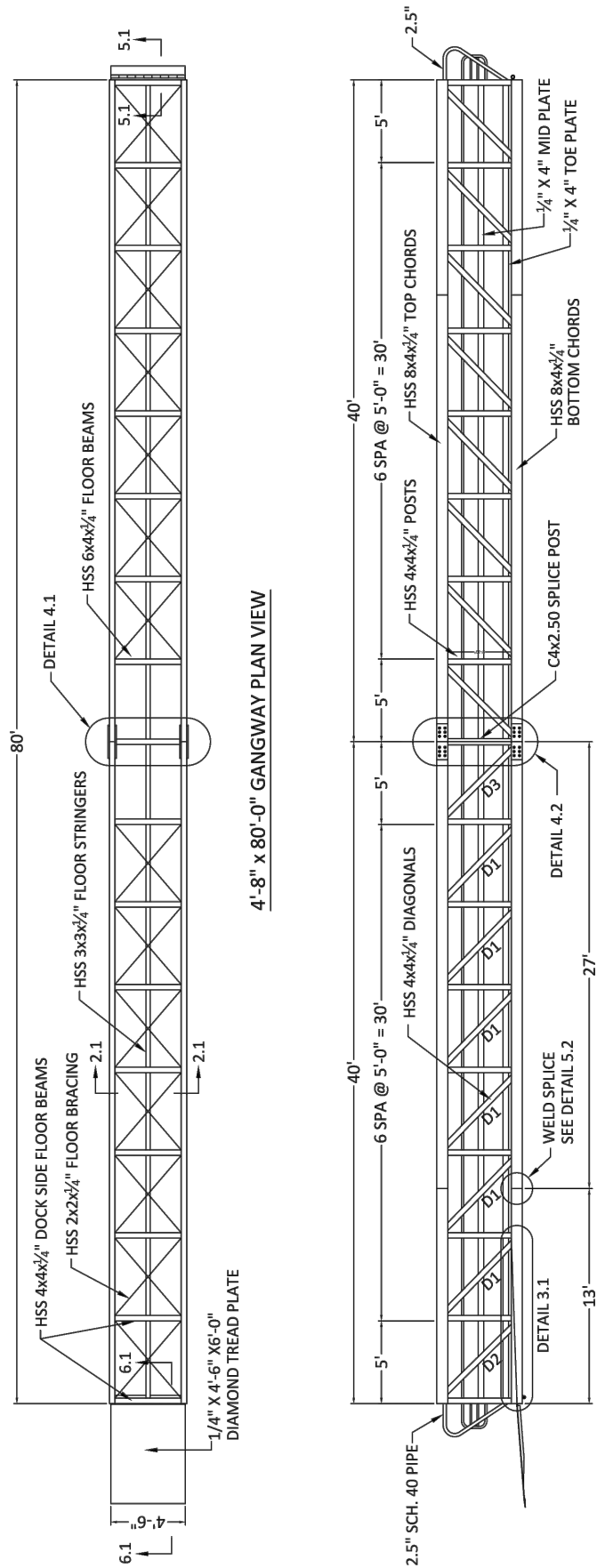

Bay Engineering Inc.

Engineers, Planners and Surveyors
 2661 Riva Road, Building 800
 Annapolis, Maryland 21401
 410.897.9290
 410.897.9295 fax
 email: info@bayengineering.com
 www.bayengineering.com



GANGWAY DETAIL

ANNAPOLIS CITY MAYOR & ALDERMEN
 7300 EDGEWOOD ROAD, ANNAPOLIS, 21403
 TAX MAP 52G, GRID 5, PARCEL 285
 6TH ELECTION DISTRICT, ANNE ARUNDEL COUNTY, MD

DRAWN BY: J.MARLOWE
 SCALE: AS SHOWN
 DATE: SEPTEMBER, 2022
 JOB NO.: 19-7030
 FOLDER REF:
 SHEET 5 OF 10

TYPICAL PIER SECTION AT BEGINNING SHOWING BOTTOM DEPTH

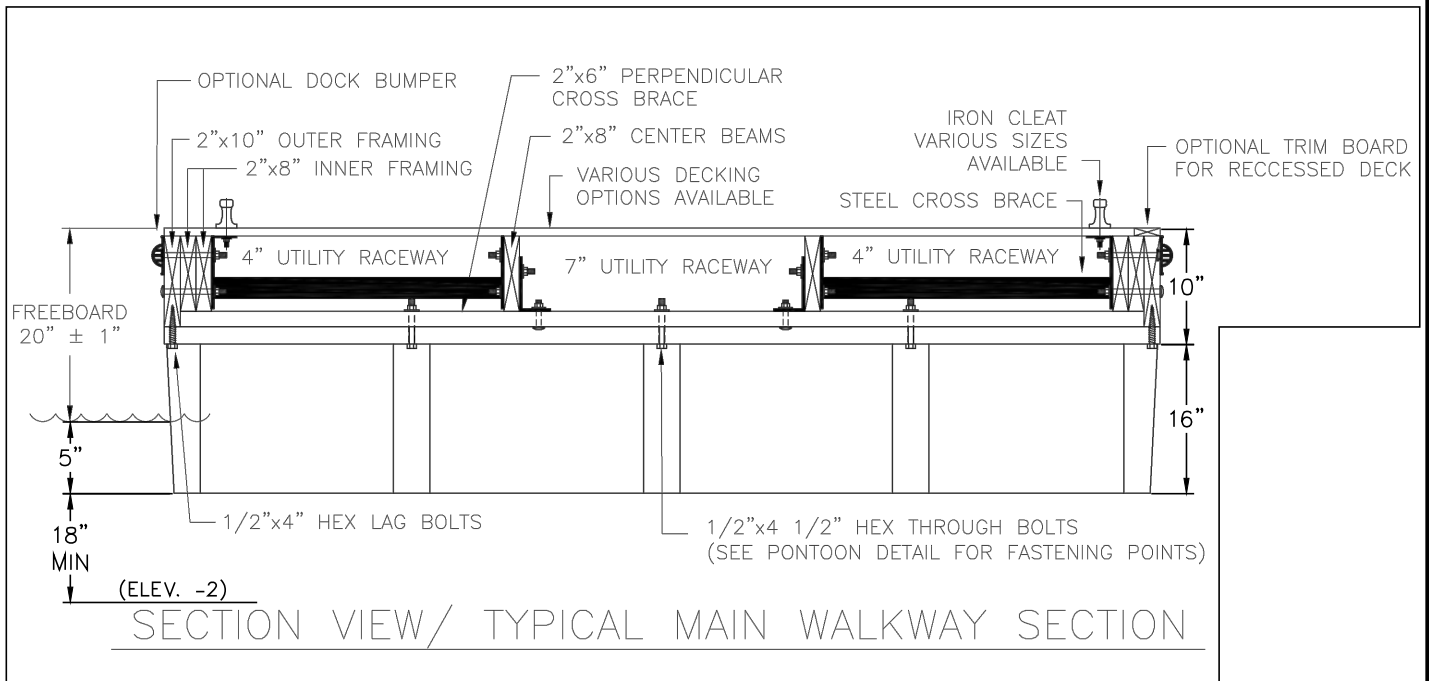

Bay Engineering Inc.

Engineers, Planners and Surveyors
 2661 Riva Road, Building 800
 Annapolis, Maryland 21401
 410.897.9290
 410.897.9295 fax
 email: info@bayengineering.com
 www.bayengineering.com



PIER DETAIL

ANNAPOLIS CITY MAYOR & ALDERMEN
 7300 EDGEWOOD ROAD, ANNAPOLIS, 21403
 TAX MAP 52G, GRID 5, PARCEL 285
 6TH ELECTION DISTRICT, ANNE ARUNDEL COUNTY, MD

DRAWN BY: J.MARLOWE

SCALE: AS SHOWN

DATE: SEPTEMBER, 2022

JOB NO.: 19-7030

FOLDER
 REF:

SHEET 6 OF 10

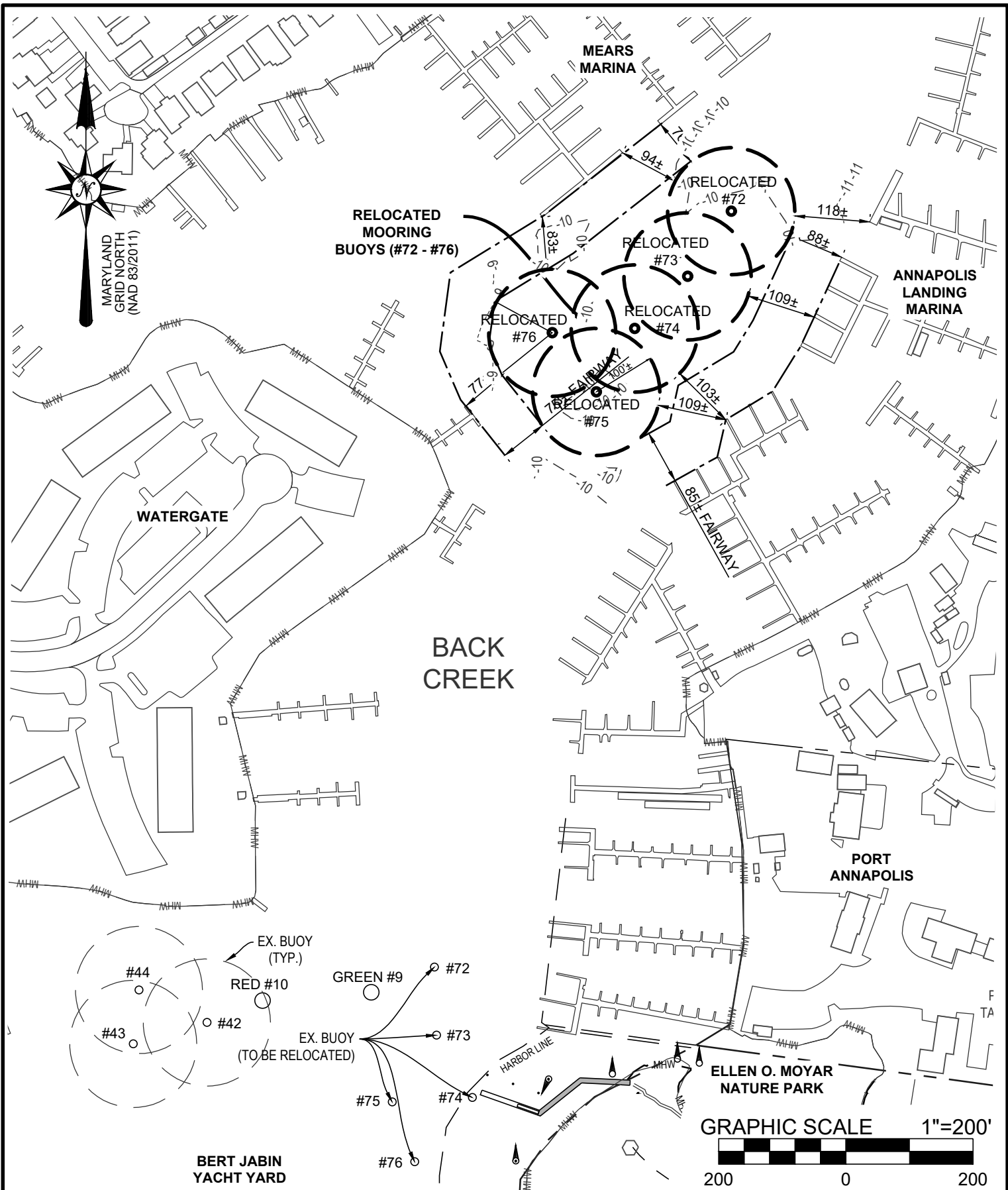

Bay Engineering Inc.
 Engineers, Planners and Surveyors
 2661 Riva Road, Building 800
 Annapolis, Maryland 21401
 410.897.9290
 410.897.9295 fax
 email: info@bayengineering.com
 www.bayengineering.com

BUOY RELOCATION PLAN

ANNAPOLIS CITY MAYOR & ALDERMEN
 7300 EDGEWOOD ROAD, ANNAPOLIS, 21403
 TAX MAP 52G, GRID 5, PARCEL 285
 6TH ELECTION DISTRICT, ANNE ARUNDEL COUNTY, MD

DRAWN BY: J.MARLOWE
SCALE: AS SHOWN
DATE: SEPTEMBER, 2022
JOB NO.: 19-7030
FOLDER REF:
SHEET 7 OF 10