

X ----- 27770 Crisfield Marion

21838

21817

SOMERSET COUNTY

INDIAN HAMMOCK

PARSONVILLE



MERLIN-Maryland's Environmental Resource & Land Information Network



Green Infrastructure (ARCHIVED - superseded by HCN)

Biodiversity Conservation Network

DNR Focal Areas

Federal Lands

Land Use Land Cover - MD Dept of Planning

Historical Land Use Land Cover

Maryland Inventory of Historic Properties

National Register of Historic Places

MHT Preservation Easements

Incentive Zones

Map Grids

USGS Topographic Quads

NAIP Imagery 2018

NAIP Imagery 2017

NAIP Imagery 2015

NAIP Imagery 2013

NAIP Imagery 2011

NAIP Imagery 2009

NAIP Imagery 2007

NAIP Imagery 2005

High Resolution Imagery 2014-2016

High Resolution Imagery 2013-2014

High Resolution Imagery 2011-2013

High Resolution Imagery 2010-2011

Panchromatic DOQ's 1998

Color Infrared DOQ's 1988-1994

Map interface showing a search for '27770 CRISFIELD MARIO X'. The search results show '27770 CRISFIELD MARIO STATION, MD. 21838'. The map displays a satellite image with a red polygon highlighting a specific area. A scale bar indicates 200ft. The map coordinates are -75.8019 38.0437 Degrees.

District: **08** Account Number: **142335**

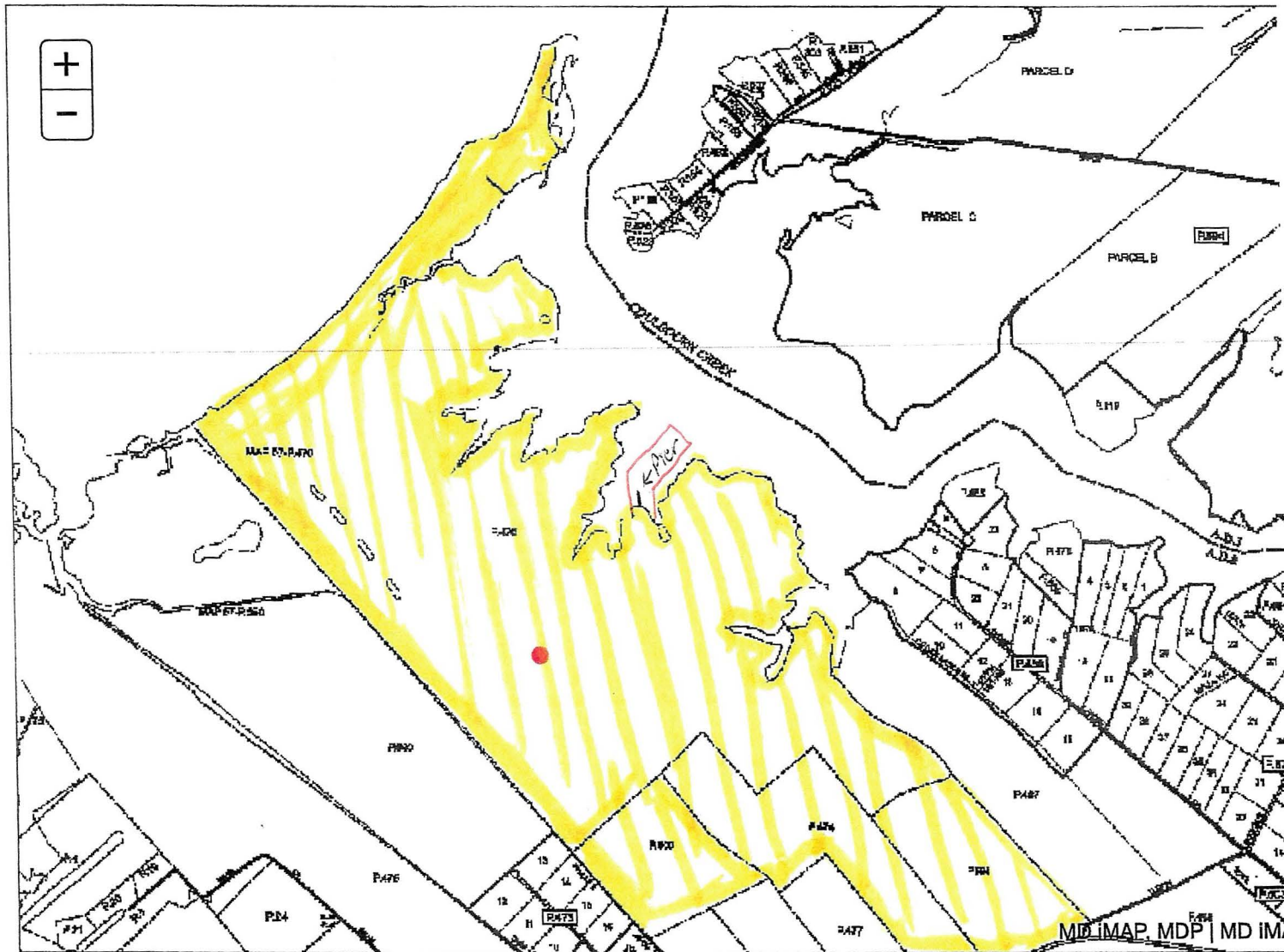

The information shown on this map has been compiled from deed descriptions and plats and is not a property survey. The map should not be used for legal descriptions. Users noting errors are urged to notify the Maryland Department of Planning Mapping, 301 W. Preston Street, Baltimore MD 21201.

If a plat for a property is needed, contact the local Land Records office where the property is located. Plats are also available online through the Maryland State Archives at www.plats.net (<http://www.plats.net>).

John Borth
27770 Crisfeld
Marion Rd.
Marion, MD
21838

27770 Crisfield MarionRd.

Existing Conditions, SAV, waterway widths

Legend

- Constructed
- Feature 1
- feet (50%)
- Line Measure
- Line Measure
- Line Measure
- PLOW
- Untitled Path

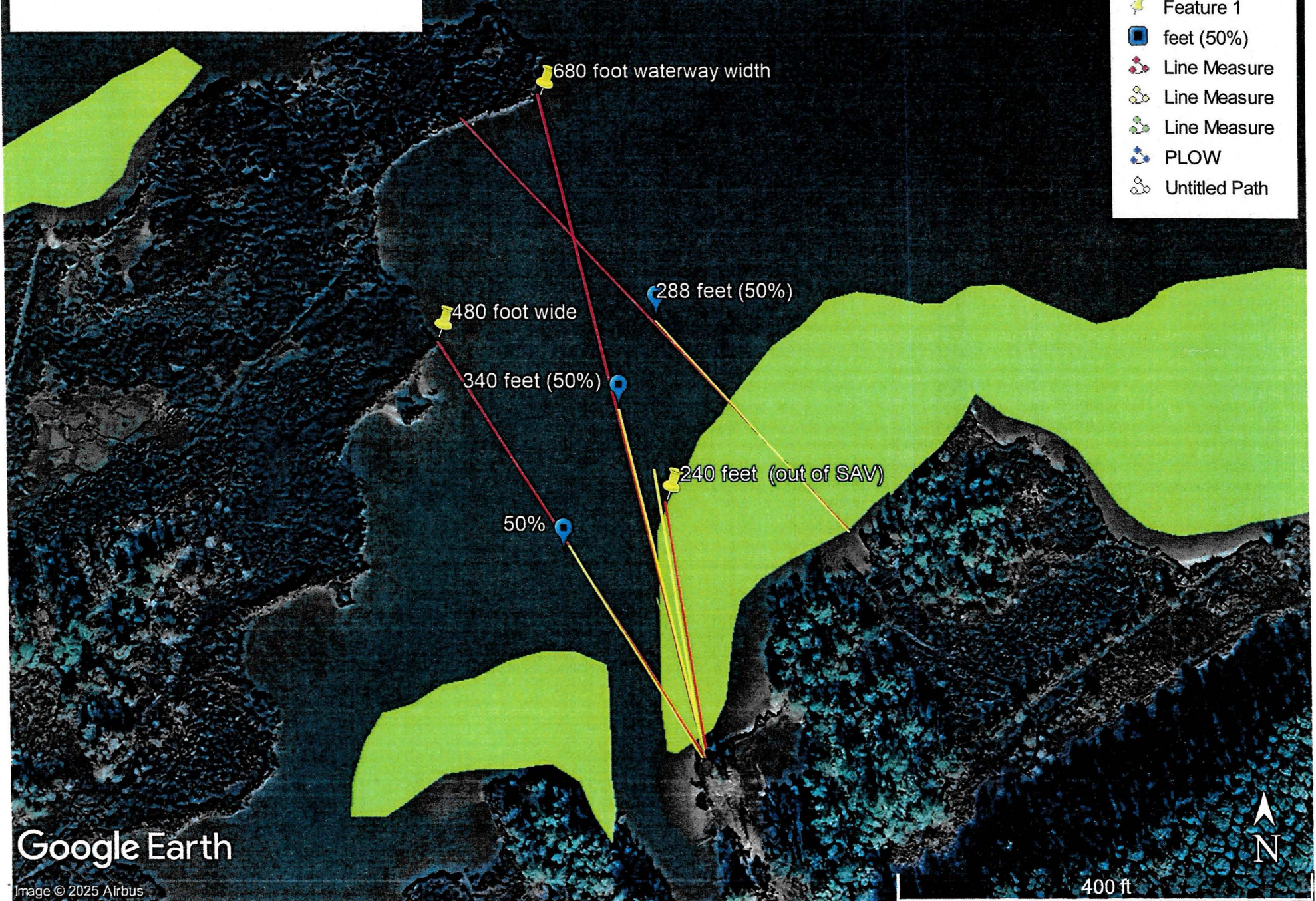

Google Earth

Image © 2025 Airbus

400 ft

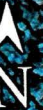

27770 Crisfield Marion

Proposed pier

Existing Conditions

Legend

- Constructed
- Feature 1
- Line Measure
- Line Measure
- PLOW
- Untitled Path



Google Earth



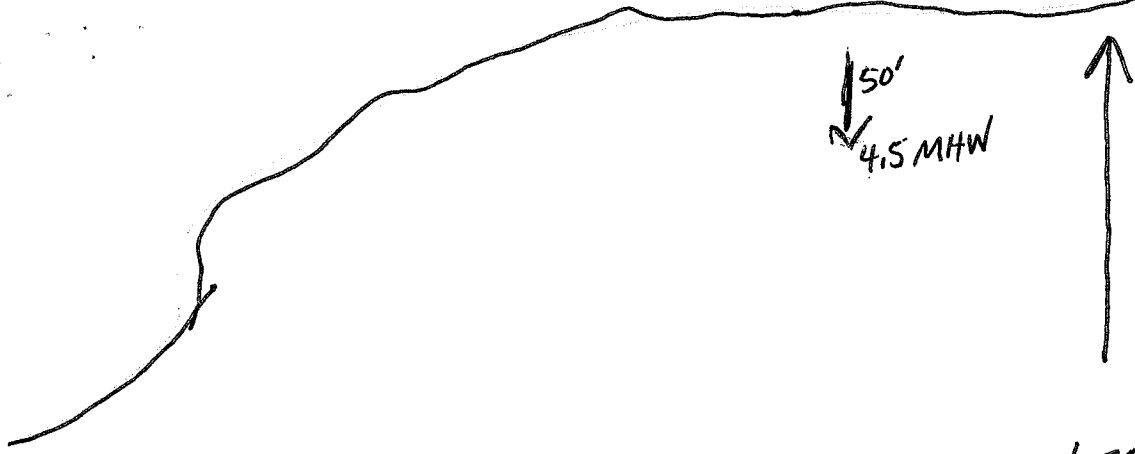

- 250' from end of dock 5' MHW 675' across canal

- 200' from dock 5' MHW

- 100' from dock 5' MHW

Ebb
FLOW

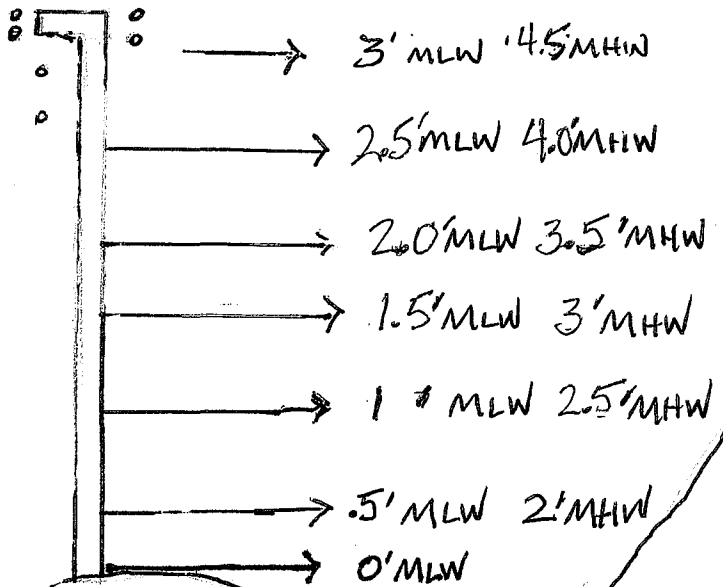

Proposed Conditions

John M. Borth
27770 Crisfield Marion Rd.
Marion, MD 21838

①

Arable land

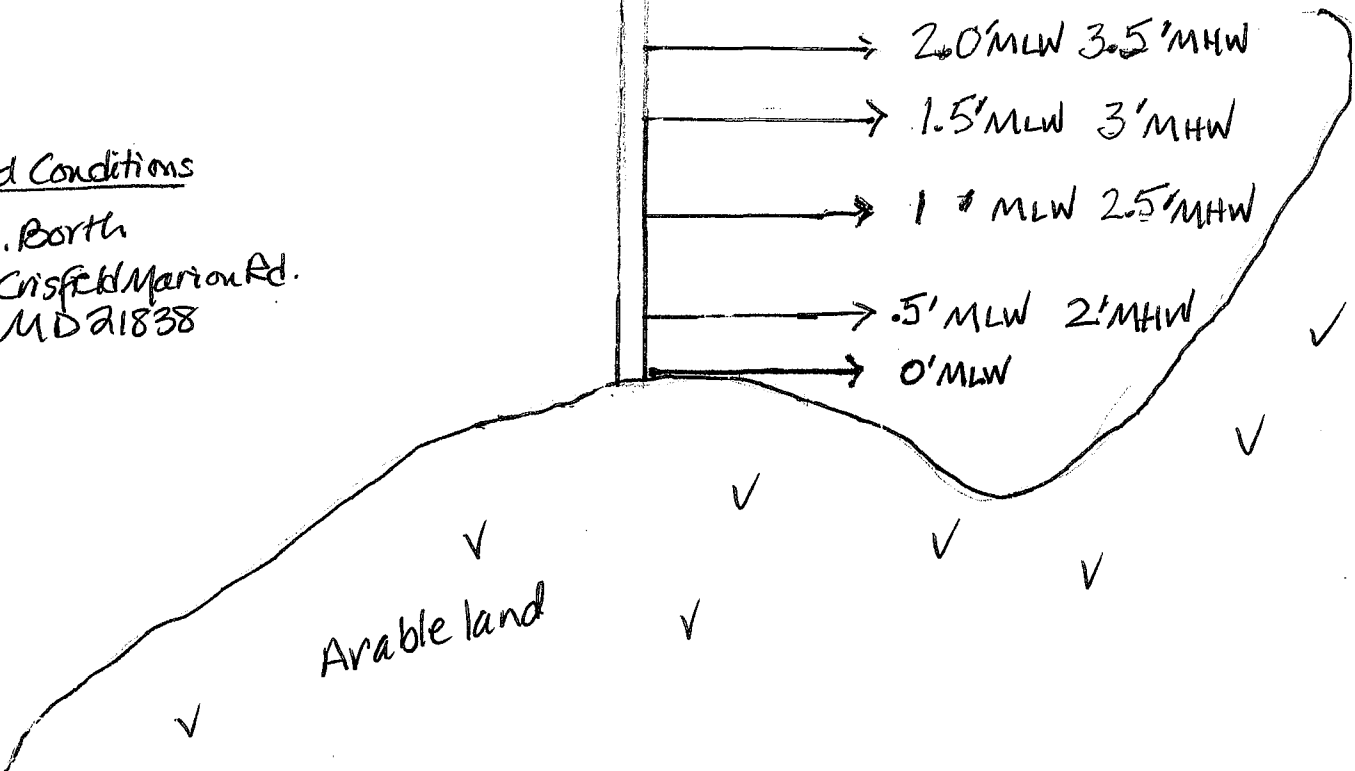

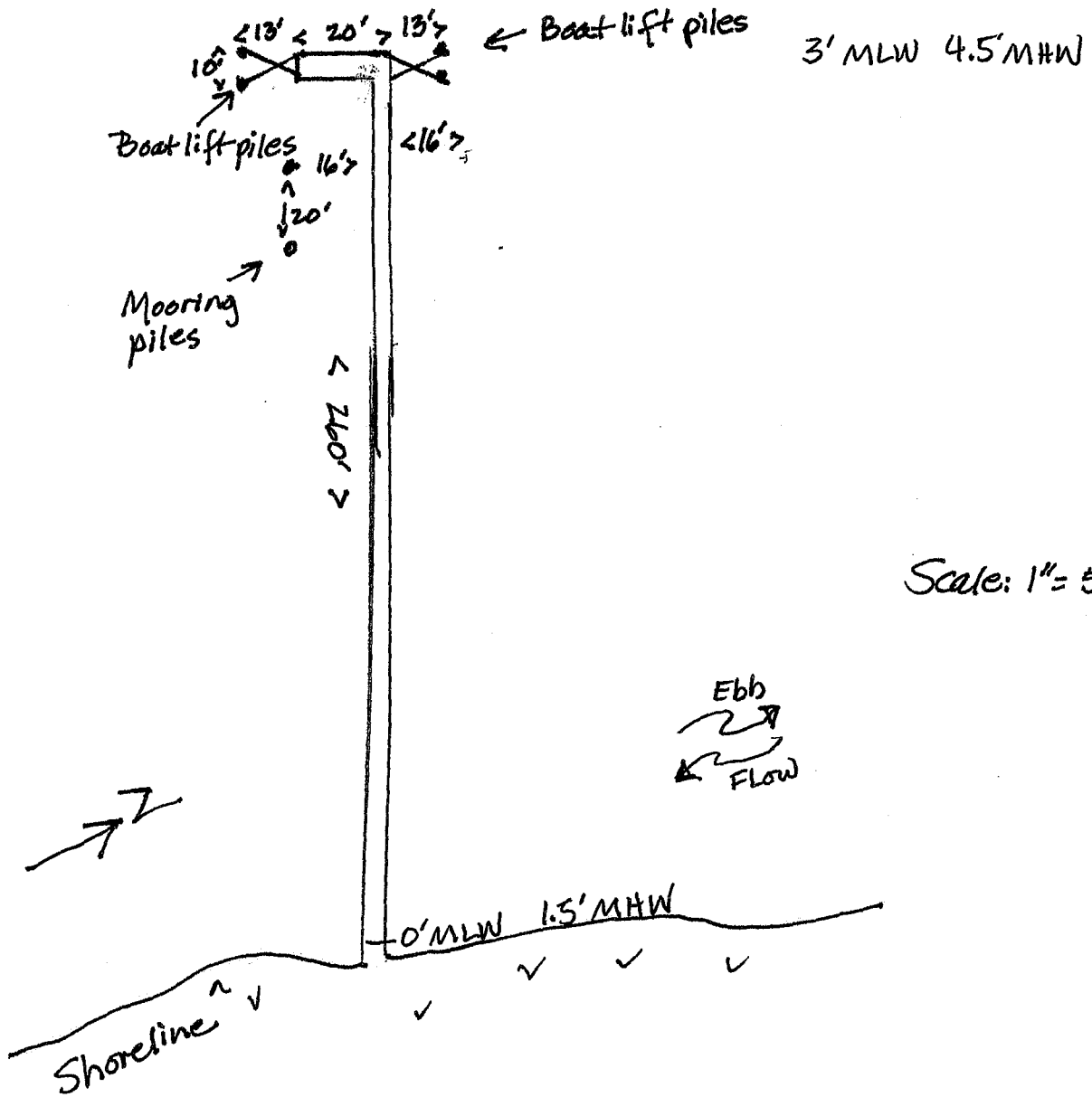

Pier and Boat lift Detail

John Matthew Borth
 27770 Crisfield Marion Rd
 Marion, MD 21838

Map 57
 Parcel 470

Platform and Boat Lift Cross Section

Scale 1" = 10'

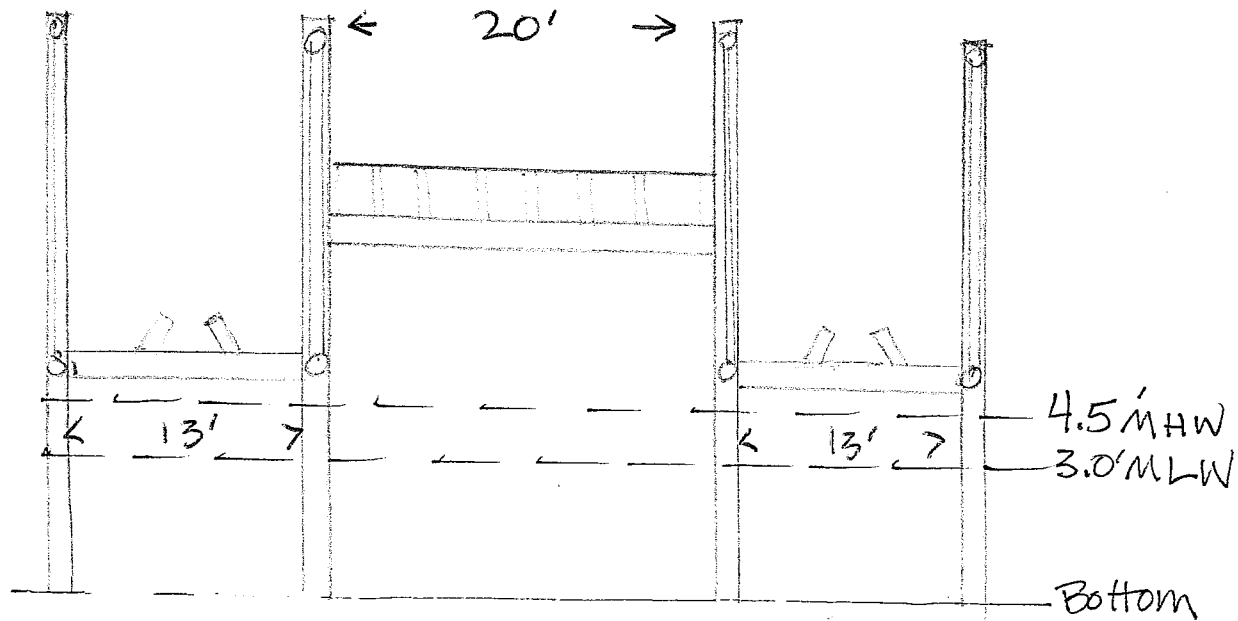

John Matthew Borth
27770 Crisfield/Marion Rd
Marion, MD 21838