

**PROJECT DESCRIPTION:**

MAINTENANCE DREDGE FOR A PERIOD OF SIX (6) YEARS BY MECHANICAL METHOD A ±40,000 SF AREA TO A UNIFORM DEPTH OF -6.0 MLW AND TRANSPORT ±2,250 C.Y. OF DREDGE SPOIL TO AN APPROVED UPLAND SITE.

**DATUM COMPARISONS**

SCALE: NONE

DATUM COMPARISONS WERE OBTAINED FROM NATIONAL OCEANIC AND ATMOSPHERIC ADMINISTRATION (NOAA) INFORMATION INTERPOLATED FROM STATION ID# 8570283 - PID: HU0267.

**THE JACKSPOT/HANNA FAMILY INVESTMENTS  
PROPOSED MAINTENANCE DREDGING  
306 & 307 DORCHESTER STREET  
TOWN OF OCEAN CITY**

APPLICANT: FOR APPLICATION PURPOSES - NOT FOR CONSTRUCTION  
306 Dorchester Street LLC  
PO Box 2638  
Salisbury, MD 21802  
PHONE: 443-497-3799  
EMAIL: sashausa10@yahoo.com

LOCATION: FORMERLY MARINA DECK RESTAURANT

NO SAV'S

WATERWAY: MANMADE BOAT BASIN ON SINEPUXENT BAY

WATER DEPTH MEASUREMENTS: 8/26/2025

TAX MAP: 110  
PARCEL: 2462 & 2463  
LOTS: 14  
GRID: 14

REFERENCED TO MLW 11:00 a.m.

COPYRIGHT © 2025

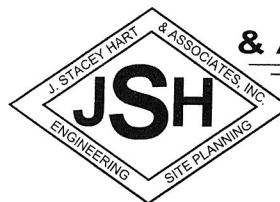

**J. STACEY HART  
& ASSOCIATES, INC.**

JOB NUMBER: 2025-053	SCALE: NONE	SHEET NO: 1 of 4	DATE: 10/2025	REVISED: n/a
-------------------------	----------------	---------------------	------------------	-----------------

POST OFFICE BOX 6  
SNOW HILL, MD 21863  
PHONE: 410-390-8096  
EMAIL: stacey@jstaceyhart.com



PROPOSED DREDGING

LIMIT OF FEDERAL CHANNEL

# SINEPUXENT BAY

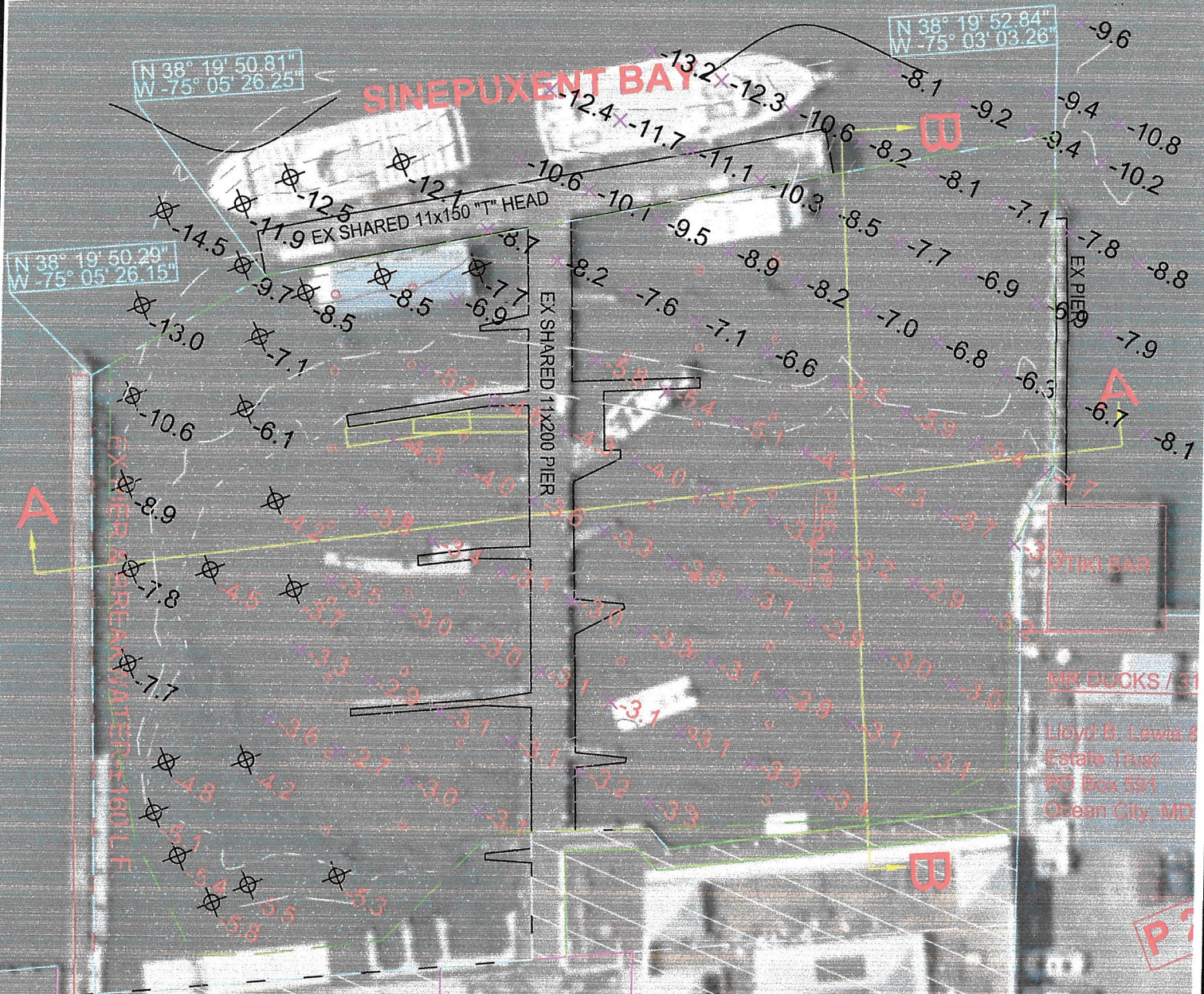

STIKI BAR

MR DUCKS / 31

Lloyd B. Lewis &  
Estate Trust  
PO Box 591  
Ocean City, MD

## 307 DORCHESTER STREET

Hanna Family Investments  
1114 E Main Street  
Salisbury, MD 21804

## 306 DORCHESTER / THE JACKSPOT

306 Dorchester LLC  
PO Box 2638  
Salisbury, MD 21802

### THE JACKSPOT/HANNA FAMILY INVESTMENTS PROPOSED MAINTENANCE DREDGING 306 & 307 DORCHESTER STREET TOWN OF OCEAN CITY

APPLICANT: FOR APPLICATION PURPOSES - NOT FOR CONSTRUCTION  
306 Dorchester Street LLC  
PO Box 2638  
Salisbury, MD 21802  
PHONE: 443-497-3799  
EMAIL: sashausa10@yahoo.com

LOCATION: FORMERLY MARINA DECK RESTAURANT NO SAV'S  
WATERWAY: MANMADE BOAT BASIN ON SINEPUXENT BAY 110  
WATER DEPTH MEASUREMENTS: 8/26/2025 2462 & 2463  
REFERENCED TO MLW 11:00 a.m. 14

JOB NUMBER: 2025-053	SCALE: 1"=40'	SHEET NO: 3 of 4	DATE: 10/2025	REVISED: n/a
-------------------------	------------------	---------------------	------------------	-----------------

COPYRIGHT © 2025

**J. STACEY HART & ASSOCIATES, INC.**

POST OFFICE BOX 6  
SNOW HILL, MD 21863  
PHONE: 410-390-8096  
EMAIL: stacey@jstaceyhart.com

EX PIER/BREAKWATER - SOUTH

PROFILE A - A

SCALE:  
H: 1"=60'  
V: 1"=6'

EX PIER - NORTH/MR DUCKS

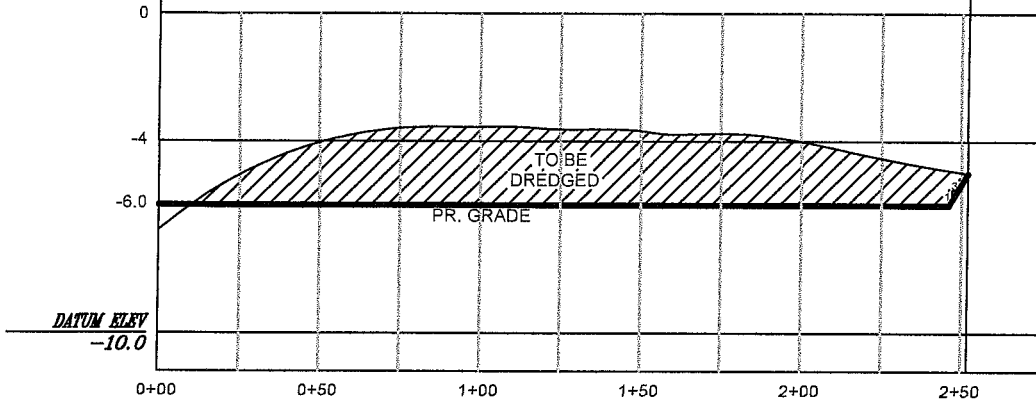

BULKHEAD - BUILDING

PROFILE B - B

SCALE:  
H: 1"=60'  
V: 1"=6'

SINEPUXENT BAY - CHANNEL

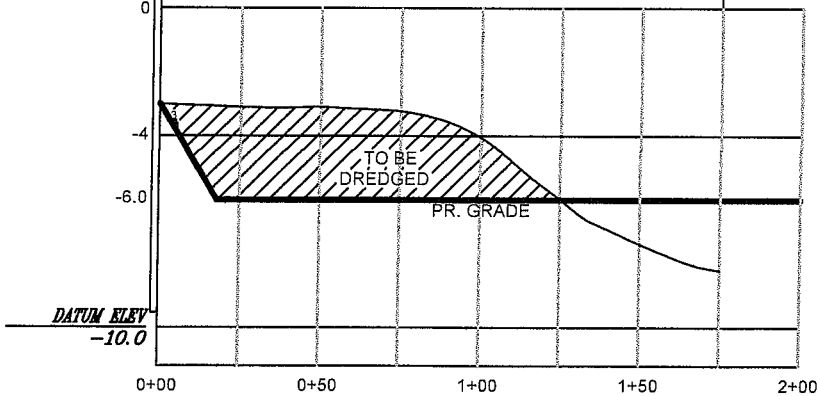

THE JACKSPOT/HANNA FAMILY INVESTMENTS  
 PROPOSED MAINTENANCE DREDGING  
 306 & 307 DORCHESTER STREET  
 TOWN OF OCEAN CITY

APPLICANT: FOR APPLICATION PURPOSES - NOT FOR CONSTRUCTION  
 306 Dorchester Street LLC  
 PO Box 2638  
 Salisbury, MD 21802  
 PHONE: 443-497-3799  
 EMAIL: sashausa10@yahoo.com

LOCATION: FORMERLY MARINA DECK RESTAURANT NO SAV'S  
 WATERWAY: MANMADE BOAT BASIN ON SINEPUXENT BAY 110  
 WATER DEPTH MEASUREMENTS: 8/26/2025 2462 & 2463  
 REFERENCED TO MLW 11:00 a.m. 14  
 14

COPYRIGHT © 2025

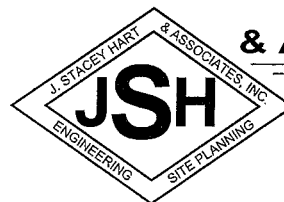

**J. STACEY HART  
 & ASSOCIATES, INC.**

POST OFFICE BOX 6  
 SNOW HILL, MD 21863  
 PHONE: 410-390-8096  
 EMAIL: stacey@jstaceyhart.com

JOB NUMBER: 2025-053	SCALE: AS NOTED	SHEET NO: 4 of 4	DATE: 10/2025	REVISED: n/a
-------------------------	--------------------	---------------------	------------------	-----------------