

**EXIST. NON-TIDAL WETLANDS AREA TABLE**

	PFO AREA		PSS AREA		EMERGENT AREA		TOTAL AREA	
	SF	AC	SF	AC	SF	AC	SF	AC
WETLANDS	572,334	13.1390	43,819	1.0059	1,215	0.0279	617,368	14.1728
WETLAND BUFFERS	331,743	7.6158	24,997	0.5738	5,406	0.1241	362,146	8.3137

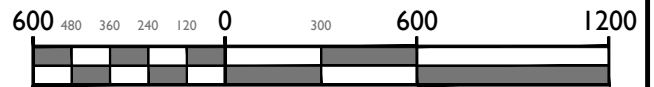

SCALE : 1" = 600'

Customer Loyalty through Client Satisfaction  
www.maserconsulting.com

Engineers ■ Planners ■ Surveyors  
Landscape Architects ■ Environmental Scientists

Office Locations:

- Red Bank, NJ
- Clinton, NJ
- Hamilton, NJ
- Egg Harbor, NJ
- Montvale, NJ
- Mt. Arlington, NJ
- Mt. Laurel, NJ
- Albany, NY
- Newburgh, NY
- Hawthorne, NY
- Columbia, MD
- Lehigh Valley, PA
- Exton, PA
- Philadelphia, PA
- Pittsburgh, PA
- Tampa, FL
- Orlando, FL
- Miami, FL
- Sterling, VA
- Norfolk, VA
- Albuquerque, NM
- Charlotte, NC

Copyright © 2022, Maser Consulting P.A. All Rights Reserved. This drawing and all the information contained herein is authorized for use only by the party for whom the services were contracted or to whom it is certified. This drawing may not be copied, reused, disclosed, distributed or relied upon for any other purpose without the express written consent of Maser Consulting P.A.

WETLAND IMPACT PLATES  
FOR  
STEPHEN'S CROSSING AT  
BRANDYWINE  
15-NT-0395/201561897  
BRANDYWINE BUSINESS PARK,  
LOTS 2-21, 23-27, PARCELS A-C,  
& OUTPARCEL A

PRINCE GEORGE'S COUNTY  
MARYLAND

Know what's below.  
Call before you dig.  
FOR STATE SPECIFIC DIRECT PHONE NUMBERS  
VISIT: WWW.CALL811.COM

PROTECT YOURSELF  
ALL STATES REQUIRE NOTIFICATION  
OF EXCAVATORS, DESIGNERS, OR  
ANY PERSON PREPARING TO  
DISTURB THE EARTH'S SURFACE  
ANYWHERE IN ANY STATE

STERLING OFFICE  
22375 Br orderick Drive  
Suite 110  
Sterling, VA 20166  
Phone: 703.430.4330  
Fax: 703.430.4339

KEY MAP

SCALE:	DATE:	DRAWN BY:	CHECKED BY:
AS SHOWN	03/19/2021	CME	JWC
PROJECT NUMBER:	DRAWING NAME:		
20000031A	C-WETLAND IMPACT PLATES		

SHEET TITLE:  
**PLATE NO. 1**

SHEET NUMBER:  
1 of 15

# LEGEND

	WETLAND BOUNDARY
	WETLAND BUFFER
	PUBLIC ROAD DISTURBANCE
	RESIDENTIAL DISTURBANCE
	COMMERCIAL DISTURBANCE
	PRIVATE ROAD DISTURBANCE
	UTILITY DISTURBANCE
	WETLAND BUFFER DISTURBANCE
	DISTURBANCE IN FLOODPLAIN
	FORESTED AREA (PFO) (PALUSTRINE FORESTED OUTSIDE OF OLD FARM FIELD)
	FORESTED AREA (PSS) (PALUSTRINE SHRUB SCRUB OLD FARM FIELD NEAR MISSOURI AVENUE)
	FLOODPLAIN
	INTERMITTENT STREAM
	EPHEMERAL STREAM
	WETLAND TYPE BOUNDARY
	LOD
	LIMIT OF DISTURBANCE

# IMPACTS BY AREA NUMBER

IMPACT AREA No.	WET-LAND IMPACT (SF) (PERM)	WET-LAND IMPACT (SF) (TEMP)	WET-LAND BUFFER IMPACT (SF) (PERM)	WET-LAND BUFFER IMPACT (SF) (TEMP)	WATERS OF US IMPACT (PERM) (LF)	WATERS OF US IMPACT (TEMP) (LF)	FLOOD-PLAIN IMPACT (SF)
1	4,336	0	8,754	0	0	0	0
2	223	341	1,231	2,805	12	28	4,986
3	25,184	0	13,184	0	235	22	9,984
4	8,856	0	8,945	0	177	18	11,653
5	58,383	0	12,693	0	0	0	0
6	1,215	0	4,762	0	0	0	0
7	10,482	0	18,551	0	0	0	0
8	0	0	0	0	0	0	8,721
9	0	1,076	0	397	0	15	4,096
10	206	0	2,094	0	157	10	3,476
11	0	0	631	0	0	0	1,214
12	0	0	0	3,072	0	24	1,555
13	0	0	0	906	0	0	3,720
14	0	0	0	0	0	0	0
TOTAL	108,885	1,417	70,214	7,180	581	117	49,405

# WATERS OF THE U.S. LENGTH TABLE

EXISTING WATERS OF THE U.S.	5,261 LF
WATERS OF THE U.S. PERMANENT DISTURBANCE	581 LF
WATERS OF THE U.S. TEMPORARY DISTURBANCE	117 LF

# NON-TIDAL WETLAND IMPACT BY TYPE

DISTURBANCE TYPE	PFO WETLAND IMPACT		PSS WETLAND IMPACT		EMERGENT WETLAND IMPACT		TOTAL WETLAND IMPACT		PFO WETLAND BUFFER IMPACT		PSS WETLAND BUFFER IMPACT		EMERGENT WETLAND BUFFER IMPACT		TOTAL WETLAND BUFFER IMPACT	
	SF	Ac	SF	AC	SF	AC	SF	AC	SF	AC	SF	AC	SF	AC	SF	AC
PUBLIC ROADS	89,579	2.0565	3,050	0.0700	0	0.0000	92,629	2.1265	35,519	0.8154	753	0.0173	644	0.0148	36,916	0.8475
GRADING	223	0.0051	478	0.0110	1,215	0.0279	1,916	0.0440	1,231	0.0283	9,471	0.2174	4,762	0.1093	15,464	0.3550
COMMERCIAL	4336	0.0995	0	0.0000	0	0.0000	4336	0.0995	9,385	0.2154	0	0.0000	0	0.0000	9,385	0.2154
PRIVATE ROADS	2,270	0.0521	7,734	0.1776	0	0.0000	10,004	0.2297	3,112	0.0714	5,968	0.1370	0	0.0000	9,080	0.2084
UTILITIES	1,417	0.0325	0	0.0000	0	0.0000	1,417	0.0325	7,180	0.1648	0	0.0000	0	0.0000	7,180	0.1648
TOTALS	97,825	2.2457	11,262	0.2586	1,215	0.0279	110,302	2.5321	56,427	1.2953	16,192	0.3717	5,406	0.1241	78,025	1.7911

- 1 - PERMANENT WETLAND AND WETLAND BUFFER IMPACT AREAS
- 2 - TEMPORARY WETLAND AND WETLAND BUFFER IMPACT AREAS

Customer Loyalty through Client Satisfaction  
www.maserconsulting.com

Engineers ■ Planners ■ Surveyors  
Landscape Architects ■ Environmental Scientists

Office Locations:

- Red Bank, NJ
- Clinton, NJ
- Hamilton, NJ
- Egg Harbor, NJ
- Montvale, NJ
- Mt. Arlington, NJ
- Mt. Laurel, NJ
- Albany, NY
- Newburgh, NY
- Hawthorne, NY
- Columbia, MD
- Lehigh Valley, PA
- Exton, PA
- Philadelphia, PA
- Pittsburgh, PA
- Tampa, FL
- Orlando, FL
- Miami, FL
- Sterling, VA
- Norfolk, VA
- Albuquerque, NM
- Charlotte, NC

Copyright © 2022, Maser Consulting P.A. All Rights Reserved. This drawing and all the information contained herein is authorized for use only by the party for whom the services were contracted or to whom it is certified. This drawing may not be copied, reused, disclosed, distributed or relied upon for any other purpose without the express written consent of Maser Consulting P.A.

WETLAND IMPACT PLATES  
FOR  
STEPHEN'S CROSSING AT  
BRANDYWINE  
15-NT-0395/201561897  
BRANDYWINE BUSINESS PARK,  
LOTS 2-21, 23-27, PARCELS A-C,  
& OUTPARCEL A  
PRINCE GEORGE'S COUNTY  
MARYLAND

PROTECT YOURSELF  
ALL STATES REQUIRE NOTIFICATION  
OF EXCAVATORS, DESIGNERS, OR  
ANY PERSON PREPARING TO  
DISTURB THE EARTH'S SURFACE  
ANYWHERE IN ANY STATE

Know what's below.  
Call before you dig.  
FOR STATE SPECIFIC DIRECT PHONE NUMBERS  
VISIT: WWW.CALL811.COM

STERLING OFFICE  
22375 Brudenrick Drive  
Suite 110  
Sterling, VA 20166  
Phone: 703.430.4330  
Fax: 703.430.4339

LEGEND AND IMPACT TABLES

SCALE	DATE	DRAWN BY	CHECKED BY
AS SHOWN	05/10/2022	CME	JWC
PROJECT NUMBER	DRAWING NAME		
20000031A	C-WETLAND IMPACT PLATES		

SHEET TITLE:  
**PLATE NO. 2**

SHEET NUMBER:  
**2 of 15**

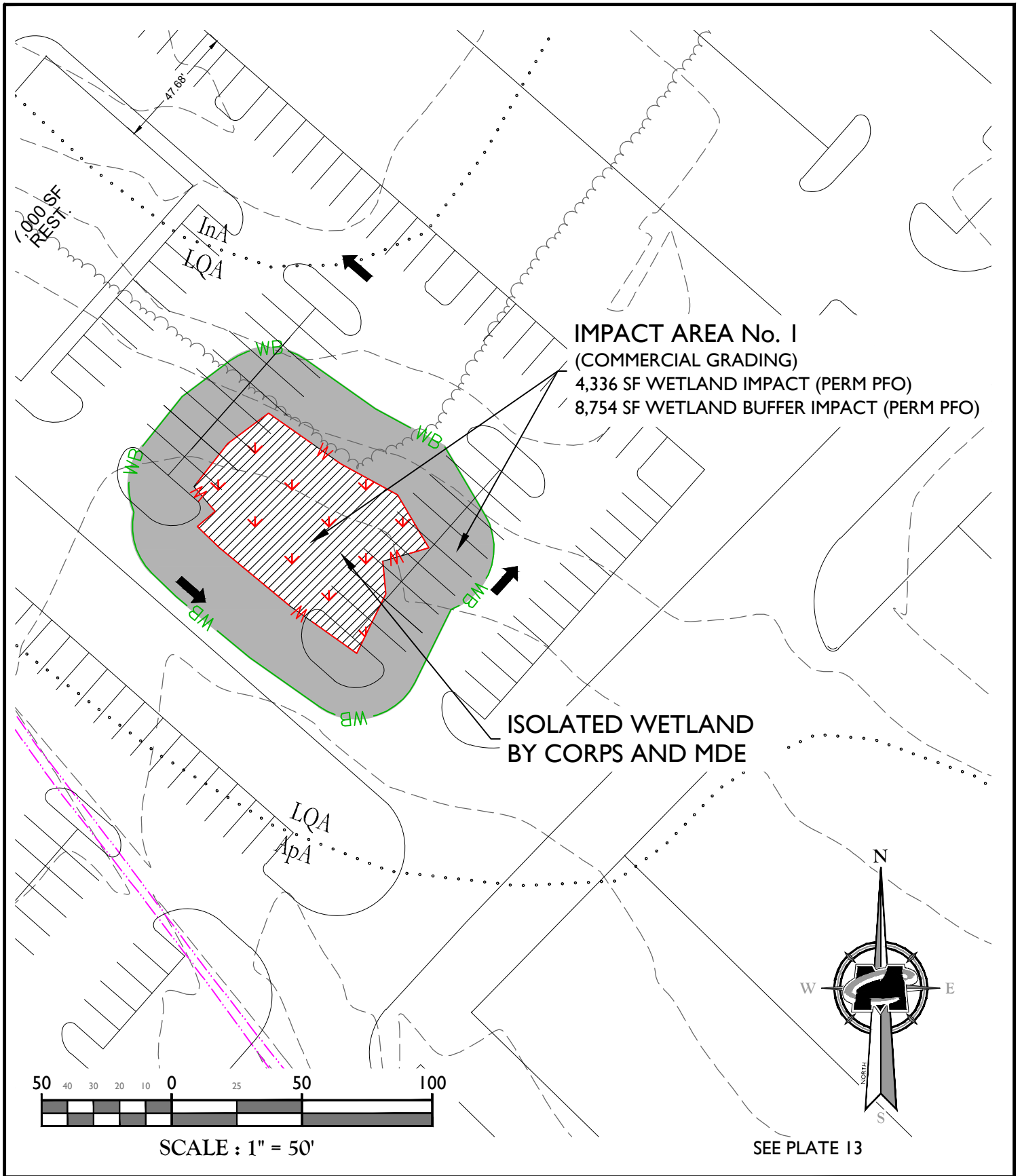

**MASER**  
CONSULTING P.A.

Customer Loyalty through Client Satisfaction  
 www.maserconsulting.com

Engineers ■ Planners ■ Surveyors  
 Landscape Architects ■ Environmental Scientists

Office Locations:

- Red Bank, NJ
- Clinton, NJ
- Hamilton, NJ
- Egg Harbor, NJ
- Montvale, NJ
- Mt. Arlington, NJ
- Mt. Laurel, NJ
- Albany, NY
- Newburgh, NY
- Hawthorne, NY
- Columbia, MD
- Lehigh Valley, PA
- Exton, PA
- Philadelphia, PA
- Pittsburgh, PA
- Tampa, FL
- Orlando, FL
- Miami, FL
- Sterling, VA
- Norfolk, VA
- Albuquerque, NM
- Charlotte, NC

Copyright © 2022, Maser Consulting P.A. All Rights Reserved. This drawing and all the information contained herein is authorized for use only by the party for whom the services were contracted or to whom it is certified. This drawing may not be copied, reused, disclosed, distributed or relied upon for any other purpose without the express written consent of Maser Consulting P.A.

**WETLAND IMPACT PLATES**

FOR  
**STEPHEN'S CROSSING AT BRANDYWINE**  
 15-NT-0395/201561897  
**BRANDYWINE BUSINESS PARK,**  
**LOTS 2-21, 23-27, PARCELS A-C,**  
**& OUTPARCEL A**

**PRINCE GEORGE'S COUNTY**  
**MARYLAND**

**PROTECT YOURSELF**  
 ALL STATES REQUIRE NOTIFICATION OF EXCAVATORS, DESIGNERS, OR ANY PERSON PREPARING TO DISTURB THE EARTH'S SURFACE ANYWHERE IN ANY STATE

Know what's below.  
 Call before you dig.  
 FOR STATE SPECIFIC DIRECT PHONE NUMBERS VISIT: WWW.CALL811.COM

**STERLING OFFICE**  
 22375 Br odereck Drive  
 Suite 110  
 Sterling, VA 20166

Phone: 703.430.4330  
 Fax: 703.430.4339

IMPACT AREA No. 1			
SCALE	DATE	DRAWN BY:	CHECKED BY:
AS SHOWN	05/04/2022	CME	JWC
PROJECT NUMBER:	DRAWING NAME:		
20000031A	C-WETLAND IMPACT PLATES		
SHEET TITLE:			
PLATE NO. 3			
SHEET NUMBER:			
3 of 15			

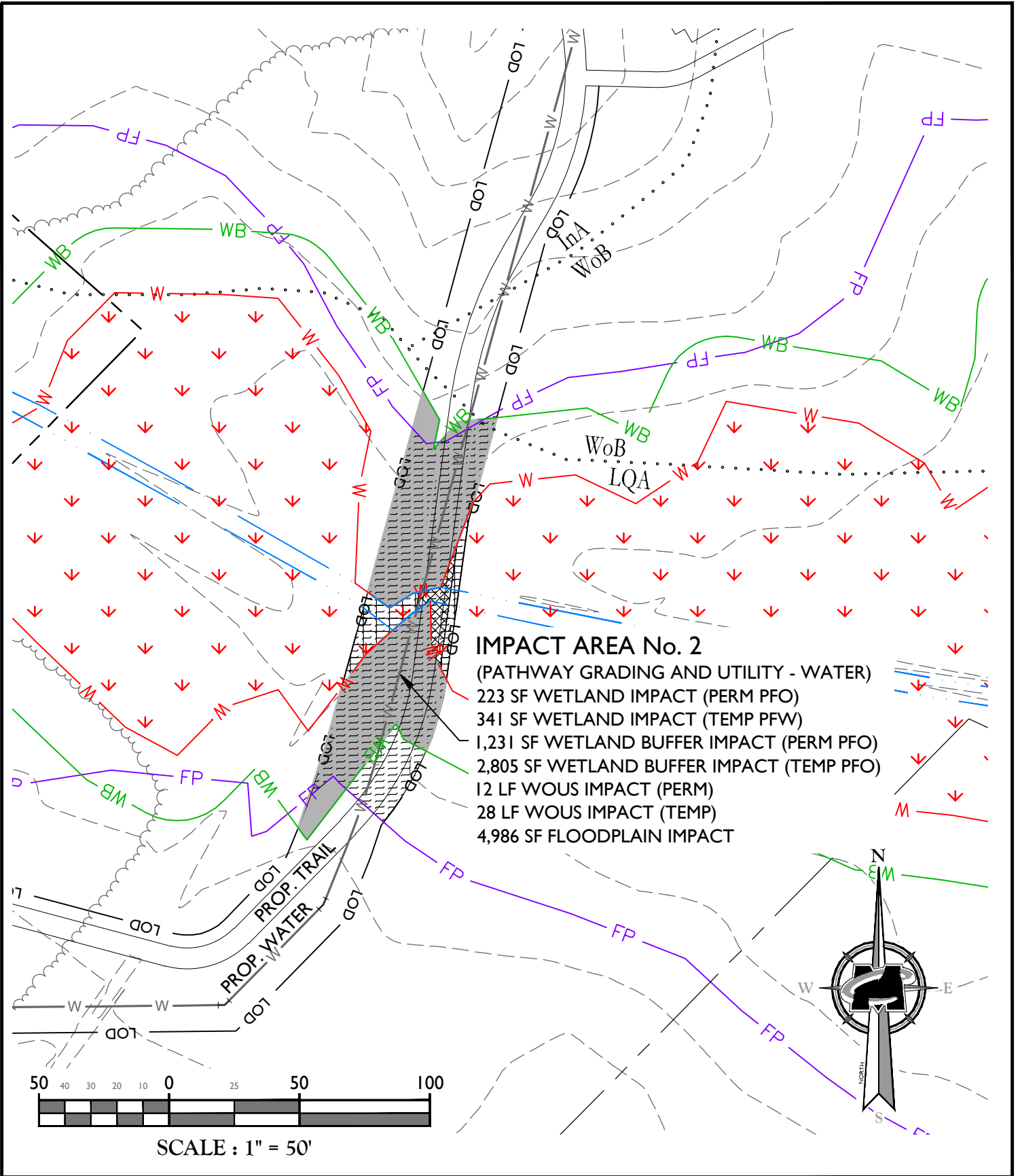

**IMPACT AREA No. 2**  
 (PATHWAY GRADING AND UTILITY - WATER)  
 223 SF WETLAND IMPACT (PERM PFO)  
 341 SF WETLAND IMPACT (TEMP PFW)  
 1,231 SF WETLAND BUFFER IMPACT (PERM PFO)  
 2,805 SF WETLAND BUFFER IMPACT (TEMP PFO)  
 12 LF WOBS IMPACT (PERM)  
 28 LF WOBS IMPACT (TEMP)  
 4,986 SF FLOODPLAIN IMPACT

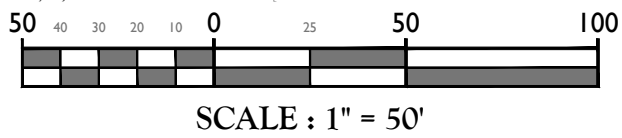

**MASER**  
CONSULTING P.A.

Customer Loyalty through Client Satisfaction  
[www.maserconsulting.com](http://www.maserconsulting.com)

Engineers ■ Planners ■ Surveyors  
 Landscape Architects ■ Environmental Scientists

Office Locations:

■ Red Bank, NJ	■ Lehigh Valley, PA
■ Clinton, NJ	■ Exton, PA
■ Hamilton, NJ	■ Philadelphia, PA
■ Egg Harbor, NJ	■ Pittsburgh, PA
■ Montvale, NJ	■ Tampa, FL
■ Mt. Arlington, NJ	■ Orlando, FL
■ Mt. Laurel, NJ	■ Miami, FL
■ Albany, NY	■ Sterling, VA
■ Newburgh, NY	■ Norfolk, VA
■ Hawthorne, NY	■ Albuquerque, NM
■ Columbia, MD	■ Charlotte, NC

Copyright © 2021, Maser Consulting P.A. All Rights Reserved. This drawing and all the information contained herein is authorized for use only by the party for whom the services were contracted or to whom it is certified. This drawing may not be copied, reused, disclosed, distributed or relied upon for any other purpose without the express written consent of Maser Consulting P.A.

WETLAND IMPACT PLATES  
 FOR  
 STEPHEN'S CROSSING AT  
 BRANDYWINE  
 BRANDYWINE BUSINESS PARK  
 LOTS 2-21, 23-27, PARCELS A-C,  
 & OUTPARCEL A  
 BRANDYWINE  
 PRINCE GEORGE'S COUNTY  
 MARYLAND

PROTECT YOURSELF  
 ALL STATES REQUIRE NOTIFICATION  
 OF EXCAVATORS, DESIGNERS, OR  
 ANY PERSON PREPARING TO  
 DISTURB THE EARTH'S SURFACE  
 ANYWHERE IN ANY STATE

Know what's below.  
 Call before you dig.  
 FOR STATE SPECIFIC DIRECT PHONE NUMBERS  
 VISIT: [WWW.CALL811.COM](http://WWW.CALL811.COM)

**STERLING OFFICE**  
 22375 Broderick Drive  
 Suite 110  
 Sterling, VA 20166  
 Phone: 703.430.4330  
 Fax: 703.430.4339

IMPACT AREA No. 2			
SCALE:	DATE:	DRAWN BY:	CHECKED BY:
AS SHOWN	03/17/2021	CME	JWC
PROJECT NUMBER:		DRAWING NAME:	
20000031A		C-WETLAND IMPACT PLATES	
SHEET TITLE:			
PLATE NO. 4			
SHEET NUMBER:			
4 of 15			

**IMPACT AREA No. 3**  
 (PUBLIC ROAD)  
 25,184 SF WETLAND IMPACT  
 (PERM PFO)  
 13,184 SF WETLAND BUFFER  
 IMPACT (PERM PFO)  
 235 LF WOUS IMPACT (PERM)  
 22 LF WOUS IMPACT (TEMP)  
 9,984 SF FLOODPLAIN IMPACT

**IMPACT AREA No. 14**  
 (UTILITY - SEWER)  
 906 SF WETLAND BUFFER IMPACT  
 (TEMP PFO)  
 3,720 SF FLOODPLAIN IMPACT  
 (TEMP)

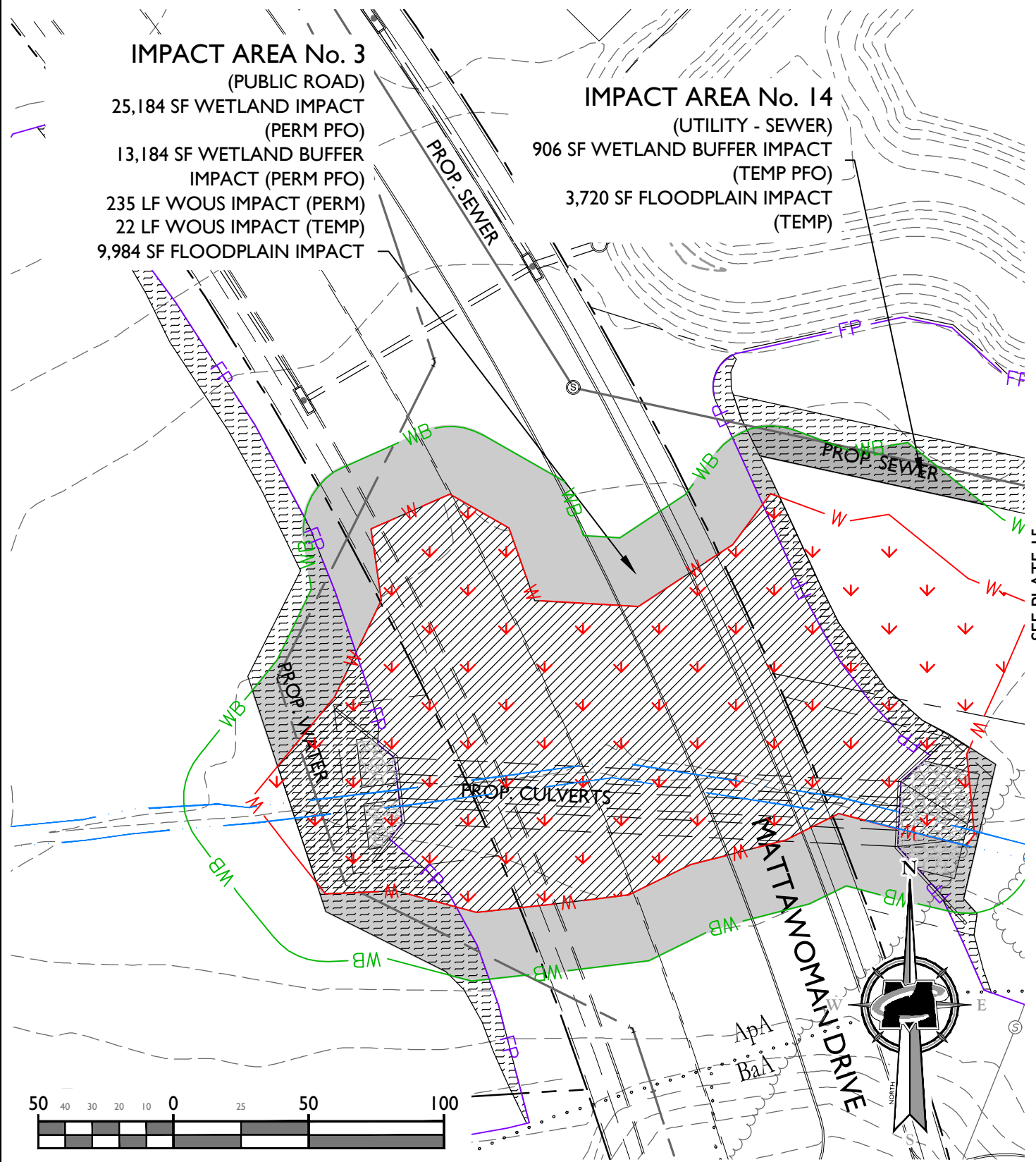

SEE PLATE 15

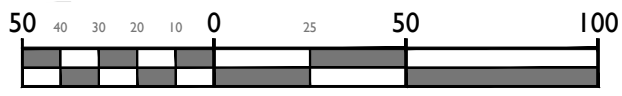

SCALE : 1" = 50'

**MASER CONSULTING P.A.**

Customer Loyalty through Client Satisfaction  
 www.maserconsulting.com

Engineers ■ Planners ■ Surveyors  
 Landscape Architects ■ Environmental Scientists

Office Locations:

■ Red Bank, NJ	■ Lehigh Valley, PA
■ Clinton, NJ	■ Exton, PA
■ Hamilton, NJ	■ Philadelphia, PA
■ Egg Harbor, NJ	■ Pittsburgh, PA
■ Montvale, NJ	■ Tampa, FL
■ Mt. Arlington, NJ	■ Orlando, FL
■ Mt. Laurel, NJ	■ Miami, FL
■ Albany, NY	■ Sterling, VA
■ Newburgh, NY	■ Norfolk, VA
■ Hawthorne, NY	■ Albuquerque, NM
■ Columbia, MD	■ Charlotte, NC

Copyright © 2021 Maser Consulting P.A. All Rights Reserved. This drawing and all the information contained herein is authorized for use only by the party for whom the services were contracted or to whom it is certified. This drawing may not be copied, reused, disclosed, distributed or relied upon for any other purpose without the express written consent of Maser Consulting P.A.

WETLAND IMPACT PLATES  
 FOR  
 STEPHEN'S CROSSING AT  
 BRANDYWINE  
 BRANDYWINE BUSINESS PARK  
 LOTS 2-21, 23-27, PARCELS A-C,  
 & OUTPARCEL A  
 BRANDYWINE  
 PRINCE GEORGE'S COUNTY  
 MARYLAND

**811**  
 Know what's below.  
 Call before you dig.  
 FOR STATE SPECIFIC DIRECT PHONE NUMBERS  
 VISIT: WWW.CALL811.COM

**PROTECT YOURSELF**  
 ALL STATES REQUIRE NOTIFICATION  
 OF EXCAVATORS, DESIGNERS, OR  
 ANY PERSON PREPARING TO  
 DISTURB THE EARTH'S SURFACE  
 ANYWHERE IN ANY STATE

**STERLING OFFICE**  
 22375 Braddock Drive  
 Suite 110  
 Sterling, VA 20166  
 Phone: 703.430.4330  
 Fax: 703.430.4339

IMPACT AREA No. 3 AND 14			
SCALE:	DATE:	DRAWN BY:	CHECKED BY:
AS SHOWN	03/17/2021	CME	JWC
PROJECT NUMBER:	DRAWING NAME:		
20000031A	C-WETLAND IMPACT PLATES		
SHEET TITLE:			
PLATE NO. 5			
SHEET NUMBER:			
5 of 15			