

U.S. Army Corps
of Engineers
Baltimore District
PN-19-13

Public Notice

In Reply to Application Number

NAB-2018-61862 (CHRISTOPHER AND CARTER

BRADSHAW) Comment Period: March 1, 2019 to March 22, 2019

THE PURPOSE OF THIS PUBLIC NOTICE IS TO SOLICIT COMMENTS FROM THE PUBLIC REGARDING THE WORK DESCRIBED BELOW. NO DECISION HAS BEEN MADE AS TO WHETHER OR NOT A PERMIT WILL BE ISSUED AT THIS TIME.

This District has received an application for a Department of the Army permit pursuant to Section 10 of the Rivers and Harbors Act of 1899 and Section 404 of the Clean Water Act (33 U.S.C. 1344) as described below:

APPLICANT: Messrs. Christopher and Carter Bradshaw
c/o Dani Walton, Lane Engineering, LLC
117 Bay Street
Easton, Maryland 21601

WATERWAY AND LOCATION OF THE PROPOSED WORK: In Hunting Creek at Easton, Talbot County, Maryland.

PROPOSED WORK AND PURPOSE: The applicant proposes to repair approximately 275 linear feet of riprap revetment to extend no more than 5 feet channelward of the approximate mean high water (MHW) shoreline; to deposit approximately 69 cubic yards of sloped, clean select sand fill, averaging 27-feet wide as beach nourishment, to extend no more than 27 feet channelward of the approximate MHW shoreline stabilized with 95 linear feet of segmented stone sill, 8-feet wide at the base and 2-feet wide at the top, to extend no more than 35 feet channelward of the approximate MHW shoreline; to create marsh along 135 linear feet of shoreline by depositing approximately 35 cubic yards of sloped, clean select sand fill in unvegetated areas, stabilized with 1,257 square feet of *Spartina alterniflora* to extend no more than 27 feet channelward of the approximate MHW shoreline; to emplace 135 linear feet of low-profile stone sill, 8-feet wide at the base and 2-feet wide at the top, to extend no more than 35 feet channelward of the approximate MHW shoreline; to emplace 2-feet wide by 85 linear feet of stone tidal marsh edging along the existing un-vegetated marsh face to extend no more than 16 feet channelward of the approximate MHW shoreline; to emplace 3-feet wide by 50 linear feet of stone tidal marsh edging along the existing un-vegetated marsh face to extend no more than 13 feet channelward of the approximate MHW shoreline; to enhance approximately 819 square feet of tidal marsh as follows: to emplace approximately 11 cubic yards of clean sand fill, stabilized with 189 square feet of *S. alterniflora*, to extend no more than 10 feet channelward of the approximate MHW shoreline and to emplace approximately 20 cubic yards of clean sand fill, stabilized with 630 square feet of *S. alterniflora*; to create marsh along 935 linear feet of shoreline by depositing approximately 779 cubic yards of sloped, clean select sand fill in unvegetated areas, stabilized with 7,012.5 square feet of *Spartina alterniflora* and 7,012.5 square feet of *Spartina patens* to extend no more than 23 feet channelward of the approximate MHW shoreline, to emplace 125 linear feet of low-profile stone sill, 8-

feet wide at the base and 2-feet wide at the top, to extend no more than 23 feet channelward of the approximate MHW shoreline, and to emplace 810 linear feet of segmented, low-profile stone sill, 8-feet wide at the base and 2-feet wide at the top, to extend no more than 23 feet channelward of the approximate MHW shoreline to completely remove an existing 5-foot wide by 100 foot long pier with a 15-foot wide by 20-foot long "L" head platform; and to construct a 5-foot wide by 45-foot long walkway to a 6-foot wide by 67-foot long pier with a 10-foot wide by 20-foot long "L" head platform, to install 2 personal watercraft lifts, one 4-pile boat lift, and to install 4 mooring piles, all to extend no more than 128 feet channelward of the approximate MHW shoreline. All work is proposed in accordance with the attached plans dated October 12, 2018 and revised on February 5, 2019. If you have any questions concerning this matter, please contact Jessica Miller at (410) 820-8629 or Jessica.d.miller@usace.army.mil.

The purposes of the project are shoreline erosion control, beach nourishment, and navigational access.

As part of the planning process for the proposed project, steps were taken to ensure avoidance and minimization of impacts to aquatic resources to the maximum extent practicable based on the existing site conditions and previously authorized work. Because the project would involve the deposition of fill within approximately 630 square feet of tidal vegetated wetlands, it does not qualify for authorization pursuant to the MD-SPGP-5 and is being processed as a standard permit.

No compensatory mitigation is proposed. Although approximately 630 square feet of tidal wetland vegetation would be buried or altered, the project would maintain approximately 16,101 square feet of enhanced intertidal wetlands vegetated with high and low marsh grasses.

The decision whether to issue a permit will be based on an evaluation of the probable impacts, including cumulative impacts of the proposed activity on the public interest. That decision will reflect the national concern for both protection and utilization of important resources. The benefit, which reasonably may be expected to accrue from the proposal, must be balanced against its reasonably foreseeable detriments. All factors, which may be relevant to the proposal will be considered, including the cumulative effects thereof; among those are conservation, economic, aesthetics, general environmental concerns, wetlands, cultural values, fish and wildlife values, flood hazards, flood plain values, land use, navigation, shoreline erosion and accretion, recreation, water supply and conservation, water quality, energy needs, safety, food and fiber production, mineral needs, and consideration of property ownership and in general, the needs and welfare of the people.

The evaluation of the impacts of the work described above on the public interest will include application of the Clean Water Act 404(b)(1) Guidelines promulgated by the Administrator, U.S. Environmental Protection Agency, under authority of Section 404 of the Clean Water Act.

The Corps of Engineers is soliciting comments from the public; Federal, State, and local agencies and officials; Indian Tribes; and other interested parties in order to consider and evaluate the impacts of this proposed activity. Any comments received will be considered by the Corps of Engineers to determine whether to issue, modify, condition

or deny a permit for this proposal. To make this decision, comments are used to assess impacts on endangered species, historic properties, water quality, general environmental effects, and the other public interest factors listed above. Comments are used in the preparation of an Environmental Assessment and/or an Environmental Impact Statement pursuant to the National Environmental Policy Act. Comments provided will become part of the public record for this action. Comments are also used to determine the need for a public hearing and to determine the overall public interest of the proposed activity.

Written comments concerning the work described above related to the factors listed above or other pertinent factors must be received by the District Engineer, U.S. Army Corps of Engineers, Baltimore District, [Attn: Jessica Miller, CENAB-OPR-M], 218 N. Washington Street, Suite 304 Easton, MD 21601 or jessica.d.miller@usace.army.mil, within the comment period specified above.

ESSENTIAL FISH HABITAT: The Magnuson-Stevens Fishery Conservation and Management Act (MSFCMA), as amended by the Sustainable Fisheries Act of 1996 (Public Law 04-267), requires all Federal agencies to consult with the National Marine Fisheries Service (NMFS) on all actions, or proposed actions, permitted, funded, or undertaken by the agency that may adversely effect Essential Fish Habitat (EFH).

The project site lies in or adjacent to EFH as described under MSFCMA for the Chesapeake Bay, Mainstream complex for EFH as described under the MSFCMA for *Scophthalmus aquosus* (windowpane flounder) juvenile; *Pomatomus saltatrix* (blue fish) juvenile and adult; *Stenotomus chrysops* (scup) juvenile and adult; *Paralichthys dentatus* (summer flounder) larvae, juvenile and adult; *Centropristus striata* (black sea bass) juvenile and adult; *Leucoraja erinacea* (little skate) adult; *Clupea harengus* (Atlantic herring) juvenile and adult; *Leucoraja ocellata* (winter skate) adult; *Raja eglanteria* (clearnose skate) juvenile and adult; and the eggs, larvae, juvenile, and adult stages of *Urophycis chuss* (red hake), *Sciaenops ocellatus* (red drum), *Scomberomorus cavalla* (king mackerel), *Scomberomorus maculatus* (Spanish mackerel), and *Rachycentron canadum* (cobia), managed species under the MSFCMA., all managed species under the MSFCMA.

The project has the potential to adversely affect EFH or the species of concern by loss of spawning, nursery, forage and/or shelter habitat as described under the MSFCMA for the species and life stages identified above. The Baltimore District has made a preliminary determination that site-specific impacts would not be substantial and an abbreviated consultation will be conducted with NMFS. No mitigative measures are recommended to minimize adverse effects on EFH at this time. This determination may be modified if additional information indicates otherwise and would change the preliminary determination. The project area is not a Habitat Area of Particular Concern (HAPC).

WATER QUALITY CERTIFICATION: The applicant is required to obtain a water quality certification in accordance with Section 401 of the Clean Water Act from the **Maryland Department of the Environment**. Any written comments concerning the work described above which relate to water quality certification must be received by the Wetlands and Waterways Program, Maryland Department of the Environment, Montgomery Park Business Center, 1800 Washington Boulevard, Suite 430, Baltimore, Maryland 21230-1708 within the comment period as specified above to receive consideration. The Section 401 certifying agency has a statutory limit of one year from the date of this public notice to

make its decision.

COASTAL ZONE MANAGEMENT PROGRAMS: Where applicable, the applicant has certified in this application that the proposed activity complies with and will be conducted in a manner consistent with the approved Coastal Zone Management (CZM) Program. By this public notice, we are requesting the State concurrence or objection to the applicant's consistency statement. It should be noted that the CZM Program has a statutory limit of 6 months to make its consistency determination.

The applicant must obtain any State or local government permits which may be required.

ENDANGERED SPECIES ACT: A preliminary review of this application indicates that the proposed work will not affect Federal listed threatened or endangered species or their critical habitat, pursuant to Section 7 of the Endangered Species Act, as amended. As the evaluation of this application continues, additional information may become available which could modify this preliminary determination.

NATIONAL HISTORIC PRESERVATION ACT: Review of the latest published version of the National Register of Historic Places indicates that no registered properties listed as eligible for inclusion, therein, are located at the site of the proposed work. Currently unknown archeological, scientific, prehistoric, or historical data may be lost or destroyed by the work to be accomplished under the request permit.

The evaluation of the impact of this project on the public interest will include application of the guidelines promulgated by the Administrator, U.S. Environmental Protection Agency, under authority of Section 404 of the Clean Water Act.

Any person who has an interest which may be adversely affected by the issuance of this permit may request a public hearing. The request, which must be in writing, must be received by the District Engineer, U.S. Army Corps of Engineers, Baltimore District, 218 N. Washington Street, Suite 304 Easton, MD 21601, within the comment period as specified above to receive consideration. Also it must clearly set forth the interest which may be adversely affected by this activity and the manner in which the interest may be adversely affected.

It is requested that you communicate this information concerning the proposed work to any persons known by you to be interested and not being known to this office, who did not receive a copy of this notice.

FOR THE DISTRICT ENGINEER:

Kathy B. Anderson
Chief, Maryland Section Southern

TIDAL WETLAND PERMIT DRAWINGS
PREPARED FOR
CHRISTOPHER E. BRADSHAW &
CARTER G. BRADSHAW
IN THE FIRST ELECTION DISTRICT
TALBOT COUNTY, MARYLAND

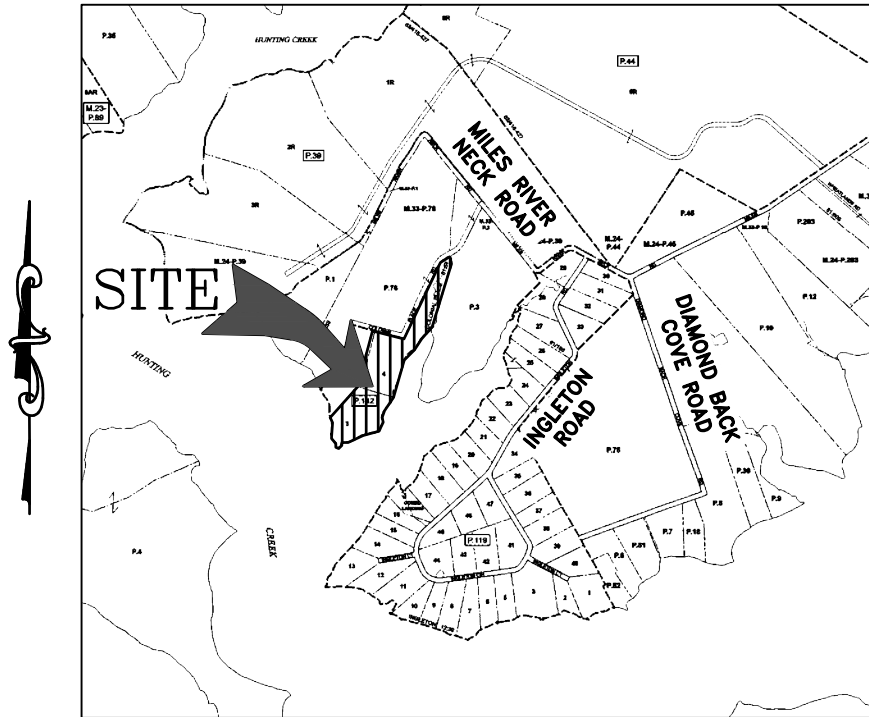

VICINITY MAP
SCALE: 1" = 2,000'

ENGINEER

Lane Engineering, LLC
117 BAY STREET
EASTON, MARYLAND 21601
(410) 822-8003

OWNER/DEVELOPER

CHRISTOPHER E. BRADSHAW
CARTER G. BRADSHAW
2777 YULUPA AVE #187
SANTA ROSA, CA 95405

PROJECT LOCATION

26325 MILES RIVER ROAD
EASTON, MD 21601

ISSUE FOR:	DATE:	BY:	No.	DATE:	REVISION:	BY:
MDE SUBMITTAL	10/12/18	DSW				
MDE SUBMITTAL	12/21/18	DSW				
USACE SUBMITTAL	02/05/19	DSW				

TITLE SHEET

ON THE LANDS OF
CHRISTOPHER E. BRADSHAW &
CARTER G. BRADSHAW

IN THE FIRST ELECTION DISTRICT, TALBOT COUNTY
TAX MAP 33, GRID 2, PARCEL 142, LOTS 3 & 4

Lane Engineering, LLC

Established 1986
Civil Engineers • Land Planning • Land Surveyors



E-mail: general@leinc.com
117 Bay St. Easton, MD 21601 (410) 822-8003
15 Washington St. Cambridge, MD 21613 (410) 221-0818
354 Pennsylvania Ave. Centreville, MD 21617 (410) 758-2095

SHEET No.
1 OF 20
DATE: AS NOTED
SCALE: AS NOTED
JOB No. 180289
FILE No. 9831

LEGEND & ABBREVIATIONS

MHW MEAN HIGH WATER
MLW MEAN LOW WATER
EX EXISTING
APPROX APPROXIMATE

SPOT ELEVATION $\times -3.0$

NON-TIDAL WETLAND 

NON TIDAL WETLAND 

TIDAL WETLAND 

LIMITS OF 2016 MAPPED SAV 

LIMITS OF 2017 MAPPED SAV 

PROPERTY LINE 

TOP OF BANK 

APPROXIMATE TREE LINE 

EXISTING TREES 

EXISTING MARSH VEGETATION 

PROPOSED MARSH VEGETATION 

SITE NOTES

- LOT SIZE: LOT 3 = 5.797 AC \pm / LOT 4 = 11.09 AC \pm
- LOT DEPTH: LOT 3 = 1,200' \pm / LOT 4 = 610' \pm
- ROAD FRONTAGE: LOT 3 = 30' \pm / LOT 4 = 1,958' \pm
- LOT WIDTH AT SHORELINE: LOT 3 = 1,307' \pm / LOT 4 = 883' \pm
- MAXIMUM CHANNELWARD ENCROACHMENT = 35' (BEACH NOURISHMENT)
23'-35' (LIVING SHORELINE)
13'-16' (MARSH EDGING)
128' (PIER)
- ZONING CLASSIFICATION: RC (RURAL CONSERVATION DISTRICT)
- THE PROPERTY SHOWN HEREON LIES ENTIRELY WITHIN THE CHESAPEAKE BAY CRITICAL AREA AS SHOWN ON THE TALBOT COUNTY CRITICAL AREA MAPS IN ACCORDANCE WITH TALBOT COUNTY BILL NO. 1295, ENACTED AUGUST 12, 2014.
- MEAN HIGH WATER WAS NOT ESTABLISHED BY THIS SURVEY. MEAN HIGH WATER IS DEFINED BY ELEVATION REFERENCED TO A TIDAL BENCH MARK. THE SHORELINE WAS LOCATED TO THE EDGE OF TIDAL VEGETATION AND TO THE EDGE OF TIDAL WATER STAINS ON RIPRAP. THE BOUNDARY IS SUBJECT TO CHANGE DUE TO NATURAL CAUSES AND IT MAY NOT REPRESENT THE ACTUAL LOCATION OF THE LIMIT OF TITLE.
- THE LANDWARD IMPROVEMENTS SHOWN HEREON WERE FIELD LOCATED BY LANE ENGINEERING, LLC ON NOVEMBER 25, 2015.
- THE SHORELINE FEATURES SHOWN HEREON INCLUDING TOP OF BANK, MEAN HIGH WATER, LIMITS OF EXISTING MARSH AND SOUNDINGS WERE SURVEY LOCATED BY LANE ENGINEERING, LLC IN OCTOBER, 2018.

MHHW = 1.64

MHW = 1.40

MTW = 0.96

MLW = 0.00

MLLW = -0.20

NAVD 88 = 0.39

NGVD 29 = -0.37

VERTICAL DATUM COMPARISON CHART

SCALE: 1"=1'

NOTE: MEAN LOW WATER (MLW) AND RELATIVE TIDAL INFORMATION WAS OBTAINED FROM THE NATIONAL OCEANIC AND ATMOSPHERIC ADMINISTRATION (NOAA) AND THE NATIONAL OCEANIC SERVICE (NOS) AND ARE BASED UPON TIDAL BENCH MARK ST. MICHAELS TIDAL EPOCH 1960-1978 AND ADJUSTED 0.22 HIGHER FOR THE EPOCH 1983-2001. USING PRIMARY BENCH MARK NO 4 1942 AND BENCH MARK 7 1969 MLW WAS DETERMINED -0.39 NAVD 1988 DATUM AS ESTABLISHED BY GPS METHODOLOGY TO CORS STATIONS HNPT (PID AI3494) COMBINED FACTOR: 0.99996650 & LOYG (NGS CERTIFICATE PENDING).

LEGEND & PROJECT NOTES

ON THE LANDS OF
CHRISTOPHER E. BRADSHAW &
CARTER G. BRADSHAW

IN THE FIRST ELECTION DISTRICT, TALBOT COUNTY
TAX MAP 33, GRID 2, PARCEL 142, LOTS 3 & 4

Lane Engineering, LLC

Established 1986
Civil Engineers • Land Planning • Land Surveyors



E-mail: general@leinc.com
117 Bay St. Easton, MD 21601 (410) 822-8003
15 Washington St. Cambridge, MD 21613 (410) 221-0818
354 Pennsylvania Ave. Centreville, MD 21617 (410) 758-2095

FILE No. 9831
JOB No. 180289
SCALE: AS NOTED
DATE: AS NOTED
SHEET No. 2 OF 20

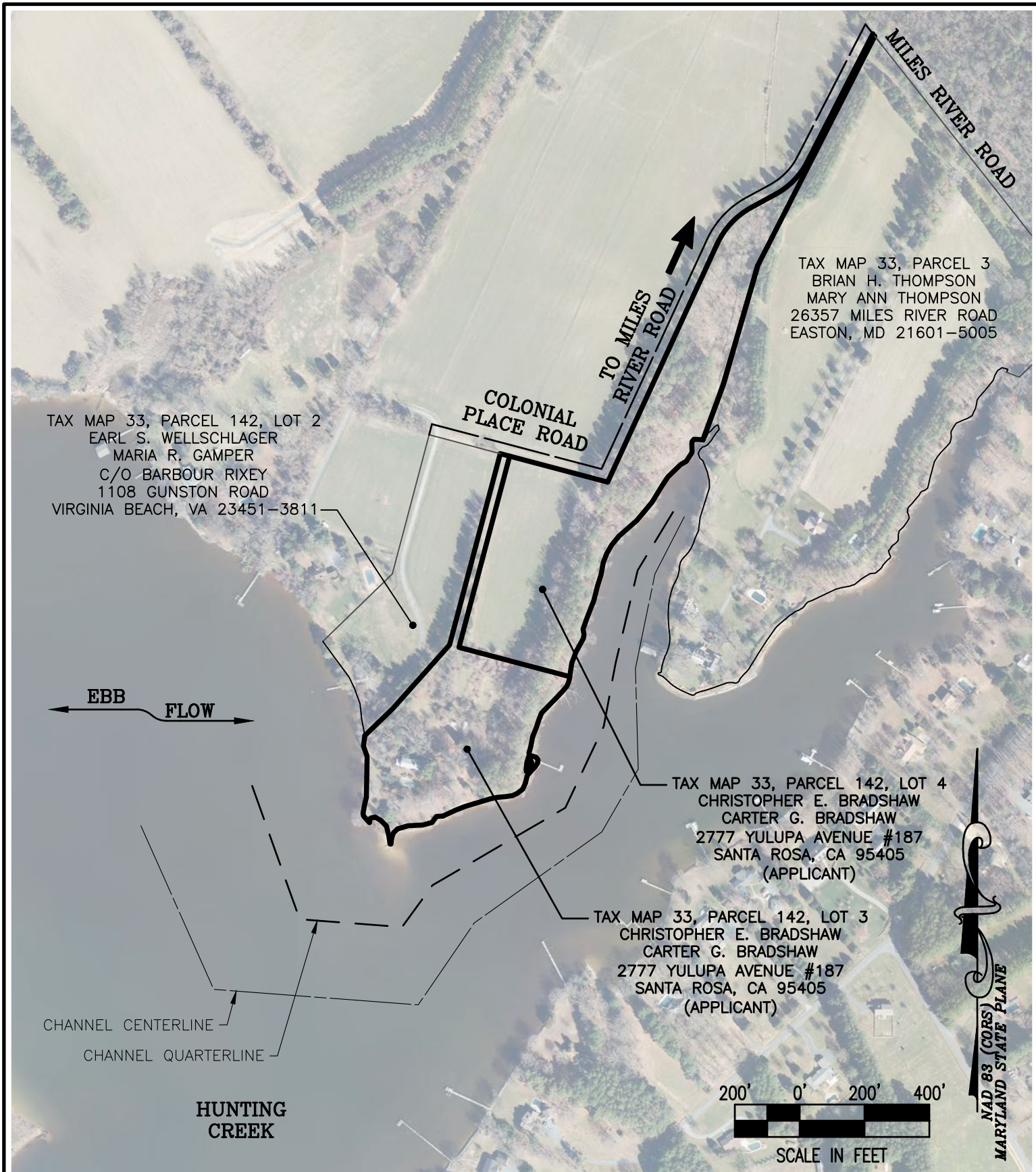

SHEET No.
3 OF 20

DATE: AS NOTED

SCALE: AS NOTED

JOB No. 180289

FILE No. 9831

SITE OVERVIEW

ON THE LANDS OF
CHRISTOPHER E. BRADSHAW &
CARTER G. BRADSHAW

IN THE FIRST ELECTION DISTRICT, TALBOT COUNTY
TAX MAP 33, GRID 2, PARCEL 142, LOTS 3 & 4

Lane Engineering, LLC

Established 1986
 Civil Engineers • Land Planning • Land Surveyors

E-mail: general@leinc.com
 117 Bay St. Easton, MD 21601 (410) 822-8003
 15 Washington St. Cambridge, MD 21613 (410) 221-0818
 354 Pennsylvania Ave. Centreville, MD 21617 (410) 758-2095

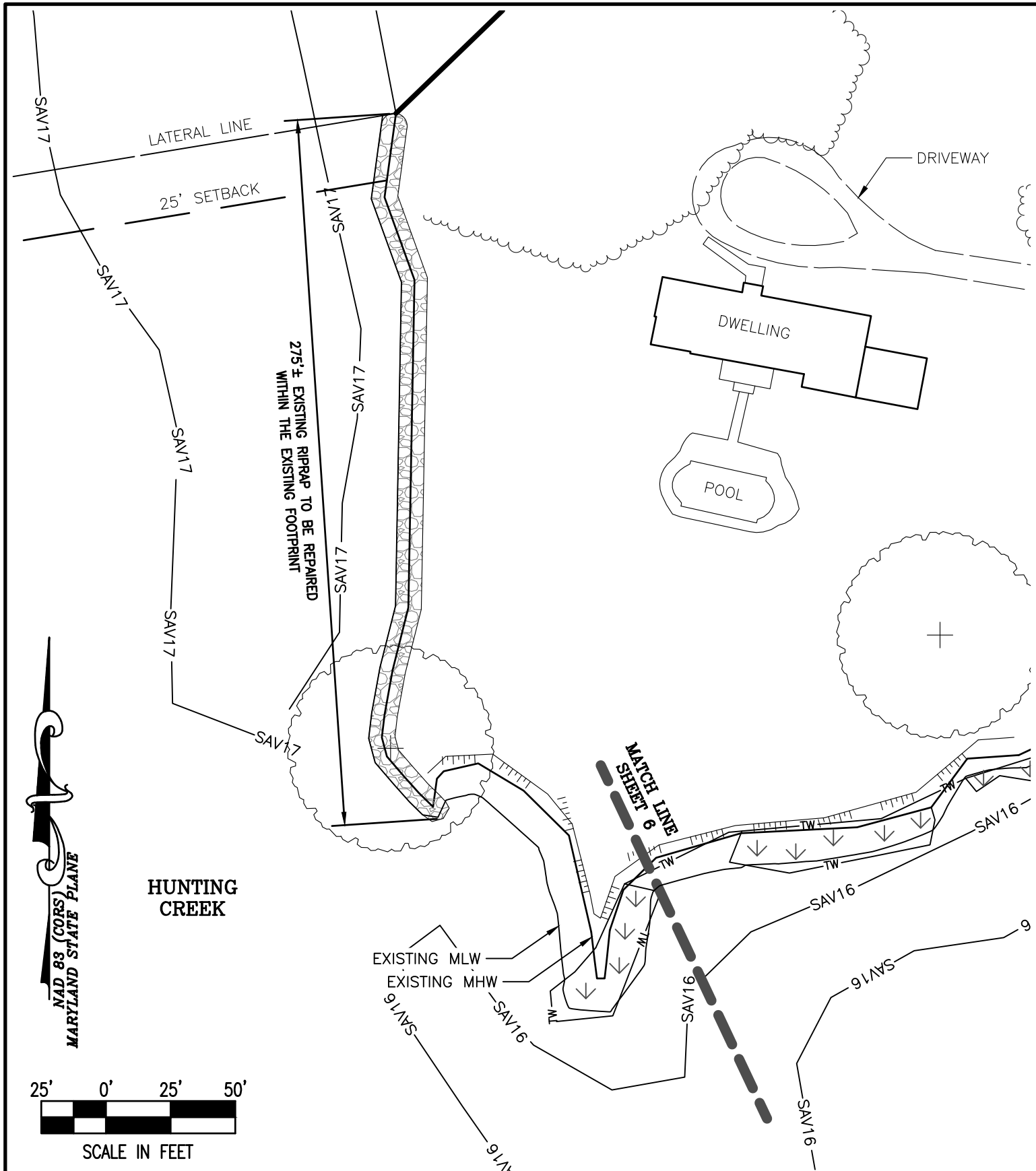

FILE No. 9831

JOB No. 180289

SCALE: AS NOTED

DATE: AS NOTED

SHEET No. 5 OF 20

EXISTING CONDITIONS

ON THE LANDS OF

CHRISTOPHER E. BRADSHAW &

CARTER G. BRADSHAW

IN THE FIRST ELECTION DISTRICT, TALBOT COUNTY

TAX MAP 33, GRID 2, PARCEL 142, LOTS 3 & 4

Lane Engineering, LLC

Established 1986

Civil Engineers • Land Planning • Land Surveyors



E-mail: general@leinc.com

117 Bay St. Easton, MD 21601 (410) 822-8003

15 Washington St. Cambridge, MD 21613 (410) 221-0818

354 Pennsylvania Ave. Centreville, MD 21617 (410) 758-2095

25' 0' 25' 50'



SCALE IN FEET

DRIVEWAY

DWELLING

POOL

NAD 83 (CORS)
MARYLAND STATE PLANE

MATCH LINE
SHEET 7

MATCH LINE
SHEET 5

CHANNEL QUARTERLINE

HUNTING CREEK

EXISTING & PROPOSED MLW
EXISTING & PROPOSED MHW

EXISTING CONDITIONS

ON THE LANDS OF
CHRISTOPHER E. BRADSHAW &
CARTER G. BRADSHAW

IN THE FIRST ELECTION DISTRICT, TALBOT COUNTY
TAX MAP 33, GRID 2, PARCEL 142, LOTS 3 & 4

Lane Engineering, LLC

Established 1986
Civil Engineers • Land Planning • Land Surveyors



E-mail: general@leinc.com
117 Bay St. Easton, MD 21601 (410) 822-8003
15 Washington St. Cambridge, MD 21613 (410) 221-0818
354 Pennsylvania Ave. Centreville, MD 21617 (410) 758-2095

SHEET No.
6 OF 20
DATE: AS NOTED
SCALE: AS NOTED
JOB No. 180289
FILE No. 9831

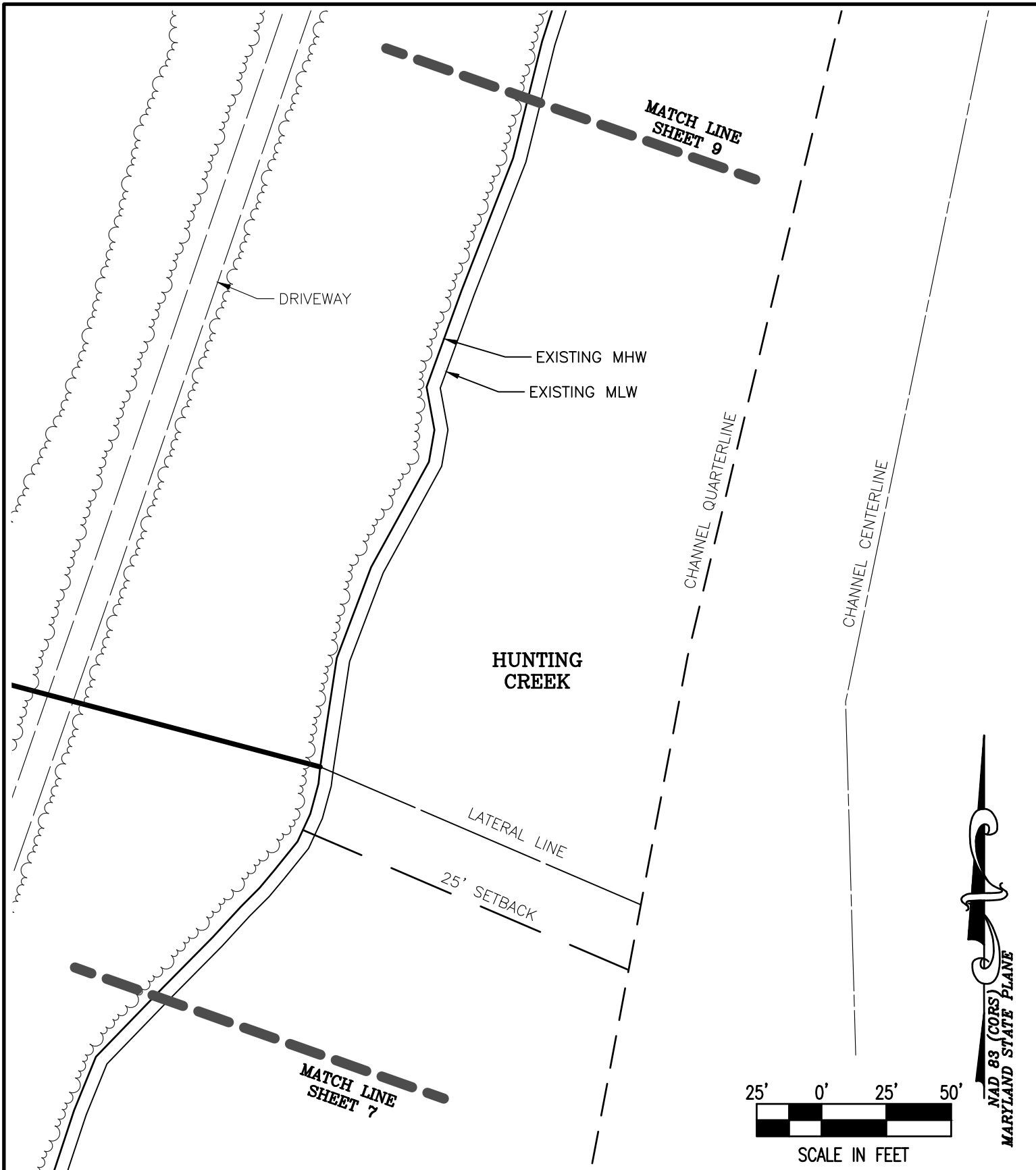

FILE No. 9831

JOB No. 180289

SCALE: AS NOTED

DATE: AS NOTED

SHEET No.
8 OF 20

EXISTING CONDITIONS

ON THE LANDS OF

CHRISTOPHER E. BRADSHAW &

CARTER G. BRADSHAW

IN THE FIRST ELECTION DISTRICT, TALBOT COUNTY
TAX MAP 33, GRID 2, PARCEL 142, LOTS 3 & 4

Lane Engineering, LLC

Established 1986
Civil Engineers • Land Planning • Land Surveyors



E-mail: general@leinc.com
117 Bay St. Easton, MD 21601 (410) 822-8003
15 Washington St. Cambridge, MD 21613 (410) 221-0818
354 Pennsylvania Ave. Centreville, MD 21617 (410) 758-2095

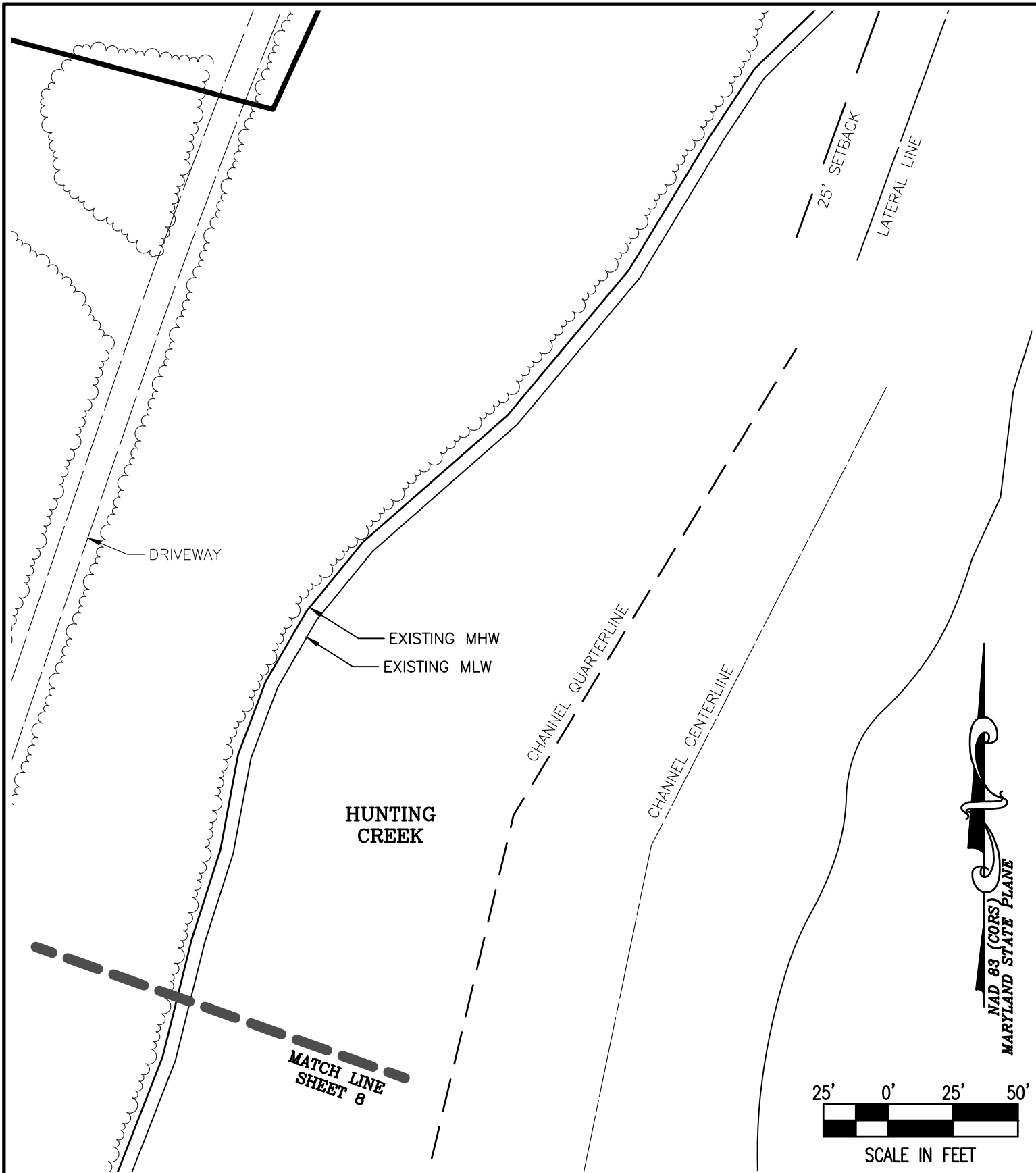

SHEET No.
9 OF 20

DATE: AS NOTED

SCALE: AS NOTED

JOB No. 180289

FILE No. 9831

EXISTING CONDITIONS

**ON THE LANDS OF
CHRISTOPHER E. BRADSHAW &
CARTER G. BRADSHAW**

**IN THE FIRST ELECTION DISTRICT, TALBOT COUNTY
TAX MAP 33, GRID 2, PARCEL 142, LOTS 3 & 4**

Lane Engineering, LLC

Established 1986
Civil Engineers • Land Planning • Land Surveyors



E-mail: general@leinc.com
117 Bay St. Easton, MD 21601 (410) 822-8003
15 Washington St. Cambridge, MD 21613 (410) 221-0818
354 Pennsylvania Ave. Centreville, MD 21617 (410) 758-2095

NOTE:

THE SHORELINE STABILIZATION
MEASURES SHOWN HEREON HAVE BEEN
DESIGNED TO AVOID IMPACTING SAV

SEE SHEETS 12-19 FOR DETAILED
PLAN VIEW AND CROSS SECTIONS

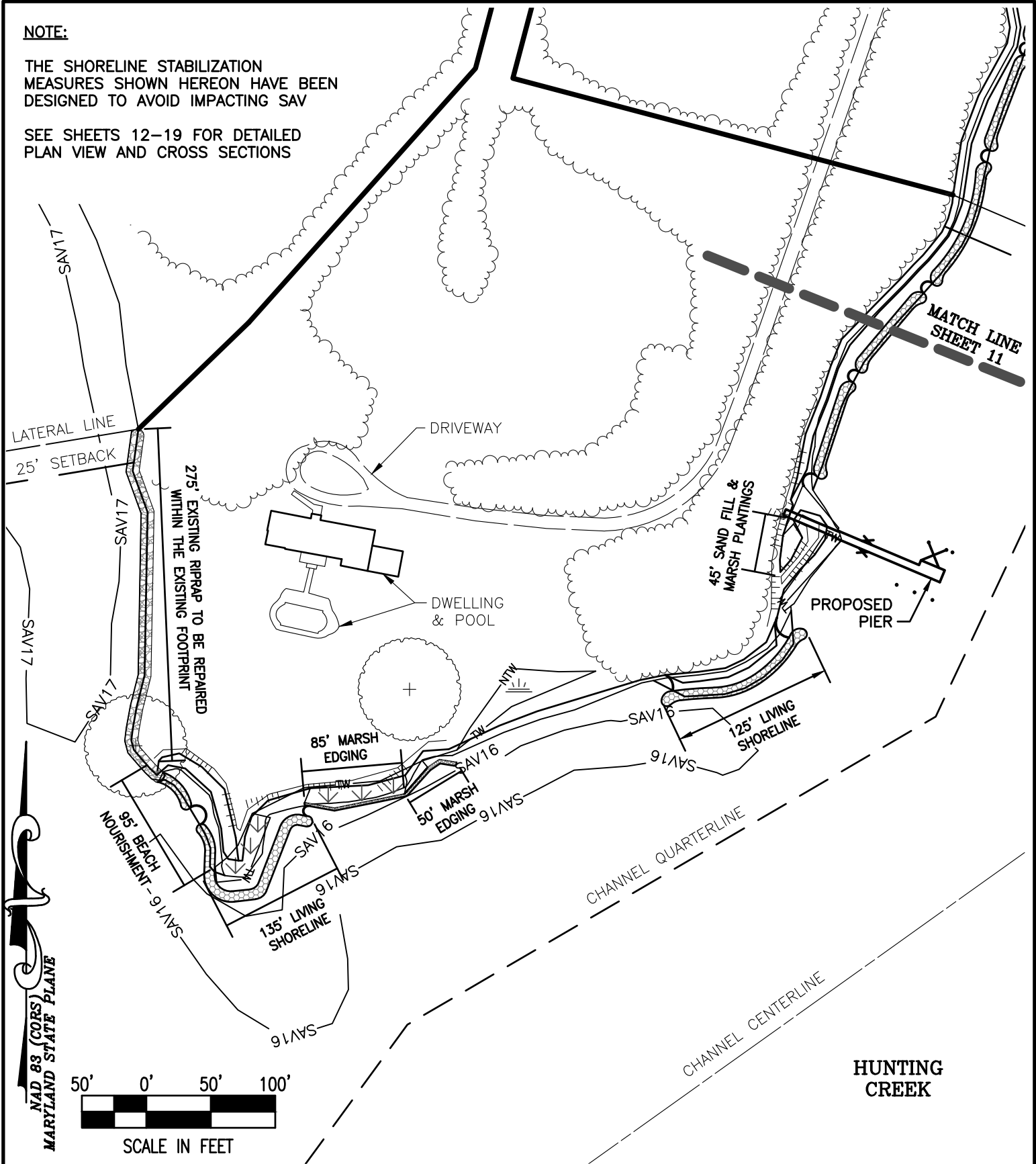

PROPOSED IMPROVEMENTS OVERVIEW

ON THE LANDS OF
**CHRISTOPHER E. BRADSHAW &
CARTER G. BRADSHAW**

IN THE FIRST ELECTION DISTRICT, TALBOT COUNTY
TAX MAP 33, GRID 2, PARCEL 142, LOTS 3 & 4

Lane Engineering, LLC

Established 1986
Civil Engineers • Land Planning • Land Surveyors



E-mail: general@leinc.com
117 Bay St. Easton, MD 21601 (410) 822-8003
15 Washington St. Cambridge, MD 21613 (410) 221-0818
354 Pennsylvania Ave. Centreville, MD 21617 (410) 758-2095

SHEET No.
10 OF 20
DATE: AS NOTED
SCALE: AS NOTED
JOB No. 180289
FILE No. 9831

NOTE:

THE SHORELINE STABILIZATION MEASURES SHOWN HEREON HAVE BEEN DESIGNED TO AVOID IMPACTING SAV

SEE SHEETS 12-19 FOR DETAILED PLAN VIEW AND CROSS SECTIONS

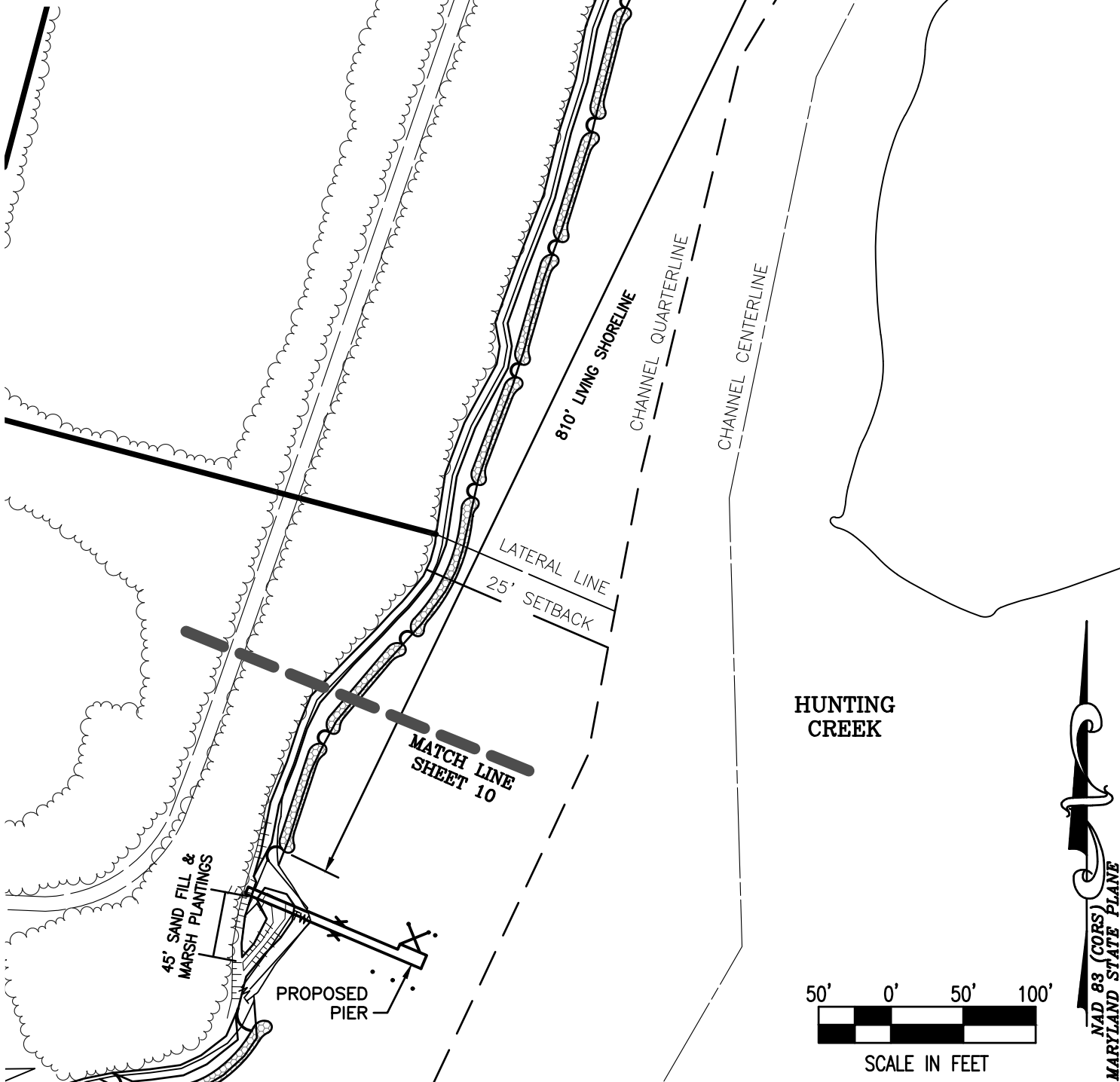

FILE No. 9831
JOB No. 180289
SCALE: AS NOTED
DATE: AS NOTED
SHEET No. 11 OF 20

PROPOSED IMPROVEMENTS OVERVIEW

**ON THE LANDS OF
CHRISTOPHER E. BRADSHAW &
CARTER G. BRADSHAW**

**IN THE FIRST ELECTION DISTRICT, TALBOT COUNTY
TAX MAP 33, GRID 2, PARCEL 142, LOTS 3 & 4**

Lane Engineering, LLC

Established 1986
Civil Engineers • Land Planning • Land Surveyors



E-mail: general@leinc.com
117 Bay St. Easton, MD 21601 (410) 822-8003
15 Washington St. Cambridge, MD 21613 (410) 221-0818
354 Pennsylvania Ave. Centreville, MD 21617 (410) 758-2095

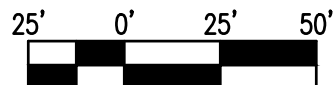

NOTE: UNLESS OTHERWISE SPECIFIED, ALL LIVING SHORELINE SECTIONS WILL FOLLOW SECTION F DESIGN

25' 0' 25' 50'



SCALE IN FEET

NAD 83 (CORS)
MARYLAND STATE PLANE

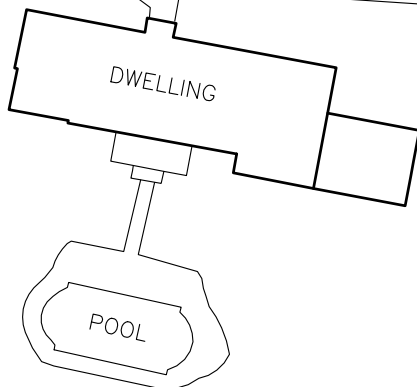

DRIVEWAY

DWELLING

POOL

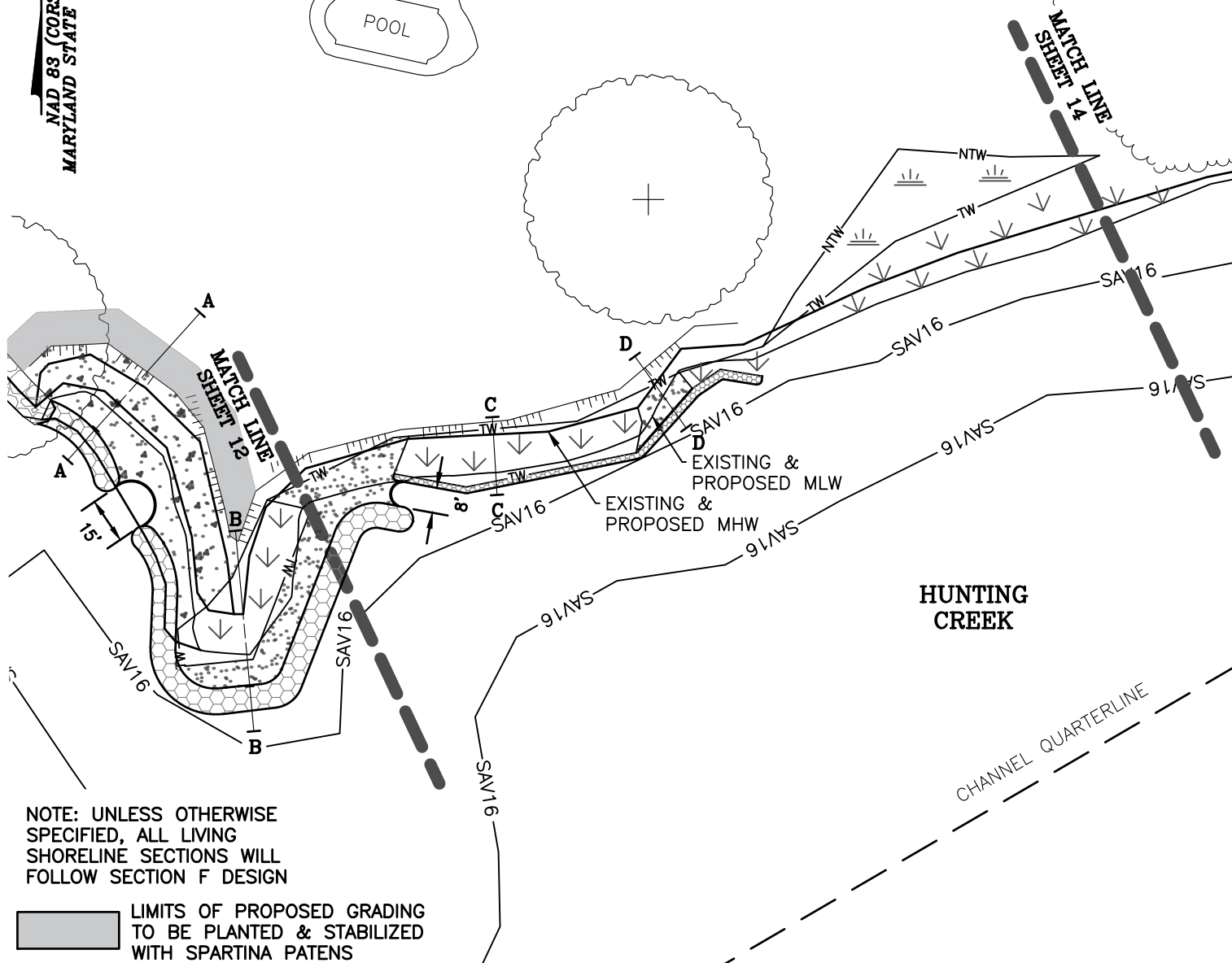

NOTE: UNLESS OTHERWISE SPECIFIED, ALL LIVING SHORELINE SECTIONS WILL FOLLOW SECTION F DESIGN

LIMITS OF PROPOSED GRADING TO BE PLANTED & STABILIZED WITH SPARTINA PATENS

PROPOSED IMPROVEMENTS

ON THE LANDS OF
CHRISTOPHER E. BRADSHAW &
CARTER G. BRADSHAW

IN THE FIRST ELECTION DISTRICT, TALBOT COUNTY
TAX MAP 33, GRID 2, PARCEL 142, LOTS 3 & 4

Lane Engineering, LLC

Established 1986
Civil Engineers • Land Planning • Land Surveyors



E-mail: general@leinc.com
117 Bay St. Easton, MD 21601 (410) 822-8003
15 Washington St. Cambridge, MD 21613 (410) 221-0818
354 Pennsylvania Ave. Centreville, MD 21617 (410) 758-2095

FILE No. 9831
JOB No. 180289
SCALE: AS NOTED
DATE: AS NOTED
SHEET No. 13 OF 20

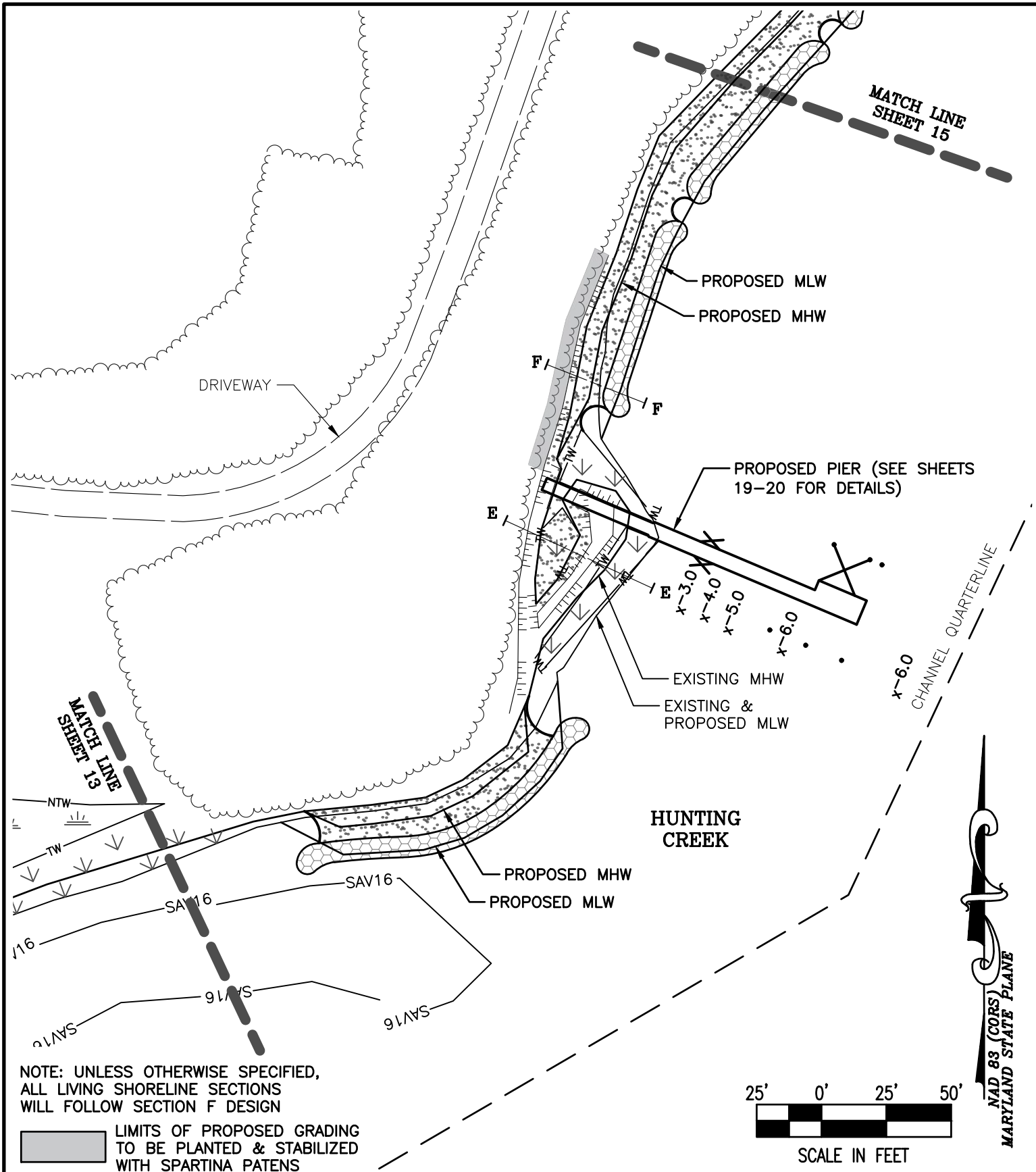

FILE No. 9831

JOB No. 180289

SCALE: AS NOTED

DATE: AS NOTED

SHEET No. 14 OF 20

PROPOSED IMPROVEMENTS

ON THE LANDS OF

CHRISTOPHER E. BRADSHAW &

CARTER G. BRADSHAW

IN THE FIRST ELECTION DISTRICT, TALBOT COUNTY

TAX MAP 33, GRID 2, PARCEL 142, LOTS 3 & 4

Lane Engineering, LLC

Established 1986

Civil Engineers • Land Planning • Land Surveyors



E-mail: general@leinc.com

117 Bay St. Easton, MD 21601 (410) 822-8003

15 Washington St. Cambridge, MD 21613 (410) 221-0818

354 Pennsylvania Ave. Centreville, MD 21617 (410) 758-2095

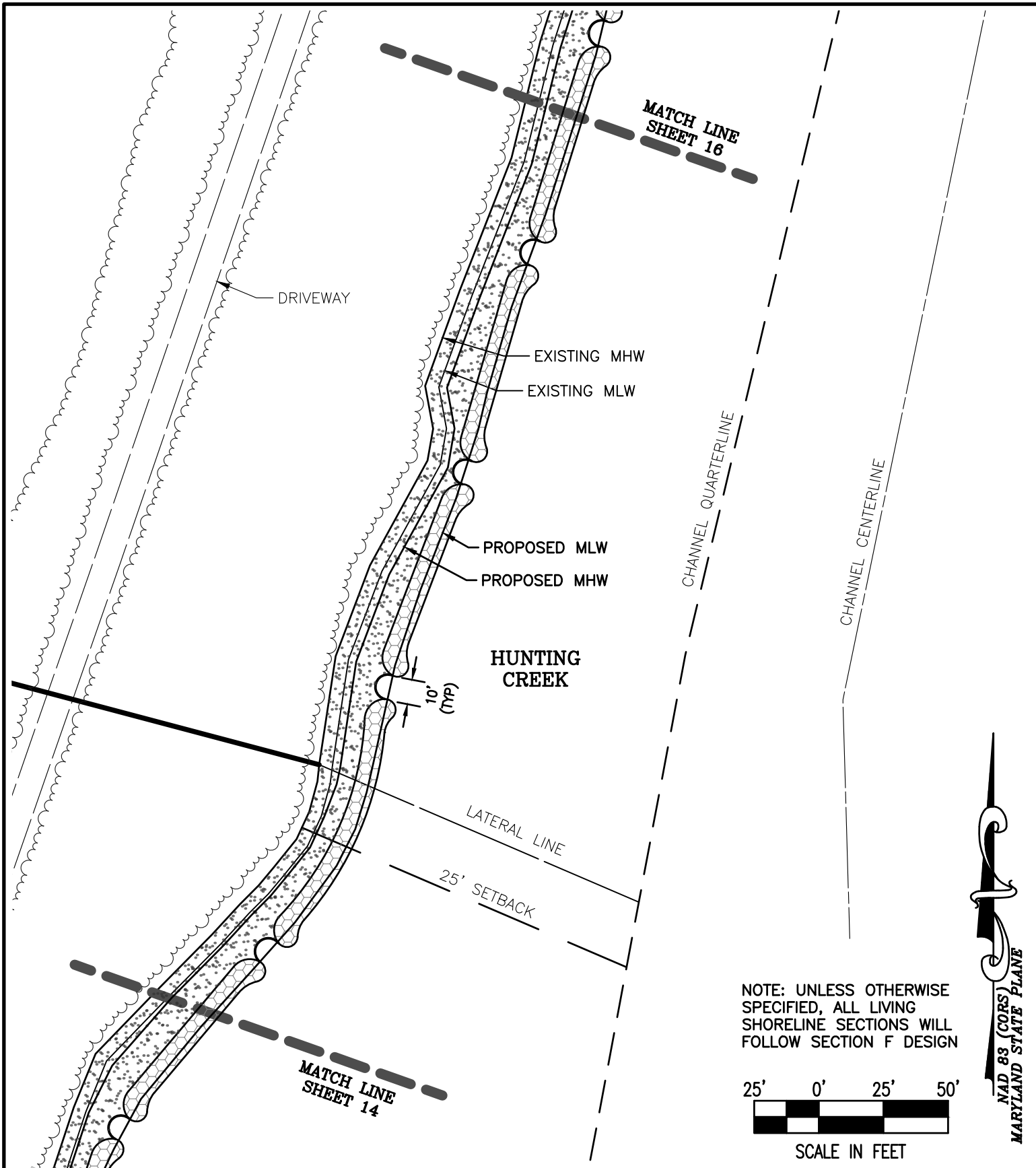

SHEET No. **15 OF 20**
 DATE: AS NOTED
 SCALE: AS NOTED
 JOB No. 180289
 FILE No. 9831

PROPOSED IMPROVEMENTS
ON THE LANDS OF
CHRISTOPHER E. BRADSHAW &
CARTER G. BRADSHAW

IN THE FIRST ELECTION DISTRICT, TALBOT COUNTY
 TAX MAP 33, GRID 2, PARCEL 142, LOTS 3 & 4

Lane Engineering, LLC

Established 1986
 Civil Engineers • Land Planning • Land Surveyors



E-mail: general@leinc.com
 117 Bay St. Easton, MD 21601 (410) 822-8003
 15 Washington St. Cambridge, MD 21613 (410) 221-0818
 354 Pennsylvania Ave. Centreville, MD 21617 (410) 758-2095

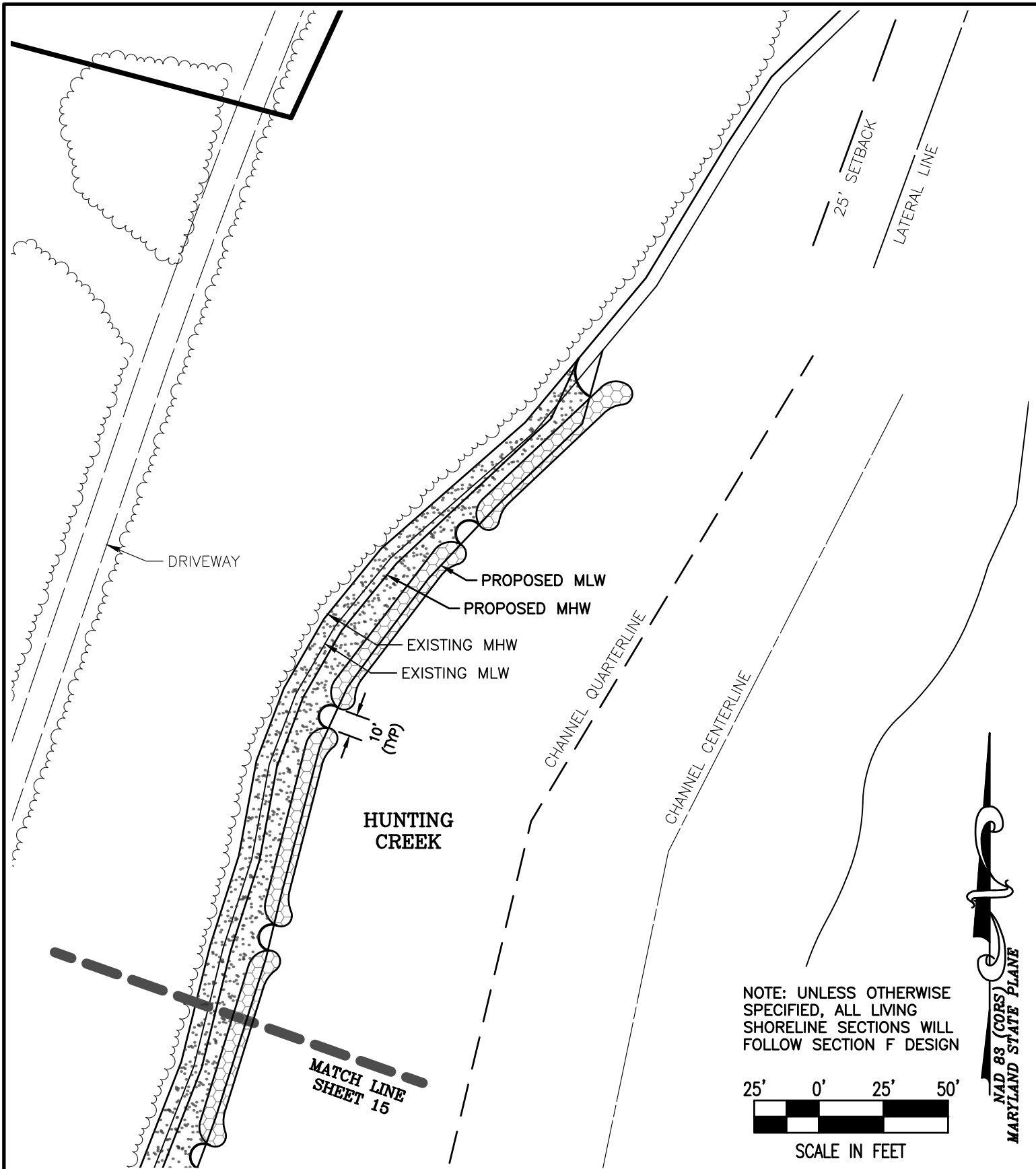

SHEET No.
16 OF 20

DATE: AS NOTED

SCALE: AS NOTED

JOB No. 180289

FILE No. 9831

PROPOSED IMPROVEMENTS

ON THE LANDS OF
**CHRISTOPHER E. BRADSHAW &
CARTER G. BRADSHAW**

IN THE FIRST ELECTION DISTRICT, TALBOT COUNTY
TAX MAP 33, GRID 2, PARCEL 142, LOTS 3 & 4

Lane Engineering, LLC

Established 1986
Civil Engineers • Land Planning • Land Surveyors



E-mail: general@leinc.com
117 Bay St. Easton, MD 21601 (410) 822-8003
15 Washington St. Cambridge, MD 21613 (410) 221-0818
354 Pennsylvania Ave. Centreville, MD 21617 (410) 758-2095

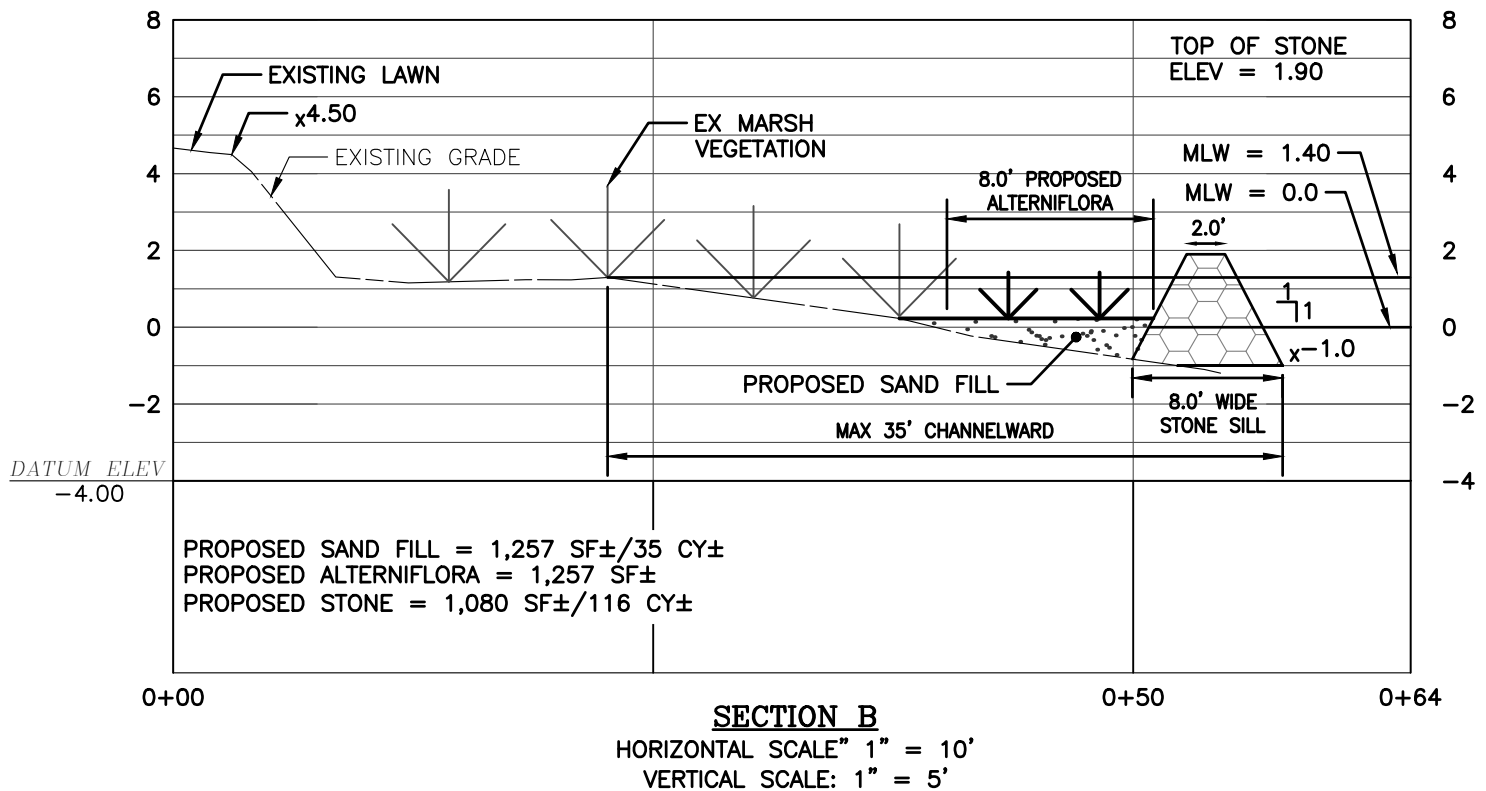
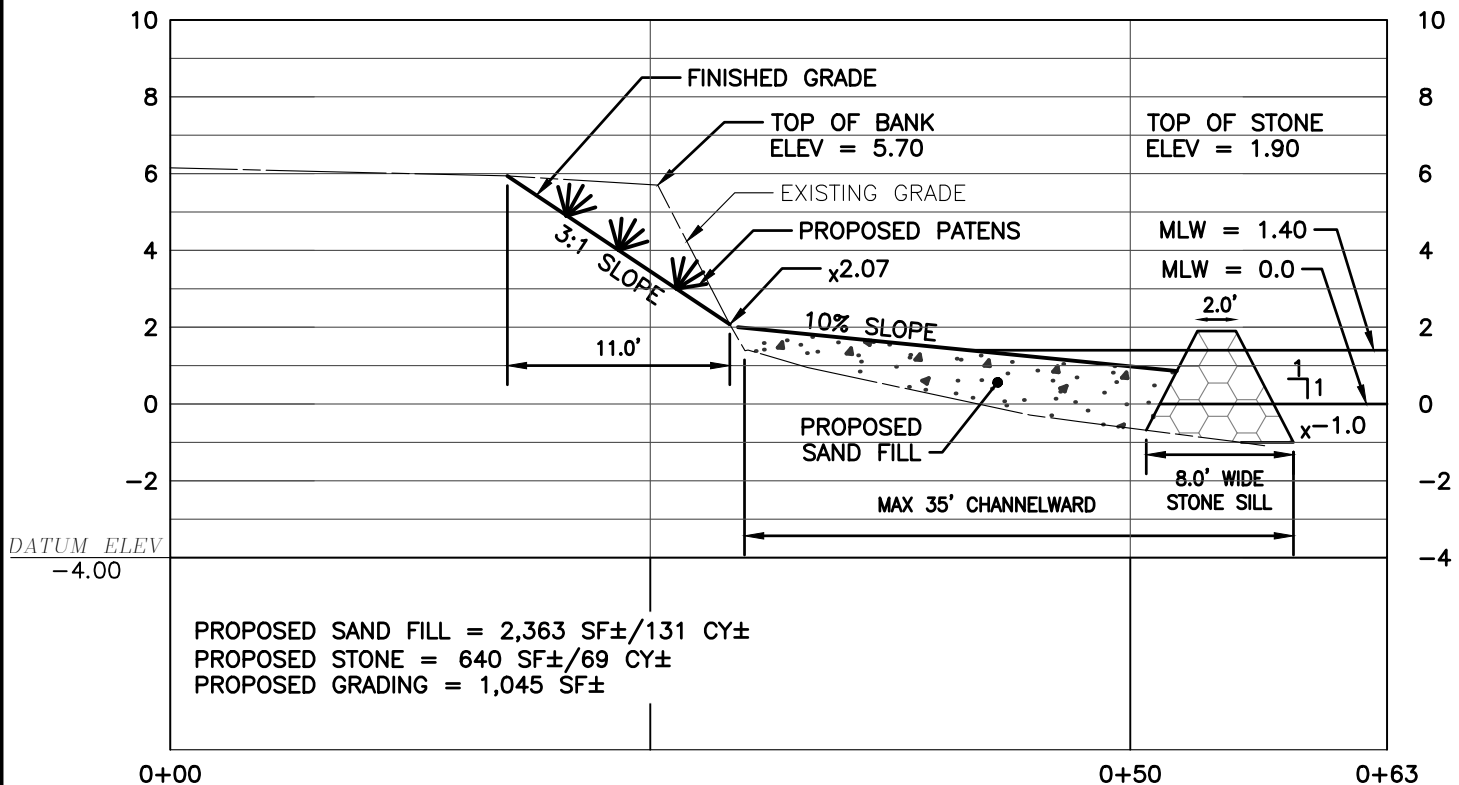

FILE No. 9831

JOB No. 180289

SCALE: AS NOTED

DATE: AS NOTED

SHEET No. 17 OF 20

DETAILS

ON THE LANDS OF
CHRISTOPHER E. BRADSHAW &
CARTER G. BRADSHAW

IN THE FIRST ELECTION DISTRICT, TALBOT COUNTY
TAX MAP 33, GRID 2, PARCEL 142, LOTS 3 & 4

Lane Engineering, LLC

Established 1986
Civil Engineers • Land Planning • Land Surveyors



E-mail: general@leinc.com
117 Bay St. Easton, MD 21601 (410) 822-8003
15 Washington St. Cambridge, MD 21613 (410) 221-0818
354 Pennsylvania Ave. Centerville, MD 21617 (410) 758-2095

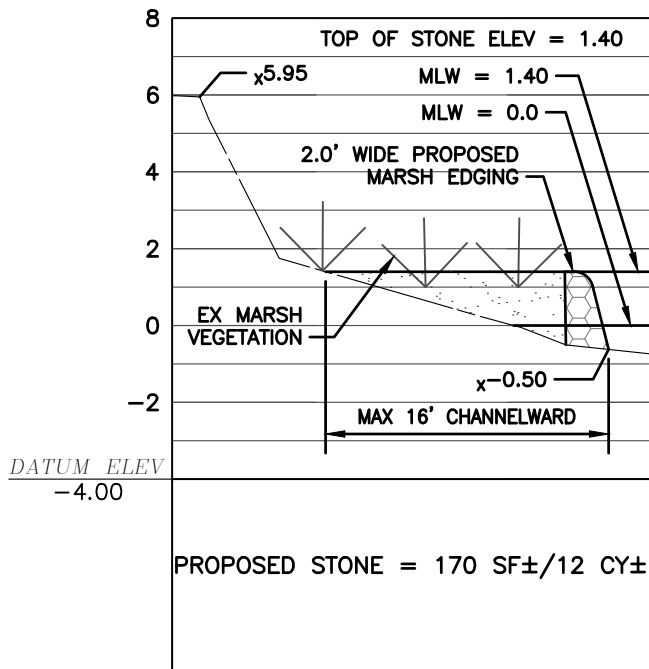

0+00

0+25

SECTION C

HORIZONTAL SCALE" 1" = 10'

VERTICAL SCALE: 1" = 5'

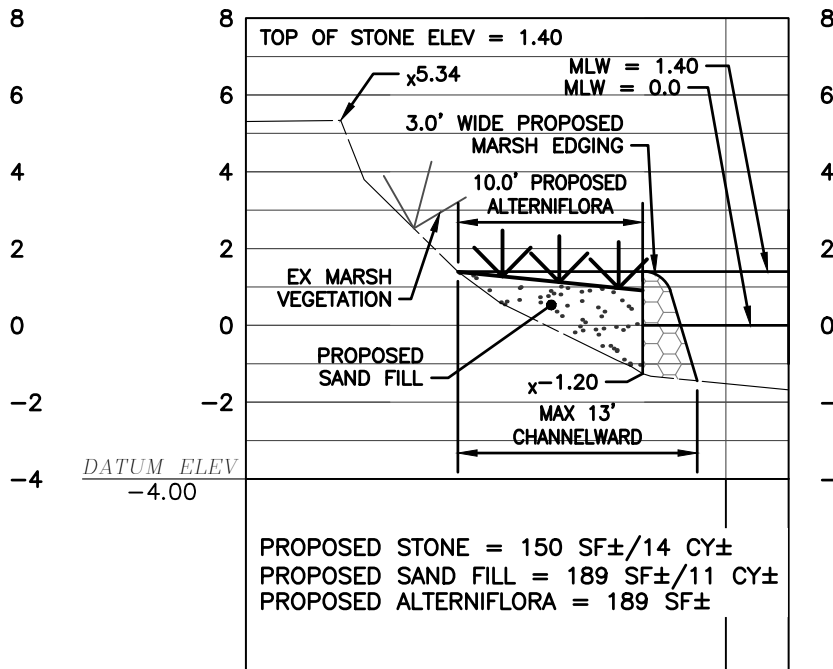

0+00

0+28

SECTION D

HORIZONTAL SCALE" 1" = 10'

VERTICAL SCALE: 1" = 5'

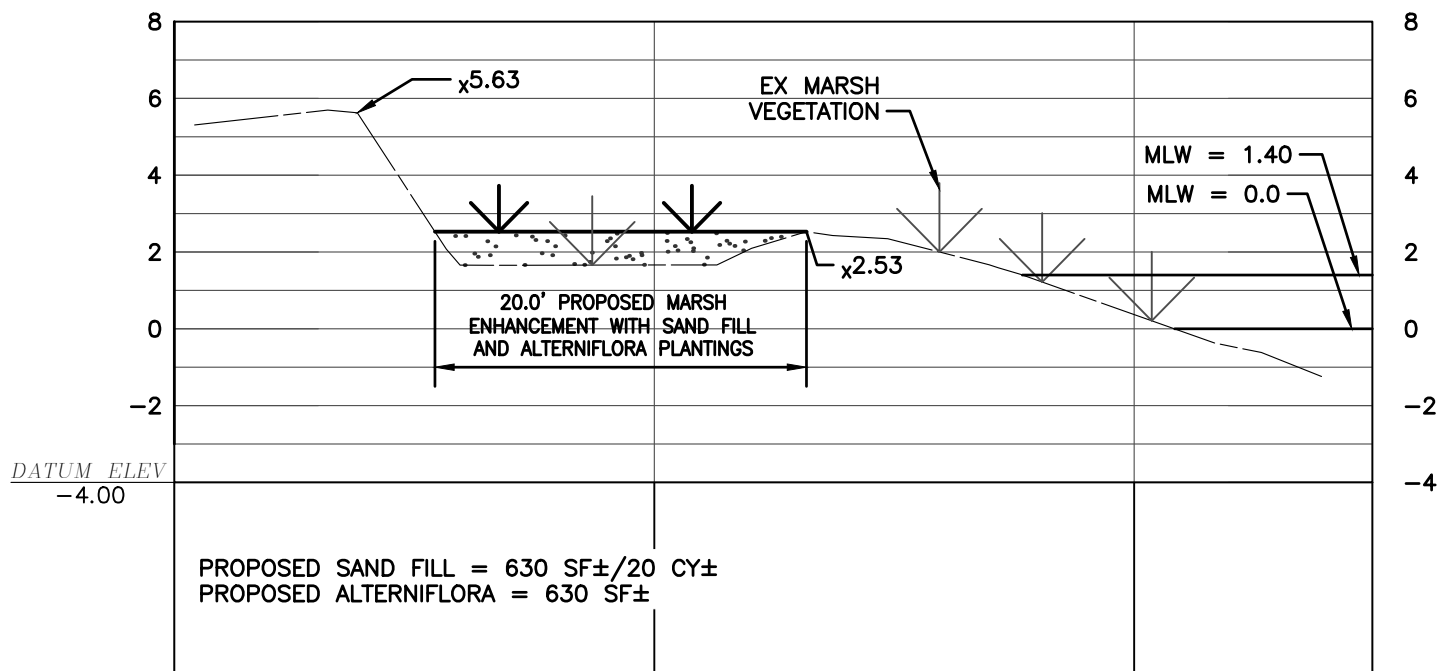

0+00

0+50

0+62

SECTION E

HORIZONTAL SCALE" 1" = 10'

VERTICAL SCALE: 1" = 5'

DETAILS

ON THE LANDS OF
CHRISTOPHER E. BRADSHAW &
CARTER G. BRADSHAW

IN THE FIRST ELECTION DISTRICT, TALBOT COUNTY
TAX MAP 33, GRID 2, PARCEL 142, LOTS 3 & 4

Lane Engineering, LLC

Established 1986
Civil Engineers • Land Planning • Land Surveyors



E-mail: general@leinc.com
117 Bay St. Easton, MD 21601 (410) 822-8003
15 Washington St. Cambridge, MD 21613 (410) 221-0818
354 Pennsylvania Ave. Centreville, MD 21617 (410) 758-2095

FILE No. 9831
JOB No. 180289
SCALE: AS NOTED
DATE: AS NOTED
SHEET No. 18 OF 20

NOTE: GRADING WILL OCCUR IN THE DESIGNATED AREAS SHOWN IN PLAN VIEW. ALL OTHER SECTION F LIVING SHORELINE SECTIONS WILL FOLLOW THE BELOW DESIGN WITHOUT GRADING.

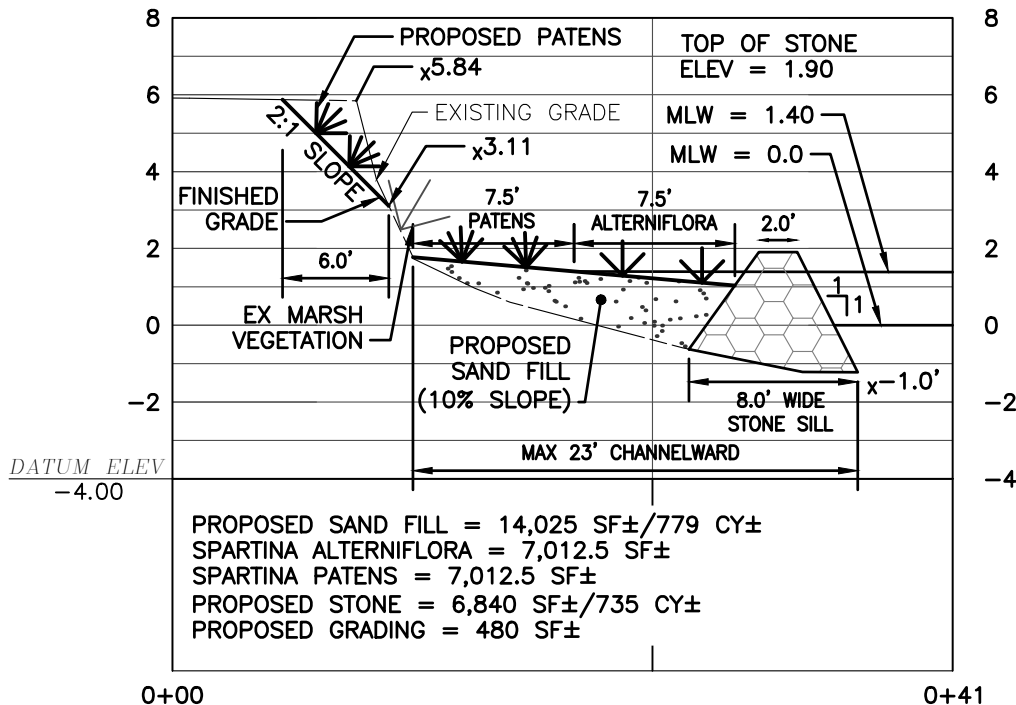

SECTION F
 HORIZONTAL SCALE "1" = 10'
 VERTICAL SCALE: "1" = 5'

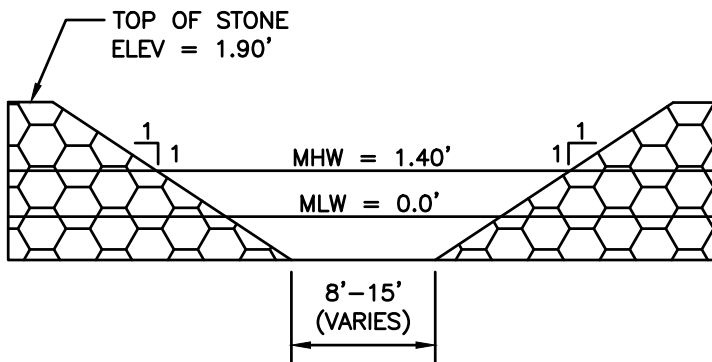

STONE SILL WINDOW DETAIL
 NOT TO SCALE

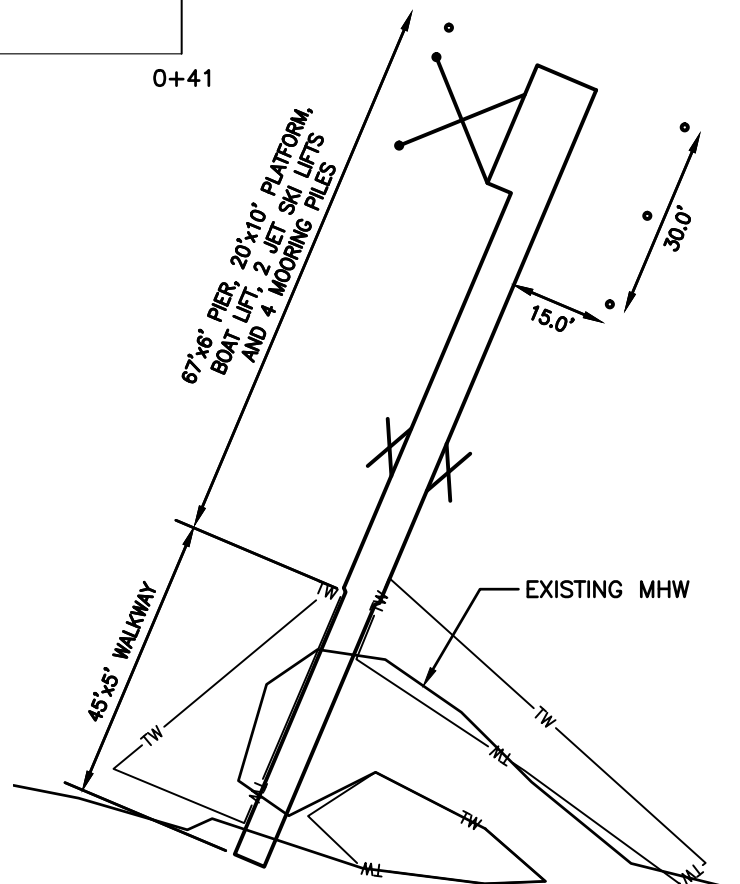

PROPOSED PIER
 SCALE "1" = 30'

FILE No. 9831
 JOB No. 180289
 SCALE: AS NOTED
 DATE: AS NOTED
 SHEET No. 19 OF 20

DETAILS
 ON THE LANDS OF
 CHRISTOPHER E. BRADSHAW &
 CARTER G. BRADSHAW
 IN THE FIRST ELECTION DISTRICT, TALBOT COUNTY
 TAX MAP 33, GRID 2, PARCEL 142, LOTS 3 & 4

Lane Engineering, LLC
 Established 1986
 Civil Engineers • Land Planning • Land Surveyors
 E-mail: general@leinc.com
 117 Bay St. Easton, MD 21601 (410) 822-8003
 15 Washington St. Cambridge, MD 21613 (410) 221-0818
 354 Pennsylvania Ave. Centreville, MD 21617 (410) 758-2095

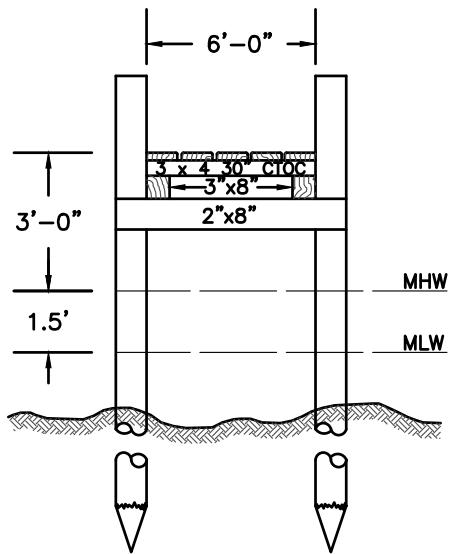

PIER SECTION
NOT TO SCALE

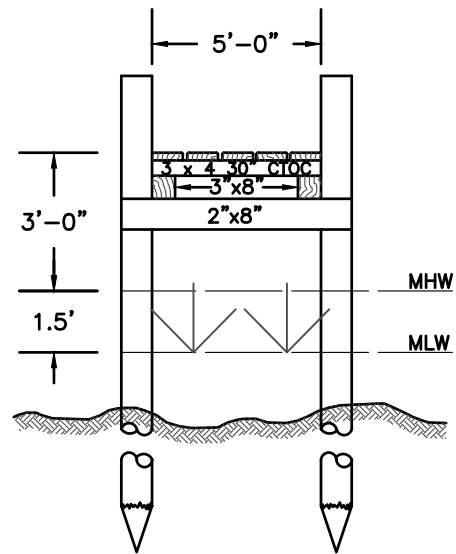

WALKWAY SECTION
NOT TO SCALE

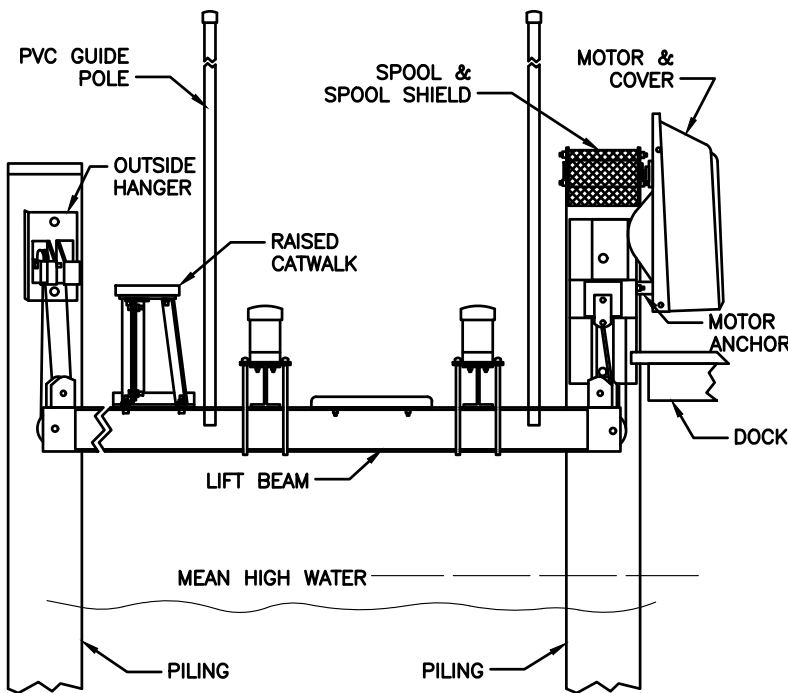

BOAT LIFT DETAIL
NOT TO SCALE

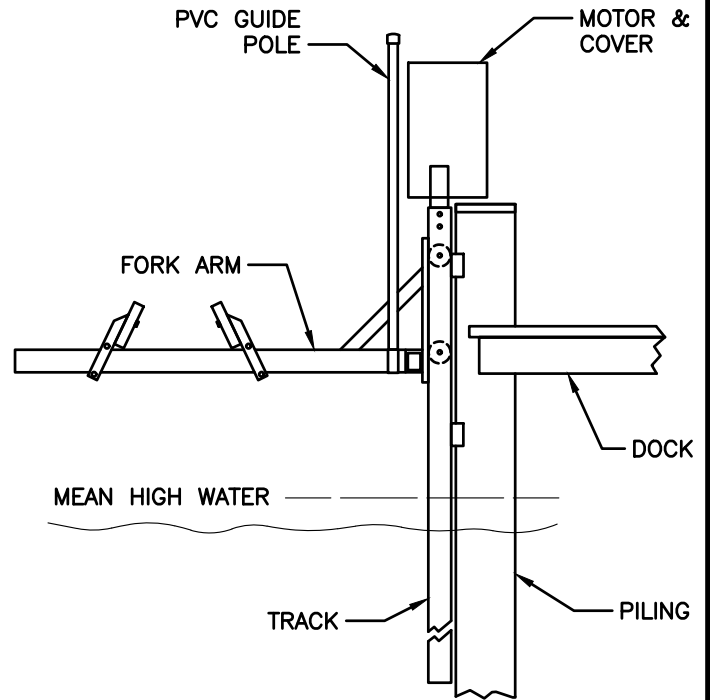

JET SKI LIFT DETAIL
NOT TO SCALE

DETAILS

ON THE LANDS OF
CHRISTOPHER E. BRADSHAW &
CARTER G. BRADSHAW

IN THE FIRST ELECTION DISTRICT, TALBOT COUNTY
TAX MAP 33, GRID 2, PARCEL 142, LOTS 3 & 4

Lane Engineering, LLC

Established 1986
Civil Engineers • Land Planning • Land Surveyors



E-mail: general@leinc.com
117 Bay St. Easton, MD 21601 (410) 822-8003
15 Washington St. Cambridge, MD 21613 (410) 221-0818
354 Pennsylvania Ave. Centreville, MD 21617 (410) 758-2095

FILE No. 9831
JOB No. 180289
SCALE: AS NOTED
DATE: AS NOTED
SHEET No. 20 OF 20