

U.S. Army Corps
of Engineers
Baltimore District

Public Notice

In Reply to Application Number
**NAB-2020-60802 (Worcester County Commissioners Selsey
Rd/Shoreline Stabilization)**

PN-20-45

Comment Period: July 23, 2020 to August 13, 2020

THE PURPOSE OF THIS PUBLIC NOTICE IS TO INFORM INTERESTED PARTIES OF THE PROPOSED ACTIVITY AND TO SOLICIT COMMENTS. NO DECISION HAS BEEN MADE AS TO WHETHER OR NOT A PERMIT WILL BE ISSUED AT THIS TIME.

This District has received an application for a Department of the Army permit pursuant to Section 10 of the Rivers and Harbors Act (33 USC 403) and Section 404 of the Clean Water Act (33 USC 1344), as described below:

APPLICANT: County Commissioners of Worcester County
Worcester County Government Center
1 West Market Street
Snow Hill, Maryland 21863

Arthur Larson
12539 Selsey Road
Ocean City, Maryland 21842

Robert Larson
26 McConkey Drive
Washington Crossing, Pennsylvania 18977

Levin Monroe Lewis, Jr & Sara Nichols Lewis
12636 Selsey Road
Ocean City, Maryland 21842

WATERWAY AND LOCATION OF THE PROPOSED WORK: The proposed project is in the Isle of Wight Bay at the end of Selsey Road, Ocean City, Worcester County, Maryland. Latitude: 38.565706, Longitude: -76.025

OVERALL PROJECT PURPOSE: Shoreline stabilization along Selsey Road, Ocean City, Worcester County, Maryland.

PROJECT DESCRIPTION: To emplace approximately 70 linear feet of stone revetment to extend no more than 10 feet channelward of the approximate mean high water (MHW) shoreline, impacting approximately 200 square feet of tidal marsh; to create a marsh along approximately 1,100 linear feet of shoreline by depositing approximately 5,381 cubic yards of sloped, sand fill, stabilized with approximately 7,400 square feet of *Spartina alterniflora*, and 45,530 square of *Ammophila beviligaulata* and *S. patens*, to extend no more than 105 feet channelward of the approximate MHW shoreline, impacting approximately 2,585 square feet of tidal marsh; to construct a 180 linear foot stone sill of varying height,

approximately 18-feet wide at the base and 5-feet wide at the top, to extend no more than 65 feet channelward of the approximate MHW shoreline; to construct a 90 linear foot stone sill of varying height, approximately 18-feet wide at the base and 5-feet wide at the top, to extend no more than 90 feet channelward of the approximate MHW shoreline; to construct a 110 linear foot stone sill of varying height, approximately 18-feet wide at the base and 5-feet wide at the top, to extend no more than 75 feet channelward of the approximate MHW; to construct a 70 linear foot stone sill of varying height, approximately 18-feet wide at the base and 5-feet wide at the top, to extend no more than 50 feet channelward of the approximate MHW shoreline; to construct a 120 linear foot stone breakwater of varying height, approximately 21-feet wide at the base and 5-feet wide at the top, to extend no more than 105 feet channelward of the approximate MHW shoreline; to construct a 95 linear foot stone breakwater of varying height, approximately 21-feet wide at the base and 5-feet wide at the top, to extend no more than 45 feet channelward of the approximate MHW shoreline; to construct a 130 linear foot stone breakwater of varying height, approximately 21-feet wide at the base and 5-feet wide at the top, to extend no more than 90 feet channelward of the approximate MHW shoreline; to construct a 130 linear foot stone breakwater of varying height, approximately 21-feet wide at the base and 5-feet wide at the top, to extend no more than 90 feet channelward of the approximate MHW shoreline; and to construct a 75 linear foot stone breakwater of varying height, approximately 21-feet wide at the base and 5-feet wide at the top, to extend no more than 80 feet channelward of the approximate MHW shoreline. The work includes a temporary sand path, matting and a steel pipe installed at the tidal inlet for construction access, impacting approximately 2,100 square feet of tidal wetlands.

Please refer to the table below for a summary of aquatic resource impacts.

EFFECTS ON AQUATIC RESOURCES:

Activity (i.e. culvert)	Unvegetated Tidal Waters (Sq. Ft.)	Wetland Impact (Sq. Ft.)	Authority (Section 10/404/408)
Stone Revetment	0	200	Section 10/404
Marsh Establishment	52,930	6,305	Section 10/404
Stone Sills	7,965	0	Section 10/404
Stone Breakwaters	11,550	0	Section 10/404
Temporary Access	0	2,100	Section 10/404

LEAD FEDERAL AGENCY: The U.S. Army Corps of Engineers, as the lead federal agency, is responsible for all coordination pursuant to applicable federal authorities.

APPLICANT'S PROPOSED AVOIDANCE, MINIMIZATION, AND COMPENSATORY

MITIGATION: As part of the planning process for the proposed project, steps were taken to ensure avoidance and minimization of impacts to aquatic resources to the maximum extent practicable based on the existing site conditions. The project does not qualify for authorization pursuant to the MD-SPGP-5 and is being processed as standard permit because it would involve the deposition of fill within vegetated wetlands, impacts over ½ acre of un-vegetated shallow waters and extends more than 50 feet channelward of the approximate MHW shoreline.

The applicant did not propose any compensatory mitigation. The project would result in the creation of 1.22 acres of tidal marsh.

CORPS EVALUATION REQUIREMENTS: This project will be evaluated pursuant to Corps Regulatory Program Regulations (33 CFR Parts 320-332). The decision whether to issue a permit will be based on an evaluation of the probable impacts, including cumulative impacts of the proposed activity on the public interest. That decision will reflect the national concern for both protection and utilization of important resources. The benefit, which reasonable may be expected to accrue from the proposal, must be balanced against its reasonably foreseeable detriments. All factors, which may be relevant to the proposal will be considered, including the cumulative effects thereof; among those are conservation, economic, aesthetics, general environmental concerns, wetlands, cultural values, fish and wildlife values, flood hazards, flood plain values, land use, navigation, shoreline erosion and accretion, recreation, water supply and conservation, water quality, energy needs, safety, food and fiber production, mineral needs, and consideration of property ownership and in general, the needs and welfare of the people. The evaluation of the impact of this project will also include application of the Clean Water Act Section 404(b)(1) Guidelines promulgated by the Administrator, U.S. Environmental Protection Agency.

ENDANGERED SPECIES: A preliminary review of this application indicates that the proposed work will have no effect federally-listed threatened or endangered species or their critical habitat, pursuant to Section 7 of the Endangered Species Act, as amended. As the evaluation of this application continues, additional information may become available which could modify this preliminary determination.

ESSENTIAL FISH HABITAT: The Magnuson-Stevens Fishery Conservation and Management Act (MSFCMA), as amended by the Sustainable Fisheries Act of 1996 (Public Law 04-267), requires all Federal agencies to consult with the National Marine Fisheries Service (NMFS) on all actions, or proposed actions, permitted, funded, or undertaken by the agency that may adversely affect Essential Fish Habitat (EFH), including species of concern, life cycle habitat, or Habitat Areas of Particular Concern. The project site lies in or adjacent to EFH as described under MSFCMA for managed species under the MSFCMA. The Baltimore District has made a preliminary determination that the project will not have a substantial adverse effect on EFH. The Baltimore District has made a preliminary determination that mitigative measures are not required to

minimize adverse effects on EFH at this time. This determination may be modified if additional information indicates otherwise.

HISTORIC RESOURCES: Pursuant to Section 106 of the National Historic Preservation Act of 1966 and applicable guidance, the Corps has reviewed the latest published version of the National Register of Historic Places and initially determined that no registered properties listed as eligible for inclusion, therein, are located at the site of the proposed work. The Corps has made the preliminary determination that the proposed project has no potential to cause effects on historic properties. The Corps final eligibility and effect determination will be based on coordination with the State Historic Preservation Office as appropriate and required, and with full consideration given to the proposed undertaking's potential direct and indirect effects on historic properties within the Corps' identified permit area.

TRIBAL RESOURCES: Section 106 of the National Historic Preservation Act also requires federal agencies to consult with federally-recognized American Indian tribes that attach religious and cultural significance to historic properties that may be affected by the agency's undertaking. Corps Tribal Consultation Policy mandates an open, timely, meaningful, collaborative, and effective deliberative communication process that emphasizes trust, respect, and shared responsibility. The policy further emphasizes that, to the extent practicable and permitted by law, consultation works toward mutual consensus and begins at the earliest planning stages, before decisions are made and actions taken. The Corps final eligibility and effect determination will be based on coordination with interested tribes, in accordance with the Corps current tribal standard operating procedures as appropriate and required, and with full consideration given to the proposed undertaking's potential direct and indirect effects on tribal resources.

MODIFICATION OF CIVIL WORKS PROJECTS: 33 USC 408 (SECTION 408): All Section 408 proposals will be coordinated internally at USACE. The Section 408 decision will be issued along with the Section 404 and/or Section 10 decision. Please see the following link for more information regarding Section 408:
<https://www.nab.usace.army.mil/Missions/Regulatory/Section-408-Requests/>.

WATER QUALITY CERTIFICATION: The applicant is required to obtain a water quality certification in accordance with Section 401 of the Clean Water Act.

COASTAL ZONE MANAGEMENT PROGRAMS: Where applicable, the applicant has certified in this application that the proposed activity complies with and will be conducted in a manner consistent with the approved Coastal Zone Management (CZM) Program. By this public notice, we are requesting the state concurrence or objection to the applicant's consistency statement.

The applicant must obtain any state or local government permits which may be required.

SUBMISSION OF COMMENTS: The Corps of Engineers is soliciting comments from the public; federal, state, and local agencies and officials; Indian Tribes; and other interested

parties in order to consider and evaluate the impacts of this proposed activity. Any comments received will be considered by the Corps of Engineers to determine whether to issue, modify, condition or deny a permit for this proposal. To make this decision, comments are used to assess impacts on endangered species, historic properties, water quality, general environmental effects, and the other public interest factors listed above. Comments are used in the preparation of an Environmental Assessment and/or an Environmental Impact Statement pursuant to the National Environmental Policy Act. Comments provided will become part of the public record for this action and are subject to release to the public through the Freedom of Information Act. Comments are also used to determine the need for a public hearing and to determine the overall public interest of the proposed activity.

Written comments concerning the work described above related to the factors listed above or other pertinent factors must be received by the U.S. Army Corps of Engineers, Baltimore District within the comment period specified above through postal mail at the address below or electronic submission to the project manager email address below. Written comments should reference the Application Number NAB-2019-62064-P45 (SO Sanitary District Smith Island Clean Water Project/Utility Line)

PUBLIC HEARING REQUESTS: Any person who has an interest which may be adversely affected by the issuance of this permit may request a public hearing. The request, which must be in writing, must be received within the comment period as specified above to receive consideration. Also, it must clearly set forth the interest which may be adversely affected by this activity and the manner in which the interest may be adversely affected. The public hearing request may be submitted by electronic mail or mailed to the following address:

Josh Gaimaro
02-E-01
(Josh.Gaimaro@usace.army.mil)
U.S. Army Corps of Engineers, Baltimore District
Regulatory Branch
2 Hopkins Plaza
Baltimore, Maryland 21201

It is requested that you communicate this information concerning the proposed work to any persons known by you to be interested, who did not receive a copy of this notice.

General information regarding the Corps' permitting process can be found on our website at <https://www.nab.usace.army.mil/Missions/Regulatory.aspx>. This public notice has been prepared in accordance with Corps implementing regulations at 33 CFR 325.3. If you have any questions concerning this specific project, or would like to request a paper copy of this public notice, please contact Mr. Josh Gaimaro at Josh.Gaimaro@us.army.mil or 410-949-6072. This public notice is issued by the Chief, Regulatory Branch.

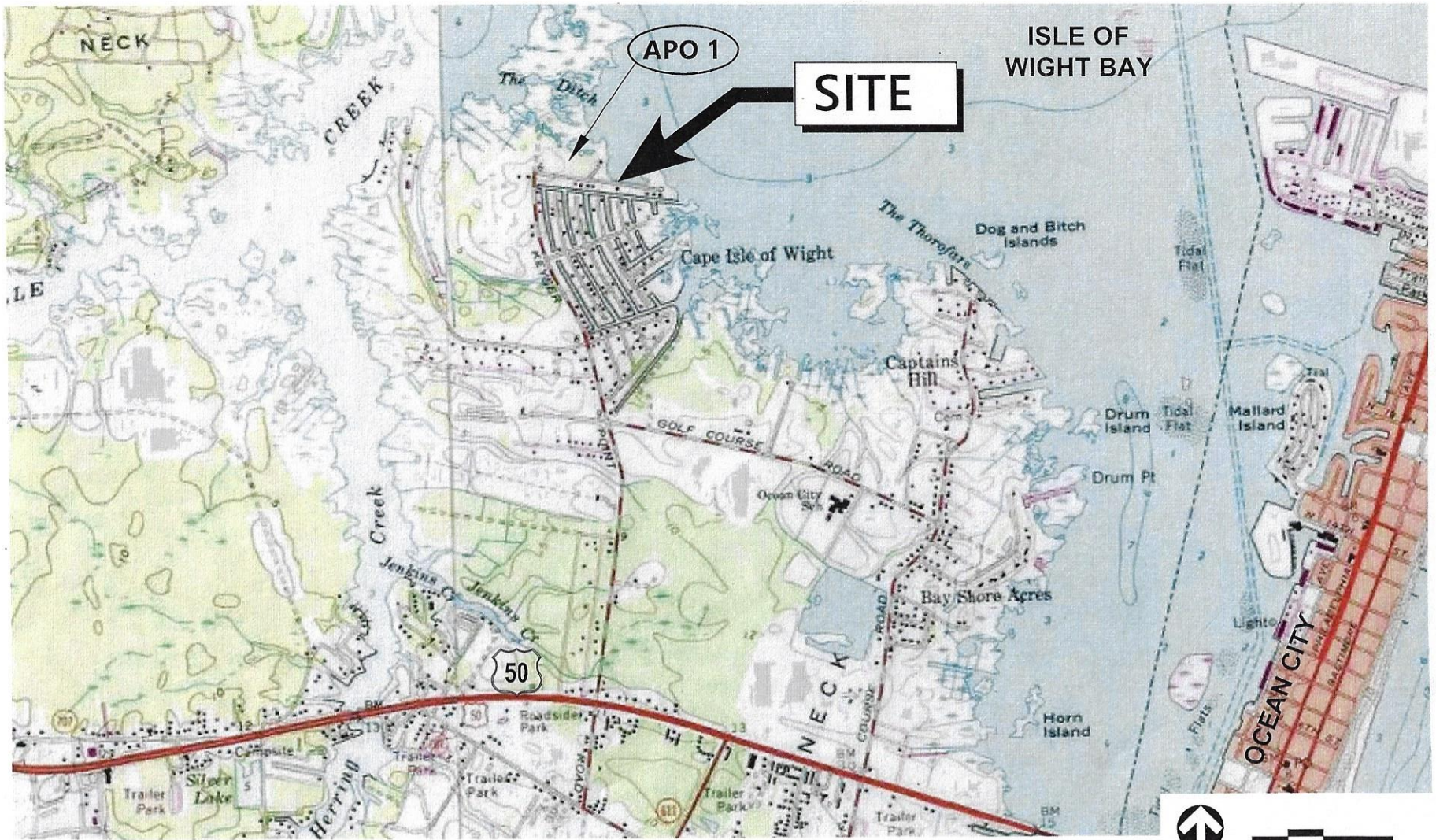

0 1,000 2,000 Feet

COASTLINE DESIGN, P.C.

P.O. BOX 157
ACHILLES, VIRGINIA 23001
(804) 642-2158

ADJACENT PROPERTY OWNERS:
1. MITCHELL & NANCY PARKER

DATUM: MEAN LOW WATER

Coastal Resiliency & Living Shoreline Project at Selsey Road

LOCATION MAP

AT: ISLE OF WIGHT BAY

IN: WORCESTER COUNTY, MARYLAND

PURPOSE: MARSH AND BEACH RESTORATION

APPLICATION BY:
LARSON
LEWIS
WORCESTER COUNTY

DATE: MARCH, 2020

SHEET 1 OF 7



COASTLINE DESIGN, P.C.

P.O. BOX 157
ACHILLES, VIRGINIA 23001
(804) 642-2158

ADJACENT PROPERTY OWNERS:
1. MITCHELL & NANCY PARKER

DATUM: MEAN LOW WATER

Coastal Resiliency & Living Shoreline Project at Selsey Road

EXISTING CONDITIONS

AT: ISLE OF WIGHT BAY

IN: WORCESTER COUNTY, MARYLAND

PURPOSE: MARSH AND BEACH RESTORATION

APPLICATION BY:
LARSON
LEWIS
WORCESTER COUNTY

DATE: MARCH, 2020

SHEET 2 OF 7

SHEET 5

SHEET 4

APO 1

MLW 0.0
MHW +0.9

N/F
FRED & ROBERT LARSON

N/F
LEWIS



0 75 150 Feet

COASTLINE DESIGN, P.C.

P.O. BOX 157
ACHILLES, VIRGINIA 23001
(804) 642-2158

ADJACENT PROPERTY OWNERS:
1. MITCHELL & NANCY PARKER

DATUM: MEAN LOW WATER

Coastal Resiliency & Living Shoreline Project at Selsey Road OVERALL LAYOUT

AT: ISLE OF WIGHT BAY
IN: WORCESTER COUNTY, MARYLAND

PURPOSE: MARSH AND BEACH RESTORATION

APPLICATION BY:
**LARSON
LEWIS
WORCESTER COUNTY**

DATE: MARCH, 2020

SHEET 3 OF 7

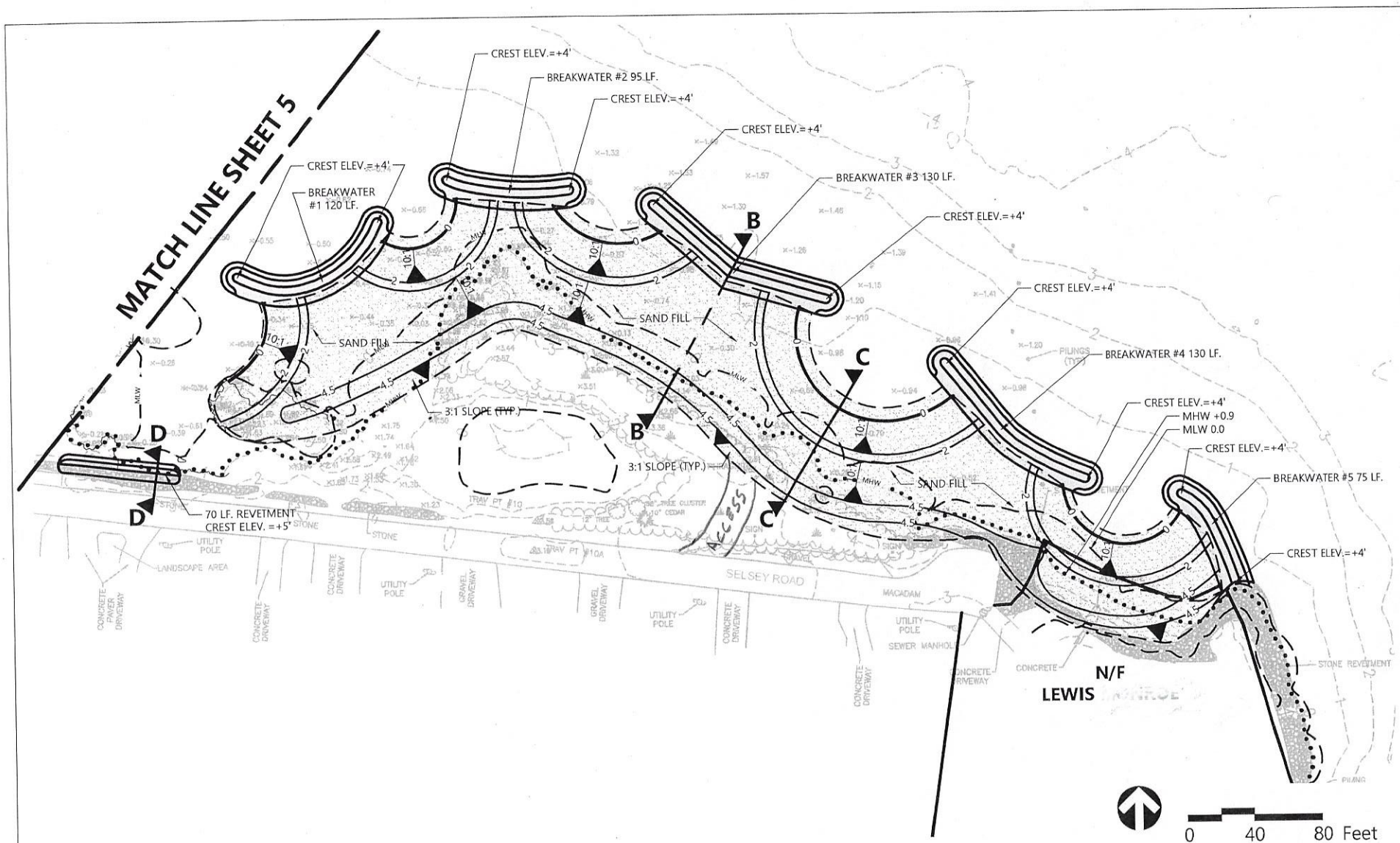

COASTLINE DESIGN, P.C.

P.O. BOX 157
ACHILLES, VIRGINIA 23001
(804) 642-2158

ADJACENT PROPERTY OWNERS:
1. MITCHELL & NANCY PARKER

DATUM: MEAN LOW WATER

Coastal Resiliency & Living Shoreline Project at Selsey Road **PROPOSED SHORELINE LAYOUT**

AT: ISLE OF WIGHT BAY

IN: WORCESTER COUNTY, MARYLAND

PURPOSE: MARSH AND BEACH RESTORATION

APPLICATION BY:
LARSON
LEWIS
WORCESTER COUNTY

DATE: MARCH, 2020

SHEET 4 **OF** 7

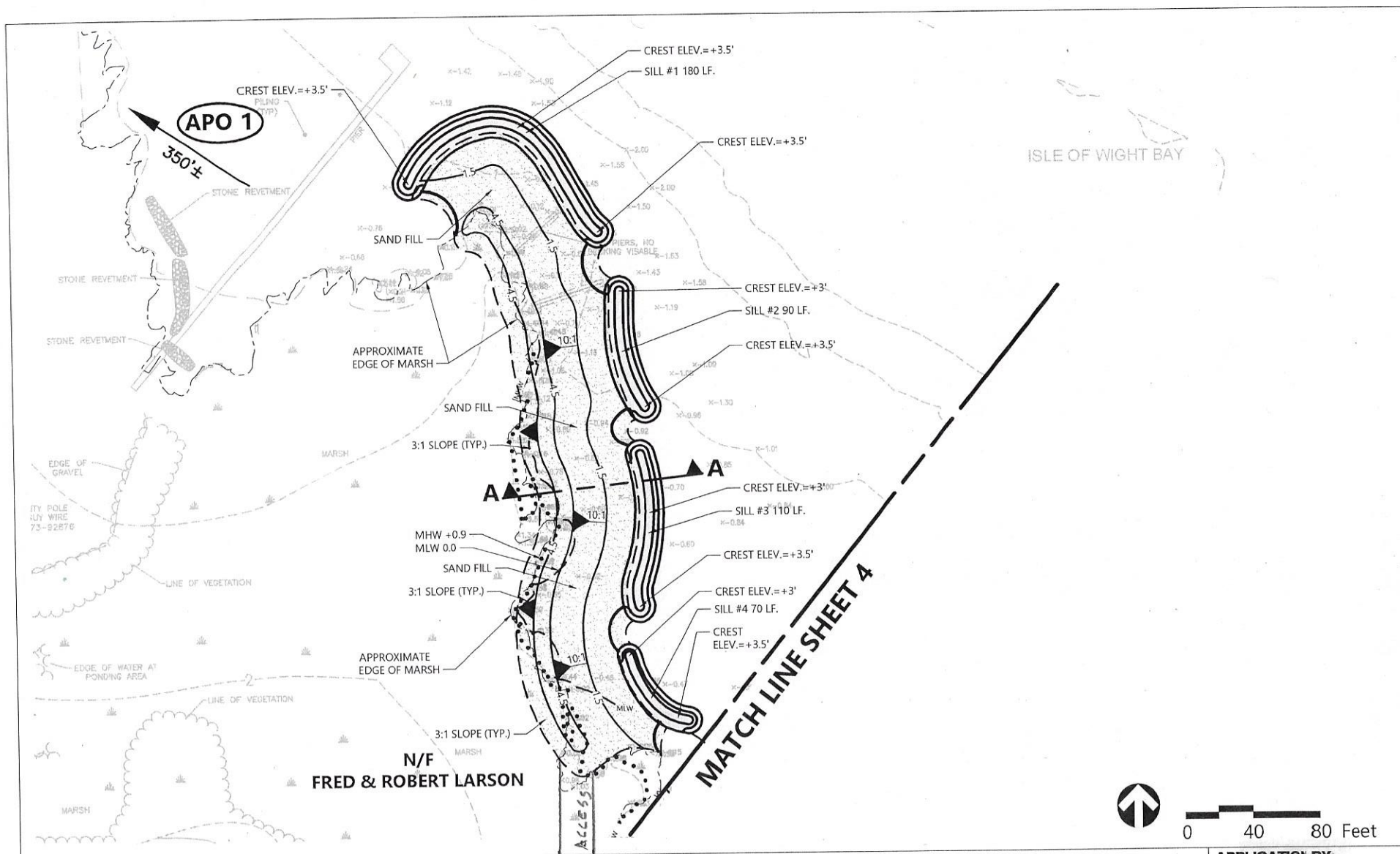

COASTLINE DESIGN, P.C.

P.O. BOX 157
ACHILLES, VIRGINIA 23001
(804) 642-2158

ADJACENT PROPERTY OWNERS:
1. MITCHELL & NANCY PARKER

DATUM: MEAN LOW WATER

Coastal Resiliency & Living Shoreline Project at Selsey Road **PROPOSED SHORELINE LAYOUT**

AT: ISLE OF WIGHT BAY

IN: WORCESTER COUNTY, MARYLAND

PURPOSE: MARSH AND BEACH RESTORATION

APPLICATION BY:
LARSON
LEWIS
WORCESTER COUNTY

DATE: MARCH, 2020

SHEET 5 **OF** 7

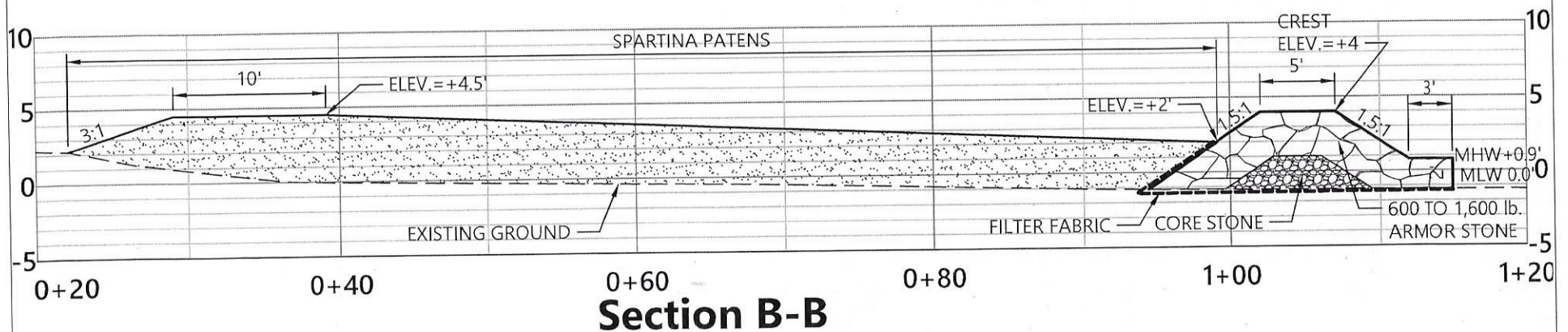
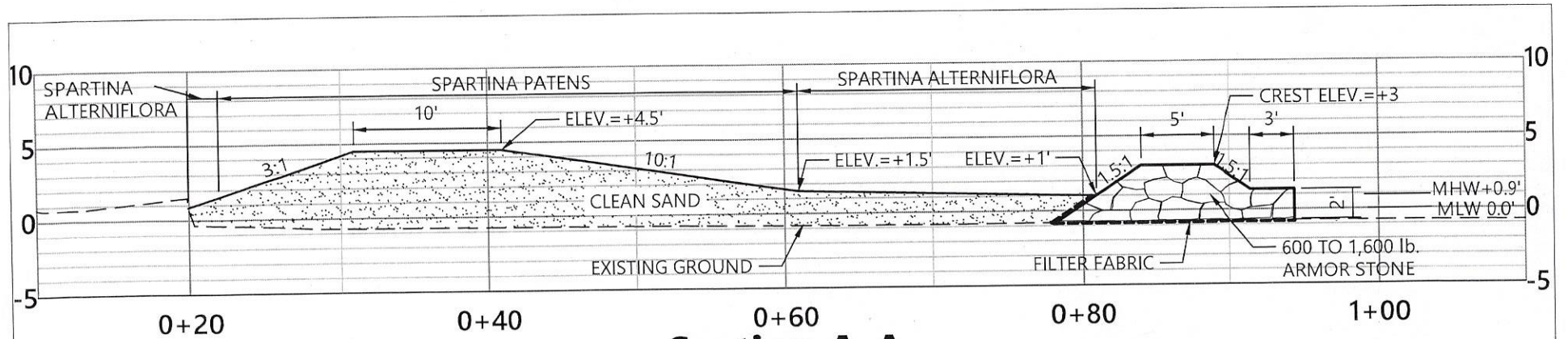

0 5 10 Feet

COASTLINE DESIGN, P.C.

P.O. BOX 157
ACHILLES, VIRGINIA 23001
(804) 642-2158

ADJACENT PROPERTY OWNERS:
1. MITCHELL & NANCY PARKER

DATUM: MEAN LOW WATER

Coastal Resiliency & Living Shoreline Project at Selsey Road

SECTION A-A & B-B

AT: ISLE OF WIGHT BAY

IN: WORCESTER COUNTY, MARYLAND

PURPOSE: MARSH AND BEACH RESTORATION

APPLICATION BY:
LARSON
LEWIS
WORCESTER COUNTY

DATE: MARCH, 2020

SHEET 6 OF 7

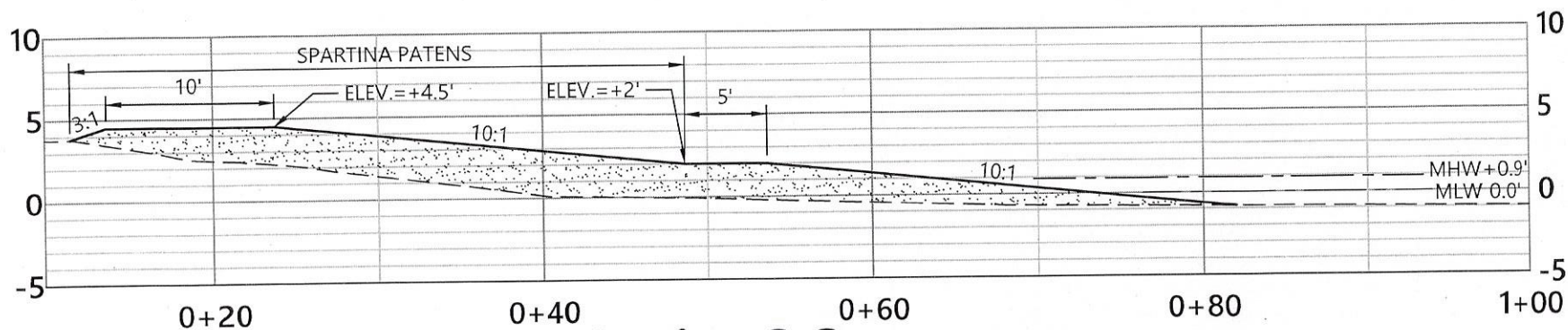

Section C-C

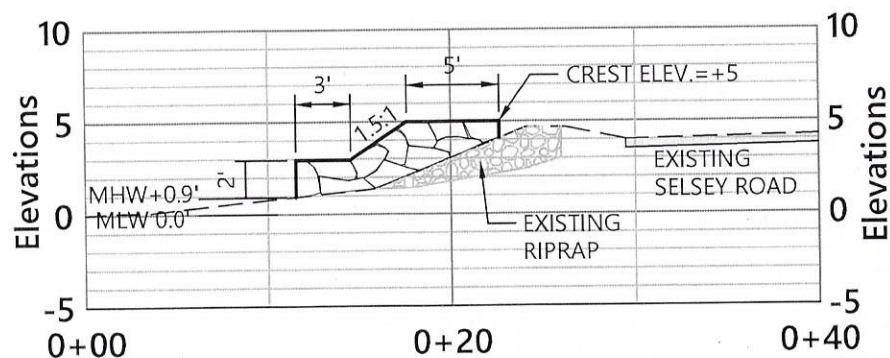

D-D

0 5 10 Feet

COASTLINE DESIGN, P.C.

P.O. BOX 157
ACHILLES, VIRGINIA 23001
(804) 642-2158

ADJACENT PROPERTY OWNERS:
1. MITCHELL & NANCY PARKER

DATUM: MEAN LOW WATER

Coastal Resiliency & Living Shoreline Project at Selsey Road
SECTION C-C & D-D

AT: ISLE OF WIGHT BAY

IN: WORCESTER COUNTY, MARYLAND

PURPOSE: MARSH AND BEACH RESTORATION

APPLICATION BY:
LARSON
LEWIS
WORCESTER COUNTY

DATE: MARCH, 2020

SHEET 7 OF 7