



0 250 500
1 INCH = 500 FEET

EX. WAREHOUSE

PRINCIPIO PKWY EAST

BUILDING
SITE 'C-1'

BUILDING
SITE 'C-2'

EX. WAREHOUSE

REVISED JUNE 2, 2021 PER REVISED SITE ACCESS



GEO-TECHNOLOGY ASSOCIATES, INC.

GEOTECHNICAL AND ENVIRONMENTAL CONSULTANTS

3445-A BOX HILL CORPORATE CENTER DRIVE
ABINGDON, MARYLAND 21009
410-515-9446
FAX: 410-515-4895
WWW.GTAENG.COM

© 2020 GEO-TECHNOLOGY ASSOCIATES, INC.

IMPACT PLATES

**PRINCIPIO BUSINESS PARK
SITE 'C'**

CECIL COUNTY, MARYLAND

JOB NO.	31200335	SCALE:	1"=500'	DATE:	AUGUST 28, 2020	DRAWN BY:	MAJ	REVIEW BY:	TAS	FIGURE:	1 OF 12
---------	----------	--------	---------	-------	-----------------	-----------	-----	------------	-----	---------	---------

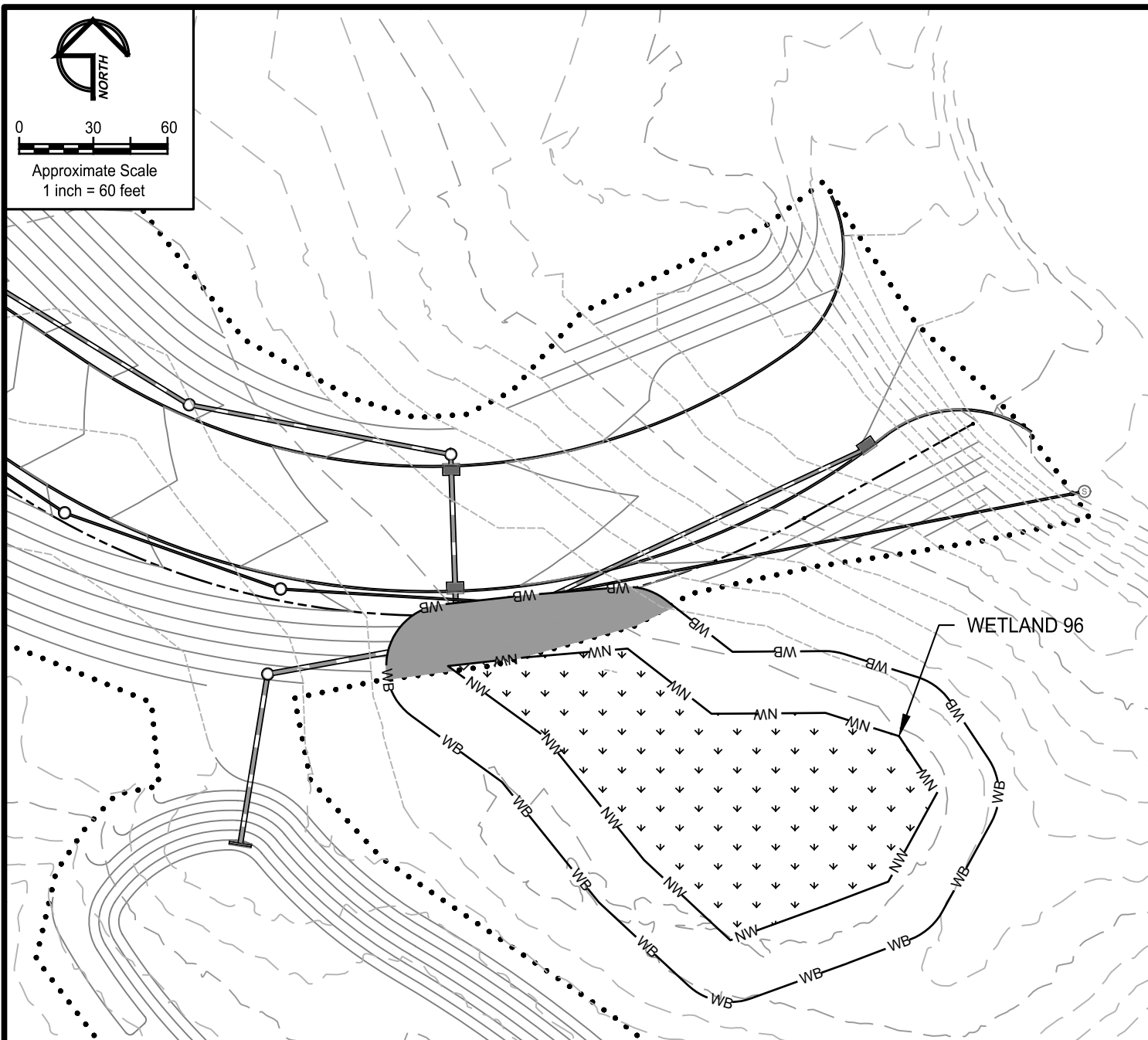

\\PSMC-DATA\gta\Shared\Project Files\2020\31200335 - Principio Business Park 'C'\WET\CAD\Plot\31200335 Impact Plates.dwg



LEGEND

- PR. LIMIT OF DISTURBANCE
- PR. CONTOURS
- PR. EDGE OF PAVEMENT
- US—— EX. STREAM CHANNEL
- ↓ ↓ ↓ ↓ ↓ EX. NONTIDAL WETLAND
- WB—— EX. 25' WETLAND BUFFER

PROPOSED IMPACTS

-  PERMANENT ISOLATED PFO WETLAND
44 SF (0.001 AC)
-  PERMANENT 25' WETLAND BUFFER
2,421 SF (0.06 AC)

REVISED JUNE 2, 2021 PER REVISED SITE ACCESS



GEO-TECHNOLOGY ASSOCIATES, INC.

GEOTECHNICAL AND ENVIRONMENTAL CONSULTANTS

3445-A BOX HILL CORPORATE CENTER DRIVE
ABINGDON, MARYLAND 21009
410-515-9446
FAX: 410-515-4895
WWW.GTAENG.COM

© 2020 GEO-TECHNOLOGY ASSOCIATES, INC.

IMPACT PLATES PRINCIPIO BUSINESS PARK SITE 'C'

CECIL COUNTY, MARYLAND

JOB NO. 31200335 SCALE: 1"=60' DATE: AUGUST 28, 2020 DRAWN BY: MAJ REVIEW BY: TAS FIGURE: 2 OF 12

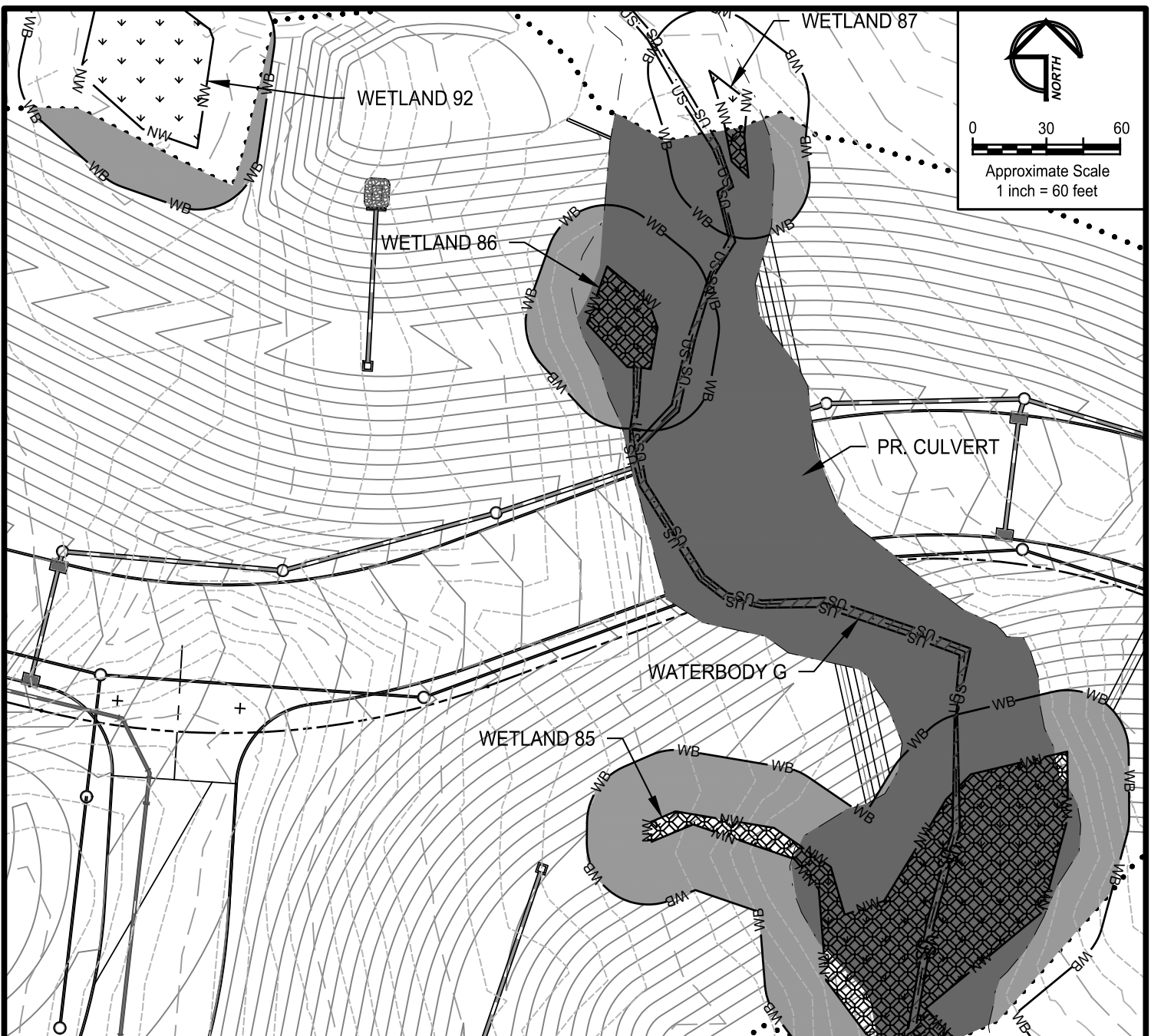

LEGEND

.....	PR. LIMIT OF DISTURBANCE
---	PR. CONTOURS
---	PR. EDGE OF PAVEMENT
---	FP EX. 100-YEAR FLOODPLAIN
---	US EX. STREAM CHANNEL
NW	EX. NONTIDAL WETLAND
NW	EX. 25' WETLAND BUFFER
WB	

PROPOSED IMPACTS

	PERMANENT CONNECTED PFO WETLAND 7,494 SF (0.17 AC)
	PERMANENT 25' WETLAND BUFFER 21,372 SF (0.49 AC)
	PERMANENT INTERMITTENT STREAM 1,489 SF (0.03 AC), 514 LF
	PERMANENT 100-YR FLOODPLAIN IMPACTS 29,536 SF (0.68 AC)

REVISED JUNE 2, 2021 PER REVISED SITE ACCESS



GEO-TECHNOLOGY ASSOCIATES, INC.

GEOTECHNICAL AND ENVIRONMENTAL CONSULTANTS

3445-A BOX HILL CORPORATE CENTER DRIVE
ABINGDON, MARYLAND 21009
410-515-9446
FAX: 410-515-4895
WWW.GTAENG.COM

© 2020 GEO-TECHNOLOGY ASSOCIATES, INC.

IMPACT PLATES PRINCIPIO BUSINESS PARK SITE 'C'

CECIL COUNTY, MARYLAND

JOB NO. 31200335 SCALE: 1"=60' DATE: AUGUST 28, 2020 DRAWN BY: MAJ REVIEW BY: TAS FIGURE: 3 OF 12

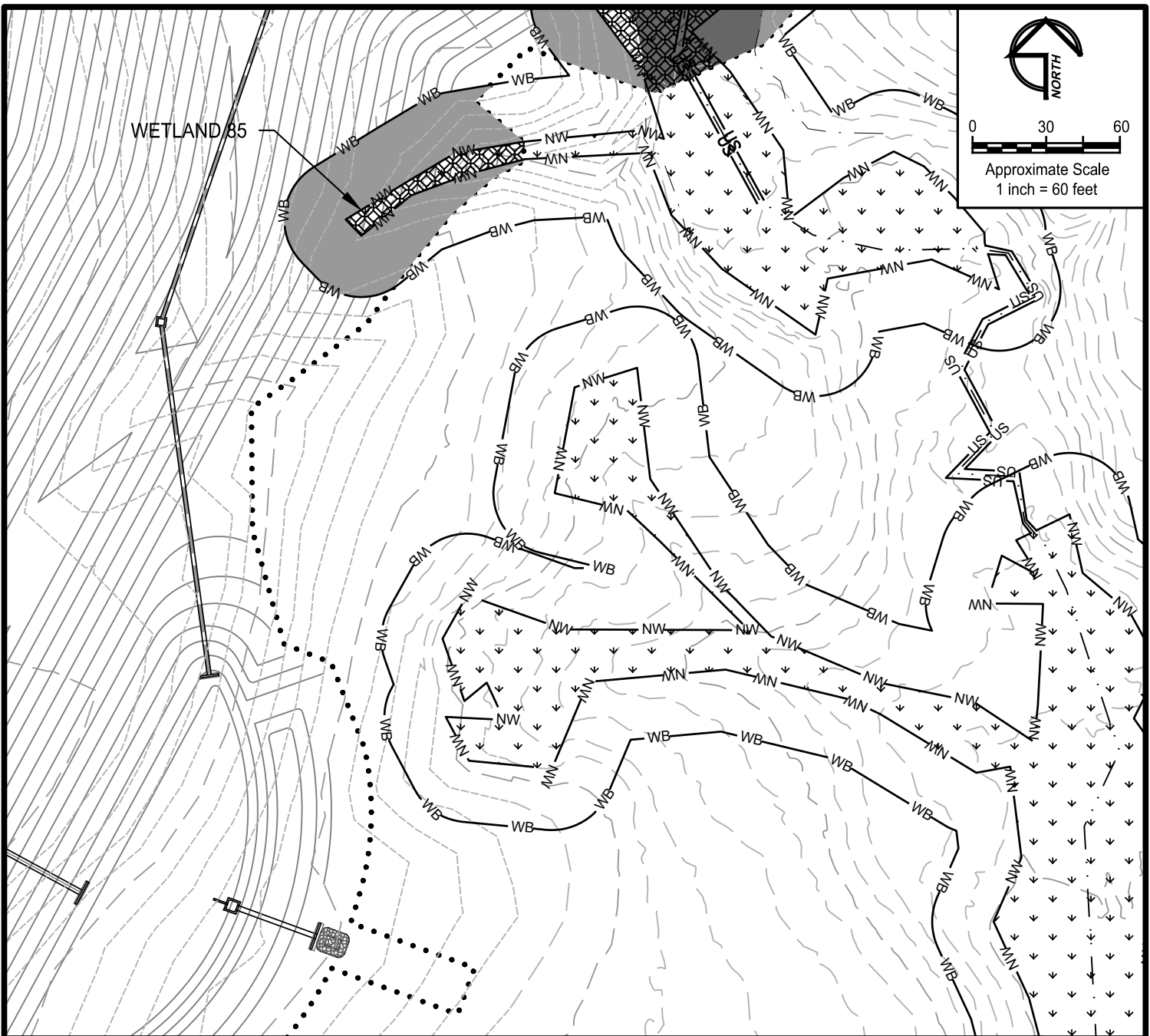

LEGEND

.....	PR. LIMIT OF DISTURBANCE
---	PR. CONTOURS
---	PR. EDGE OF PAVEMENT
---	FP EX. 100-YEAR FLOODPLAIN
---	US EX. STREAM CHANNEL
↓ ↓ ↓	NW EX. NONTIDAL WETLAND
WB	EX. 25' WETLAND BUFFER

PROPOSED IMPACTS

	PERMANENT CONNECTED PFO WETLAND 597 SF (0.01 AC)
	PERMANENT 25' WETLAND BUFFER 4,051 SF (0.09 AC)
	PERMANENT INTERMITTENT STREAM 20 SF (0.0005 AC), 7 LF
	PERMANENT 100-YR FLOODPLAIN IMPACTS 221 SF (0.005 AC)

REVISED JUNE 2, 2021 PER REVISED SITE ACCESS



GEO-TECHNOLOGY ASSOCIATES, INC.

GEOTECHNICAL AND ENVIRONMENTAL CONSULTANTS

3445-A BOX HILL CORPORATE CENTER DRIVE
ABINGDON, MARYLAND 21009
410-515-9446
FAX: 410-515-4895
WWW.GTAENG.COM

© 2020 GEO-TECHNOLOGY ASSOCIATES, INC.

IMPACT PLATES

PRINCIPIO BUSINESS PARK SITE 'C'

CECIL COUNTY, MARYLAND

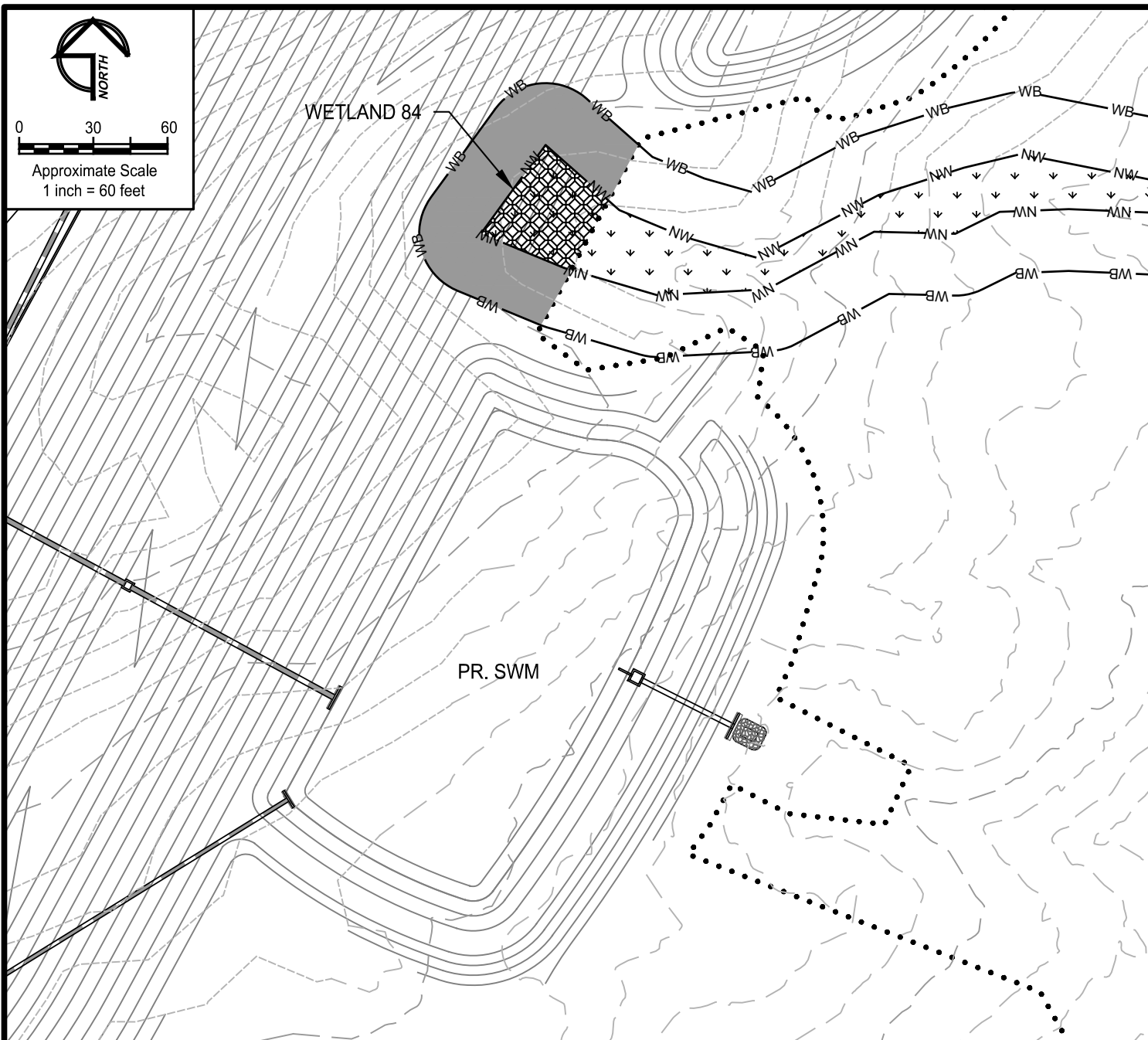

JOB NO. 31200335 SCALE: 1"=60' DATE: AUGUST 28, 2020 DRAWN BY: MAJ REVIEW BY: TAS FIGURE: 4 OF 12



LEGEND

- PR. LIMIT OF DISTURBANCE
- PR. CONTOURS
- PR. EDGE OF PAVEMENT
- US —— EX. STREAM CHANNEL
- ↓ ↓ ↓ EX. NONTIDAL WETLAND
- WB —— EX. 25' WETLAND BUFFER

PROPOSED IMPACTS

-  PERMANENT CONNECTED PFO WETLAND
1,376 SF (0.03 AC)
-  PERMANENT 25' WETLAND BUFFER
3,919 SF (0.09 AC)

REVISED JUNE 2, 2021 PER REVISED SITE ACCESS



GEO-TECHNOLOGY ASSOCIATES, INC.

GEOTECHNICAL AND ENVIRONMENTAL CONSULTANTS

3445-A BOX HILL CORPORATE CENTER DRIVE
ABINGDON, MARYLAND 21009
410-515-9446
FAX: 410-515-4895
WWW.GTAENG.COM

© 2020 GEO-TECHNOLOGY ASSOCIATES, INC.

IMPACT PLATES PRINCIPIO BUSINESS PARK SITE 'C'

CECIL COUNTY, MARYLAND

JOB NO. 31200335 SCALE: 1"=60' DATE: AUGUST 28, 2020 DRAWN BY: MAJ REVIEW BY: TAS FIGURE: 5 OF 12

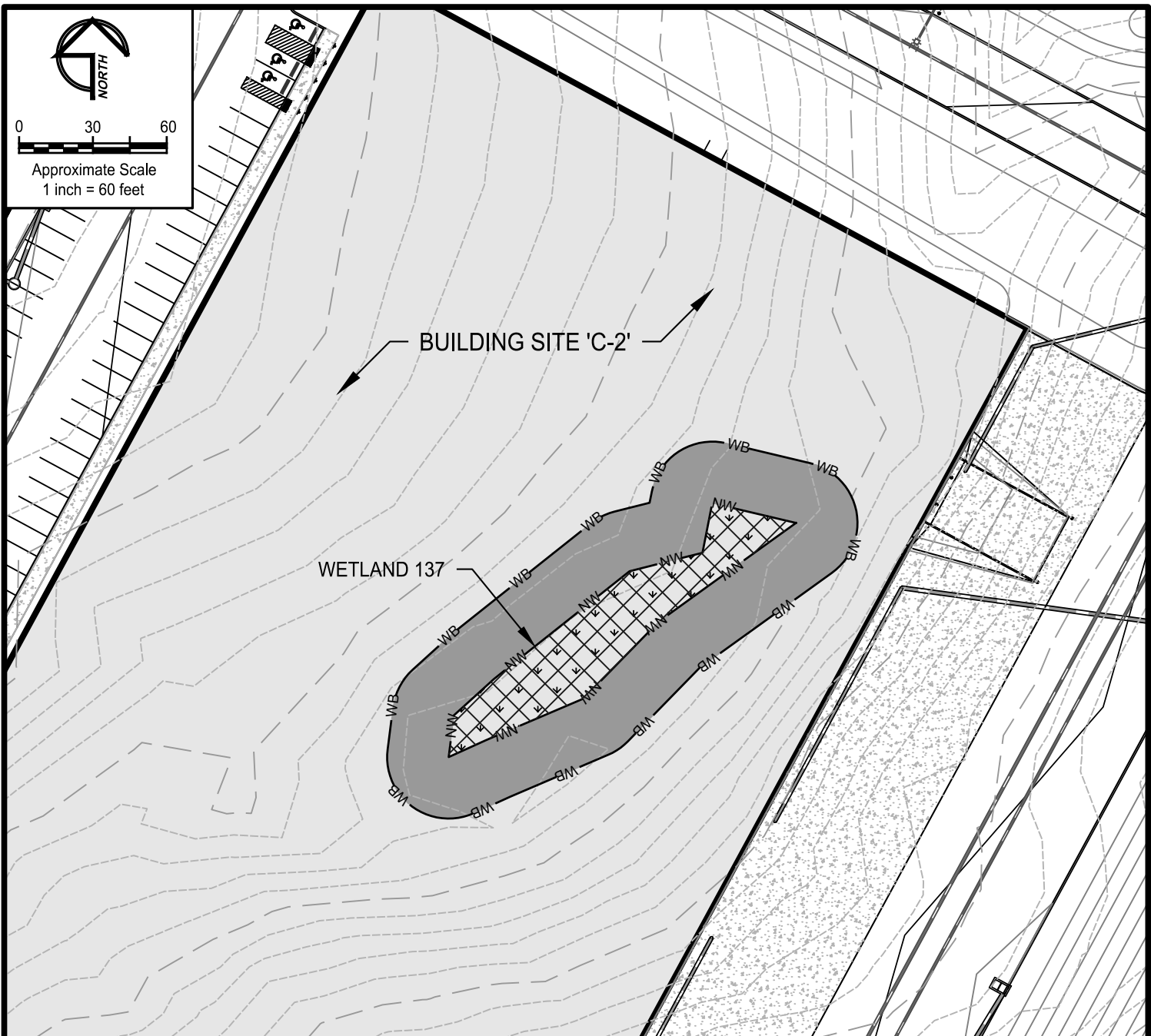

LEGEND

.....	PR. LIMIT OF DISTURBANCE
---	PR. CONTOURS
---	PR. EDGE OF PAVEMENT
---	US
---	NW
---	NW
---	WB
---	EX. NONTIDAL WETLAND
---	EX. 25' WETLAND BUFFER

PROPOSED IMPACTS

	PERMANENT ISOLATED PFO WETLAND 3,413 SF (0.08 AC)
	PERMANENT 25' WETLAND BUFFER 11,116 SF (0.26 AC)

REVISED JUNE 2, 2021 PER REVISED SITE ACCESS



GEO-TECHNOLOGY ASSOCIATES, INC.

GEOTECHNICAL AND ENVIRONMENTAL CONSULTANTS

3445-A BOX HILL CORPORATE CENTER DRIVE
ABINGDON, MARYLAND 21009
410-515-9446
FAX: 410-515-4895
WWW.GTAENG.COM

© 2020 GEO-TECHNOLOGY ASSOCIATES, INC.

IMPACT PLATES PRINCIPIO BUSINESS PARK SITE 'C'

CECIL COUNTY, MARYLAND

JOB NO. 31200335 SCALE: 1"=60' DATE: AUGUST 28, 2020 DRAWN BY: MAJ REVIEW BY: TAS FIGURE: 6 OF 12

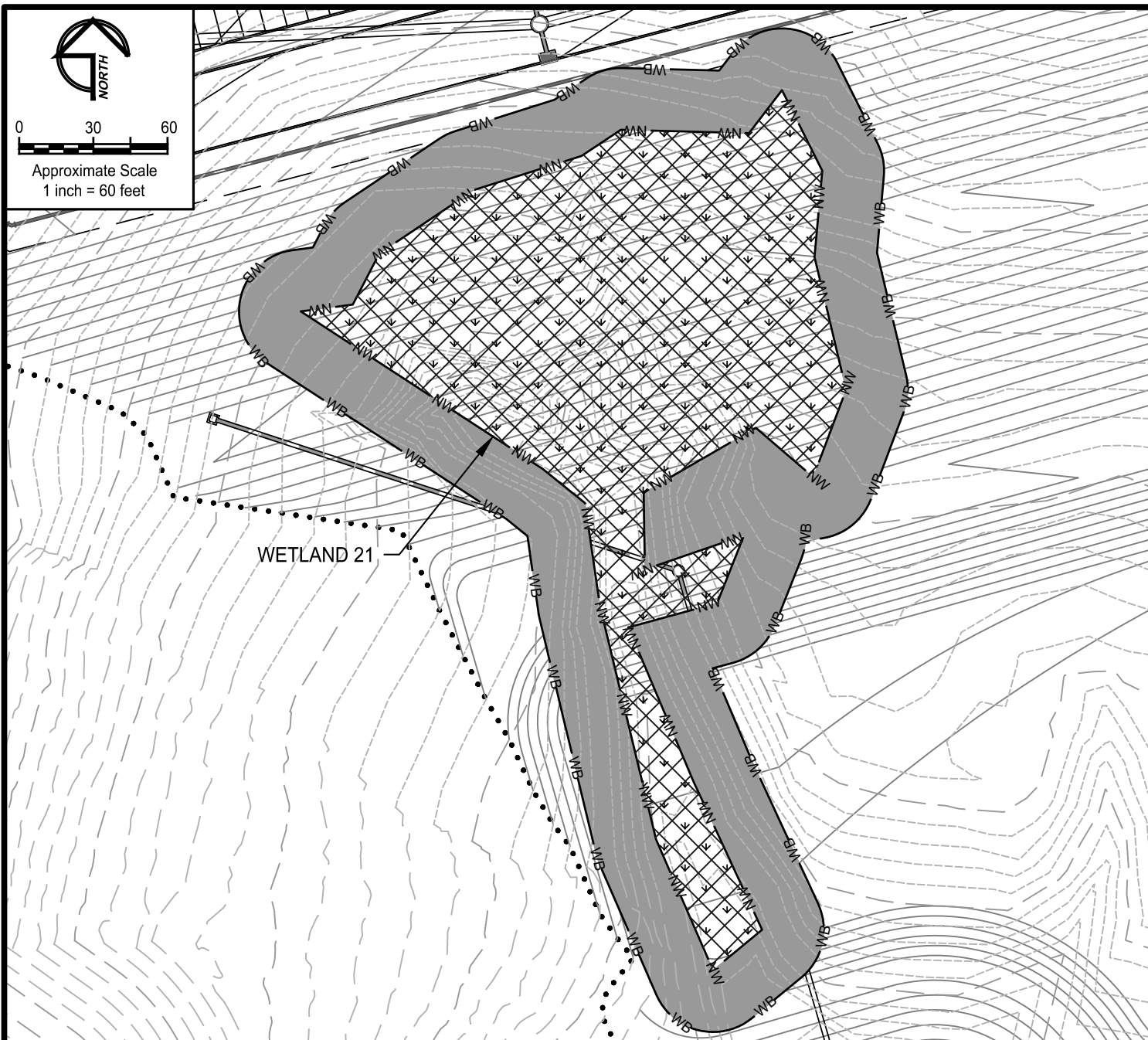

LEGEND

.....	PR. LIMIT OF DISTURBANCE
---	PR. CONTOURS
---	PR. EDGE OF PAVEMENT
---	EX. STREAM CHANNEL
US	
NW	
NW	
NW	
WB	
	EX. NONTIDAL WETLAND
	EX. 25' WETLAND BUFFER

PROPOSED IMPACTS

	PERMANENT ISOLATED PFO WETLAND 26,300 SF (0.60 AC)
	PERMANENT 25' WETLAND BUFFER 28,528 SF (0.66 AC)

REVISED JUNE 2, 2021 PER REVISED SITE ACCESS



GEO-TECHNOLOGY ASSOCIATES, INC.

GEOTECHNICAL AND ENVIRONMENTAL CONSULTANTS

3445-A BOX HILL CORPORATE CENTER DRIVE
ABINGDON, MARYLAND 21009
410-515-9446
FAX: 410-515-4895
WWW.GTAENG.COM

© 2020 GEO-TECHNOLOGY ASSOCIATES, INC.

IMPACT PLATES PRINCIPIO BUSINESS PARK SITE 'C'

CECIL COUNTY, MARYLAND

JOB NO. 31200335 SCALE: 1"=60' DATE: AUGUST 28, 2020 DRAWN BY: MAJ REVIEW BY: TAS FIGURE: 7 OF 12

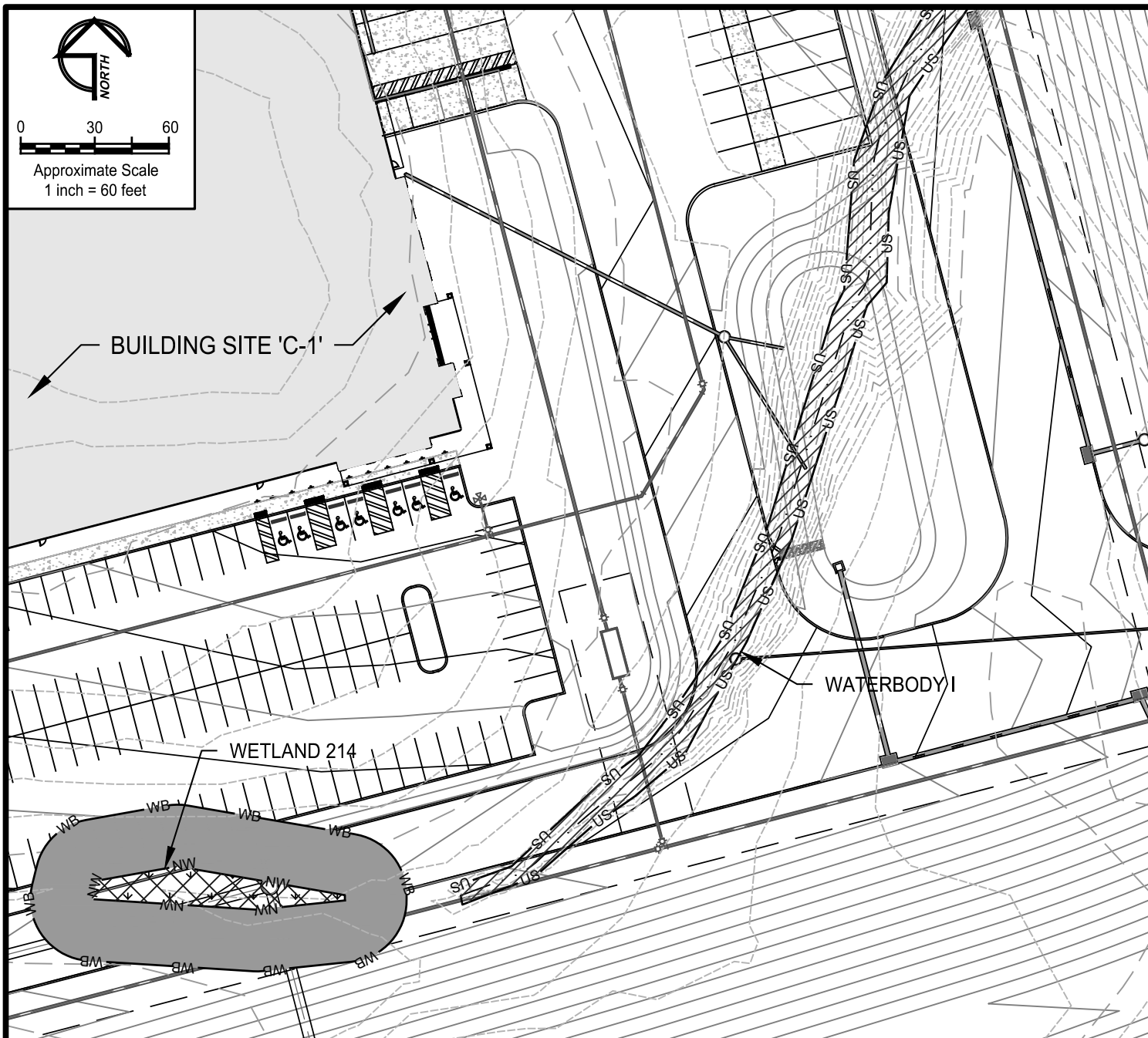

LEGEND

.....	PR. LIMIT OF DISTURBANCE
---	PR. CONTOURS
---	PR. EDGE OF PAVEMENT
---	US
---	NW
---	NW
---	WB
---	EX. NONTIDAL WETLAND
---	EX. 25' WETLAND BUFFER

PROPOSED IMPACTS

---	PERMANENT ISOLATED PFO WETLAND 1,080 SF (0.02 AC)
---	PERMANENT 25' WETLAND BUFFER 7,372 SF (0.17 AC)
---	PERMANENT INTERMITTENT STREAM 5,163 SF (0.12 AC), 430 LF

REVISED JUNE 2, 2021 PER REVISED SITE ACCESS



GEO-TECHNOLOGY ASSOCIATES, INC.

GEOTECHNICAL AND ENVIRONMENTAL CONSULTANTS

3445-A BOX HILL CORPORATE CENTER DRIVE
ABINGDON, MARYLAND 21009
410-515-9446
FAX: 410-515-4895
WWW.GTAENG.COM

© 2020 GEO-TECHNOLOGY ASSOCIATES, INC.

IMPACT PLATES PRINCIPIO BUSINESS PARK SITE 'C'

CECIL COUNTY, MARYLAND

JOB NO. 31200335 SCALE: 1"=60' DATE: AUGUST 28, 2020 DRAWN BY: MAJ REVIEW BY: TAS FIGURE: 8 OF 12

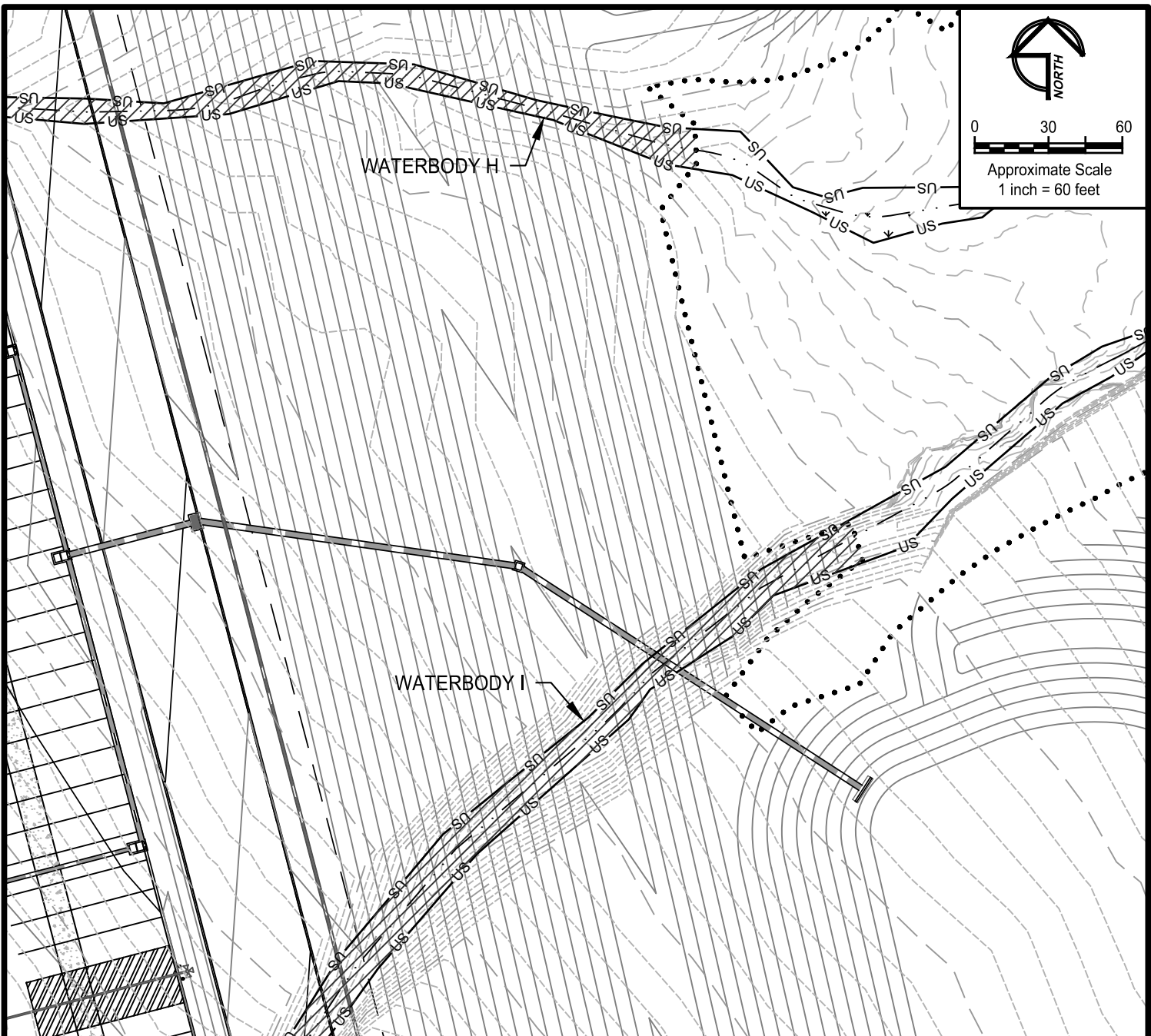

LEGEND

.....	PR. LIMIT OF DISTURBANCE
---	PR. CONTOURS
---	PR. EDGE OF PAVEMENT
US	EX. STREAM CHANNEL
NW	EX. NONTIDAL WETLAND
NW	EX. 25' WETLAND BUFFER
WB	

PROPOSED IMPACTS

	PERMANENT INTERMITTENT STREAM 6,866 SF (0.16 AC), 590 LF
--	---

REVISED JUNE 2, 2021 PER REVISED SITE ACCESS



GEO-TECHNOLOGY ASSOCIATES, INC.

GEOTECHNICAL AND ENVIRONMENTAL CONSULTANTS

3445-A BOX HILL CORPORATE CENTER DRIVE
ABINGDON, MARYLAND 21009
410-515-9446
FAX: 410-515-4895
WWW.GTAENG.COM

© 2020 GEO-TECHNOLOGY ASSOCIATES, INC.

IMPACT PLATES

PRINCIPIO BUSINESS PARK SITE 'C'

CECIL COUNTY, MARYLAND

JOB NO.	31200335	SCALE:	1"=60'	DATE:	AUGUST 28, 2020	DRAWN BY:	MAJ	REVIEW BY:	TAS	FIGURE:	9 OF 12
---------	----------	--------	--------	-------	-----------------	-----------	-----	------------	-----	---------	---------

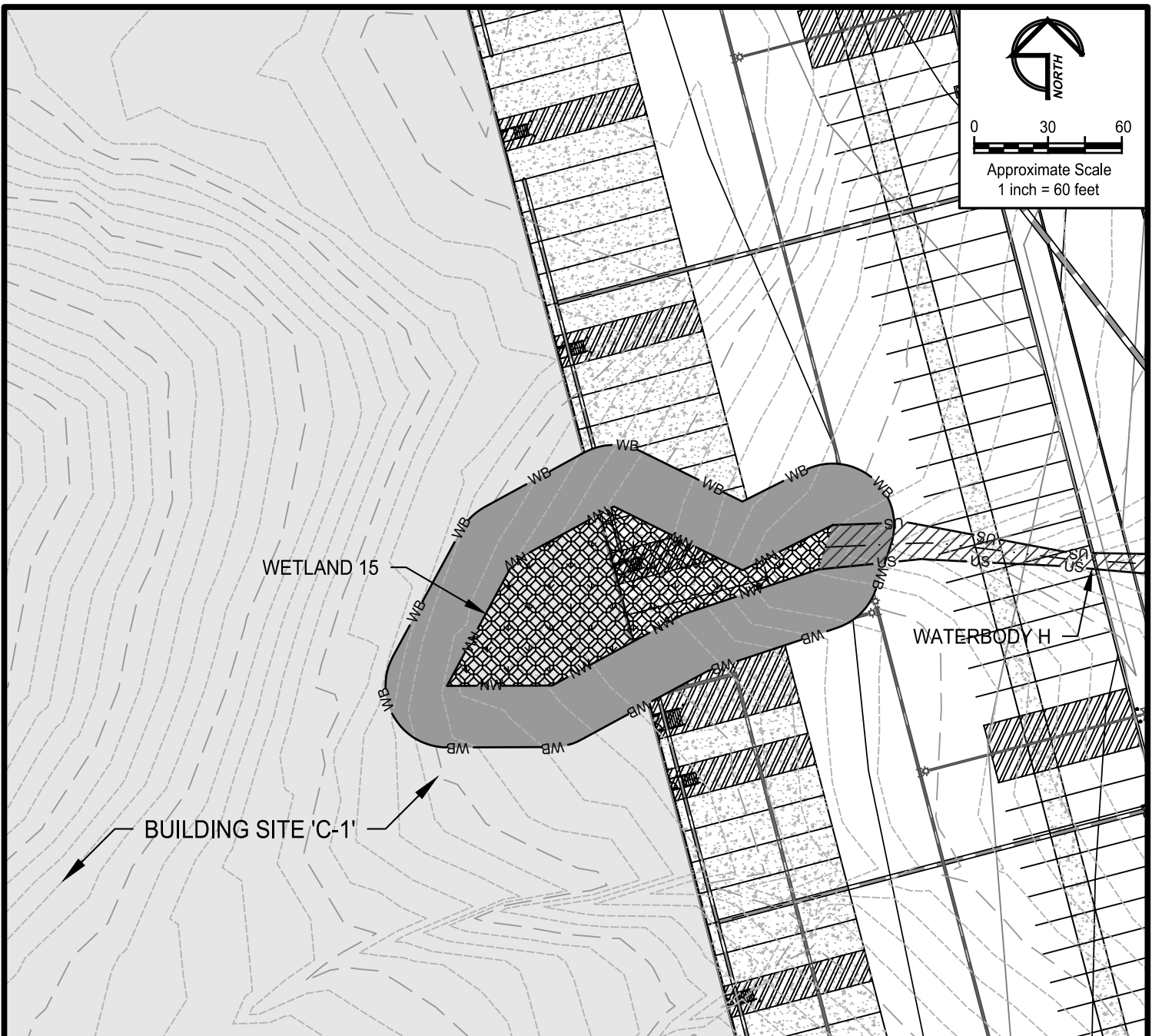

LEGEND

.....	PR. LIMIT OF DISTURBANCE
---	PR. CONTOURS
---	PR. EDGE OF PAVEMENT
---	US
---	NW
---	NW
---	WB
---	EX. NONTIDAL WETLAND
---	EX. 25' WETLAND BUFFER

PROPOSED IMPACTS

---	PERMANENT CONNECTED PFO WETLAND 5,185 SF (0.12 AC)
---	PERMANENT 25' WETLAND BUFFER 11,527 SF (0.26 AC)
---	PERMANENT INTERMITTENT STREAM 1,442 SF (0.03 AC), 132 LF

REVISED JUNE 2, 2021 PER REVISED SITE ACCESS



GEO-TECHNOLOGY ASSOCIATES, INC.

GEOTECHNICAL AND ENVIRONMENTAL CONSULTANTS

3445-A BOX HILL CORPORATE CENTER DRIVE
ABINGDON, MARYLAND 21009
410-515-9446
FAX: 410-515-4895
WWW.GTAENG.COM

© 2020 GEO-TECHNOLOGY ASSOCIATES, INC.

IMPACT PLATES

PRINCIPIO BUSINESS PARK SITE 'C'

CECIL COUNTY, MARYLAND

JOB NO. 31200335 SCALE: 1"=60' DATE: AUGUST 28, 2020 DRAWN BY: MAJ REVIEW BY: TAS FIGURE: 10 OF 12

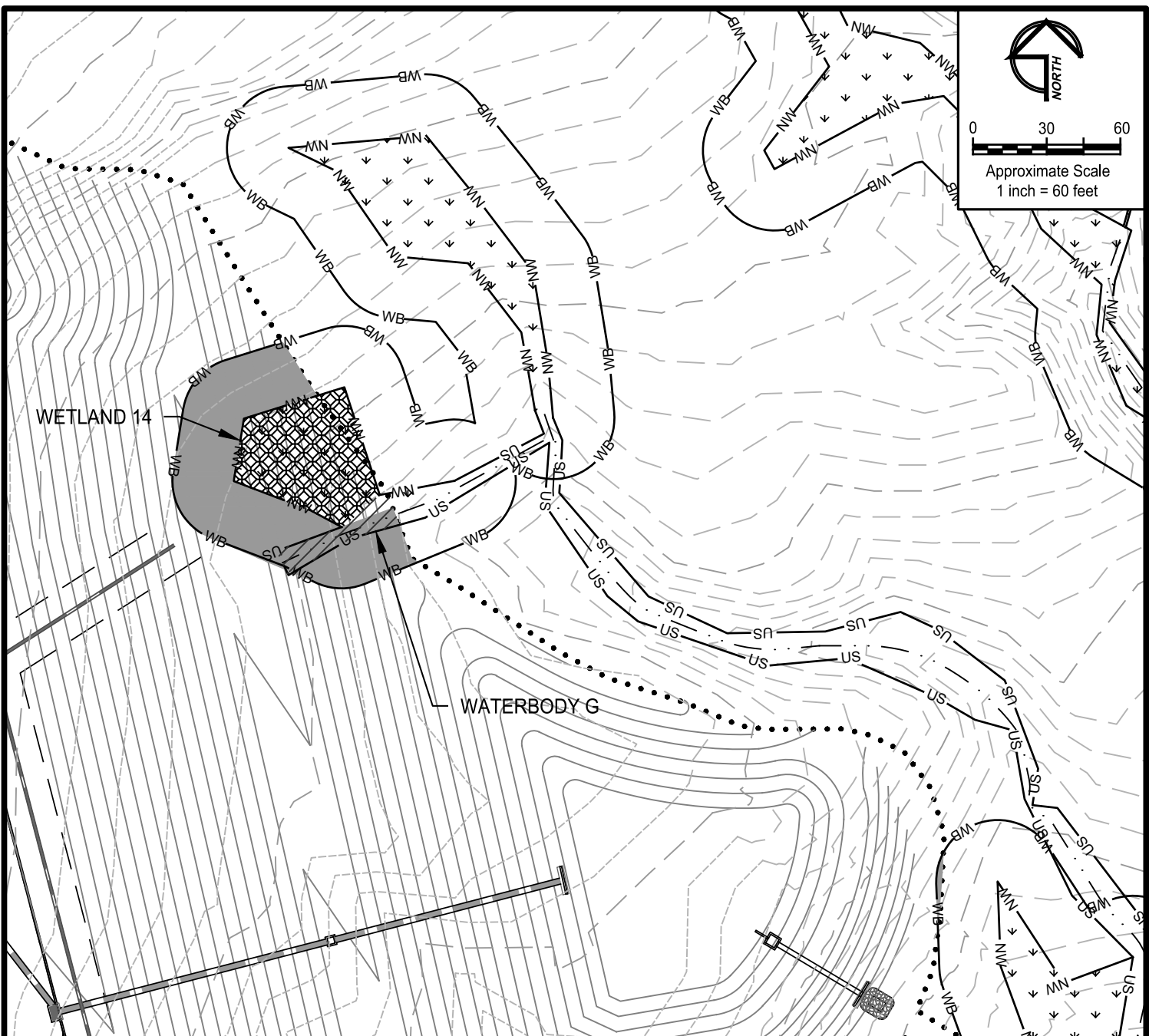

LEGEND

.....	PR. LIMIT OF DISTURBANCE
---	PR. CONTOURS
---	PR. EDGE OF PAVEMENT
---	EX. STREAM CHANNEL
US	US
NW	NW
NW	NW
WB	WB
	EX. NONTIDAL WETLAND
	EX. 25' WETLAND BUFFER

PROPOSED IMPACTS

	PERMANENT CONNECTED PFO WETLAND 2,156 SF (0.05 AC)
	PERMANENT 25' WETLAND BUFFER 4,147 SF (0.10 AC)
	PERMANENT INTERMITTENT STREAM 462 SF (0.01 AC), 50 LF

REVISED JUNE 2, 2021 PER REVISED SITE ACCESS



GEO-TECHNOLOGY ASSOCIATES, INC.

GEOTECHNICAL AND ENVIRONMENTAL CONSULTANTS

3445-A BOX HILL CORPORATE CENTER DRIVE
ABINGDON, MARYLAND 21009
410-515-9446
FAX: 410-515-4895
WWW.GTAENG.COM

© 2020 GEO-TECHNOLOGY ASSOCIATES, INC.

IMPACT PLATES

PRINCIPIO BUSINESS PARK SITE 'C'

CECIL COUNTY, MARYLAND

JOB NO. 31200335 SCALE: 1"=60' DATE: AUGUST 28, 2020 DRAWN BY: MAJ REVIEW BY: TAS FIGURE: 11 OF 12

SUMMARY OF IMPACTS

STREAM CHANNELS

PERMANENT INTERMITTENT STREAM IMPACTS = 15,442 SF (0.35 ACRES)
1,723 LINEAR FEET

NONTIDAL WETLANDS

PERMANENT ISOLATED PFO WETLAND IMPACTS = 30,837 SF (0.71 ACRES)
PERMANENT CONNECTED PFO WETLAND IMPACTS = 17,020 SF (0.39 ACRES)

NONTIDAL WETLAND BUFFERS

PERMANENT WETLAND BUFFER IMPACTS = 94,796 SF (2.18 ACRES)

100-YEAR FLOODPLAIN

PERMANENT 100-YEAR FLOODPLAIN IMPACTS = 29,757 SF (0.68 ACRES)

REVISED JUNE 2, 2021 PER REVISED SITE ACCESS



GEO-TECHNOLOGY ASSOCIATES, INC.

GEOTECHNICAL AND ENVIRONMENTAL CONSULTANTS

3445-A BOX HILL CORPORATE CENTER DRIVE
ABINGDON, MARYLAND 21009
410-515-9446
FAX: 410-515-4895
WWW.GTAENG.COM

© 2020 GEO-TECHNOLOGY ASSOCIATES, INC.

IMPACT PLATES PRINCIPIO BUSINESS PARK SITE 'C'

CECIL COUNTY, MARYLAND

JOB NO.	31200335	SCALE:	1"=60'	DATE:	AUGUST 28, 2020	DRAWN BY:	MAJ	REVIEW BY:	TAS	FIGURE:	12 OF 12
---------	----------	--------	--------	-------	-----------------	-----------	-----	------------	-----	---------	----------