



**DREDGE
SITE**

**PARKER CREEK MAINTENANCE
DREDGING
AT
ANNE ARUNDEL
COUNTY**

APPL. BY: ANNE ARUNDEL COUNTY DEPARTMENT OF PUBLIC WORKS

VICINITY MAP

DATE: JULY 2025 SHEET 1 OF 11

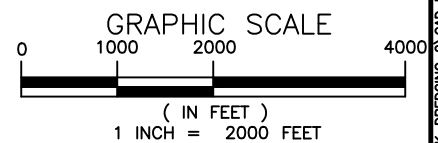

Consultants & Designers, Inc.

"Integrating Engineering and Environment"

7455 New Ridge Road, Suite 1 Phone: (410) 694-9401
Hanover, Maryland 21076 Fax: (410) 694-9405
www.baylandinc.com

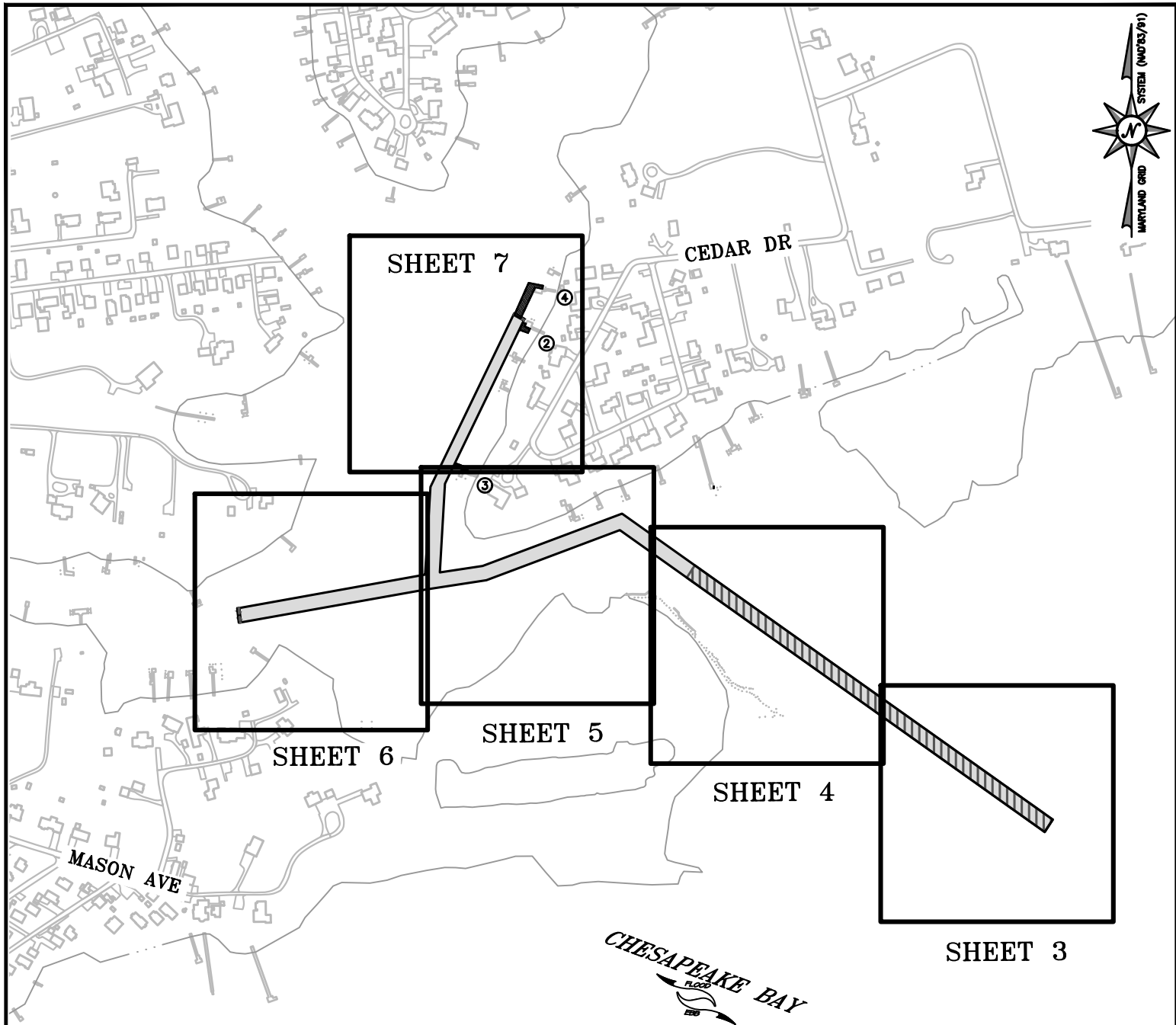

**PARKER CREEK MAINTENANCE
DREDGING
AT
ANNE ARUNDEL
COUNTY**

APPL. BY: ANNE ARUNDEL COUNTY DEPARTMENT OF PUBLIC WORKS

KEY SHEET

DATE: JULY 2025 SHEET 2 OF 11

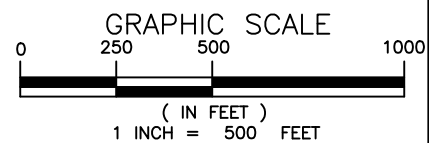

Consultants & Designers, Inc.

"Integrating Engineering and Environment"

7455 New Ridge Road, Suite 1 Phone: (410) 694-9401
Hanover, Maryland 21076 Fax: (410) 694-9405
www.baylandinc.com

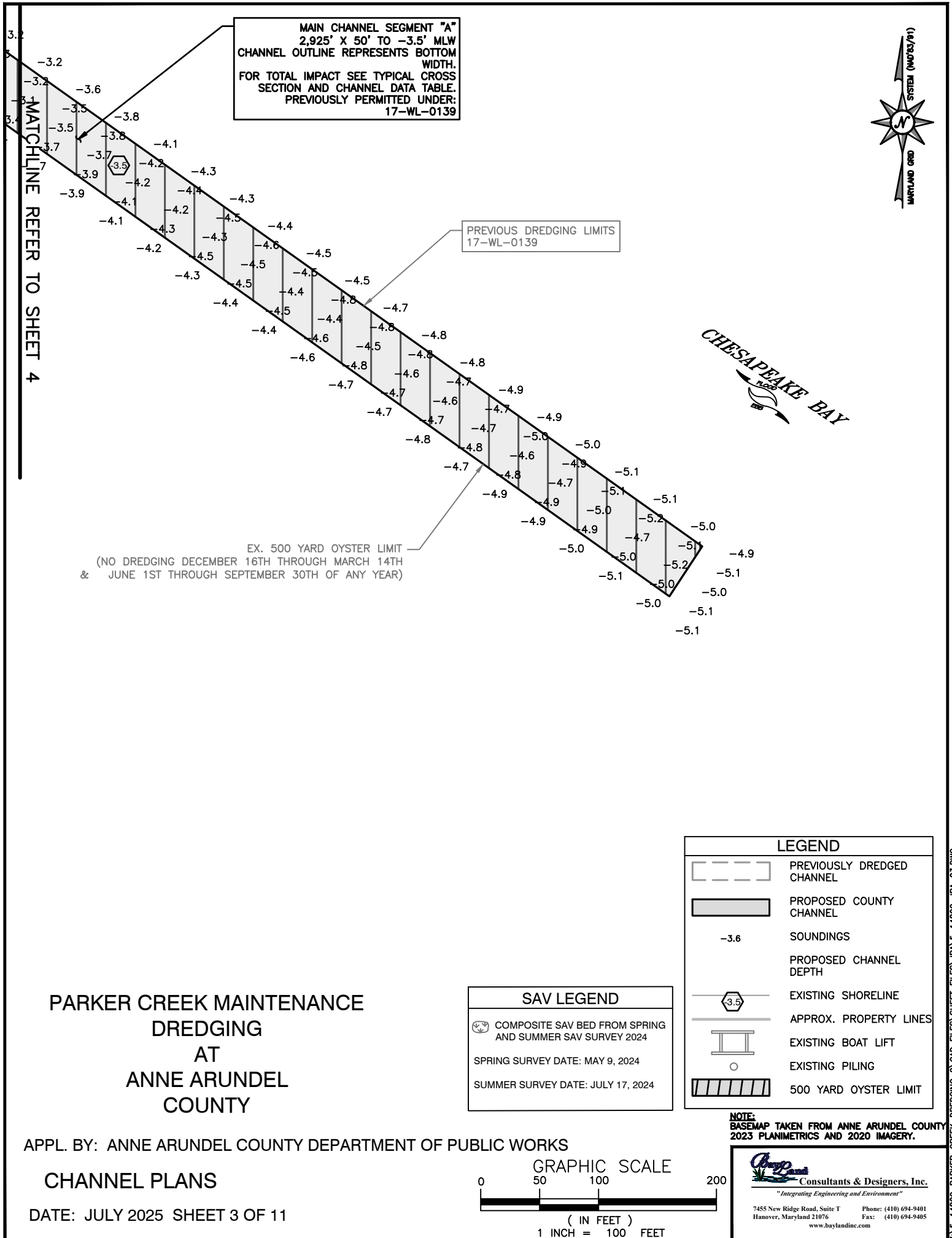

MAIN CHANNEL SEGMENT "A"
2,925' X 50' TO -3.5' MLW
CHANNEL OUTLINE REPRESENTS BOTTOM
WIDTH.
FOR TOTAL IMPACT SEE TYPICAL CROSS
SECTION AND CHANNEL DATA TABLE.
PREVIOUSLY PERMITTED UNDER:
17-WL-0139

PREVIOUS DREDGING LIMITS
17-WL-0139

EX. 500 YARD OYSTER LIMIT
(NO DREDGING DECEMBER 16TH THROUGH MARCH 14TH
& JUNE 1ST THROUGH SEPTEMBER 30TH OF ANY YEAR)

PARKER CREEK MAINTENANCE
DREDGING
AT
ANNE ARUNDEL
COUNTY

APPL. BY: ANNE ARUNDEL COUNTY DEPARTMENT OF PUBLIC WORKS

CHANNEL PLANS

DATE: JULY 2025 SHEET 3 OF 11

| SAV LEGEND | |
|-----------------------------------|--|
| | COMPOSITE SAV BED FROM SPRING AND SUMMER SAV SURVEY 2024 |
| SPRING SURVEY DATE: MAY 9, 2024 | |
| SUMMER SURVEY DATE: JULY 17, 2024 | |

| LEGEND | |
|--------|----------------------------|
| | PREVIOUSLY DREDGED CHANNEL |
| | PROPOSED COUNTY CHANNEL |
| -3.6 | SOUNDINGS |
| | PROPOSED CHANNEL DEPTH |
| | EXISTING SHORELINE |
| | APPROX. PROPERTY LINES |
| | EXISTING BOAT LIFT |
| | EXISTING PILING |
| | 500 YARD OYSTER LIMIT |

NOTE:
BASEMAP TAKEN FROM ANNE ARUNDEL COUNTY
2023 PLANIMETRICS AND 2020 IMAGERY.

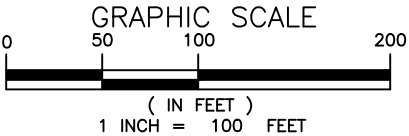

Consultants & Designers, Inc.
"Integrating Engineering and Environment"
7455 New Ridge Road, Suite T Phone: (410) 694-9401
Hanover, Maryland 21076 Fax: (410) 694-9405
www.baylandinc.com

Z:\5_14802_PARKER_CREEK_DREDGING_2\CAD FILES\SHEET FILES\JPA\5_14802_JPA_03.DWG

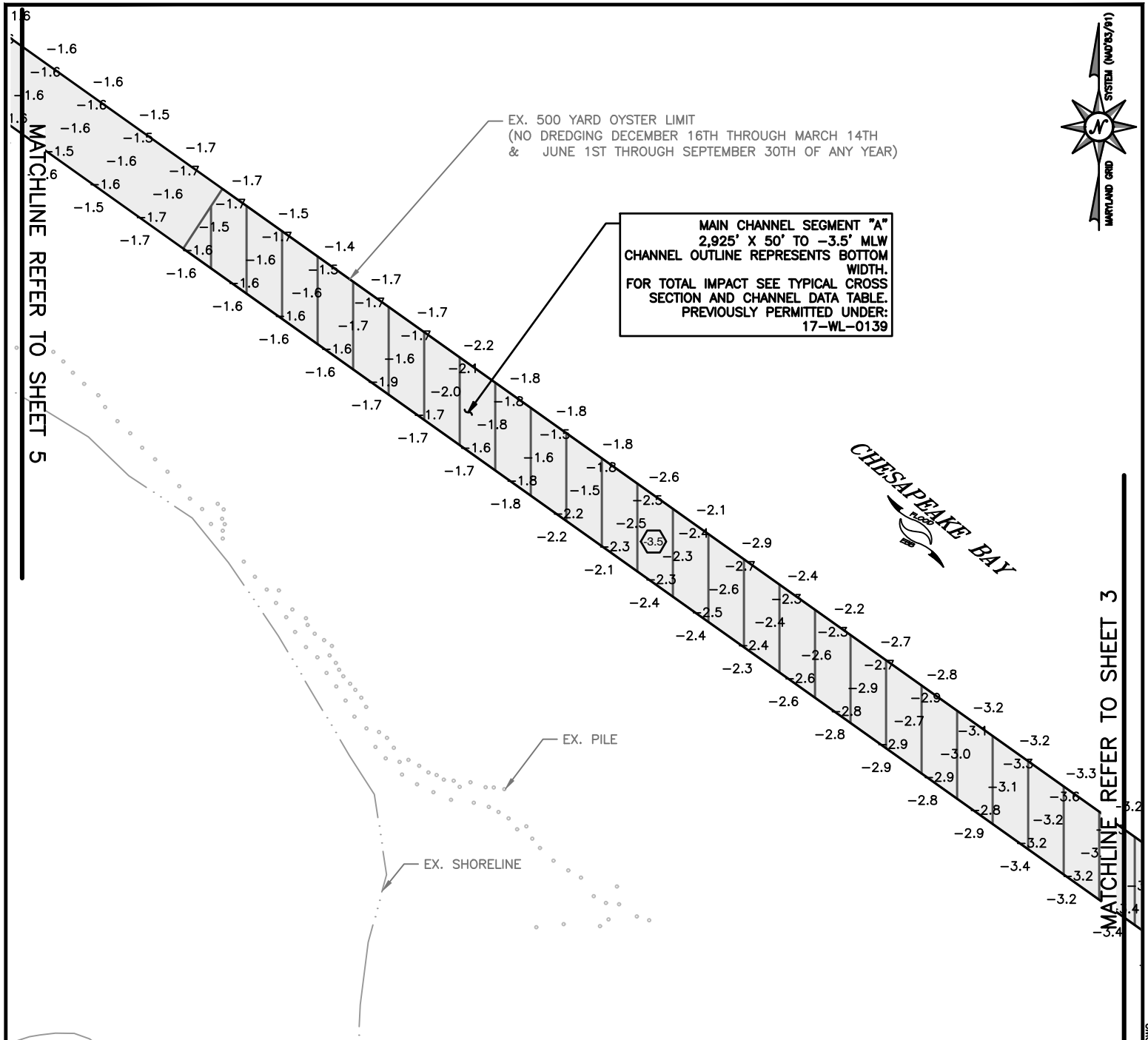

PARKER CREEK MAINTENANCE DREDGING AT ANNE ARUNDEL COUNTY

APPL. BY: ANNE ARUNDEL COUNTY DEPARTMENT OF PUBLIC WORKS

CHANNEL PLANS

DATE: JULY 2025 SHEET 4 OF 11

GRAPHIC SCALE

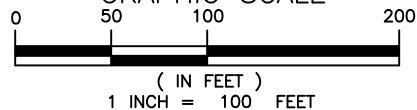

NOTE:
BASEMAP TAKEN FROM ANNE ARUNDEL COUNTY
2023 PLANIMETRICS AND 2020 IMAGERY.



Consultants & Designers, Inc.

"Integrating Engineering and Environment"

7455 New Ridge Road, Suite T Phone: (410) 694-9401
Hanover, Maryland 21076 Fax: (410) 694-9405
www.baylandinc.com

Z:\5_14802_PARKER_CREEK_DREDGING_2\CAD FILES\SHEET FILES\JPA\5_14802_JPA_04.DWG

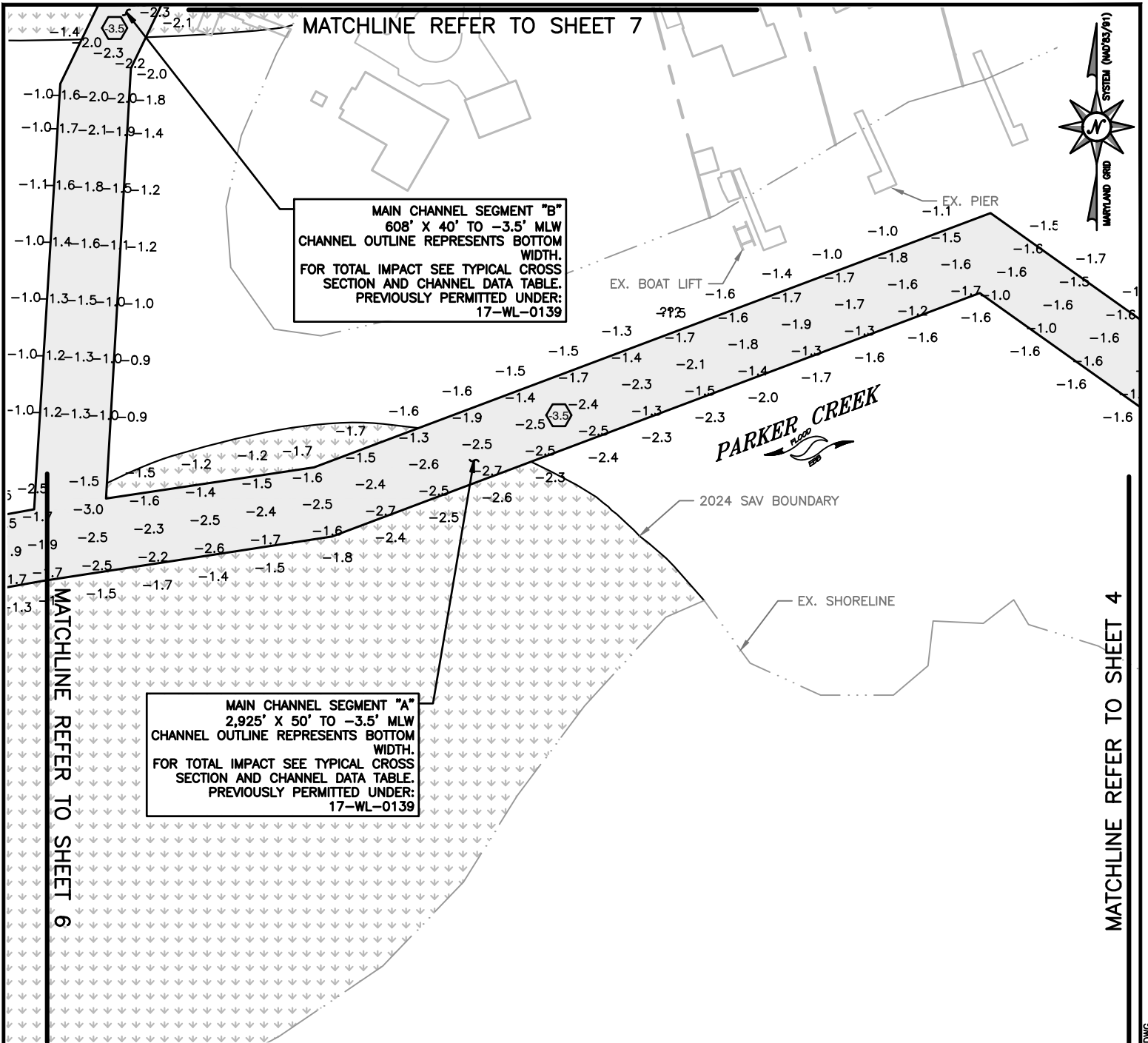

PARKER CREEK MAINTENANCE
DREDGING
AT
ANNE ARUNDEL
COUNTY

APPL. BY: ANNE ARUNDEL COUNTY DEPARTMENT OF PUBLIC WORKS

CHANNEL PLANS

DATE: JULY 2025 SHEET 5 OF 11

GRAPHIC SCALE

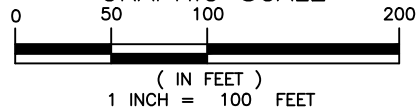

NOTE:
BASEMAP TAKEN FROM ANNE ARUNDEL COUNTY
2023 PLANIMETRICS AND 2020 IMAGERY.



7455 New Ridge Road, Suite T Phone: (410) 694-9401
Hanover, Maryland 21076 Fax: (410) 694-9405
www.baylandinc.com



MAIN CHANNEL SEGMENT "A"
2,925' X 50' TO -3.5' MLW
CHANNEL OUTLINE REPRESENTS BOTTOM
WIDTH.
FOR TOTAL IMPACT SEE TYPICAL CROSS
SECTION AND CHANNEL DATA TABLE.
PREVIOUSLY PERMITTED UNDER:
17-WL-0139

PARKER CREEK

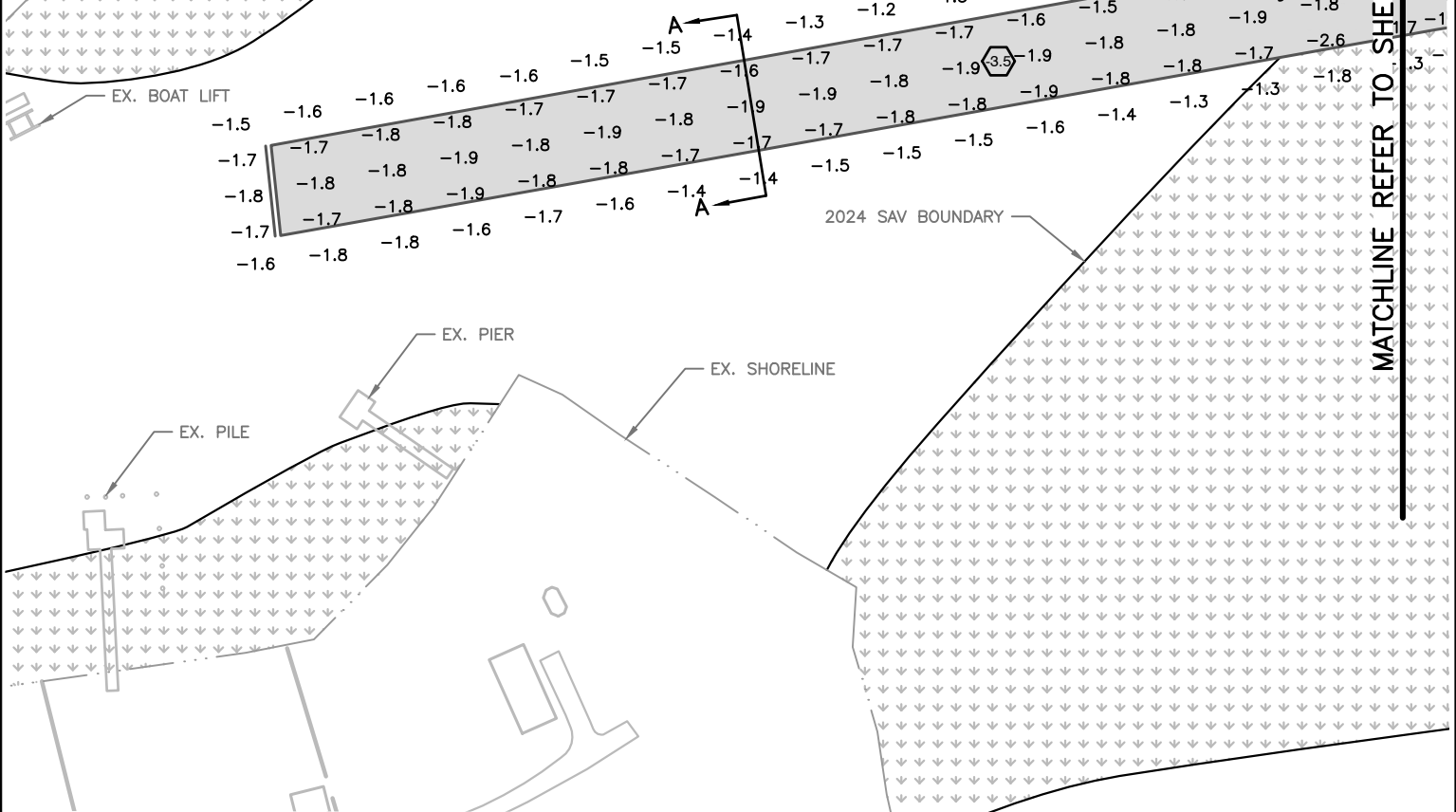

**PARKER CREEK MAINTENANCE
DREDGING
AT
ANNE ARUNDEL
COUNTY**

APPL. BY: ANNE ARUNDEL COUNTY DEPARTMENT OF PUBLIC WORKS

CHANNEL PLANS

DATE: JULY 2025 SHEET 6 OF 11

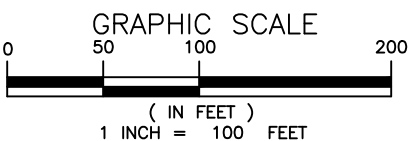

NOTE:
BASEMAP TAKEN FROM ANNE ARUNDEL COUNTY
2023 PLANIMETRICS AND 2020 IMAGERY.

Consultants & Designers, Inc.
"Integrating Engineering and Environment"
7455 New Ridge Road, Suite T Phone: (410) 694-9401
Hanover, Maryland 21076 Fax: (410) 694-9405
www.baylandinc.com

Z:\5_14802_PARKER_CREEK_DREDGING_2\CAD FILES\SHEET FILES\JPA\5_14802_JPA_06.DWG

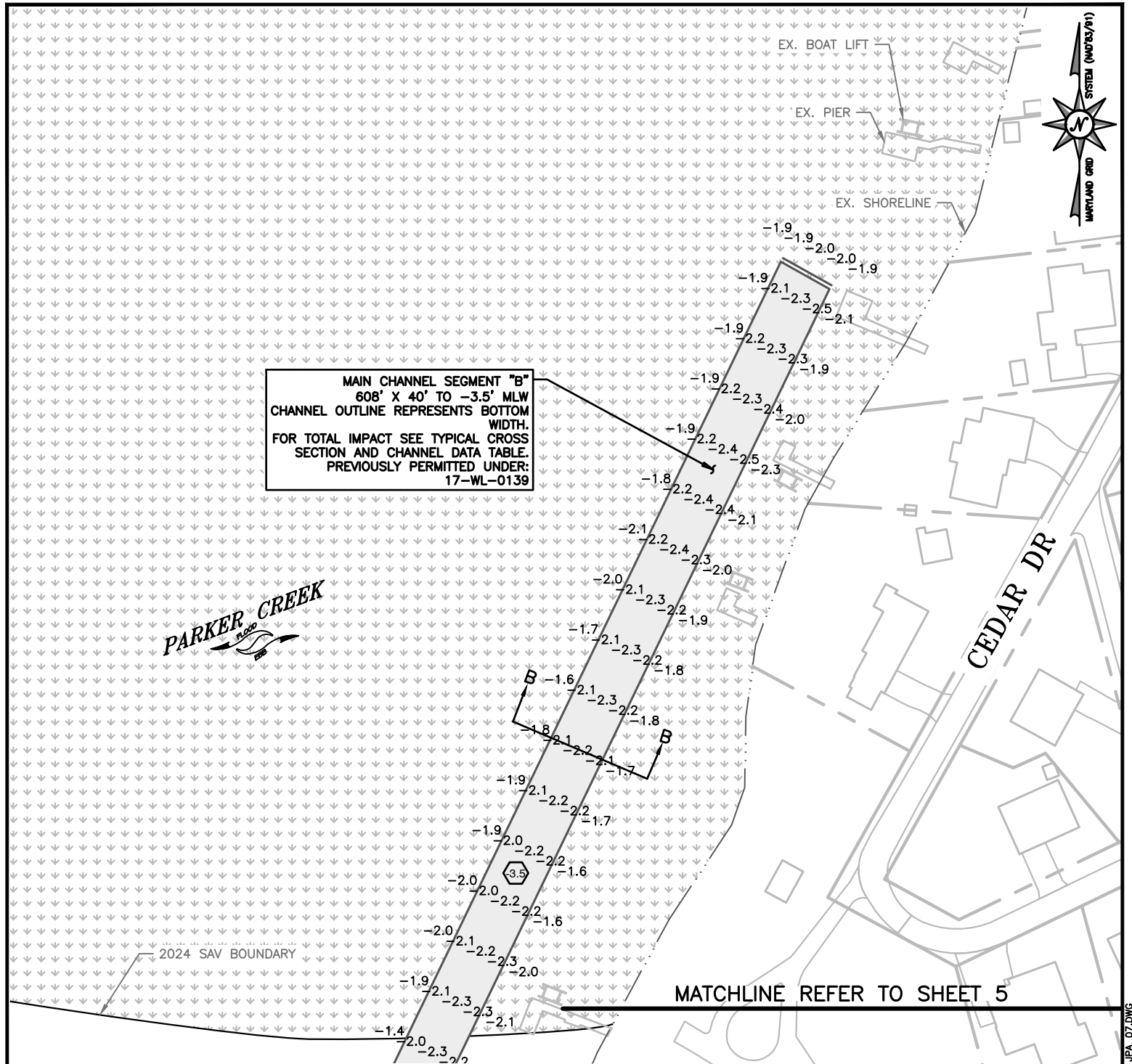

**PARKER CREEK MAINTENANCE
DREDGING
AT
ANNE ARUNDEL
COUNTY**

APPL. BY: ANNE ARUNDEL COUNTY DEPARTMENT OF PUBLIC WORKS

CHANNEL PLANS

DATE: JULY 2025 SHEET 7 OF 11

GRAPHIC SCALE

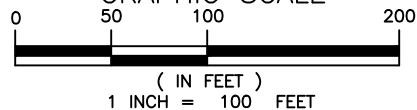

NOTE:
BASEMAP TAKEN FROM ANNE ARUNDEL COUNTY
2023 PLANIMETRICS AND 2020 IMAGERY.



Consultants & Designers, Inc.

"Integrating Engineering and Environment"

7455 New Ridge Road, Suite 1 Phone: (410) 694-9401
Hanover, Maryland 21076 Fax: (410) 694-9405
www.baylandinc.com

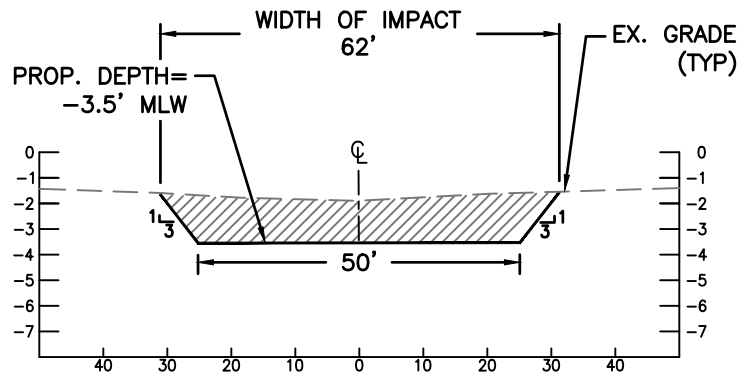

SECTION A-A

SCALE: NTS

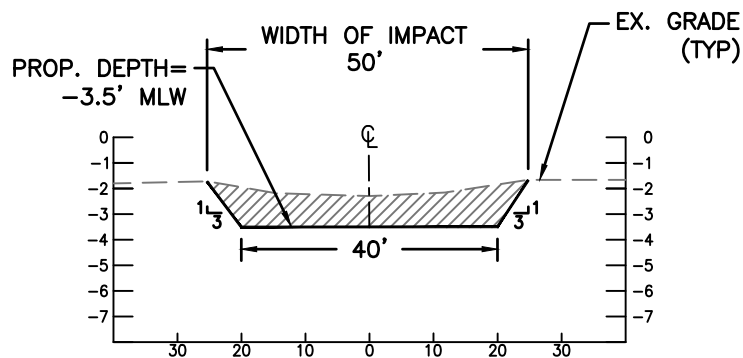

SECTION B-B

SCALE: NTS

PARKER CREEK MAINTENANCE DREDGING AT ANNE ARUNDEL COUNTY

APPL. BY: ANNE ARUNDEL COUNTY DEPARTMENT OF PUBLIC WORKS

CHANNEL DETAILS

DATE: JULY 2025 SHEET 8 OF 11



Consultants & Designers, Inc.

"Integrating Engineering and Environment"

7455 New Ridge Road, Suite T Phone: (410) 694-9401
Hanover, Maryland 21076 Fax: (410) 694-9405
www.baylandinc.com

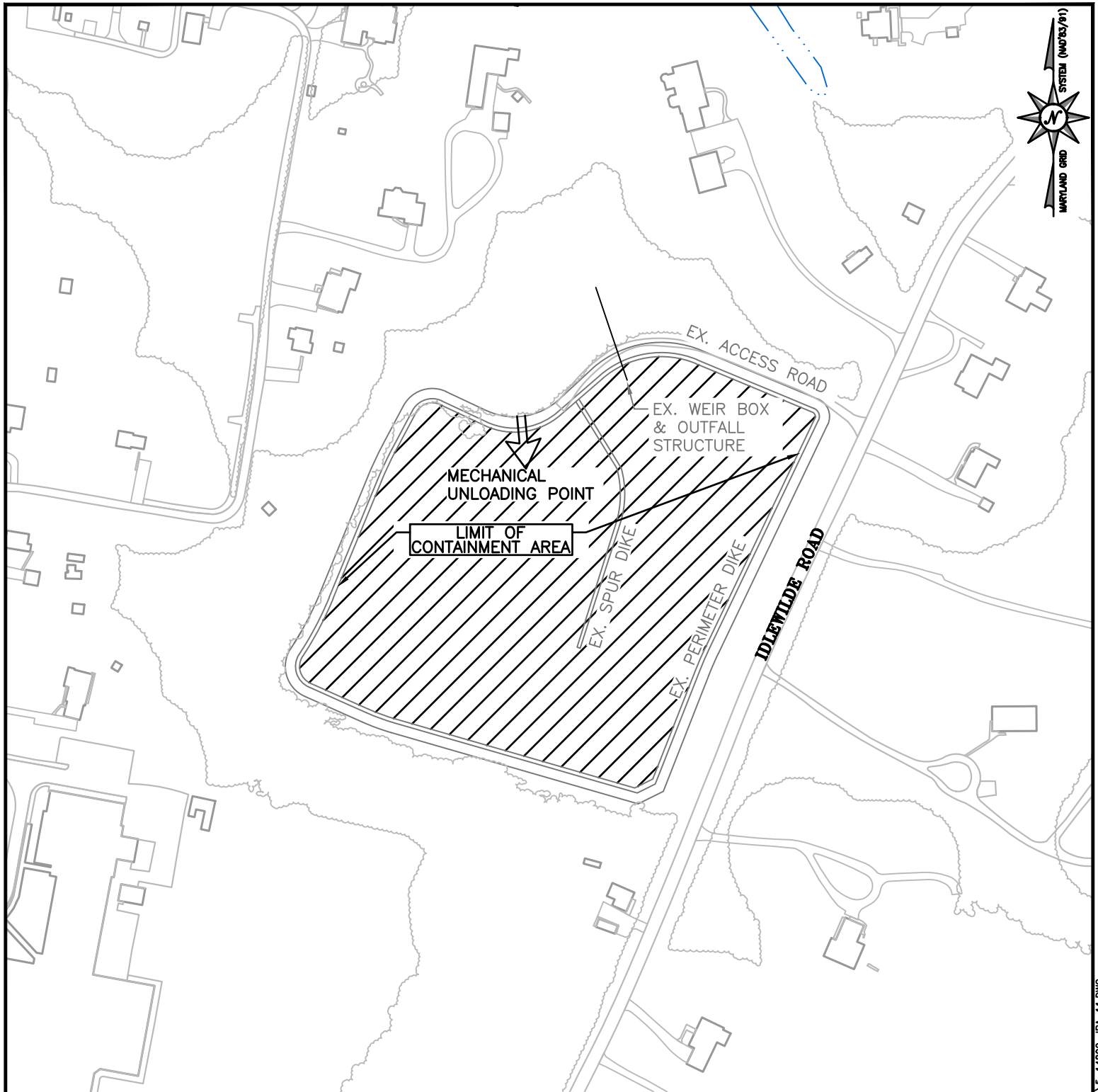

PARKER CREEK MAINTENANCE
DREDGING
AT
ANNE ARUNDEL
COUNTY

APPL. BY: ANNE ARUNDEL COUNTY DEPARTMENT OF PUBLIC WORKS

IDLEWILDE DMP SITE

DATE: JULY 2025 SHEET 9 OF 11

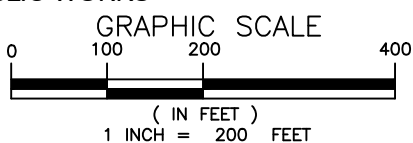

NOTE:
BASEMAP TAKEN FROM ANNE ARUNDEL COUNTY
2023 PLANIMETRICS AND 2020 IMAGERY.



Consultants & Designers, Inc.

"Integrating Engineering and Environment"

7455 New Ridge Road, Suite T Phone: (410) 694-9401
Hanover, Maryland 21076 Fax: (410) 694-9405
www.baylandinc.com



MECHANICAL
UNLOADING POINT

LIMIT OF CONTAINMENT AREA

EX. PERIMETER DIKE

EX. WEIR BOX AND
OUTFALL STRUCTURE
TO BE MAINTAINED

PARKER CREEK MAINTENANCE
DREDGING
AT
ANNE ARUNDEL
COUNTY

APPL. BY: ANNE ARUNDEL COUNTY DEPARTMENT OF PUBLIC WORKS

SOUTH COUNTY DMP SITE

DATE: JULY 2025 SHEET 10 OF 11

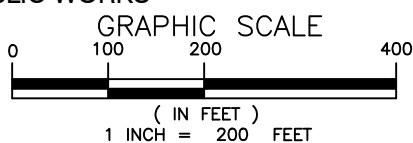

NOTE:
BASEMAP TAKEN FROM ANNE ARUNDEL COUNTY
2023 PLANIMETRICS AND 2020 IMAGERY.



Consultants & Designers, Inc.

"Integrating Engineering and Environment"

7455 New Ridge Road, Suite T Phone: (410) 694-9401
Hanover, Maryland 21076 Fax: (410) 694-9405
www.baylandinc.com

| CHANNEL DETAILS | | | | |
|--|-------------|------------|------------|----------------------|
| SEGMENT | LENGTH (FT) | WIDTH (FT) | DEPTH (FT) | VOLUME (CY) |
| A | 2,925 | 50 | -3.5 | 7,711 |
| B | 608 | 40 | -3.5 | 1,342 |
| TOTAL MAIN CHANNEL LENGTH | | | | 3,533 LF |
| TOTAL MAIN CHANNEL VOLUME | | | | 9,053 CY |
| TOTAL MAIN CHANNEL AREA OF IMPACT | | | | 233,368 SF = 5.36 AC |
| TOTAL NEW AREA OF DREDGING | | | | 0 SF = 0.0 AC |
| TOTAL MAIN CHANNEL AREA OF IMPACT TO 2019-2023 SAV | | | | 0 SF = 0.0 AC |
| TOTAL MAIN CHANNEL AREA OF IMPACT TO 2024 SAV | | | | 42,539 SF = 0.98 AC |

NOTES:

1. BASEMAP COMPILED FROM ANNE ARUNDEL COUNTY 2023 PLANIMETRICS AND 2020 IMAGERY.
2. TIDAL RANGE IS 0.97 FEET.
3. BATHYMETRY FROM BAYLAND SURVEY DATED NOVEMBER 11, 2024. COMPOSITE SAV BED FROM BAYLAND SPRING AND SUMMER SURVEYS DATED MAY 9, 2024 AND JULY 17, 2024.
4. SOUNDINGS ARE IN FEET AND REFER TO MLW.
5. THE PARKER CREEK CHANNEL PROPOSED FOR MAINTENANCE DREDGING WAS PREVIOUSLY PERMITTED UNDER MDE PERMIT 17-WL-0139 / USACE PERMIT NAB-2017-60213-M18
6. THESE ARE PERMIT DRAWINGS ONLY. DESIGN DRAWINGS WILL BE PREPARED SEPARATELY.

**PARKER CREEK MAINTENANCE
DREDGING
AT
ANNE ARUNDEL
COUNTY**

APPL. BY: ANNE ARUNDEL COUNTY DEPARTMENT OF PUBLIC WORKS

CHANNEL DETAILS

DATE: JULY 2025 SHEET 11 OF 11

