

CRISFIELD MARINE CONSTRUCTION SHORELINE APPLICATION FOR 331 BOAT HARBOR DRIVE: REPLACEMENT PIERS LOCATION MAP

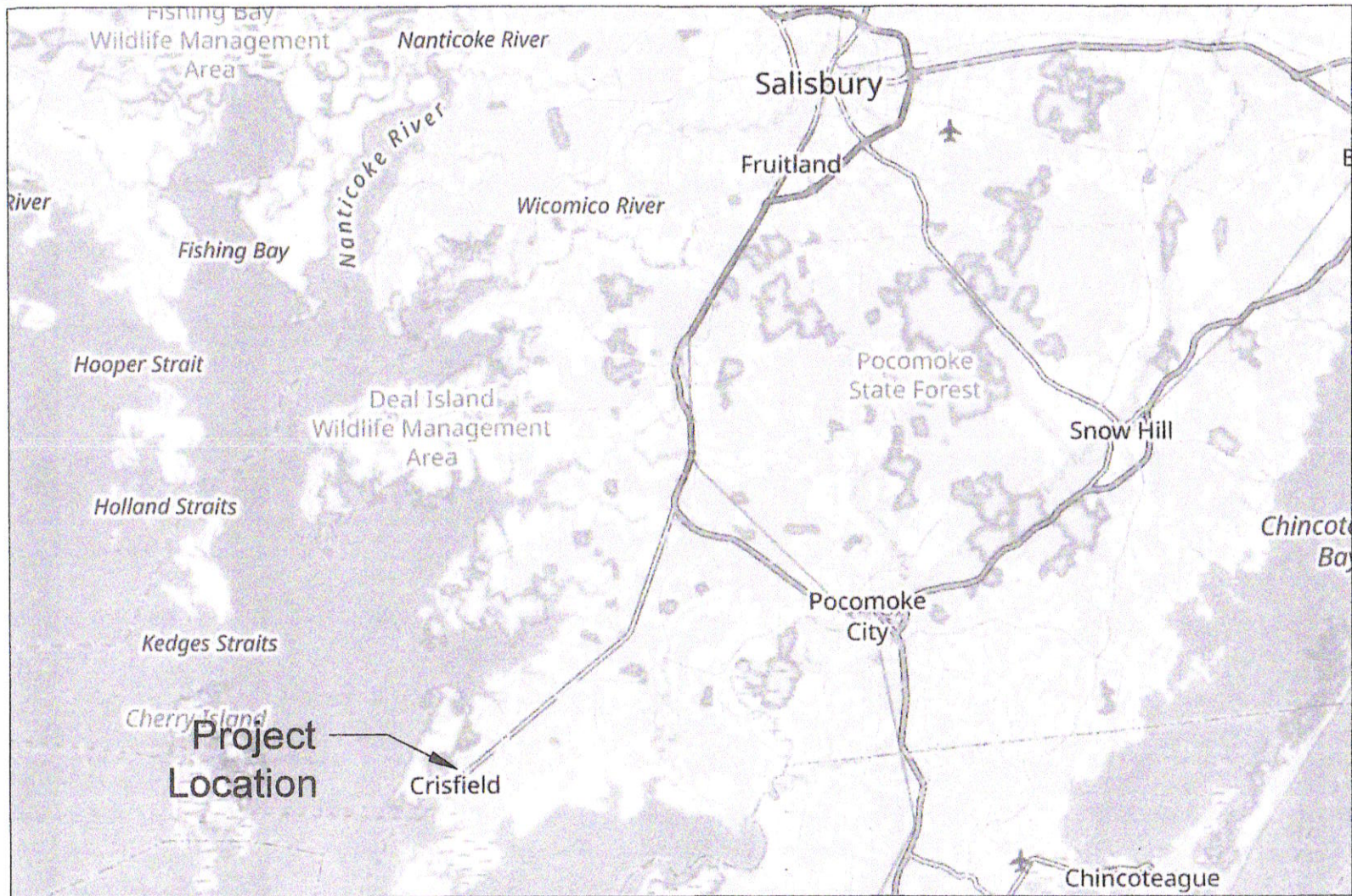

PLAN TO ACCOMPANY SHORELINE PERMIT APPLICATION FOR: APPLICANT: CRISFIELD MARINE CONSTRUCTION 331 BOAT HARBOR ROAD CRISFIELD, MD 21817 TAX MAP 072A PARCEL 0334 LOT 331		Location Map for Shoreline Permit Application: New/Replacement Piers	
		331 Boat Harbor Rd Crisfield, MD 21817	
		SMULLEN ENVIRONMENTAL SOLUTIONS	
VSS	10/2024	REV 01	LOCATION MAP, SHEET 1 OF 6

CRISFIELD MARINE CONSTRUCTION SHORELINE APPLICATION FOR 331 BOAT HARBOR DRIVE: REPLACEMENT PIERS EXISTING VICINITY CONDITIONS

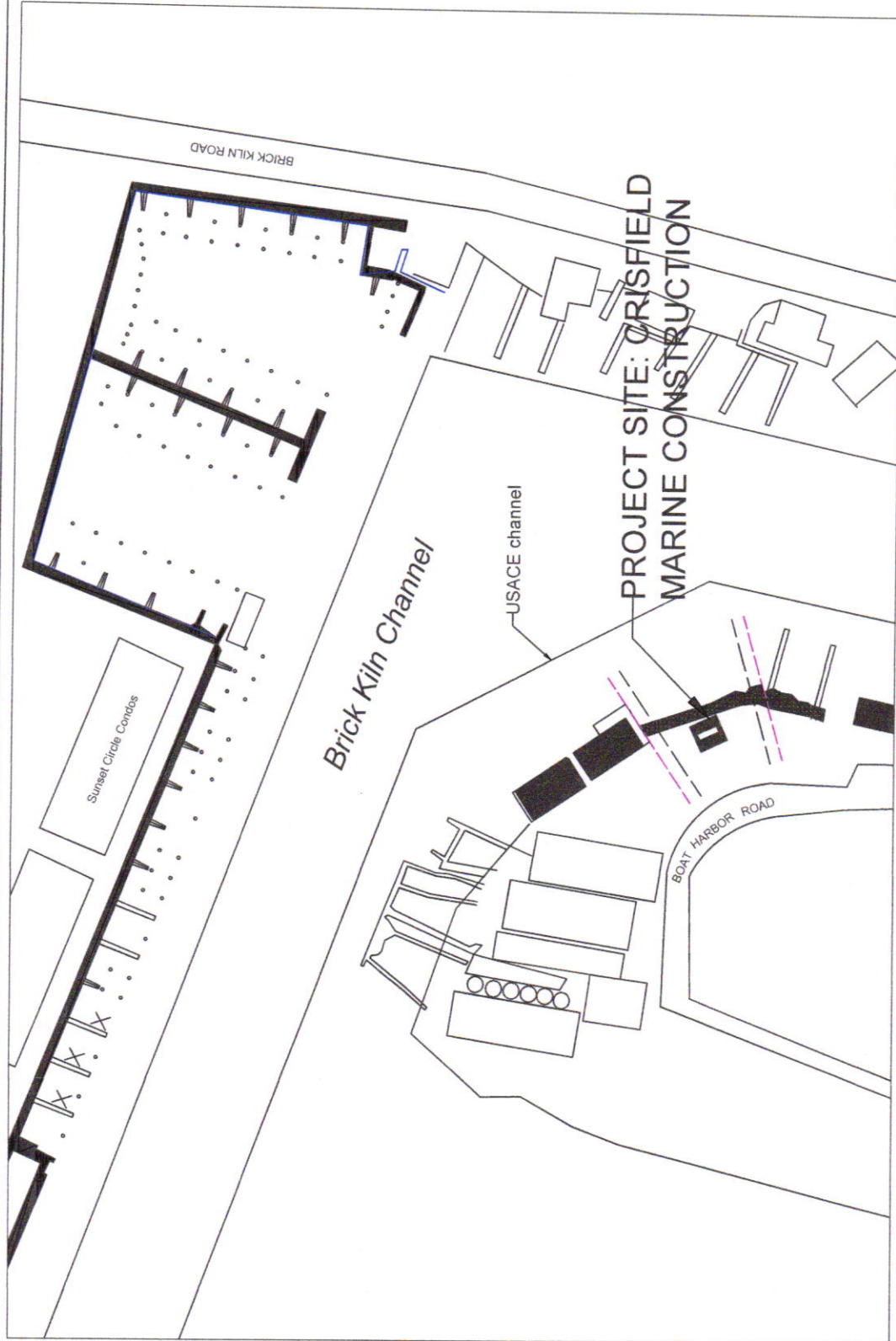

Water Depths referenced to mean low water (MLW = 0.0')

-ELEVATIONS NOT TO SCALE

NOT TO SCALE

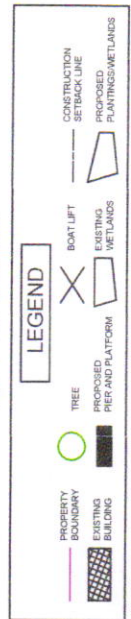

PLAN TO ACCOMPANY SHORELINE PERMIT APPLICATION FOR:
APPLICANT: CRISFIELD MARINE CONSTRUCTION
 331 BOAT HARBOR ROAD
 CRISFIELD, MD 21817
 TAX MAP 072A PARCEL 0334 LOT 331

Existing Vicinity Conditions for Shoreline Permit Application:
 New/Replacement Pier

331 Boat Harbor Rd Crisfield, MD 21817		
VSS	10/2024	REV 01
		SMULLEN ENVIRONMENTAL SOLUTIONS
		EXISTING VICINITY, SHEET 2 OF 6

CRISFIELD MARINE CONSTRUCTION SHORELINE APPLICATION FOR 331 BOAT HARBOR DRIVE: REPLACEMENT PIERS PROPOSED CONDITIONS

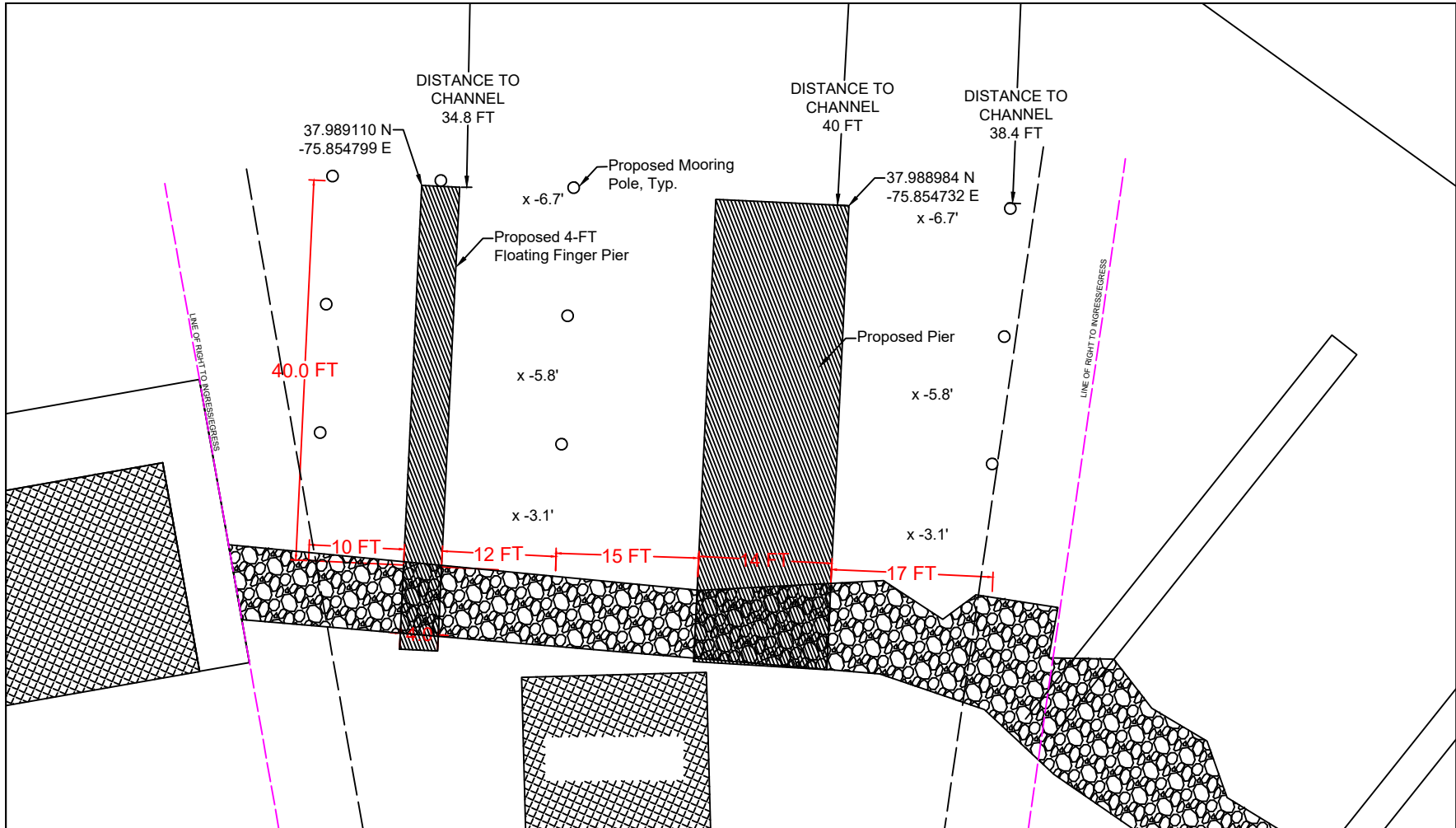

Water Depths referenced to mean low water (MLW = 0.0')

-ELEVATIONS NOT TO SCALE

NOT TO SCALE

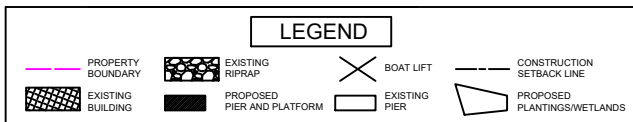

PLAN TO ACCOMPANY SHORELINE PERMIT APPLICATION FOR:
 APPLICANT: CRISFIELD MARINE CONSTRUCTION
 331 BOAT HARBOR ROAD
 CRISFIELD, MD 21817
 TAX MAP 072A PARCEL 0334 LOT 331

Proposed Conditions for Shoreline Permit Application:
New/Replacement Piers

331 Boat Harbor Rd
Crisfield, MD 21817

SMULLEN ENVIRONMENTAL SOLUTIONS

VSS	10/2024	REV 01	PROPOSED; SHEET 4 OF 6
-----	---------	--------	------------------------

CRISFIELD MARINE CONSTRUCTION SHORELINE APPLICATION FOR 331 BOAT HARBOR DRIVE: REPLACEMENT PIERS PIER CROSS-SECTION

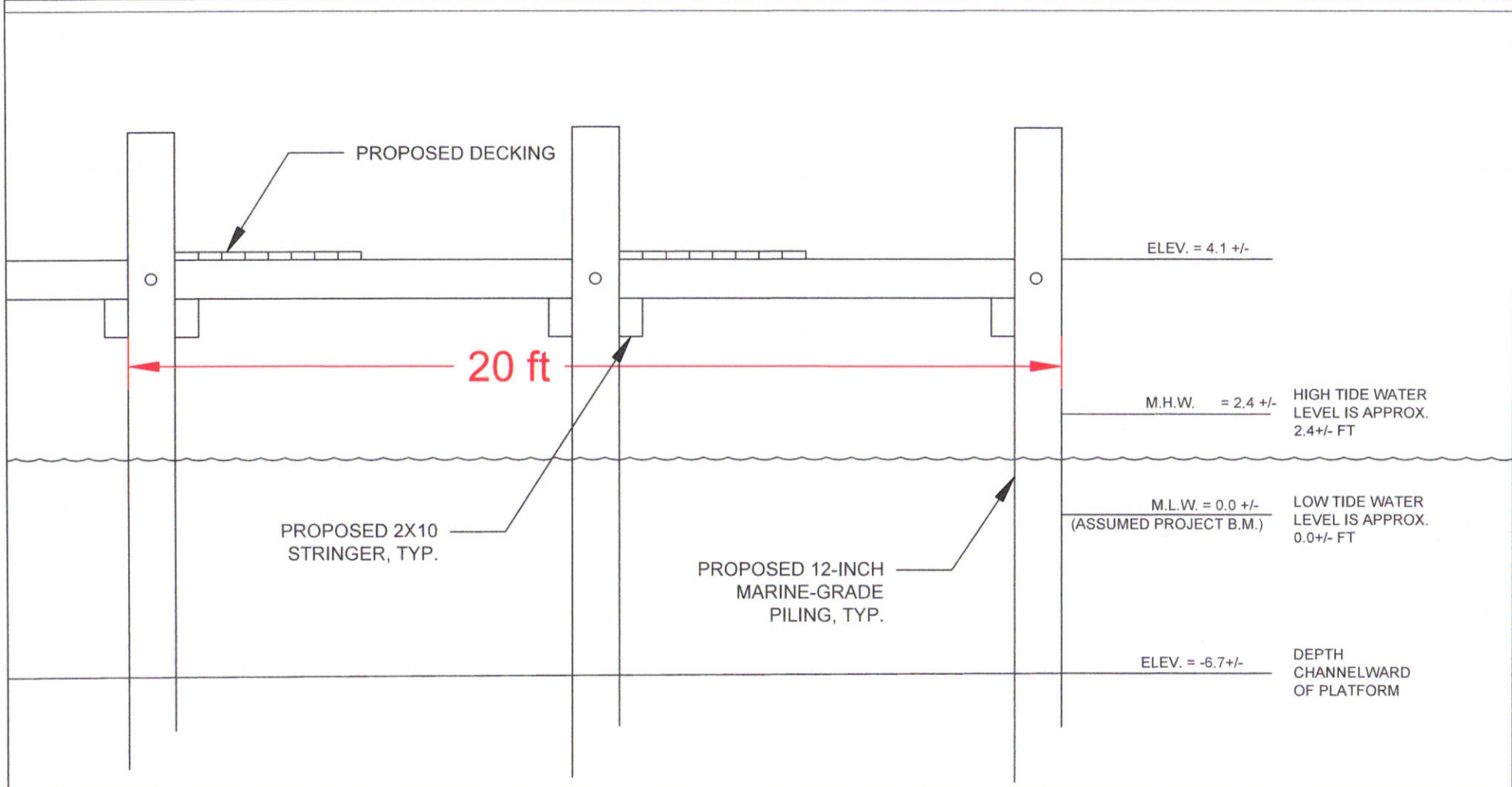

Water Depths referenced to mean low water (MLW = 0.0')

-ELEVATIONS NOT TO SCALE

NOT TO SCALE

PLAN TO ACCOMPANY SHORELINE PERMIT APPLICATION FOR: APPLICANT: CRISFIELD MARINE CONSTRUCTION 331 BOAT HARBOR ROAD CRISFIELD, MD 21817 TAX MAP 072A PARCEL 0334 LOT 331		Pier Cross-Section for Shoreline Permit Application: New/Replacement Piers	
		331 Boat Harbor Rd Crisfield, MD 21817	
		SMULLEN ENVIRONMENTAL SOLUTIONS	
VSS	10/2024	REV 01	CROSS-SECTION; SHEET 5 OF 6