

**U.S. Army Corps
Of Engineers
Baltimore District**

Public Notice

**In Reply to Application Number
CENAB-OP-RMN (CSX Transportation/Curtis Bay)
2014-61649-M02**

PN 14-60

Comment Period: November 21, 2014 – December 22, 2014

THE PURPOSE OF THIS PUBLIC NOTICE IS TO SOLICIT COMMENTS FROM THE PUBLIC ABOUT THE WORK DESCRIBED BELOW. AT THIS TIME, NO DECISION HAS BEEN MADE AS TO WHETHER OR NOT A PERMIT WILL BE ISSUED.

The Baltimore District has received an application for a Department of the Army (DA) Permit pursuant to Section 10 of the Rivers and Harbors Act of 1899 and Section 404 of the Clean Water Act as described below.

APPLICANT: CSX Transportation-Curtis Bay
c/o Mr. Randy Sheets
1910 Benhill Avenue
Baltimore, Maryland 21226

LOCATION AND WATERWAY: Curtis Bay at 1910 Benhill Avenue, Baltimore City, Maryland.

WORK: To mechanically or hydraulically dredge a total of approximately 21.4 acres at the applicant's coal and ore piers to 27, 42, and 52 feet below mean low water, and to deposit the approximately 35,000 cubic yards of dredged material at either the Maryland Port Administration's Masonville or Cox Creek Dredged Material Containment Facility.

A permit for this project, if issued, would authorize periodic maintenance dredging subject to the prior approval of the District Engineer. Prior to conducting dredging, the applicant proposes to take up to 50 bottom samples of sediment within the proposed dredge areas for material testing purposes.

The purpose of the project is to provide safe vessel access and docking at the applicant's coal and ore piers. All work is to be completed in accordance with the enclosed plans. If you have any questions concerning this matter, please contact Mr. Jon Romeo at (410) 962-6079 or at jon.romeo@usace.army.mil.

The decision whether to issue a permit will be based on an evaluation of the probable impact including cumulative impacts of the proposed activity on the public interest. That decision will reflect the national concern for both protection and utilization of important resources. The benefit which reasonably may be expected to accrue from the proposal must be balanced against its reasonably foreseeable detriments. All factors which may be relevant to the proposal will be considered including the cumulative effects thereof; among those are conservation, economics, aesthetics, general environmental concerns, wetlands, cultural values, fish and wildlife values, flood hazards, flood plain values, land use,

navigation, shoreline erosion and accretion, recreation, water supply and conservation, water quality, energy needs, safety, food and fiber production, and, in general, the needs and welfare of the people.

The Corps of Engineers is soliciting comments from the public; Federal, State, and local agencies and officials; Indian Tribes; and other interested parties in order to consider and evaluate the impacts of this proposed activity. Any comments received will be considered by the Corps of Engineers to determine whether to issue, modify, condition or deny a permit for this proposal. To make this decision, comments are used to assess impacts on endangered species, historic properties, water quality, general environmental effects, and the other public interest factors listed above. Comments are used in the preparation of an Environmental Assessment and/or an Environmental Impact Statement pursuant to the National Environmental Policy Act. Comments are also used to determine the need for a public hearing and to determine the overall public interest of the proposed activity.

Written comments concerning the work described above related to the factors listed above or other pertinent factors must be received by the District Engineer, U.S. Army Corps of Engineers, Baltimore District, [ATTN: Mr. Jon Romeo, CENAB-OP-RMN] P.O. Box 1715, Baltimore, Maryland 21203-1715, within the comment period specified above.

ESSENTIAL FISH HABITAT (EFH) ASSESSMENT: The Magnuson-Steven Fishery Conservation Act (MSFCA), as amended by the Sustainable Fisheries Act of 1996 (Public Law 104-267), requires all Federal agencies to consult with the National Marine Fisheries Service on all actions, or proposed actions, permitted, funded, or undertaken by the agency that may adversely affect EFH. The EFH designations within the Northeast Region (Maine to Virginia), dated March 1, 1999 include EFH for a number of species in various life stages. This waterway has EFH listed for juvenile and adult windowpane flounder (*Scophthalmus aquosus*), summer flounder (*Paralichthys dentatus*), and bluefish (*Pomatomus saltatrix*); egg, larva, juvenile and adult life stages of king mackerel (*Scomberomorus cavalla*), Spanish mackerel (*Scomberomorus maculatus*), cobia (*Rachycentron canadum*), and red drum (*Sciaenops ocellatus*). These are managed species under the MSFCA. A preliminary assessment indicates that the proposed work would not have a substantial adverse effect on either managed species or prey species. Therefore, no EFH conservation measures have been developed. As the evaluation of this application continues, additional information may become available which could modify this preliminary determination.

SECTION 401 WATER QUALITY CERTIFICATION: The applicant is required to obtain a Water Quality Certification, (WQC) in accordance with Section 401 of the Clean Water Act from the Maryland Department of the Environment, the Section 401 certifying agency. Any written comments concerning the work described above which relate to WQC must be received by the Maryland Department of the Environment, Tidal Wetlands Division, Attn: Mr. Robert Rushlow, 1800 Washington Boulevard, Suite 430, Baltimore, Maryland 21230-1708, within the comment period specified above to receive consideration. The MDE has a statutory limit of one year from the date of this public notice to make its decision.

COASTAL ZONE MANAGEMENT PROGRAMS: The applicant has certified in this

application that the proposed activity complies with and will be conducted in a manner consistent with the Maryland Coastal Zone Management (CZM) Program. By this public notice, we are requesting the State concurrence or objection to the applicant's consistency statement. Public comments relating to consistency must be received by the Maryland Department of the Environment, Wetlands and Waterways Program, Montgomery Park Business Center, 1800 Washington Boulevard, Suite 430, Baltimore, Maryland 21230-1708 within the comment period specified above to receive consideration. MDE has a statutory limit of 6 months to concur or object to the applicant's consistency determination.

The applicant must obtain any State or local government permits which may be required.

A preliminary review of this application indicates that the proposed work will not affect listed species or their critical habitat pursuant to Section 7 of the Endangered Species Act as amended. As the evaluation of this application continues, additional information may become available which could modify this preliminary determination.

Review of the latest published version of the National Register of Historic Places indicates that no registered properties listed as eligible for inclusion therein are located at the site of the proposed work. Currently unknown archeological, scientific, prehistoric, or historical data may be lost or destroyed by the work to be accomplished under the requested permit.

Any person who has an interest which may be adversely affected by the issuance of this permit may request a public hearing. The request, which must be in writing, must be received by the District Engineer, US Army Corps of Engineers, Baltimore District, [ATTN : Mr. Jon Romeo CENAB-OP-RMN], P.O. Box 1715, Baltimore, Maryland 21203-1715, within the comment period specified above to receive consideration. Also, the request must clearly state forth the interest which may be adversely affected by this activity and the manner in which the interest may be adversely affected.

It is requested that you communicate the foregoing information concerning the proposed work to any persons known by you to be interested and not being known to this office, who did not receive a copy of this notice.

FOR THE DISTRICT ENGINEER:

Joseph P. DaVia
Chief, Maryland Section Northern

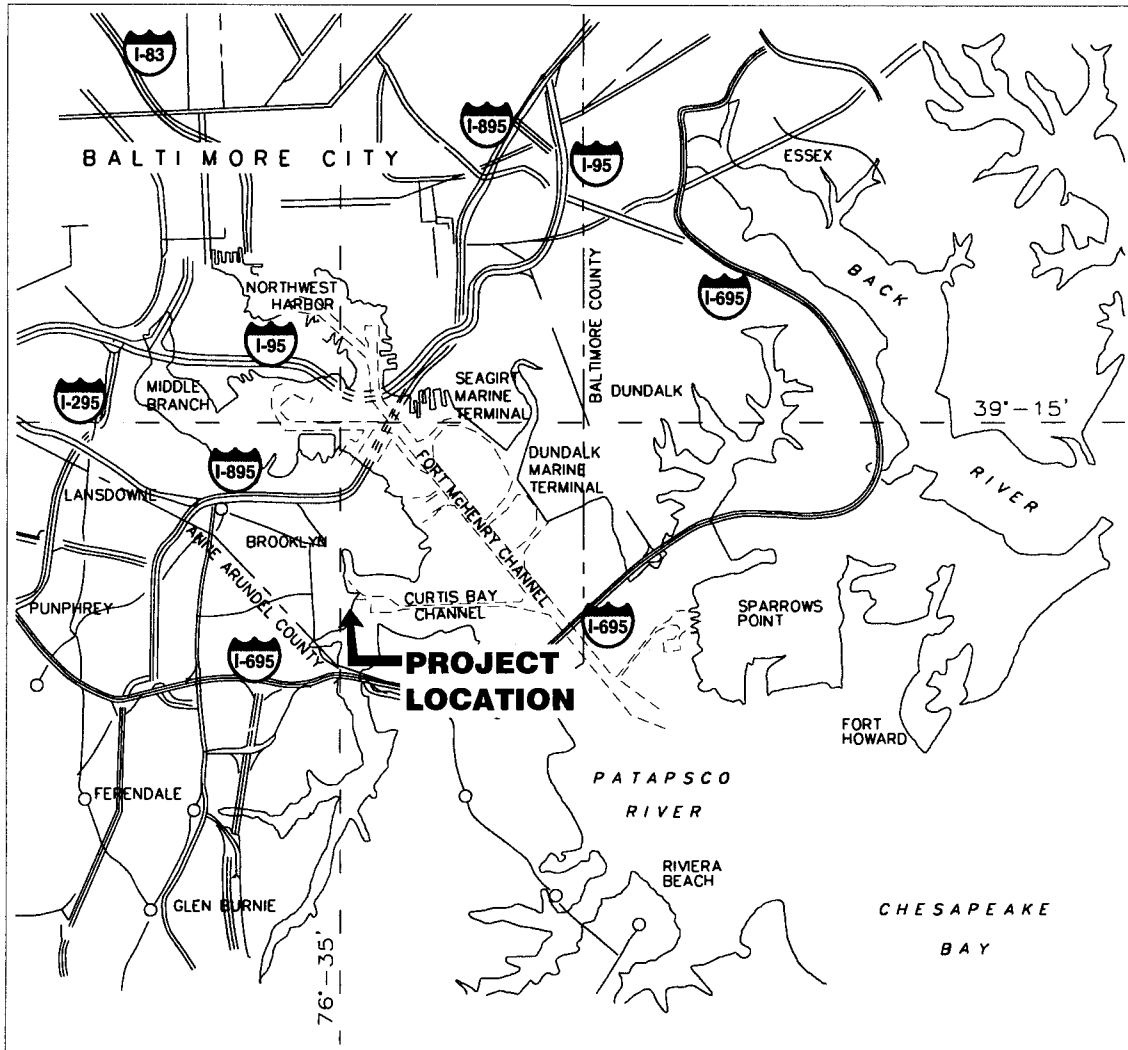

VICINITY MAP
NOT TO SCALE

APPLICATION BY:
CSX TRANSPORTATION
1910 BENHILL AVENUE
BALTIMORE, MD 21226

AGENT/ENGINEER:
 **moffatt & nichol**

**CURTIS BAY PIERS
MAINTENANCE DREDGING**

PROJECT LOCATION:
CURTIS BAY
PATAPSCO RIVER
BALTIMORE, MARYLAND

0 500' 1000'
1"=500'

DATE: OCT 10, 2014

SHEET 1 OF 10

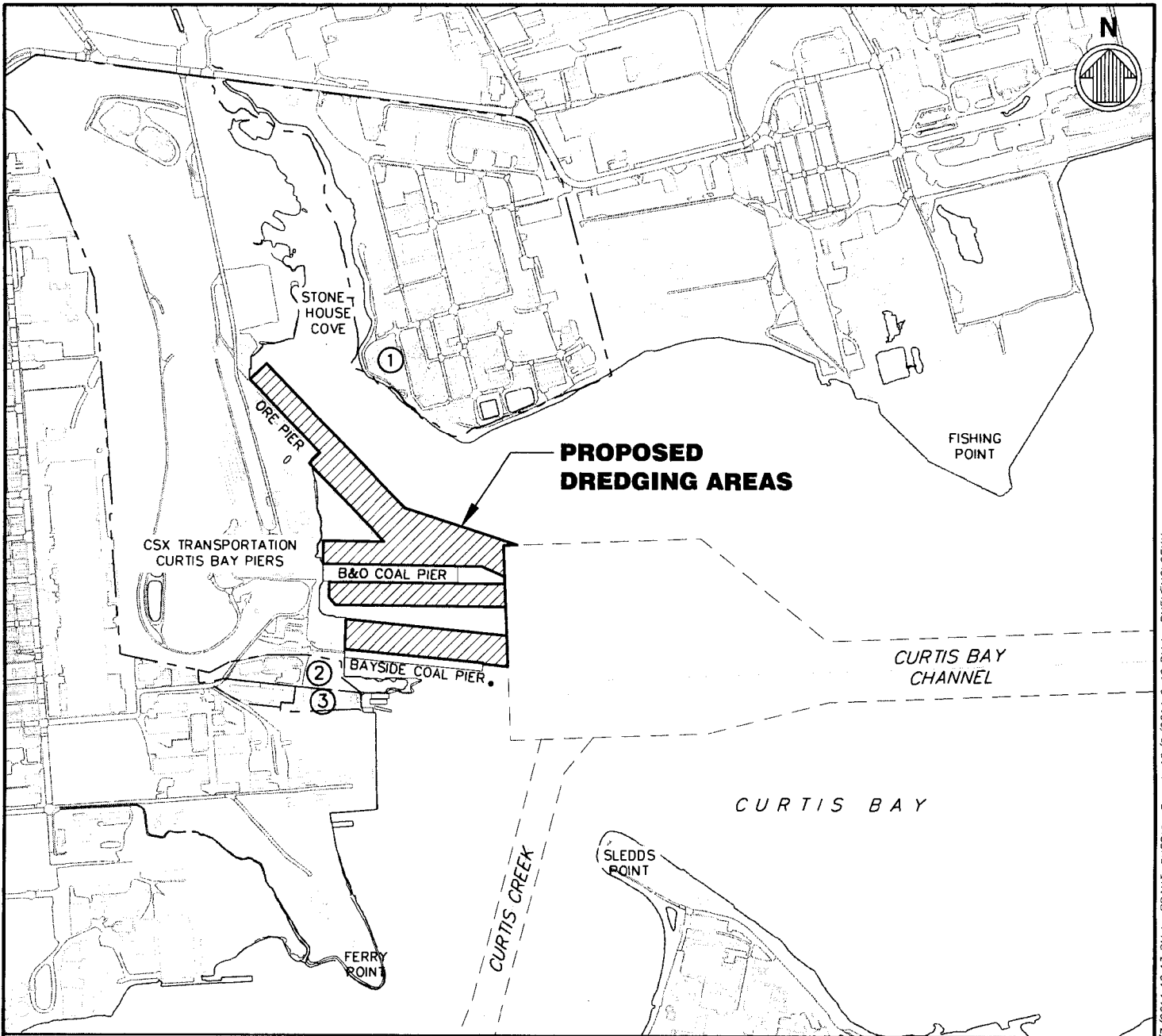

LOCATION MAP

ADJACENT PROPERTIES

- ① FOOD MACHINERY & CHEMICAL CORP.
- ② GEO SPECIALTY CHEMICALS LLC
- ③ 2000 BENHILL AVENUE LLC

APPLICATION BY:
 CSX TRANSPORTATION
 1910 BENHILL AVENUE
 BALTIMORE, MD 21226

AGENT/ENGINEER:



**CURTIS BAY PIERS
 MAINTENANCE DREDGING**

PROJECT LOCATION:
 CURTIS BAY
 PATAPSCO RIVER
 BALTIMORE, MARYLAND

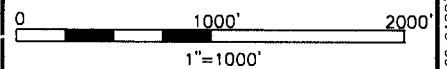

DATE: OCT 10, 2014

SHEET 2 OF 10

File: P:\8622 CSX\500 CAD\ACTIVE\862200C-P002; Plotted: 10/7/2014 12:13 PM by BRANT, CHERYL; Saved: 10/6/2014 6:42 PM by PNE\ENGLOSKY

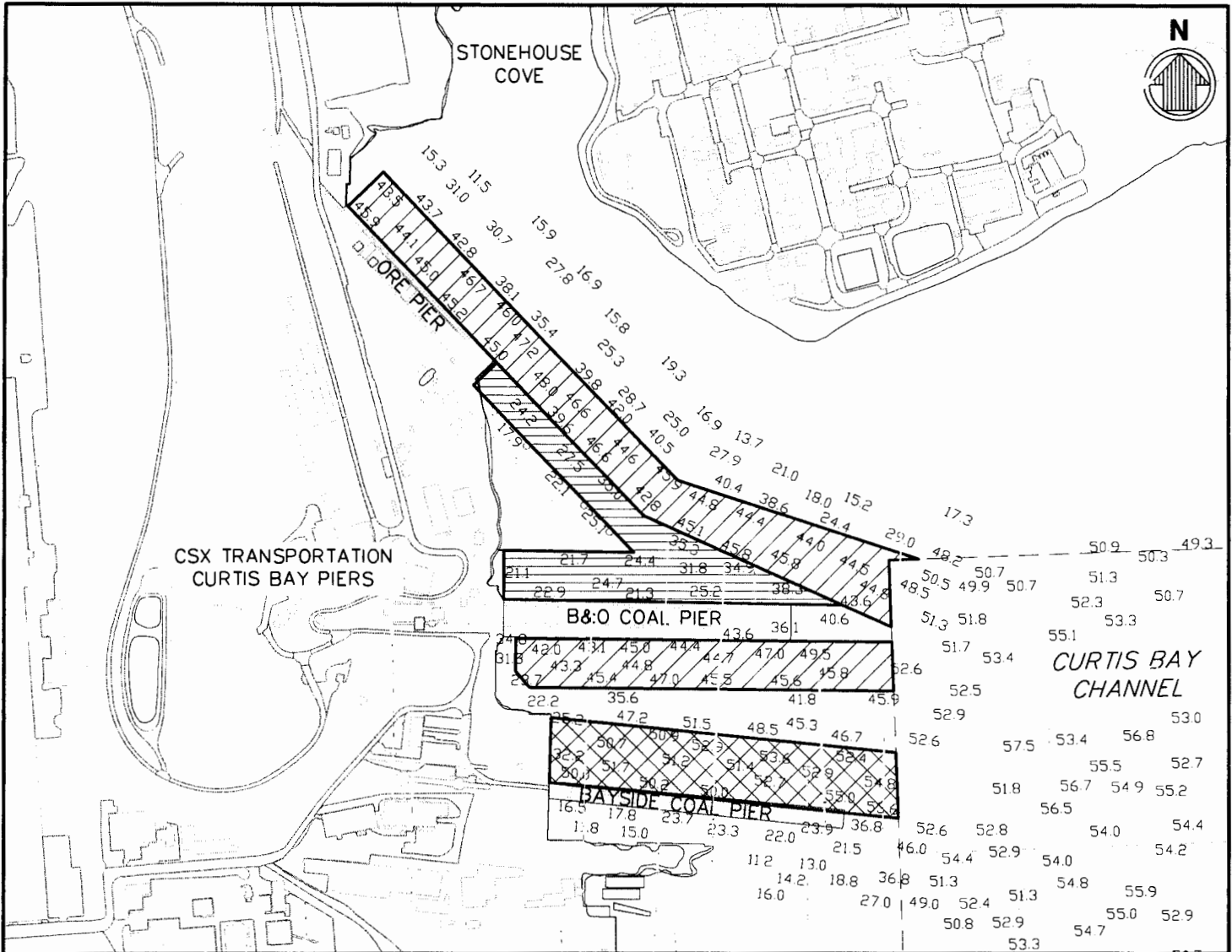

DREDGING PLAN

NOTES

1. MECHANICALLY OR HYDRAULICALLY MAINTENANCE DREDGE APPROXIMATELY 35,000 CY IN THE AREAS SHOWN (21.4 TOTAL ACRES) TO DEPTHS VARYING FROM -27 TO -52 FEET AT MEAN LOW WATER AND DEPOSIT THE MATERIAL AT THE MASONVILLE OR COX CREEK DISPOSAL SITE.
2. PERFORM UP TO 50 OFFSHORE SOIL BORINGS WITHIN THE DREDGING AREAS (ACCESS CHANNELS, BERTHING AREAS, AND SIDE SLOPES) AS NEEDED TO CHARACTERIZE THE MATERIAL.
3. PERFORM UP TO 50 OFFSHORE SOIL BORINGS WITHIN 200 FEET OF THE EXISTING PIERS OR WITHIN THE DREDGING AREAS FOR GEOTECHNICAL INVESTIGATIONS.
4. FOR TYPICAL BORING PROCEDURES, SEE SHEET 7.

DREDGING DEPTH LEGEND (MLW)

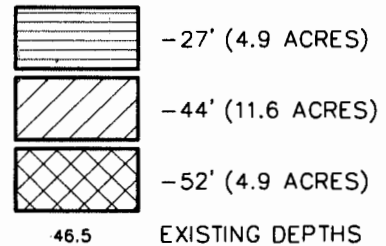

DATUM

MEAN LOW WATER (MLW) = 0.0
SOUNDINGS IN FEET

APPLICATION BY:
CSX TRANSPORTATION
1910 BENHILL AVENUE
BALTIMORE, MD 21226

AGENT/ENGINEER:



**CURTIS BAY PIERS
MAINTENANCE DREDGING**

PROJECT LOCATION:
CURTIS BAY
PATAPSCO RIVER
BALTIMORE, MARYLAND

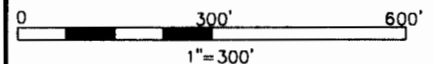

DATE: OCT 10, 2014

SHEET 3 OF 10

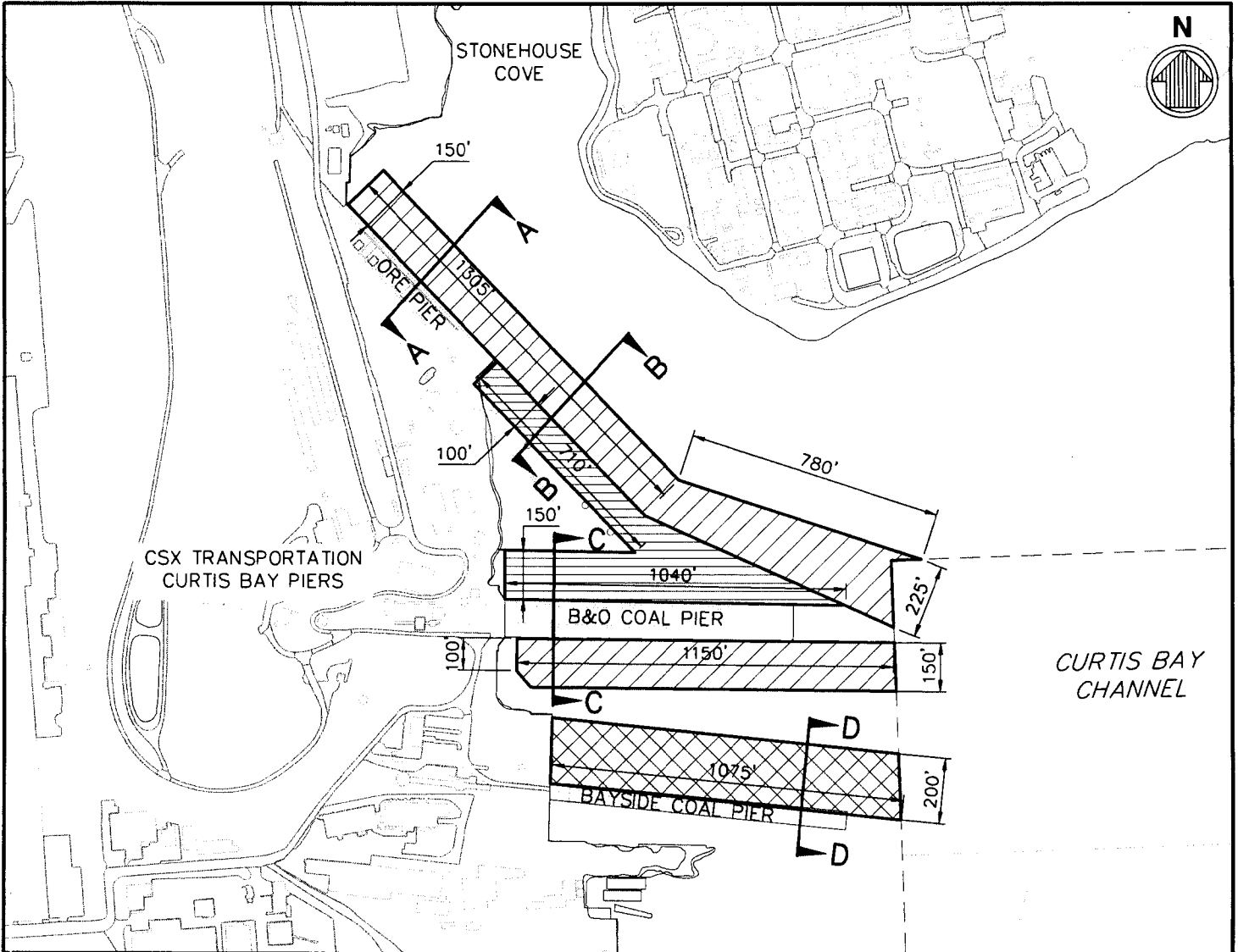

DREDGING SECTIONS

NOTES

1. FOR SECTIONS, SEE SHEETS 5 & 6.
2. FOR EXISTING WATER DEPTHS, SEE SHEET 3.

DREDGING DEPTH LEGEND (MLW)

	-27'
	-44'
	-52'

DATUM

MEAN LOW WATER (MLW) = 0.0
SOUNDINGS IN FEET

APPLICATION BY:
CSX TRANSPORTATION
1910 BENHILL AVENUE
BALTIMORE, MD 21226

AGENT/ENGINEER:



CURTIS BAY PIERS MAINTENANCE DREDGING

PROJECT LOCATION:
CURTIS BAY
PATAPSCO RIVER
BALTIMORE, MARYLAND

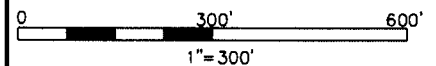

DATE: OCT 10, 2014

SHEET 4 OF 10

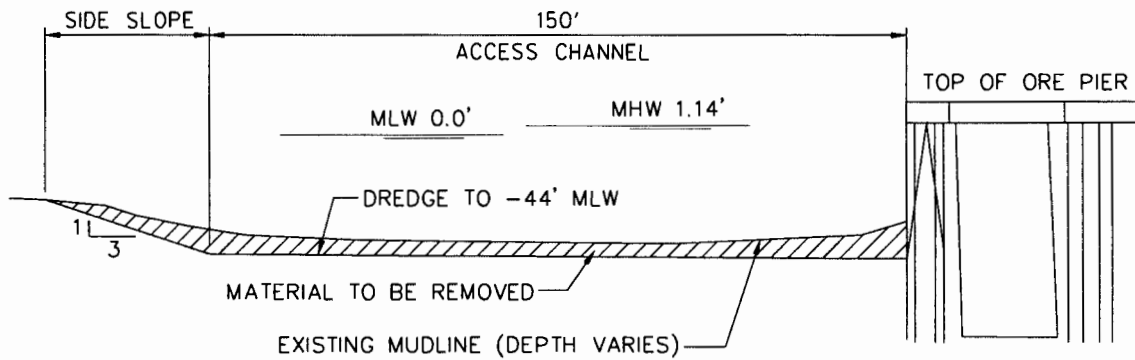

TYPICAL SECTION A-A
NOT TO SCALE

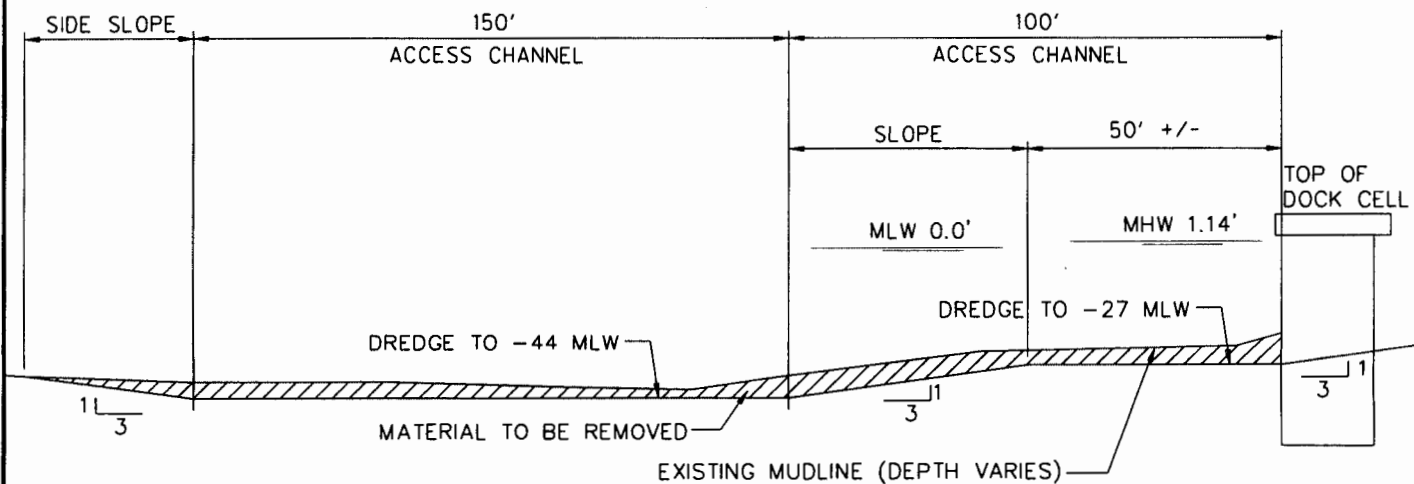

TYPICAL SECTION B-B
NOT TO SCALE

APPLICATION BY:
CSX TRANSPORTATION
1910 BENHILL AVENUE
BALTIMORE, MD 21226

AGENT/ENGINEER:



**CURTIS BAY PIERS
MAINTENANCE DREDGING**

PROJECT LOCATION:
CURTIS BAY
PATAPSCO RIVER
BALTIMORE, MARYLAND

DATE: OCT 10, 2014

SHEET 5 OF 10

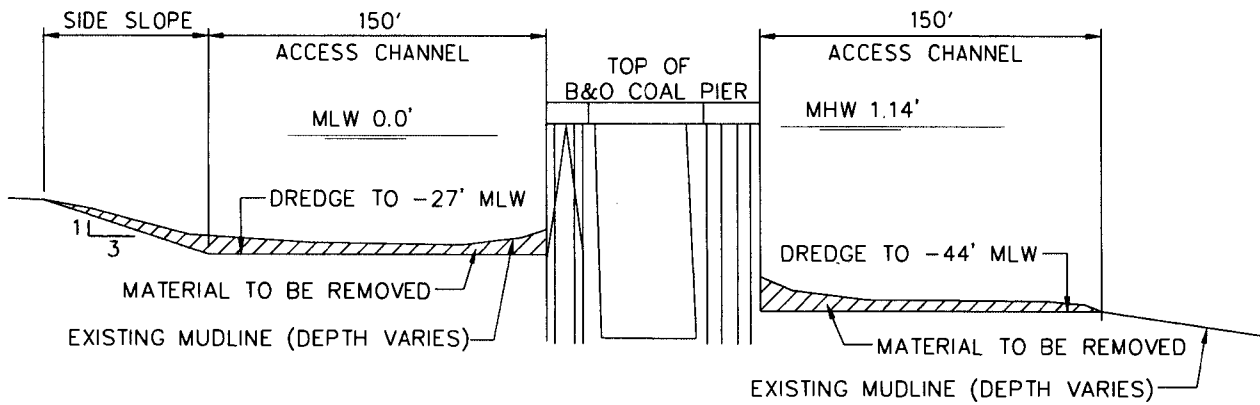

TYPICAL SECTION C-C
NOT TO SCALE

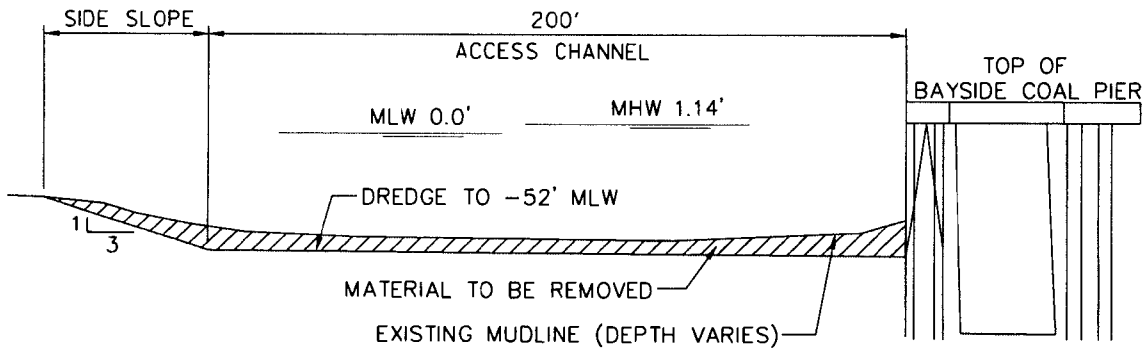

TYPICAL SECTION D-D
NOT TO SCALE

APPLICATION BY:
CSX TRANSPORTATION
1910 BENHILL AVENUE
BALTIMORE, MD 21226

AGENT/ENGINEER:



**CURTIS BAY PIERS
MAINTENANCE DREDGING**

PROJECT LOCATION:
CURTIS BAY
PATAPSCO RIVER
BALTIMORE, MARYLAND

DATE: OCT 10, 2014

SHEET 6 OF 10

TYPICAL BORING PROCEDURES

1. CONSTRUCTION ACCESS TO BORING SITES WILL BE BY WATER.
2. DRILLING SHALL BE ACCOMPLISHED USING HOLLOW STEM AUGERS.
3. DRILLING DEPTH SHALL VARY BASED ON LOCATION AND PURPOSE OF INVESTIGATION.
4. TESTING MAY INCLUDE PHYSICAL AND CHEMICAL SOIL CHARACTERIZATION, STANDARD PENETRATION TESTS TO EVALUATE SOIL STRENGTH, UNDISTURBED 3-INCH DIAMETER SHELBY TUBES SAMPLES FOR SOIL CLASSIFICATION, AND IN-SITU VANE SHEAR TESTS.
5. SOIL SAMPLES COLLECTED FOR LABORATORY ANALYSIS SHALL BE DISPOSED OF PROPERLY PER STANDARD LABORATORY PROCEDURES.

APPLICATION BY:
CSX TRANSPORTATION
1910 BENHILL AVENUE
BALTIMORE, MD 21226

AGENT/ENGINEER:



moffatt & nichol

**CURTIS BAY PIERS
MAINTENANCE DREDGING**

PROJECT LOCATION:
CURTIS BAY
PATAPSCO RIVER
BALTIMORE, MARYLAND

DATE: OCT 10, 2014

SHEET 7 OF 10

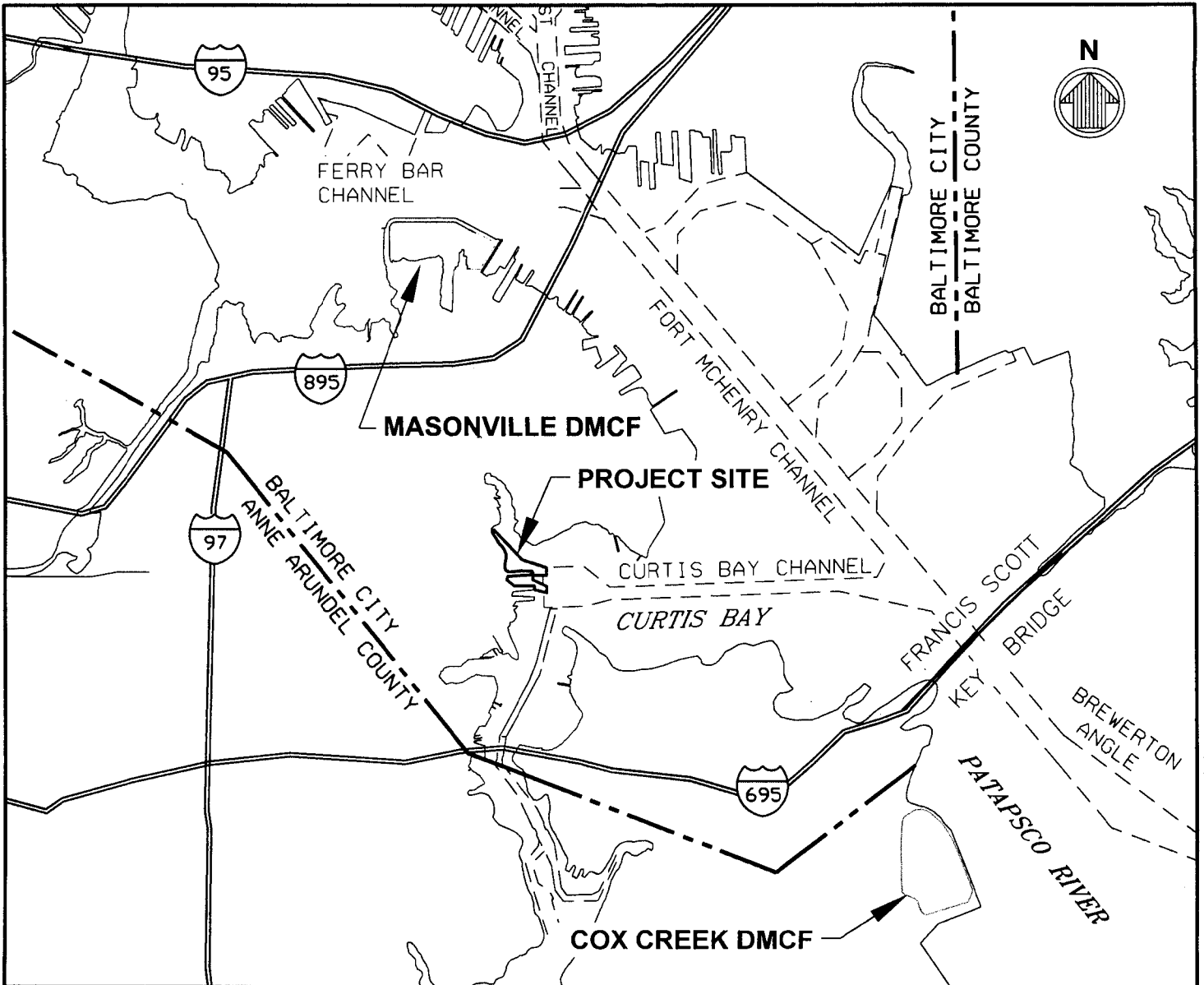

DISPOSAL SITE LOCATION MAP

APPLICATION BY:
 CSX TRANSPORTATION
 1910 BENHILL AVENUE
 BALTIMORE, MD 21226

AGENT/ENGINEER:



**CURTIS BAY PIERS
 MAINTENANCE DREDGING**

PROJECT LOCATION:
 CURTIS BAY
 PATAPSCO RIVER
 BALTIMORE, MARYLAND

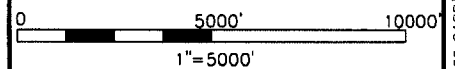

DATE: OCT 10, 2014

SHEET 8 OF 10

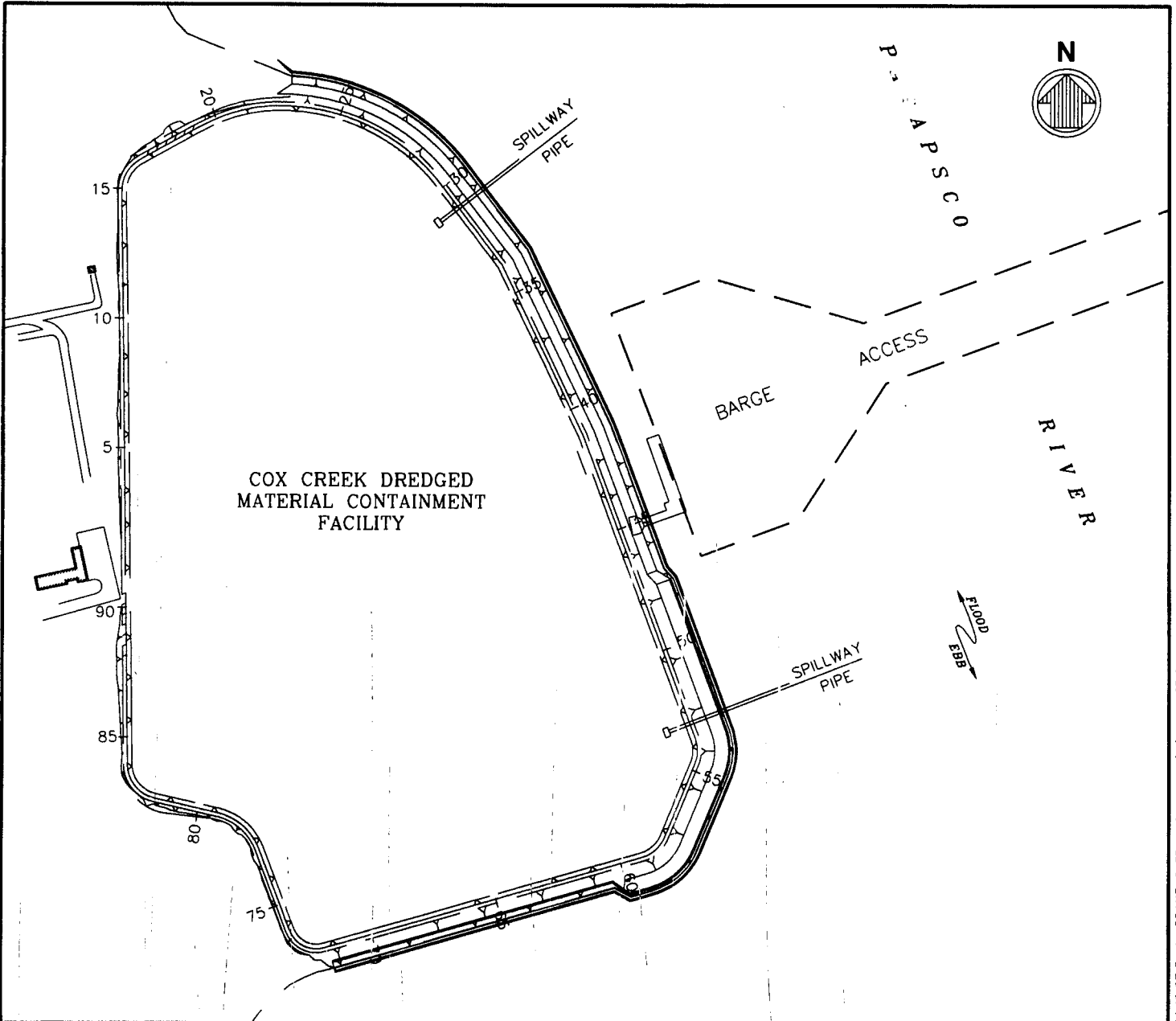

COX CREEK DREDGED MATERIAL CONTAINMENT FACILITY

NOTES

COX CREEK DMCF CAPACITY = 6.0 MCY
 COX CREEK AREA = 116 ACRES

APPLICATION BY:
 CSX TRANSPORTATION
 1910 BENHILL AVENUE
 BALTIMORE, MD 21226

AGENT/ENGINEER:



**CURTIS BAY PIERS
 MAINTENANCE DREDGING**

PROJECT LOCATION:
 CURTIS BAY
 PATAPSCO RIVER
 BALTIMORE, MARYLAND

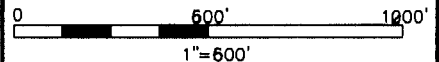

DATE: OCT 10, 2014

SHEET 9 OF 10

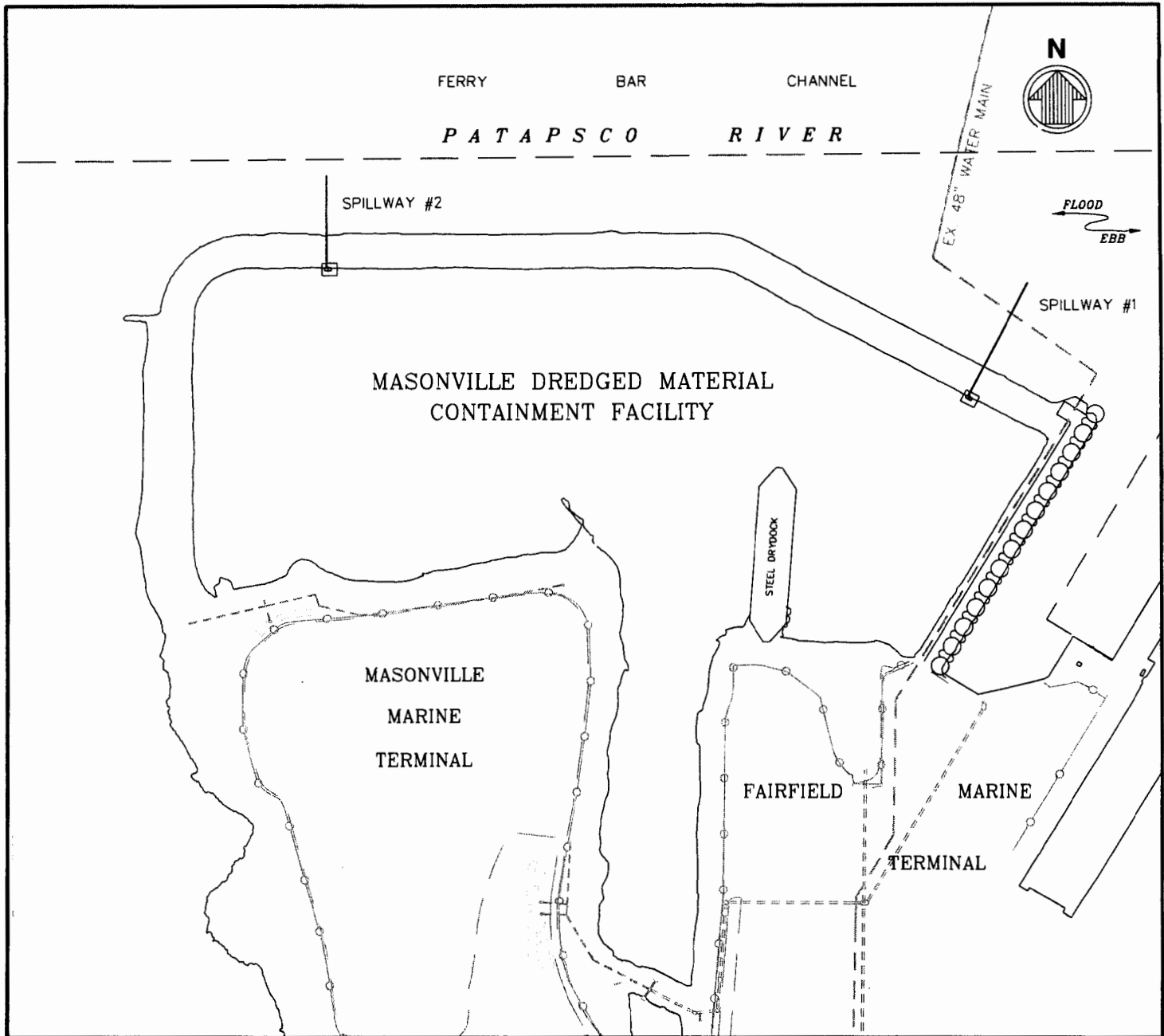

MASONVILLE DREDGED MATERIAL CONTAINMENT FACILITY

NOTES

MASONVILLE DCMF CAPACITY = 14.0 MCY
 MASONVILLE AREA = 96 ACRES

APPLICATION BY:
 CSX TRANSPORTATION
 1910 BENHILL AVENUE
 BALTIMORE, MD 21226

AGENT/ENGINEER:
 **moffatt & nichol**

**CURTIS BAY PIERS
 MAINTENANCE DREDGING**

PROJECT LOCATION:
 CURTIS BAY
 PATAPSCO RIVER
 BALTIMORE, MARYLAND

0 600' 1200'

1"=600'

DATE: OCT 10, 2014

SHEET 10 OF 10

File: P:\8622 CSX\500 CA00\ACTIVE\862200C-P010. Plotted: 10/7/2014 12:27 PM by BRANT, CHERYL. Saved: 10/6/2014 6:38 PM by PNEVENGLOSKY