

U.S. Army Corps  
Of Engineers  
Baltimore District

# Public Notice

In Reply to Application Number  
CENAB-OP-RMN (Ho DPW/Dorsey Run Road  
Extended) 2003-61775-M02

PN 14-11

Comment Period: February 4, 2014 – March 6, 2014

---

THE PURPOSE OF THIS PUBLIC NOTICE IS TO SOLICIT COMMENTS FROM THE PUBLIC ABOUT THE WORK DESCRIBED BELOW. AT THIS TIME, NO DECISION HAS BEEN MADE AS TO WHETHER OR NOT A PERMIT WILL BE ISSUED.

The Baltimore District has received an application for a Department of the Army Permit pursuant to Section 404 of the Clean Water Act (33 U.S.C. 1344), as described below:

**APPLICANT:** Howard County Department of Public Works  
ATTN: Mr. Tom Wilkins, P.E.  
9250 Bendix Road  
Columbia, Maryland 20145

**LOCATION AND WATERWAY:** Deep Run, unnamed tributaries, and adjacent wetlands, at Dorsey Run Road, Howard County, Maryland.

**WORK:** To discharge fill material into waters of the United States, including jurisdictional wetlands permanently impacting 18,545 square feet of nontidal wetlands and 278 linear feet (5,046 square feet) of stream associated with construction of Dorsey Run Road extended from station 544+77.91 to station 594+85.00. All work would be completed in accordance with the attached plans.

The Corps previously authorized this project on February 20, 2007, authorizing construction of Dorsey Run Road Extended under the Department of the Army (DA) Maryland State Programmatic General Permit-3 (MDSPGP-3), but the work has not started. The DA MDSPGP-3 authorization for the project expired on December 31, 2013. Therefore, authorization under a DA standard permit is now required for the project.

The applicant has proposed to avoid certain wetland and stream impacts by construction of a 60-foot bottomless concrete arch culvert from station 565+01.67 to station 565+94.35.

As mitigation for the wetlands impacts for this project, the applicant has paid into the State of Maryland wetland compensation fund. Further, as mitigation for the permanent stream impacts, the applicant completed a stream restoration project in a tributary to Deep Run, near Hi-Tech Drive, Howard County, Maryland.

The purpose of the project is to extend existing Dorsey Run Road.

If you have any questions concerning this matter, please contact Mr. Jon Romeo at (410) 962-6079 or [jon.romeo@usace.army.mil](mailto:jon.romeo@usace.army.mil).

The decision whether to issue a permit will be based on an evaluation of the probable impact including cumulative impacts of the proposed activity on the public interest. That decision will reflect the national concern for both protection and utilization of important resources. The benefit which reasonably may be expected to accrue from the proposal must be balanced against its reasonably foreseeable detriments. All factors which may be relevant to the proposal will be considered including the cumulative effects thereof; among those are conservation, economics, aesthetics, general environmental concerns, wetlands, cultural values, fish and wildlife values, flood hazards, flood plain values, land use, navigation, shoreline erosion and accretion, recreation, water supply and conservation, water quality, energy needs, safety, food and fiber production, and, in general, the needs and welfare of the people.

The evaluation of the impact of the work described above on the public interest will include application of the Clean Water Act Section 404(b)(1) Guidelines promulgated by the Administrator, U.S. Environmental Protection Agency, under authority of Section 404 of the Clean Water Act.

The Corps of Engineers is soliciting comments from the public; Federal, State, and local agencies and officials; Indian Tribes; and other interested parties in order to consider and evaluate the impacts of this proposed activity. Any comments received will be considered by the Corps of Engineers to determine whether to issue, modify, condition or deny a permit for this proposal. To make this decision, comments are used to assess impacts on endangered species, historic properties, water quality, general environmental effects, and the other public interest factors listed above. Comments are used in the preparation of an Environmental Assessment and/or an Environmental Impact Statement pursuant to the National Environmental Policy Act. Comments are also used to determine the need for a public hearing and to determine the overall public interest of the proposed activity.

Written comments concerning the work described above related to the factors listed above or other pertinent factors must be received by the District Engineer, U.S. Army Corps of Engineers, Baltimore District, , [Attn: Mr. Jon Romeo, CENAB-OP-RMN] P.O. Box 1715, Baltimore, Maryland 21203-1715, within the comment period specified above.

**SECTION 401 Water Quality Certification:** The Maryland Department of the Environment issued Section 401 Water Quality Certification (WQC) on September 14, 2011. The WQC expires on September 30, 2015.

The applicant must obtain any State or local government permits, which may be required.

A preliminary review of this application indicates that the proposed work will not affect listed species or their critical habitat pursuant to Section 7 of the Endangered Species Act as amended. As the evaluation of this application continues, additional information

may become available which could modify this preliminary determination.

Review of the latest published version of the National Register of Historic Places indicates that no registered properties listed as eligible for inclusion therein are located at the site of the proposed work. Currently unknown archeological, scientific, prehistoric, or historical data may be lost or destroyed by the work to be accomplished under the requested permit.

Any person who has an interest that may be adversely affected by the issuance of this permit may request a public hearing. The request, which must be in writing, must be received by the District Engineer, US Army Corps of Engineers, Baltimore District, [Attn: Mr. Jon Romeo, CENAB-OP-RMN], PO Box 1715, Baltimore, Maryland 21203-1715, within the comment period specified as above to receive consideration. Also, the request must clearly state forth the interest which may be adversely affected by this activity and the manner in which the interest may be adversely affected.

It is requested that you communicate the foregoing information concerning the proposed work to any persons known by you to be interested and not being known to this office, who did not receive a copy of this notice.



FOR THE DISTRICT ENGINEER:

Joseph P. DaVia  
Chief, Maryland Section Northern

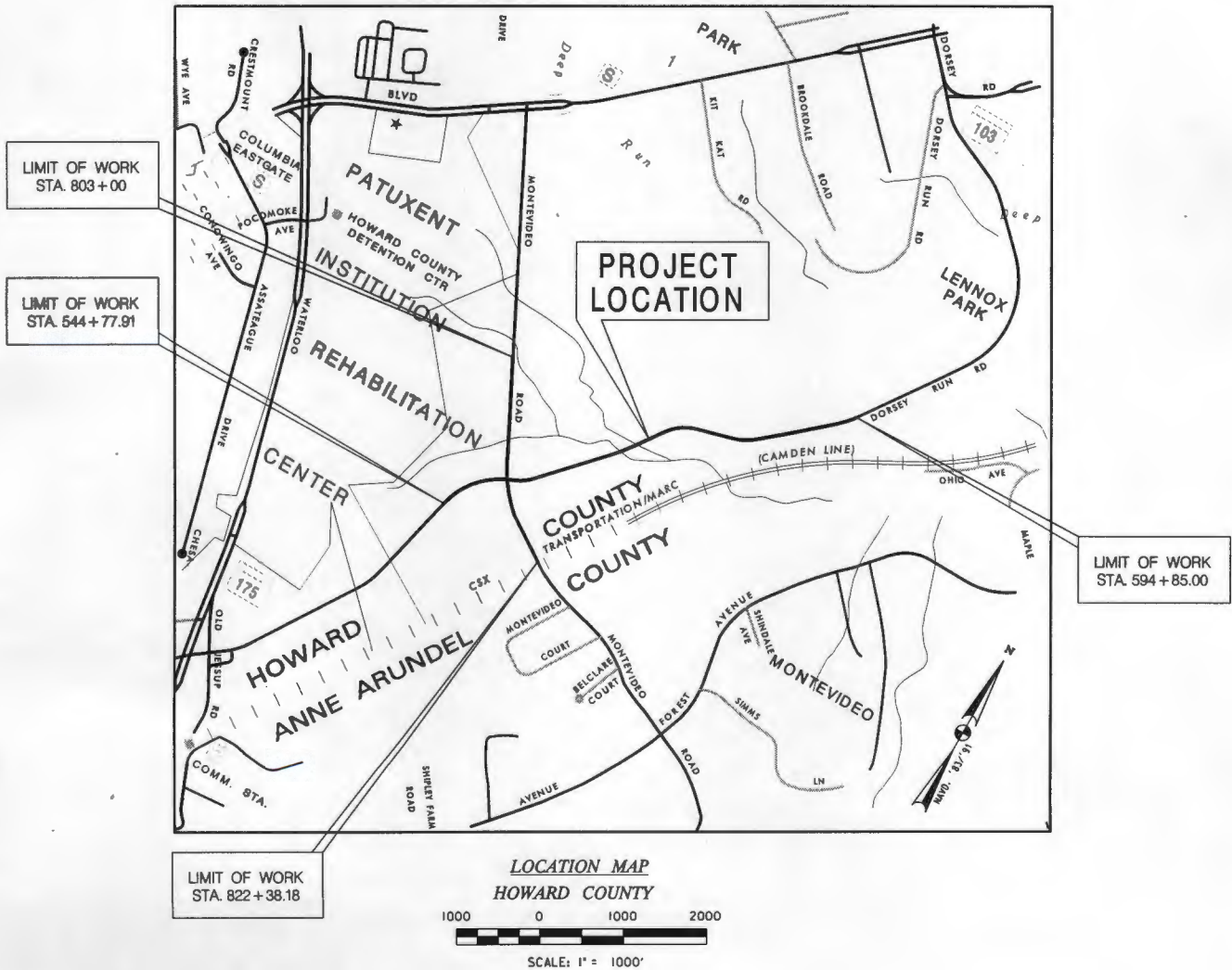
# DORSEY RUN EXTENSION MONTEVIDEO ROAD TO STATION 594+85.00

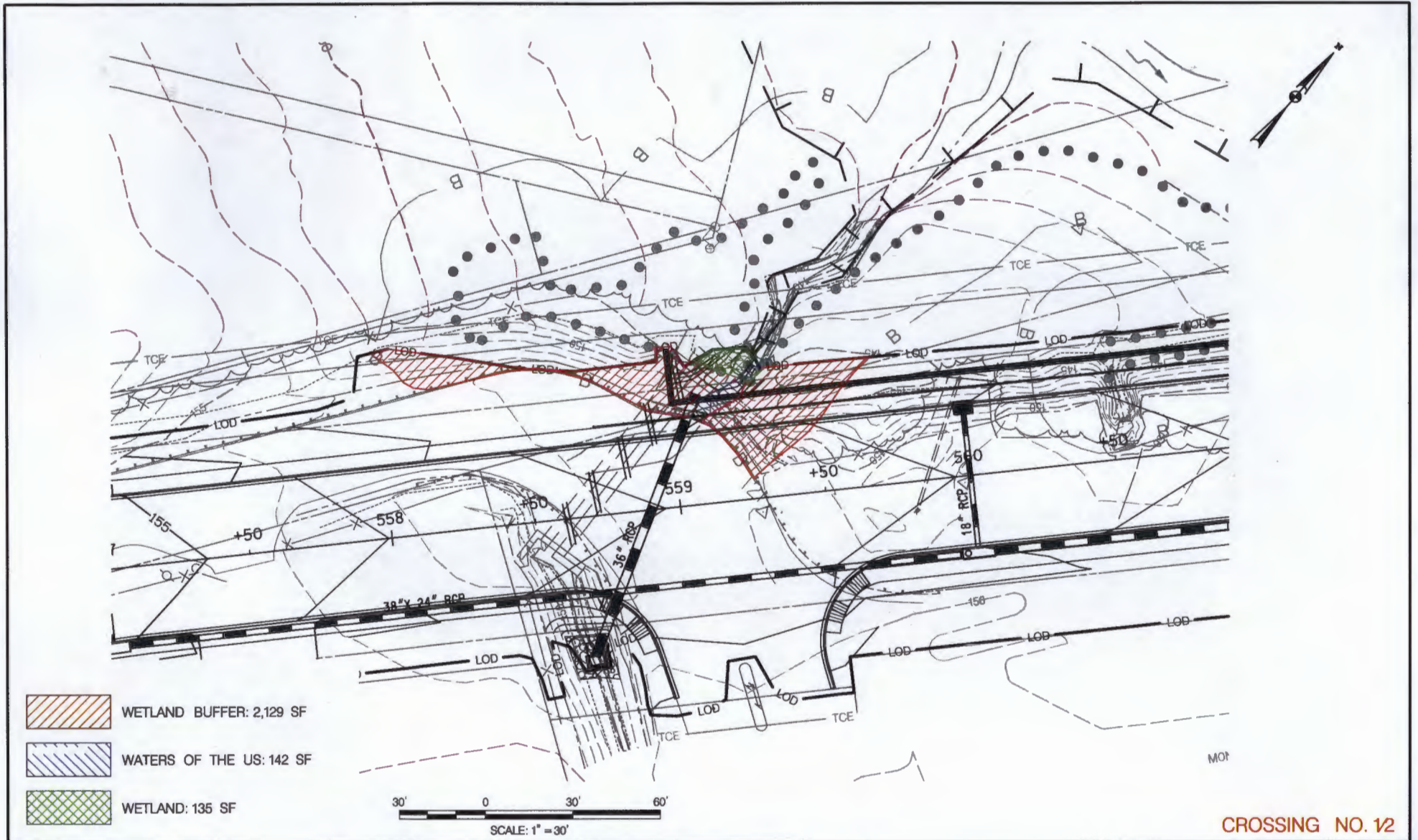



-  WETLAND BUFFER: 2,129 SF
-  WATERS OF THE US: 142 SF
-  WETLAND: 135 SF

**CROSSING NO. 12**

DEPARTMENT OF PUBLIC WORKS  
HOWARD COUNTY, MARYLAND

DIRECTOR OF PUBLIC WORKS \_\_\_\_\_ DATE \_\_\_\_\_  
 GROUP, BUREAU OF ENGINEERING DATE \_\_\_\_\_

GROUP, DIVISION OF TRANSPORTATION DATE \_\_\_\_\_  
 AND SPECIAL PROJECTS DATE \_\_\_\_\_



DES: CMB			
DWG: CDF			
CHE: DTH			
DATE: 8/18	BY NO.	REVISION	DATE

GRAPHIC EXHIBIT

SCALE: MAP NO. \_\_\_\_\_ BLOCK NO. \_\_\_\_\_

**DORSEY RUN ROAD EXTENSION**  
**MONTEVIDEO ROAD TO**  
**STATION 591+42.16**  
 ELECTION DISTRICT NO. 1 - JESSUP, MARYLAND  
 CAPITAL PROJECT J-4148-B

SCALE \_\_\_\_\_  
 SHEET \_\_\_\_\_  
 OF 29

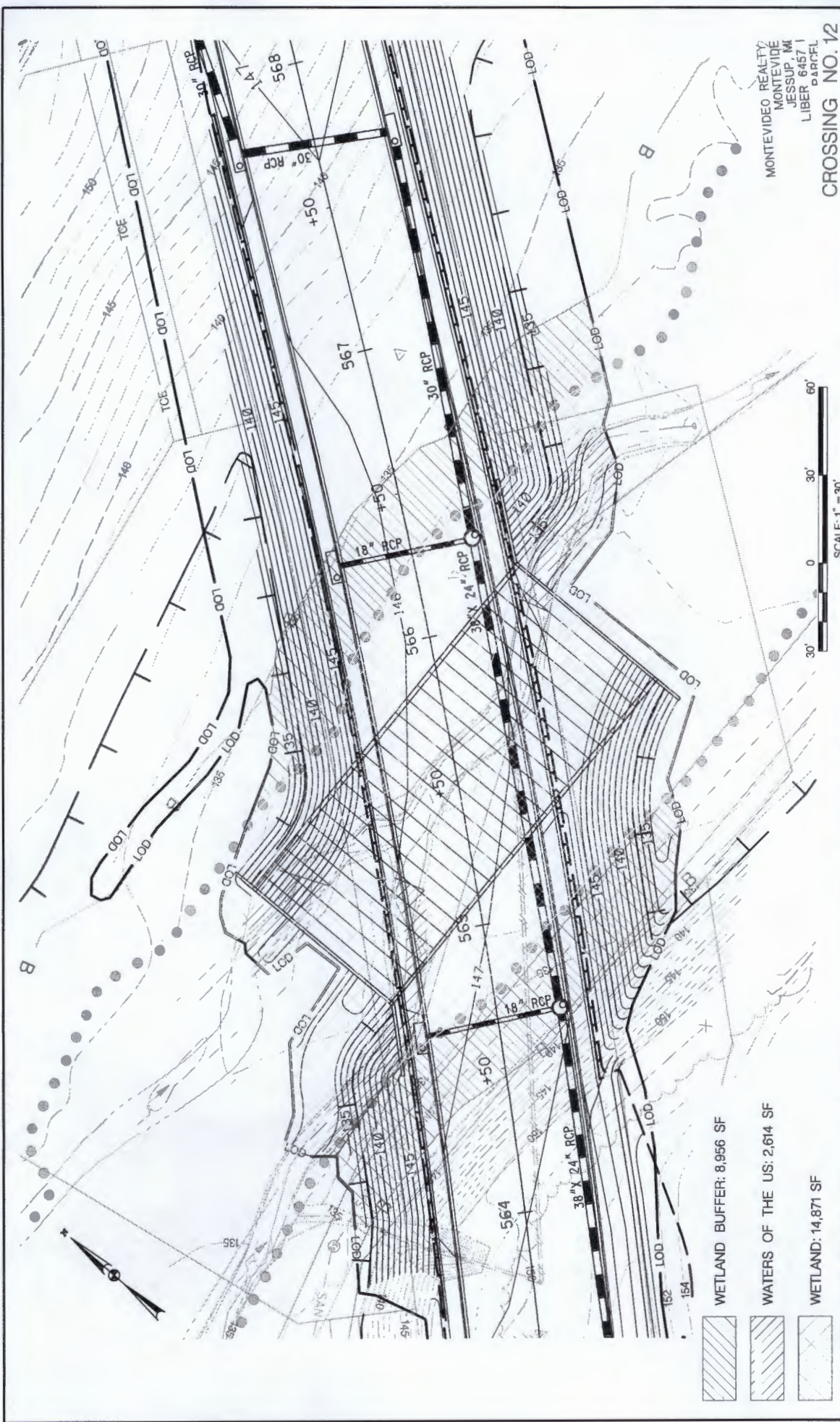

MONTEVIDEO REALTY  
 MONTEVIDEO  
 JESSUP, MD  
 LIBER 6457.1  
 PARCEL

CROSSING NO. 12

DORSEY RUN ROAD EXTENSION  
 MONTEVIDEO ROAD TO  
 STATION 591+42.16  
 ELECTION DISTRICT NO. 1 - JESSUP, MARYLAND  
 CAPITAL PROJECT J-1148-B

GRAPHIC EXHIBIT

NO.	DATE	REVISION



DATE	BY	SCALE	MAP NO.	BLOCK NO.

DEPARTMENT OF PUBLIC WORKS  
 HOWARD COUNTY, MARYLAND

DESIGNED BY: \_\_\_\_\_ DATE: \_\_\_\_\_  
 CHECKED BY: \_\_\_\_\_ DATE: \_\_\_\_\_  
 SUPERVISOR: \_\_\_\_\_ DATE: \_\_\_\_\_

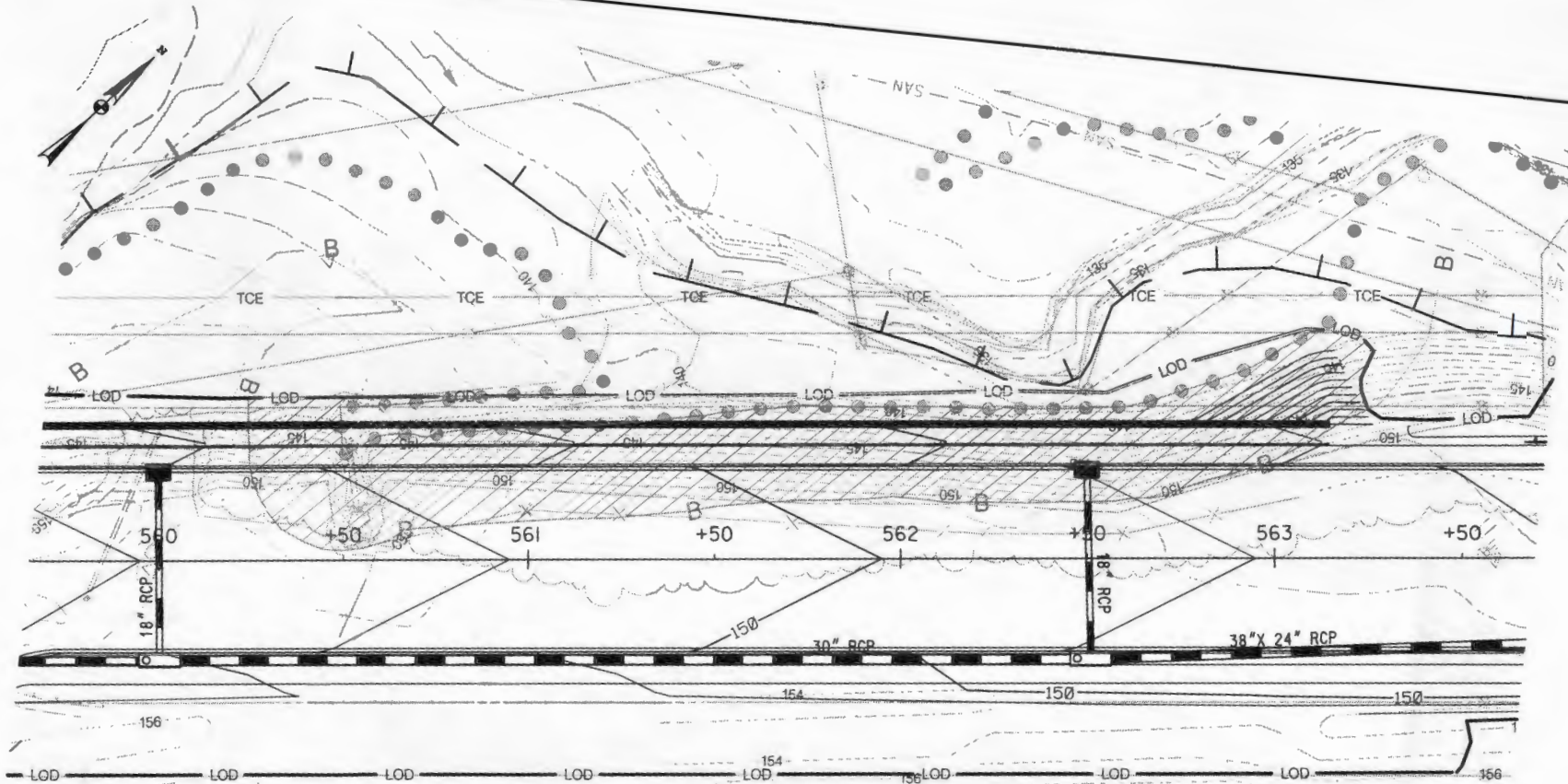
- WETLAND BUFFER: 8,956 SF
- WATERS OF THE US: 2,614 SF
- WETLAND: 14,871 SF



-  WETLAND BUFFER: 8,078 SF
-  WATERS OF THE US: 0 SF
-  WETLAND: 1,536 SF

MONTEVIDEO REALTY BUSINESS TRUST  
 MONTEVIDEO ROAD  
 JESSUP, MD 20794  
 2457 FOLIO 258

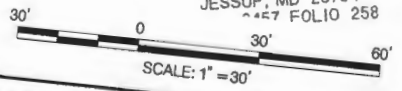

DEPARTMENT OF PUBLIC WORKS HOWARD COUNTY, MARYLAND	
DIRECTOR OF PUBLIC WORKS	DATE
CHIEF, BUREAU OF ENGINEERING	DATE
CHIEF, BUREAU OF TRANSPORTATION	DATE
CHIEF, BUREAU OF HIGHWAYS	DATE



DESIGNED BY	DATE
DRAWN BY	DATE
CHECKED BY	DATE
DATE: 8/10	
BY	NO.
REVISION	DATE

GRAPHIC EXHIBIT

SCALE MAP NO. \_\_\_\_\_ BLOCK NO. \_\_\_\_\_

CROSSING NO. 12



DORSEY RUN ROAD EXTENSION  
 MONTEVIDEO ROAD TO  
 STATION 591+42.16  
 ELECTION DISTRICT NO. 1 - JESSUP, MARYLAND  
 CAPITAL PROJECT J-4148-B

SCALE \_\_\_\_\_

SHEET \_\_\_\_\_ OF 39

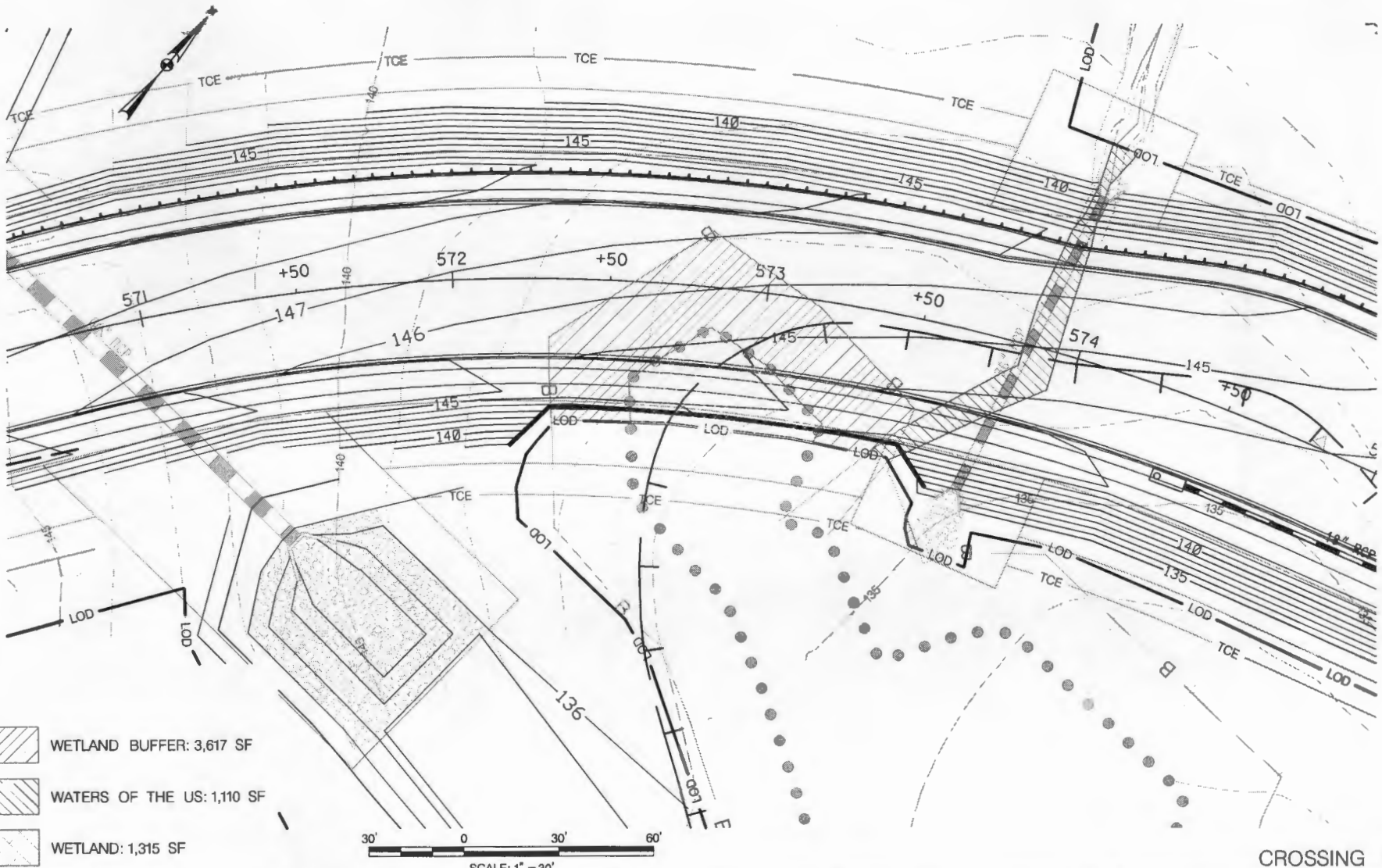
0:\2005048-VH\CD\Project\user\7003.DWG.dgn  
 OFFICE: Jessup Aug 04, 2010 10:12 AM



-  WETLAND BUFFER: 3,617 SF
-  WATERS OF THE US: 1,110 SF
-  WETLAND: 1,315 SF

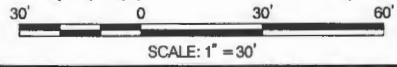



CROSSING NO. 3

DEPARTMENT OF PUBLIC WORKS HOWARD COUNTY, MARYLAND		PREPARED BY <b>URS</b> <small>UNIVERSITY RESOURCES INC.</small> <small>1000 WOODLAND DRIVE</small> <small>WILMINGTON, DELAWARE 19804</small>	DES: CME			GRAPHIC EXHIBIT	DORSEY RUN ROAD EXTENSION MONTEVIDEO ROAD TO STATION 591+42.16 ELECTION DISTRICT NO. 1 - JESSUP, MARYLAND CAPITAL PROJECT J-4148-B	SCALE
DIRECTOR OF PUBLIC WORKS _____ DATE _____	CHIEF, BUREAU OF ENGINEERING _____ DATE _____		DRN: CDF	CNE: BTM	DATE: 6/10			BY NO. _____ REVISION _____ DATE _____

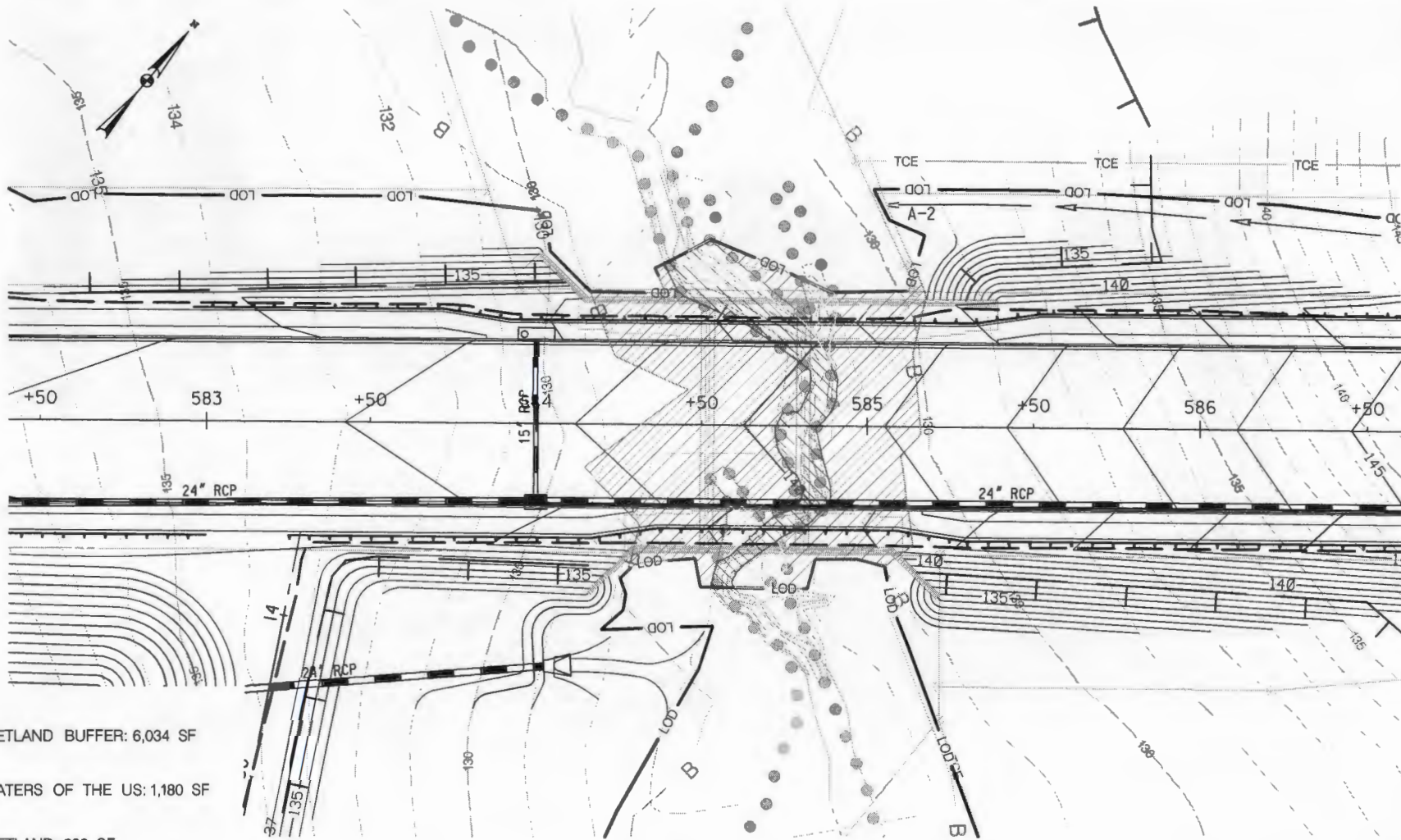



-  WETLAND BUFFER: 6,034 SF
-  WATERS OF THE US: 1,180 SF
-  WETLAND: 688 SF

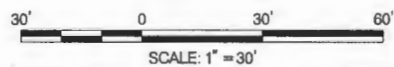

CROSSING NO. 4

DEPARTMENT OF PUBLIC WORKS HOWARD COUNTY, MARYLAND  DIRECTOR OF PUBLIC WORKS _____ DATE _____ CHIEF, BUREAU OF ENGINEERING _____ DATE _____  CHIEF, DIVISION OF TRANSPORTATION _____ DATE _____ AND SPECIAL PROJECTS _____	PREPARED BY <b>URS</b> <small>CONSTRUCTION SERVICES          INCORPORATED, SUITE 100          12000 WOODBURN ROAD</small>	DES: CMB DRN: CDF CHE: BTH DATE: 6/10  BY: _____ NO. _____ REVISION _____ DATE _____	GRAPHIC EXHIBIT	DORSEY RUN ROAD EXTENSION MONTEVIDEO ROAD TO STATION 591+42.16 ELECTION DISTRICT NO. 1 - JESSUP, MARYLAND CAPITAL PROJECT J-4148-B	SCALE  SHEET OF 32
---	---	---	-----------------	--	-----------------------------